

STATE OF ILLINOIS
 DEPARTMENT OF TRANSPORTATION
 DIVISION OF HIGHWAYS

FAI RTE.	SECTION	COUNTY	TOTAL SHEETS	SHEET NO.
70	60-9-1	MADISON	12	1
FED. ROAD DIST. NO.	ILLINOIS	CONTRACT NO. 76D07		

FOR INDEX OF SHEETS, SEE SHEET NO. 2

**PROPOSED
 HIGHWAY PLANS**

FAI ROUTE 70 (I-70)
 SECTION 60-9-1

PATCHING
 MADISON COUNTY

C-98-058-09

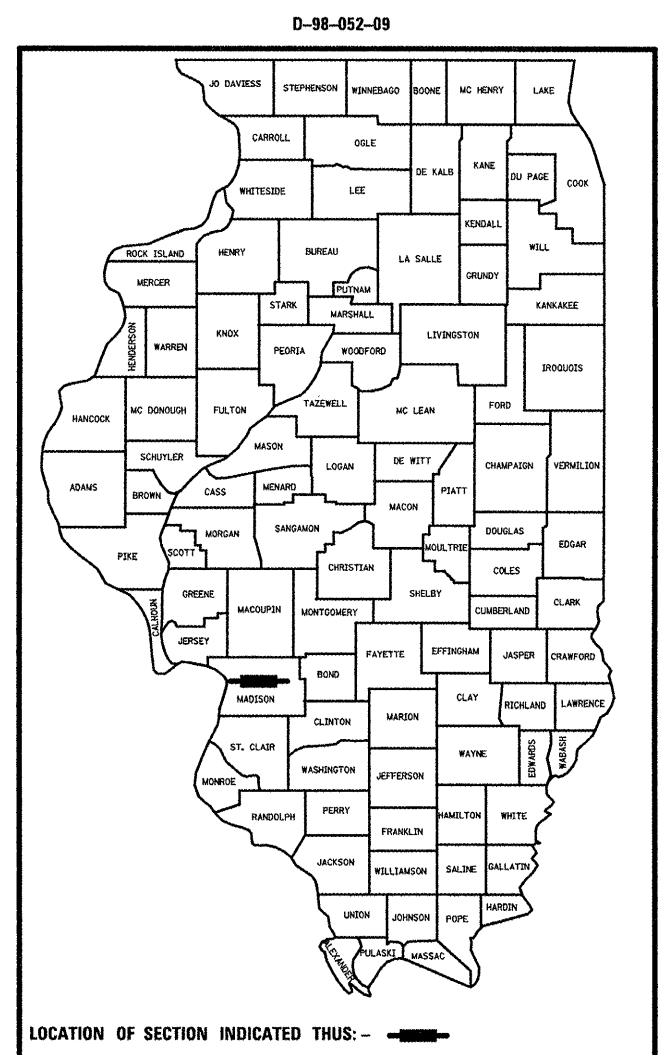

PROJECT LOCATION

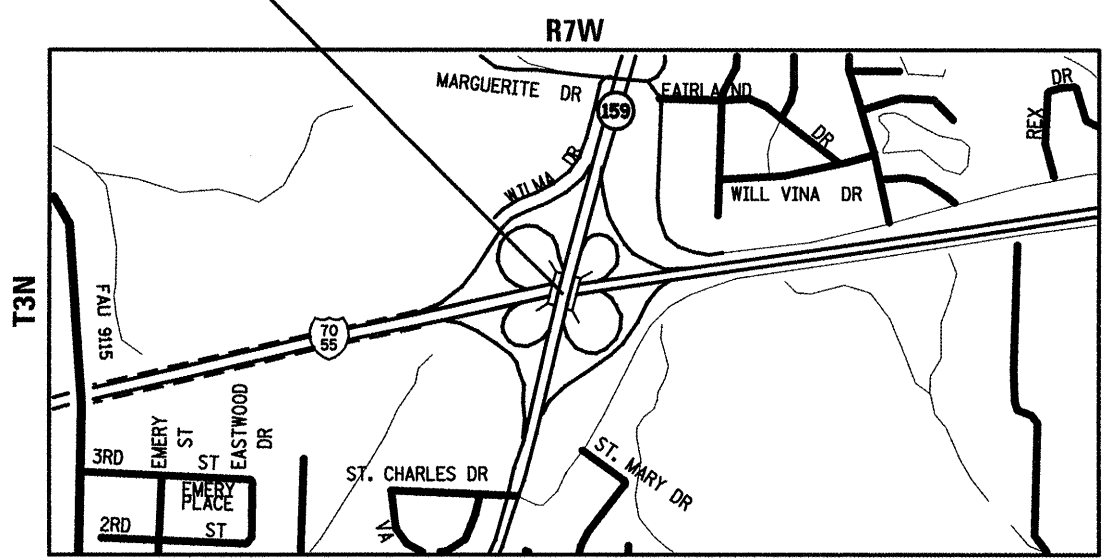

LAYOUT

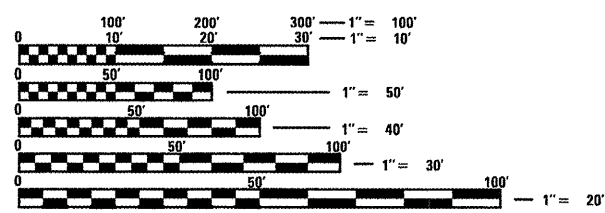

FULL SIZE PLANS HAVE BEEN PREPARED USING STANDARD ENGINEERING SCALES. REDUCED SIZED PLANS WILL NOT CONFORM TO STANDARD SCALES. IN MAKING MEASUREMENTS ON REDUCED PLANS, THE ABOVE SCALES MAY BE USED.

J.U.L.I.E.
 JOINT UTILITY LOCATION INFORMATION FOR EXCAVATION
 1-800-892-0123
 OR 811



1" = 1 MILE

LATITUDE: 38.7080
 LONGITUDE: -89.9589

GROSS LENGTH = 1037 FT. = 0.196 MILE
 NET LENGTH = 1037 FT. = 0.196 MILE

PROJECT ENGINEER: PATTI LeBEAU (618) 346-3179
 PROJECT MANAGER: TIM PADGETT (618)-346-3284

CONTRACT NO. 76D07

STATE OF ILLINOIS
 DEPARTMENT OF TRANSPORTATION
 DIVISION OF HIGHWAYS

SUBMITTED *May 15, 2009*

Mary C. Jamie
 DEPUTY DIRECTOR OF HIGHWAYS, REGION 5 ENGINEER

June 26, 2009
Charles J. Ingersoll
 ENGINEER OF DESIGN AND ENVIRONMENT

June 26, 2009
Christine M. Reed
 DIRECTOR OF HIGHWAYS, CHIEF ENGINEER

**PRINTED BY THE AUTHORITY
 OF THE STATE OF ILLINOIS**

INDEX OF SHEETS

- 1 COVER SHEET
- 2 INDEX OF SHEETS, GENERAL NOTES AND HIGHWAY STANDARDS
- 3 SUMMARY OF QUANTITIES
- 4-5 TYPICAL SECTIONS
- 6 SCHEDULES
- 7-8 DETOUR SIGNING
- 9 STAGE CONSTRUCTION
- 10 PLAN SHEET
- 11 PAVEMENT MARKING
- 12 DETAIL SHEET

STANDARDS

- 442001-04
- 701101-02
- 701106-02
- 701400-03
- 701401-05
- 701406-05
- 701426-03
- 701451
- 701901-01
- 780001-02
- 781001-03

701454

COMMITMENTS

NONE

GENERAL NOTES

1. THE PIPE UNDERDRAINS SHALL BE CONNECTED TO THE CROSSROAD CULVERTS AS SHOWN ON THE PLANS. PRIOR TO THE START OF THIS WORK, THE METHOD AND CONSTRUCTION OF THIS WORK SHALL BE APPROVED BY THE ENGINEER. ALL WORK TO MAKE THIS CONNECTION SHALL BE INCLUDED IN THE PAY ITEM PIPE UNDERDRAINS 4 INCH.
2. THE COST OF REMOVING THE EXISTING RAISED PAVEMENT MARKERS SHALL BE INCLUDED IN THE PAY ITEM CLASS A PATCHES TYPE IV, 14 INCH.
3. IF ANY SECTION OR SUB-SECTION MONUMENTS ARE ENCOUNTERED, THE ENGINEER SHALL BE NOTIFIED BEFORE SUCH MONUMENTS ARE REMOVED OR RESURFACED OVER. THE CONTRACTOR SHALL PROTECT AND CAREFULLY PRESERVE ALL PROPERTY MARKERS AND MONUMENTS UNTIL THE OWNER, AN AUTHORIZED SURVEYOR, OR AGENT HAS WITNESSED OR OTHERWISE REFERENCED THEIR LOCATION.
4. ILLINOIS STATE LAW REQUIRES A 48-HOUR NOTICE BE GIVEN TO ALL UTILITIES BEFORE DIGGING. FIELD MARKING OF FACILITIES MAY BE OBTAINED BY CONTACTING J.U.L.I.E. OR FOR NON-MEMBERS, THE UTILITY COMPANY DIRECTLY. AGENCIES KNOWN TO HAVE FACILITIES WITHIN THE PROJECT AREA ARE AS FOLLOWS:
 - AMEREN IP (GAS & ELECTRIC)
 - AT&T ILLINOIS
 - AT&T CORPORATION
 - CHARTER COMMUNICATIONS (CABLE TV)
 - CITY OF COLLINSVILLE (WATER & SEWER)
 - CITY OF TROY (WATER)

MEMBERS OF J.U.L.I.E. (800)-892-0123 ARE INDICATED BY *. NON J.U.L.I.E. MEMBERS MUST BE NOTIFIED INDIVIDUALLY.
5. ALL TEMPORARY PAVEMENT MARKINGS WILL BE PLACED IN SUCH A MANNER SO AS NOT TO INTERFERE WITH THE PLACEMENT OF PERMANENT PAVEMENT MARKINGS.
6. ONLY NON-CHLORIDE CONCRETE ACCELERATOR WILL BE ACCEPTED ON THIS PROJECT. IF USED, THE ACCELERATOR SHALL MEET THE APPROVAL OF THE ENGINEER PRIOR TO POURING THE CONCRETE.
7. THE CONTRACTOR SHALL VERIFY ALL DIMENSIONS AND CONDITIONS IN THE FIELD PRIOR TO CONSTRUCTION AND ORDERING OF MATERIALS.
8. ALL EXCAVATION ADJACENT TO THE EDGE OF PAVEMENT SHALL BE PROTECTED WITH EXTENDED LEG BARRICADES AND APPROPRIATE LIGHTS.
9. ALL TRAFFIC CONTROL DEVICES SHALL BE SKID MOUNTED.
10. "ROAD CONSTRUCTION AHEAD" SIGNS SHALL BE PLACED AT THE BEGINNING AND END OF THE PROJECT AND WILL BE INCLUDED IN THE TRAFFIC CONTROL PAY ITEMS. ALL CONSTRUCTION SIGNS SHALL BE FLUORESCENT ORANGE.
11. FLAGGERS SHALL BE PRESENT DURING ALL CLOSURE HOURS (INCLUDING LUNCH HOUR) WHEN WORKERS ARE PRESENT. NO ADDITIONAL COMPENSATION SHALL BE APPLIED.

Rev.

FILE NAME =	USER NAME = challesdeske	DESIGNED -	REVISED -	STATE OF ILLINOIS DEPARTMENT OF TRANSPORTATION	GENERAL NOTES, STANDARDS AND COMMITMENTS				F.A.I. RTE.	SECTION	COUNTY	TOTAL SHEETS	SHEET NO.
ct\pwwork\VPWIDOT\CHALLANDESKE\d013487	d876d87-ahp-plan.dgn	DRAWN -	REVISED -		70	60-9-I	MADISON	12	2				
	PLOT SCALE = 1/2" = 100' / IN.	CHECKED -	REVISED -		CONTRACT NO. 76D07								
	PLOT DATE = 5/14/2009	DATE -	REVISED -		SCALE:	SHEET NO. OF	SHEETS	STA.	TO STA.	FED. ROAD DIST. NO.	ILLINOIS FED. AID PROJECT		

SUMMARY OF QUANTITIES

URBAN
100% STATE

SUMMARY OF QUANTITIES			CONSTRUCTION TYPE CODE		
CODE NO	ITEM	UNIT	J000		
35101100	AGGREGATE BASE COURSE, TYPE A 12"	SQ YD	5393		
44213100	PAVEMENT FABRIC	SQ YD	5221		
44200628	CLASS A PATCHES, TYPE IV, 14 INCH	SQ YD	5221		
44213000	PATCHING REINFORCEMENT	SQ YD	5221		
44213200	SAW CUTS	FOOT	6693		
60100070	SHOULDER REMOVAL AND REPLACEMENT	FOOT	3761		
60107600	PIPE UNDERDRAINS 4"	FOOT	3761		
67000400	ENGINEER'S FIELD OFFICE, TYPE A	CAL MO	4		
67100100	MOBILIZATION	L SUM	1		
70100700	TRAFFIC CONTROL AND PROTECTION, STANDARD 701406	L SUM	1		
70100800	TRAFFIC CONTROL AND PROTECTION, STANDARD 701401	L SUM	1		
70100820	TRAFFIC CONTROL AND PROTECTION, STANDARD 701451	L SUM	1		
70106800	CHANGEABLE MESSAGE SIGN	CAL MO	6		
70300100	SHORT-TERM PAVEMENT MARKING	FOOT	232		
70300240	TEMPORARY PAVEMENT MARKING - LINE 6"	FOOT	2876		
70300250	TEMPORARY PAVEMENT MARKING - LINE 8"	FOOT	831		
70301000	WORK ZONE PAVEMENT MARKING REMOVAL	SQ FT	2069		
* 78001130	PAINT PAVEMENT MARKING - LINE 6"	FOOT	2876		
* 78001140	PAINT PAVEMENT MARKING - LINE 8"	FOOT	831		
* 78100100	RAISED REFLECTIVE PAVEMENT MARKER	EACH	36		
X0324743	SUBGRADE REINFORCEMENT	SQ YD	5393		
X0324952	DETOUR SIGNING	L SUM	1		
X0325702	NIGHTTIME WORK ZONE LIGHTING	L SUM	1		
Z0017202	DOWEL BARS 1 1/2"	EACH	149		
Z0021400	EXPANSION JOINT (SPECIAL)	FOOT	168		
Z0075310	TIE BARS 3/4"	EACH	647		
70100825	TRAFFIC CONTROL AND PROTECTION, STANDARD 701456	L SUM	1		

* SPECIALTY ITEMS

Rev.

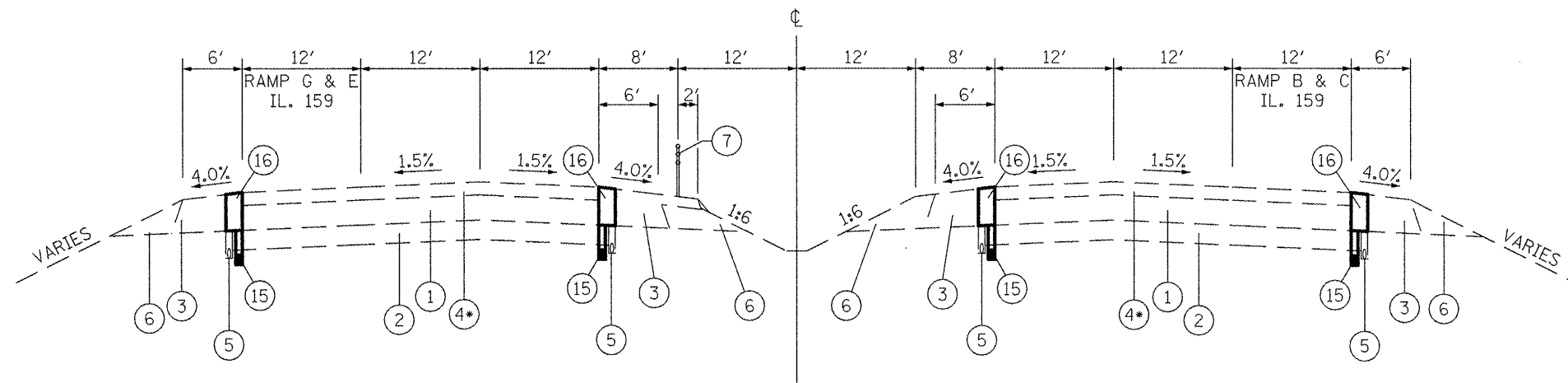

**EXISTING
F.A.I. ROUTE 70 TYPICAL SECTION
UNDER IL. 159 BRIDGE**

STA. 706+50 E.B. TO STA. 709+50 E.B. * 3"
STA. 707+00 W.B. TO STA. 710+00 W.B. * 3"

LEGEND

- ① EXISTING P.C.C. PAVEMENT 10"
- ② EXISTING SUB-BASE GRANULAR MATERIAL, TYPE A 8"
- ③ EXISTING BITUMINOUS SHOULDER 12"±
- ④ EXISTING BITUMINOUS SURFACE COURSE 5 1/4"
- ⑤ EXISTING PIPE UNDERDRAINS
- ⑥ EXISTING AGGREGATE SHOULDERS
- ⑦ EXISTING HIGH TENSION CABLE MEDIAN BARRIER & HOT-MIX ASPHALT SHOULDER, 4' (4' WIDE)
- ⑧ EXISTING BITUMINOUS CONCRETE PAVEMENT (FULL DEPTH), TYPE 1 20 1/2"
- ⑨ EXISTING LIME MODIFIED SOIL, 12"
- ⑩ EXISTING BITUMINOUS SHOULDER 8"
- ⑪ EXISTING BITUMINOUS CONCRETE PAVEMENT (FULL DEPTH), TYPE 1 15 1/2"
- ⑫ EXISTING BITUMINOUS CONCRETE PAVEMENT (FULL DEPTH), TYPE 2 13 1/2"
- ⑬ EXISTING COMBINATION CONCRETE CURB AND GUTTER TYPE M-4.12
- ⑭ EXISTING CONCRETE MEDIAN SURFACE, 4"
- ⑮ PROPOSED PIPE UNDERDRAIN 4"
- ⑯ PROPOSED SHOULDER REMOVAL AND REPLACEMENT

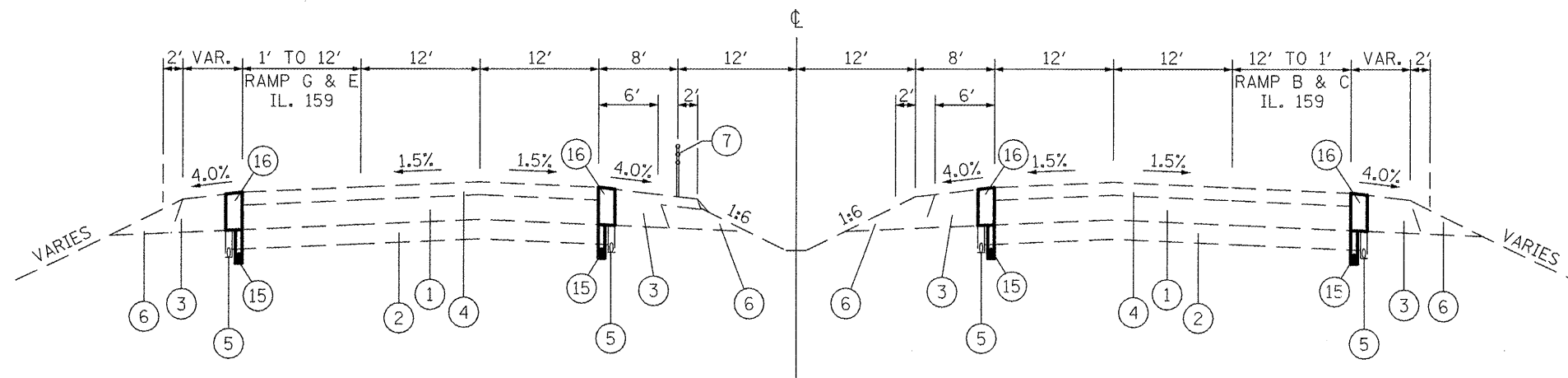

**EXISTING
F.A.I. ROUTE 70 TYPICAL SECTION
TANGENT**

STA. 704+23 E.B. TO STA. 706+50 E.B.
STA. 704+53 W.B. TO STA. 707+00 W.B.
STA. 709+50 E.B. TO STA. 712+50 E.B.
STA. 710+00 W.B. TO STA. 712+50 W.B.

FILE NAME =	USER NAME = #USER#	DESIGNED -	REVISED -	STATE OF ILLINOIS DEPARTMENT OF TRANSPORTATION	EXISTING TYPICAL SECTIONS			F.A.I. RTE.	SECTION	COUNTY	TOTAL SHEETS	SHEET NO.
#FILE#		DRAWN -	REVISED -					70	60-9-I	MADISON	12	4
		CHECKED -	REVISED -		SCALE: SHEET NO. OF SHEETS STA. TO STA.			CONTRACT NO. 76007				
		DATE -	REVISED -		FED. ROAD DIST. NO. ILLINOIS FED. AID PROJECT							

LEGEND

- ① EXISTING P.C.C. PAVEMENT 10"
- ② EXISTING SUB-BASE GRANULAR MATERIAL, TYPE A 8"
- ③ EXISTING BITUMINOUS SHOULDER 12"±
- ④ EXISTING BITUMINOUS SURFACE COURSE 5 1/4"
- ⑤ EXISTING PIPE UNDERDRAINS
- ⑥ EXISTING AGGREGATE SHOULDERS
- ⑦ EXISTING HIGH TENSION CABLE MEDIAN BARRIER & HOT-MIX ASPHALT SHOULDER, 4" (4' WIDE)
- ⑧ EXISTING BITUMINOUS CONCRETE PAVEMENT (FULL DEPTH), TYPE 1 20 1/2"
- ⑨ EXISTING LIME MODIFIED SOIL, 12"
- ⑩ EXISTING BITUMINOUS SHOULDER 8"
- ⑪ EXISTING BITUMINOUS CONCRETE PAVEMENT (FULL DEPTH), TYPE 1 15 1/2"
- ⑫ EXISTING BITUMINOUS CONCRETE PAVEMENT (FULL DEPTH), TYPE 2 13 1/2"
- ⑬ EXISTING COMBINATION CONCRETE CURB AND GUTTER TYPE M-4.12
- ⑭ EXISTING CONCRETE MEDIAN SURFACE, 4"
- ⑮ PROPOSED PIPE UNDERDRAIN 4"
- ⑯ PROPOSED SHOULDER REMOVAL AND REPLACEMENT

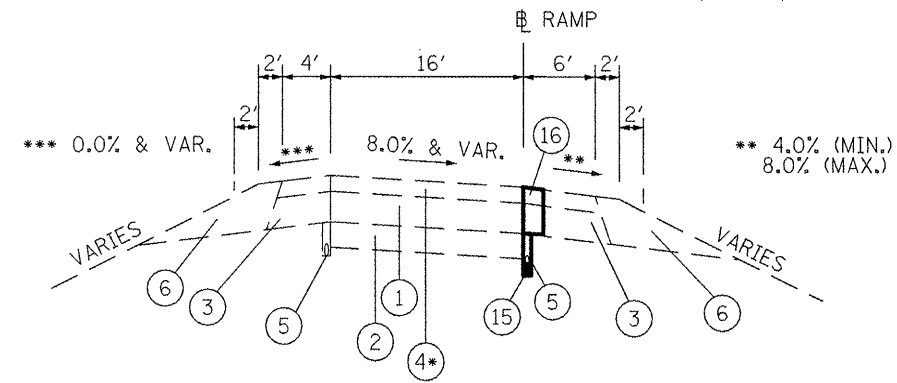

EXISTING RAMP TYPICAL SECTION (IL 159 INTERCHANGE)

RAMP B, E & G (3 1/4"±)*

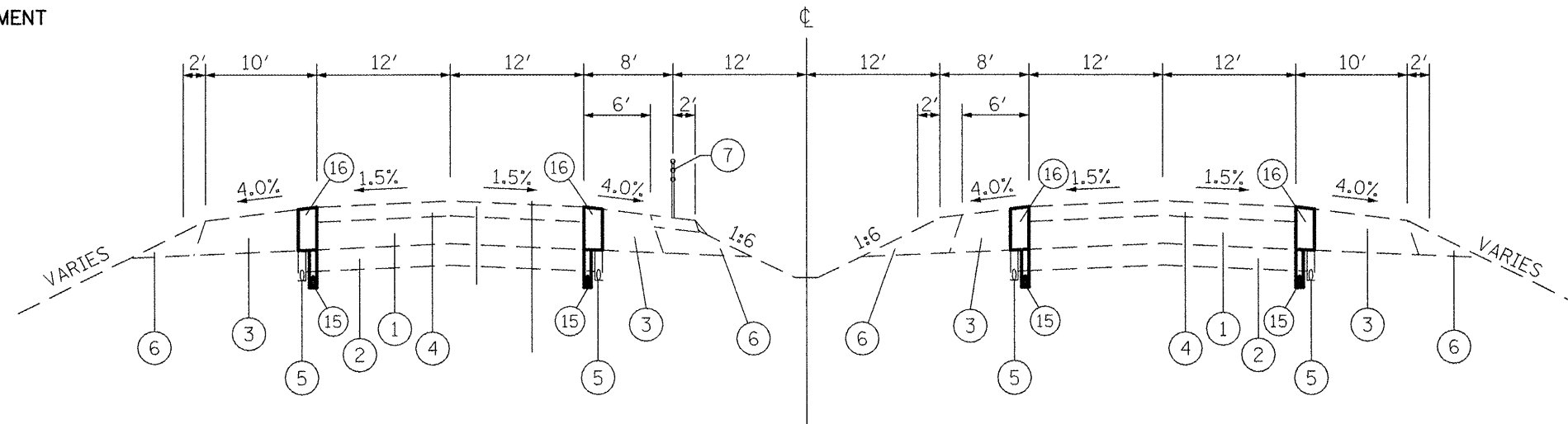

F.A.I. ROUTE 70 TYPICAL SECTION TANGENT

STA. 712+50 TO STA. 714+60

FILE NAME =	USER NAME = #USER#	DESIGNED -	REVISED -	STATE OF ILLINOIS DEPARTMENT OF TRANSPORTATION	EXISTING TYPICAL SECTIONS			F.A.I. RTE.	SECTION	COUNTY	TOTAL SHEETS	SHEET NO.
#FILE#		DRAWN -	REVISED -		70	60-9-I	MADISON	12	5			
		CHECKED -	REVISED -		SCALE: SHEET NO. OF SHEETS STA. TO STA.			CONTRACT NO. 76D07				
		DATE -	REVISED -		FED. ROAD DIST. NO. ILLINOIS FED. AID PROJECT							

PIPE UNDERDRAINS				
STA	TO	STA	SHOULDER REMOVAL AND REPLACEMENT (FOOT)	PIPE UNDERDRAINS 4 INCH (FOOT)
EB 55/70				
704+53	TO	714+60	1007	1007
RAMP B & C				
8+00	TO	11+63	363	363
707+15	TO	710+00	285	285
12+61	TO	10+50	211	211
WB 55/70				
704+23	TO	714+60	1037	1037
RAMP G & E				
11+00	TO	13+66	266	266
706+30	TO	709+20	290	290
11+62	TO	8+60	302	302
TOTAL:			3761	3761

STAGE CONSTRUCTION SCHEDULE								
LOCATION	SUBGRADE REINFORCEMENT (SQ. YD.)	AGGREGATE BASE COURSE TYPE-A 12" (SQ. YD.)	CLASS A PATCHES TYPE IV (SQ. YD.)	EXPANSION JOINT(SPECIAL) (FOOT)	DOWEL BARS 1/2" (EACH)	TIE BARS (EACH)	SAW CUTS (FOOT)	PAVEMENT FABRIC (SQ. YD.)
STAGE I	1615	1615	1560	54	49		1798	1560
STAGE II	2048	2048	1995	62	56		2201	1995
STAGE III	1730	1730	1666	52	44	647	2694	1666
TOTAL:	5393	5393	5221	168	149	647	6693	5221

RAISED REFLECTIVE PAVEMENT MARKER			
STA	TO	STA	ONE WAY CRYSTAL (each)
EB 55/70			
704+53	TO	710+28	16
WB 55/70			
704+23	TO	711+47	20
TOTAL:			36

PAINT PAVEMENT MARKING							
STA	TO	STA	WHITE SKIP DASH LINE 6 INCH (FOOT)	SOLID YELLOW LINE 6 INCH (FOOT)	SOLID WHITE LINE 6 INCH (FOOT)	ABBR. WHITE SKIP DASH LINE 8 INCH (FOOT)	SOLID WHITE LINE 8 INCH (FOOT)
EB 55/70							
704+53	TO	710+28	150				
705+75	TO	710+28				114	
704+53	TO	710+28		575			
EB RAMPS							
9+04	TO	11+63			259		
707+15	TO	710+28			313		
WB 55/70							
704+23	TO	711+47	190				
705+50	TO	711+00				138	
704+23	TO	711+47		724			
WB RAMPS							
12+26	TO	13+66			140		
706+30	TO	709+20			290		
11+62	TO	9+27			235		
RAMP B GORE							
704+53	TO	705+75					122
9+04	TO	10+10					106
RAMP G GORE							
704+23	TO	705+50					127
12+26	TO	13+00					74
RAMP E GORE							
710+75	TO	711+47					72
10+05	TO	9+27					78
SUBTOTAL:			340	1299	1237	252	579
TOTAL:				2876			831

NOTES:

1. DETOUR SIGNS REQUIRED WILL BE SUPPLIED TO THE CONTRACTOR BY I.D.O.T.
2. THE CONTRACTOR SHALL FURNISH THE POSTS AND ERECT SIGNS AT THE LOCATIONS SHOWN ON THIS SHEET, AS DIRECTED BY THE R.E./R.T. THE POSTS SHALL REMAIN THE PROPERTY OF THE CONTRACTOR.
3. THE CONTRACTOR SHALL GIVE ILLINOIS DEPARTMENT OF TRANSPORTATION, BUREAU OF OPERATIONS TWO WEEKS NOTICE FOR SIGNS. THE CONTRACTOR SHALL PICK UP THE SIGNS AT THE T.M. BUILDING IN FAIRVIEW HEIGHTS, AND RETURN THEM UPON COMPLETION OF THE CONTRACT. CONTACT JEAN SLAPE, PHONE (618) 346-3289.
4. CHANGEABLE MESSAGE BOARDS SHALL BE USED TWO WEEKS PRIOR TO THE START OF CONSTRUCTION, AND DURING STAGE 1, 2, AND 3.
5. SIGN SPACING WILL BE 400' OR TO FIT FIELD CONDITIONS.
6. THE HEIGHT TO THE BOTTOM OF THE LOWEST SIGN SHALL NOT BE LESS THAN 6'.
7. CONTRACTOR SHALL FURNISH ADVANCE WARNING SIGNS, ROAD CLOSURE SIGNS, MESSAGE BOARD, AND TYPE 3 BARRICADES.
8. ALL ADVANCE WARNING SIGNS SHALL BE 48" FLOURESCENT ORANGE WITH FLASHING LIGHTS.
9. SIGNS, MESSAGE BOARD, AND TRAFFIC CONTROL DEVICES TO BE PLACED AS SHOWN ON THE PLANS OR AS DIRECTED BY THE ENGINEER.

* IN ADDITION TO THE TYPE III BARRICADES, STANDARD 701451 SHALL BE USED TO CLOSE NB RAMP, SB TO EB RAMP, AND EB TO NB RAMP (SEE DETAIL).



STAGE I SIGNING		
①		5 EACH
②		6 EACH
③		2 EACH
④		1 EACH
⑤		4 EACH
⑥		4 EACH

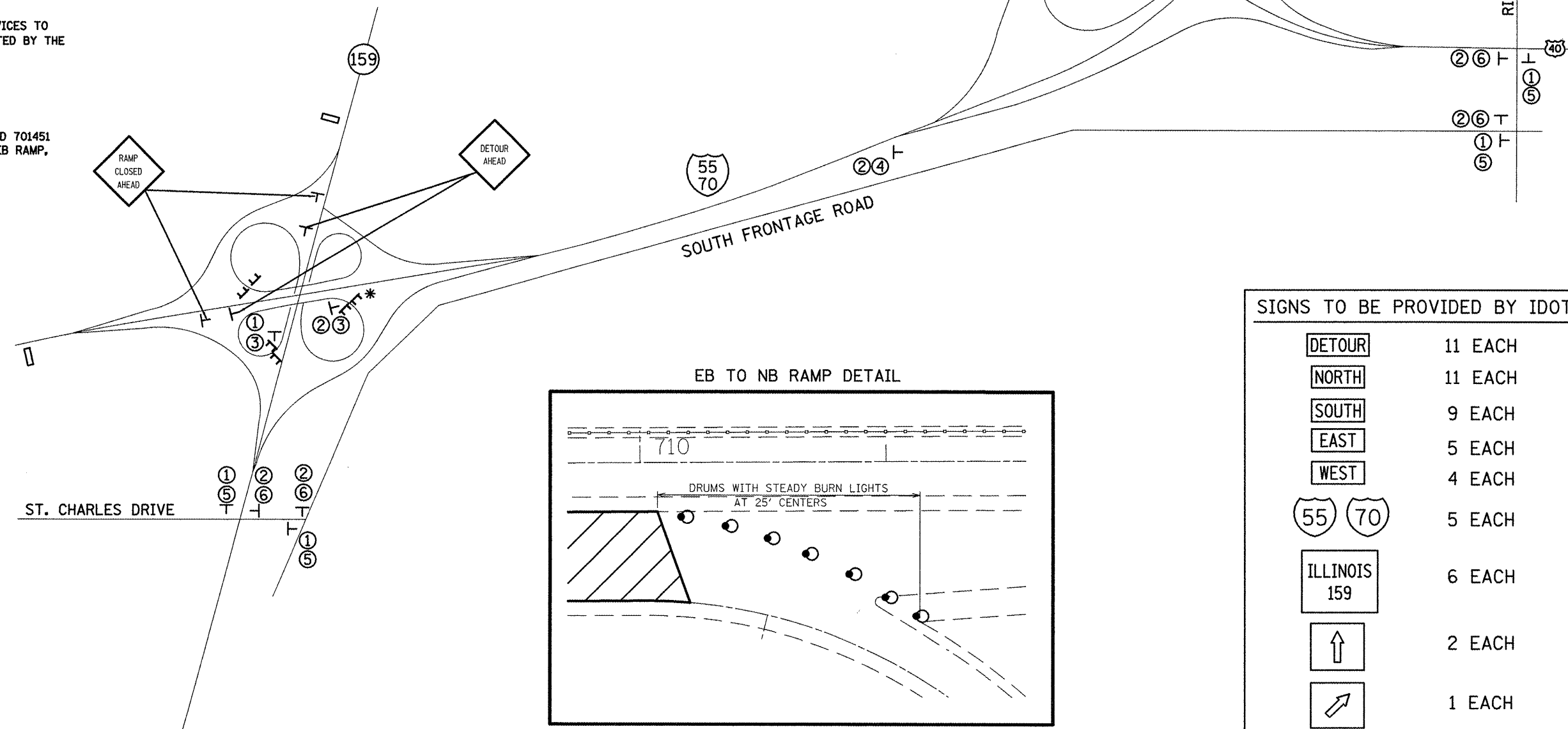

SIGNS TO BE PROVIDED BY IDOT	
	11 EACH
	11 EACH
	9 EACH
	5 EACH
	4 EACH
	5 EACH
	6 EACH
	2 EACH
	1 EACH
	4 EACH
	4 EACH

--- TYPE 3 BARRICADES
 --- MESSAGE BOARD

DRAWING NOT TO SCALE

NOTES:

1. DETOUR SIGNS REQUIRED WILL BE SUPPLIED TO THE CONTRACTOR BY I.D.O.T.
2. THE CONTRACTOR SHALL FURNISH THE POSTS AND ERECT SIGNS AT THE LOCATIONS SHOWN ON THIS SHEET, AS DIRECTED BY THE R.E./R.T. THE POSTS SHALL REMAIN THE PROPERTY OF THE CONTRACTOR.
3. THE CONTRACTOR SHALL GIVE ILLINOIS DEPARTMENT OF TRANSPORTATION, BUREAU OF OPERATIONS TWO WEEKS NOTICE FOR SIGNS. THE CONTRACTOR SHALL PICK UP THE SIGNS AT THE T.M. BUILDING IN FAIRVIEW HEIGHTS, AND RETURN THEM UPON COMPLETION OF THE CONTRACT. CONTACT JEAN SLAPE, PHONE (618) 346-3289.
4. CHANGEABLE MESSAGE BOARDS SHALL BE USED TWO WEEKS PRIOR TO THE START OF CONSTRUCTION, AND DURING STAGE 1, 2, AND 3.
5. SIGN SPACING WILL BE 400' OR TO FIT FIELD CONDITIONS.
6. THE HEIGHT TO THE BOTTOM OF THE LOWEST SIGN SHALL NOT BE LESS THAN 6'.
7. CONTRACTOR SHALL FURNISH ADVANCE WARNING SIGNS, ROAD CLOSURE SIGNS, MESSAGE BOARD, AND TYPE 3 BARRICADES.
8. ALL ADVANCE WARNING SIGNS SHALL BE 48" FLOURESCENT ORANGE WITH FLASHING LIGHTS.
9. SIGNS, MESSAGE BOARD, AND TRAFFIC CONTROL DEVICES TO BE PLACED AS SHOWN ON THE PLANS OR AS DIRECTED BY THE ENGINEER.

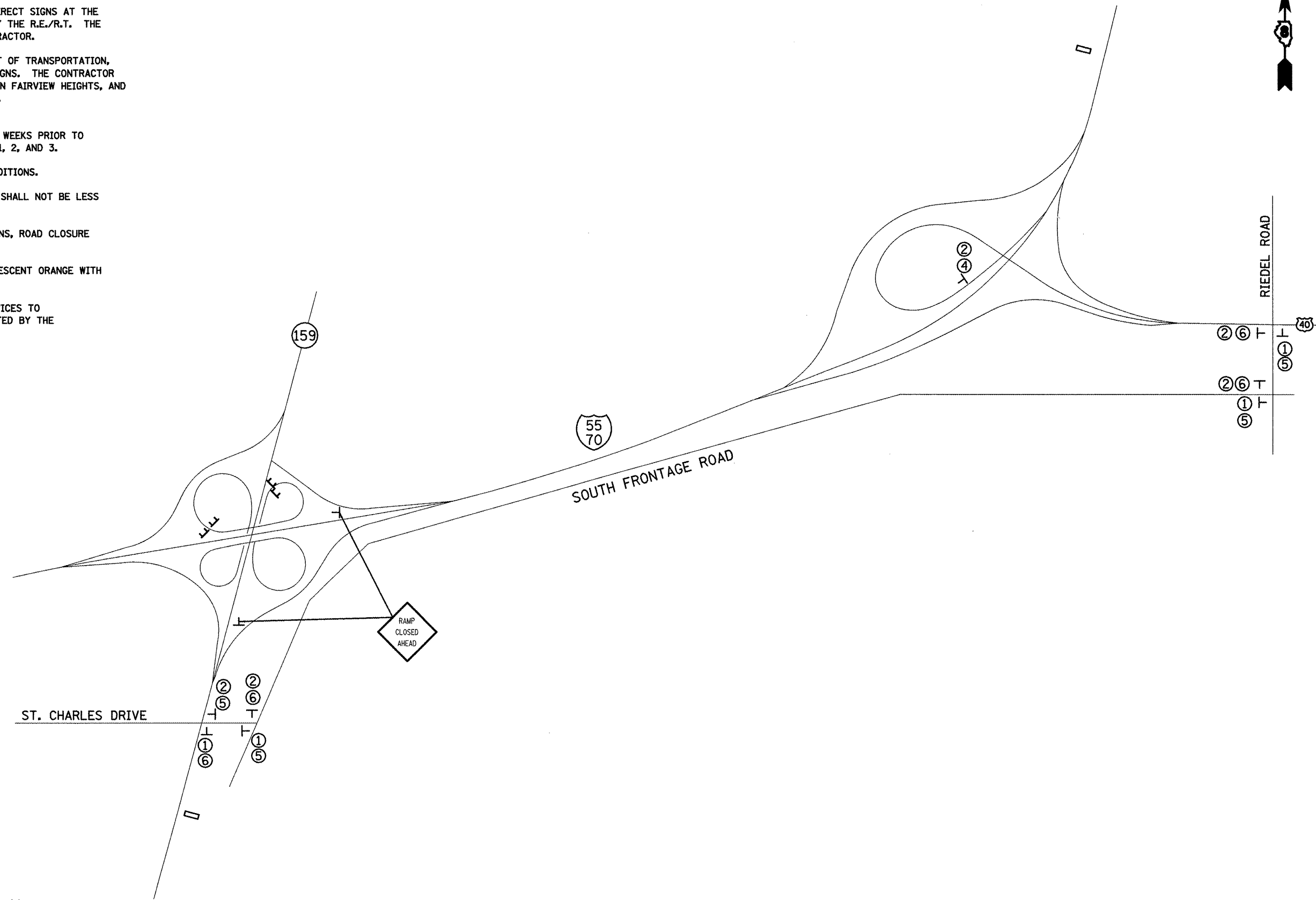

STAGE II SIGNING

- ① 4 EACH
- ② 5 EACH
- ③ 1 EACH
- ④ 1 EACH
- ⑤ 4 EACH
- ⑥ 4 EACH

⏏ TYPE 3 BARRICADES
 □ MESSAGE BOARD

DRAWING NOT TO SCALE

FILE NAME = #FILE#	USER NAME = #USER#	DESIGNED -	REVISED -	STATE OF ILLINOIS DEPARTMENT OF TRANSPORTATION	STAGE 2 DETOUR SIGNING	F.A.I. RTE. 70	SECTION 60-9-I	COUNTY MADISON	TOTAL SHEETS 12	SHEET NO. 8
	PLOT SCALE = #SCALE#	DRAWN -	REVISED -							
	PLOT DATE = #DATE#	CHECKED -	REVISED -		SCALE: SHEET NO. OF SHEETS STA. TO STA.					
		DATE -	REVISED -							
CONTRACT NO. 76007										
FED. ROAD DIST. NO. ILLINOIS FED. AID PROJECT										

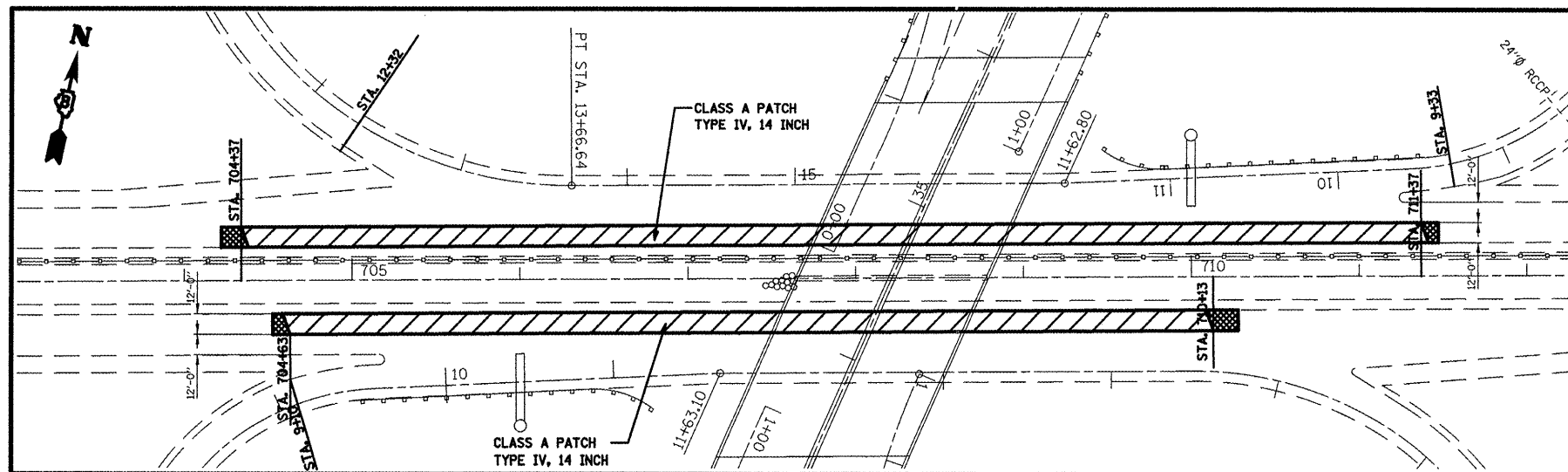
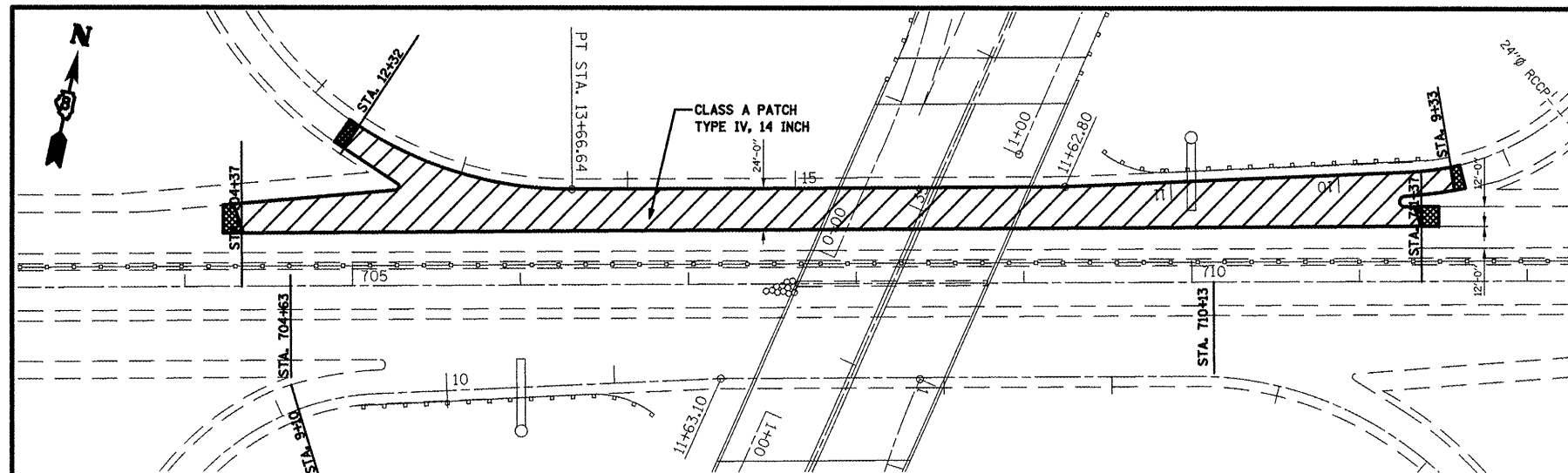
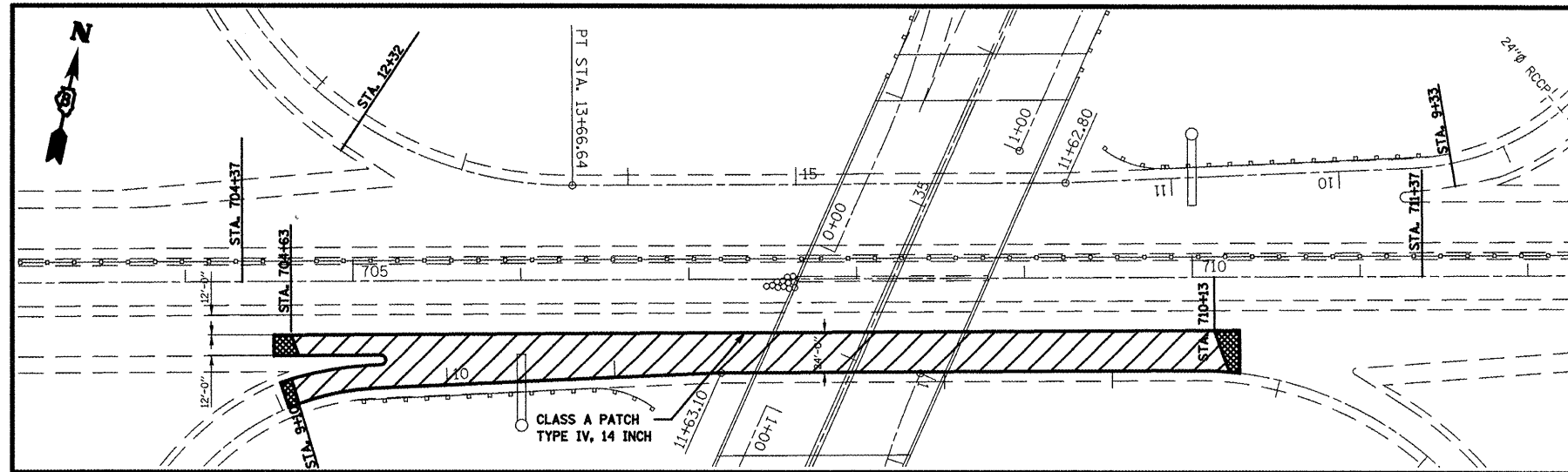

STAGING GENERAL NOTES:

THE CONTRACTOR WILL BE ALLOWED TO SAW CUT THE PAVEMENT FOR EACH STAGE FIVE CALENDAR DAYS PRIOR TO THE START OF STAGE CONSTRUCTION.

THE STAGE CONSTRUCTION SHALL BE ACCOMPLISHED ON THREE SEPARATE WEEKENDS.

STAGE 1 CONSTRUCTION

STAGE 1 GENERAL NOTES

THE CONTRACTOR WILL NOT BE ALLOWED TO CLOSE ANY PORTION OF THE OPEN EB THROUGH TRAFFIC LANE.

THE CONTRACTOR SHALL PROVIDE STAGE I DETOUR SIGNING ACCORDING TO THE DETAILS IN THE PLANS AND PROVISIONS.

CHANGEABLE MESSAGE BOARDS SHALL BE USED TWO WEEKS PRIOR TO THE START OF AND DURING STAGE I CONSTRUCTION.

THE CONTRACTOR SHALL COMPLETE ALL WORK ASSOCIATED WITH STAGE 1 CONSTRUCTION, EXCEPT ITEMS RELATED TO DRAINAGE AND PAVEMENT MARKING, DURING ONE WEEKEND PERIOD (BETWEEN 6:00 PM FRIDAY AND 3:00 PM MONDAY).

PENALTY DURING PEAK HOUR SPECIAL PROVISION SHALL APPLY.

STAGE 2 CONSTRUCTION

STAGE 2 GENERAL NOTES

THE CONTRACTOR WILL NOT BE ALLOWED TO CLOSE ANY PORTION OF THE OPEN WB THROUGH TRAFFIC LANE.

THE CONTRACTOR SHALL PROVIDE STAGE II DETOUR SIGNING ACCORDING TO THE DETAILS IN THE PLANS AND PROVISIONS

CHANGEABLE MESSAGE BOARDS SHALL BE USED TWO WEEKS PRIOR TO THE START OF AND DURING STAGE II CONSTRUCTION.

THE CONTRACTOR SHALL COMPLETE ALL WORK ASSOCIATED WITH STAGE 2 CONSTRUCTION, EXCEPT ITEMS RELATED TO DRAINAGE AND PAVEMENT MARKING, DURING ONE WEEKEND PERIOD (BETWEEN 9:00 AM FRIDAY AND 6:00 AM MONDAY).

PENALTY DURING PEAK HOUR SPECIAL PROVISION SHALL APPLY.

STAGE 3 CONSTRUCTION

STAGE 3 GENERAL NOTES

THE CONTRACTOR WILL NOT BE ALLOWED TO CLOSE ANY PORTION OF THE OPEN EB OR WB THROUGH TRAFFIC LANES.

THE CONTRACTOR WILL NOT BE ALLOWED TO CLOSE ANY PORTION OF THE OPEN AUXILIARY OR RAMP TRAFFIC LANES.

UPON THE ENGINEER'S REQUEST, THE CONTRACTOR MAY BE REQUIRED TO FULL DEPTH SAW CUT THE LONGITUDINAL EDGE OF NEWLY POURED CLASS A PATCH ADJACENT TO STAGE 3 PATCH TO OBTAIN A STRAIGHT EDGE. THE SAW CUT WILL BE COMPLETED AND PAID FOR ACCORDING ARTICLE 442 OF THE STANDARD SPECIFICATIONS.

CHANGEABLE MESSAGE BOARDS SHALL BE USED TWO WEEKS PRIOR TO THE START OF AND DURING STAGE III CONSTRUCTION.

THE CONTRACTOR SHALL COMPLETE ALL WORK ASSOCIATED WITH STAGE 3 CONSTRUCTION, EXCEPT ITEMS RELATED TO DRAINAGE AND PAVEMENT MARKING, DURING ONE WEEKEND PERIOD (BETWEEN 6:00 PM FRIDAY AND 3:00 PM MONDAY FOR EASTBOUND TRAFFIC AND 9:00 AM FRIDAY TO 6:00 AM MONDAY FOR WESTBOUND TRAFFIC).

PENALTY DURING PEAK HOUR SPECIAL PROVISION SHALL APPLY.

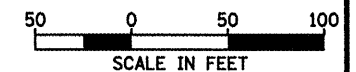

FILE NAME =	USER NAME = challandeske	DESIGNED -	REVISED -	STATE OF ILLINOIS DEPARTMENT OF TRANSPORTATION	STAGING SHEET			F.A.I. RTE.	SECTION	COUNTY	TOTAL SHEETS	SHEET NO.
ct:\pw\work\NPWIDOT\CHALLANDESKE\d013407	d876d07-sht-plan.dgn	DRAWN -	REVISED -		70	60-9-I	MADISON	12	9			
	PLOT SCALE = 100.0000' / IN.	CHECKED -	REVISED -		CONTRACT NO. 76007							
	PLOT DATE = 5/14/2009	DATE	REVISED -		FED. ROAD DIST. NO.	ILLINOIS FED. AID PROJECT						

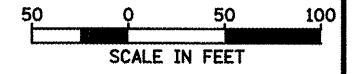
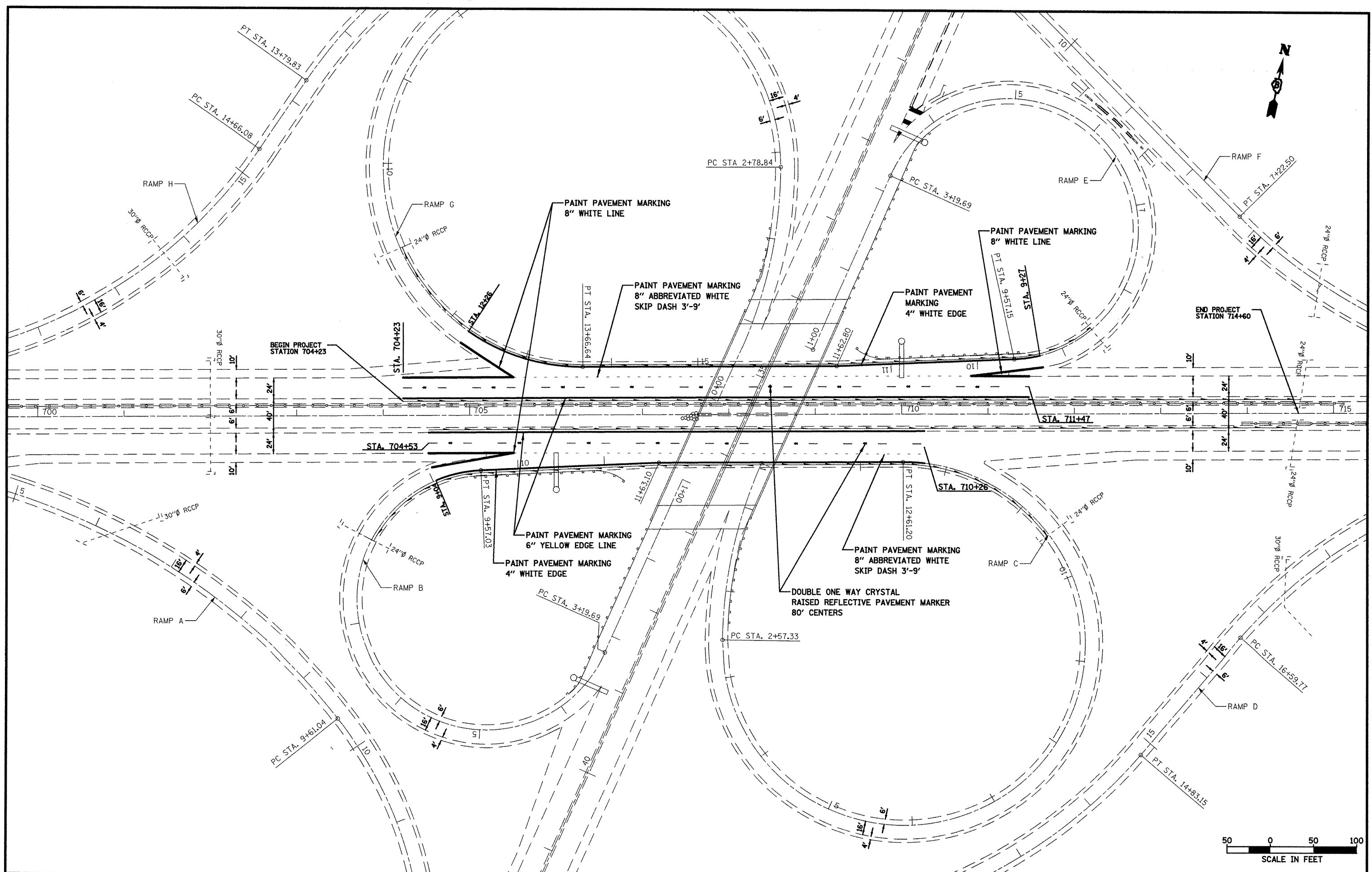

FILE NAME = *FILEL*	USER NAME = *USER*	DESIGNED -	REVISED -	STATE OF ILLINOIS DEPARTMENT OF TRANSPORTATION	PAVEMENT MARKING			F.A.I. RTE.	SECTION	COUNTY	TOTAL SHEETS	SHEET NO.		
		DRAWN -	REVISED -					TO	60-9-I	MADISON	12	11		
		CHECKED -	REVISED -					CONTRACT NO. 76007						
		DATE -	REVISED -					SCALE:	SHEET NO.	OF SHEETS	STA.	TO STA.	FED. ROAD DIST. NO.	ILLINOIS FED. AID PROJECT

EXPANSION JOINT SPECIAL NOTES

ALL EXCAVATION AND PAVEMENT REMOVAL REQUIRED FOR THE CONSTRUCTION OF THIS ITEM SHALL BE INCLUDED IN THE COST FOR EXPANSION JOINT (SPECIAL). SAW CUTS SHALL BE PAID FOR SEPARATELY.

UPON THE ENGINEER'S APPROVAL OF THE CONSTRUCTION AND INSTALLATION METHOD, A PRECAST APPROACH FOOTING CAN BE USED IN LIEU OF THE CAST-IN PLACE FOOTING. THE WIDTH OF THE PRECAST FOOTING SHALL NOT BE LESS THAN 6 FOOT.

UPON THE ENGINEER'S APPROVAL, A PAINTED STEEL PLATE WITH EQUAL OR GREAT SHEAR STRENGTH AS THE CAST-IN-PLACE FOOTING CAN BE USED IN LIEU OF THE CAST-IN-PLACE FOOTING. THE WIDTH OF THE PAINTED STEEL PLATE SHALL NOT BE LESS THAN 6 FOOT AND THE TOP SHALL BE COATED WITH A LUBRICANT PRIOR TO POURING CONCRETE ABOVE THE PLATE. THIS WORK SHALL BE APPROVED BY THE ENGINEER PRIOR TO CONSTRUCTION AND INSTALLATION.

IF THE PAINTED STEEL PLATE IS APPROVED, THE DEPTH OF THE AGGREGATE BASE COURSE TYPE A BELOW THE PLATE AND SHALL BE INCREASED TO 12 INCHES AND SHALL BE PAID FOR AS SUCH.

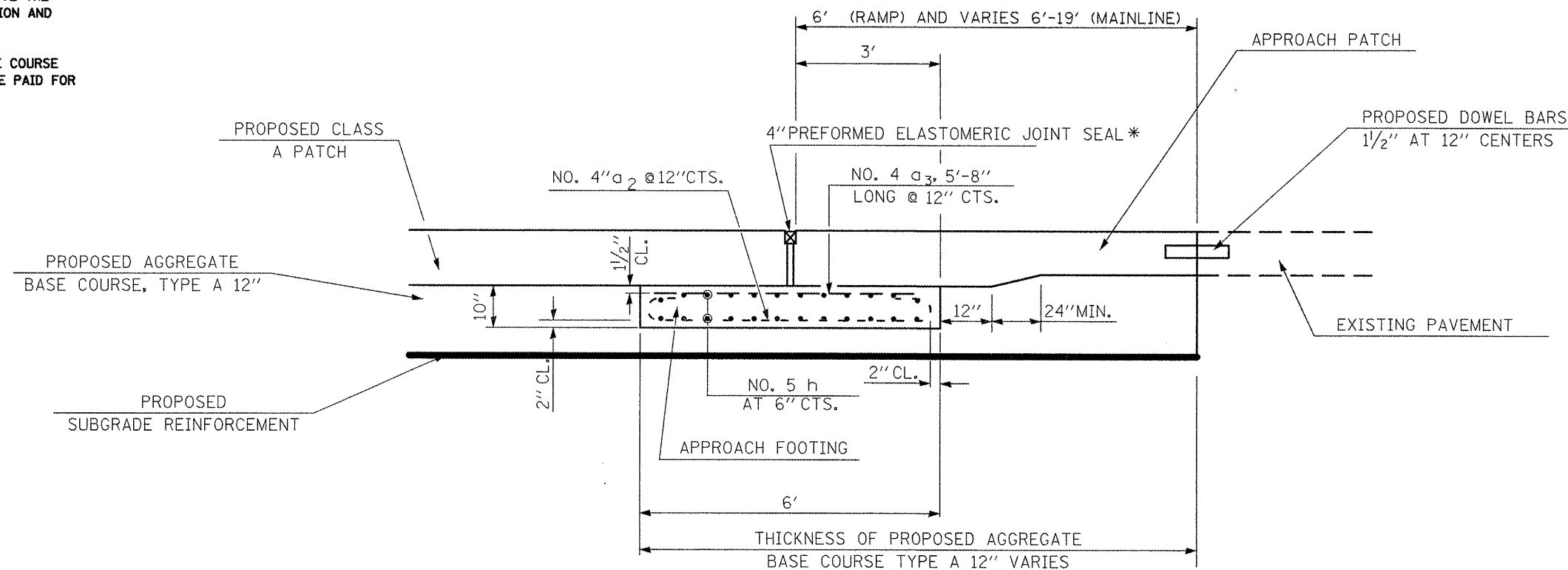
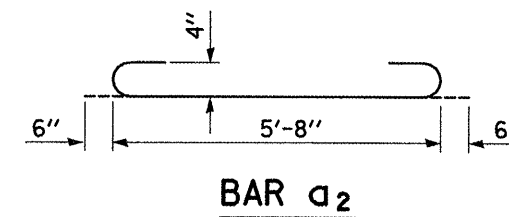

EXPANSION JOINT (SPECIAL) DETAIL

* 20° SKEW FOR MAINLINE PERPENDICULAR FOR RAMPS

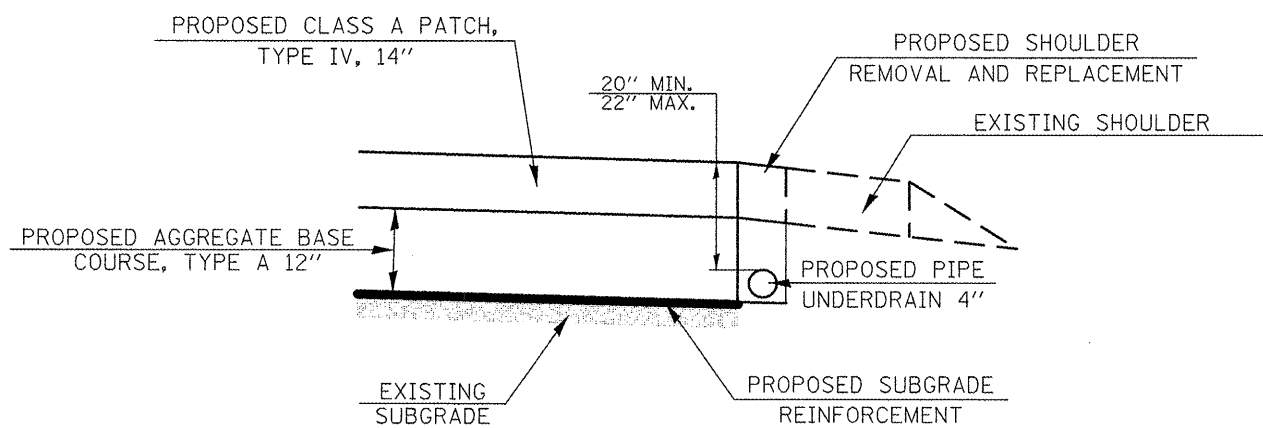

DETAIL I-55/70 @ IL 159

FILE NAME =	USER NAME = #USER#	DESIGNED -	REVISED -	STATE OF ILLINOIS DEPARTMENT OF TRANSPORTATION	DETAIL SHEET			F.A.I. RTE. 70	SECTION 60-9-1	COUNTY MADISON	TOTAL SHEETS 12	SHEET NO. 12
#FILEL#	PLOT SCALE = #SCALE#	DRAWN -	REVISED -		SCALE:	SHEET NO.	OF	SHEETS	STA.	TO STA.	CONTRACT NO. 76007	
	PLOT DATE = #DATE#	CHECKED -	REVISED -								FED. ROAD DIST. NO. ILLINOIS FED. AID PROJECT	
		DATE -	REVISED -									