

STREET LIGHTING LEGEND

LIGHTING CONTROLLER	
JUNCTION BOX STAINLESS STEEL, EMBEDDED IN STRUCTURE, 12" X 10" X 6" (SEE STRUCTURAL PLANS)	
HANDHOLE	
POLE, LIGHT TYPE 1 WITH LUMINAIRE, TYPE 1 (INSTALL ONLY)	
POLE, LIGHT TYPE 2 WITH LUMINAIRE, TYPE 2 (INSTALL ONLY)	
POLE, COMBINATION (SEE TRAFFIC SIGNAL PLANS) WITH LUMINAIRE, TYPE 2 (INSTALL ONLY)	
ELECTRIC CABLE	E
CONDUIT PUSHED	P
CONDUIT TRENCHED	T
CONDUIT SPECIAL APPLICATION	S
CONDUIT IN PARAPET (SEE STRUCTURAL PLANS)	PA

NOTES:

- HANDHOLES TO BE INSTALLED IN MOMENT SLAB WILL BE COMPOSITE CONCRETE HANDHOLES
- INSTALLATION OF HANDHOLES AND JUNCTION BOXES IN MOMENT SLAB AND PARAPET WALL IS INCLUDED IN COST OF THE INDIVIDUAL ITEMS. NO ADDITIONAL COMPENSATION WILL BE ALLOWED
- CONTRACTOR SHALL COORDINATE WITH LIGHTING CONTROLLER MANUFACTURER TO ENSURE CONTROLLER SUPPLIED MATCHES THE EXISTING SERVICE
- CONDUIT FOR ELECTRIC SERVICE SHALL BE RIGID GALVANIZED STEEL
- REFER TO STRUCTURAL PLANS FOR CONDUIT IN PARAPET DETAILS
- SPECIAL CONDUIT INSTALLATION INVOLVES RUNNING CONDUIT FROM A JUNCTION BOX, VERTICALLY BEHIND THE RETAINING WALL, TO A HANDHOLE IN THE GROUND BELOW. THIS WORK SHALL BE PAID FOR AS "CONDUIT BEHIND RETAINING WALL, 1X2", GALVANIZED STEEL"
- REFER TO GENERAL NOTES SHEET FOR ADDITIONAL NOTES

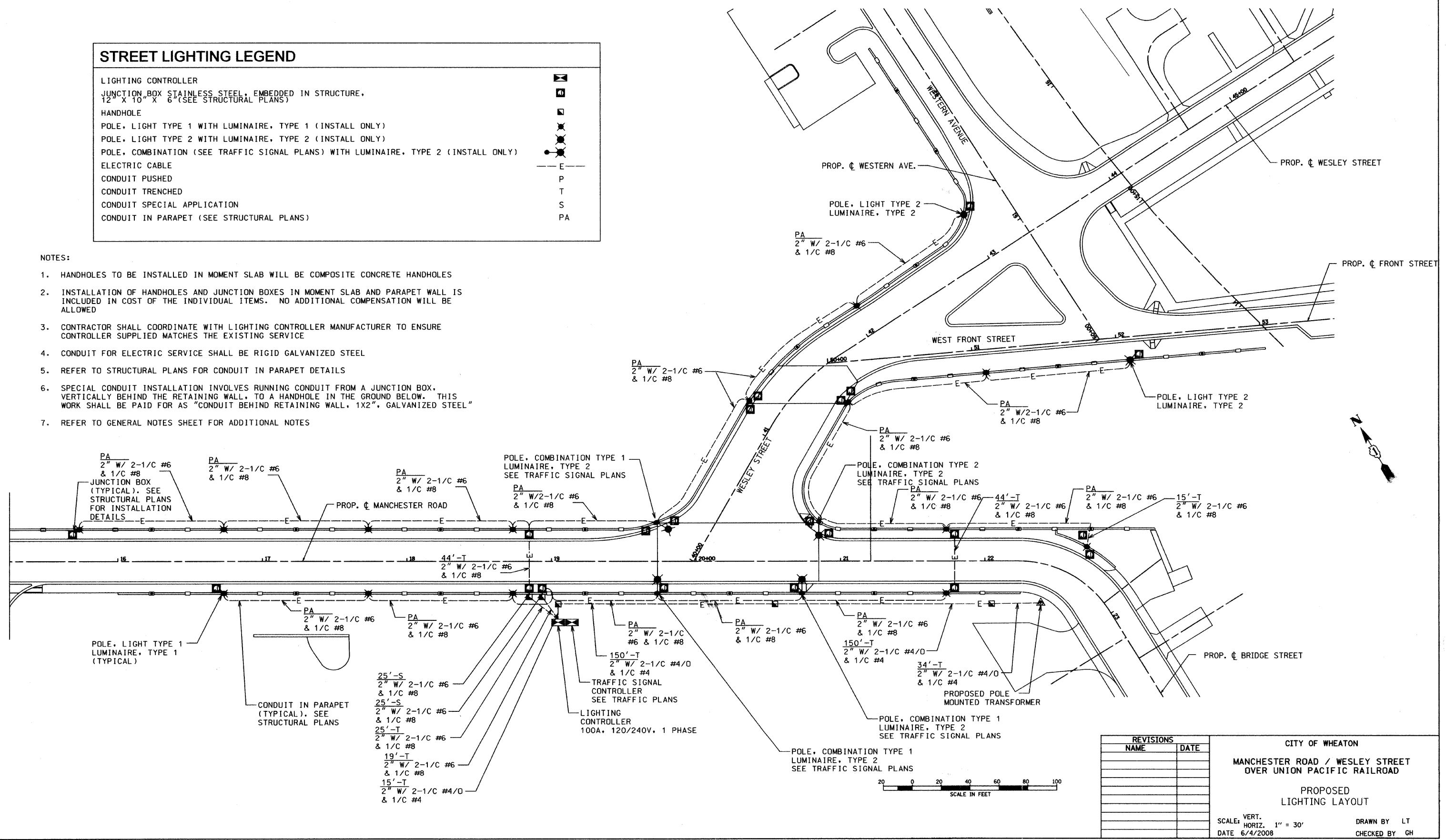

REVISIONS	
NAME	DATE

CITY OF WHEATON
**MANCHESTER ROAD / WESLEY STREET
OVER UNION PACIFIC RAILROAD**
**PROPOSED
LIGHTING LAYOUT**
SCALE: VERT. 1" = 30'
HORIZ. 1" = 30'
DATE: 6/4/2008
DRAWN BY: LT
CHECKED BY: GH

