

Location	Dim. "A"	Size	Floor Beam Length	New ST 4 x 4 Col. Height
S. Abut.	* 0"	W6x20	11'-10"	N/A
FB1	7 7/8"	2-L6x4x1/2	13'-0"	N/A
FB2	11 1/2"	W8x18	13'-0"	N/A
FB3	1'-5 1/8"	W8x18	13'-0"	4 1/8"
FB4	1'-10 5/8"	W8x18	13'-0"	9 5/8"
FB5	2'-4 1/8"	W8x18	13'-0"	1'-3 1/8"
FB6	2'-9 3/4"	W8x18	13'-0"	1'-8 3/4"
FB7	3'-5 1/4"	W8x18	13'-0"	2'-4 1/4"
FB8	3'-11 3/8"	W8x18	13'-0"	2'-10 3/8"
FB9	4'-5 1/2"	W8x18	13'-0"	3'-4 1/2"
FB10	4'-11 5/8"	W8x18	13'-0"	3'-10 5/8"
FB11	5'-5 7/8"	W8x18	13'-0"	4'-4 3/4"
FB12	6'-0"	W8x18	13'-0"	4'-11"
FB13	6'-6 1/8"	W8x18	13'-0"	5'-5 1/8"
FB14	6'-10 3/4"	W8x18	13'-10"	1'-9"

Note
 Dim. "A" = Distance From T/ Exist. Floor Beam to T/ Prop. Deck
 * Distance T/ Exist. Backwall to T/ Prop. Backwall

- NOTES:**
- All new steel shall be painted within 15' - 0" of each deck joint in accordance with the Special Provisions.
 - Timber planks shall be treated Southern Pine No. 2 Commercial Grade with $F_b \geq 975$ psi, or other species as approved by the Engineer.
 - For Details 1 thru 4 see Sht. IPP-7.

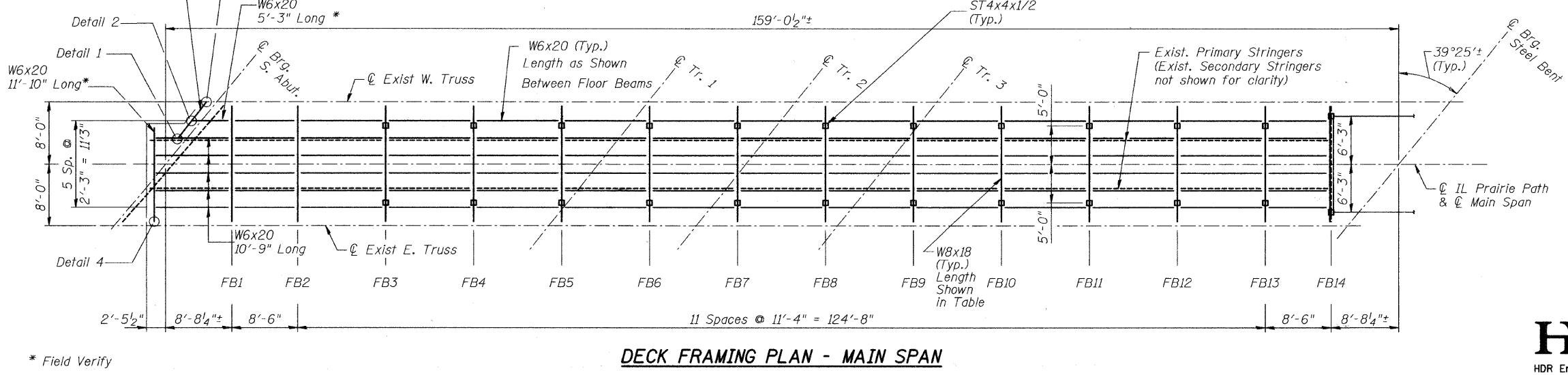
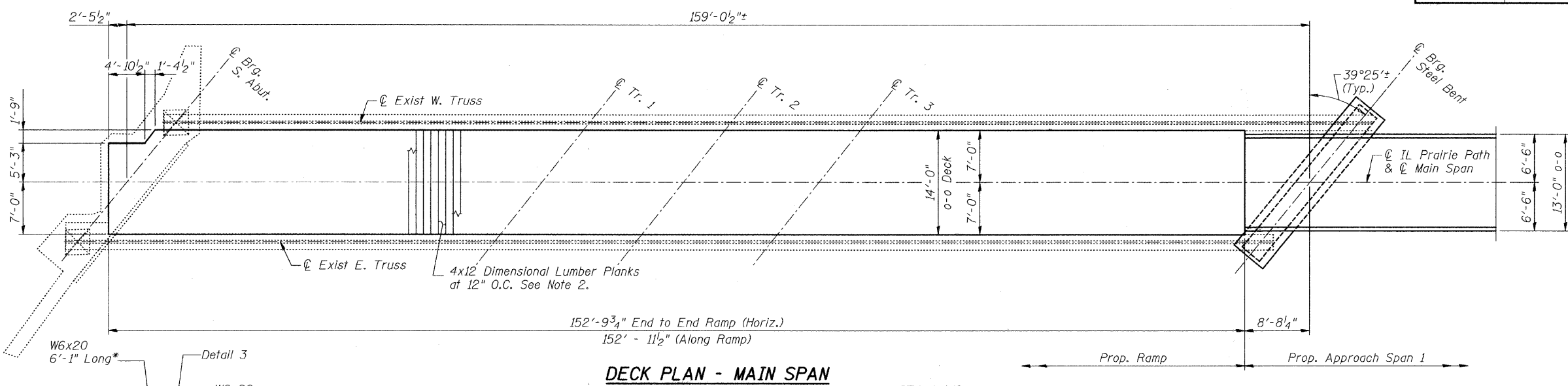

* Field Verify

CITY OF WHEATON		
ILLINOIS PRAIRIE PATH BRIDGE OVER UNION PACIFIC RAILROAD, FRONT STREET AND WESLEY STREET		
MAIN SPAN PROPOSED MODIFICATIONS		
DRAWN	JM/PES/TV	SHEET NO.
CHECKED	VEVS	IPP-6
APPROVED	BSK	
DATE	06/04/2008	
SCALE	NONE	

