

**STATE OF ILLINOIS
DEPARTMENT OF TRANSPORTATION
PLANS FOR PROPOSED LOCAL AGENCY IMPROVEMENT
FEDERAL-AID PROJECT**

FAU 9888/ CH 52 (WILLOWBROOK ROAD)
SECTION 04-00383-00-WR
PROJECT NO. ARA-5099(093)
JOB NO. C-92-170-09
CONTRACT NO. 85472



INDEX OF SHEETS

SHEET NO. SHEET NAME

- 1. COVER SHEET
- 2. GENERAL NOTES
- 3. SUMMARY OF QUANTITIES
- 4. SCHEDULE OF QUANTITIES
- 5. TYPICAL SECTIONS & DETAILS
- 6-8. PLAN SHEETS

STANDARDS

- 406201-01 MAILBOX TURNOUT
- 701001-02 OFF-RD OPERATIONS 2L, 2W,
MORE THAN 15' AWAY
- 701006-03 OFF-RD OPERATIONS 2L, 2W 4.5M (15') TO
PAVEMENT EDGE FOR SPEEDS \geq 45 MPH
- 701101-02 OFF-RD OPERATIONS 2L, 2W, 15' TO 24'
FROM PAVEMENT EDGE
- 701201-03 LANE CLOSURE, 2L, 2W, DAY ONLY FOR
SPEEDS \geq 45 MPH
- 701301-03 LANE CLOSURE, 2L, 2W, SHORT TIME
OPERATIONS
- 701306-02 LANE CLOSURE, 2L, 2W, SLOW MOVING
OPERATIONS DAY ONLY, FOR SPEEDS \geq 45 MPH
- 701311-03 LANE CLOSURE, 2L, 2W, MOVING
OPERATIONS - DAY ONLY
- 701326-03 LANE CLOSURE, 2L, 2W, PAVEMENT
WIDENING FOR SPEEDS \geq 45 MPH
- 701901-01 TRAFFIC CONTROL DEVICES
- 720011-01 METAL POSTS FOR SIGNS,
MARKERS & DELINEATORS
- 728001-01 TELESCOPING STEEL SIGN SUPPORT
- 780001-02 TYPICAL PAVEMENT MARKINGS
- 729001-01 APPLICATIONS OF TYPES A&B METAL POSTS
(FOR SIGNS & MARKERS)

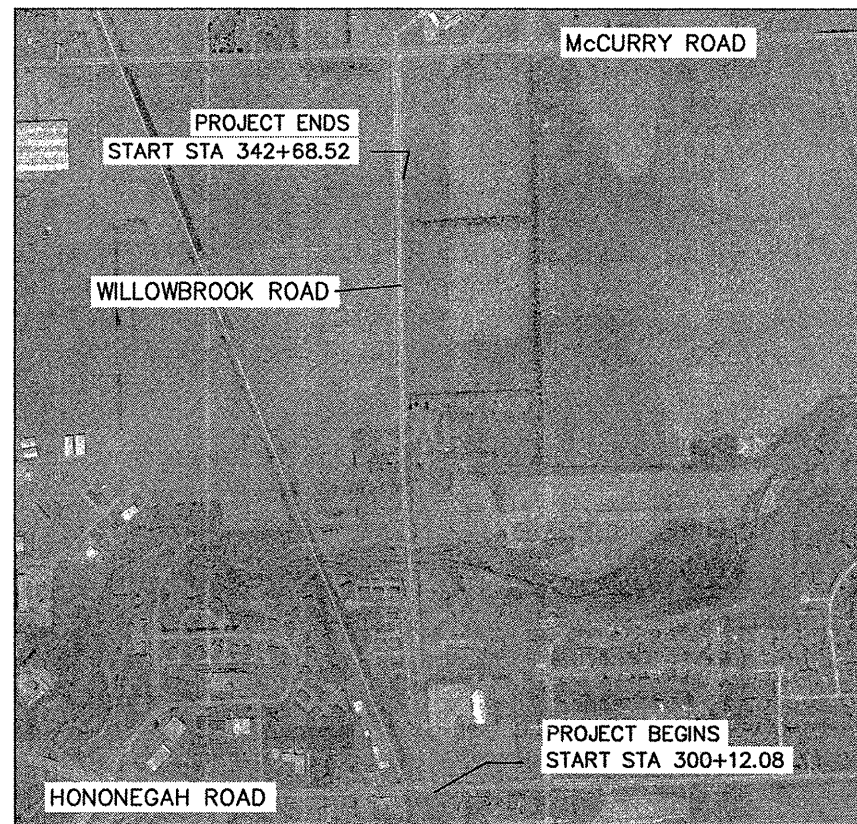

PROJECT LOCATION

WILLOWBROOK ROAD:
NET LENGTH: 4268.5 FT (0.80 MILES)
ADT : 3,100 (2009) TRUCK: 2%
RURAL COLLECTOR
45 MPH DESIGN SPEED

CALL J.U.L.I.E.
BEFORE YOU DIG
1-800-892-0123
T.46 N. - R.2 E.
SEC. 28

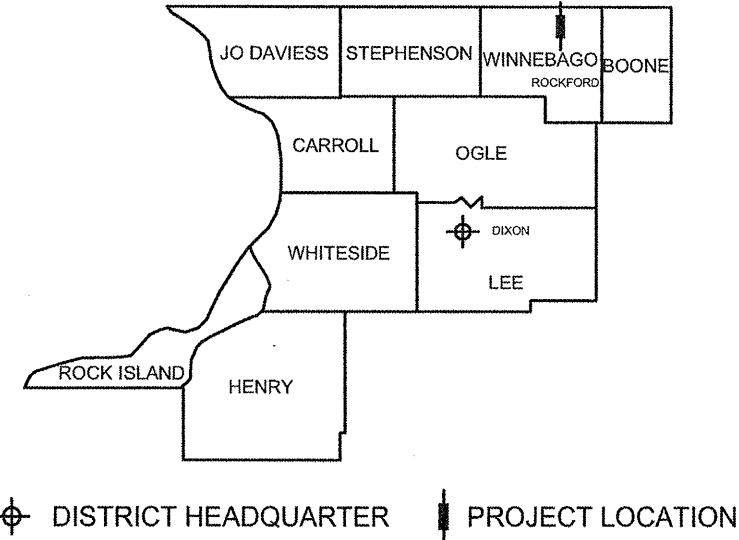

**STATE OF ILLINOIS
DEPARTMENT OF TRANSPORTATION
DIVISION OF HIGHWAYS**

APPROVED 5/14/2009
[Signature]
WINNEBAGO COUNTY ENGINEER

PASSED **MAY 29 2009** 20
[Signature]
DISTRICT 2 ENGINEER OF LOCAL ROADS & STREETS

RELEASING FOR BID
BASED ON LIMITED
REVIEW **MAY 29 2009** 20
[Signature]
DEPUTY DIRECTOR OF HIGHWAYS REGION 2 ENGINEER



GENERAL NOTES

GENERAL NOTES AND CONDITIONS

All earthwork, grading and paving shall be performed in accordance with the "Standard Specifications for Road and Bridge Construction, State of Illinois Department of Transportation, adopted January 1, 2007"; the "Supplemental Specifications and Recurring Special Provisions" (current addition), and all revisions and supplements thereto, and the requirements and specifications of the County of Winnebago.

DISCRIPTION OF WORK

UTILITIES

Exact horizontal and vertical locations of existing utilities shall be determined by the Contractor at no additional cost to the contract. Locations and depths shown on these plans are only schematic representation.

The Contractor shall be responsible for protecting utility property during construction operations as outlined in Article 107.31 of the Standard Specifications. The phone number for J.U.L.I.E. is 800-892-0123. The utilities located within the project limits or immediately adjacent to the project construction limits are members of J.U.L.I.E.

Commonwealth Edison
123 Energy Ave.
Rockford, IL 61109
Phone - (815) 490-2869

Nicor Gas
300 W. Terra Cotta
Crystal Lake, IL 60014
Phone - (815) 455-0271

South Beloit Sewer
R.H. Batterman & Co., Inc.
2857 Bartells Dr,
Beloit, WI. 53511
Phone - (815) 387-7660

SBC
301 E. Milwaukee St.
Janesville, WI. 53545
Phone - (608) 5589

North Park Water District
1350 Turret Drive
Machesney Park, IL. 61115
Phone - (815) 633-5461

Charter Communication
1348 Plainfield Ave.
Janesville, WI
Phone - (608) 373-7537

Abandoned underground utilities that conflict with construction or have the potential for creating future problems shall be disposed of outside the limits of the right-of-way according to Article 202.03 of the standard specifications and as directed by the Engineer.

The Contractor is responsible for maintaining positive drainage at the conclusion of each working day.

All private entrances and side road approaches shall be bladed and rolled, as directed by the Engineer, prior to placing Hot Mix Asphalt. This work shall not be paid for separately but shall be considered incidental to INCIDENTAL HMA SURFACING. As provided in the plan quantities and shall be used only as needed and as directed by the Engineer.

HOT-MIX ASPHALT

The following Mixture requirements are applicable for this project:

MIXTURE USE(S):	SURFACE	BINDER
PG:	PG 64-22	PG 64-22
DESIGN AIR VOIDS:	4.0 @ N70	4.0 @ N70
MIXTURE COMPOSITION (GRADATION MIXTURE):	IL 9.5 or 12.5	IL 19.0
FRICTION AGGREGATE:	N	N/A
20 YEAR ESAL:	0.7	0.7
MIX UNIT WEIGHT	112 lbs/sy/in	

SHORT TERM PAVEMENT MARKING

Striping removal shall be incidental to SHORT TERM PAVEMENT MARKING. This work will not be paid for separately and shall be considered incidental to the contract and no additional compensation shall be allowed.

ROUTE
63SECTION
04-00383-00-WRSHEET
03 OF 08

SUMMARY OF QUANTITIES

CONSTRUCTION TYPE CODE: I 000

SUMMARY OF QUANTITIES

Item No	Item	Unit	QTY
40600200	BITUMINOUS MATERIALS (PRIME COAT)	TON	7.00
40600625	LEVELING BINDER (MACHINE METHOD), N70	TON	1,067.00
40603340	HOT-MIX ASPHALT SURFACE COURSE, MIX "D", N70	TON	1,524.00
40800050	INCIDENTAL HOT-MIX ASPHALT SURFACING	TON	33.00
48101200	AGGREGATE SHOULDERS, TYPE B	TON	1,258.00
58100200	WATERPROOFING MEMBRANE SYSTEM	SQ YD	300.00
67100100	MOBILIZATION	L SUM	1.00
70101700	TRAFFIC CONTROL AND PROTECTION	L SUM	1.00
70300100	SHORT-TERM PAVEMENT MARKING	FOOT	776.00
* 78000400	THERMOPLASTIC PAVEMENT MARKING - LINE 6"	FOOT	11,764.00
Z0011500	COLD MILLING EXISTING SURFACE	SQ YD	1,143.00

* SPECIALTY ITEMS

ROUTE
63SECTION
04-00383-00-WRSHEET
04 OF 08

SCHEDULE OF QUANTITIES

BITUMINOUS MATERIALS (PRIME COAT) (TON)	
Willowbrook Road	7.00
TOTAL	7.00
LEVELING BINDER (MACHINE METHOD), N70, 3/4" (TON)	
Willowbrook Road	1,067.00
TOTAL	1,067.00
HMA SURFACE COURSE, MIX "D", N70, 2 1/2" (TON)	
Willowbrook Road	1,524.00
TOTAL	1,524.00
INCIDENTAL HOT-MIX ASPHALT SURFACING, 3" (TON)	
STA 323+72, LT	11.00
STA 324+91, RT	11.00
STA 326+86, RT	11.00
TOTAL	33.00
AGGREGATE SHOULDERS TYPE B (TON)	
Willowbrook Road	1,258.00
TOTAL	1,258.00
WATERPROOFING MEMBRANE SYSTEM (SQ. YD.)	
STA 315+77 TO 316+68	300.00
TOTAL	300.00
SHORT TERM PAVEMENT MARKING (FEET)	
6" YELLOW	776.00
TOTAL	776.00
THERMOPLASTIC PAVEMENT MARKING LINE 6" (FEET)	
6" WHITE	7,128.00
6" YELLOW	4,636.00
TOTAL	11,764.00
COLD MILLING EXISTING SURFACE (SQ. YD.)	
Willowbrook Road	244.00
Bridge (315+46 TO 316+98)	372.00
Entrances, RT & LT	527.00
TOTAL	1,143.00

SCHEDULE OF QUANTITIES

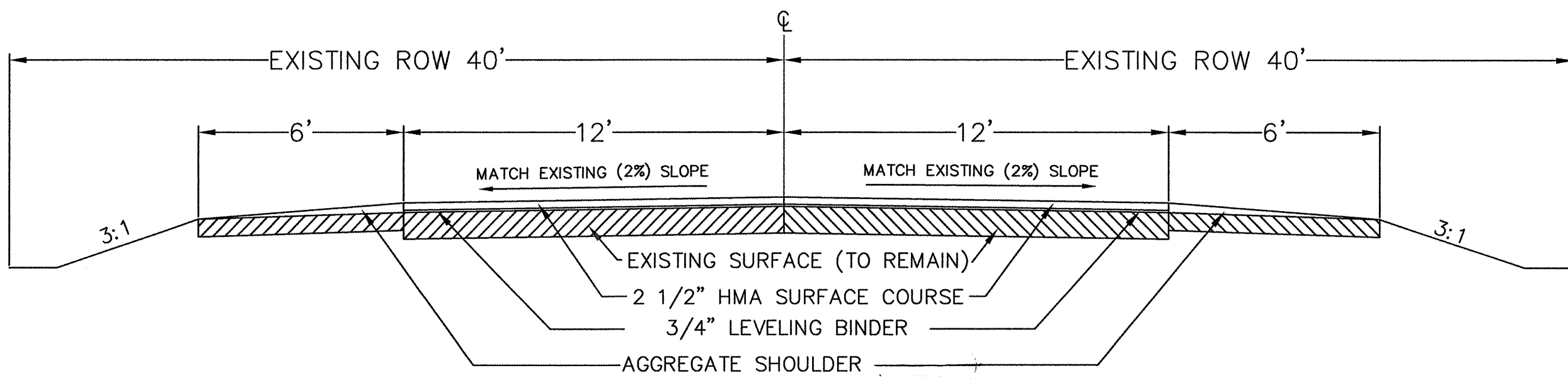

SECTION 06-00383-00-RS
COUNTY HIGHWAY 52 (WILLOWBROOK ROAD)
STA. 300+00 TO STA. 342+67

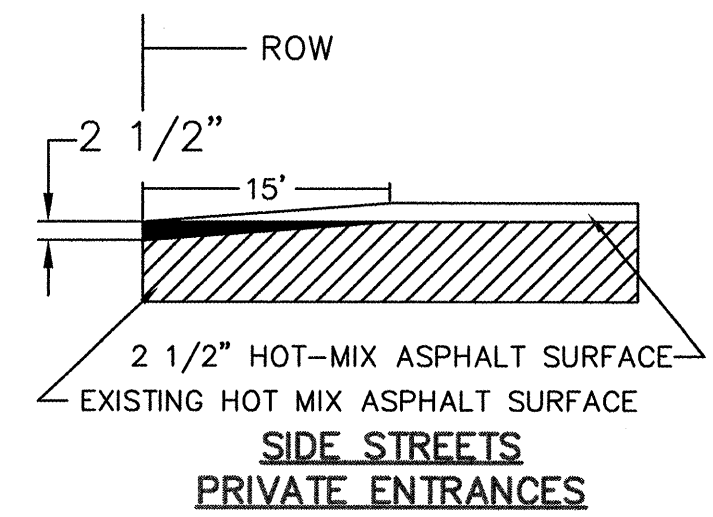
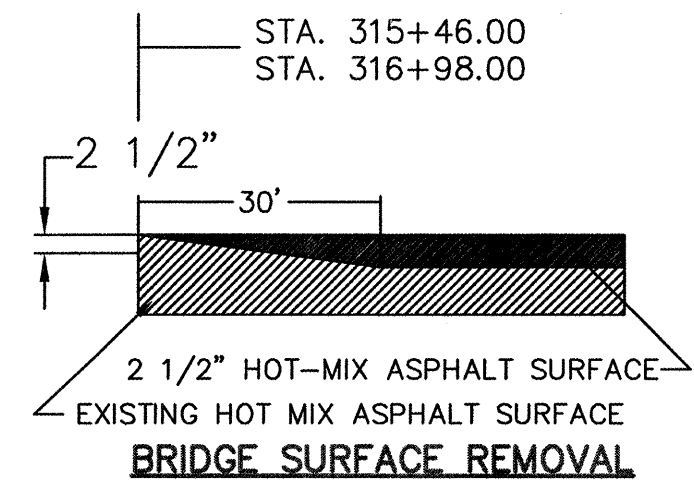
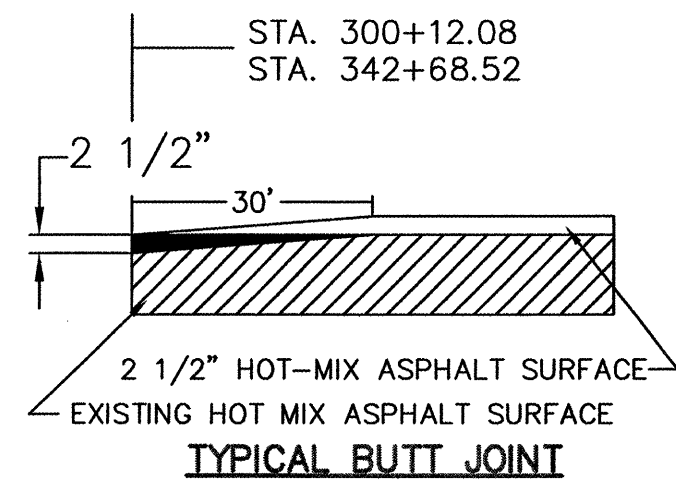

NOT TO SCALE



ROUTE 52 SECTION 06-00383-00-RS SHEET 06 OF 08
WILLOWBROOK RD, STA 330+00-STA 318+00

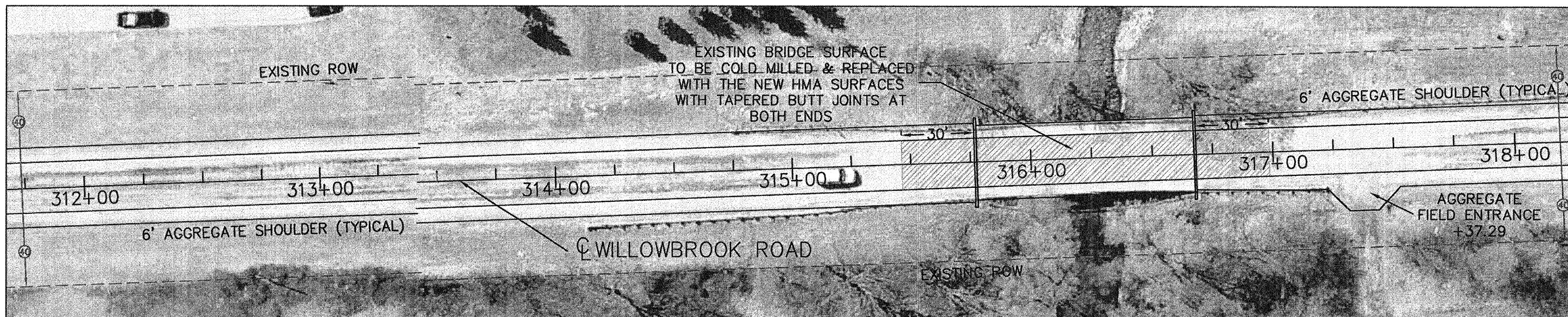
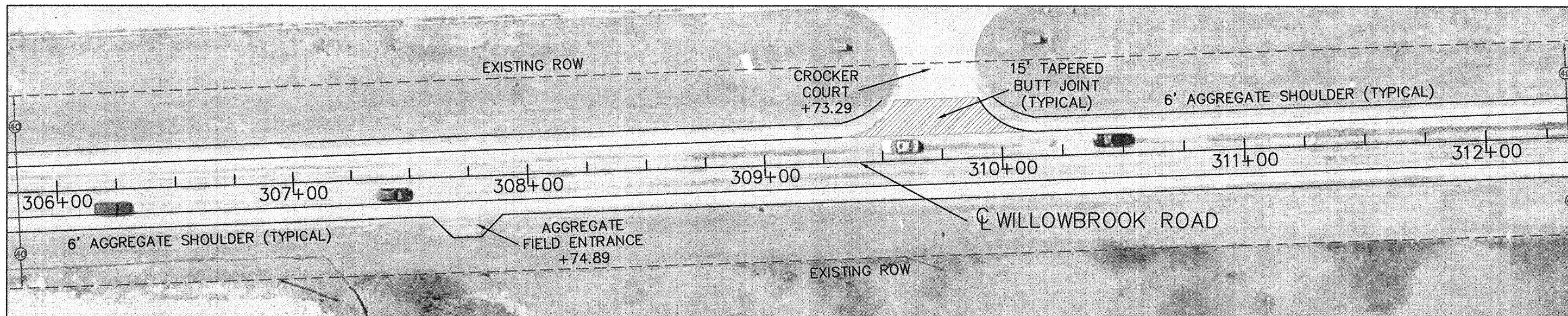
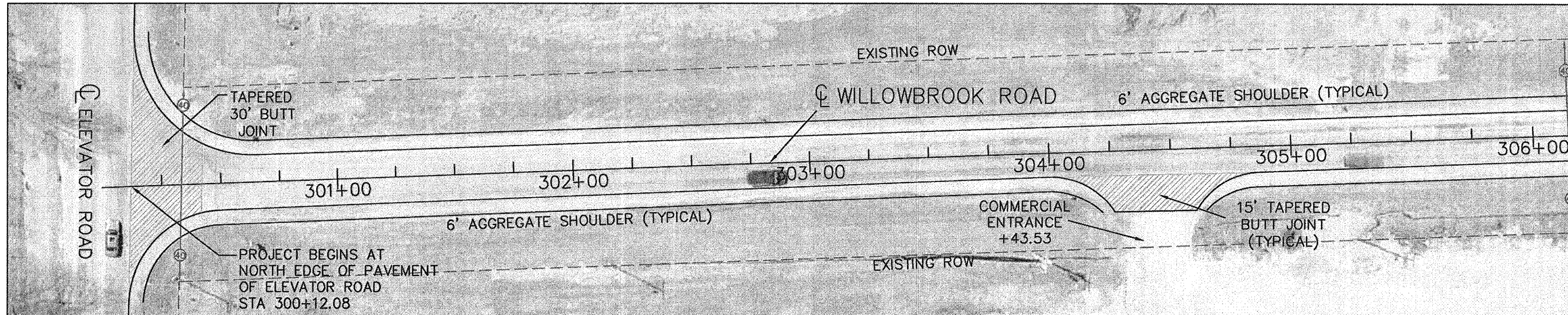

WILLOWBROOK ROAD

NOT TO SCALE

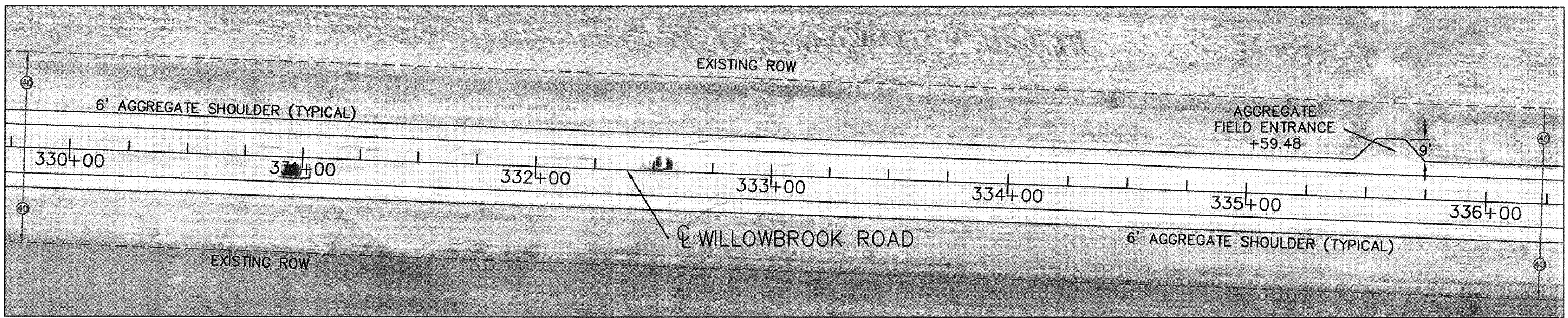
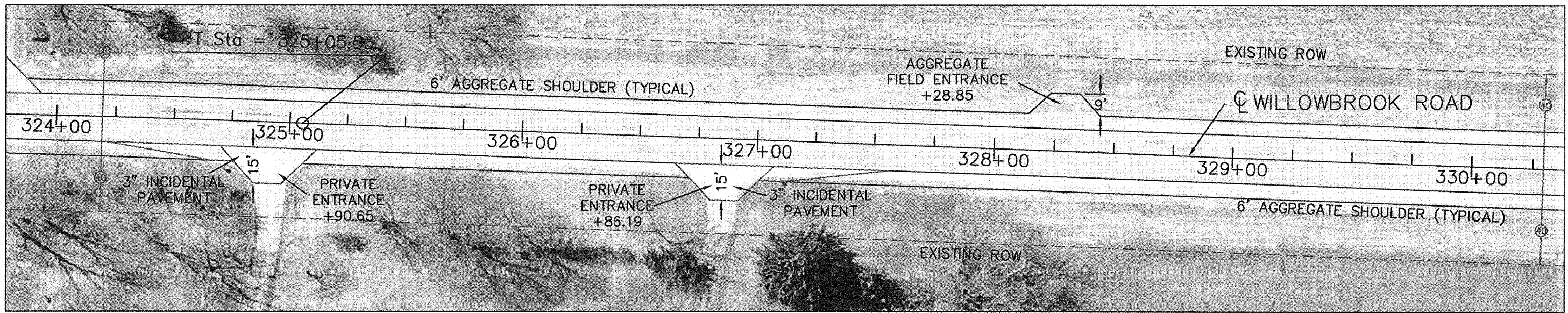
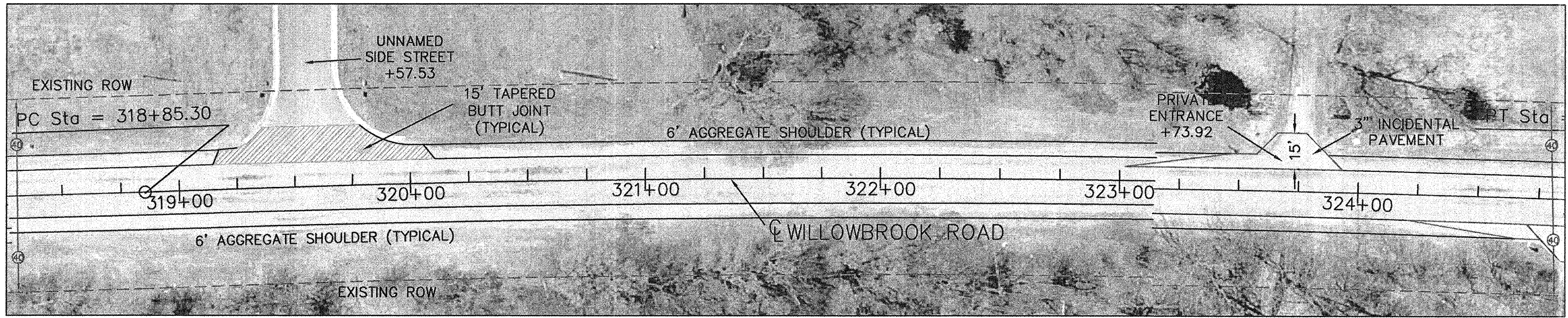

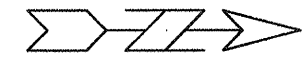

NOT TO SCALE

