

F.A.U. RTE.	SECTION	COUNTY	TOTAL SHEETS	SHEET NO.
6141	09-00092-00-PV	LASALLE	36	7
STA. 1+85.00		TO STA. 39+80.00		
FED. ROAD DIST. NO. 3		ILLINOIS FED. AID PROJECT		

**LEGEND**

 = STAGE 1 (HOT PATCH AREAS)

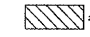
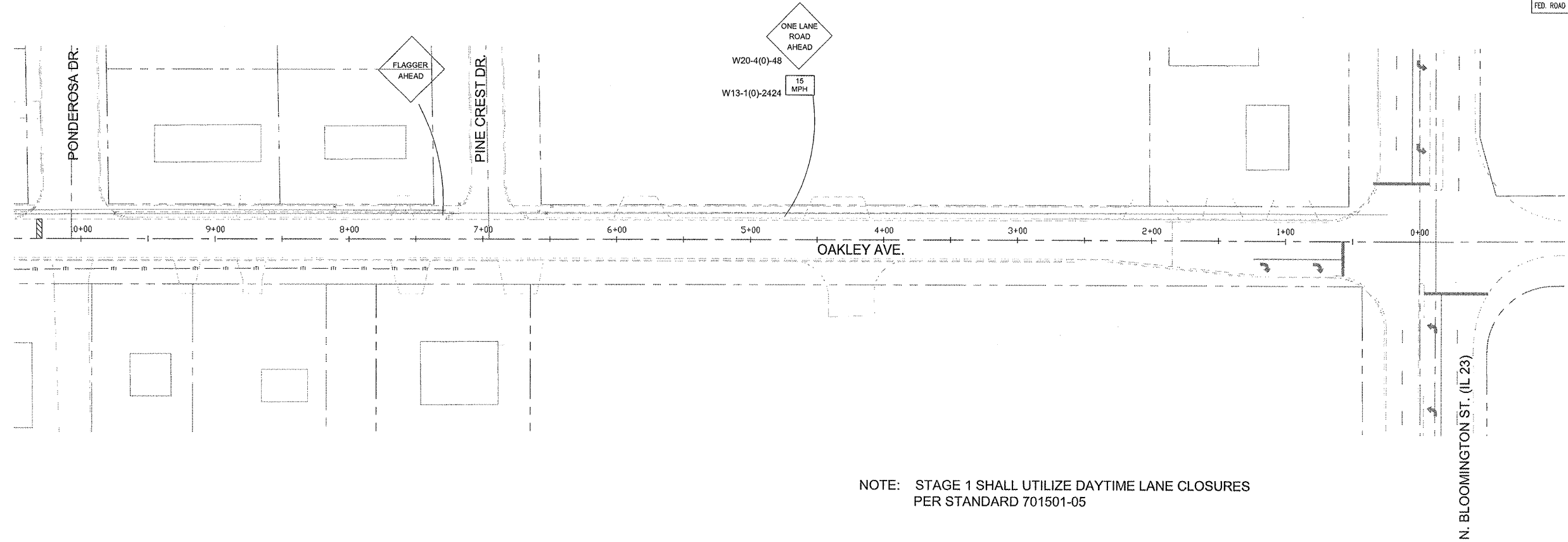

NOTE: STAGE 1 SHALL UTILIZE DAYTIME LANE CLOSURES PER STANDARD 701501-05

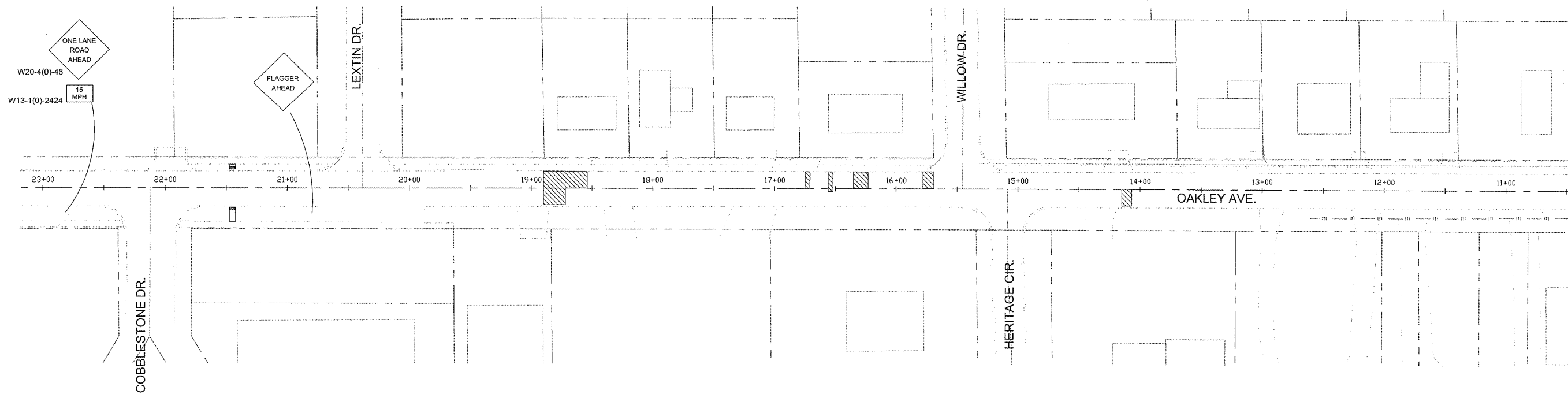

**FINAL**

SCALE: 1" = 20'

DESIGNED - JEP	REVISED -
DRAWN - JCL	REVISED -
CHECKED - JEP	REVISED -
DATE - 4/10/09	REVISED -

STATE OF ILLINOIS  
DEPARTMENT OF TRANSPORTATION

**STAGING PLAN - STAGE 1**