

CONTRACT NO. 87427			
F.A.U. RTE.	SECTION	COUNTY	TOTAL SHEETS
6141	09-00092-00-PV	LASALLE	36
STA. 1+85		TO STA. 39+80	
FED. ROAD DIST. NO. 3		ILLINOIS ARRA PROJECT	

- LEGEND**
- = STAGE 4 CONSTRUCTION
  - = TYPE III. BARRICADE R11-4 WITH FLASHING LIGHTS AND SIGNS
  - = STAGE 4A CONSTRUCTION
  - = DRUM WITH STEADY BURN LIGHT
  - = TEMPORARY SIGNAL
  - = TEMPORARY PAVEMENT MARKINGS (4")

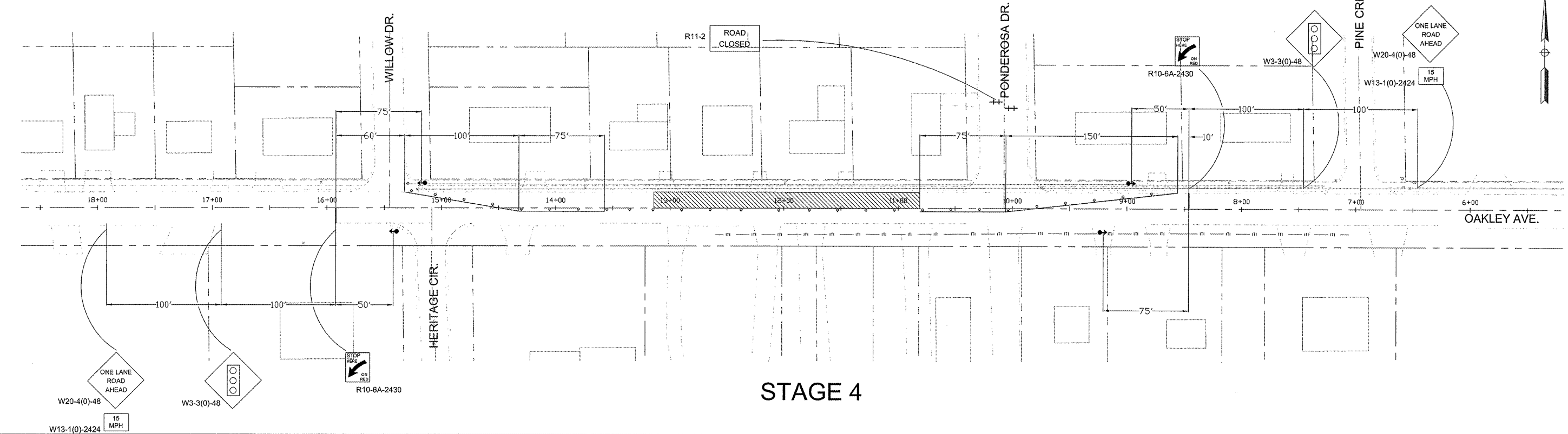

**STAGE 4**

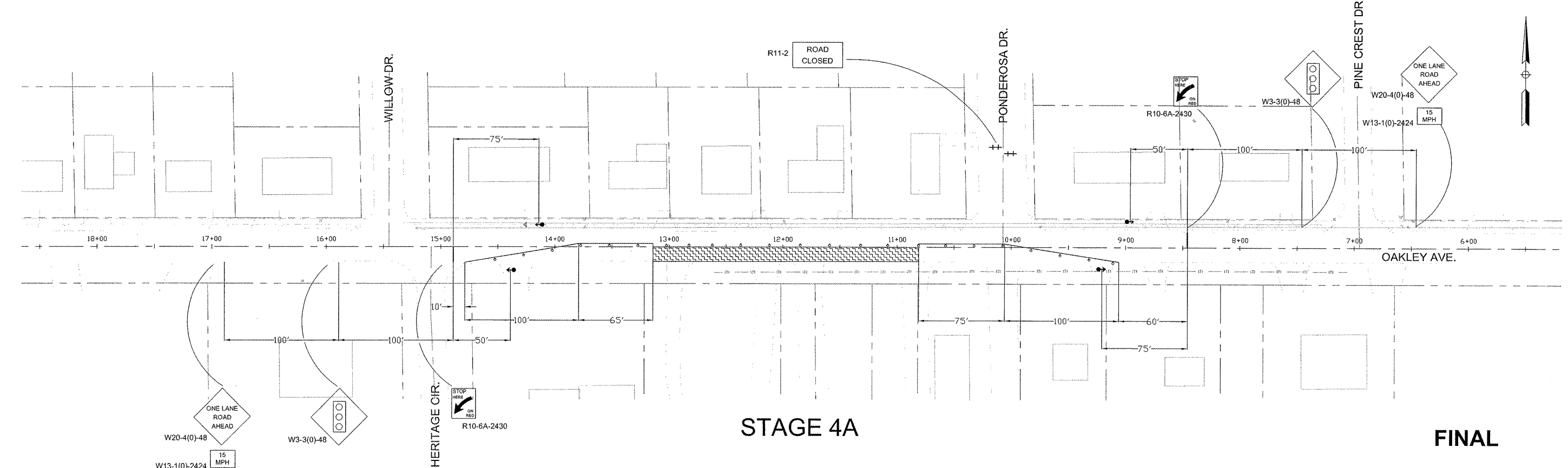

**STAGE 4A**

**FINAL**

SCALE: 1" = 40'

DESIGNED - JEP	REVISED -
DRAWN - JCL	REVISED -
CHECKED - JEP	REVISED -
DATE - 4/10/09	REVISED -

STATE OF ILLINOIS  
DEPARTMENT OF TRANSPORTATION

**TRAFFIC CONTROL PLAN - STAGE 4**