

| | | | | |
|--------------------------------|---------|---------------|-----------|--|
| CONTRACT NO. 87427 | | | | |
| F.A.U. SECTION | COUNTY | TOTAL SHEETS | SHEET NO. | |
| 6141 09-00092-00-PV | LASALLE | 36 | 23 | |
| STA. 1+85 | | TO STA. 39+80 | | |
| FED. ROAD DIST. NO. 3 ILLINOIS | | ARRA PROJECT | | |

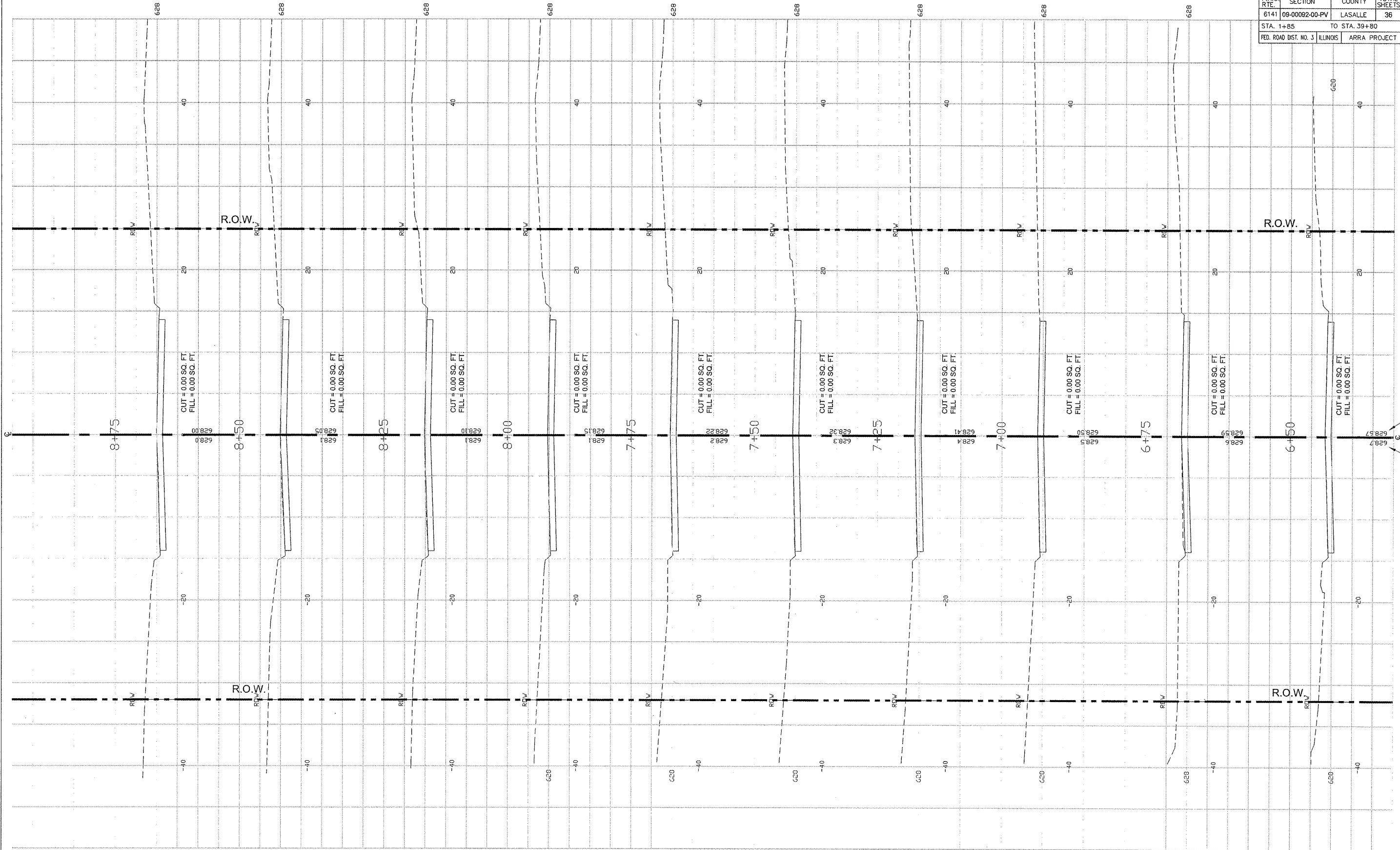

FINAL

SCALE: 1" = 20'

| | |
|----------------|-----------|
| DESIGNED - JEP | REVISED - |
| DRAWN - JCL | REVISED - |
| CHECKED - JEP | REVISED - |
| DATE - 4/10/09 | REVISED - |

STATE OF ILLINOIS
DEPARTMENT OF TRANSPORTATION

CROSS SECTIONS - STA. 6+50 TO 8+75