

CONTRACT NO. 87427				
FAU	SECTION	COUNTY	TOTAL	SHEET
RTE.	09-00092-00-PV	LASALLE	SHEETS	NO.
6141			36	28
STA. 1+85		TO STA. 39+80		
FED. ROAD DIST. NO. 3		ILLINOIS		
		ARRA PROJECT		

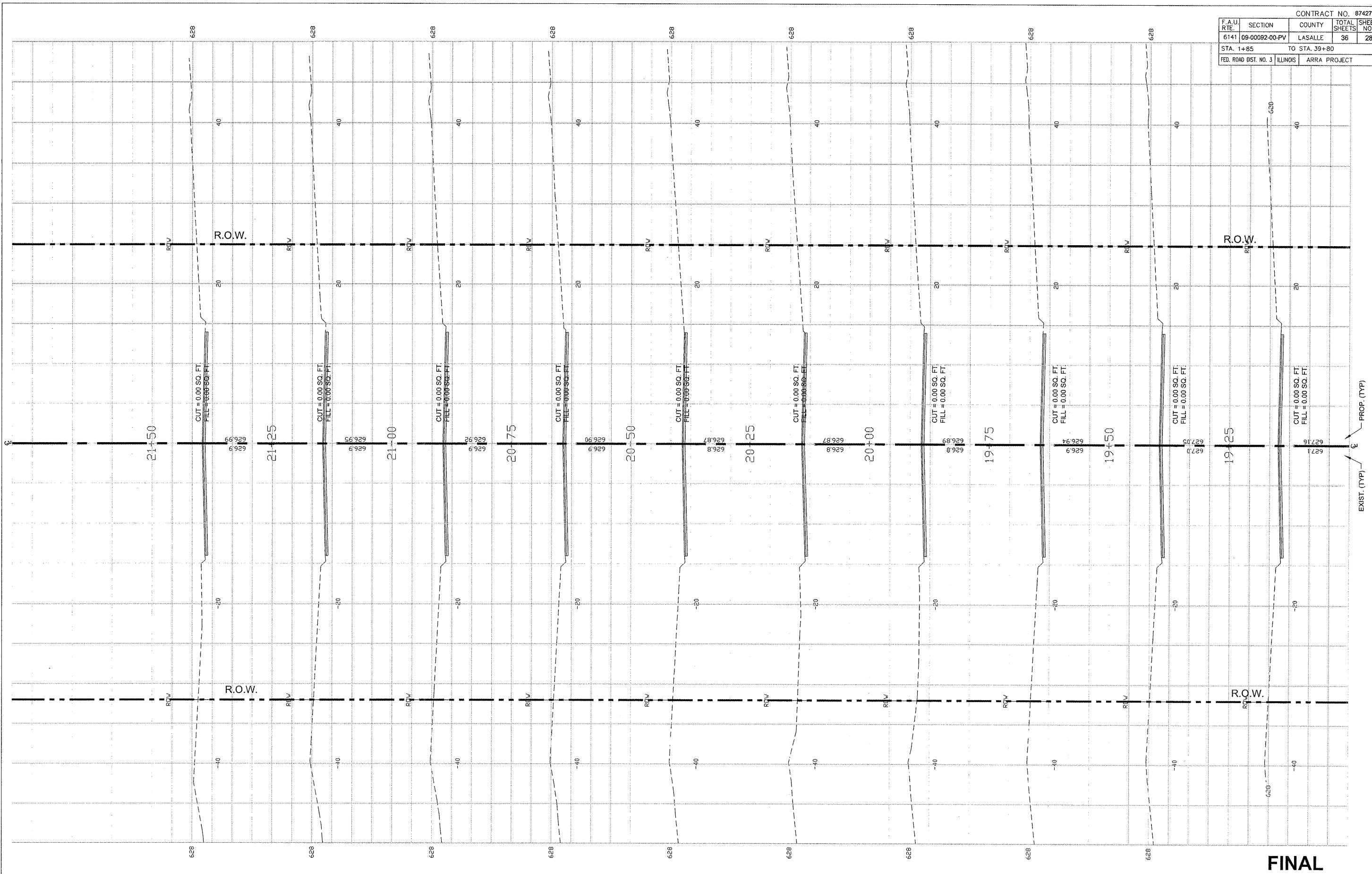

SCALE: 1" = 20'

DESIGNED	- JEP	REVISED	-
DRAWN	- JCL	REVISED	-
CHECKED	- JEP	REVISED	-
DATE	- 4/10/09	REVISED	-

STATE OF ILLINOIS
DEPARTMENT OF TRANSPORTATION

CROSS SECTIONS - STA. 19+25 TO 21+50

FINAL