

PR CURVE PATH-1 PI STA 50+97.56 $\Delta = 11^\circ 17' 24''$ (LT) $D = 11^\circ 27' 33''$ $R = 500.00'$ $T = 49.42'$ $L = 98.52'$ $E = 2.44'$	PR CURVE PATH-2 PI STA 52+24.94 $\Delta = 11^\circ 17' 24''$ (RT) $D = 11^\circ 27' 33''$ $R = 500.00'$ $T = 49.42'$ $L = 98.52'$ $E = 2.44'$	PR CURVE PATH-3 PI STA 55+79.56 $\Delta = 3^\circ 10' 49''$ (RT) $D = 11^\circ 27' 33''$ $R = 500.00'$ $T = 13.88'$ $L = 27.75'$ $E = 0.19'$	PR CURVE PATH-4 PI STA 57+41.77 $\Delta = 3^\circ 10' 49''$ (LT) $D = 11^\circ 27' 33''$ $R = 500.00'$ $T = 13.88'$ $L = 27.75'$ $E = 0.19'$	PR CURVE PATH-5 PI STA 60+98.03 $\Delta = 3^\circ 26' 02''$ (RT) $D = 11^\circ 27' 33''$ $R = 500.00'$ $T = 14.99'$ $L = 29.97'$ $E = 0.22'$	PR CURVE PATH-6 PI STA 61+98.21 $\Delta = 3^\circ 26' 02''$ (LT) $D = 11^\circ 27' 33''$ $R = 500.00'$ $T = 14.99'$ $L = 29.97'$ $E = 0.22'$	PR CURVE PATH-7 PI STA 63+24.08 $\Delta = 6^\circ 13' 46''$ (LT) $D = 28^\circ 38' 52''$ $R = 200.00'$ $T = 10.88'$ $L = 21.74'$ $E = 0.30'$	PR CURVE PATH-8 PI STA 64+49.51 $\Delta = 6^\circ 40' 17''$ (RT) $D = 11^\circ 27' 33''$ $R = 500.00'$ $T = 29.14'$ $L = 58.22'$ $E = 0.85'$	PR CURVE PATH-9 PI STA 66+08.45 $\Delta = 17^\circ 45' 39''$ (RT) $D = 57^\circ 17' 45''$ $R = 100.00'$ $T = 15.62'$ $L = 31.00'$ $E = 1.21'$	PR CURVE PATH-10 PI STA 66+57.38 $\Delta = 17^\circ 45' 39''$ (LT) $D = 53^\circ 03' 06''$ $R = 108.00'$ $T = 16.87'$ $L = 33.48'$ $E = 1.31'$
---	---	--	--	--	--	--	--	---	--

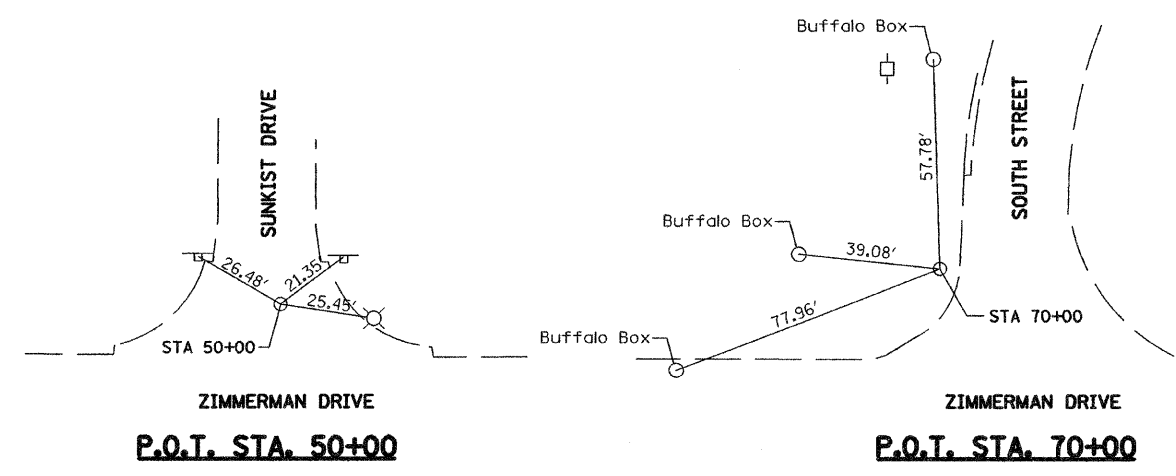

FILE NAME =	USER NAME = IE Consultants	DESIGNED -	REVISED -	STATE OF ILLINOIS DEPARTMENT OF TRANSPORTATION	ALIGNMENT & TIES - ZIMMERMAN DRIVE				F.A. RTE.	SECTION	COUNTY	TOTAL SHEETS	SHEET NO.
G:\S07009-01\Cad\Zimmerman\7009.ZIM.AT.SHT	DRAWN THW	REVISOR -	REVISIONS -						08-00014-00-SW	SANGAMON	47	25	
PLOT SCALE = 5/8" = 1' IN.	CHECKED -	REVISOR -	REVISIONS -		SCALE: SHEET NO. OF SHEETS STA. TO STA.				CONTRACT NO. 03486				
PLOT DATE = 2/13/2009	DATE FEB 09, 2009	REVISOR -	REVISIONS -		FED. ROAD DIST. NO. ILLINOIS FED. AID PROJECT								