

F.A.U. ROUTE NO.	SECTION	COUNTY	TOTAL SHEETS	SHEET NO.
9249	09-00015-01-SW	ST. CLAIR	15	11
STA. 51+50.00		TO STA. 57+50.00		
FEDERAL AID PROJECT		CONTRACT 97385		

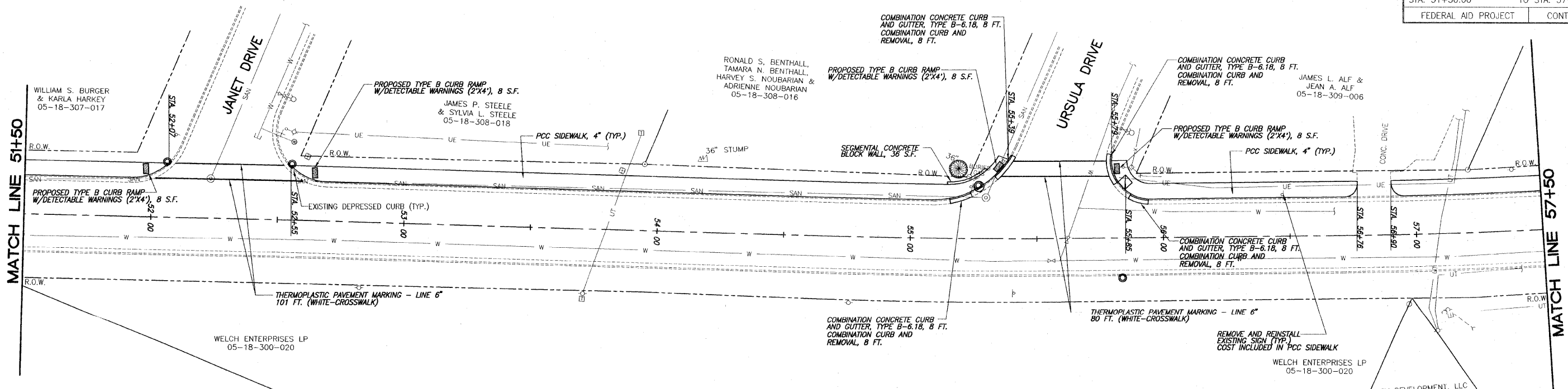

WILLIAM S. BURGER & KARLA HARKEY
05-18-307-017

JAMES P. STEELE & SYLVIA L. STEELE
05-18-308-018

RONALD S. BENTHALL, TAMARA N. BENTHALL, HARVEY S. NOUBARIAN & ADRIENNE NOUBARIAN
05-18-308-016

JAMES L. ALF & JEAN A. ALF
05-18-309-006

WELCH ENTERPRISES LP
05-18-300-020

WELCH ENTERPRISES LP
05-18-300-020

CCV DEVELOPMENT, LLC
05-18-314-024

SCALE:
PLAN: 1"=20'
PROFILE: 1"=20' HORIZ.
1"=5' VERT.

NOTE: SEE SCHEDULES FOR QUANTITIES

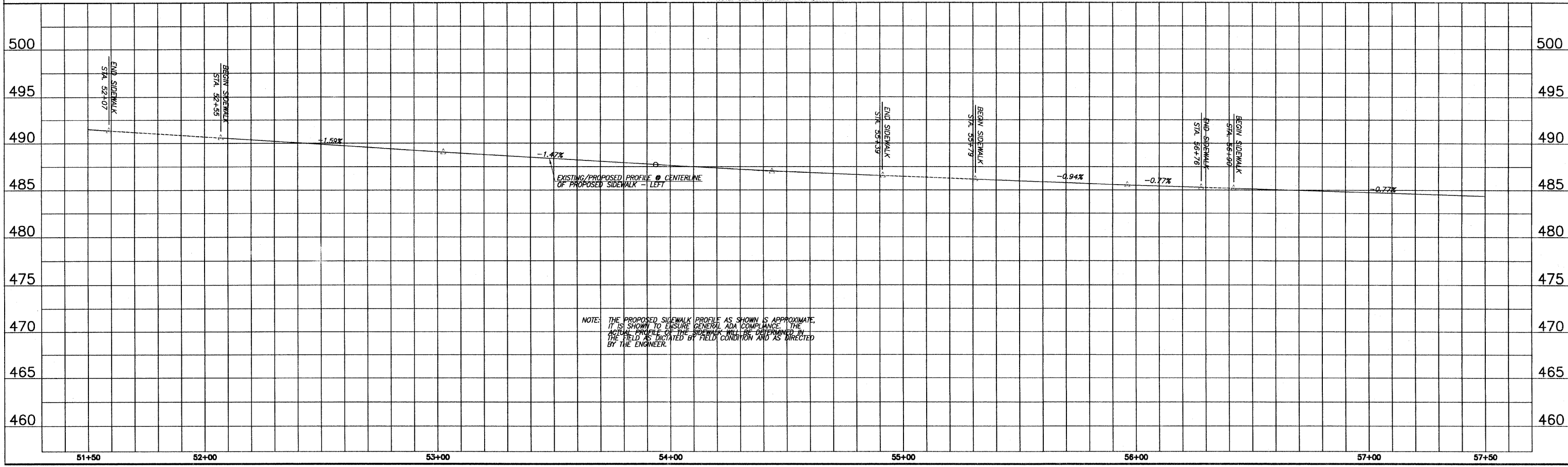

NOTE: THE PROPOSED SIDEWALK PROFILE AS SHOWN IS APPROXIMATE. IT IS SHOWN TO ENSURE GENERAL ADA COMPLIANCE. THE ACTUAL PROFILE OF THE SIDEWALK WILL BE DETERMINED IN THE FIELD AS DICTATED BY FIELD CONDITION AND AS DIRECTED BY THE ENGINEER.