

REVISIONS

SMS Sheppard, Morgan & Schwaab, Inc.
CONSULTING ENGINEERS AND LAND SURVEYORS
215 Market Street, P.O. Box E, Alton, IL 62002-6776; E-mail: sms@smss.com
10 Central Industrial Drive, Suite 3, Granite City, IL 62040; 618/877-8700; E-mail: smg@smss.com

ENGINEERS

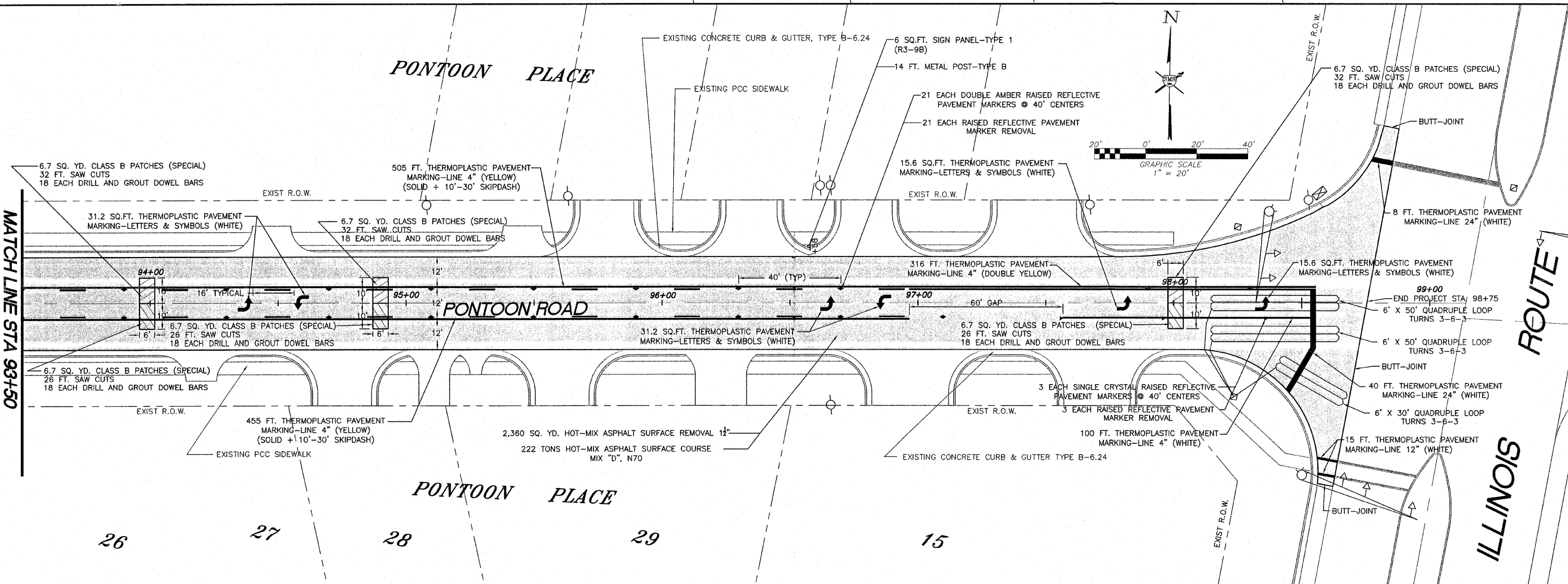
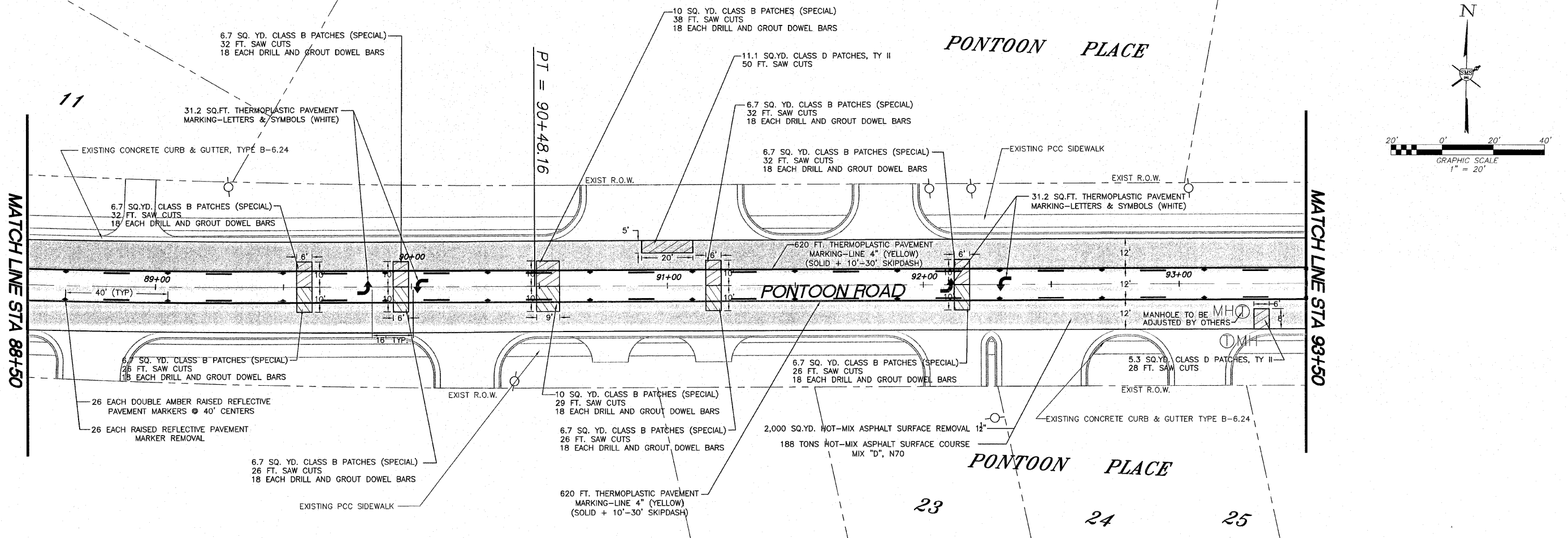

VILLAGE OF PONTON BEACH
PONTON ROAD RESURFACING PROJECT
SECTION 09-00006-01-RS
PLAN SHEET

OVERLAY PPT.DWG	PG.
REF. BK.	PG.
JOB NO. 266059	
DSN. BY: JHH	
DWN. BY: JCP	
CHK. BY: JHH	
DATE: FEBRUARY, 2009	
SCALE: 1"=20'	
SHEET 5 OF 5	