

Bench Mark: Chiseled square on end of N.E. abutment/wing wall of structure 002-0009 Elev. = 348.99
 Datum for Bench Mark is ±0.47 ft higher than elevations shown on record drawings.
 Any elevations taken from existing drawings should be revised accordingly.

Existing Structure: SN 002-0009 built as S.B.I. Rte. 150, Sec. 133 B-C, in 1933.
 The structure is a three span truss (pony truss side spans and through truss main span),
 338'-0³/₈" Bk.-Bk. abutments along C. of Roadway and 24'-0" O.-O. deck on spread
 footing conc. abutments and piers. Traffic is to be detoured.

No salvage.

ROUTE NO.	SECTION	COUNTY	SHEETS	SHEET NO.
S.B.I. 150	(133A) D.I	Alexander	32	8
SHEET NO. 1				
23 SHEETS				

Contract #98910

DESIGN SPECIFICATIONS

AASHTO Standard Specifications for Highway Bridges, 17th Edition, 2002

LOADING HS20-44

No future wearing surface allowed
 Stresses in existing structural members are limited to 65% Fy

SEISMIC DATA

Not Applicable

DESIGN STRESSES

FIELD UNITS (NEW)

f'c = 3,500 psi
 fy = 50,000 psi (M270 Grade 50)
 fy = 60,000 psi (reinforcement)

FIELD UNITS (EXISTING)

f'c = 3,500 psi
 fy = 33,000 psi (structural steel)
 fy = 33,000 psi (reinforcement)

WATERWAY INFORMATION

100 YR = 349.2
 50 YR = 347.2
 10 YR = Unknown
 NORMAL POOL = 336.65

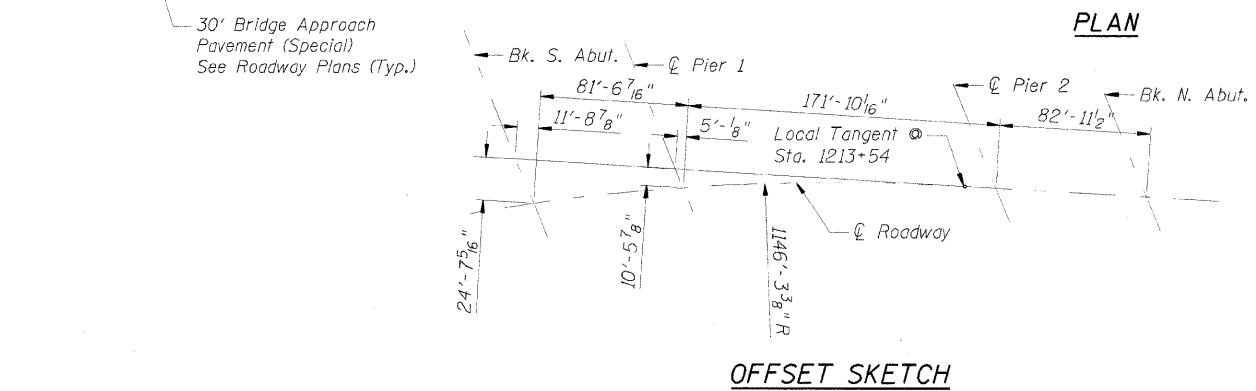
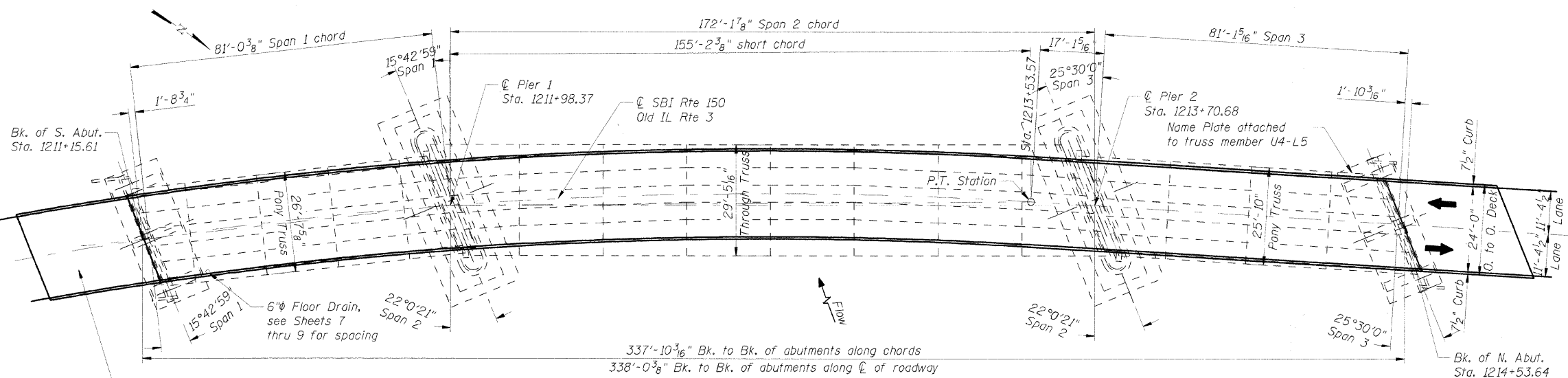
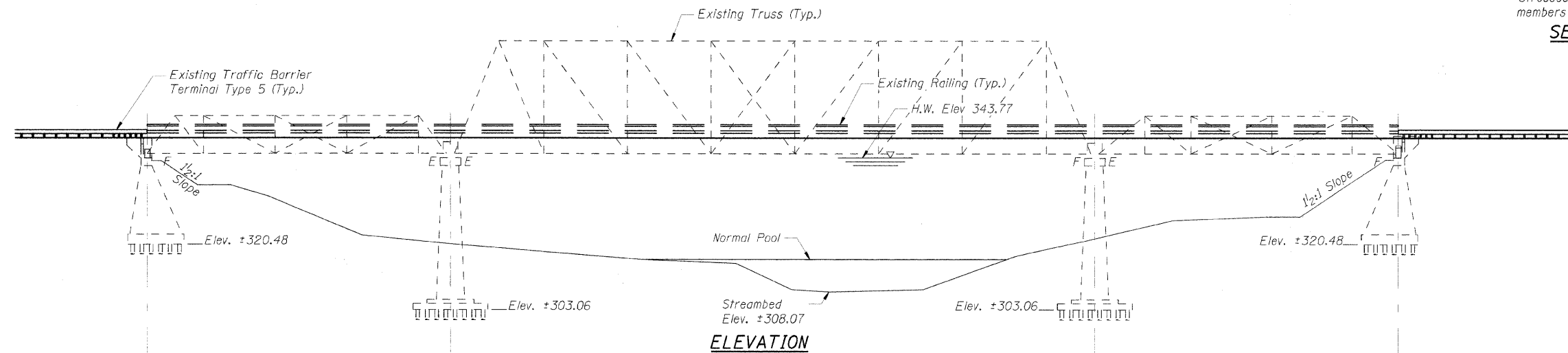

CURVE DATA
 Δ = 37°52'00" (RT)
 D = 4°59'54"
 R = 1146.28'
 T = 393.20
 L = 757.57
 E = 65.56'
 S.E. = 0.0716'/ft.
 P.C. Sta. = 1205+96.00
 P.T. Sta. = 1213+53.57

APPROVED
 FOR STRUCTURAL ADEQUACY ONLY

Ralph E. Anderson (TS)
 ENGINEER OF BRIDGES AND STRUCTURES

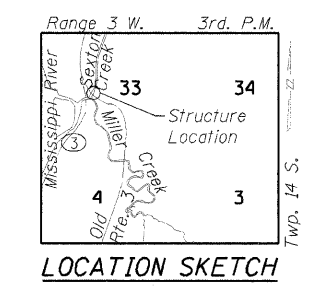

TENG TENG & ASSOCIATES, INC.
 ENGINEERS/ARCHITECTS-PLANNERS
 CHICAGO, ILLINOIS

LIN ENGINEERING, LTD.



BY: *Michael J. Haley* DATE: 4/24/09
 SHEETS: 2, 7-14, 18-23 EXPIRE: 11/30/10

TENG & ASSOCIATES, INC.

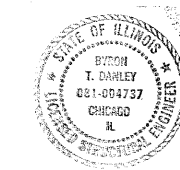

BY: *Randy* DATE: 4/20/09
 SHEETS: 1, 3-6, 15-17 EXPIRE: 11/30/10

ILLINOIS DEPARTMENT OF TRANSPORTATION
GENERAL PLAN & ELEVATION
OLD ILLINOIS ROUTE 3
OVER SEXTON CREEK
 S.B.I. ROUTE 150 - SECTION (133A)D,I
 ALEXANDER COUNTY
 STATION 1212+84.95
 STRUCTURE NO. 002-0009

4-17-2009, 7:53:39 C:\NIC\WORKSPACE\GALLTC\NFS-0044\TRANS-07\2202\STRUCT\CAD\02 PHASE II\IA TEND\SHEET\CP02IA001.SHT