

Contract #98910

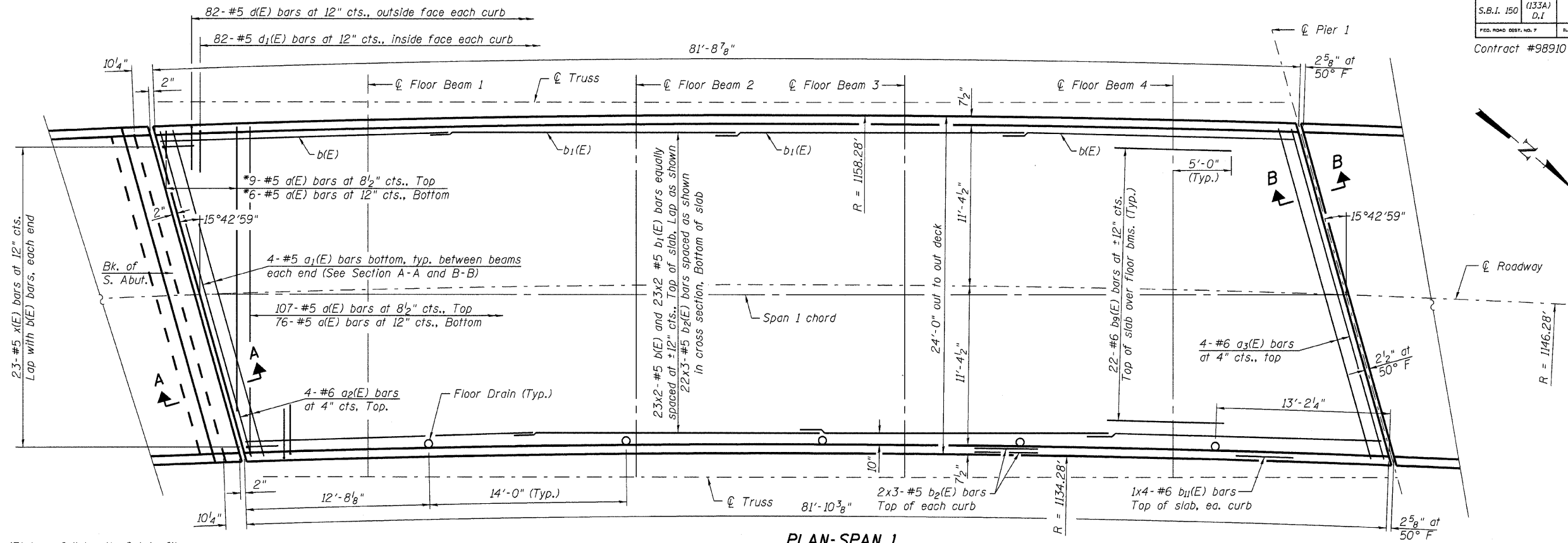

*Order a(E) bars full length. Cut to fit skew and use remainder in opposite end.

MIN. BAR LAP
#5 bar = 1'-8"
#6 bar = 2'-0"

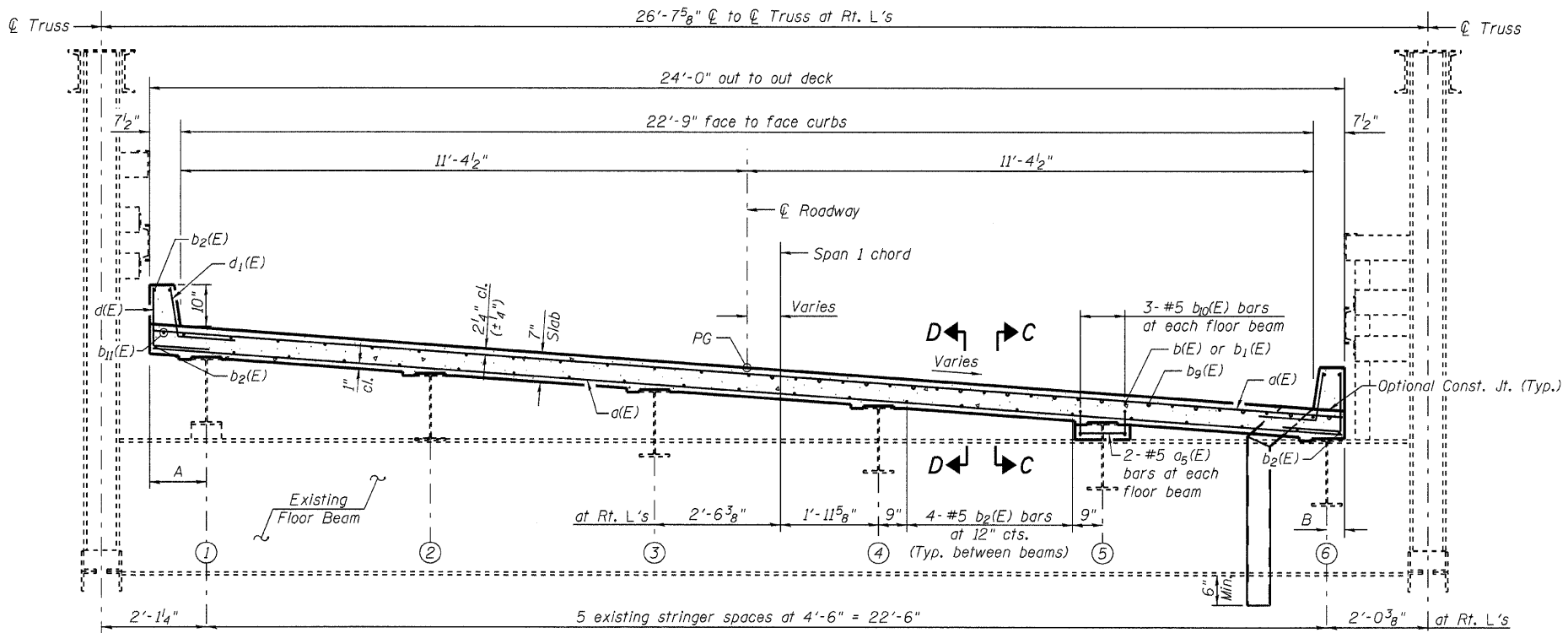

OVERHANG DIMENSIONS
(at Rt. L's)

Location	A	B
@ Brg. S. Abut.	4 1/4"	11"
Floor Beam 1	9 3/4"	8 3/8"
Floor Beam 2	1'-1 3/4"	4 1/4"
Floor Beam 3	1'-1 1/8"	4 1/2"
Floor Beam 4	10 1/8"	8"
@ Pier 1	7 1/8"	1'-2"

Notes:
All longitudinal dimensions are measured along inside face of curb.
All transverse dimensions are measured along radii, unless otherwise shown.
See Sheet 10 of 23 for superstructure details and Bill of Material.
See Sheet 10 of 23 for Sections A-A, B-B, C-C and D-D.
Bars indicated thus 2x3-#5 etc. indicates 2 lines of bars with 3 lengths per line.

ILLINOIS DEPARTMENT OF TRANSPORTATION
SUPERSTRUCTURE - SPAN 1
OLD ILLINOIS ROUTE 3
OVER SEXTON CREEK
S.B.I. ROUTE 150 - SECTION (133A)D.I
ALEXANDER COUNTY
STATION 1212+84.95
STRUCTURE NO. 002-0009

LE LIN ENGINEERING, LTD.
Consulting Engineers
Chatham, Illinois

Designed By: DLS
Checked By: STJ
Date: Feb 2009

Drawn By: AJF
File: 002-0009.dgn

3/11/2009 11:47:54 AM ... \2009 revisions\002-0009.dgn