

FAU ROUTE	SECTION	COUNTY
9723	09-00123-00-FP	JACKSON
FEDERAL AID PROJECT		ILLINOIS

CONTRACT NO. 99378

**THOUVENOT, WADE & MOERCHEN, INC.**  
ENGINEERS ♦ SURVEYORS ♦ PLANNERS



- CORPORATE OFFICE**  
4940 OLD COLLINSVILLE RD.  
SWANSEA, ILLINOIS 62226  
TEL (618) 624-4488  
FAX (618) 624-6688  
info@twm-inc.com
- CARBONDALE OFFICE**  
206 WEST COLLEGE STREET  
CARBONDALE, ILLINOIS 62901  
TEL (618) 549-8844  
FAX (618) 549-8450  
info@twm-inc.com
- EDWARDSVILLE OFFICE**  
1015B CENTURY DRIVE  
EDWARDSVILLE, ILLINOIS 62025  
TEL (618) 656-4040  
FAX (618) 656-4343  
info@twm-inc.com
- ST. CHARLES OFFICE**  
400 NORTH 5TH ST., SUITE 101  
ST. CHARLES, MISSOURI 63301  
TEL (636) 724-8300  
FAX (636) 724-8304  
info@twm-inc.com
- WATERLOO OFFICE**  
113 SOUTH MAIN STREET  
WATERLOO, ILLINOIS 62298  
TEL (618) 939-5050  
FAX (618) 939-3938  
info@twm-inc.com

PROFESSIONAL REGISTRATIONS	LICENSE NO.
ILLINOIS PROFESSIONAL DESIGN FIRM	184-00120
PROFESSIONAL ENGINEERING CORP.	62-035370
PROFESSIONAL STRUCTURAL ENGR. CORP.	81-005202
ILLINOIS PROF. LAND SURVEYING CORP.	D48-000029
MISSOURI PROFESSIONAL ENGR. CORP.	NC 001528
MISSOURI LAND SURVEYING CORP.	NC 000346

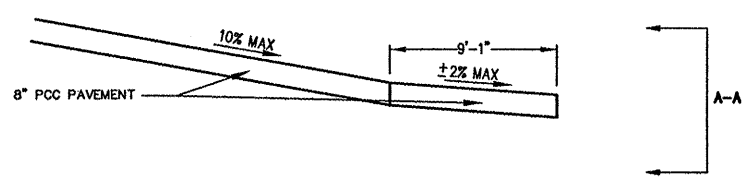
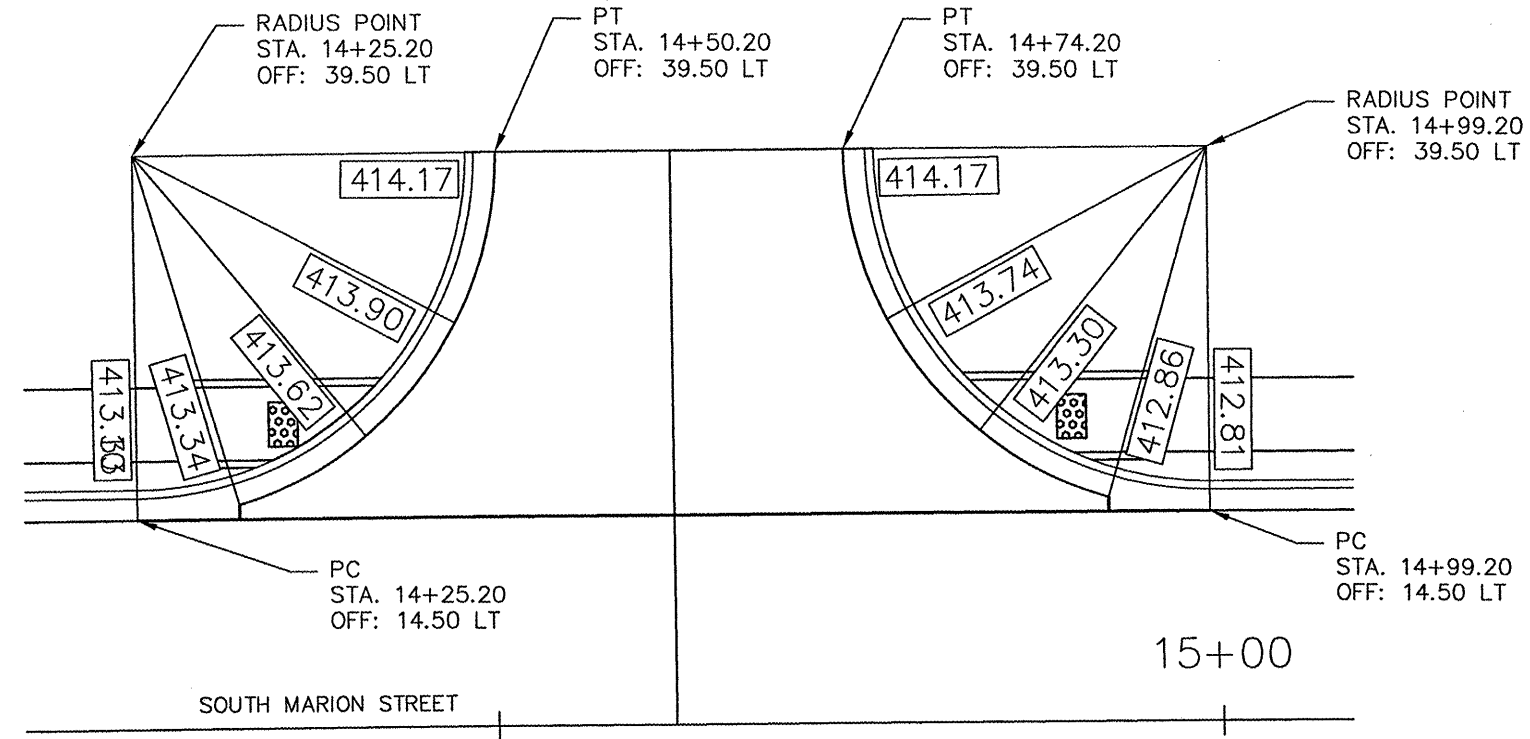

**SECTION A-A**  
**COMMERCIAL ENTRANCE**  
**STA. 14+62.20**

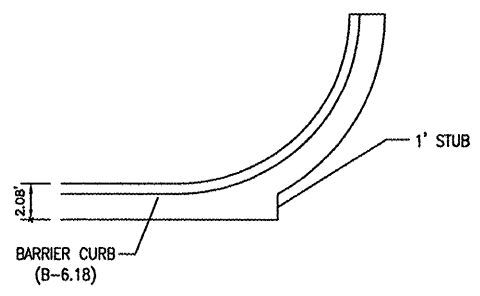

**B-6.18 CURB & GUTTER DETAIL**  
**AT COMMERCIAL ENTRANCE**

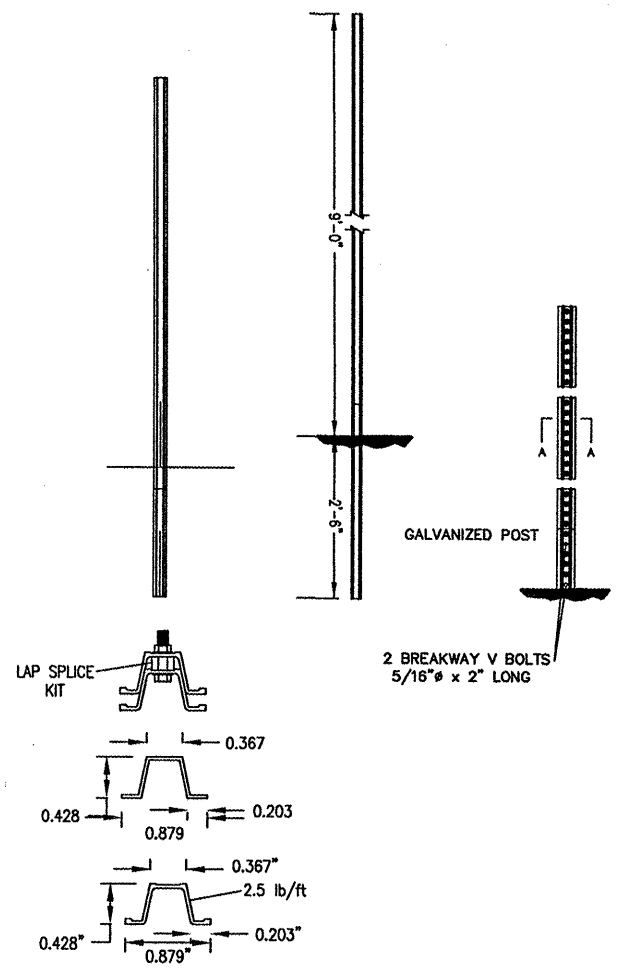

**STEEL SIGN SUPPORT**  
**METAL POST, SPECIAL**

**SPECIAL DETAILS**

**PROJECT:**  
SOUTH MARION STREET  
CITY OF CARBONDALE  
JACKSON COUNTY, ILLINOIS

REV.	DATE	DESCRIPTION
▲		
▲		
▲		

PLAN STATUS:	
<b>FINAL</b>	
<input checked="" type="checkbox"/> ISSUED FOR REVIEW	<input type="checkbox"/> ISSUED FOR BIDDING
<input type="checkbox"/> ISSUED FOR CONSTR.	<input type="checkbox"/> RECORD DRAWING
DRAWN BY: JUV	SHEET
DESIGNED BY: JUV	<b>15</b>
CHECKED BY: SJK	OF 24 SHEETS
APPROVED BY: JUV	PROJECT DESCRIPTION
PROJECT NUMBER: T06090142	

P:\090142\A\_CADD\12-TR\SHEETS\090142DL-01.dwg Plotted By: mchawajohn