



**SCOPE OF WORK**

THIS PROJECT WILL CONSIST OF CONSTRUCTING A WETLAND MITIGATION AREA FOR THE ST. LOUIS DOWNTOWN AIRPORT. PRIMARY WORK ITEMS INCLUDE UNCLASSIFIED EXCAVATION, EROSION CONTROL, SEEDING AND MULCHING.

**UTILITY NOTE**

THE CONTRACTOR SHALL CONTACT ALL UTILITY COMPANIES AND AGENCIES WHICH HAVE LINES OR CONDUITS IN THE PROPOSED WORK AREA. ALL LINES AND CONDUITS SHALL BE LOCATED AND IDENTIFIED FOR DEPTH BEFORE ANY EXCAVATION BEGINS. THE CONTRACTOR WILL CALL J.U.L.I.E. (1-800-892-0123) TO ACCOMPLISH THE ABOVE. IT IS THE CONTRACTOR'S RESPONSIBILITY TO IDENTIFY ALL UNDERGROUND NON-JULIE UTILITIES LOCATED WITHIN THE PROPOSED CONSTRUCTION LIMITS. THESE UNDERGROUND IMPROVEMENTS WILL BE LOCATED AT THE CONTRACTOR'S OWN EXPENSE PRIOR TO THE START OF CONSTRUCTION ACTIVITIES.

**HEIGHT OF CONSTRUCTION EQUIPMENT**

THE MAXIMUM ANTICIPATED HEIGHT OF THE CONSTRUCTION EQUIPMENT WILL BE 25 FEET. THE TALLEST EQUIPMENT IS EXPECTED TO BE A SEMI TRUCK WITH TRAILER IN THE UP POSITION.

**CONTRACTOR RESPONSIBILITIES**

THE CONTRACTOR'S EQUIPMENT PARKING AND STORAGE AREA WILL BE LOCATED WITHIN THE LIMITS OF THE PROPOSED CONSTRUCTION. THE CONTRACTOR'S EMPLOYEES WILL PARK THEIR VEHICLES IN THIS AREA.

THE CONTRACTOR AND HIS EMPLOYEES WILL BE RESTRICTED TO THE WORK AREA AND ALL OTHER AREAS ARE "OFF LIMITS" TO THEM.

**150-ENGINEER'S FIELD OFFICE NOTES**

THE CONTRACTOR WILL FURNISH A CELL PHONE TO THE RESIDENT ENGINEER FOR HIS EXCLUSIVE USE FOR THE DURATION OF THIS PROJECT. THE RESIDENT ENGINEER WILL USE THIS PHONE FOR PROJECT BUSINESS ONLY. THE CONTRACTOR WILL BE RESPONSIBLE FOR ALL CHARGES ASSOCIATED WITH THIS CELL PHONE.

THE PROPOSED ENGINEER'S FIELD OFFICE WILL BE PAID FOR UNDER ITEMS:  
AR150510 ENGINEER'S FIELD OFFICE \_\_\_\_\_ 1 L.S.



**J.U.L.I.E. INFORMATION**

COUNTY \_\_\_\_\_ ST. CLAIR  
CITY \_\_\_\_\_ CAHOKIA  
TOWNSHIP \_\_\_\_\_ CENTERVILLE  
SECTION NO. \_\_\_\_\_ T.1N. - R.10W.  
ADDRESS \_\_\_\_\_ ST. LOUIS DOWNTOWN AIRPORT  
1680 SAUGET INDUSTRIAL PARKWAY  
SAUGET, ILLINOIS 62206

**CRITICAL POINT DATA**

LATITUDE: 38° 34' 29.07"  
LONGITUDE: 90° 08' 10.84"  
ELEVATION: 411.0 M.S.L.  
CRITICAL POINT IS LOCATED 3,630'  
LEFT OF RUNWAY 12L-30R  
STATION 251+02

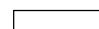
**LEGEND**

-  EXISTING IMPROVEMENTS
-  PROPOSED IMPROVEMENTS
-  EXISTING BUILDINGS

THE LOCATION, SIZE AND TYPE OF MATERIAL OF EXISTING UNDERGROUND UTILITIES INDICATED ON THE PLANS IS NOT REPRESENTED AS BEING ACCURATE, SUFFICIENT OR COMPLETE. IT SHALL BE THE CONTRACTOR'S RESPONSIBILITY TO DETERMINE THE ACTUAL LOCATION OF ALL SUCH FACILITIES, INCLUDING SERVICE CONNECTIONS TO UNDERGROUND UTILITIES. PRIOR TO CONSTRUCTION, THE CONTRACTOR SHALL NOTIFY THE UTILITY COMPANIES OF HIS OPERATIONAL PLANS AND SHALL OBTAIN FROM THE RESPECTIVE UTILITY COMPANIES DETAILED INFORMATION AND ASSISTANCE RELATIVE TO THE LOCATION OF THEIR FACILITIES AND THE WORKING SCHEDULE OF THE COMPANIES FOR REMOVAL OR ADJUSTMENT WHERE REQUIRED. IN THE EVENT AN UNEXPECTED UTILITY INTERFERENCE IS ENCOUNTERED DURING CONSTRUCTION, THE CONTRACTOR SHALL IMMEDIATELY NOTIFY THE UTILITY COMPANY OF JURISDICTION. THE ENGINEER SHALL ALSO BE IMMEDIATELY NOTIFIED. ANY SUCH MAINS AND SERVICES SHALL BE RESTORED TO SERVICE AT ONCE AND PAID FOR BY THE CONTRACTOR AT NO ADDITIONAL COST TO THE CONTRACT.

CALL J.U.L.I.E. FOR UTILITY INFORMATION AT 1-800-892-0123.

**EROSION CONTROL**

THIS PROJECT WILL DISTURB MORE THAN 1 ACRE OF LAND, THEREFORE A N.P.D.E.S. PERMIT WILL BE REQUIRED.

**CERTIFIED PAYROLLS**

THE RESIDENT ENGINEER CANNOT FORWARD CONSTRUCTION REPORTS TO THE ILLINOIS DIVISION OF AERONAUTICS FOR PROCESSING UNTIL ALL CERTIFIED PAYROLLS FOR THE PERIOD HAVE BEEN RECEIVED.

**MATERIAL CERTIFICATION**

COMPLETED WORK CANNOT BE PLACED ON A CONSTRUCTION REPORT UNTIL ALL MATERIAL CERTIFICATIONS FOR THAT PAY ITEM HAVE BEEN RECEIVED, REVIEWED AND ACCEPTED BY THE RESIDENT ENGINEER.

BENCHMARK DATA				
NO.	DESCRIPTION	NORTHING	EASTING	ELEVATION
1	CONCRETE MONUMENT	694968.540	2298934.635	405.14
2	NGS MONUMENT	691967.554	2302245.146	402.76

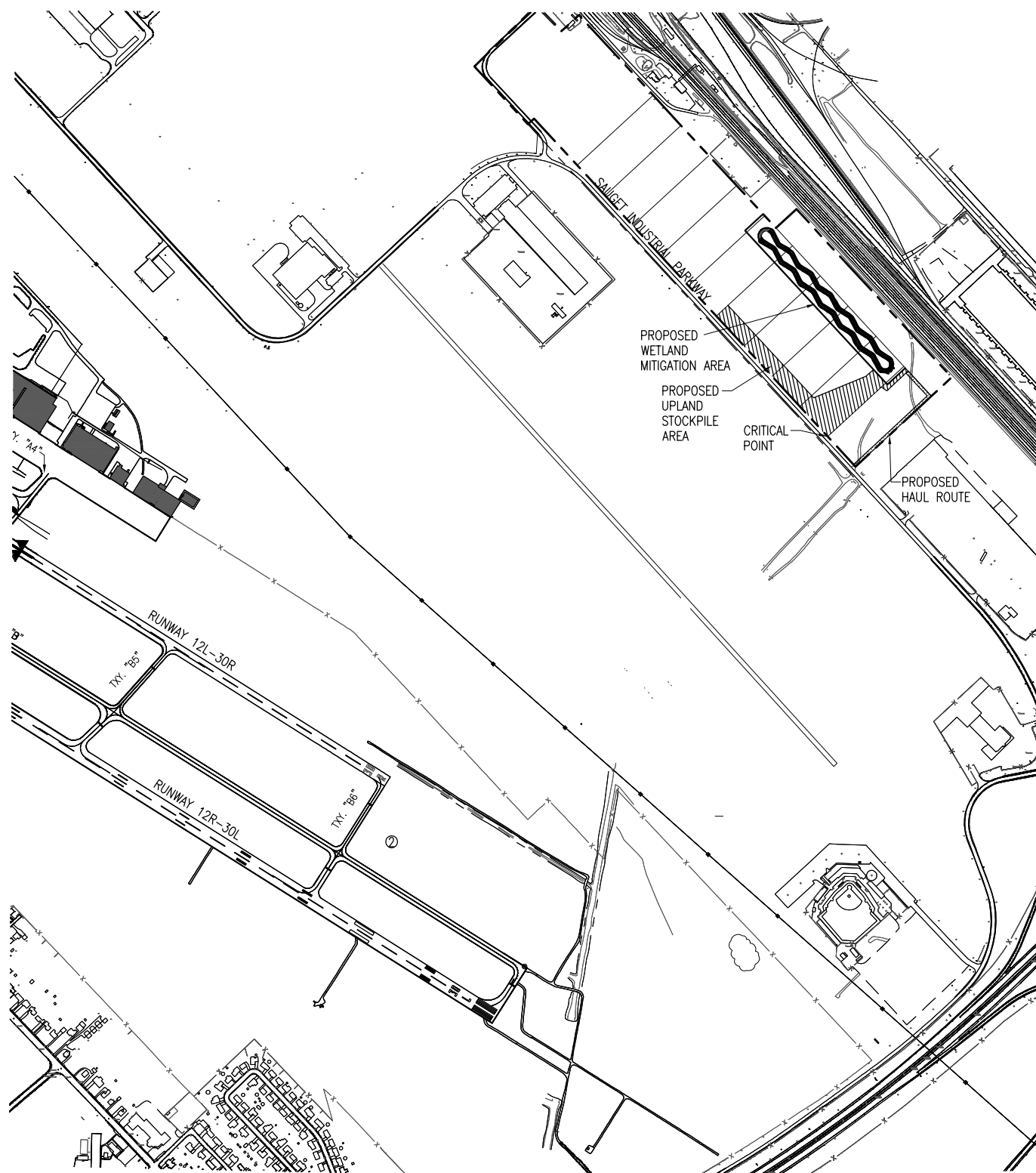

DATE	REVISION	BY

**SAINT LOUIS DOWNTOWN AIRPORT**  
A Division of METRO



A.I.P. PROJ.: 3-17-0039-B23  
ILL. PROJ.: CPS-3916

Hanson Project No. 84506RWYSS	JAC	02/05/07
Filename R-003SEY.DWG	ZSH	02/05/07
Scale 1" = 500'	CAH	04/05/07
Date 02/05/07		
LAYOUT		
DRAWN		
REVIEWED		

**HANSON**

Hanson Professional Services Inc.  
4227 Earth City Expressway, Suite 130  
St. Louis, Missouri 63106  
Offices Nationwide

CONSTRUCT WETLAND MITIGATION  
PROPOSED SAFETY PLAN

JUN 24, 2009 10:35 AM KINCA00394 I:\AIRPORTS\ST. LOUIS DOWNTOWN\84506RWYSS\CAD\SHEETS\R-003SEY.DWG - Safety

EXISTING SAUGET INDUSTRIAL PARKWAY

PROPOSED UPLAND STOCKPILE AREA

1,131'

253'

100'

PROPOSED HAUL ROUTE  
20' WIDE (TYP.)

463'

EXISTING LOT LINE

PROPOSED WETLAND MITIGATION AREA

EXISTING WETLAND MITIGATION PARCEL PROPERTY LINE



3+00 4+00 5+00 6+00 7+00 8+00 9+00 10+00 11+00 12+00 13+00 14+00

BOP Sta = 2+00.00

EXISTING GOOSE LAKE DITCH

EXISTING GOOSE LAKE DITCH

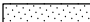
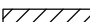
LEGEND

-  EXISTING IMPROVEMENTS
-  PROPOSED WETLAND MITIGATION AREA
-  PROPOSED STOCKPILE AREA
-  PROPOSED HAUL ROUTE

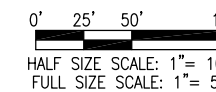

DATE	REVISION	BY

SAINT LOUIS  
DOWNTOWN  
AIRPORT  
A Division of METRO

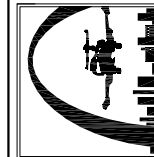

ILL. PROJ.: CPS-3916 A.I.P. PROJ.: 3-17-0039-B23

Hanson Project No. 84506RWYSS	RAW	1/12/09
Filename R=122CON.DWG	BAK	1/12/09
Scale 1" = 100'	xxx	xx/xx/xx
Date		
LAYOUT		
DRAWN		
REVIEWED		



Hanson Professional Services Inc.  
4227 East City Expressway, Suite 130  
St. Louis, Missouri 63106  
Offices Nationwide

CONSTRUCT  
WETLAND MITIGATION  
PROPOSED STOCKPILE  
& HAUL ROUTE  
LAYOUT PLAN

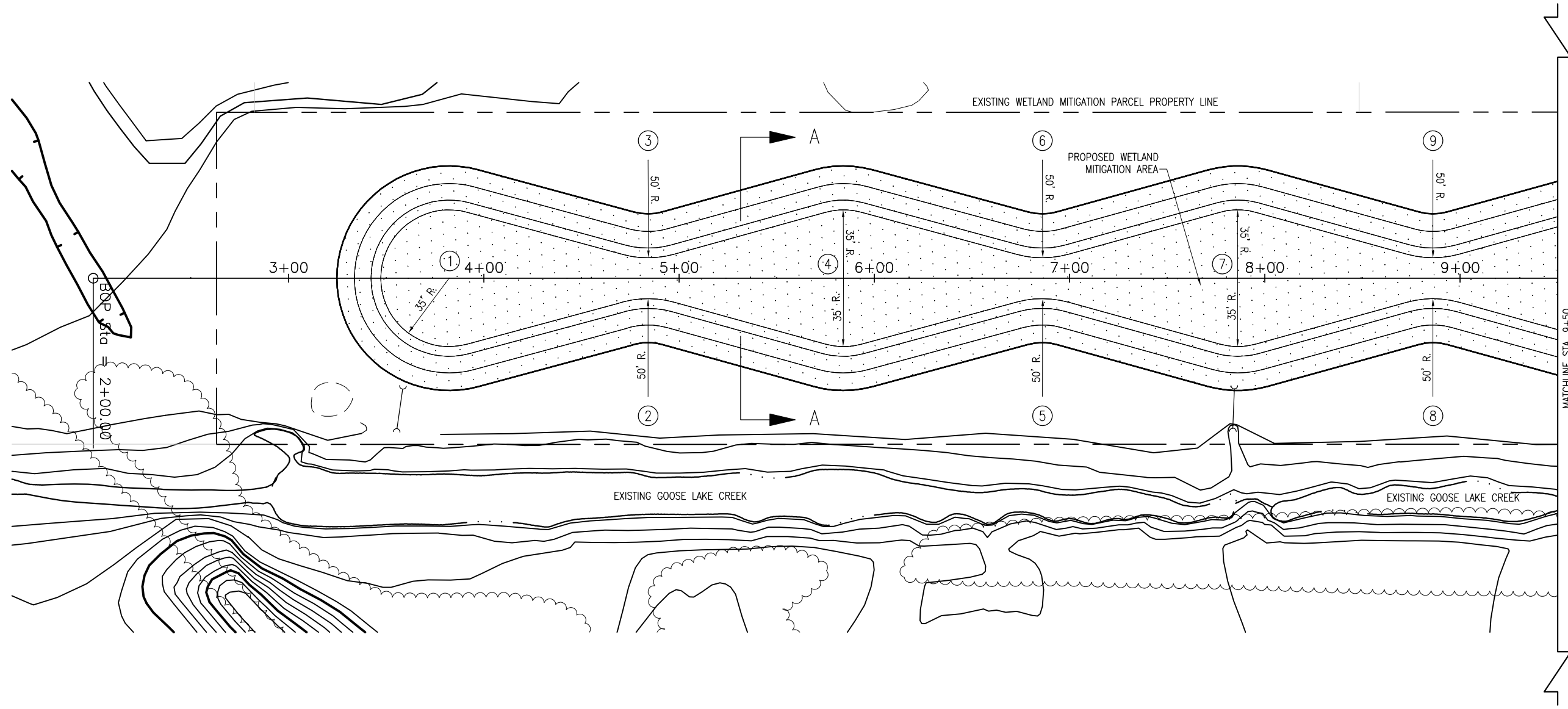

DATE	REVISION	BY

**SAINT LOUIS DOWNTOWN AIRPORT**  
A Division of METRO

ILL. PROJ.: CPS-3916  
A.I.P. PROJ.: 3-17-0039-B23

Hanson Project No. 84506RWYSS	RAW	1/12/09
Filename R-121CON.DWG	BAK	1/12/09
Scale 1" = 100'	xxx	xx/xx/xx
Date		
LAYOUT		
DRAWN		
REVIEWED		

**HANSON**

Hanson Professional Services Inc.  
4227 East City Expressway, Suite 130  
St. Louis, MO 63117  
Offices Nationwide

**CONSTRUCT WETLAND MITIGATION**

PROPOSED WETLAND MITIGATION AREA LAYOUT  
STA. 3+00 TO STA. 9+50

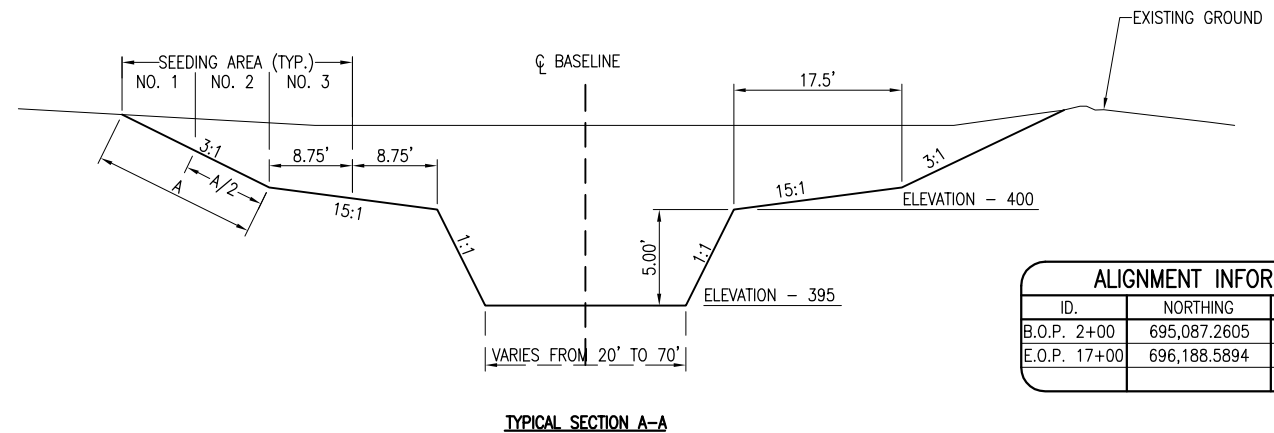

ID.	NORTHING	EASTING
B.O.P. 2+00	695,087.2605	2,305,860.0583
E.O.P. 17+00	696,188.5894	2,304,841.6890

ID.	STATION	OFFSET	NORTHING	EASTING
1	3+82.22	☉	695,260.528	2,305,647.794
2	4+84.16	60.45' RT.	695,376.409	2,305,622.972
3	4+84.16	60.45' LT.	695,294.330	2,305,534.207
4	5+84.16	☉	695,408.792	2,305,510.698
5	6+86.09	60.45' RT.	695,524.673	2,305,485.876
6	6+86.09	60.45' LT.	695,442.595	2,305,397.111
7	7+86.09	☉	695,557.056	2,305,373.602
8	8+86.09	60.45' RT.	695,671.517	2,305,350.093
9	8+86.09	60.45' LT.	695,598.438	2,305,261.329

**LEGEND**

EXISTING IMPROVEMENTS

PROPOSED IMPROVEMENTS

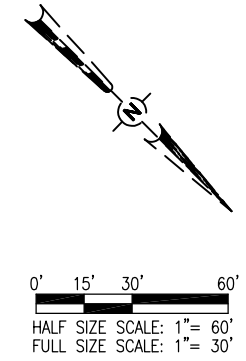

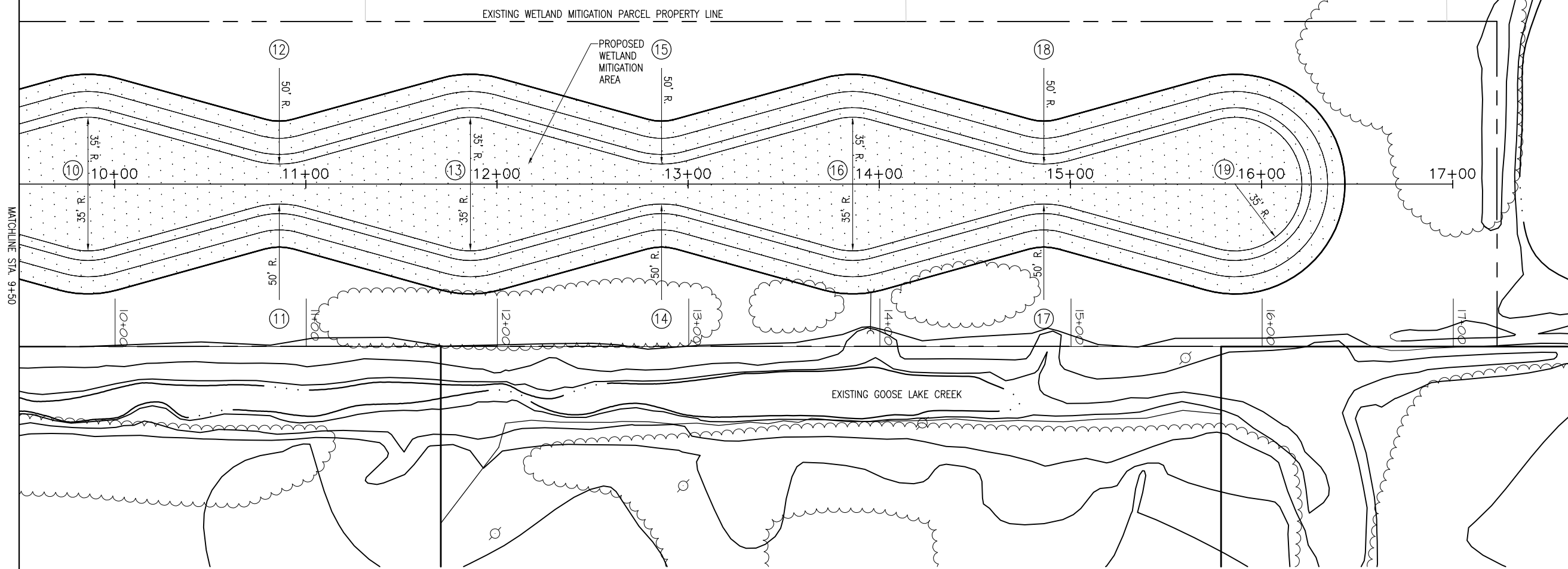

**WETLAND SEEDING DATA**

AREA NO. 1  
THE AREA DESIGNED AS NO. 1 ON THE TYPICAL SECTION WILL BE SEEDING IN ACCORDANCE WITH IDOT CLASS 5B WETLAND FORB MIXTURE.

100% FORBS MIXTURE (BELOW)      2 LBS/ACRE  
2 LBS/ACRE

FORBS MIXTURE SPECIES	% BY WEIGHT
SWEET FLAG	03
ANGELICA	06
SWAMP MILKWEED	02
STEMMED ASTER	10
BEGGARTICKS	07
SPOTTED JOE-PYE WEED	07
BONESET	07
AUTUMN SNEEZE WEED	02
BLUE GLAG IRIS	02
CARDINAL FLOWER	05
GREAT BLUE LOBELIA	05
WINGED LOOSESTRIFE	02
FALSE DRAGONHEAD	05
SMARTWEED	10
WATER SMARTWEED	10
MOUNTAIN MINT	05
CUT LEAF CONEFLOWER	05
RIDDLE GOLDENROD	02
GIANT BURWEED	05

AREA NO. 2  
THE AREA DESIGNED AS NO. 2 ON THE TYPICAL SECTION WILL BE SEEDING IN ACCORDANCE WITH IDOT CLASS 4B WETLAND GRASS & SEDGE MIXTURE.

44.64% ANNUAL RYEGRASS      25 LBS/ACRE  
44.64% SPRING OATS      25 LBS/ACRE  
10.72% WETLAND GRASSES (BELOW)      6 LBS/ACRE  
56 LBS/ACRE

WETLAND GRASSES SPECIES	% BY WEIGHT
BLUE JOINT GRASS	12
LAKE-BANK SEDGE	06
AWL-FRUITED SEDGE	06
TUSsock SEDGE	06
FOX SEDGE	06
NEEDLE SPIKE RUSH	03
BLUNT SPIKE RUSH	03
FOWL MANNA GRASS	14
COMMON RUSH	06
SLENDER RUSH	06
TORREY'S RUSH	06
RICE CUT GRASS	10
HARD-STEMMED BULRUSH	03
DARK GREEN RUSH	03
RIVER BULRUSH	03
SOFTSTEM BULRUSH	03
CORD GRASS	04

AREA NO. 3  
THE AREA DESIGNED AS NO. 3 ON THE TYPICAL SECTION WILL BE SEEDING WITH SEDGE PLUGS

SEEDGE PLUGS SPECIES      % BY WEIGHT  
HARD-STEMMED BULRUSH      33 - 1/3  
RIVER BULRUSH      33 - 1/3  
SOFTSTEM BULRUSH      33 - 1/3

**WETLAND MULCHING DATA**

ALL AREAS THAT WILL BE SEEDING WILL ALSO BE MULCHED.

THE CONTRACTOR WILL PLACE THE MULCH AT RATES ESTABLISHED IN THE SUPPLEMENTAL SPECIFICATION AND RECURRING SPECIAL PROVISIONS, ADOPTED JULY 1, 2004.

THE PROPOSED MULCHING WILL BE PAID FOR UNDER: AR908510 "MULCHING" PER ACRE.

**EXISTING TREE/VEGETATION NOTE**

A MINOR AMOUNT OF SMALL TREES AND VEGETATION EXISTS WITHIN THE PROJECT LIMITS. ANY REMOVAL NECESSARY SHALL BE CONSIDERED INCIDENTAL TO THE PROJECT AND NO ADDITIONAL COMPENSATION WILL BE ALLOWED.

COORDINATE DATA				
ID.	STATION	OFFSET	NORTHING	EASTING
10	9+86.09	0	695,703.900	2,305,237.820
11	10+86.09	60.45' RT.	695,818.361	2,305,214.311
12	10+86.09	60.45' LT.	695,736.282	2,305,125.546
13	11+86.09	0	695,850.743	2,305,102.037
14	12+86.09	60.45' RT.	695,965.204	2,305,078.528
15	12+86.09	60.45' LT.	695,883.126	2,304,989.764
16	13+86.09	0	695,997.587	2,304,966.255
17	14+86.09	60.45' RT.	696,112.048	2,304,942.746
18	14+86.09	60.45' LT.	696,029.970	2,304,853.981
19	15+86.09	0	696,144.431	2,304,830.472

**LEGEND**

- EXISTING IMPROVEMENTS
- PROPOSED IMPROVEMENTS

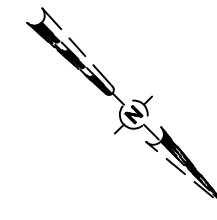

0' 15' 30' 60'  
HALF SIZE SCALE: 1" = 60'  
FULL SIZE SCALE: 1" = 30'

DATE	REVISION	BY

**SAINT LOUIS DOWNTOWN AIRPORT**  
A Division of METRO  
A.I.P. PROJ.: 3-17-0039-B23  
ILL. PROJ.: CPS-3916

Hanson Project No. 84506RWYSS	RAW	1/12/09
Filename R-121CON.DWG	BAK	1/12/09
Scale 1" = 100'	xxx	xx/xx/xx
Date		

**HANSON**  
Hanson Professional Services Inc.  
4227 East City Expressway, Suite 130  
St. Louis, MO 63126  
Offices Nationwide

CONSTRUCT WETLAND MITIGATION  
PROPOSED WETLAND MITIGATION AREA LAYOUT  
STA. 9+50 TO STA. 17+00

JUN 24, 2009 10:38 AM KINCA00394 I:\AIRPORTS\ST. LOUIS DOWNTOWN\84506RWYSS\CAD\SHEETS\R-121CON.DWG - WEST

SD050

EXISTING SAUGET INDUSTRIAL PARKWAY

PROPOSED SILT FENCE

PROPOSED UPLAND STOCKPILE AREA

PROPOSED WETLAND MITIGATION AREA

PROPOSED HEADWALL PROTECTION

PROPOSED HEADWALL PROTECTION



PROPOSED HEADWALL PROTECTION

EXISTING GOOSE LAKE DITCH

EXISTING GOOSE LAKE DITCH

NOTE: FOR STORMWATER POLLUTION PREVENTION NOTES AND DETAILS SEE SHEET 7

LEGEND

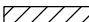
-  EXISTING IMPROVEMENTS
-  PROPOSED WETLAND MITIGATION AREA
-  PROPOSED STOCKPILE AREA

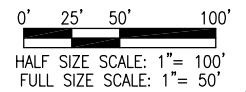

DATE	REVISION	BY

**SAINT LOUIS DOWNTOWN AIRPORT**  
A Division of METRO

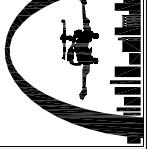

ILL. PROJ.: CPS-3916 A.I.P. PROJ.: 3-17-0039-B23

Hanson Project No. 84506RWYSS	1/12/09
Filename R-181_SWP.DWG	BAK
Scale 1" = 100'	xxx
Date	xx/xx/xx
LAYOUT	RAW
DRAWN	BAK
REVIEWED	xxx
	1/12/09
	1/12/09
	xx/xx/xx

**HANSON**

Hanson Professional Services Inc.  
4227 East City Expressway, Suite 130  
St. Louis, MO 63114  
Offices Nationwide

CONSTRUCT WETLAND MITIGATION

PROPOSED STORM WATER POLLUTION PREVENTION PLAN

6

6 of 23 sheets

JUN 24, 2009 10:39 AM KINCA00394 I:\AIRPORTS\ST. LOUIS DOWNTOWN\84506RWYSS\CAD\SHEETS\R-181\_SWP.DWG - Layout



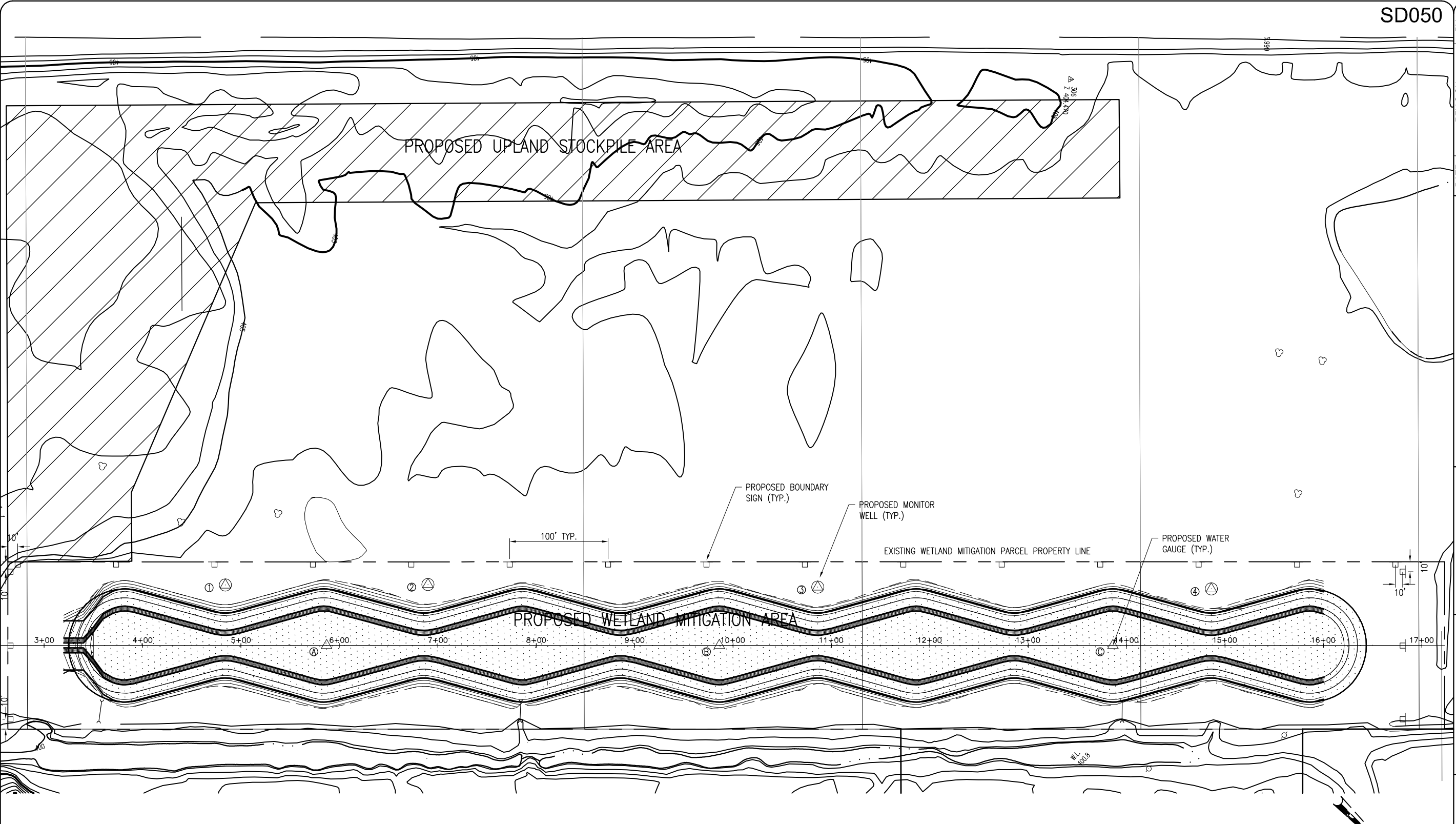

COORDINATE DATA				
ID.	STATION	OFFSET	NORTHING	EASTING
1	4+84.16	61.45' LT.	695,293.65	2,305,533.47
2	6+90	61.96' LT.	695,444.44	2,305,393.35
3	10+86.09	59.32' LT.	695,737.05	2,305,126.38
4	14+86.09	57.53' LT.	696,031.95	2,304,856.12
A	5+87.08	☉	695,410.94	2,305,508.72
B	9+86.09	☉	695,703.90	2,305,237.82
C	13+86.09	☉	695,997.59	2,304,966.25

**LEGEND**

THE CONTRACTOR WILL FURNISH AND INSTALL THE PROPOSED MONITOR WELLS AT THE LOCATIONS SHOWN ON THIS SHEET AND IN ACCORDANCE WITH THE DETAIL SHOWN ON SHEET 9. THE MONITOR WELLS WILL BE INSTALLED AFTER THE CONTRACTOR HAS COMPLETED THE FINAL GRADING OF THE AREA WHERE THE WELLS WILL BE LOCATED.

THE CONTRACTOR WILL FURNISH AND INSTALL THE PROPOSED WATER GAUGES AT THE LOCATIONS SHOWN ON THIS SHEET AND IN ACCORDANCE WITH THE SPECIAL PROVISIONS. THE WATER GAUGES WILL BE INSTALLED AFTER THE CONTRACTOR HAS COMPLETED THE FINAL GRADING OF THE AREA WHERE THE GAUGES WILL BE LOCATED.

THE CONTRACTOR WILL FURNISH AND INSTALL THE PROPOSED BOUNDARY SIGNS AT THE LOCATIONS SHOWN ON THIS SHEET AND IN ACCORDANCE WITH THE SPECIAL PROVISIONS. THE BOUNDARY SIGNS WILL BE INSTALLED AFTER THE CONTRACTOR HAS COMPLETED THE UNCLASSIFIED EXCAVATION AND PRIOR TO THE SEEDING AND MULCHING OPERATIONS.

**LEGEND**

- EXISTING IMPROVEMENTS
- PROPOSED WETLAND MITIGATION AREA
- PROPOSED WASTE AREA
- PROPOSED MONITOR WELL
- PROPOSED WATER GAUGE
- PROPOSED SIGN

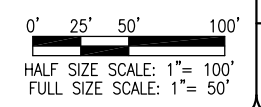

JUN 24, 2009 10:40 AM KINCA00394 I:\AIRPORTS\ST. LOUIS DOWNTOWN\84506RWYSS\CAD\SHEETS\R-123CON.DWG - STOCKPILE

DATE	REVISION	BY

**SAINT LOUIS DOWNTOWN AIRPORT**  
A Division of METRO

ILL. PROJ.: CPS-3916 A.I.P. PROJ.: 3-17-0039-B23

Hanson Project No. 84506RWYSS	RAW	1/12/09
Filename R-123CON.DWG	BAK	1/12/09
Scale 1" = 100'	xxx	xx/xx/xx
Date		
LAYOUT		
DRAWN		
REVIEWED		

**HANSON**

Hanson Professional Services Inc.  
4227 East City Expressway, Suite 130  
St. Louis, MO 63117  
Offices Nationwide

**CONSTRUCT WETLAND MITIGATION**

**PROPOSED MONITOR WELL, WATER GAUGE, & BOUNDARY SIGN LAYOUT PLAN**



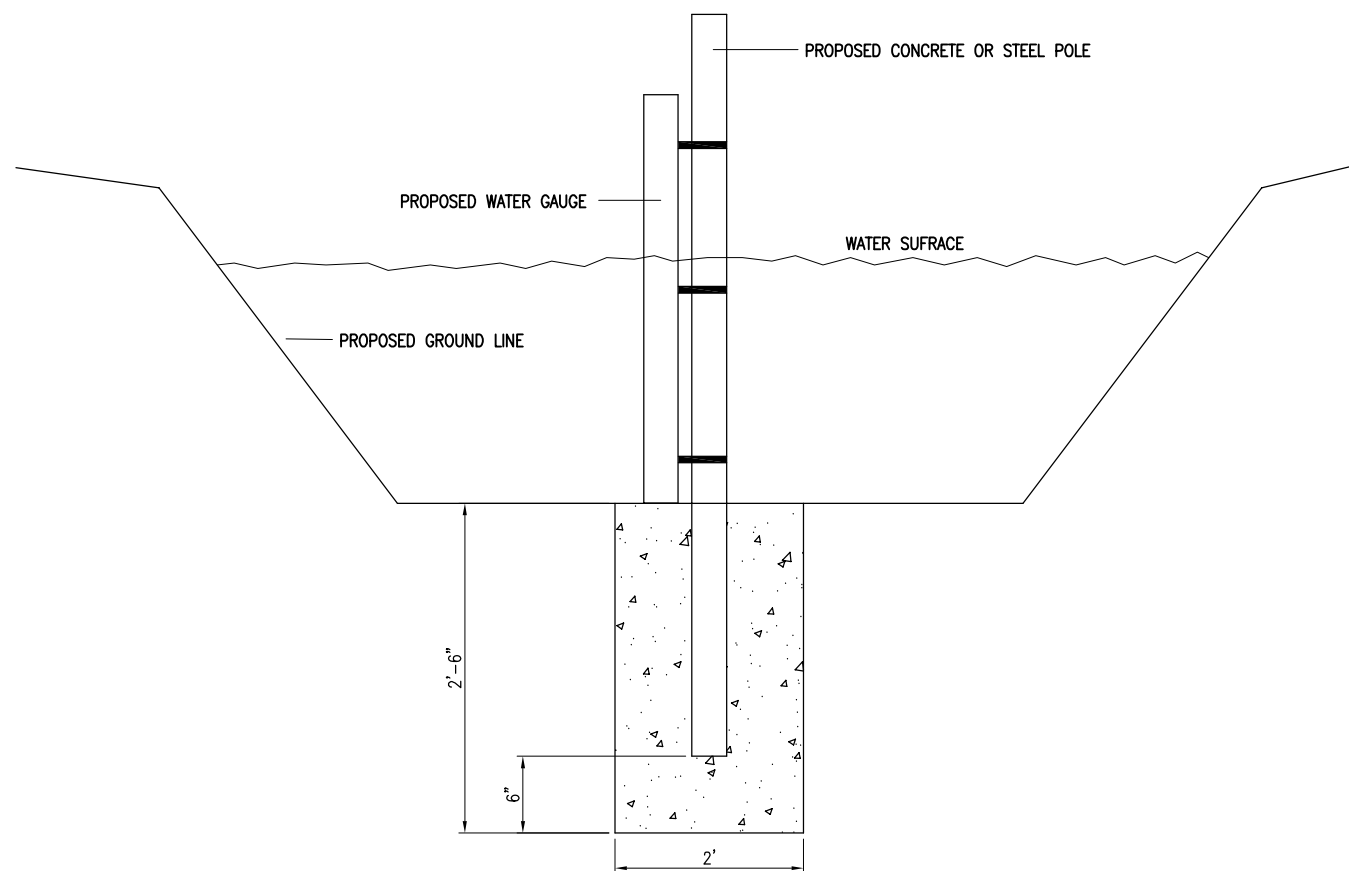

**WATER GAUGE DETAIL**  
"NOT TO SCALE"

**WATER GAUGE NOTES**

THE CONTRACTOR WILL FURNISH AND INSTALL THREE WATER GAUGES AT THE LOCATIONS SHOWN ON SHEET NO. 8.

THE PROPOSED WATER GAUGE WILL BE AFIXED TO EITHER A CONCRETE OR STEEL POLE. THE POLE WILL BE PLACED IN THE GROUND AT LEAST TWO FEET DEEP. A CONCRETE ANCHOR WILL BE PLACED AROUND THE POLE AS SHOWN IN THE DETAIL ON THIS SHEET.

THE PROPOSED WATER GAUGE WILL BE AFIXED TO THE POLE WITH THE BOTTOM OF THE GAUGE AT ELEVATION 395, WHICH SHOULD BE FLUSH TO THE PROPOSED GROUND LINE. THE WATER GAUGE WILL EXTEND AT LEAST 6' ABOVE THE PROPOSED GROUND LINE.

THE PROPOSED WATER GAUGE WILL BE PAID FOR UNDER ITEM: AR800473 "WATER GAUGE" PER EACH.

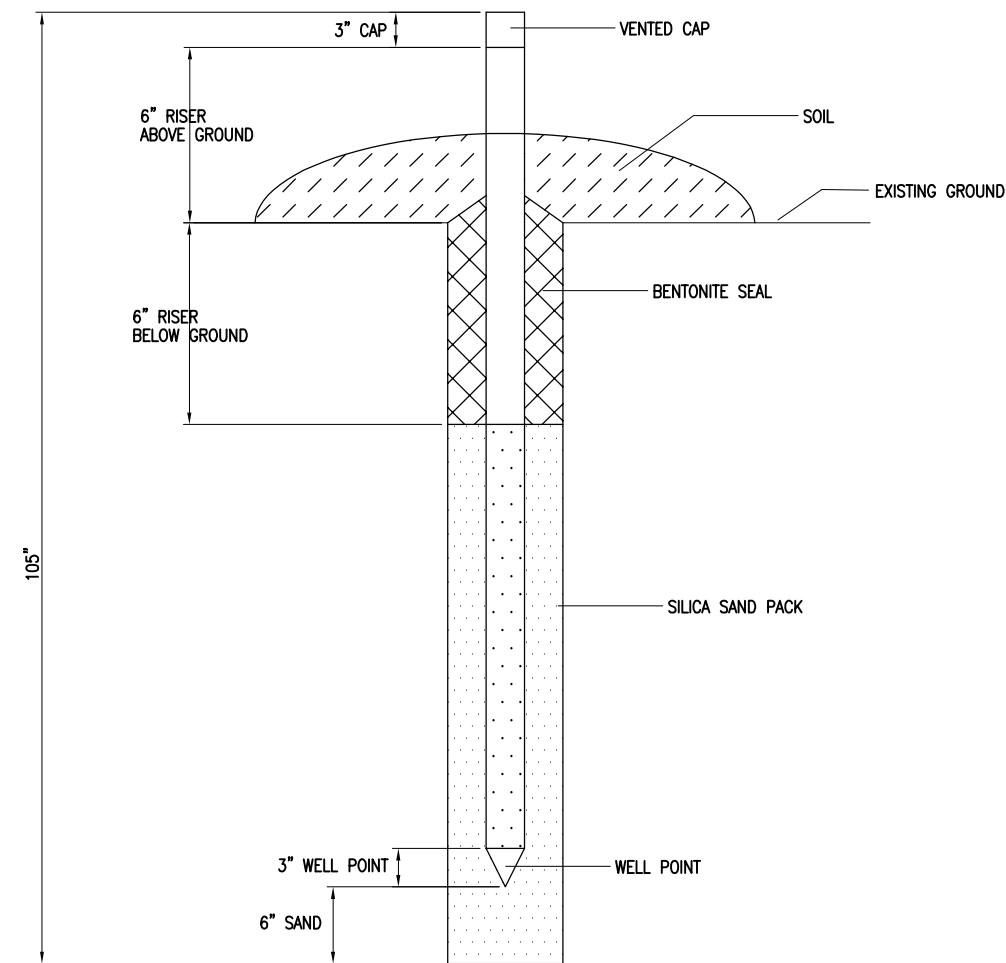

**MONITORING WELL DETAIL**  
"NOT TO SCALE"

**MONITOR WELL NOTES**

THE CONTRACTOR WILL FURNISH AND INSTALL FOUR MONITOR WELLS AT THE LOCATIONS SHOWN ON SHEET NO. 8.

THE PROPOSED MONITOR WELL WILL BE CONSTRUCTED IN ACCORDANCE WITH THE DETAIL ON THIS SHEET.

THE PROPOSED RISER WILL BE A 1 INCH ID PVC PIPE.

THE PROPOSED RISER CAP WILL BE PVC

THE PROPOSED SCREEN WILL BE A SLOTTED PVC PIPE WITH 0.006 INCH SLOTS

THE PROPOSED SAND PACK WILL BE 40-60 MESH SILICA SAND

THE PROPOSED MONITOR WELL WILL BE PAID FOR UNDER ITEM: AR800472 "MONITOR WELL" PER EACH.

REVISION	DATE	BY

**SAINT LOUIS DOWNTOWN AIRPORT**  
A Division of METRO

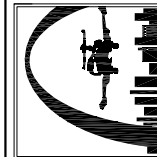

ILL. PROJ.: CPS-3916 A.I.P. PROJ.: 3-17-0039-B23

Hanson Project No.	84506RWYSS
Filename	R-523DET.DWG
Scale	N/A
Date	03/02/09
LAYOUT	CAH 03/10/09
DRAWN	CAH 03/10/09
REVIEWED	xxx xx/xx/xx



Hanson Professional Services Inc.  
4227 East City Expressway, Suite 130  
St. Louis, Missouri 63136  
Offices Nationwide

**CONSTRUCT WETLAND MITIGATION**

**MISCELLANEOUS DETAILS AND NOTES**

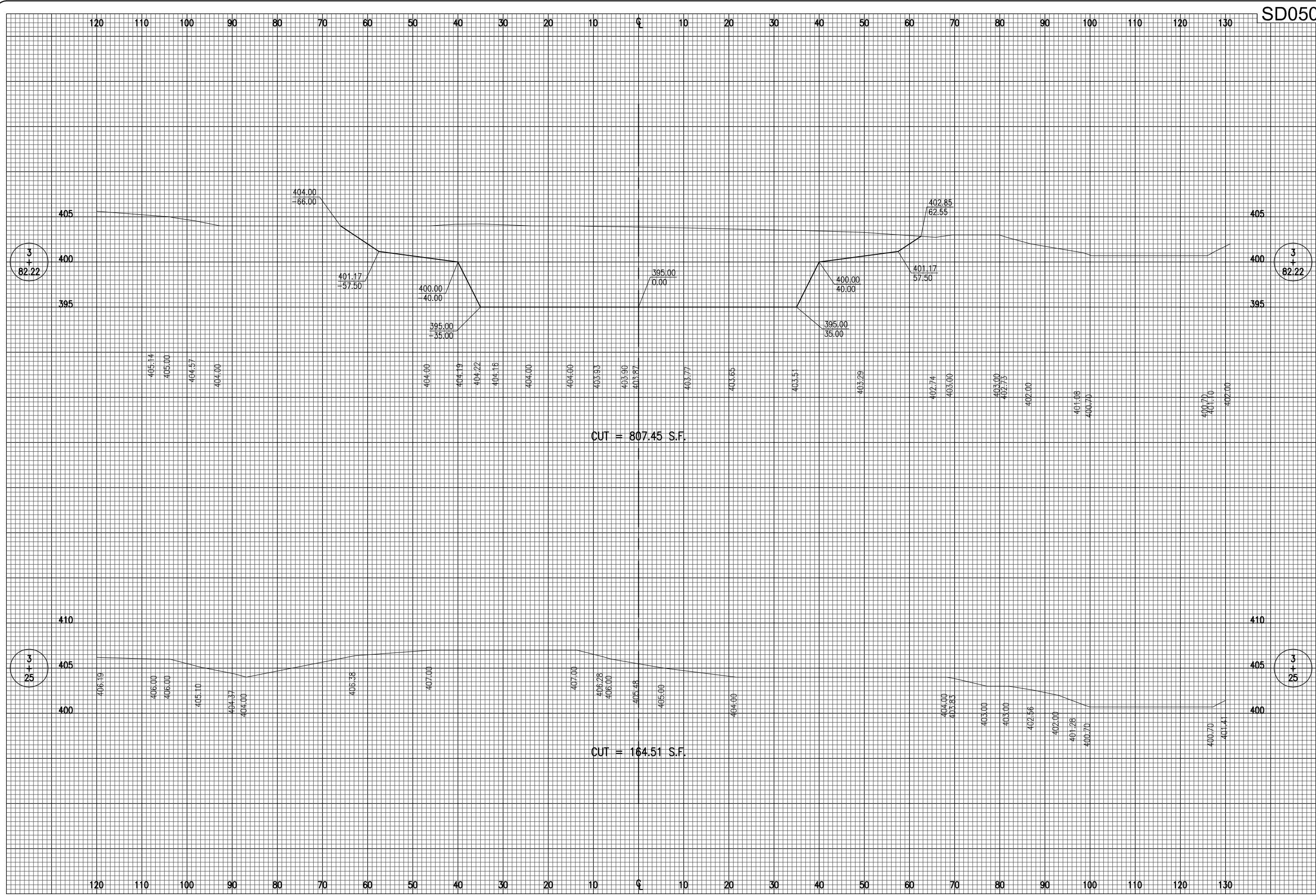

SD050

3  
+  
82.22

3  
+  
82.22

3  
+  
25

3  
+  
25

CUT = 807.45 S.F.

CUT = 164.51 S.F.

DATE	REVISION	BY

**SAINT LOUIS DOWNTOWN AIRPORT**  
A Division of METRO

ILL. PROJ.: CPS-3916  
A.I.P. PROJ.: 3-17-0039-B23

Hanson Project No.	84506RWYSS
Filename	R-301XS.DWG
Scale	
Date	2/18/09
LAYOUT	xx/xx/xx
DRAWN	DPE 2/18/09
REVIEWED	xxx xx/xx/xx

**HANSON**

Hanson Professional Services Inc.  
4227 East City Expressway, Suite 130  
St. Louis, Missouri 63106  
Offices Nationwide

**CONSTRUCT WETLAND MITIGATION**  
**PROPOSED CROSS-SECTIONS**  
**FOR**  
**STA. 3+25 TO STA. 3+82.22**

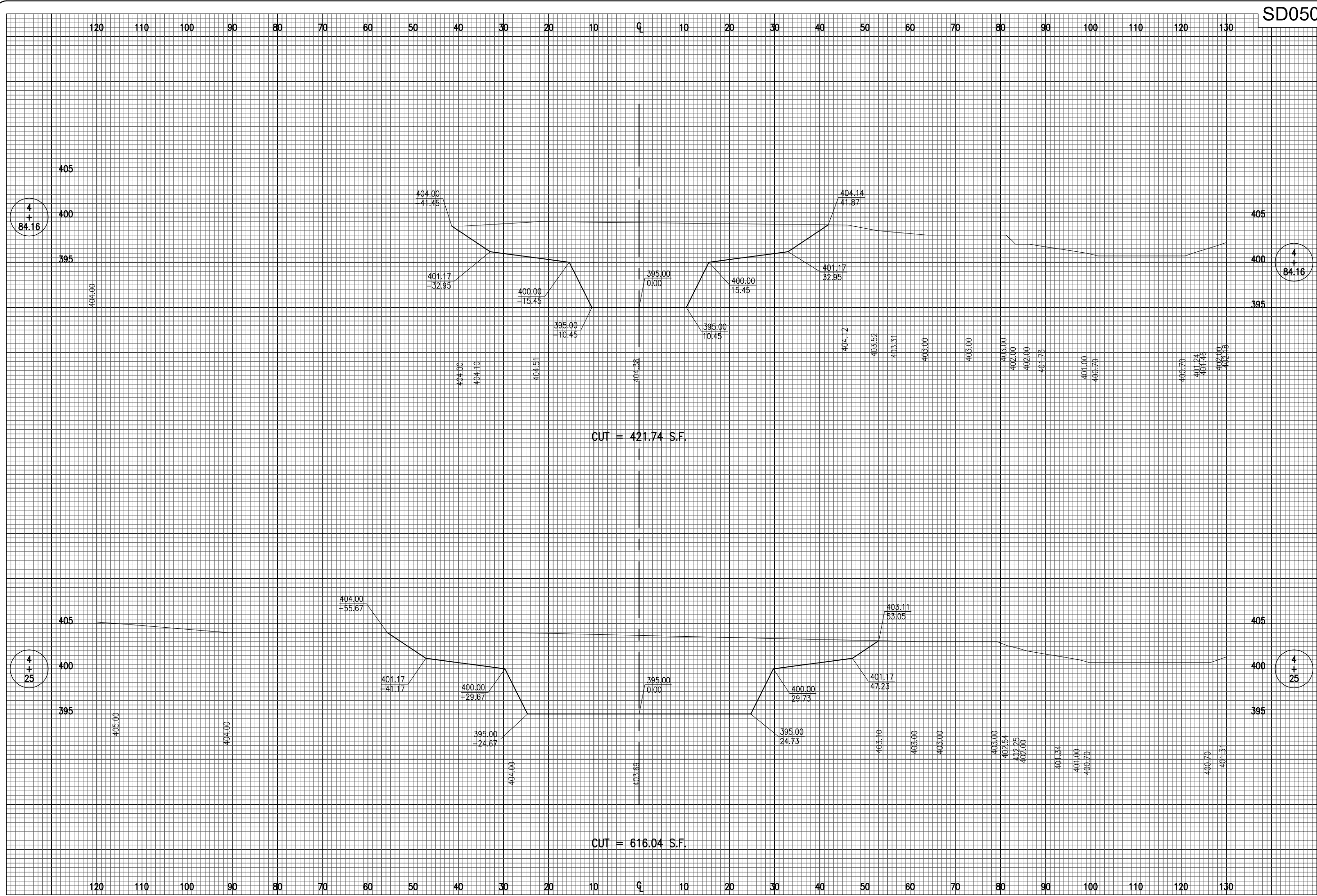

SD050

DATE	REVISION	BY

**SAINT LOUIS DOWNTOWN AIRPORT**  
 A Division of METRO

ILL. PROJ.: CPS-3916  
 A.I.P. PROJ.: 3-17-0039-B23

Hanson Project No. 84506RWYSS			
Filename R-302XS.DWG			
Scale	Date	LAYOUT	xx/xx/xx
	2/18/09	DRAWN	DPE 2/18/09
		REVIEWED	xxx xx/xx/xx

**HANSON**

Hanson Professional Services Inc.  
 4227 East City Expressway, Suite 130  
 St. Louis, Missouri 63106  
 Offices Nationwide

**CONSTRUCT WETLAND MITIGATION**  
**PROPOSED CROSS-SECTIONS**  
**FOR**  
**STA. 4+25 TO STA. 4+84.16**

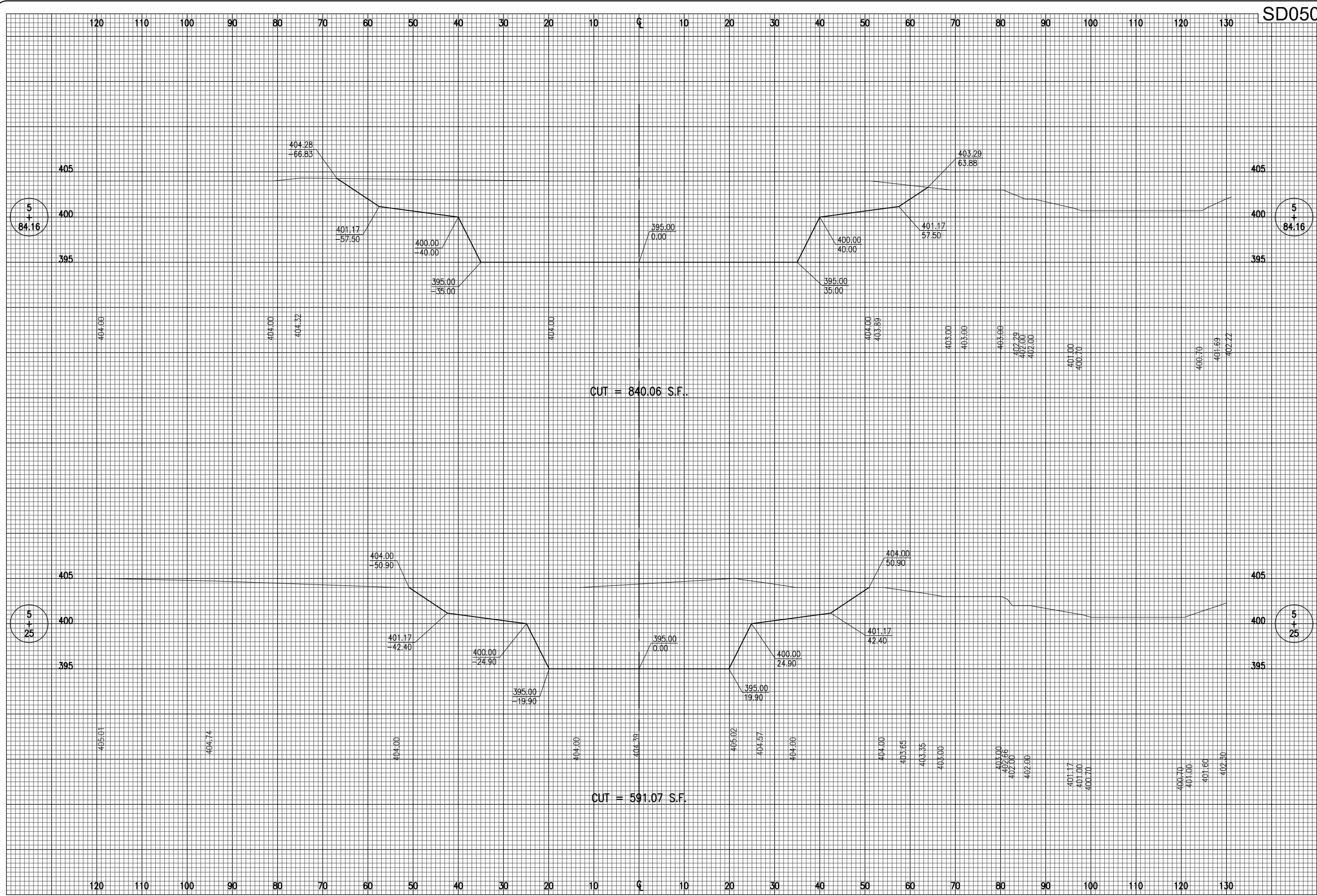

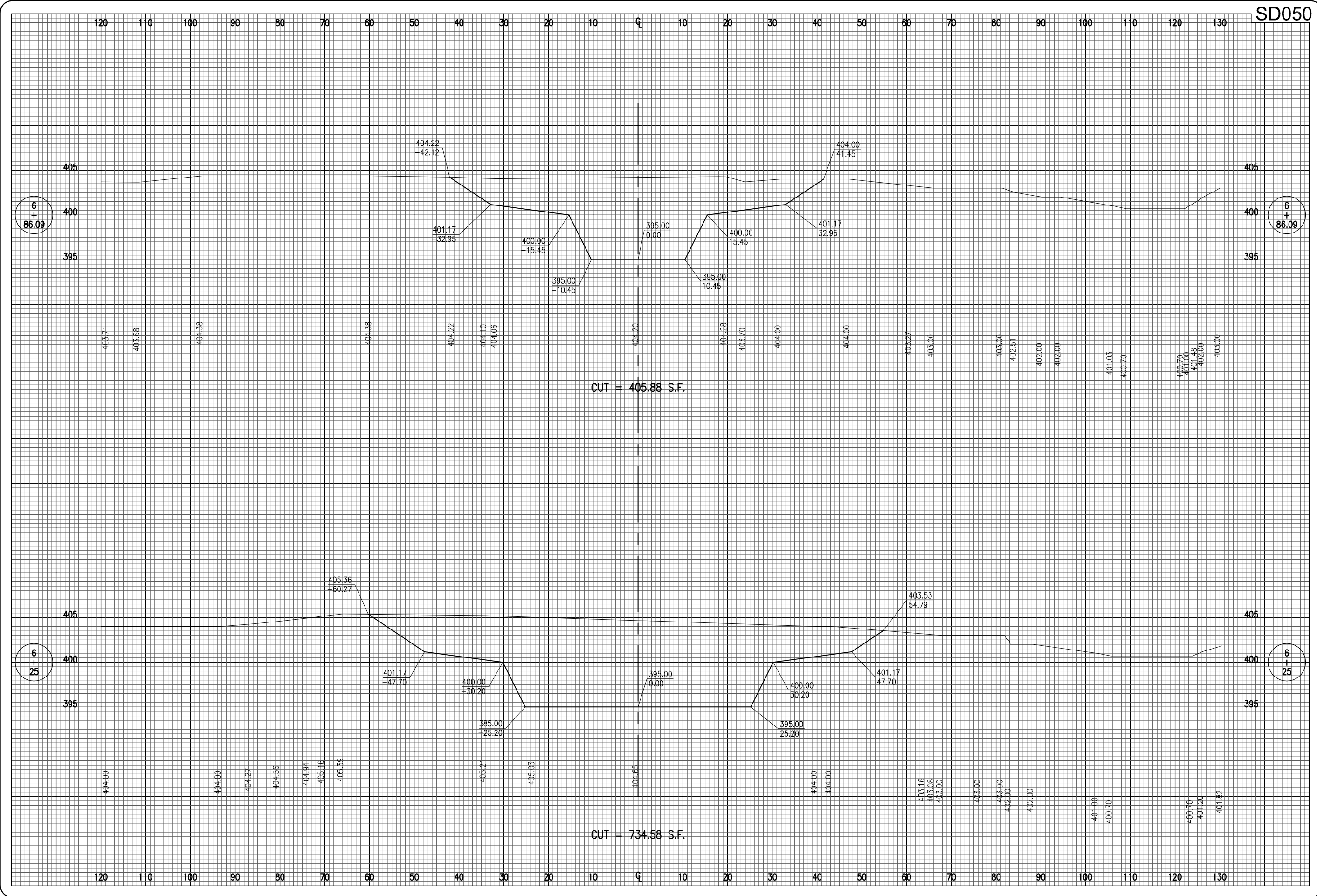

DATE	REVISION	BY

**SAINT LOUIS DOWNTOWN AIRPORT**  
 A Division of METRO

ILL. PROJ.: CPS-3916  
 A.I.P. PROJ.: 3-17-0039-B23

Hanson Project No. 84506RWYSS			
Filename R-304XS.DWG			
Scale	Date	LAYOUT	xx/xx/xx
	2/18/09	DRAWN	2/18/09
		REVIEWED	xxx

**HANSON**

Hanson Professional Services Inc.  
 4227 East City Expressway, Suite 130  
 St. Louis, Missouri 63106  
 Offices Nationwide

**CONSTRUCT WETLAND MITIGATION**  
**PROPOSED CROSS-SECTIONS FOR STA. 6+25 TO STA. 6+86.09**

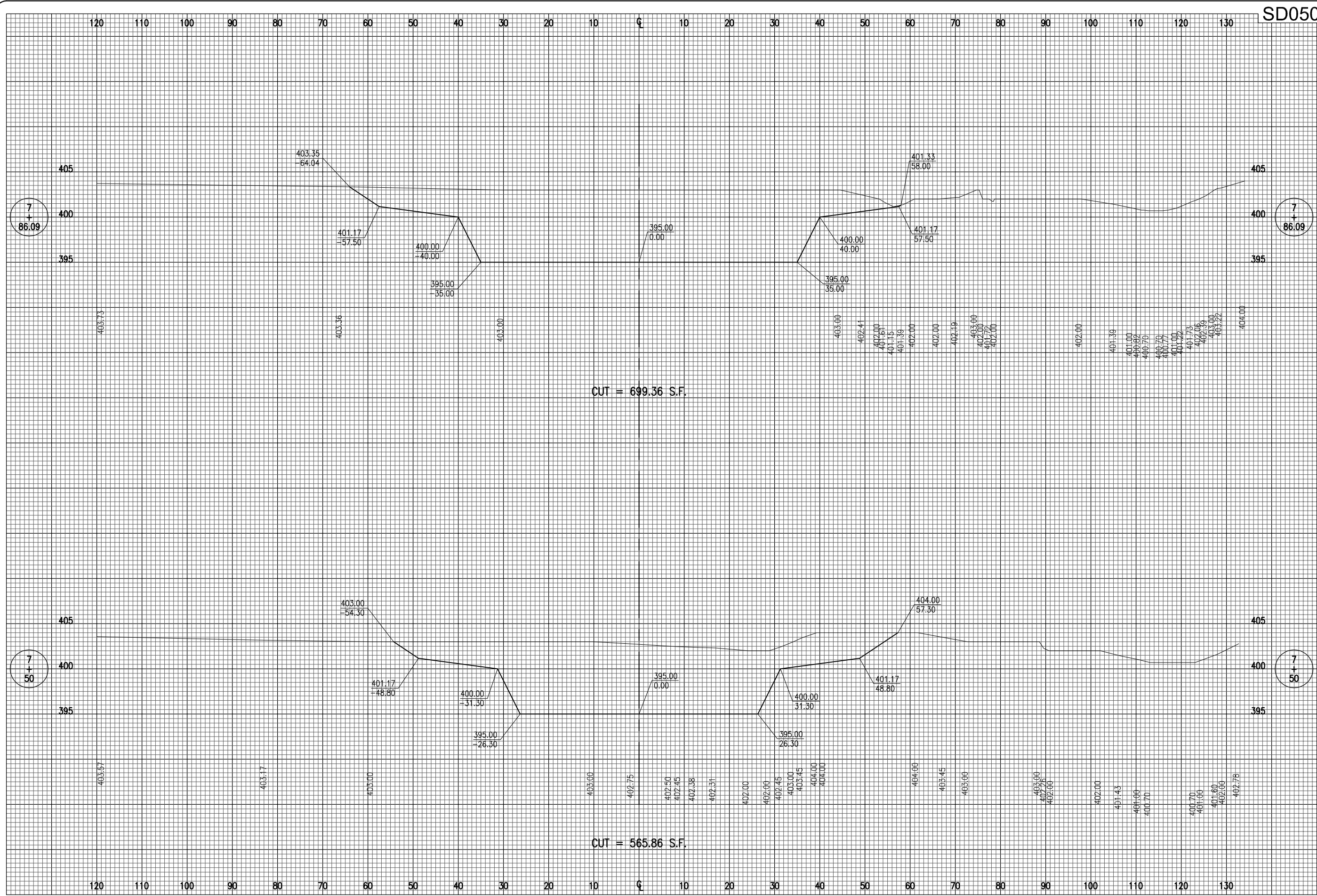

CUT = 699.36 S.F.

CUT = 565.86 S.F.

DATE	REVISION	BY

**SAINT LOUIS DOWNTOWN AIRPORT**  
A Division of METRO

ILL. PROJ.: CPS-3916  
A.I.P. PROJ.: 3-17-0039-B23

Hanson Project No. 84506RWYSS			
Filename R-305XS.DWG			
Scale		LAYOUT	xx/xx/xx
Date 2/18/09		DRAWN	DPE 2/18/09
		REVIEWED	xxx xx/xx/xx

**HANSON**

Hanson Professional Services Inc.  
4227 East City Expressway, Suite 130  
St. Louis, Missouri 63106  
Offices Nationwide

**CONSTRUCT WETLAND MITIGATION**  
**PROPOSED CROSS-SECTIONS FOR STA. 7+50 TO STA. 7+86.09**

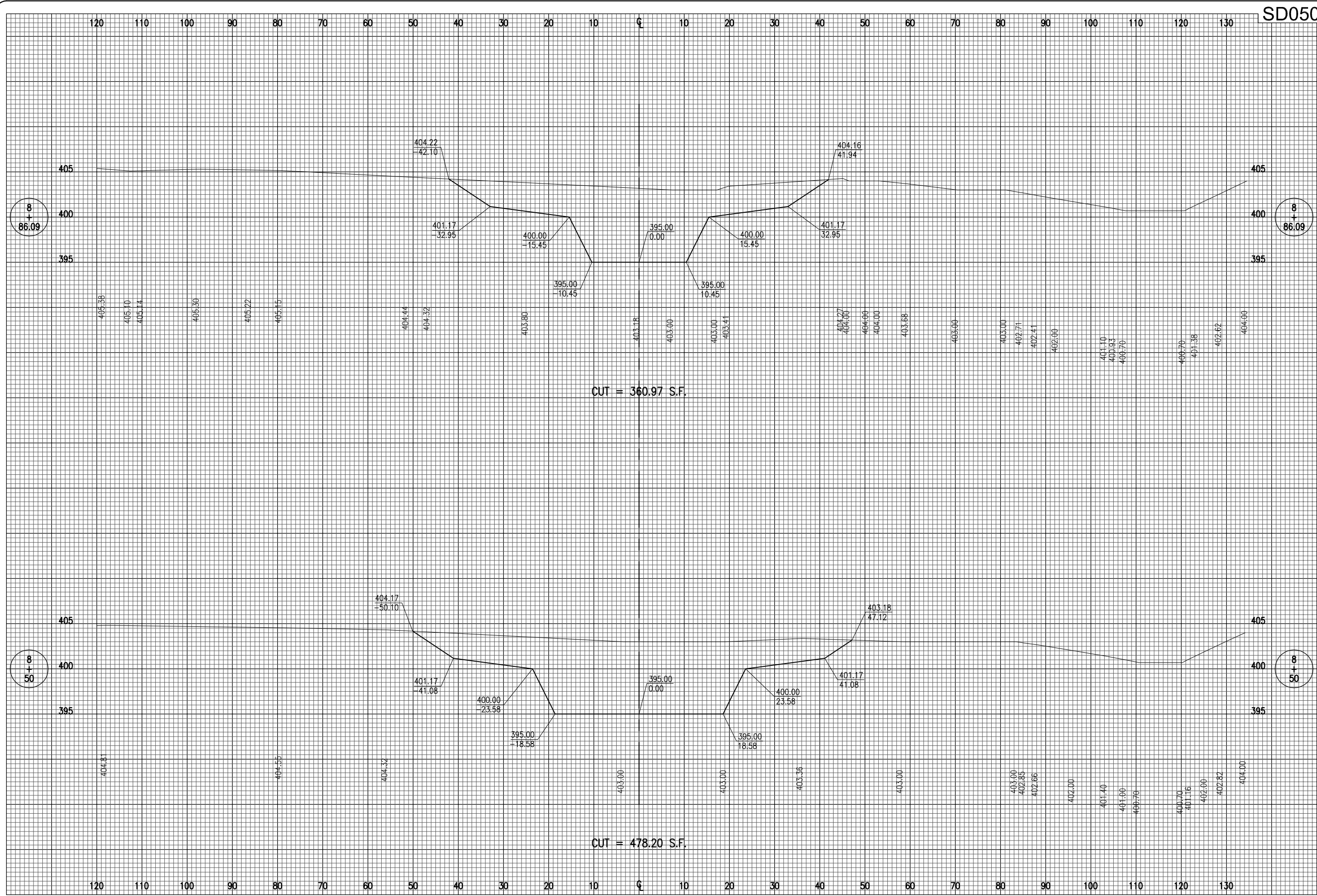

DATE	REVISION	BY

**SAINT LOUIS DOWNTOWN AIRPORT**  
 A Division of METRO

ILL. PROJ.: CPS-3916  
 A.I.P. PROJ.: 3-17-0039-B23

Hanson Project No. 84506RWYSS			
Filename R-306XS.DWG			
Scale			
Date 2/18/09			
LAYOUT			
DRAWN			
REVIEWED			

**HANSON**

Hanson Professional Services Inc.  
 4227 East City Expressway, Suite 130  
 St. Louis, Missouri 63106  
 Offices Nationwide

**CONSTRUCT WETLAND MITIGATION**  
**PROPOSED CROSS-SECTIONS**  
**FOR**  
**STA. 8+50 TO STA. 8+86.09**

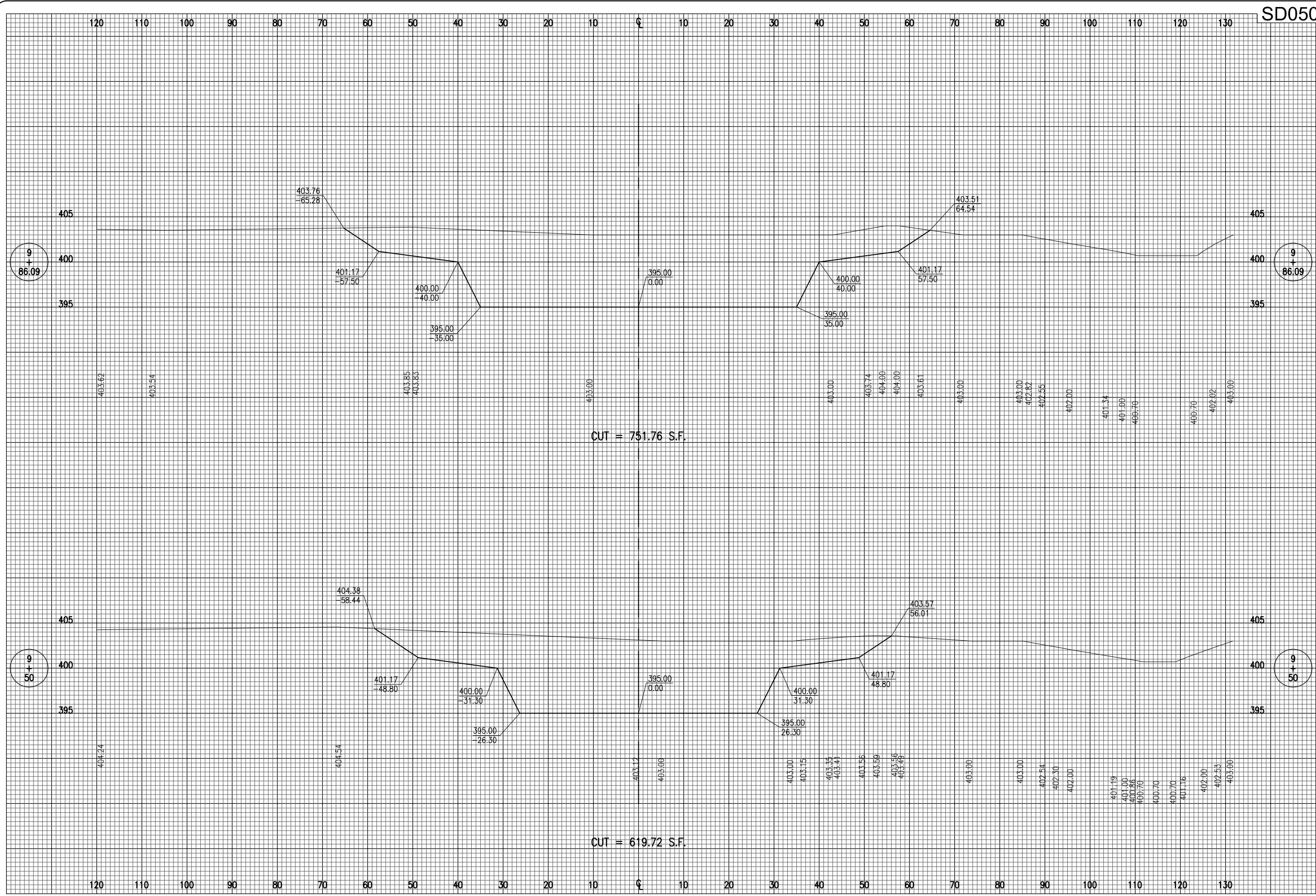

CUT = 751.76 S.F.

CUT = 619.72 S.F.

DATE	REVISION	BY

**SAINT LOUIS DOWNTOWN AIRPORT**  
 A Division of METRO

ILL. PROJ.: CPS-3916  
 A.I.P. PROJ.: 3-17-0039-B23

Hanson Project No. 84506RWYSS			
Filename R-307XS.DWG			
Scale		LAYOUT	xx/xx/xx
Date 2/18/09		DRAWN	DPE 2/18/09
		REVIEWED	xxx xx/xx/xx

**HANSON**

Hanson Professional Services Inc.  
 4227 East City Expressway, Suite 130  
 St. Louis, Missouri 63106  
 Offices Nationwide

**CONSTRUCT WETLAND MITIGATION**  
**PROPOSED CROSS-SECTIONS FOR STA. 9+50 TO STA. 9+86.09**



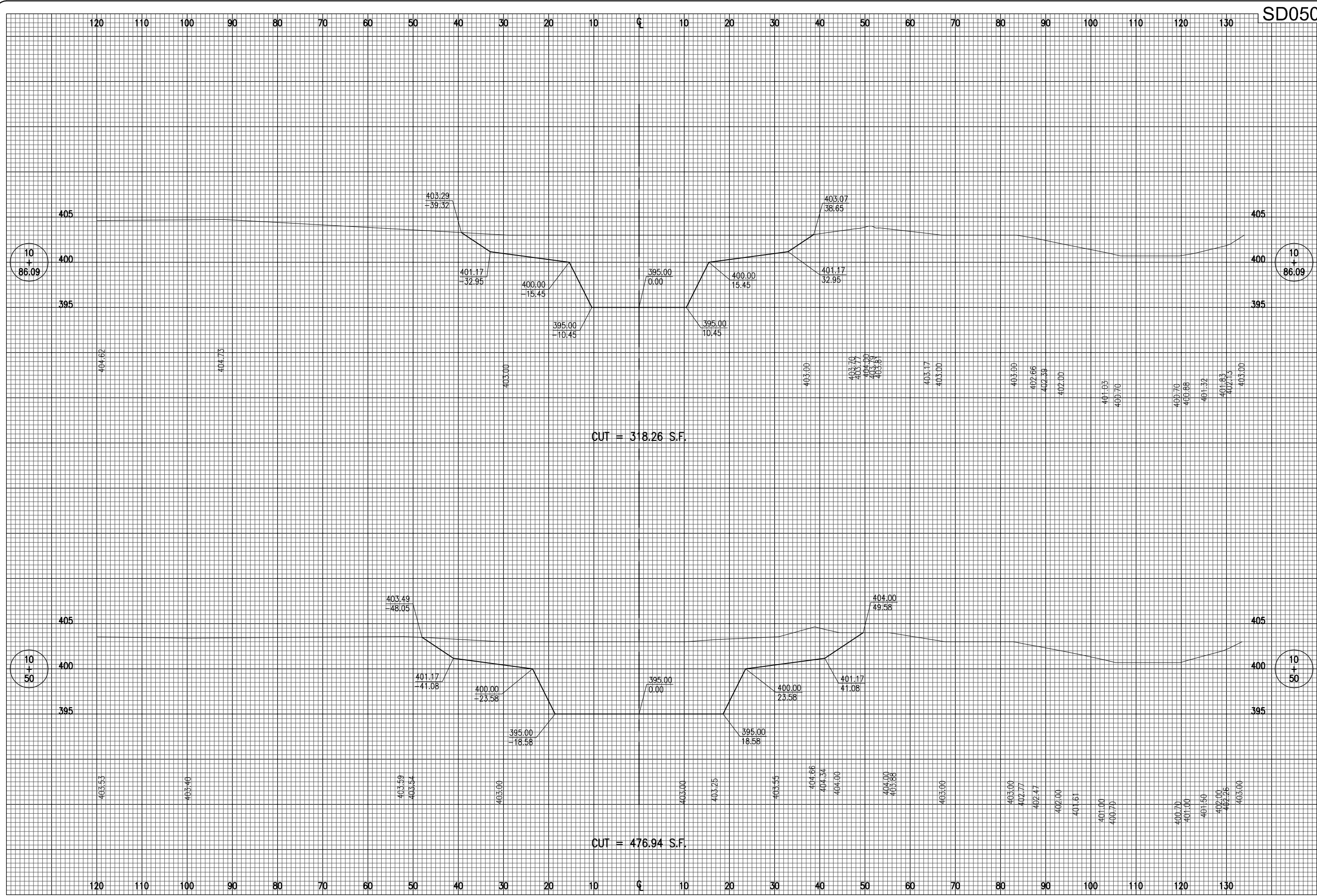

DATE	REVISION	BY

**SAINT LOUIS DOWNTOWN AIRPORT**  
 A Division of METRO

ILL. PROJ.: CPS-3916  
 A.I.P. PROJ.: 3-17-0039-B23

Hanson Project No. 84506RWYSS			
Filename R-308XS.DWG			
Scale			
Date 2/18/09			
LAYOUT			
DRAWN			
REVIEWED			

**HANSON**

Hanson Professional Services Inc.  
 4227 East City Expressway, Suite 130  
 St. Louis, Missouri 63106  
 Offices Nationwide

**CONSTRUCT WETLAND MITIGATION**  
**PROPOSED CROSS-SECTIONS FOR**  
**STA. 10+50 TO STA. 10+86.09**

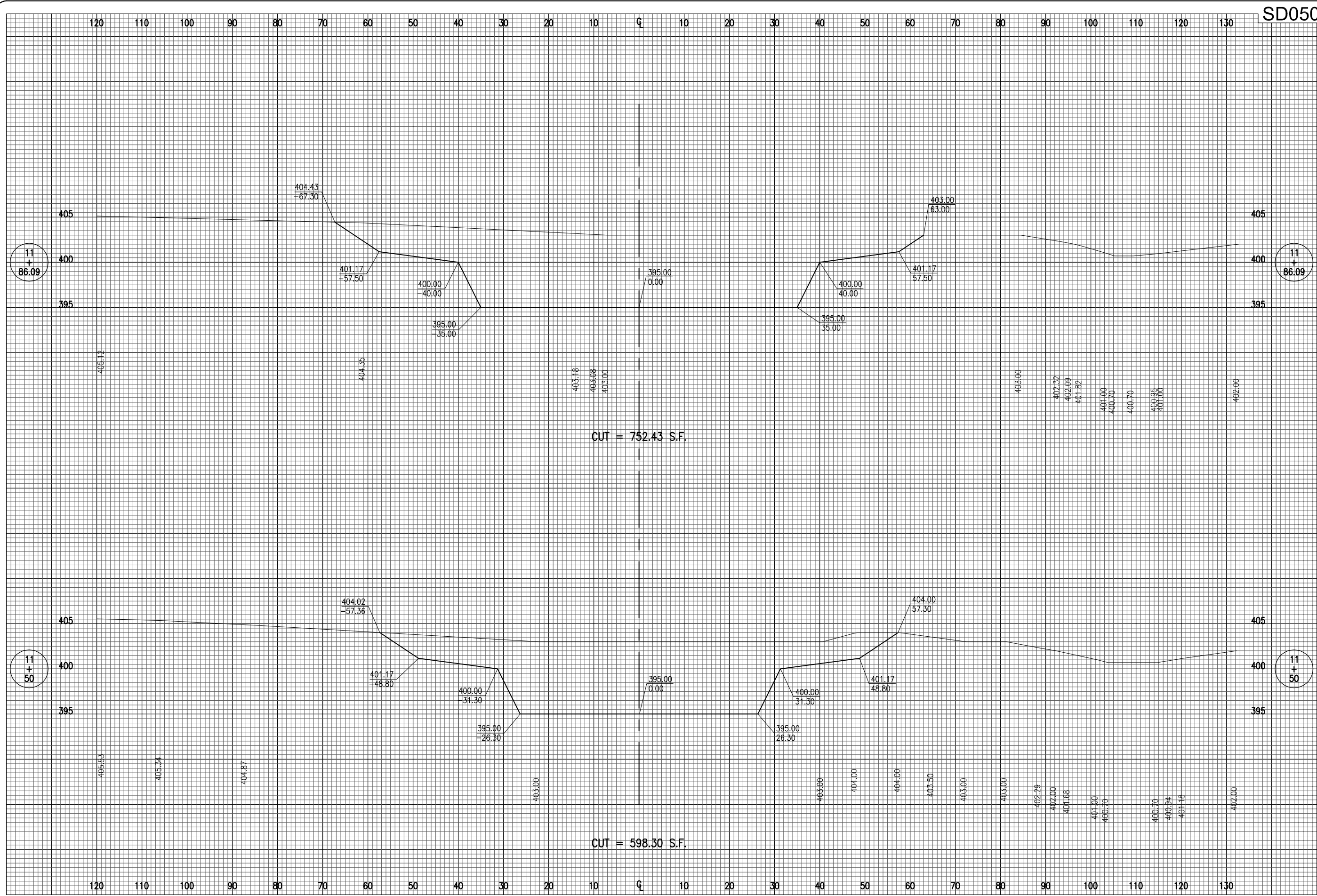

SD050

DATE	REVISION	BY

**SAINT LOUIS DOWNTOWN AIRPORT**  
 A Division of METRO

ILL. PROJ.: CPS-3916  
 A.I.P. PROJ.: 3-17-0039-B23

Hanson Project No. 84506RWYSS			
Filename R-309XS.DWG			
Scale		LAYOUT	xx/xx/xx
Date 2/18/09		DRAWN	DPE 2/18/09
		REVIEWED	xxx xx/xx/xx

**HANSON**

Hanson Professional Services Inc.  
 4227 East City Expressway, Suite 130  
 St. Louis, Missouri 63106  
 Offices Nationwide

**CONSTRUCT WETLAND MITIGATION**  
**PROPOSED CROSS-SECTIONS FOR STA. 11+50 TO STA. 11+86.09**

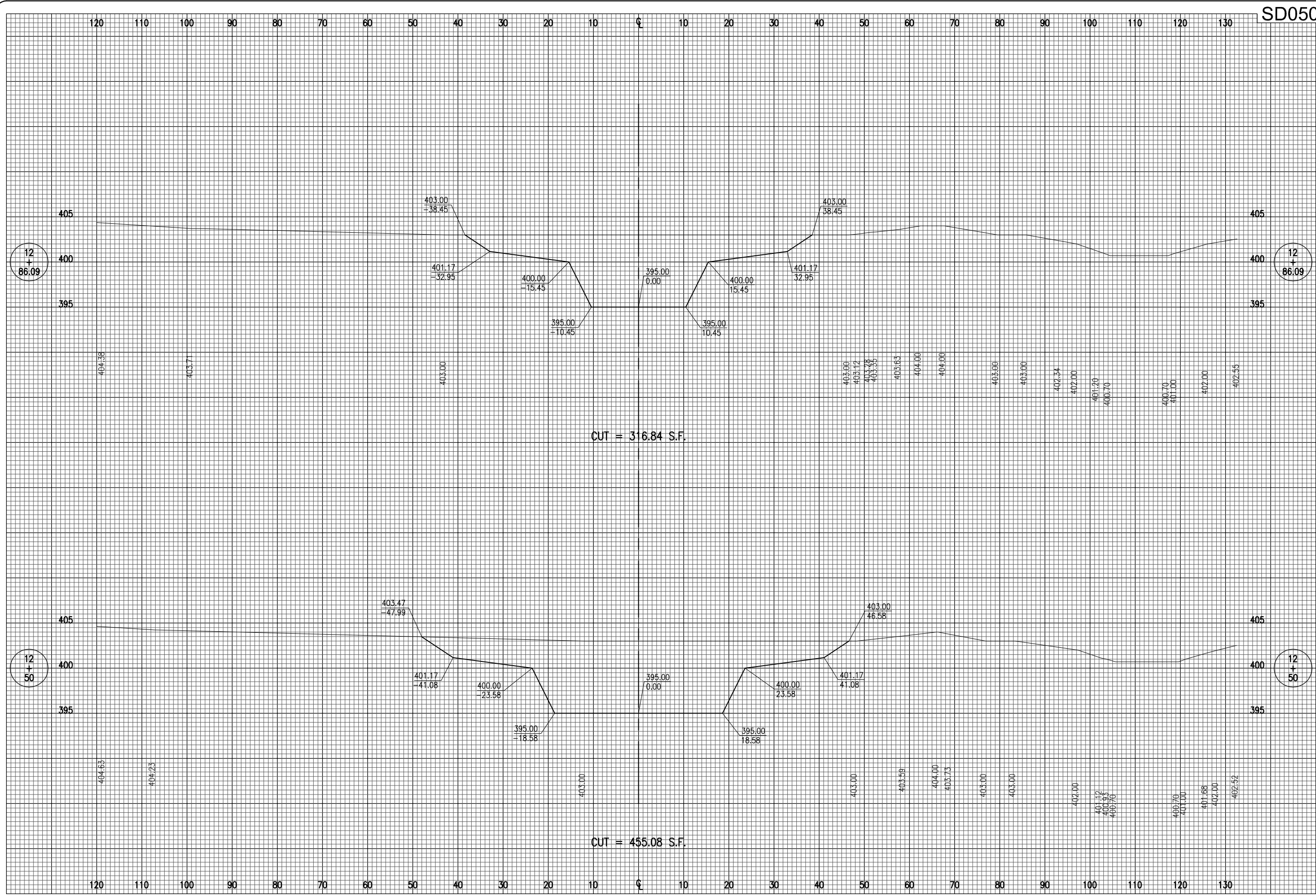

SD050

12  
+  
86.09

12  
+  
86.09

12  
+  
50

12  
+  
50

CUT = 316.84 S.F.

CUT = 455.08 S.F.

DATE	REVISION	BY

**SAINT LOUIS DOWNTOWN AIRPORT**  
 A Division of METRO

ILL. PROJ.: CPS-3916  
 A.I.P. PROJ.: 3-17-0039-B23

Hanson Project No.	84506RWYSS
Filename	R-310XS.DWG
Scale	
Date	2/18/09
LAYOUT	xx/xx/xx
DRAWN	DPE 2/18/09
REVIEWED	xxx xx/xx/xx

**HANSON**

Hanson Professional Services Inc.  
 4227 East City Expressway, Suite 130  
 St. Louis, Missouri 63106  
 Offices Nationwide

**CONSTRUCT WETLAND MITIGATION**  
**PROPOSED CROSS-SECTIONS FOR**  
**STA. 12+50 TO STA. 12+86.09**

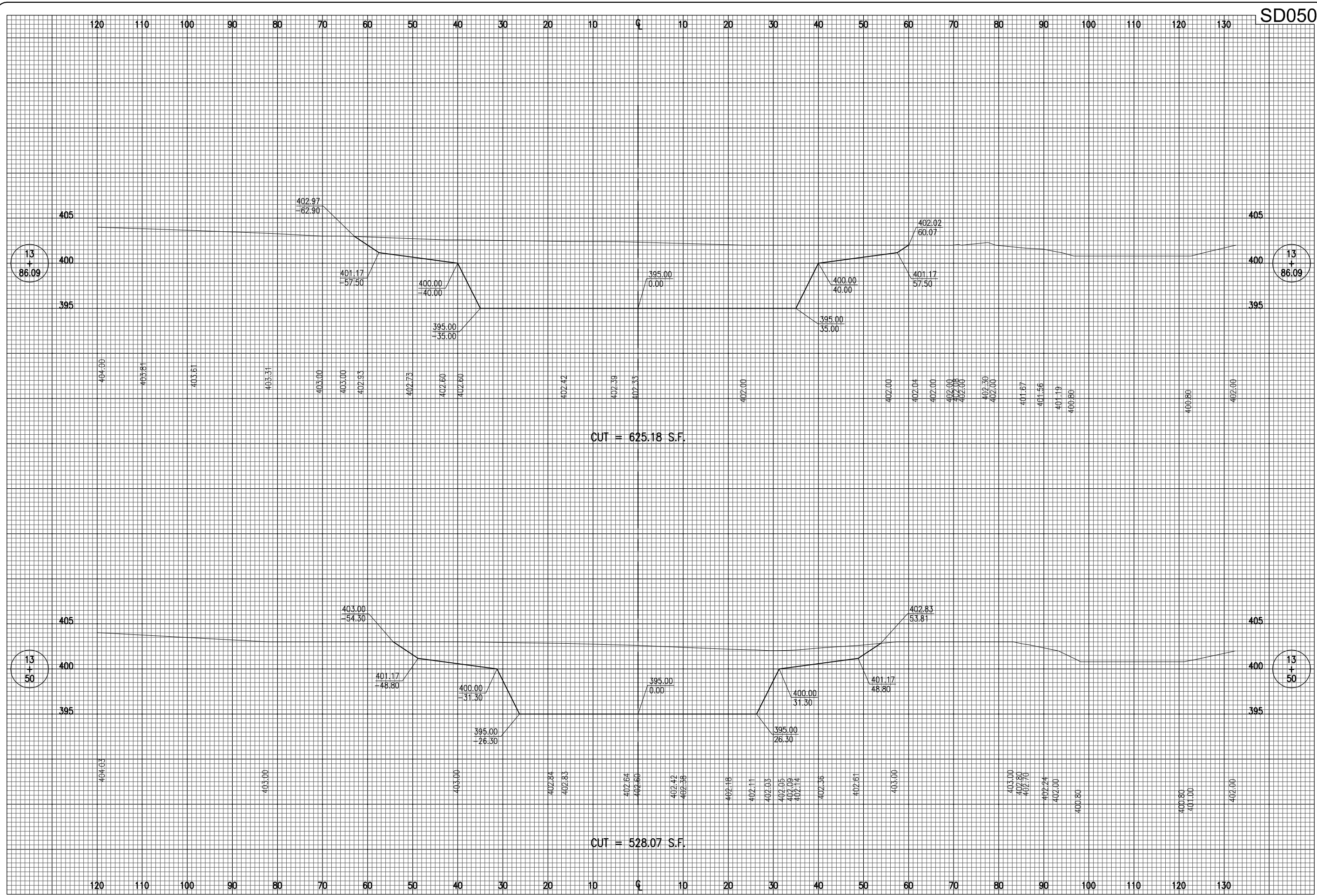

SD050

DATE	REVISION	BY

**SAINT LOUIS DOWNTOWN AIRPORT**  
 A Division of METRO  
  
 IL PROJ.: CFS-3916  
 A.I.P. PROJ.: 3-17-0039-B23

Hanson Project No.	84506RWYSS
Filename	R-311XS.DWG
Scale	
Date	2/18/09
LAYOUT	xxx
DRAWN	DPE
REVIEWED	xxx
	xx/xx/xx
	xx/xx/xx
	xx/xx/xx

**HANSON**  
 Hanson Professional Services Inc.  
 4227 Earth City Expressway, Suite 130  
 St. Louis, MO 63045-1308  
 Offices Nationwide

**CONSTRUCT WETLAND MITIGATION**  
 PROPOSED CROSS-SECTIONS  
 FOR  
 STA. 13+50 TO STA. 13+86.09

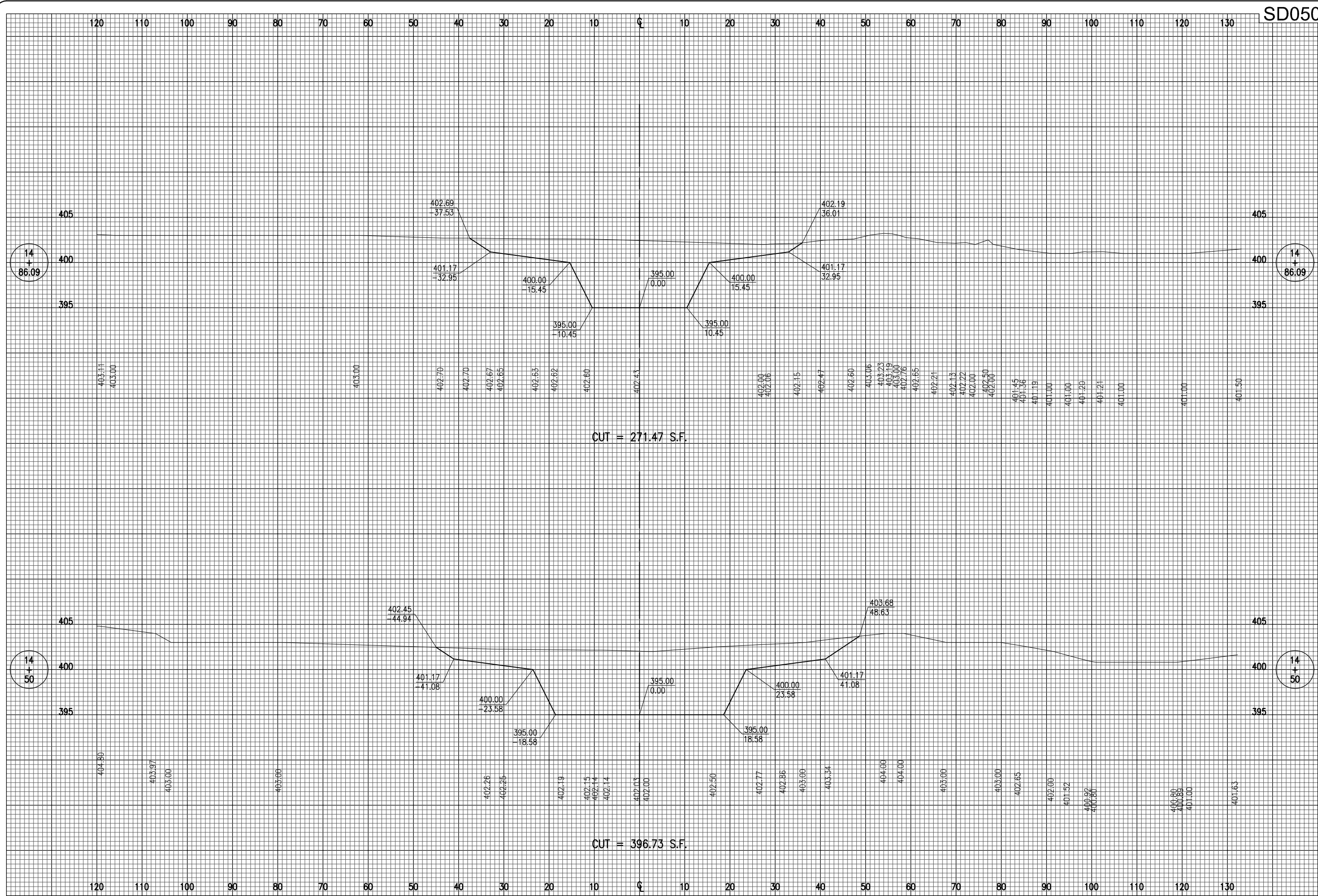

SD050

14  
+  
86.09

14  
+  
86.09

14  
+  
50

14  
+  
50

CUT = 271.47 S.F.

CUT = 396.73 S.F.

DATE	REVISION	BY

**SAINT LOUIS DOWNTOWN AIRPORT**  
 A Division of METRO

ILL. PROJ.: CPS-3916  
 A.I.P. PROJ.: 3-17-0039-B23

Hanson Project No.	84506RWYSS
Filename	R-312XS.DWG
Scale	
Date	2/18/09
LAYOUT	xx/xx/xx
DRAWN	DPE 2/18/09
REVIEWED	xxx xx/xx/xx

**HANSON**

Hanson Professional Services Inc.  
 4227 East City Expy, Suite 130  
 St. Louis, MO 63114  
 Offices Nationwide

**CONSTRUCT WETLAND MITIGATION**  
**PROPOSED CROSS-SECTIONS FOR STA. 14+50 TO STA. 14+86.09**

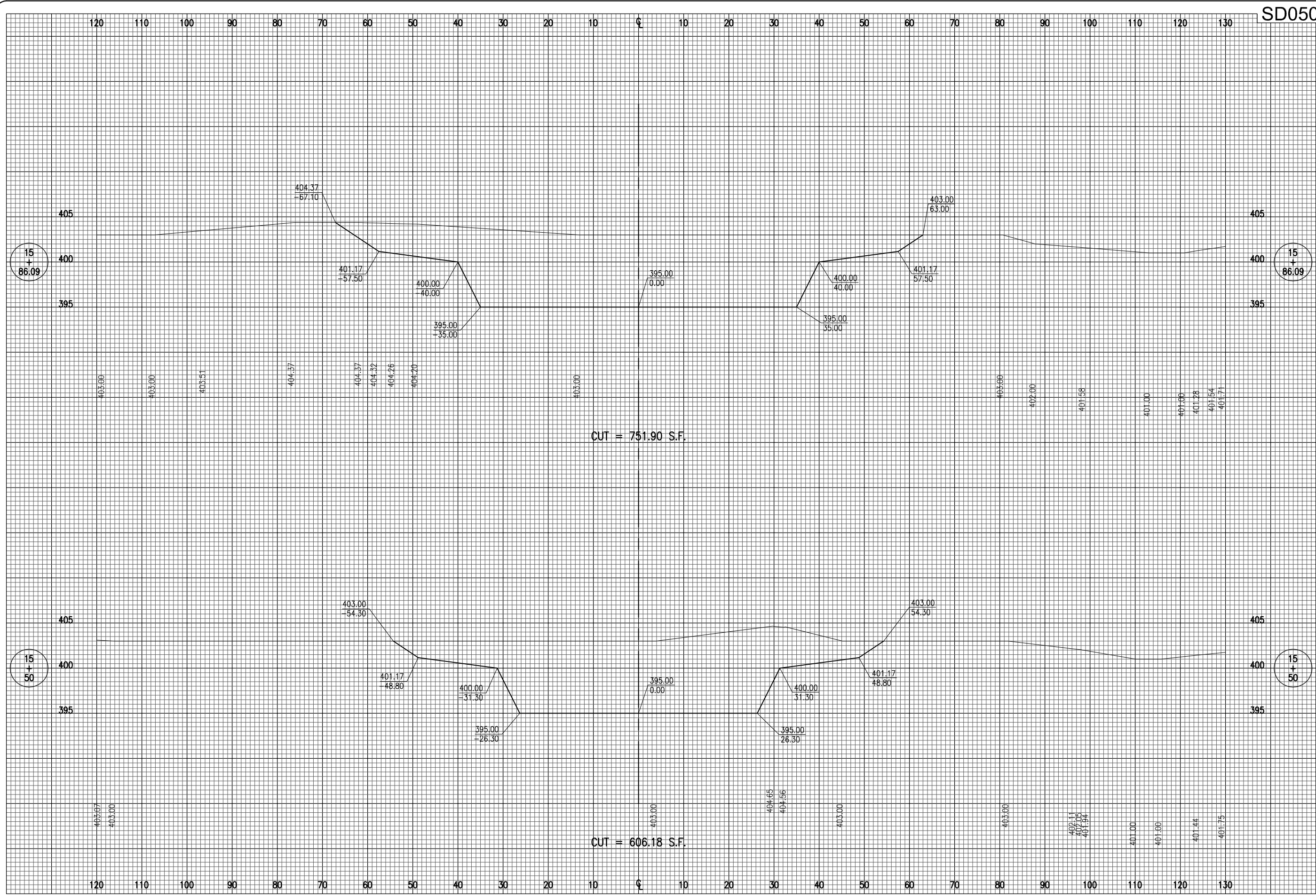

CUT = 751.90 S.F.

CUT = 606.18 S.F.

DATE	REVISION	BY

**SAINT LOUIS DOWNTOWN AIRPORT**  
A Division of METRO

ILL. PROJ.: CPS-3916  
A.I.P. PROJ.: 3-17-0039-B23

Hanson Project No.	84506RWYSS
Filename	R-313XS.DWG
Scale	
Date	2/18/09
LAYOUT	xx/xx/xx
DRAWN	DPE 2/18/09
REVIEWED	xxx xx/xx/xx

**HANSON**

Hanson Professional Services Inc.  
4227 East City Expressway, Suite 130  
St. Louis, MO 63117  
Offices Nationwide

CONSTRUCT WETLAND MITIGATION  
PROPOSED CROSS-SECTIONS  
FOR  
STA. 15+50 TO STA. 15+86.09

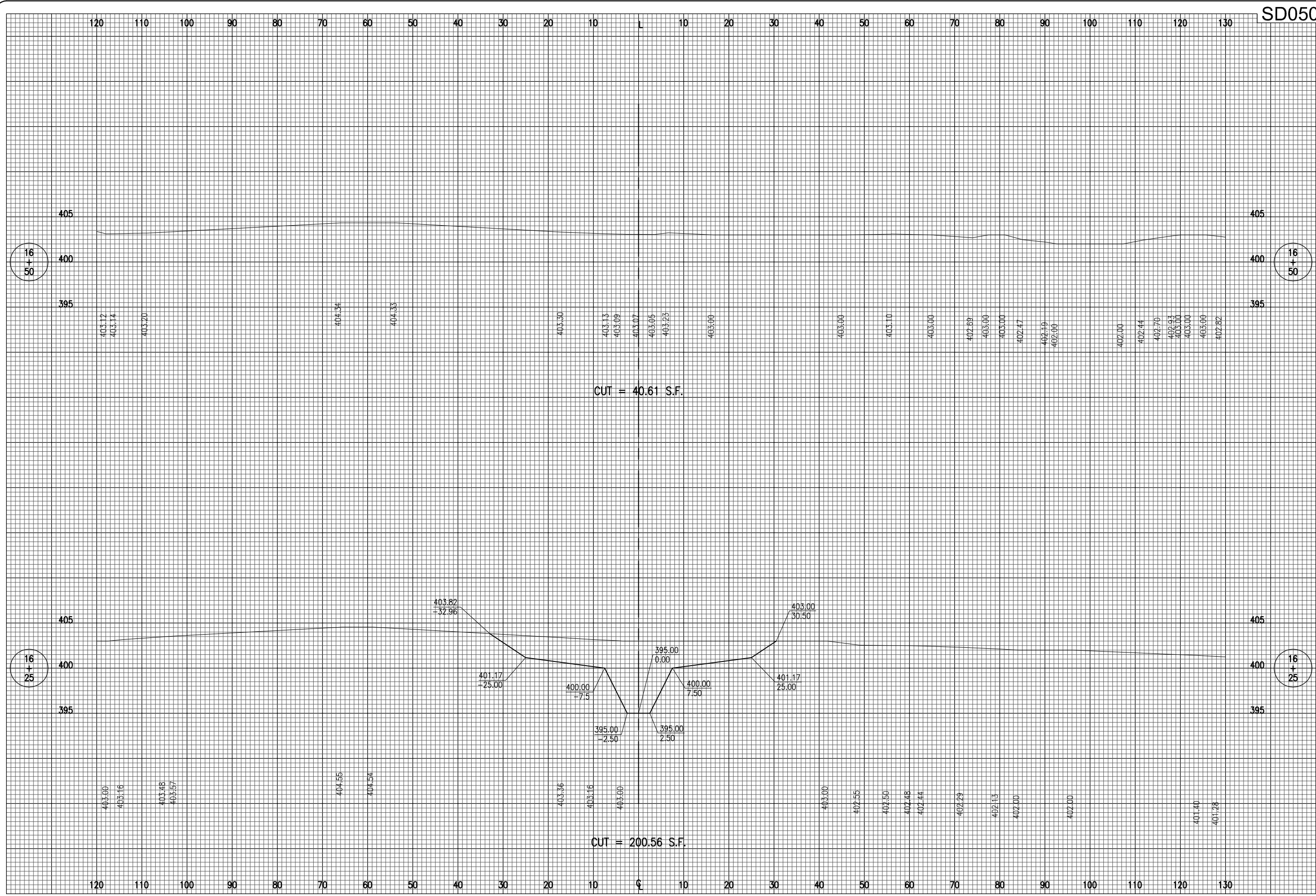

CUT = 40.61 S.F.

CUT = 200.56 S.F.

DATE	REVISION	BY

**SAINT LOUIS DOWNTOWN AIRPORT**  
 A Division of METRO  
 ILL. PROJ.: CPS-3916 A.I.P. PROJ.: 3-17-0039-B23

Hanson Project No. 84506RWYSS			
Filename R-314XS.DWG			
Scale		LAYOUT	xx/xx/xx
Date 2/18/09		DRAWN	DPE 2/18/09
		REVIEWED	xxx xx/xx/xx

**HANSON**  
 Hanson Professional Services Inc.  
 4227 East City Expy, Suite 130  
 St. Louis, MO 63114  
 Offices Nationwide

**CONSTRUCT WETLAND MITIGATION**  
**PROPOSED CROSS-SECTIONS**  
 FOR  
 STA. 16+25 TO STA. 16+50