

STATE OF ILLINOIS
 DEPARTMENT OF TRANSPORTATION
 DIVISION OF HIGHWAYS
**PLANS FOR PROPOSED
 FEDERAL AID PROJECT**

FAU ROUTE 1300 (CENTRAL ROAD) AT WELLER LANE
 SAFE ROUTES TO SCHOOL
 SECTION 14-00162-00-SP
 PROJECT NO. SRTS-4009(323)
 PEDESTRIAN CROSSING IMPROVEMENTS
 VILLAGE OF MOUNT PROSPECT
 COOK COUNTY

F.A.U. RTE.	SECTION	COUNTY	TOTAL SHEETS	SHEET NO.
1300	14-00162-00-SP	COOK	16	1
		ILLINOIS	CONTRACT NO. 61B72	

16 + 1 = 17

FOR INDEX OF SHEETS, SEE SHEET NO. 2

FOR LIST OF HIGHWAY STANDARDS, SEE SHEET NO. 2

THESE IMPROVEMENTS ARE LOCATED WITHIN
 THE VILLAGE OF MOUNT PROSPECT

STREET	FUNCTIONAL CLASS	ADT	POSTED SPEED
CENTRAL RD.	MINOR ARTERIAL	21,600	35 MPH

C-91-246-15

LOCATION MAP
 NOT TO SCALE

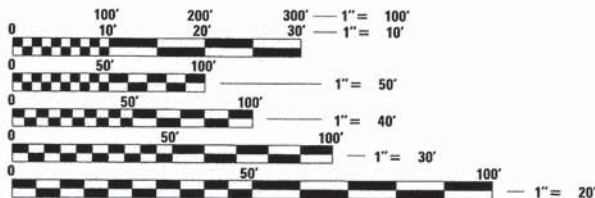

FULL SIZE PLANS HAVE BEEN PREPARED USING STANDARD
 ENGINEERING SCALES. REDUCED SIZED PLANS WILL NOT
 CONFORM TO STANDARD SCALES. IN MAKING MEASUREMENTS
 ON REDUCED PLANS, THE ABOVE SCALES MAY BE USED.

J.U.L.I.E.
 JOINT UTILITY LOCATION INFORMATION FOR EXCAVATION
 1-800-892-0123
 OR 811

Ciorba Group, Inc.

DESIGN FIRM
 REGISTRATION NUMBER
 184-001016

CONSULTING ENGINEERS
 SUITE 402, 5507 NORTH CUMBERLAND AVE
 CHICAGO, ILLINOIS 60656 :: (773) 775-4009

CENTRAL ROAD AND
 WELLER LANE

BEGIN STA
 112+83.70

END STA
 114+32.20

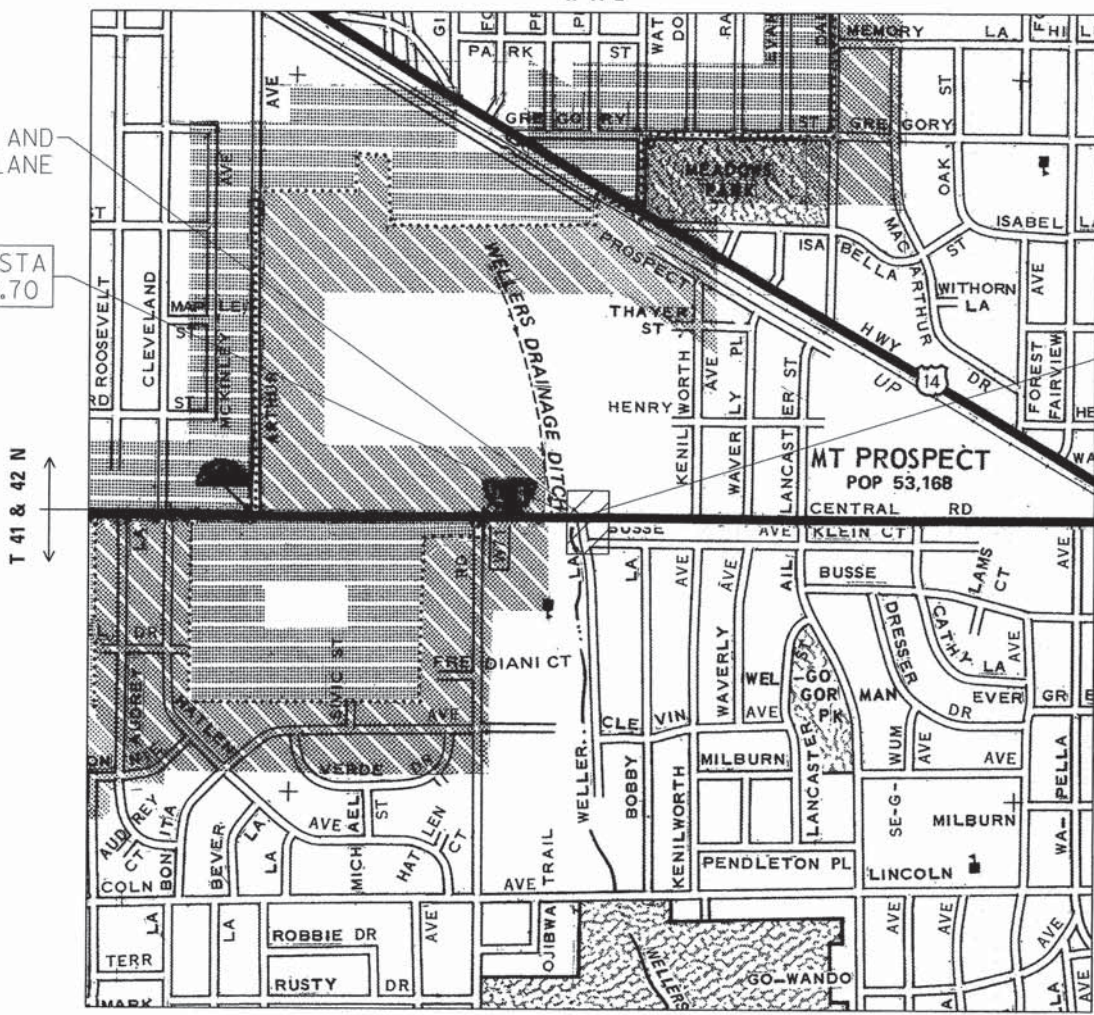

GROSS LENGTH = NET LENGTH = 150 FT. = 0.03 MILE

STATE OF ILLINOIS DEPARTMENT OF TRANSPORTATION
 DIVISION OF HIGHWAYS

Approved May 4, 2015
Jeffrey P. Wulbecker
 VILLAGE OF MOUNT PROSPECT, VILLAGE ENGINEER

Passed MAY 22, 2015
Christopher Holt
 District 1 Engineer of Local Roads & Streets

Releasing for Bid
 Based on Limited
 Review May 26 2015
John F. ...
 District 1 Engineer of Highways, Region 1 Engineer



PRINTED BY THE AUTHORITY
 OF THE STATE OF ILLINOIS

CONSULTANT ENGINEER: JOSEPH P. ATTANASEO, P.E. CIORBA GROUP, INC.
 FEDERAL AID PROGRAM ENGINEER: FAWAD AQUELLE, P.E. 847-705-4021 SCHAUMBURG

CONTRACT NO. 61B72

INDEX OF SHEETS

- 1 TITLE SHEET
- 2 STATE STANDARDS, GENERAL NOTES & INDEX
- 3-4 SUMMARY OF QUANTITIES
- 5-6 EXISTING AND PROPOSED TYPICAL SECTIONS
- 7 ALIGNMENT, TIES, AND BENCHMARKS
- 8 REMOVAL PLAN
- 9 PROPOSED PLAN
- 10 INTERSECTION DETAILS
- 11 PAVEMENT MARKING AND LANDSCAPING PLAN
- 12 LANDSCAPING DETAIL
- 13 SIGNING PLAN
- 13A SIGNING DETAIL
- 14 DISTRICT ONE TRAFFIC CONTROL AND PROTECTION FOR SIDE ROADS, INTERSECTIONS, AND DRIVEWAYS (TC-10)
- 15 DISTRICT ONE TYPICAL PAVEMENT MARKINGS (TC-13)
- 16 DISTRICT ONE ARTERIAL ROAD INFORMATION SIGN (TC-22)

STATE STANDARDS

- 000001-06 STANDARD SYMBOLS, ABBREVIATIONS AND PATTERNS
- 001001-02 AREAS OF REINFORCEMENT BARS
- 001006 DECIMAL OF AN INCH AND OF A FOOT
- 280001-07 TEMPORARY EROSION CONTROL SYSTEMS
- 420001-08 PAVEMENT JOINTS
- 424001-08 PERPENDICULAR CURB RAMPS FOR SIDEWALKS
- 424011-02 CORNER PARALLEL CURB RAMPS FOR SIDEWALKS
- 424016-02 MID-BLOCK CURB RAMPS FOR SIDEWALKS
- 424021-03 DEPRESSED CORNER FOR SIDEWALKS
- 424031-01 MEDIAN PEDESTRIAN CROSSINGS
- 542011 CONCRETE END SECTIONS FOR ELLIPTICAL PIPE CULVERTS 15" (375 mm) THRU 72" (1800 mm) EQUIVALENT DIAMETER
- 602301-04 INLET - TYPE A
- 604091-03 FRAME AND GRATE, TYPE 24
- 606001-06 CONCRETE CURB TYPE B AND COMBINATION CONCRETE CURB AND GUTTER
- 606301-04 PC CONCRETE ISLANDS AND MEDIANS
- 701101-04 OFF-RD OPERATIONS, MULTILANE, 15' (4.5 m) TO 24" (600 mm) FROM PAVEMENT EDGE
- 701427-03 LANE CLOSURE, MULTILANE, INTERMITTENT OR MOVING OPERATION, FOR SPEED <= 40 MPH
- 701602-07 URBAN LANE CLOSURE, MULTILANE, 2W WITH BIDIRECTIONAL LEFT TURN LANE
- 701701-09 URBAN LANE CLOSURE, MULTILANE INTERSECTION
- 701801-05 LANE CLOSURE, MULTILANE 1W OR 2W CROSSWALK OR SIDEWALK CLOSURE
- 701901-04 TRAFFIC CONTROL DEVICES
- 720006-04 SIGN PANEL ERECTION DETAILS
- 720011-01 METAL POSTS FOR SIGNS, MARKERS & DELINEATORS
- 728001-01 TELESCOPING STEEL SIGN SUPPORT
- 729001-01 APPLICATIONS OF TYPES A & B METAL POSTS (FOR SIGNS & MARKERS)
- 731001-01 BASE FOR TELESCOPING STEEL SIGN SUPPORT
- 780001-05 TYPICAL PAVEMENT MARKINGS
- 878001-10 CONCRETE FOUNDATION DETAILS

GENERAL NOTES

1. IT SHALL BE THE CONTRACTOR'S RESPONSIBILITY TO HAVE THE UTILITY COMPANIES FIELD-LOCATE ALL UTILITIES, ASCERTAIN THEIR STATUS AND ADJUST OR RELOCATE THESE UTILITIES, AS NECESSARY, PRIOR TO STARTING CONSTRUCTION. THIS WORK SHALL BE INCLUDED IN THE COST OF "MOBILIZATION." THE CONTRACTOR SHALL NOTIFY ALL PUBLIC AND PRIVATE UTILITIES BEFORE STARTING CONSTRUCTION, INCLUDING, BUT NOT LIMITED TO:

 AT&T DISTRIBUTION - MS. KATE PETERS - 630-573-5759
 AT&T - LNS - MR. BOBBY AKHTER - 630-719-1483
 COMCAST - MR. THOMAS MUNAR - 630-600-6316
 MWRD - MR. JOE SCHUESSLER - 312-751-3184
 MCI/VERIZON - MR. DEAN BOYERS - 972-729-6322
 NICOR GAS - MR. BRICE KOPPANG - 630-388-3046
 VILLAGE OF MT. PROSPECT - MS. DONNA BROWN - 847-870-5640
 WIDE OPEN WEST - MR. PAUL FINKOW - 630-536-3139
2. DURING THE CONSTRUCTION OPERATION WHEN ANY LOOSE MATERIAL IS DEPOSITED IN THE FLOW LINE OF DITCHES, GUTTERS, OR DRAINAGE STRUCTURES SO THE NATURAL FLOW OF WATER IS OBSTRUCTED, THE MATERIAL SHALL BE REMOVED AT THE CLOSE OF EACH WORKING DAY. AT THE CONCLUSION OF THE CONSTRUCTION OPERATIONS ALL DRAINAGE STRUCTURES SHALL BE FREE FROM ALL DIRT AND DEBRIS. THIS WORK SHALL NOT BE PAID FOR SEPARATELY BUT SHALL BE INCLUDED IN THE COST OF "INLETS, TYPE A, TYPE 24 FRAME AND GRATE", "MANHOLES TO BE ADJUSTED", AND "INLETS TO BE ADJUSTED".
3. IT IS THE CONTRACTOR'S RESPONSIBILITY TO ASCERTAIN EXISTING FIELD CONDITIONS PRIOR TO BIDDING ON THIS PROJECT. NO ADDITIONAL COMPENSATION WILL BE ALLOWED FOR FAILURE TO VERIFY EXISTING DIMENSIONS OR CONDITIONS.
4. THE CONTRACTOR SHALL LIMIT HIS CONSTRUCTION ACTIVITIES TO THE WORK AREAS DESIGNATED ON THE PLANS. ANY DAMAGE TO AREAS OUTSIDE OF THESE LIMITS SHALL BE REPAIRED BY THE CONTRACTOR AT HIS OWN EXPENSE TO THE SATISFACTION OF THE ENGINEER.
5. THE CONTRACTOR SHALL CONTACT DISTRICT ONE TRAFFIC CONTROL SUPERVISOR AT (847) 705-4470 A MINIMUM OF 72 HOURS IN ADVANCE OF BEGINNING WORK.
6. THE PROPOSED COMBINATION CONCRETE CURB AND GUTTER SHALL BE DEPRESSED AT CURB RAMPS AND/OR AS SPECIFIED BY THE ENGINEER.
7. PROPER DRAINAGE SHALL BE MAINTAINED IN THE IMPROVEMENT AREA DURING CONSTRUCTION. THE COST OF THIS WORK SHALL BE INCLUDED IN THE COST OF GRADING AND SHAPING DITCHES.
8. THE CONTRACTOR SHALL OBTAIN AUTHORIZATION FROM THE ENGINEER BEFORE BEGINNING WORK ON ANY STREET.
9. IT IS THE RESPONSIBILITY OF THE CONTRACTOR TO PROTECT ALL PAVEMENT OPENINGS, OPEN HOLES, EQUIPMENT AND RUBBLE LEFT IN THE PUBLIC RIGHT-OF-WAY. THE CONTRACTOR SHALL MAINTAIN HIGH VISIBILITY OF ALL TEMPORARY HAZARDS TO PEDESTRIANS AND MOTORISTS.
10. ALL REQUIRED SAW CUTS SHALL NOT BE PAID FOR SEPARATELY BUT SHALL BE INCLUDED IN THE PRICE OF THE RESPECTIVE PAY ITEM.
11. ALL TREES SHALL BE PROTECTED AND CARED FOR DURING CONSTRUCTION. THE CONTRACTOR SHALL ADHERE TO ALL VILLAGE TREE PROTECTION ORDINANCES AND REQUIREMENTS.
12. THE CONTRACTOR SHALL MAINTAIN ACCESS TO PRIVATE PROPERTIES AT ALL TIMES.
13. THE FOLLOWING ADDITIONAL QUANTITIES HAVE BEEN INCLUDED FOR USE ONLY AT THE DISCRETION OF THE ENGINEER AND SPECIAL PROVISIONS:

 20101200 TREE ROOT PRUNING 5 EACH
 25200200 SUPPLEMENTAL WATERING 48 UNIT

GENERAL NOTES (CONT.)

14. THE CONTRACTOR SHALL TAKE APPROPRIATE MEASURES TO CONTROL DUST AT ALL TIMES ALONG THE ENTIRE PROJECT BY MEANS SUCH AS A MECHANICAL SWEEPER, WATER TRUCK, OR AS DIRECTED BY THE ENGINEER. THIS WORK SHALL BE INCLUDED IN THE COST OF "TRAFFIC CONTROL AND PROTECTION, STANDARD 701701.
15. LOCATIONS OF ALL PROPOSED DRAINAGE STRUCTURES ARE APPROXIMATE AND SHALL BE FIELD VERIFIED BY THE ENGINEER PRIOR TO FINAL INSTALLATION. THE CONTRACTOR SHALL VERIFY EXISTING INVERT INFORMATION BEFORE ORDERING EACH DRAINAGE STRUCTURE (INLET, CATCH BASIN, MANHOLE, ETC.) NO ADDITIONAL COMPENSATION WILL BE ALLOWED FOR FAILURE TO VERIFY EXISTING INVERT FOR THE CONNECTION OF EXISTING STORM SEWER.
16. ALL EXCAVATED MATERIAL SHALL REMAIN ON-SITE AND WITHIN THE RIGHT-OF-WAY OF ORIGIN. SURPLUS TOPSOIL SHALL REMAIN ON SITE BY INCREASING THE THICKNESS OF TOPSOIL PLACED, OR AS DIRECTED BY THE ENGINEER. THIS WORK WILL BE PAID FOR AT THE CONTRACT UNIT PRICE FOR "TOPSOIL EXCAVATION AND PLACEMENT".
17. THE CONTRACTOR SHALL BE REQUIRED TO MOVE ANY DECORATIVE ROCKS, PAVER BRICKS, OR LANDSCAPE ITEMS THAT INTERFERE WITH CONSTRUCTION. UPON COMPLETION OF THE CONSTRUCTION, THE CONTRACTOR SHALL MOVE THESE ITEMS BACK TO THEIR ORIGINAL LOCATION AND ORIGINAL CONDITION. THIS WORK SHALL BE INCLUDED IN THE COST OF THE REMOVAL ITEM.
18. THE CONTRACTOR SHALL BE PERMITTED TO WORK BETWEEN THE HOURS OF 7:00 AM AND 7:00 PM MONDAY THROUGH SATURDAY. LANE CLOSURES SHALL ONLY BE ALLOWED ON WORK DAYS BETWEEN THE HOURS OF 9:00 AM AND 3:00 PM.
19. TIE BARS FOR COMBINATION CONCRETE CURB AND GUTTER AND CONCRETE MEDIAN SHALL BE INCLUDED IN THE COST OF THE ITEM.
20. FOR ANY NICOR GAS VALVES TO BE ADJUSTED, THE CONTRACTOR SHALL CONTACT DAN STEFANECH, SCHEDULER AT (815) 754-3488 A MINIMUM OF 2 WEEKS PRIOR TO FIELD WORK.

FILE NAME = N:\PROJ\020146\01\Design\Misc\Sheets\020146_01-gennote01.dgn



Ciorba Group, Inc.
 CONSULTING ENGINEERS
 6507 North Cumberland Avenue, Suite 402
 Chicago, Illinois 60658
 Tel. 773.775.4009 Fax 773.775.4014

USER NAME = jettanaseo	DESIGNED - JPA	REVISED -
	DRAWN - MLD	REVISED -
PLOT SCALE = 20,0000' / 1in.	CHECKED - DJO	REVISED -
PLOT DATE = 5/4/2015	DATE - 5/4/2015	REVISED -

**VILLAGE OF MOUNT PROSPECT
 SAFE ROUTES TO SCHOOL**

**CENTRAL RD AT WELER LN PEDESTRIAN CROSSING IMPROVEMENTS
 STATE STANDARDS, GENERAL NOTES AND INDEX**

SCALE: NTS SHEET 1 OF 1 SHEETS STA. TO STA.

F.A.U. RTE.	SECTION	COUNTY	TOTAL SHEETS	SHEET NO.
1300	14-00162-00-SP	COOK	16	2
CONTRACT NO. 61B72				
ILLINOIS FED. AID PROJECT				

ITEM #	DESCRIPTION	UNIT	TOTAL	ROADWAY 8 0% FEDERAL SAFETY 0021
20101000	TEMPORARY FENCE	FOOT	570	570
* 20101200	TREE ROOT PRUNING	EACH	5	5
20200100	EARTH EXCAVATION	CU YD	34	34
20400800	FURNISHED EXCAVATION	CU YD	207	207
28000500	INLET AND PIPE PROTECTION	EACH	1	1
28000510	INLET FILTERS	EACH	2	2
21101505	TOPSOIL EXCAVATION AND PLACEMENT	CU YD	53	53
21101625	TOPSOIL FURNISH AND PLACE, 6"	SQ YD	474	474
21400100	GRADING AND SHAPING DITCHES	FOOT	75	75
* 25000400	NITROGEN FERTILIZER NUTRIENT	POUND	9	9
* 25000500	PHOSPHORUS FERTILIZER NUTRIENT	POUND	9	9
* 25000600	POTASSIUM FERTILIZER NUTRIENT	POUND	9	9
* 25200110	SODDING, SALT TOLERANT	SQ YD	1,050	1,050
* 25200200	SUPPLEMENTAL WATERING	UNIT	48	48
35101400	AGGREGATE BASE COURSE, TYPE B	TON	136	136
40603335	HOT-MIX ASPHALT SURFACE COURSE, MIX "D", N50	TON	56	56
42400200	PORTLAND CEMENT CONCRETE SIDEWALK 5 INCH	SQ FT	1,579	1,579
42400800	DETECTABLE WARNINGS	SQ FT	122	122
44000100	PAVEMENT REMOVAL	SQ YD	314	314
44000500	COMBINATION CURB AND GUTTER REMOVAL	FOOT	240	240

* SPECIALTY ITEM

ITEM #	DESCRIPTION	UNIT	TOTAL	ROADWAY 8 0% FEDERAL SAFETY 0021
44000600	SIDEWALK REMOVAL	SO FT	1,691	1,691
50105220	PIPE CULVERT REMOVAL	FOOT	60	60
54214509	PRECAST REINFORCED CONCRETE FLARED END SECTIONS, EQUIVALENT ROUND SIZE 24"	EACH	2	2
542A5479	PIPE CULVERTS, CLASS A, TYPE 1 EQUIVALENT ROUND SIZE 24"	FOOT	62	62
55100700	STORM SEWER REMOVAL 15"	FOOT	5	5
60237470	INLETS, TYPE A, TYPE 24 FRAME AND GRATE	EACH	1	1
60255500	MANHOLES TO BE ADJUSTED	EACH	1	1
60260100	INLETS TO BE ADJUSTED	EACH	1	1
60500050	REMOVING CATCH BASINS	EACH	1	1
60605000	COMBINATION CONCRETE CURB AND GUTTER, TYPE B-6.24	FOOT	209	209
60608562	COMBINATION CONCRETE CURB AND GUTTER, TYPE M-4.12	FOOT	33	33
60619600	CONCRETE MEDIAN, TYPE SB-6.12	SO FT	834	834
67100100	MOBILIZATION	L SUM	1	1
70102632	TRAFFIC CONTROL AND PROTECTION, STANDARD 701602	L SUM	1	1
70102635	TRAFFIC CONTROL AND PROTECTION, STANDARD 701701	L SUM	1	1
70102640	TRAFFIC CONTROL AND PROTECTION, STANDARD 701801	L SUM	1	1
70103815	TRAFFIC CONTROL SURVEILLANCE	CAL DA	10	10
72000100	SIGN PANEL - TYPE 1	SQ FT	70	70
72000200	SIGN PANEL - TYPE 2	SQ FT	25	25
72400100	REMOVE SIGN PANEL ASSEMBLY - TYPE A	EACH	6	6

* SPECIALTY ITEM

FILE NAME: I:\VPROJ\10028148\01\Design\Drawings\Drawings\0028148.dwg



USER NAME = jatonasoo	DESIGNED - JPA	REVISED -
	DRAWN - MLD	REVISED -
PLOT SCALE = 1:8000' / in.	CHECKED - DJO	REVISED -
PLOT DATE = 5/4/2015	DATE - 5/4/2015	REVISED -

**VILLAGE OF MOUNT PROSPECT
SAFE ROUTES TO SCHOOL**

**CENTRAL RD AT WELLER LN PEDESTRIAN CROSSING IMPROVEMENTS
SUMMARY OF QUANTITIES**

SCALE: NTS SHEET 1 OF 2 SHEETS STA. TO STA.

F.A.U. RTE.	SECTION	COUNTY	TOTAL SHEETS	SHEET NO.
1300	14-00162-00-SP	COOK	16	3
CONTRACT NO. 61B72			ILLINOIS FED. AID PROJECT	

ITEM #	DESCRIPTION	UNIT	TOTAL	ROADWAY 80% FEDERAL SAFETY 0021
72400310	REMOVE SIGN PANEL - TYPE 1	SO FT	18	18
72800100	TELESCOPING STEEL SIGN SUPPORT	FOOT	23	23
72900100	METAL POST - TYPE A	FOOT	33	33
73100100	BASE FOR TELESCOPING STEEL SIGN SUPPORT	EACH	2	2
* 78000200	THERMOPLASTIC PAVEMENT MARKING - LINE 4"	FOOT	737	737
* 78000400	THERMOPLASTIC PAVEMENT MARKING - LINE 6"	FOOT	94	94
* 78000600	THERMOPLASTIC PAVEMENT MARKING - LINE 12"	FOOT	383	383
* 78300100	PAVEMENT MARKING REMOVAL	SO FT	572	572
* 87800100	CONCRETE FOUNDATION, TYPE A	FOOT	6	6
* A2004720	TREE, GLEDITSIA TRIACANTHOS INERMIS SHADEMASTER (SHADEMASTER THORNLESS COMMON HONEYLOCUST), 2-1/2" CALIPER, BALLED AND	EACH	2	2
* A2005040	TREE, GYMNOCLADUS DIOICUS ESPRESSO-JFS (ESPRESSO KENTUCKY COFFEETREE), 2-1/2" CALIPER, BALLED AND BURLAPPED	EACH	1	1
*		EACH	3	3
Z0001110	GAS VALVE TO BE ADJUSTED	EACH	1	1
Z0013798	CONSTRUCTION LAYOUT	L SUM	1	1
Z0030850	TEMPORARY INFORMATION SIGNING	SO FT	52	52
* XX007021	PEDESTRIAN ACTIVATED CROSSWALK WARNING SYSTEM	EACH	1	1

* SPECIALTY ITEM

FILE NAME = I:\PROJ\80220148\01\Design\Misc_Sheets\80220148_01_soa02.dgn



Ciorba Group, Inc.
CONSULTING ENGINEERS
5507 North Cumberland Avenue, Suite 402
Chicago, Illinois 60656
Tel. 773.775.4009 Fax 773.775.4014

USER NAME = jattenaseo	DESIGNED - JPA	REVISED -
PLOT SCALE = 1:8000 "/> <td>DRAWN - MLD</td> <td>REVISED -</td>	DRAWN - MLD	REVISED -
PLOT DATE = 5/4/2015	CHECKED - DJO	REVISED -
	DATE - 5/4/2015	REVISED -

**VILLAGE OF MOUNT PROSPECT
SAFE ROUTES TO SCHOOL**

**CENTRAL RD AT WELER LN PEDESTRIAN CROSSING IMPROVEMENTS
SUMMARY OF QUANTITIES**

SCALE: NTS SHEET 2 OF 2 SHEETS STA. TO STA.

F.A.U. RTE.	SECTION	COUNTY	TOTAL SHEETS	SHEET NO.
1300	14-00162-00-SP	COOK	16	4
ILLINOIS FED. AID PROJECT			CONTRACT NO. 61B72	

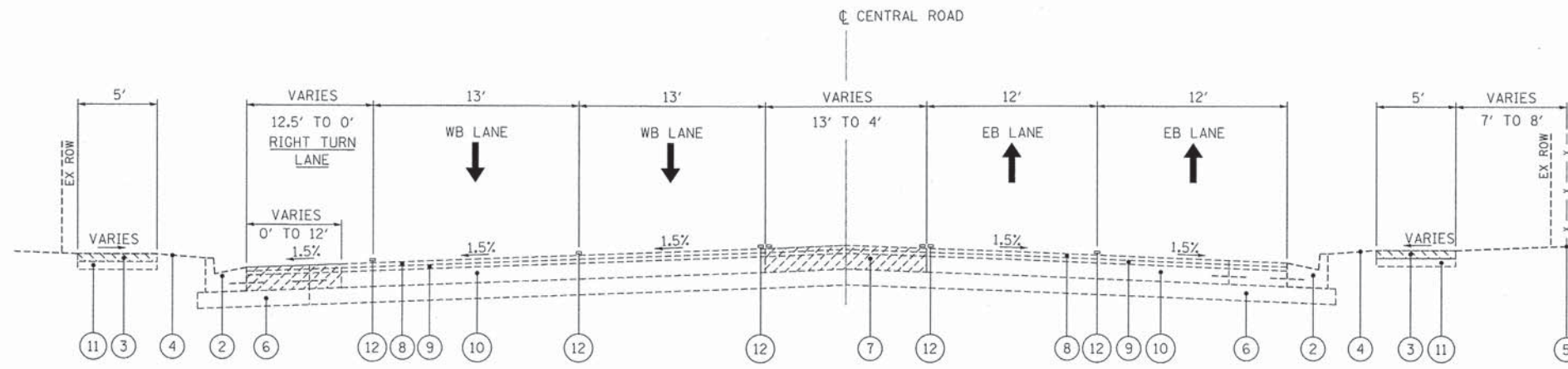

EXISTING TYPICAL SECTION
STA 112+83.68 TO STA 114+32.21

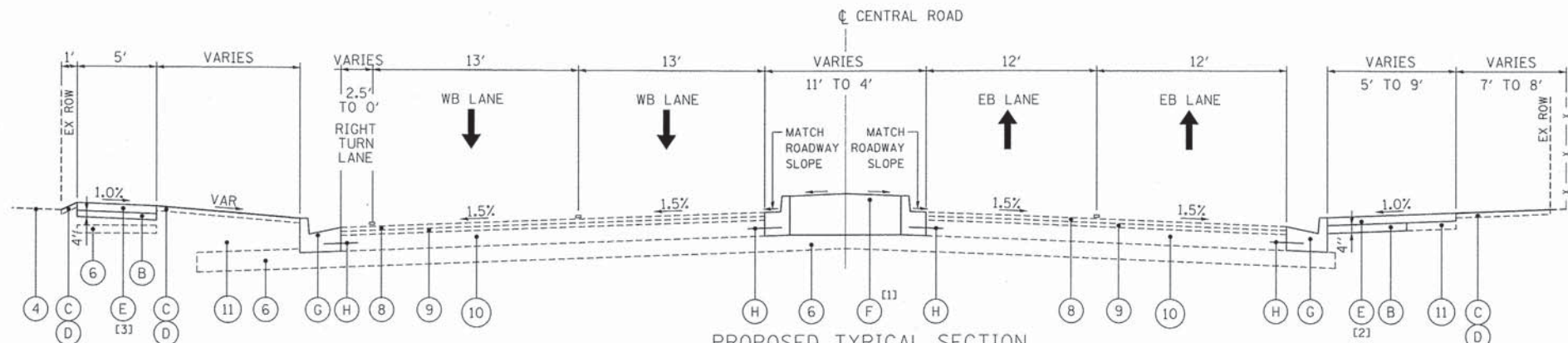

PROPOSED TYPICAL SECTION
STA 113+27.13 TO STA 114+32.21

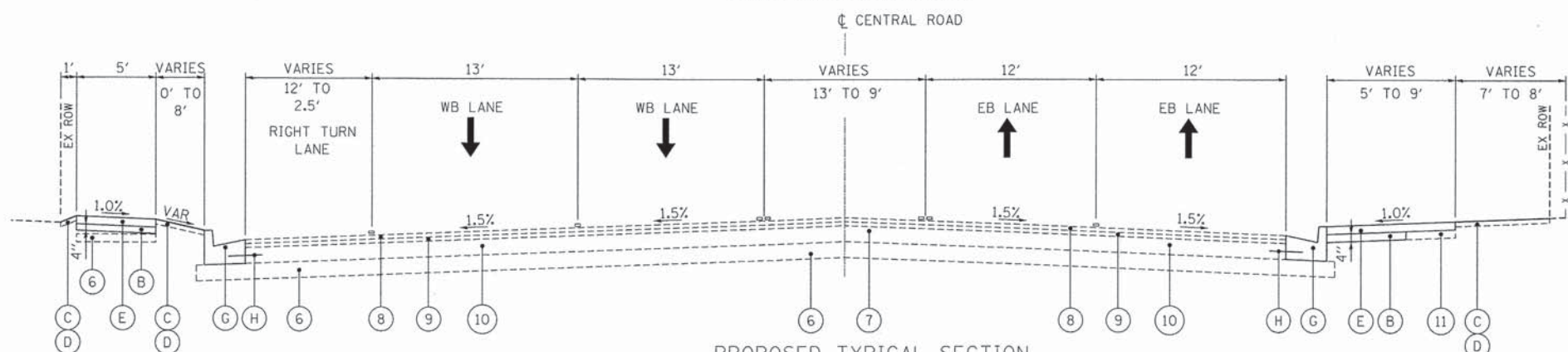

PROPOSED TYPICAL SECTION
STA 112+83.68 TO STA 113+27.13

- NOTES:**
- [1] CONCRETE MEDIAN ENDS AT STA 114+30.8
 - [2] PCC SIDEWALK ENDS AT STA 113+59.8
 - [3] PCC SIDEWALK ENDS AT STA 113+80.2
 - [4] 6" DEPTH
 - [5] 2" DEPTH

- EXISTING LEGEND**
- ① EXISTING PAVEMENT
 - ② CURB AND GUTTER
 - ③ SIDEWALK
 - ④ EXISTING GROUND
 - ⑤ FENCE
 - ⑥ SUBBASE GRANULAR MATERIAL, TYPE B
 - ⑦ PAINTED MEDIAN
 - ⑧ BIT. CONC. SURFACE COURSE, MIX D CL. 1, TYPE 2, 1.5"
 - ⑨ BIT. CONC. BINDER COURSE, MIX B, TYPE 2, 1.5"
 - ⑩ P.C.C. BASE COURSE, 9"
 - ⑪ EARTH EXCAVATION / FURNISHED EXCAVATION
 - ⑫ EXISTING PAVEMENT MARKING
 - ▨ PAVEMENT REMOVAL
 - ▨ SIDEWALK REMOVAL

- PROPOSED LEGEND**
- (A) HOT-MIX ASPHALT SURFACE COURSE, MIX "D", N50, 3"
 - (B) AGGREGATE BASE COURSE, TYPE B
 - (C) SODDING, SALT TOLERANT
 - (D) TOPSOIL EXCAVATION AND PLACEMENT (6" PLACEMENT)
 - (E) PORTLAND CEMENT CONCRETE SIDEWALK 5 INCH
 - (F) CONCRETE MEDIAN, TYPE SB-6.12
 - (G) COMBINATION CONCRETE CURB AND GUTTER, TYPE B-6.24
 - (H) TIE BAR

HOT-MIX ASPHALT MIXTURE REQUIREMENTS	
MIXTURE TYPE	AIR VOIDS @ NDES
SHARED-USE PATH	
HOT-MIX ASPHALT SURFACE COURSE, MIX "D", N50 (IL 9.5 mm); 3"	4% @ 50 GYR.

1. THE UNIT WEIGHT USED TO CALCULATE ALL HMA SURFACE MIXTURE QUANTITIES IS 112 LBS/SO YD/IN.
2. THE "AC TYPE" FOR POLYMERIZED HMA MIXES SHALL BE "SBS/SBR PG 76-22" AND FOR NON POLYMERIZED HMA THE "AC TYPE" SHALL BE "PG 64-22" UNLESS MODIFIED BY DISTRICT ONE SPECIAL PROVISIONS.
3. FOR HMA FULL DEPTH "AC TYPE" SEE SPECIAL PROVISIONS.
4. FOR USE OF RECYCLED MATERIALS SEE SPECIAL PROVISIONS.

FILE NAME = N:\PROJECTS\2014\04\11\Design\Typical\Sections\020140.01-Typical01.dgn

Gioba Group, Inc.
CONSULTING ENGINEERS
5507 North Cumberland Avenue, Suite 402
Chicago, Illinois 60656
Tel. 773.775.4009 Fax 773.775.4014

USER NAME = jstanaseo	DESIGNED - JPA	REVISED -
PLOT SCALE = 5.0000 "/>		

**VILLAGE OF MOUNT PROSPECT
SAFE ROUTES TO SCHOOL**

**CENTRAL RD AT WELLER LN PEDESTRIAN CROSSING IMPROVEMENTS
TYPICAL SECTIONS**

SCALE: NTS SHEET 1 OF 2 SHEETS STA. TO STA.

F.A.U. RTE.	SECTION	COUNTY	TOTAL SHEETS	SHEET NO.
1300	14-00162-00-SP	COOK	16	5
CONTRACT NO. 61B72			ILLINOIS FED. AID PROJECT	

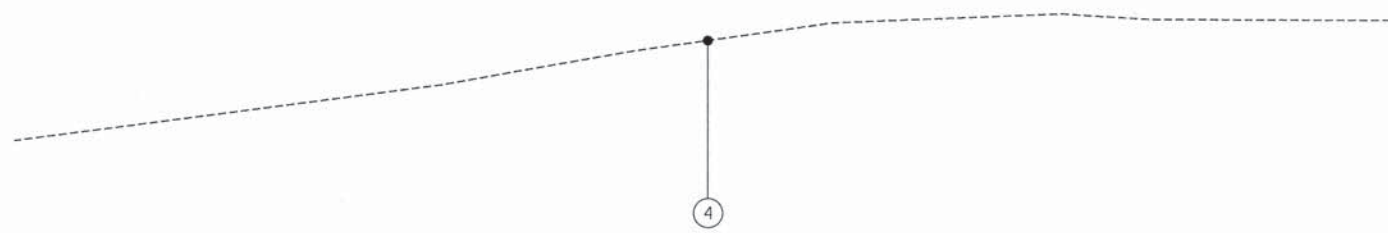

EXISTING TYPICAL SECTION
NORTH OF CENTRAL ROAD

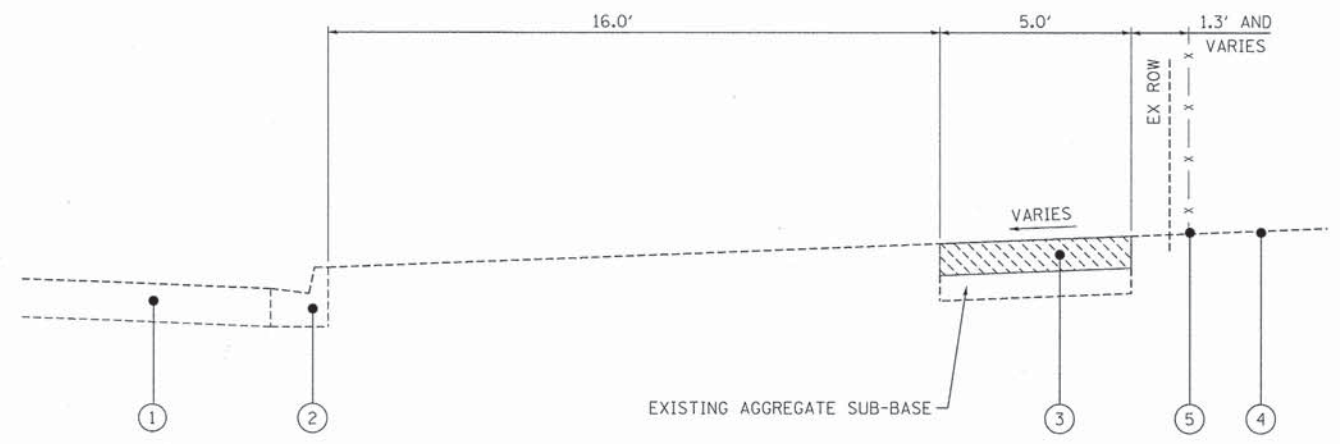

EXISTING TYPICAL SECTION
WELLER LANE

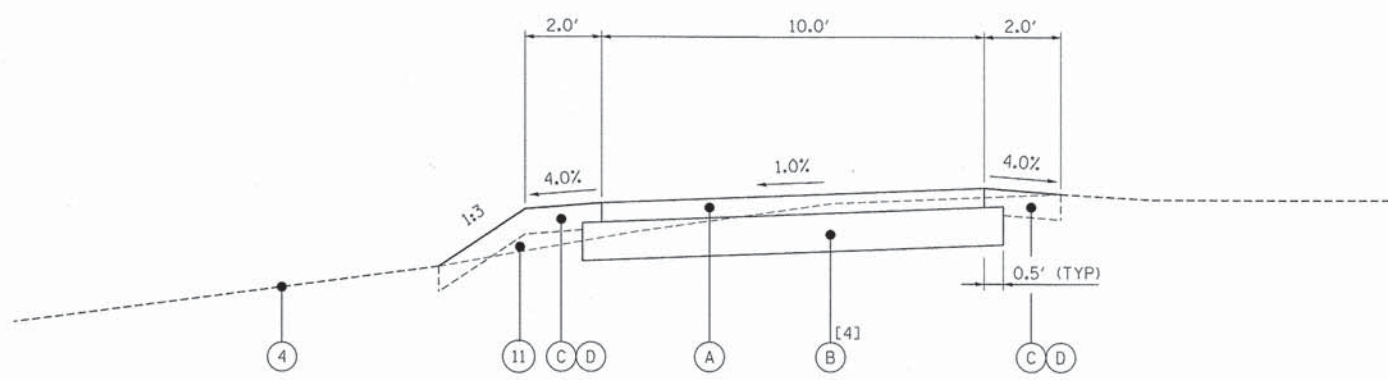

PROPOSED TYPICAL SECTION
NORTH OF CENTRAL ROAD
(LOOKING NORTH)

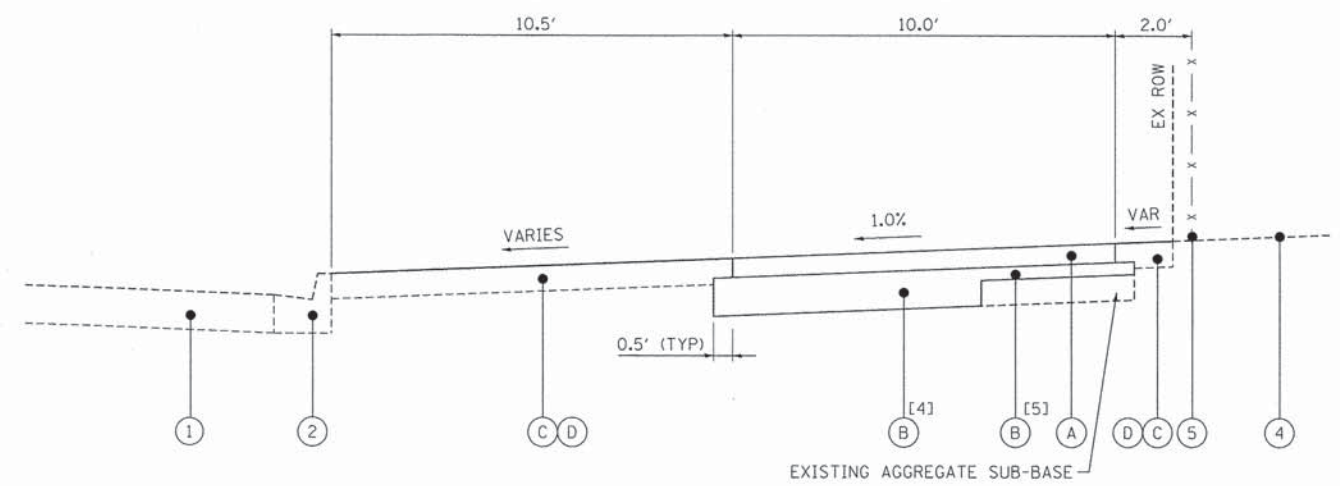

PROPOSED TYPICAL SECTION
WELLER LANE

EXISTING LEGEND

- ① EXISTING PAVEMENT
- ② CURB AND GUTTER
- ③ SIDEWALK
- ④ EXISTING GROUND
- ⑤ FENCE
- ⑥ SUBBASE GRANULAR MATERIAL, TYPE B
- ⑦ PAINTED MEDIAN
- ⑧ BIT. CONC. SURFACE COURSE, MIX D CL. 1, TYPE 2, 1.5"
- ⑨ BIT. CONC. BINDER COURSE, MIX B, TYPE 2, 1.5"
- ⑩ P.C.C. BASE COURSE, 9"
- ⑪ EARTH EXCAVATION / FURNISHED EXCAVATION
- ⑫ EXISTING PAVEMENT MARKING
- ▨ PAVEMENT REMOVAL
- ▨ SIDEWALK REMOVAL

PROPOSED LEGEND

- (A) HOT-MIX ASPHALT SURFACE COURSE, MIX "D", NSO, 3"
- (B) AGGREGATE BASE COURSE, TYPE B
- (C) SODDING, SALT TOLERANT
- (D) TOPSOIL EXCAVATION AND PLACEMENT; TOPSOIL, FURNISH AND PLACE, 6"
- (E) PORTLAND CEMENT CONCRETE SIDEWALK 5 INCH
- (F) CONCRETE MEDIAN, TYPE SB-6.12
- (G) COMBINATION CONCRETE CURB AND GUTTER, TYPE B-6.24
- (H) TIE BAR

NOTES:

- [1] CONCRETE MEDIAN ENDS AT STA 114+30.8
- [2] PCC SIDEWALK ENDS AT STA 113+59.8
- [3] PCC SIDEWALK ENDS AT STA 113+80.2
- [4] 6" DEPTH
- [5] 2" DEPTH

FILE NAME = \\P:\PROJECTS\102201401\Design\Typical Sections\020201401\1-Typical02.dgn



Ciorba Group, Inc.
CONSULTING ENGINEERS
5507 North Cumberland Avenue, Suite 402
Chicago, Illinois 60659
Tel. 773.775.4009 Fax 773.775.4014

USER NAME = jettanaseo	DESIGNED - JPA	REVISED -
PLOT SCALE = 2.5000" / 1"	DRAWN - MLD	REVISED -
PLOT DATE = 5/4/2015	CHECKED - DJO	REVISED -
	DATE - 5/4/2015	REVISED -

**VILLAGE OF MOUNT PROSPECT
SAFE ROUTES TO SCHOOL**

CENTRAL RD AT WELLER LN PEDESTRIAN CROSSING IMPROVEMENTS		F.A.U. RTE.	SECTION	COUNTY	TOTAL SHEETS	SHEET NO.
TYPICAL SECTIONS		1300	14-00162-00-SP	COOK	16	6
SCALE: NTS	SHEET 2 OF 2 SHEETS	STA.	TO STA.		CONTRACT NO. 61B72	

ILLINOIS FED. AID PROJECT	
---------------------------	--

PROJECT COORDINATES

CENTRAL ROAD			
DESCRIPTION		NORTHING	EASTING
P.O.T.	110+00.00	1,967,008.98	1,085,953.90
P.O.T.	113+53.52	1,967,007.78	1,086,307.42
P.O.T.	117+00.00	1,967,006.61	1,086,653.90

PROJECT COORDINATES

PPATH_W (SHARED-USE PATH (WEST))			
DESCRIPTION		NORTHING	EASTING
P.C.	250+00.00	1,967,070.84	1,086,308.55
P.I.	250+30.55	1,967,100.74	1,086,314.80
P.R.C.	250+54.85	1,967,119.95	1,086,291.05
P.I.	250+74.69	1,967,132.43	1,086,275.61
P.T.	250+92.63	1,967,152.10	1,086,272.94

PROP. CURVE PPATH W-1 PI STA. = 250+30.55 Δ = 62° 51' 02" (LT) D = 114° 35' 30" R = 50.00' T = 30.55' L = 54.85' E = 8.59' e = N/A P.C. STA = 250+00.00 P.R.C. STA = 250+54.85	PROP. CURVE PPATH W-2 PI STA. = 250+74.69 Δ = 43° 17' 54" (RT) D = 114° 35' 30" R = 50.00' T = 19.85' L = 37.78' E = 3.79' e = N/A P.R.C. STA = 250+54.85 P.T. STA = 250+92.63
--	--

PROP. CURVE PPATH E2-1 PI STA. = 50+91.30 Δ = 75° 03' 08" (RT) D = 114° 35' 30" R = 50.00' T = 38.40' L = 65.50' E = 13.05' e = N/A P.C. STA = 50+52.89 P.T. STA = 51+18.39	PROP. CURVE PPATH E2-2 PI STA. = 51+50.87 Δ = 31° 23' 17" (LT) D = 114° 35' 30" R = 50.00' T = 14.05' L = 27.39' E = 1.94' e = N/A P.C. STA = 51+36.82 P.T. STA = 51+64.21
---	--

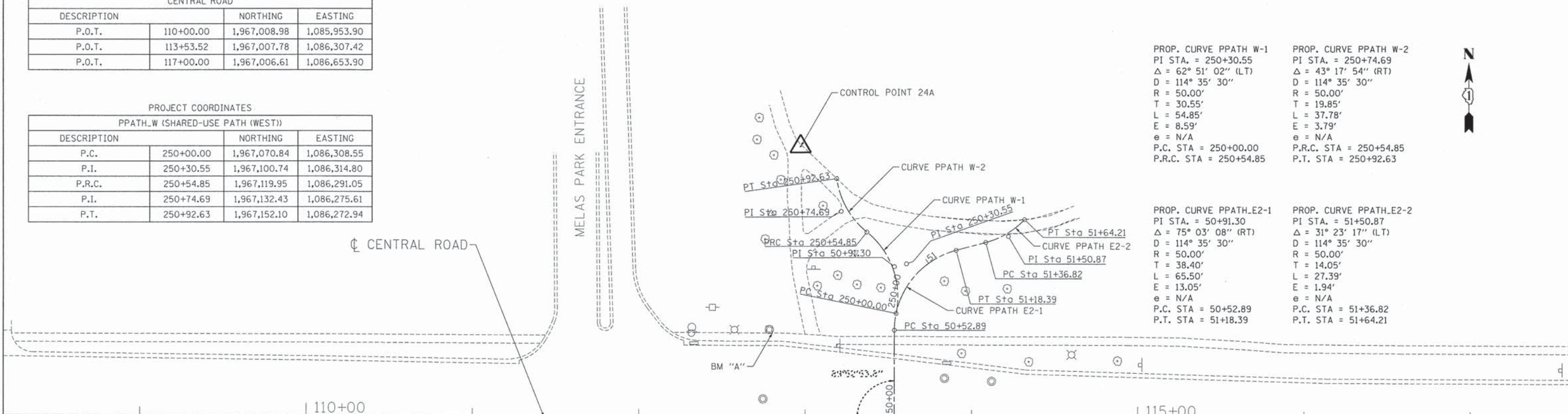

PROJECT COORDINATES

PPATH_E2 (SHARED-USE PATH (EAST))			
DESCRIPTION		NORTHING	EASTING
P.O.T.	50+00.00	1,967,007.78	1,086,307.42
P.C.	50+52.89	1,967,060.67	1,086,307.49
P.O.T.	50+63.13	1,967,070.84	1,086,308.55
P.I.	50+91.30	1,967,100.74	1,086,314.80
P.T.	51+18.39	1,967,108.93	1,086,344.66
P.C.	51+36.82	1,967,113.66	1,086,362.47
P.I.	51+50.87	1,967,117.27	1,086,376.05
P.T.	51+64.21	1,967,127.42	1,086,385.76

PROJECT LIMITS
STA 112+83.70

PROJECT LIMITS
STA 114+32.20

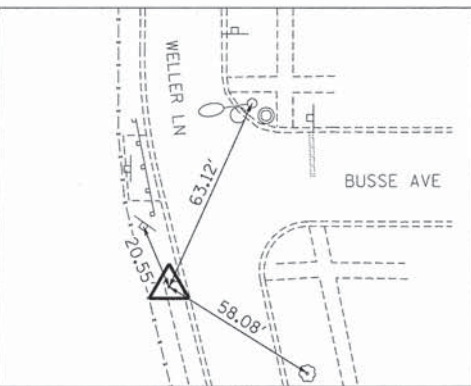

CONTROL POINT CGI 25
"x" ON CONC WALK WEST SIDE OF WELLER LN
APPROX 30' SOUTH OF BUSSE AVE CENTERLINE

N: 1,966,765.57 STA 112+66.95
E: 1,086,220.03 O/S 242.50 RT
ELEV: 670.08

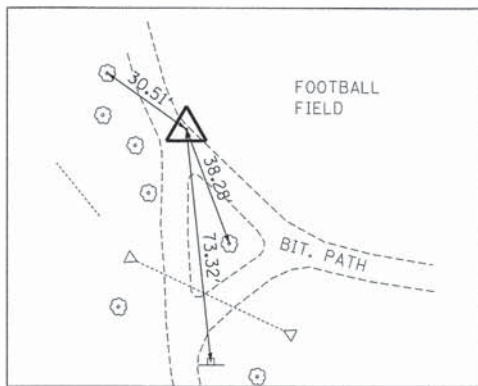

CONTROL POINT CGI 24A
PK NAIL IN EDGE OF MULTI-USE PATH APPROX
150' NORTH OF CENTRAL AND WELLER INTERSECTION

N: 1,967,171.65 STA 112+96.73
E: 1,086,251.18 O/S 163.68 LT
ELEV: SEE NOTE 5

CONTROL POINT 25

BENCHMARKS

BM "A"
ELEVATION = 672.918
BRONZE DISK AT THE SE CORNER OF
CONCRETE PAD OF MSDGC MH ON THE
NORTH SIDE OF CENTRAL ACROSS FROM
WELLER LN NEXT TO THE SIDEWALK



NOTES:

- ALL COORDINATES SHOWN ON THE ALIGNMENT AND CONTROL SHEET ARE BASED UPON THE NORTH AMERICAN DATUM 1983 (2011 ADJUSTMENT) ILLINOIS EAST ZONE AND (NAVD 88) - NORTH AMERICAN VERTICAL DATUM 1988 (GEOID 12A ADJUSTMENT).
- ALL DIMENSIONS GIVEN IN FEET AND DECIMAL PARTS THEREOF.
- ALL COORDINATE VALUES ARE IN THE US SURVEY FOOT UNITS.
- NO DIMENSION SHALL BE DERIVED FROM SCALED MEASUREMENT.
- ORIGINAL CONTROL POINT 24 DESTROYED, CONTROL POINT 24A ESTABLISHED WITHOUT ELEVATION.

FILE NAME = N:\PROJ\082814\01\Design\Misc_Sheets\082814\01-1\align\01.dgn

CGI **Ciorba Group, Inc.**
CONSULTING ENGINEERS
6507 North Cumberland Avenue, Suite 402
Chicago, Illinois 60656
Tel. 773.775.4009 Fax 773.775.4014

USER NAME = jattanasoo	DESIGNED - JPA	REVISED -
PLOT SCALE = 38.0000' / 1"	DRAWN - MLD	REVISED -
PLOT DATE = 5/4/2015	CHECKED - DJO	REVISED -
	DATE - 5/4/2015	REVISED -

**VILLAGE OF MOUNT PROSPECT
SAFE ROUTES TO SCHOOL**

**CENTRAL RD AT WELLER LN PEDESTRIAN CROSSING IMPROVEMENTS
ALIGNMENT, TIES AND BENCHMARKS**

SCALE: 1" = 30' SHEET 1 OF 1 SHEETS STA. TO STA.

F.A.U. RTE. 1300	SECTION 14-00162-00-SP	COUNTY COOK	TOTAL SHEETS 16	SHEET NO. 7
CONTRACT NO. 61B72				ILLINOIS FED. AID PROJECT

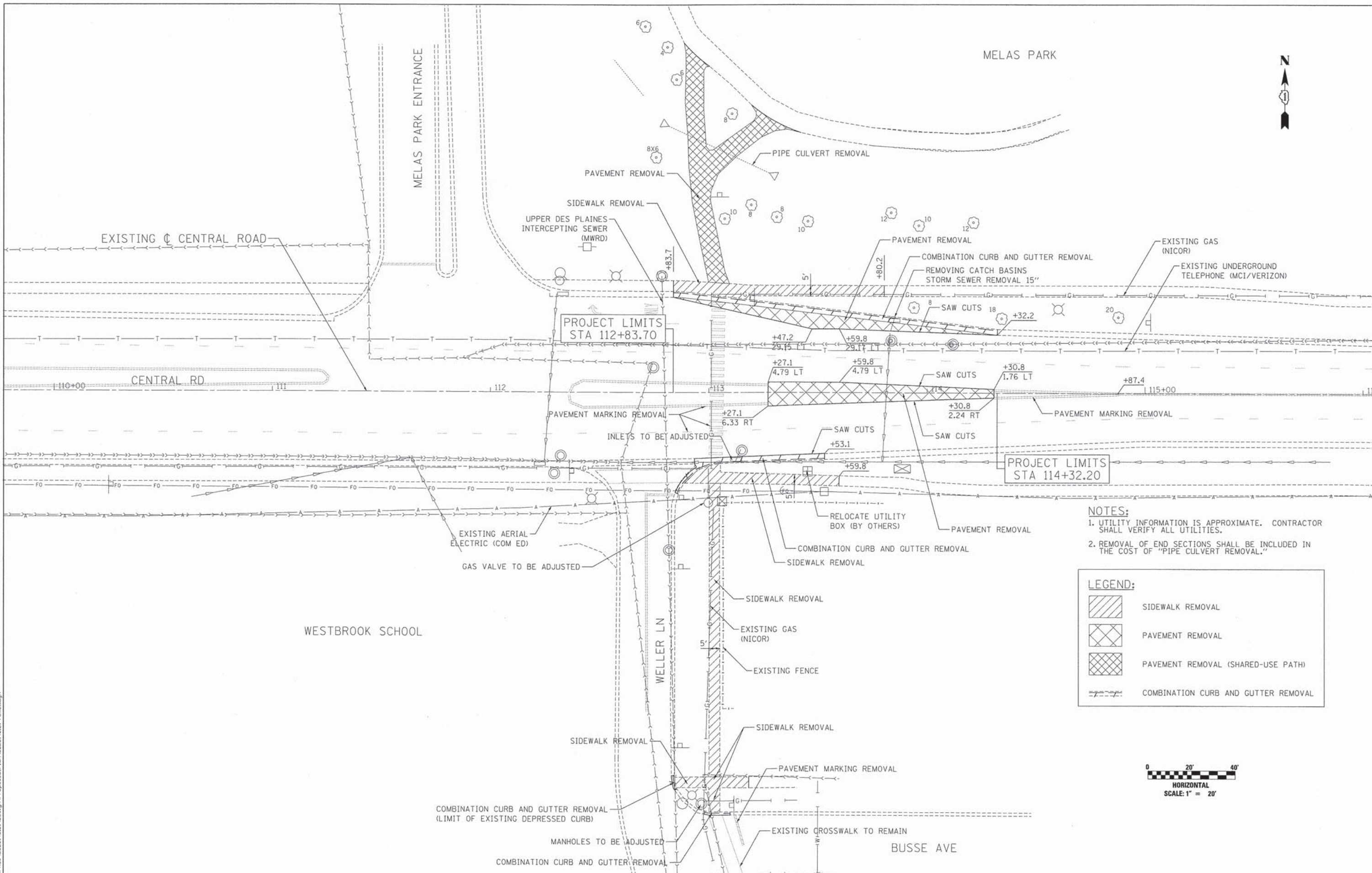

NOTES:
 1. UTILITY INFORMATION IS APPROXIMATE. CONTRACTOR SHALL VERIFY ALL UTILITIES.
 2. REMOVAL OF END SECTIONS SHALL BE INCLUDED IN THE COST OF "PIPE CULVERT REMOVAL."

LEGEND:

	SIDEWALK REMOVAL
	PAVEMENT REMOVAL
	PAVEMENT REMOVAL (SHARED-USE PATH)
	COMBINATION CURB AND GUTTER REMOVAL



FILE NAME = N:\PROJECTS\0220146\01\Design\Proposed_Plan\0220146_01_01.dgn

Ciorba Group, Inc.
 CONSULTING ENGINEERS
 5507 North Cumberland Avenue, Suite 402
 Chicago, Illinois 60656
 Tel. 773.775.4009 Fax 773.775.4014

USER NAME = jatanaseo	DESIGNED - JPA	REVISED -
DRAWN - MLD	REVISED -	
PLOT SCALE = 20,0000' / in.	CHECKED - DJO	REVISED -
PLOT DATE = 5/4/2015	DATE - 5/4/2015	REVISED -

**VILLAGE OF MOUNT PROSPECT
 SAFE ROUTES TO SCHOOL**

**CENTRAL RD AT WELLER LN PEDESTRIAN CROSSING IMPROVEMENTS
 REMOVAL PLAN**

F.A.U. RTE. 1300	SECTION 14-00162-00-SP	COUNTY COOK	TOTAL SHEETS 16	SHEET NO. 8
SCALE: 1" = 20'			CONTRACT NO. 61B72	
SHEET 1 OF 1 SHEETS		ILLINOIS FED. AID PROJECT		

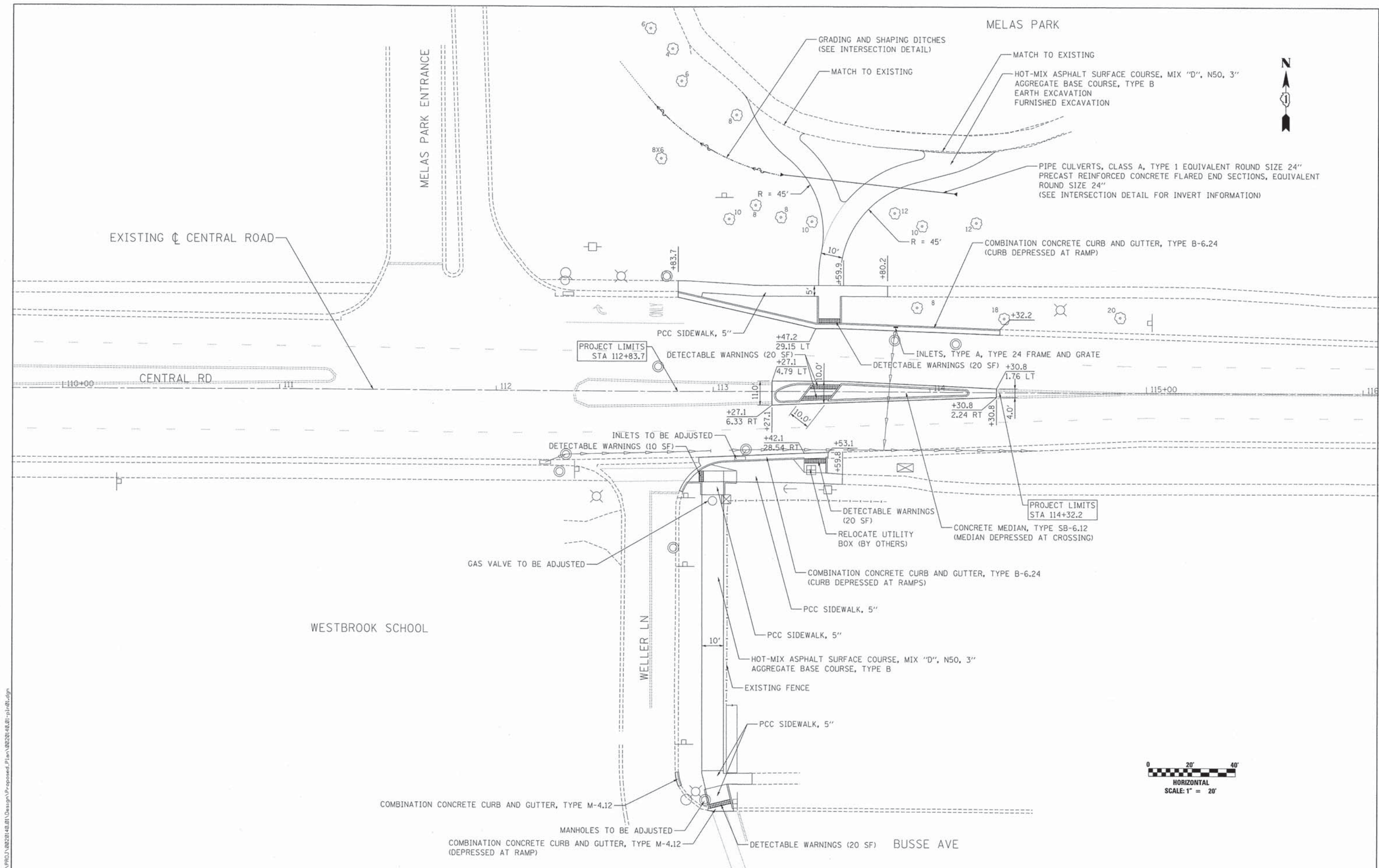

FILE NAME = N:\PROJECTS\14016\Design\Proposed\Plan\14016-01-pln1.dgn

Ciorba Group, Inc.
 CONSULTING ENGINEERS
 5507 North Cumberland Avenue, Suite 402
 Chicago, Illinois 60656
 Tel. 773.775.4009 Fax 773.775.4014

USER NAME = jettanoseo	DESIGNED - JPA	REVISED -
DRAWN - MLD	REVISED -	
PLT SCALE = 20.0406' / 1" =	CHECKED - DJO	REVISED -
PLT DATE = 5/4/2015	DATE - 5/4/2015	REVISED -

**VILLAGE OF MOUNT PROSPECT
 SAFE ROUTES TO SCHOOL**

**CENTRAL RD AT WELLER LN PEDESTRIAN CROSSING IMPROVEMENTS
 PROPOSED PLAN**

SCALE: 1" = 20' SHEET 1 OF 1 SHEETS STA. TO STA.

F.A.U. RTE. 1300	SECTION 14-00162-00-SP	COUNTY COOK	TOTAL SHEETS 16	SHEET NO. 9
CONTRACT NO. 61B72			ILLINOIS FED. AID PROJECT	

SHARED-USE PATH (WEST) - PPATH_W			
POINT	STATION	OFFSET	ELEV
A	250+00.00	5.00 LT	674.88
B	250+06.89	5.00 LT	674.91
C	250+25.04	5.00 LT	675.73
D	250+30.60	5.00 LT	675.76
E	250+40.98	5.00 LT	676.50
F	250+44.23	5.00 LT	676.73
G	250+49.79	5.00 LT	676.83
H	250+54.28	5.00 LT	677.15
I	250+64.34	5.00 LT	677.97
J	250+68.90	5.00 LT	678.07

SHARED-USE PATH (WEST) - PPATH_W			
POINT	STATION	OFFSET	ELEV
K	250+82.69	5.00 LT	678.64
L	250+88.45	6.88 LT	678.90 (EX)
M	250+16.27	0.00 RT	675.41
N	250+25.04	0.00 RT	675.82
O	250+75.69	0.00 RT	678.53 (EX)
P	250+25.04	5.00 RT	675.92
Q	250+30.60	5.00 RT	675.96
R	250+44.23	5.00 RT	676.93
S	250+49.79	5.00 RT	677.03
T	250+54.47	5.00 RT	677.35
U	250+64.34	5.00 RT	678.15
V	250+65.63	5.00 RT	678.47 (EX)
W	250+55.35	8.81 RT	678.48 (EX)

SHARED-USE PATH (EAST) - PPATH_E2			
POINT	STATION	OFFSET	ELEV
AA	50+63.13	5.00 LT	674.88
BB	50+68.69	5.00 LT	674.91
CC	50+88.17	5.00 LT	675.95
DD	51+13.31	5.00 LT	676.93
EE	51+25.11	5.00 LT	677.55
FF	51+36.82	5.00 LT	678.13 (EX)
GG	51+25.78	8.89 LT	678.33 (EX)
HH	50+63.13	5.00 RT	674.78
II	50+68.69	5.00 RT	674.88
JJ	50+77.88	5.00 RT	675.29
KK	50+88.17	5.00 RT	675.75
LL	51+11.65	5.00 RT	676.72 (EOP)
MM	51+13.31	5.00 RT	676.79
NN	51+25.11	5.00 RT	677.35
OO	51+57.51	5.00 RT	678.19 (EX)

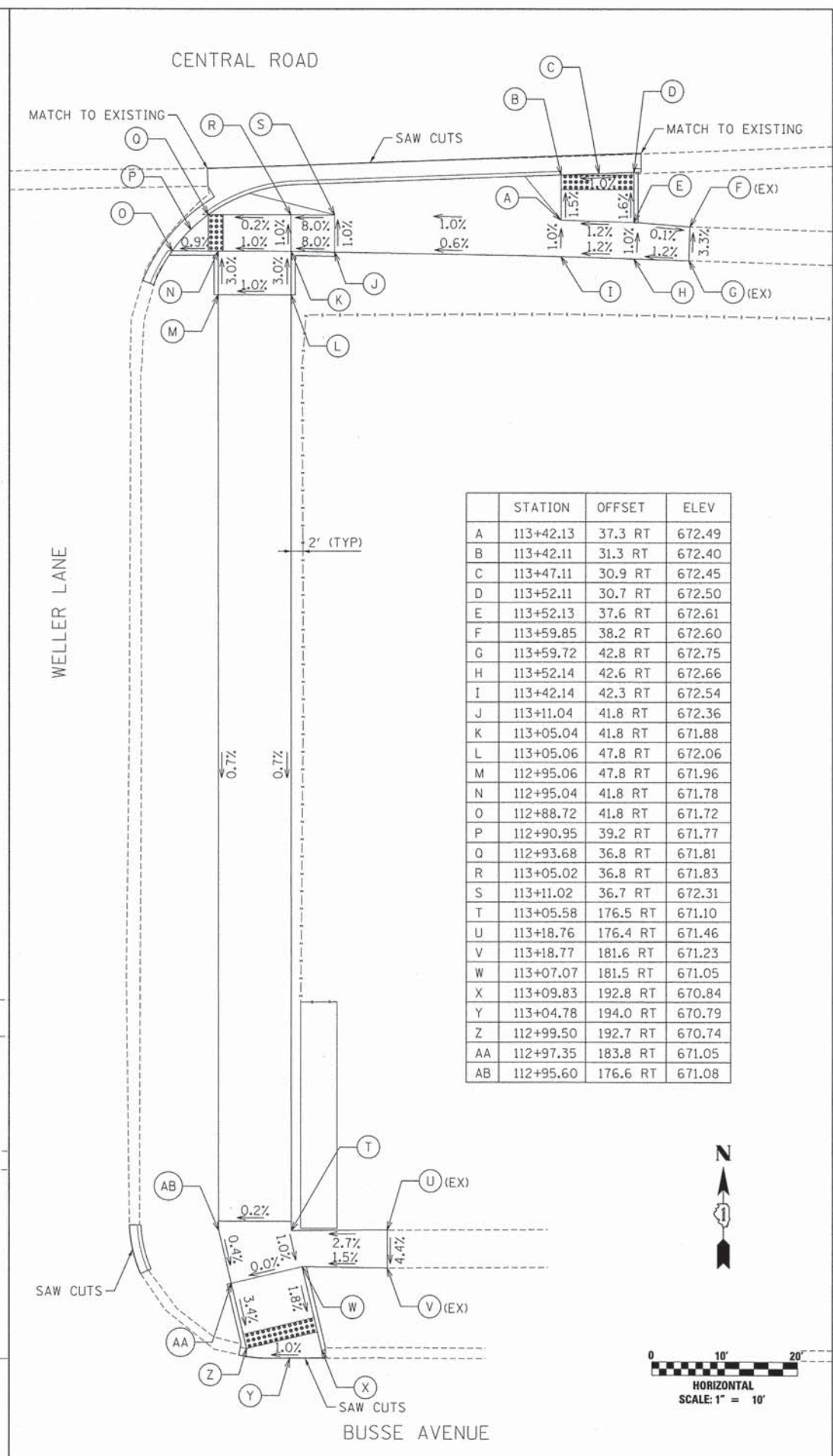
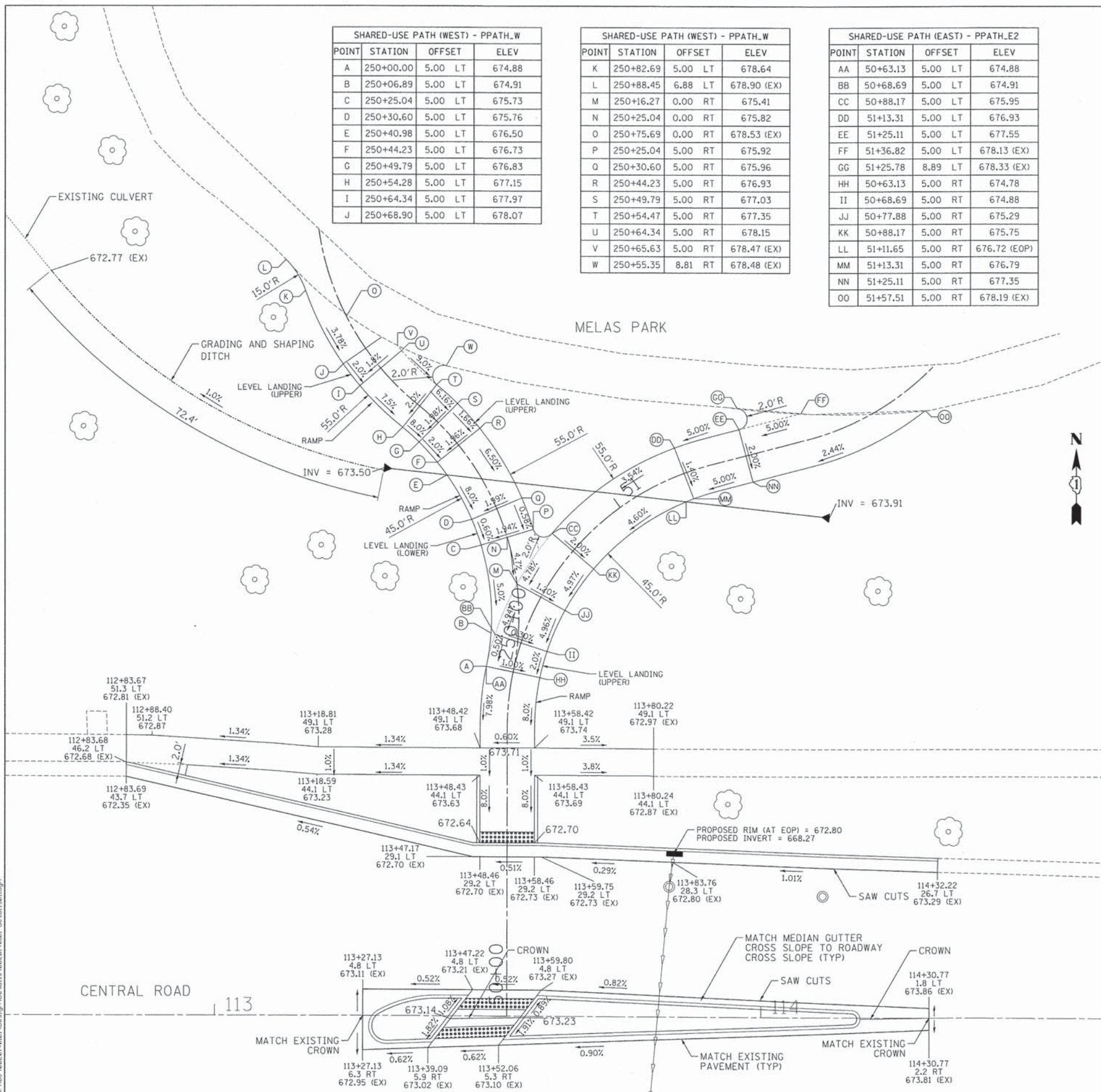

POINT	STATION	OFFSET	ELEV
A	113+42.13	37.3 RT	672.49
B	113+42.11	31.3 RT	672.40
C	113+47.11	30.9 RT	672.45
D	113+52.11	30.7 RT	672.50
E	113+52.13	37.6 RT	672.61
F	113+59.85	38.2 RT	672.60
G	113+59.72	42.8 RT	672.75
H	113+52.14	42.6 RT	672.66
I	113+42.14	42.3 RT	672.54
J	113+11.04	41.8 RT	672.36
K	113+05.04	41.8 RT	671.88
L	113+05.06	47.8 RT	672.06
M	112+95.06	47.8 RT	671.96
N	112+95.04	41.8 RT	671.78
O	112+88.72	41.8 RT	671.72
P	112+90.95	39.2 RT	671.77
Q	112+93.68	36.8 RT	671.81
R	113+05.02	36.8 RT	671.83
S	113+11.02	36.7 RT	672.31
T	113+05.58	176.5 RT	671.10
U	113+18.76	176.4 RT	671.46
V	113+18.77	181.6 RT	671.23
W	113+07.07	181.5 RT	671.05
X	113+09.83	192.8 RT	670.84
Y	113+04.78	194.0 RT	670.79
Z	112+99.50	192.7 RT	670.74
AA	112+97.35	183.8 RT	671.05
AB	112+95.60	176.6 RT	671.08



FILE NAME = NS:\PROJ\0220146\01\Design\Detail\0220146_01-Detail1.dwg

CG Ciorba Group, Inc.
CONSULTING ENGINEERS
8507 North Cumberland Avenue, Suite 402
Chicago, Illinois 60656
Tel. 773.775.4009 Fax 773.775.4014

USER NAME = jattanasoo	DESIGNED - JPA	REVISED -
PLOT SCALE = 10.0000' / in.	DRAWN - MLD	REVISED -
PLOT DATE = 5/4/2015	CHECKED - DJO	REVISED -
	DATE - 5/4/2015	REVISED -

**VILLAGE OF MOUNT PROSPECT
SAFE ROUTES TO SCHOOL**

**CENTRAL RD AT WELLER LN PEDESTRIAN CROSSING IMPROVEMENTS
INTERSECTION DETAILS**

SCALE: 1" = 10' SHEET 1 OF 1 SHEETS STA. TO STA.

F.A.U. RTE.	SECTION	COUNTY	TOTAL SHEETS	SHEET NO.
1300	14-00162-00-SP	COOK	16	10
CONTRACT NO. 61B72				
ILLINOIS FED. AID PROJECT				

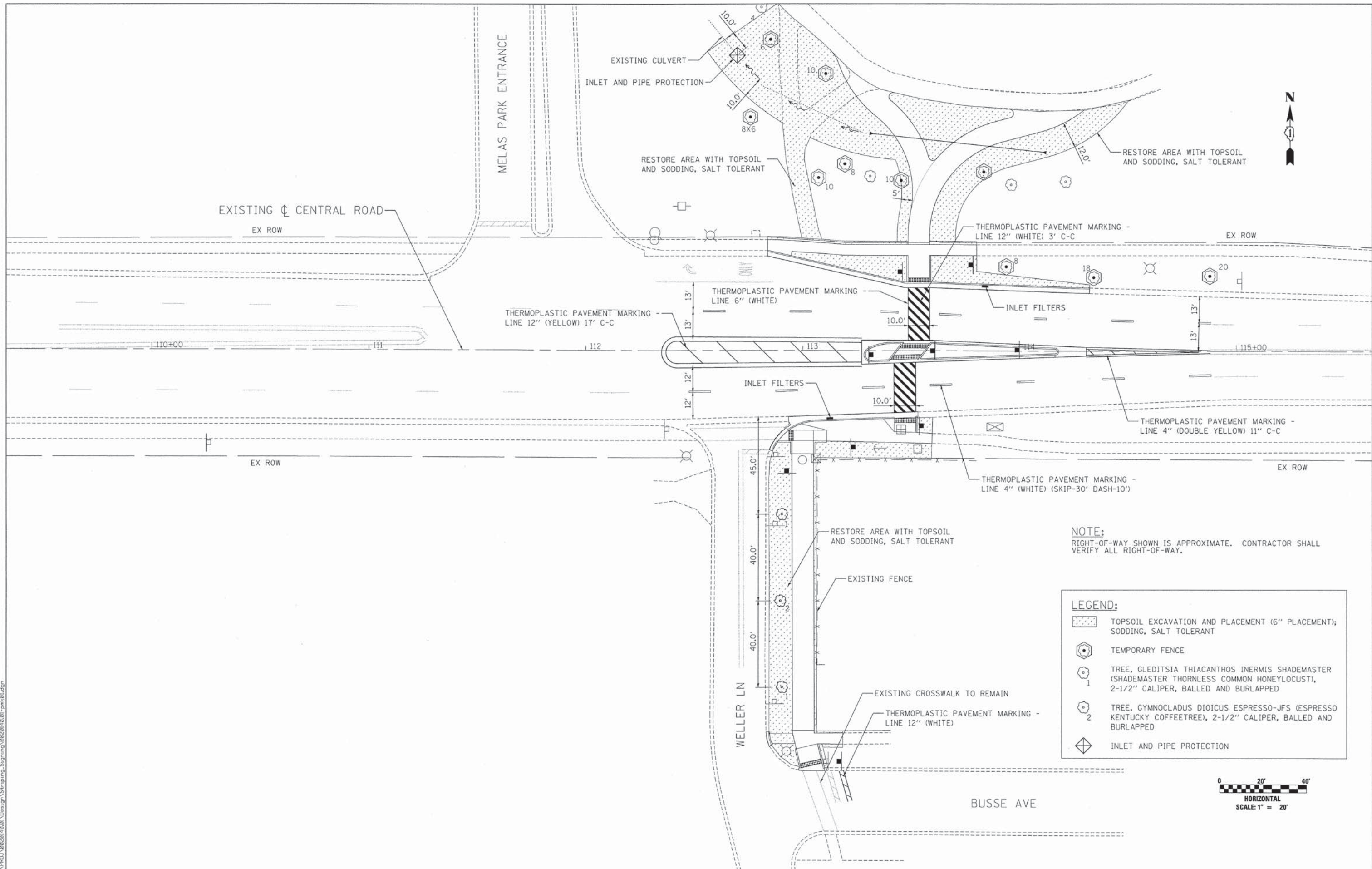

NOTE:
 RIGHT-OF-WAY SHOWN IS APPROXIMATE. CONTRACTOR SHALL VERIFY ALL RIGHT-OF-WAY.

LEGEND:

	TOPSOIL EXCAVATION AND PLACEMENT (6" PLACEMENT); SODDING, SALT TOLERANT
	TEMPORARY FENCE
	TREE, GLEDITSIA THIANCANTHOS INERMIS SHADEMASTER (SHADEMASTER THORNLESS COMMON HONEYLOCUST), 2-1/2" CALIPER, BALLED AND BURLAPPED
	TREE, GYMNOCLADUS DIOICUS ESPRESSO-JFS (ESPRESSO KENTUCKY COFFEETREE), 2-1/2" CALIPER, BALLED AND BURLAPPED
	INLET AND PIPE PROTECTION



FILE NAME = N:\PROJECTS\08228146.dwg\Design\Site\paving_Signing\08228146.dwg - mk81.dgn

Ciorba Group, Inc.
 CONSULTING ENGINEERS
 5507 North Cumberland Avenue, Suite 402
 Chicago, Illinois 60656
 Tel. 773.775.4009 Fax 773.775.4014

USER NAME = jatanaseo	DESIGNED - JPA	REVISED -
PLOT SCALE = 20,0000' / 1" =	DRAWN - MLD	REVISED -
PLOT DATE = 5/4/2015	CHECKED - DJO	REVISED -
	DATE - 5/4/2015	REVISED -

**VILLAGE OF MOUNT PROSPECT
 SAFE ROUTES TO SCHOOL**

**CENTRAL RD AT WELLER LN PEDESTRIAN CROSSING IMPROVEMENTS
 PAVEMENT MARKING AND LANDSCAPING PLAN**

SCALE: 1" = 20' SHEET 1 OF 1 SHEETS STA. TO STA.

F.A.U. RTE. 1300	SECTION 14-00162-00-SP	COUNTY COOK	TOTAL SHEETS 16	SHEET NO. 11
				CONTRACT NO. 61B72
ILLINOIS FED. AID PROJECT				

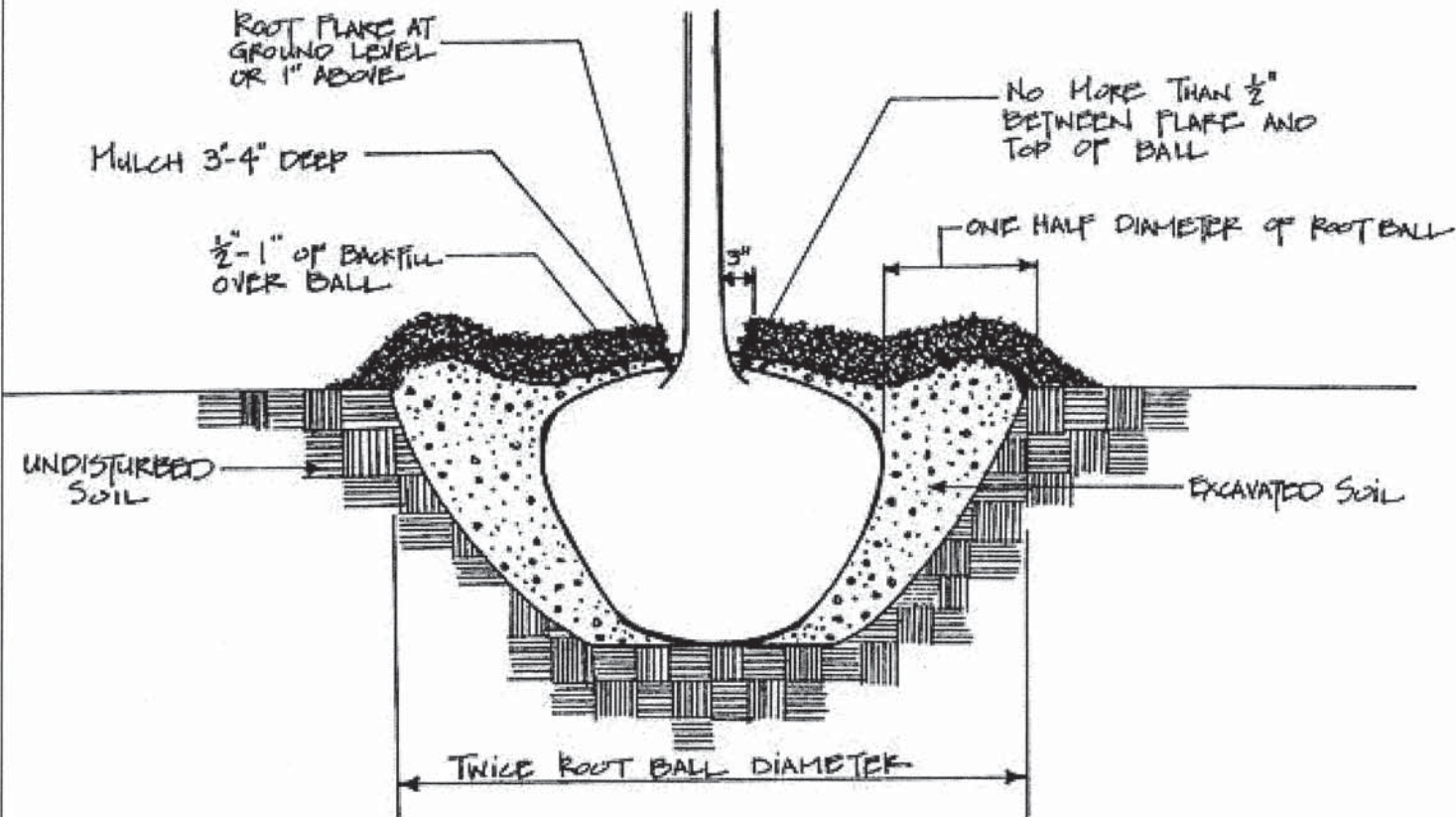

TREE AND SHRUB PLANTING DETAIL

DIGGING PLANTING HOLE:

1. ALL PLANTING HOLES SHALL BE HAND-DUG AND CIRCULAR IN OUTLINE.
2. DEPTH OF HOLES SHALL BE SUCH THAT THE BOTTOM OF THE ROOT BALL WILL BE PLACED ON UNDISTURBED SUBGRADE, AND THE ROOT FLARE SHALL BE AT, OR WITHIN ONE INCH ABOVE, THE GRADE OF THE SURROUNDING SOIL.
3. WIDTH OF HOLES AT THE SOIL SURFACE SHALL BE TWICE THE DIAMETER OF THE ROOT BALL, WITH SIDES SLOPING INWARD TOWARDS THE BOTTOM OF THE ROOT BALL (SEE DETAIL ABOVE).
4. EXCAVATED PLANT PITS THAT WILL BE LEFT OPEN WHEN WORK IS NOT IN PROGRESS OR POSE AN IMMEDIATE AND CONSIDERABLE HAZARD TO TRAFFIC SHALL BE ADEQUATELY BARRICADED WITH QUALIFIED WARNING DEVICES. NO PLANTING PIT MAY REMAIN OPEN IN EXCESS OF 24 HOURS.

PLACEMENT OF TREE / UNWRAPPING BALL

1. IN MOST INSTANCES, THE BACKFILL AROUND THE BALL SHALL BE THE SAME SOIL THAT WAS REMOVED FROM THE HOLE. HOWEVER, IN CASES WHERE EXCESSIVE ROCKS, STONES, ETC. ARE ENCOUNTERED, TOPSOIL SHALL BE USED.
2. WHEN APPROXIMATELY TWO-THIRDS TO THREE-FOURTHS OF THE PLANTING PIT HAS BEEN BACKFILLED, THE HOLE SHALL BE WATERED SO AS TO SETTLE THE SOIL AROUND ALL OF THE ROOTS. AFTER THE WATER HAS BEEN ABSORBED, THE PLANTING PIT SHALL BE FILLED WITH THE PLANTING SOIL, TAMPED LIGHTLY TO GRADE, AND WATERED THOROUGHLY AGAIN. ANY FURTHER SETTLEMENT SHALL BE BROUGHT TO GRADE WITH ADDITIONAL PLANTING SOIL. CONTRACTOR SHALL SUPPLY ALL WATERING EQUIPMENT; WATER MAY BE OBTAINED AT NO CHARGE AT THE PUBLIC WORKS FACILITY AT 1700 W. CENTRAL ROAD.
3. A SHALLOW "SAUCER" OF SOIL, APPROXIMATELY 3-4" HIGH, SHALL BE FORMED JUST INSIDE THE EDGE OF EACH PLANTING HOLE TO SERVE AS A WATER RESERVOIR.
4. ANY EXCESS SOIL OR DEBRIS SHALL BE REMOVED FROM THE PLANTING SITE IMMEDIATELY UPON COMPLETION OF PLANTING EACH INDIVIDUAL TREE.

MULCHING

1. AFTER PLANTING, THE CONTRACTOR SHALL INSTALL A THREE TO FOUR INCH LAYER OF WOOD CHIPS OR OTHER APPROVED MULCH OVER THE ROOT BALL OUT TO THE OUTER EDGE OF THE SOIL SAUCER.
2. NO MULCH SHALL BE PLACED IN CONTACT WITH THE TRUNK OF THE TREE.
3. THE VILLAGE WILL MAKE A SUPPLY OF WOOD CHIPS AVAILABLE TO THE CONTRACTOR AT THE PUBLIC WORKS FACILITY, AT NO CHARGE TO THE CONTRACTOR.

TRUNK WRAPPING

1. THE TRUNK OF THE TREE SHALL NOT BE WRAPPED. ANY EXISTING TRUNK WRAPPING MATERIALS SHALL BE REMOVED AND DISPOSED OF.

(NOTE, ABOVE DETAIL IS FOR STANDARD SITES.)

FILE NAME = W:\PROJ\14020146\01\Design\Detail\14020146_01_dctree1.dwg



Ciorba Group, Inc.
CONSULTING ENGINEERS
5507 North Cumberland Avenue, Suite 402
Chicago, Illinois 60656
Tel. 773.775.4009 Fax 773.775.4014

USER NAME = jattanasoo	DESIGNED - JPA	REVISED -
PLOT SCALE = 10,0000 1/1 in.	DRAWN - MLD	REVISED -
PLOT DATE = 5/4/2015	CHECKED - DJO	REVISED -
	DATE - 5/4/2015	REVISED -

VILLAGE OF MOUNT PROSPECT SAFE ROUTES TO SCHOOL

CENTRAL RD AT WELLER LN PEDESTRIAN CROSSING IMPROVEMENTS LANDSCAPING DETAIL

SCALE: N.T.S. SHEET 1 OF 1 SHEETS STA. TO STA.

F.A.U. RTE.	SECTION	COUNTY	TOTAL SHEETS	SHEET NO.
1300	14-00162-00-SP	COOK	16	12
CONTRACT NO. 61B72				
ILLINOIS FED. AID PROJECT				

BIKE ROUTE SIGN DETAIL



24"x18" 2.5" LETTERING (FHWA STANDARD) 0.75" GAP

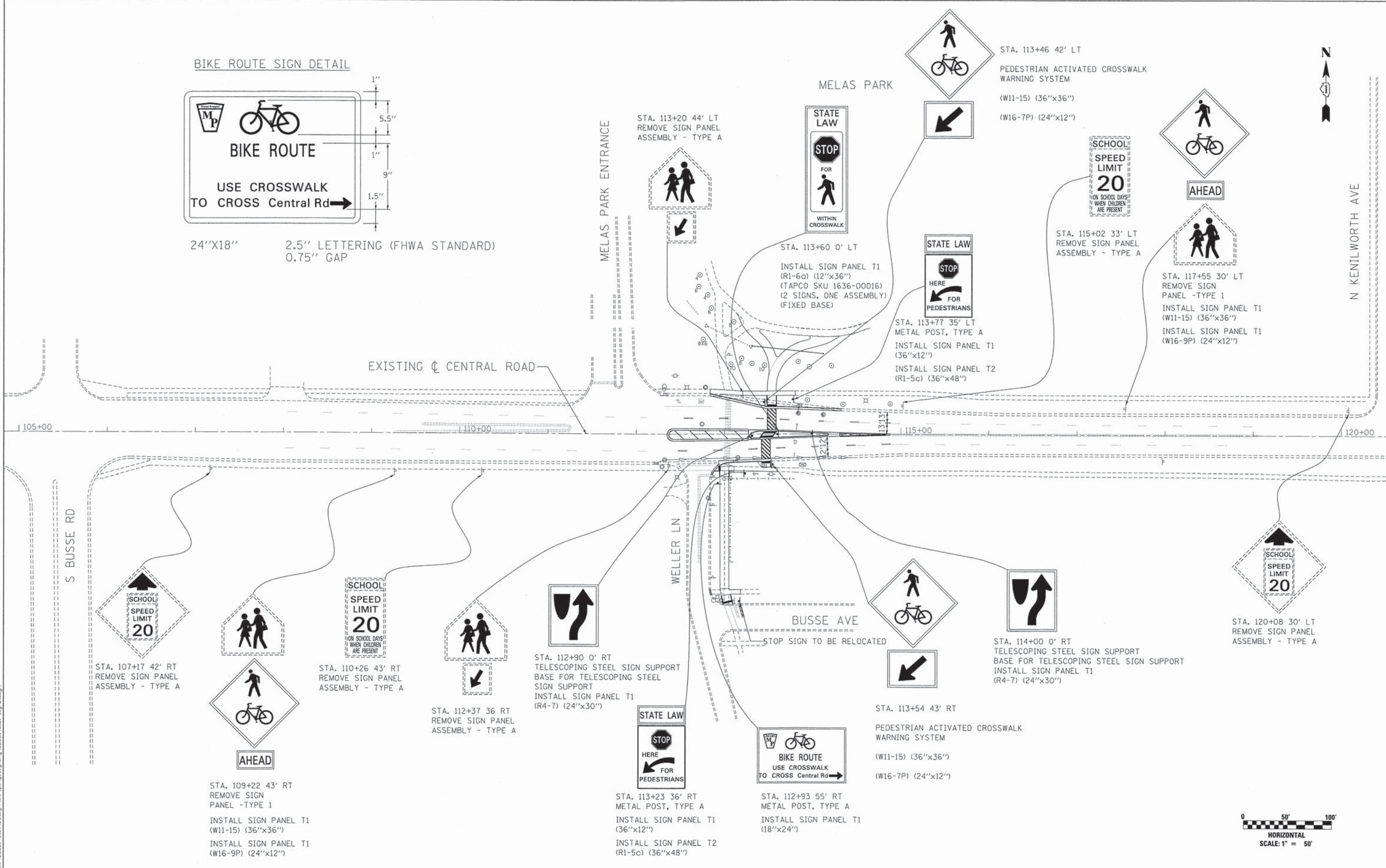

STA. 107+17 42' RT
REMOVE SIGN PANEL
ASSEMBLY - TYPE A

STA. 110+26 43' RT
REMOVE SIGN PANEL
ASSEMBLY - TYPE A

STA. 112+37 36 RT
REMOVE SIGN PANEL
ASSEMBLY - TYPE A

STA. 112+90 0' RT
TELESCOPING STEEL SIGN SUPPORT
BASE FOR TELESCOPING STEEL
SIGN SUPPORT
INSTALL SIGN PANEL T1
(R4-7) (24"x30")

STA. 113+23 36' RT
METAL POST, TYPE A
INSTALL SIGN PANEL T1
(36"x12")
INSTALL SIGN PANEL T2
(R1-5c) (36"x48")

STA. 112+93 55' RT
METAL POST, TYPE A
INSTALL SIGN PANEL T1
(18"x24")

STA. 113+54 43' RT
PEDESTRIAN ACTIVATED CROSSWALK
WARNING SYSTEM
(W11-15) (36"x36")
(W16-7P) (24"x12")

STA. 114+00 0' RT
TELESCOPING STEEL SIGN SUPPORT
BASE FOR TELESCOPING STEEL SIGN SUPPORT
INSTALL SIGN PANEL T1
(R4-7) (24"x30")

STA. 120+08 30' LT
REMOVE SIGN PANEL
ASSEMBLY - TYPE A

STA. 113+60 0' LT
INSTALL SIGN PANEL T1
(R1-6a) (12"x36")
(TAPCO SKU 1636-00016)
(2 SIGNS, ONE ASSEMBLY)
(FIXED BASE)

STA. 113+77 35' LT
METAL POST, TYPE A
INSTALL SIGN PANEL T1
(36"x12")
INSTALL SIGN PANEL T2
(R1-5c) (36"x48")

STA. 115+02 33' LT
REMOVE SIGN PANEL
ASSEMBLY - TYPE A

STA. 117+55 30' LT
REMOVE SIGN
PANEL -TYPE 1
INSTALL SIGN PANEL T1
(W11-15) (36"x36")
INSTALL SIGN PANEL T1
(W16-9P) (24"x12")



FILE NAME = N:\PROJECTS\082014\082014\Design\Signing\082014\082014.dgn

Ciorba Group, Inc.
CONSULTING ENGINEERS
5507 North Cumberland Avenue, Suite 402
Chicago, Illinois 60656
Tel. 773.775.4009 Fax 773.775.4014

USER NAME = jatanasoo	DESIGNED - JPA	REVISED -
DRAWN - MLD	REVISED -	
PLOT SCALE = 50.0000' / 1"	CHECKED - DJO	REVISED -
PLOT DATE = 5/4/2015	DATE - 5/4/2015	REVISED -

**VILLAGE OF MOUNT PROSPECT
SAFE ROUTES TO SCHOOL**

**CENTRAL RD AT WELLER LN PEDESTRIAN CROSSING IMPROVEMENTS
SIGNING PLAN**

SCALE: 1" = 50' SHEET 1 OF 1 SHEETS STA. TO STA.

F.A.U. RTE. 1300	SECTION 14-00162-00-SP	COUNTY COOK	TOTAL SHEETS 16	SHEET NO. 13
			CONTRACT NO. 61B72	
ILLINOIS FED. AID PROJECT				

BILL OF MATERIALS - CARMANAH R920 RECTANGULAR RAPID FLASHING BEACON SYSTEM		
Item No.	Material	Quantity
1	R920 Rectangular Rapid Flashing Solar Engine with 4 1/2" Diameter Pole Mounting	2
2	R920 Lightbar with Confirmation Light on Both Ends	4
3	R920 Pushbutton Kit, Polara Bulldog with Round Pole Mount	2
4	R920 Pushbutton Frame Kit, 9x12, Yellow	2
5	MUTCD Compliant R10-25 Pushbutton Sign for R920 RRFB System, 9x12	2
6	Pedestrian/Bicycle Sign W11-15, 30x30, FYG, Type ZZ	4
7	Left Arrow Sign W16-7p, 24x12, FYG, Type ZZ	2
8	Right Arrow Sign W16-7p, 24x12, FYG, Type ZZ	2
9	Galvanized Steel Pole, 13'	2
10	Traffic Signal Base, Octagonal	2

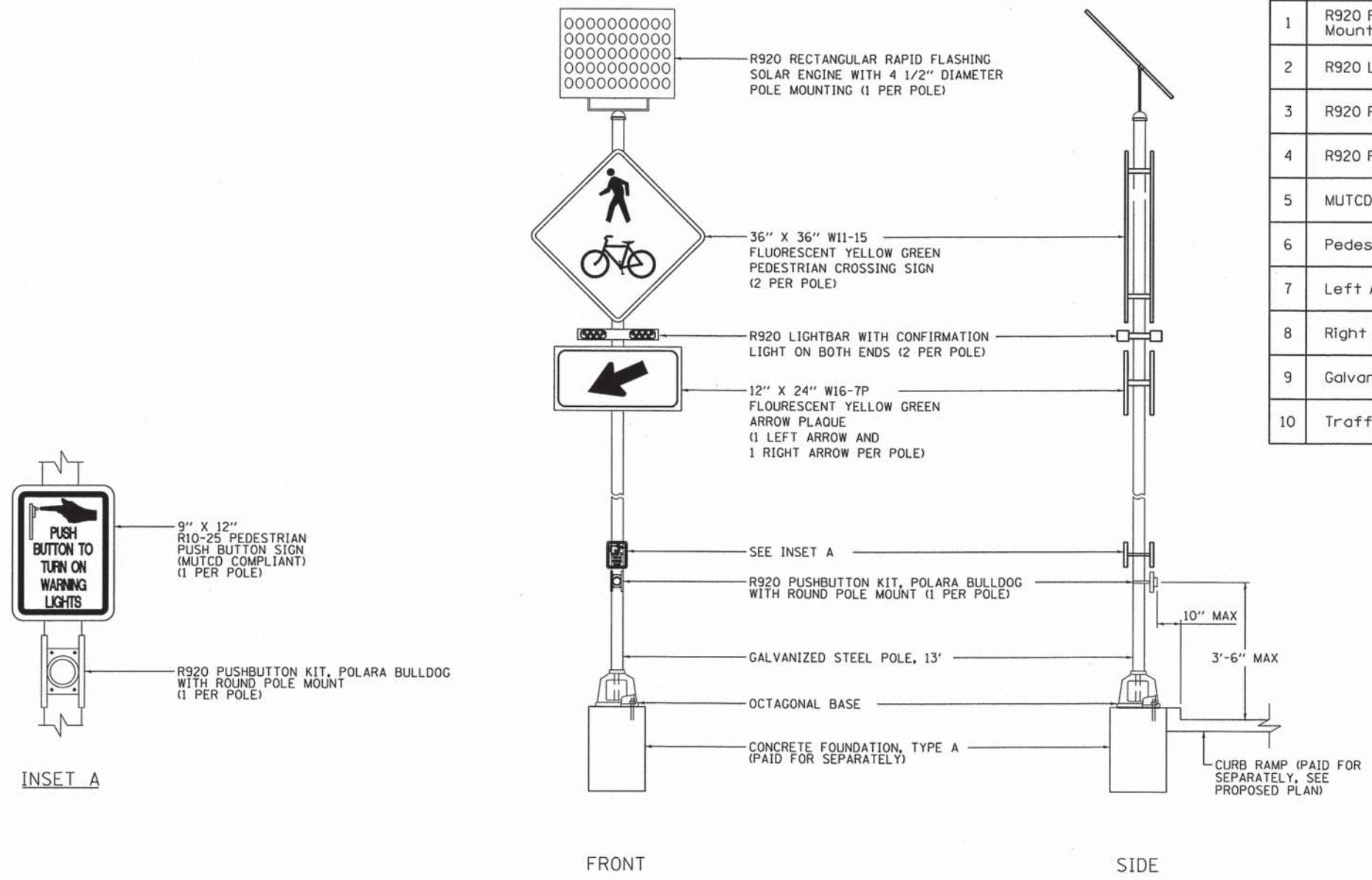

PEDESTRIAN ACTIVATED CROSSWALK WARNING SYSTEM
 (CARMANAH R920 RECTANGULAR RAPID FLASHING BEACON SYSTEM)
 ACTUAL DIMENSIONS AND MOUNTING REQUIREMENTS PER
 SPECIAL PROVISIONS AND MANUFACTURER RECOMMENDATIONS

UNLESS NOTED, ALL ITEMS SHOWN IN DETAIL ARE INCLUDED
 IN THE COST OF "PEDESTRIAN ACTIVATED CROSSWALK WARNING
 SYSTEM" (SEE BILL OF MATERIALS)

FILE NAME = N:\PROJ\14022014\01\Design\Detail\14022014.dwg

USER NAME = jstanoos	DESIGNED - JPA	REVISED -
PLT SCALE = 1/8" = 1'-0"	DRAWN - MLD	REVISED -
PLT DATE = 5/4/2015	CHECKED - DJO	REVISED -
	DATE - 5/4/2015	REVISED -

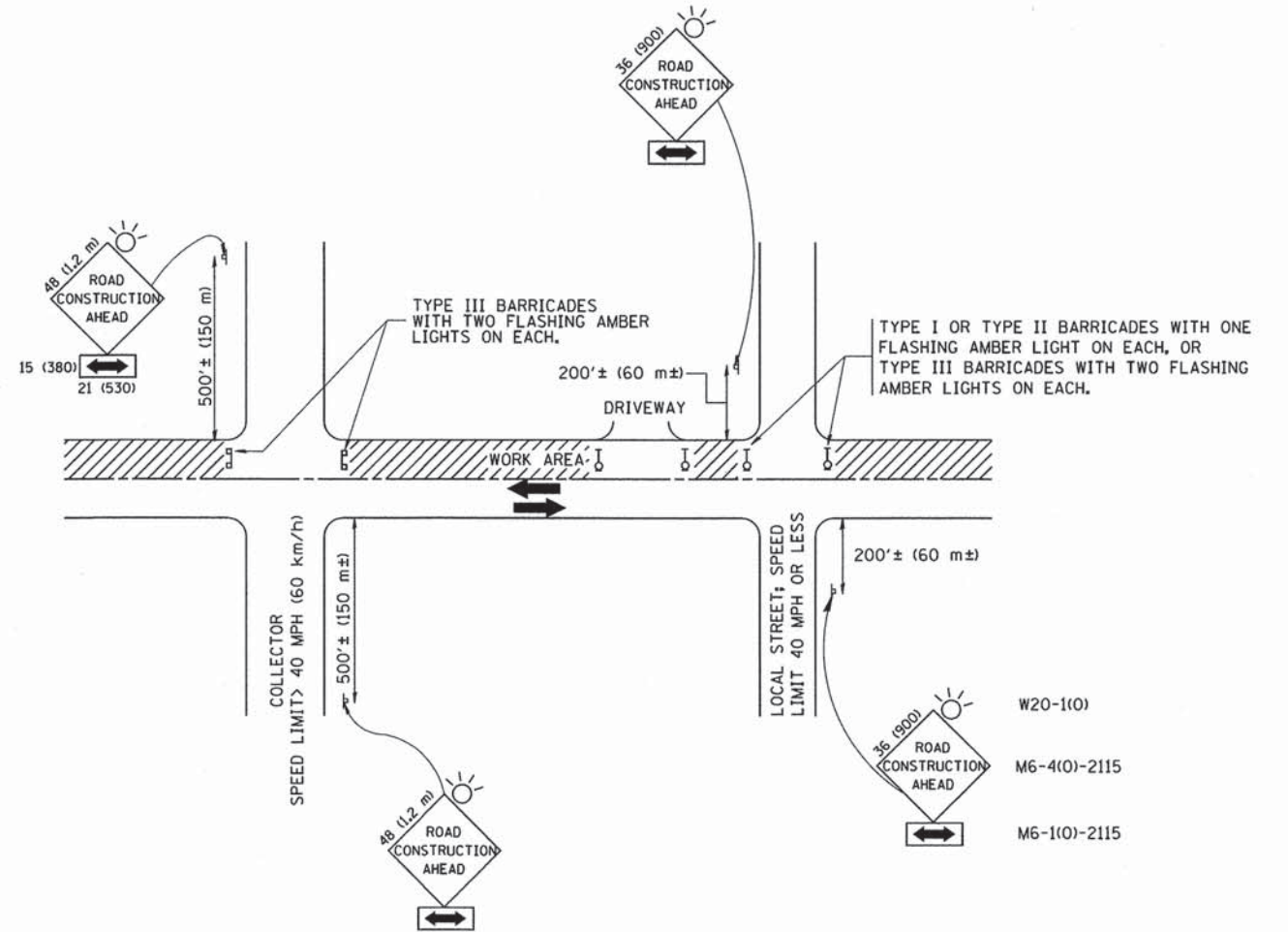

TRAFFIC CONTROL AND PROTECTION FOR SIDE ROADS, INTERSECTIONS, AND DRIVEWAYS

NOTES:

A. FOR NO LANE RESTRICTION ON THE SIDE ROAD OR DRIVEWAYS

1. SIDE ROAD WITH A SPEED LIMIT OF 40 MPH (60 km/h) OR LESS AS SHOWN ON THE DRAWING AND AS DIRECTED BY THE ENGINEER:
 - a) ONE ROAD CONSTRUCTION AHEAD SIGN 36 x 36 (900x900) WITH A FLASHER AND FLAG MOUNTED ON IT APPROXIMATELY 200' (60 m) IN ADVANCE OF THE MAIN ROUTE.
 - b) THE CLOSED PORTION OF THE MAIN ROUTE SHALL BE PROTECTED BY BLOCKING WITH TYPE I, TYPE II OR TYPE III BARRICADES, 1/3 OF THE CROSS SECTION OF THE CLOSED PORTION.
2. SIDE ROAD WITH A SPEED LIMIT GREATER THAN 40 MPH (60 km/h) AS SHOWN ON THE DRAWING AND AS DIRECTED BY THE ENGINEER:
 - a) ONE ROAD CONSTRUCTION AHEAD SIGN 48 x 48 (1.2 m x 1.2 m) WITH A FLASHER MOUNTED ON IT APPROXIMATELY 500' (150 m) IN ADVANCE OF THE MAIN ROUTE.
 - b) THE CLOSED PORTION OF THE MAIN ROUTE SHALL BE PROTECTED BY BLOCKING WITH TYPE III BARRICADES, 1/2 OF THE CROSS SECTION OF THE CLOSED PORTION.
3. WHEN THE SIDE ROAD LIES BETWEEN THE BEGINNING OF THE MAINLINE SIGNING AND THE WORK ZONE, A SINGLE HEADED ARROW (M6-1) SHALL BE USED IN LIEU OF THE DOUBLE HEADED ARROW (M6-4).

B. FOR A LANE CLOSURE ON A SIDE ROAD OR DRIVEWAY:

- USE APPLICABLE PORTIONS OF THE TYPICAL APPLICATION OF TRAFFIC CONTROL DEVICES (STD. 701501, STD. 701606 OR THE APPROPRIATE STANDARD). THE SPACING OF SIGNS AND BARRICADES SHALL BE ADJUSTED FOR FIELD CONDITIONS AS DIRECTED BY THE ENGINEER. THE DIRECTIONAL ARROW SHALL BE COVERED OR REMOVED WHEN NO LONGER CONSISTENT WITH THE SIDE ROAD LANE CLOSURE.
- C. ADVANCE WARNING SIGNS ARE TO BE OMITTED ON DRIVEWAY UNLESS OTHERWISE NOTED.
- D. THE TRAFFIC CONTROL AND PROTECTION FOR SIDE ROADS, INTERSECTIONS, AND DRIVEWAYS SHALL BE INCIDENTAL TO THE COST OF SPECIFIED TRAFFIC CONTROL STANDARDS OR ITEMS.

All dimensions are in millimeters (inches) unless otherwise shown.

FILE NAME = W:\diststd\22x34\tcl0.dgn	USER NAME = goglionobt	DESIGNED - LHA	REVISED - J. OBERLE 10-18-95
		DRAWN -	REVISED - A. HOUSEH 03-06-96
	PLOT SCALE = 50,000' / IN.	CHECKED -	REVISED - A. HOUSEH 10-15-96
	PLOT DATE = 1/4/2008	DATE - 06-89	REVISED - T. RAMMACHER 01-06-00

STATE OF ILLINOIS
DEPARTMENT OF TRANSPORTATION

TRAFFIC CONTROL AND PROTECTION FOR
SIDE ROADS, INTERSECTIONS, AND DRIVEWAYS

SCALE: NONE SHEET NO. 1 OF 1 SHEETS STA. TO STA.

F.A. RTE.	SECTION	COUNTY	TOTAL SHEETS	SHEET NO.
1300	14-00162-00-SP	COOK	16	14
TC-10			CONTRACT NO.	
FED. ROAD DIST. NO. 1 [ILLINOIS] FED. AID PROJECT				

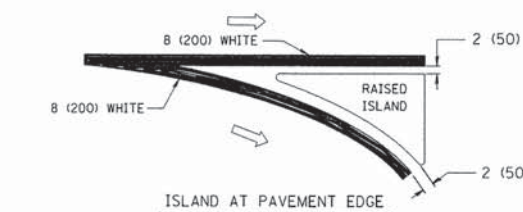
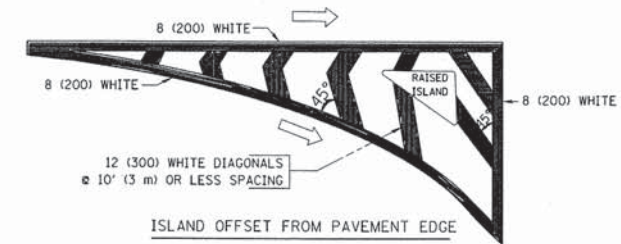
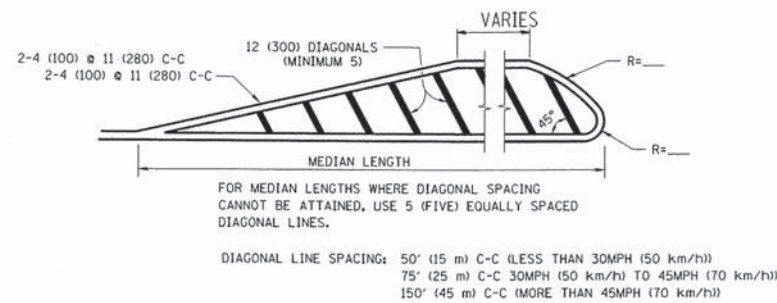
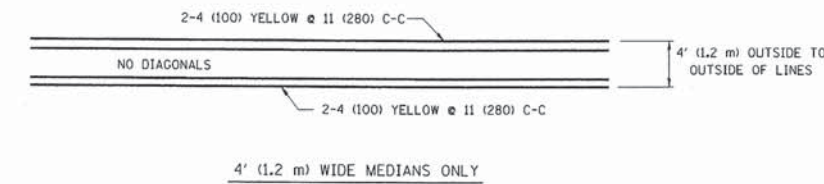
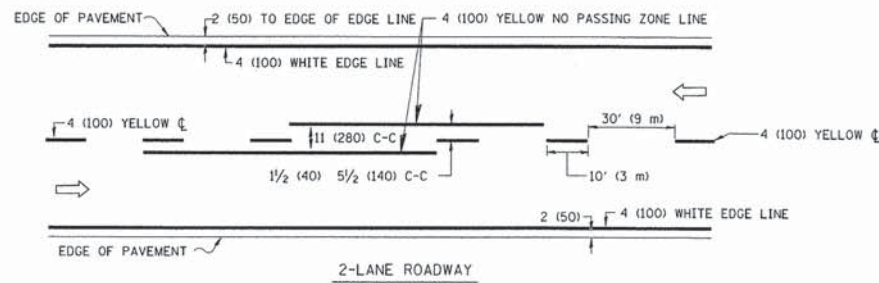

TYPICAL ISLAND MARKING

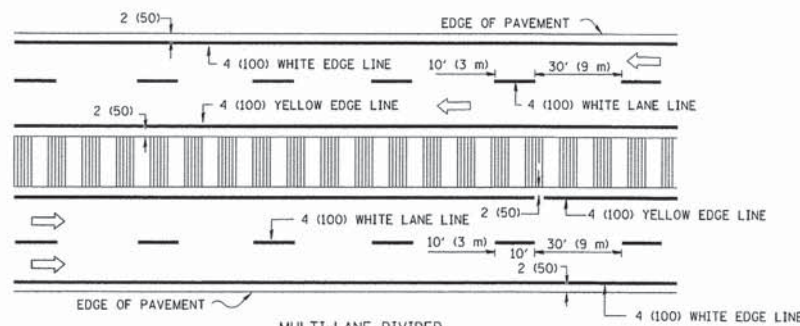
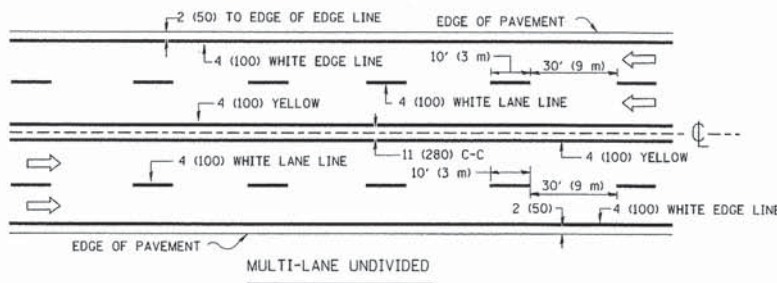

NOTE: MEDIANS WITH BARRIER CURB DO NOT REQUIRE AN EDGE LINE

TYPICAL LANE AND EDGE LINE MARKING

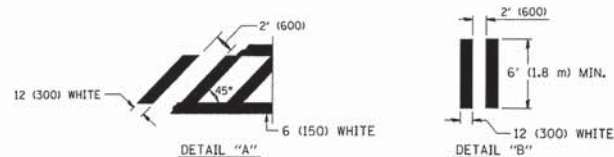
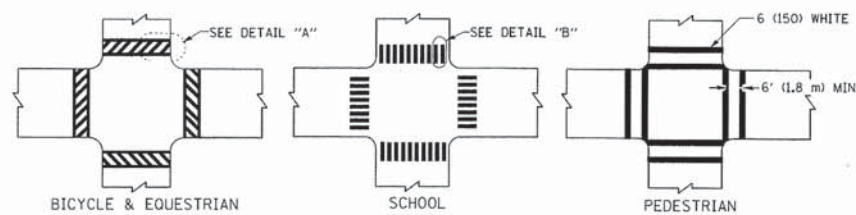

TYPICAL CROSSWALK MARKING

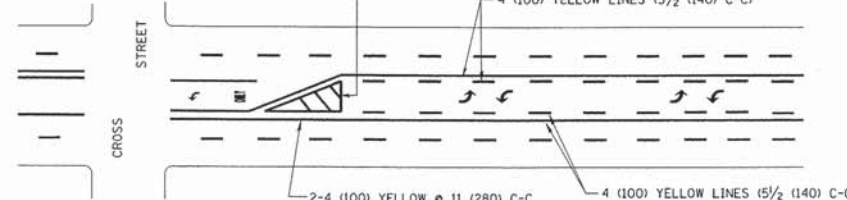

A MINIMUM OF TWO PAIRS OF TURN ARROWS SHALL BE USED, WHITE IN COLOR. ADDITIONAL PAIRS SHALL BE PLACED AT 200' (60 m) TO 300' (90 m) INTERVALS.

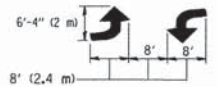

MEDIAN WITH TWO-WAY LEFT TURN LANE

TYPICAL PAINTED MEDIAN MARKING

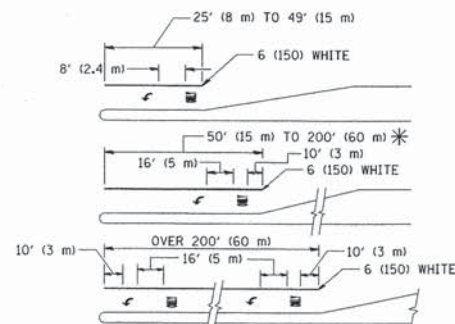

FULL SIZE LETTERS 8" (2.4 m) AND ARROWS SHALL BE USED. AREA = 15.6 SQ. FT. (1.5 m²) ONLY AREA = 20.8 SQ. FT. (1.9 m²)

* TURN LANES IN EXCESS OF 400' (120 m) IN LENGTH MAY HAVE AN ADDITIONAL SET OF ARROW - "ONLY" INSTALLED MIDWAY BETWEEN THE OTHER TWO SETS OF ARROW - "ONLY".

TYPICAL LEFT (OR RIGHT) TURN LANE

TYPICAL TURN LANE MARKING

TYPE OF MARKING	WIDTH OF LINE	PATTERN	COLOR	SPACING / REMARKS
CENTERLINE ON 2 LANE PAVEMENT	4 (100)	SKIP-DASH	YELLOW	10' (3 m) LINE WITH 30' (9 m) SPACE
CENTERLINE ON MULTI-LANE UNDIVIDED PAVEMENT	2 @ 4 (100)	SOLID	YELLOW	11 (280) C-C
NO PASSING ZONE LINES: FOR ONE DIRECTION FOR BOTH DIRECTIONS	4 (100) 2 @ 4 (100)	SOLID SOLID	YELLOW YELLOW	5/2 (140) C-C FROM SKIP-DASH CENTERLINE 11 (280) C-C OMIT SKIP-DASH CENTERLINE BETWEEN
LANE LINES	4 (100) 5 (125) ON FREEWAYS	SKIP-DASH SKIP-DASH	WHITE WHITE	10' (3 m) LINE WITH 30' (9 m) SPACE
DOTTED LINES (EXTENSIONS OF CENTER, LANE OR TURN LANE MARKINGS)	SAME AS LINE BEING EXTENDED	SKIP-DASH	SAME AS LINE BEING EXTENDED	2' (600) LINE WITH 6' (1.8 m) SPACE
EDGE LINES	4 (100)	SOLID	YELLOW-LEFT WHITE-RIGHT	OUTLINE MOUNTABLE MEDIANS IN YELLOW; EDGE LINES ARE NOT USED NEXT TO BARRIER CURB
TURN LANE MARKINGS	6 (150) LINE; FULL SIZE LETTERS & SYMBOLS (8" (2.4m))	SOLID	WHITE	SEE TYPICAL TURN LANE MARKING DETAIL
TWO WAY LEFT TURN MARKING	2 @ 4 (100) EACH DIRECTION 8" (2.4m) LEFT ARROW	SKIP-DASH AND SOLID IN PAIRS	YELLOW WHITE	10' (3 m) LINE WITH 30' (9 m) SPACE FOR SKIP-DASH; 5/2 (140) C-C BETWEEN SOLID LINE AND SKIP-DASH LINE SEE TYPICAL TWO-WAY LEFT TURN MARKING DETAIL
CROSSWALK LINES (PEDESTRIAN) A. DIAGONALS (BIKE & EQUESTRIAN) B. LONGITUDINAL BARS (SCHOOL)	2 @ 6 (150) 12 (300) @ 45° 12 (300) @ 90°	SOLID SOLID SOLID	WHITE WHITE WHITE	NOT LESS THAN 6' (1.8 m) APART 2' (600) APART 2' (600) APART SEE TYPICAL CROSSWALK MARKING DETAILS.
STOP LINES	24 (600)	SOLID	WHITE	PLACE 4' (1.2 m) IN ADVANCE OF AND PARALLEL TO CROSSWALK, IF PRESENT, OTHERWISE, PLACE AT DESIRED STOPPING POINT, PARALLEL TO CROSSROAD CENTERLINE, WHERE POSSIBLE
PAINTED MEDIANS	2 @ 4 (100) WITH 12 (300) @ 45° NO DIAGONALS USED FOR 4' (1.2 m) WIDE MEDIANS	SOLID	YELLOW: TWO WAY TRAFFIC WHITE: ONE WAY TRAFFIC	11 (280) C-C FOR THE DOUBLE LINE SEE TYPICAL PAINTED MEDIAN MARKING.
GORE MARKING AND CHANNELIZING LINES	8 (200) WITH 12 (300) DIAGONALS @ 45°	SOLID	WHITE	DIAGONALS: 15' (4.5 m) C-C (LESS THAN 30MPH (50 km/h)) 20' (6 m) C-C 30MPH (50 km/h) TO 45MPH (70 km/h) 30' (9 m) C-C (OVER 45MPH (70 km/h))
RAILROAD CROSSING	24 (600) TRANSVERSE LINES; "RR" IS 6' (1.8 m) LETTERS; 16 (400) LINE FOR "X"	SOLID	WHITE	SEE STATE STANDARD 780001 AREA OF: "R"=3.6 SQ. FT. (0.33 m ²) EACH "X"=54.0 SQ. FT. (5.0 m ²)
SHOULDER DIAGONALS	12 (300) @ 45°	SOLID	WHITE - RIGHT YELLOW - LEFT	50' (15 m) C-C (LESS THAN 30MPH (50 km/h)) 75' (25 m) C-C (30 MPH (50 km/h) TO 45MPH (70 km/h)) 150' (45 m) C-C (OVER 45MPH (70 km/h))

FOR FURTHER DETAILS ON PAVEMENT MARKING REFER TO STANDARD SPECIFICATIONS FOR ROAD AND BRIDGE CONSTRUCTION AND STATE STANDARD 780001.

All dimensions are in inches (millimeters) unless otherwise shown.

FILE NAME =	USER NAME = drvakosgn	DESIGNED - EVERS	REVISED - T. RAMMACHER 10-27-94
ci:\pe_work\pwsdot\drvakosgn\d8188315\to3.dgn		DRAWN -	REVISED - C. JUCIUS 09-09-09
PLOT SCALE = 50.000' / IN.		CHECKED -	REVISED -
PLOT DATE = 9/9/2009		DATE - 03-19-90	REVISED -

STATE OF ILLINOIS
DEPARTMENT OF TRANSPORTATION

DISTRICT ONE			
TYPICAL PAVEMENT MARKINGS			
SCALE: NONE	SHEET NO. 1 OF 1 SHEETS	STA. TO STA.	

F.A. RTE.	SECTION	COUNTY	TOTAL SHEETS	SHEET NO.
1300	14-00162-00-SP	COOK	16	15
TC-13			CONTRACT NO.	
FED. ROAD DIST. NO. 1 ILLINOIS FED. AID PROJECT				

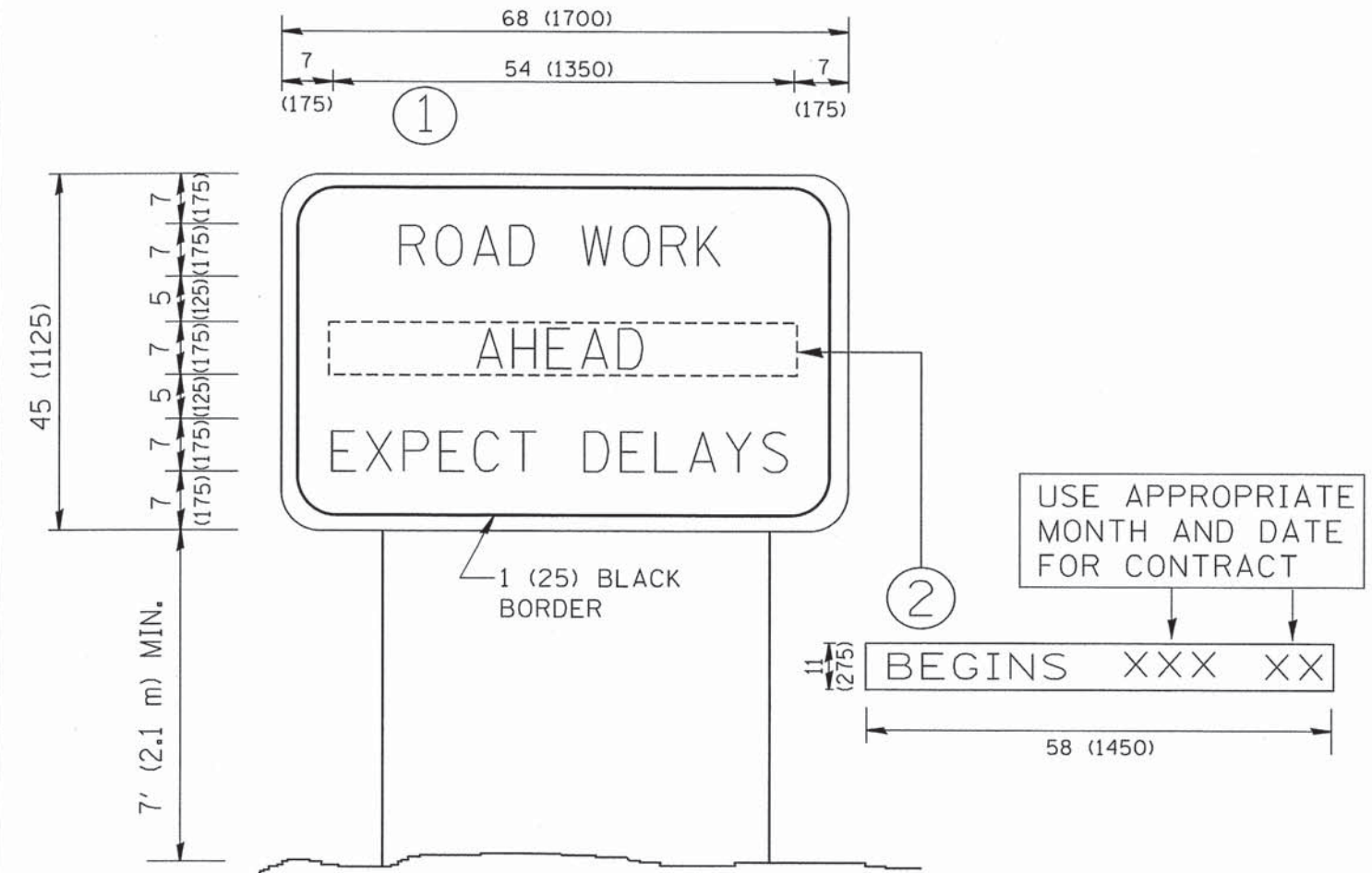

NOTES:

1. USE BLACK LETTERING ON ORANGE BACKGROUND.
2. ERECT SIGNS IN ADVANCE OF THE LOCATION FOR THE "ROAD CONSTRUCTION AHEAD" SIGN AT LOCATIONS AS DIRECTED BY THE ENGINEER.
3. ERECT SIGN ① WITH INSTALLED PANEL ② ONE WEEK PRIOR TO THE START OF CONSTRUCTION.
4. REMOVE PANEL ② SOON AFTER THE START OF CONSTRUCTION.
5. SEE SPECIAL PROVISION FOR "TEMPORARY INFORMATION SIGNING" FOR ADDITIONAL INFORMATION.
6. ONE SIGN ASSEMBLY EQUALS 25.70 SQ. FT. (2.3 SQ. M.)
7. SHALL BE PAID FOR AS TEMPORARY INFORMATION SIGNING.

ALL DIMENSIONS ARE IN INCHES (MILLIMETERS) UNLESS OTHERWISE SHOWN.

FILE NAME = W:\diststd\22x34\to22.dgn	USER NAME = goglianobt	DESIGNED -	REVISED - R. MIRS 09-15-97	STATE OF ILLINOIS DEPARTMENT OF TRANSPORTATION	ARTERIAL ROAD INFORMATION SIGN		F.A. RTE. =	SECTION	COUNTY	TOTAL SHEETS	SHEET NO.	
	PLOT SCALE = 50,000 ' / IN.	DRAWN -	REVISED - R. MIRS 12-11-97		SCALE: NONE	SHEET NO. 1 OF 1 SHEETS	STA.	1300	14-00162-00-SP	COOK	16	16
	PLOT DATE = 1/4/2008	CHECKED -	REVISED - T. RAMMACHER 02-02-99					TC-22		CONTRACT NO.		
		DATE -	REVISED - C. JUCIUS 01-31-07					FED. ROAD DIST. NO. 1 ILLINOIS FED. AID PROJECT				