

SUMMARY OF QUANTITIES

Item Number	S.P.	Pay Item Number	Description	Unit	Total	Construction Type Code		
						0003	0021	0042
31		42000301	Portland Cement Concrete Pavement, 8" (Jointed)	SQ YD	3577	3577		
32		42300400	Portland Cement Concrete Driveway Pavement, 8 Inch	SQ YD	630	630		
33		42400200	Portland Cement Concrete Sidewalk 5 Inch	SQ FT	10212	10212		
34		42400800	Detectable Warnings	SQ FT	625	625		
35	*	44000100	Pavement Removal	SQ YD	8841	8841		
36	*	44000200	Driveway Pavement Removal	SQ YD	307	307		
37		44000300	Curb Removal	FOOT	10	10		
38		44000500	Combination Curb and Gutter Removal	FOOT	5545	5545		
39		44000600	Sidewalk Removal	SQ FT	4002	4002		
40		44003100	Median Removal	SQ FT	3040	3040		
41		44004250	Paved Shoulder Removal	SQ YD	650	650		
42		44200956	Class B Patches, Type II, 9 Inch	SQ YD	46.2	46.2		
43		44200962	Class B Patches, Type III, 9 Inch	SQ YD	15.7	15.7		
44		44200964	Class B Patches, Type IV, 9 Inch	SQ YD	212	212		
45		44201696	Class D Patches, Type IV, 4 Inch	SQ YD	237	237		
46		44300200	Strip Reflective Crack Control Treatment	FOOT	450	450		
47		48203029	Hot-Mix Asphalt Shoulders, 8"	SQ YD	220	220		
48		50105220	Pipe Culvert Removal	FOOT	185	185		
49		50300300	Protective Coat	SQ YD	8053	8053		
50		542D0223	Pipe Culverts, Class D, Type 1 18"	FOOT	89	89		
51		54213660	Precast Reinforced Concrete Flared End Sections 15"	EACH	1	1		
52		54213669	Precast Reinforced Concrete Flared End Sections 24"	EACH	1	1		
53		550A0050	Storm Sewers, Class A, Type 1 12"	FOOT	718	718		
54		550A0070	Storm Sewers, Class A, Type 1 15"	FOOT	624	624		
55		550A0090	Storm Sewers, Class A, Type 1 18"	FOOT	440	440		
56		550A0110	Storm Sewers, Class A, Type 1 21"	FOOT	60	60		
57		550A0120	Storm Sewers, Class A, Type 1 24"	FOOT	195	195		
58		550A2360	Storm Sewers, Rubber Gasket, Class A, Type 1 24"	FOOT	152	152		
59		55100500	Storm Sewer Removal, 12"	FOOT	277	277		
60		55100700	Storm Sewer Removal, 15"	FOOT	168	168		

LAYOUT MWH 12/10/10
 DRAWN MWH 02/12/13
 REVIEWED DPA 02/12/13

FILE NAME =	USER NAME = *USER*	DESIGNED - DPA	REVISED -
FILES		DRAWN - MWH	REVISED -
		CHECKED - DPA	REVISED -
		DATE - *DATE*	REVISED -



SUMMARY OF QUANTITIES

F.A.U. RTE.	SECTION	COUNTY	TOTAL SHEETS	SHEET NO.
5149	04-00345-00-CH	WINNEBAGO	129	4
CONTRACT NO. 85616				
ILLINOIS FED. AID PROJECT				

SUMMARY OF QUANTITIES

Item Number	S.P.	Pay Item Number	Description	Unit	Total	Construction Type Code		
						0003	0021	0042
61		55100900	Storm Sewer Removal, 18"	FOOT	488	488		
Δ 62	*	56400200	Fire Hydrants to be Moved (Special)	EACH	5	5		
Δ 63	*	56400300	Fire Hydrants to be Adjusted	EACH	1	1		
64		60107600	Pipe Underdrains 4"	FOOT	151	151		
65		60221100	Manholes, Type A, 5'-Diameter, Type 1 Frame, Closed Lid	EACH	1	1		
66		60252800	Catch Basins to be Reconstructed	EACH	2	2		
67		60257900	Manholes to be Reconstructed	EACH	1	1		
68		60260100	Inlets to be Adjusted	EACH	1	1		
69		60263000	Inlets to be Reconstructed with New Type 1 Frame, Closed Lid	EACH	5	5		
70		60265700	Valve Vaults to be Adjusted	EACH	17	17		
71		60266600	Valve Boxes To Be Adjusted	EACH	3	3		
72		60500040	Removing Manholes	EACH	2	2		
73		60500060	Removing Inlets	EACH	4	4		
74		60603500	Combination Concrete Curb and Gutter, Type B-6.06	FOOT	209	209		
75		60603800	Combination Concrete Curb and Gutter, Type B-6.12	FOOT	47	47		
76		60604400	Combination Concrete Curb and Gutter, Type B-6.18	FOOT	3610	3610		
77		60605000	Combination Concrete Curb and Gutter, Type B-6.24	FOOT	3581	3581		
78		60607400	Combination Concrete Curb and Gutter, Type B-9.24	FOOT	166	166		
79		60618300	Concrete Median Surface, 4 Inch	SQ FT	3043	3043		
80		60619600	Concrete Median, Type SB-6.12	SQ FT	4393	4393		
81		60624600	Corrugated Median	SQ FT	100	100		
Δ 82		66400105	Chain Link Fence, 4'	FOOT	170	1		
Δ 83		66900200	Non-Special Waste Disposal	CU YD	1900	1900		
Δ 84		66900450	Special Waste Plans and Reports	L SUM	1	1		
Δ 85		66900530	Soil Disposal Analysis	EACH	4	4		
86		67100100	Mobilization	L SUM	1			
87		70300100	Short-Term Pavement Marking	FOOT	9399	9399		
88		70300210	Temporary Pavement Marking Letters and Symbols	SQ FT	1012	1012		
89		70300220	Temporary Pavement Marking - Line 4"	FOOT	52865	52865		
90		70300280	Temporary Pavement Marking - Line 24"	FOOT	535	535		

A Specialty Item

LAYOUT: MWH 12/10/10
 DRAWN: MWH 02/12/13
 REVIEWED: DPA 02/12/13

FILE NAME =	USER NAME = #USER#	DESIGNED - DPA	REVISED -
#FILES#		DRAWN - MWH	REVISED -
		CHECKED - DPA	REVISED -
		DATE - #DATE#	REVISED -



SUMMARY OF QUANTITIES

F.A.U. RTE.	SECTION	COUNTY	TOTAL SHEETS	SHEET NO.
5149	04-00345-00-CH	WINNEBAGO	129	5
CONTRACT NO. 85616				
ILLINOIS FED. AID PROJECT				

SUMMARY OF QUANTITIES

Item Number	S.P.	Pay Item Number	Description	Unit	Total	Construction Type Code		
						0003	0021	0042
91		70301000	Work Zone Pavement Marking Removal	SQ FT	16188	16188		
92		72400100	Remove Sign Panel Assembly - Type A	EACH	13	13		
93		72400500	Relocate Sign Panel Assembly - Type A	EACH	12	12		
Δ 94		78000100	Thermoplastic Pavement Marking - Letters and Symbols	SQ FT	556	556		
Δ 95		78000200	Thermoplastic Pavement Marking - Line 4"	FOOT	5519	5519		
Δ 96		78000400	Thermoplastic Pavement Marking - Line 6"	FOOT	960	960		
Δ 97		78000500	Thermoplastic Pavement Marking - Line 8"	FOOT	2833	2833		
Δ 98		78000600	Thermoplastic Pavement Marking - Line 12"	FOOT	1487	1487		
Δ 99		78000650	Thermoplastic Pavement Marking - Line 24"	FOOT	342	342		
Δ 100		78005100	Epoxy Pavement Marking - Letters and Symbols	SQ FT	448	448		
Δ 101		78005110	Epoxy Pavement Marking - Line 4"	FOOT	6732	6732		
Δ 102		78005130	Epoxy Pavement Marking - Line 6"	FOOT	945	945		
Δ 103		78005140	Epoxy Pavement Marking - Line 8"	FOOT	3017	3017		
Δ 104		78005150	Epoxy Pavement Marking - Line 12"	FOOT	1406	1406		
Δ 105		78005180	Epoxy Pavement Marking - Line 24"	FOOT	259	259		
Δ 106		78100100	Raised Reflective Pavement Marker	EACH	330	330		
Δ 107		78300100	Pavement Marking Removal	SQ FT	3816	3816		
Δ 108		80400100	Electric Service Installation	EACH	1	1		
Δ 109		80500100	Service Installation, Type A	EACH	3		3	
Δ 110		81028720	Underground Conduit, Coilable Non-Metallic Conduit, 1" Dia.	FOOT	6500	6500		
Δ 111		81028730	Underground Conduit, Coilable Non-Metallic Conduit, 1 1/4" Dia.	FOOT	78		78	
Δ 112		81028740	Underground Conduit, Coilable Non-Metallic Conduit, 1 1/2" Dia.	FOOT	79		79	
Δ 113		81028750	Underground Conduit, Coilable Non-Metallic Conduit, 2" Dia.	FOOT	3796	2630	1166	
Δ 114		81028770	Underground Conduit, Coilable Non-Metallic Conduit, 3" Dia.	FOOT	370	207	163	
Δ 115		81028780	Underground Conduit, Coilable Non-Metallic Conduit, 3 1/2" Dia.	FOOT	250		250	
Δ 116		81028790	Underground Conduit, Coilable Non-Metallic Conduit, 4" Dia.	FOOT	396		396	
Δ 117		81028800	Underground Conduit, Coilable Non-Metallic Conduit, 5" Dia.	FOOT	507		507	
Δ 118		81400100	Handhole	EACH	14		14	
Δ 119		81400300	Double Handhole	EACH	3		3	
Δ 120		81400730	Handhole, Composite Concrete	EACH	16	16		

PAY ITEMS SHIFTED
DOWN FOR PAY ITEMS
ADDED TO ADDENDUM

A Specialty
Items

LAYOUT	MWH	12/10/10
DRAWN	MWH	02/12/13
REVIEWED	DPA	02/12/13

FILE NAME =	USER NAME = #USER#	DESIGNED - DPA	REVISED -
#FILES#		DRAWN - MWH	REVISED -
		CHECKED - DPA	REVISED -
		DATE - #DATE#	REVISED -



SUMMARY OF QUANTITIES

F.A.U. RTE.	SECTION	COUNTY	TOTAL SHEETS	SHEET NO.
5149	04-00345-00-CH	WINNEBAGO	129	6
CONTRACT NO. 85616			ILLINOIS FED. AID PROJECT	

SUMMARY OF QUANTITIES

Item Number	S.P.	Pay Item Number	Description	Unit	Total	Construction Type Code		
						0003	0021	0042
△ 121		81702110	Electric Cable in Conduit, 600V (XLP-Type Use) 1/C No. 10	FOOT	29500	29500		
△ 122		81702417	Electric Cable In Conduit, 600V (XLP-Type Use), 3-1/C No. 6, 1C No. 6 Ground	FOOT	3104		3104	
△ 123		82500360	Lighting Controller, Base Mounted, 480 Volt, 100 Amp	EACH	1	1		
△ 124		83600300	Light Pole Foundation, 30" Diameter	FOOT	294	294		
△ 125		83800650	Break Away Device Coupling With Stainless Steel Screen	EACH	196	196		
△ 126		85100500	Paint New Traffic Signal Post	EACH	9		9	
△ 127		85100800	Paint New Combination Mast Arm and Pole, Under 40 ft	EACH	2		2	
△ 128		85100901	Paint New Combination Mast Arm and Pole, Over 40 ft	EACH	10		10	
△ 129		85700200	Full-Actuated Controller and Type IV Cabinet	EACH	3		3	
△ 130		87100110	Fiber Optic Cable in Conduit, No. 62.5/125, 6F	FOOT	1369		1369	
△ 131		87300925	Electric Cable in Conduit, Tracer, No. 14 1C	FOOT	2682	2682		
△ 132		87301215	Electric Cable in Conduit, Signal No. 14 2C	FOOT	5721		5721	
△ 133		87301225	Electric Cable in Conduit, Signal No. 14 3C	FOOT	5846		5846	
△ 134		87301245	Electric Cable in Conduit, Signal No. 14 5C	FOOT	5026		5026	
△ 135		87301255	Electric Cable in Conduit, Signal No. 14 7C	FOOT	8520		8520	
△ 136		87301805	Electric Cable in Conduit, Service No. 6 2C	FOOT	447		447	
△ 137		87502500	Traffic Signal Post, Galvanized Steel 16 ft.	EACH	9		9	
△ 138		87702690	Steel Mast Arm Assembly and Pole with Dual Mast Arms, 44 ft and 42 ft.	EACH	1		1	
△ 139		87702900	Steel Combination Mast Arm Assembly and Pole 34 ft.	EACH	1		1	
△ 140		87702910	Steel Combination Mast Arm Assembly and Pole 36 ft.	EACH	1		1	
△ 141		87702930	Steel Combination Mast Arm Assembly and Pole 40 ft.	EACH	3		3	
△ 142		87702980	Steel Combination Mast Arm Assembly and Pole 50 ft.	EACH	1		1	
△ 143		87702990	Steel Combination Mast Arm Assembly and Pole 54 ft.	EACH	2		2	
△ 144		87703020	Steel Combination Mast Arm Assembly and Pole 58 ft.	EACH	1		1	
△ 145		87703070	Steel Combination Mast Arm Assembly and Pole 66 ft.	EACH	1		1	
△ 146		87800100	Concrete Foundation, Type A	FOOT	27		27	
△ 147		87800200	Concrete Foundation, Type D	FOOT	10.5		10.5	
△ 148	*	87800400	Concrete Foundation, Type E 30-Inch Diameter	FOOT	10		10	
△ 149	*	87800415	Concrete Foundation, Type E 36-Inch Diameter	FOOT	104		104	
△ 150	*	87800420	Concrete Foundation, Type E 42-Inch Diameter	FOOT	46		46	

PAY ITEMS SHIFTED
DOWN FOR PAY ITEMS
ADDED TO ADDENDUM

△ Specialty
Items

LAYOUT
DRAWN
REVIEWED
MWH 12/10/10
MWH 02/12/13
DPA 02/12/13

FILE NAME *	USER NAME = #USER*	DESIGNED - DPA	REVISED -
#FILES*		DRAWN - MWH	REVISED -
		CHECKED - DPA	REVISED -
		DATE - #DATE*	REVISED -



SUMMARY OF QUANTITIES

F.A.U. RTE.	SECTION	COUNTY	TOTAL SHEETS	SHEET NO.
5149	04-00345-00-CH	WINNEBAGO	129	7
CONTRACT NO. 85616				
ILLINOIS FED. AID PROJECT				

SUMMARY OF QUANTITIES

Item Number	S.P.	Pay Item Number	Description	Unit	Total	Construction Type Code		
						0003	0021	0042
151		88030020	Signal Head, LED, 1-Face, 3-Section, Mast Arm Mounted	EACH	22		22	
152		88030100	Signal Head, LED, 1-Face, 5-Section, Bracket Mounted	EACH	23		23	
153		88030110	Signal Head, LED, 1-Face, 5-Section, Mast Arm Mounted	EACH	13		13	
154		88102825	Pedestrian Signal Head, Polycarbonate, LED, 1-Face, Bracket Mounted with Count Down Timer	EACH	28		28	
155		88200100	Traffic Signal Backplate	EACH	35		35	
156		88800100	Pedestrian Push Button	EACH	28		28	
157		89000100	Temporary Traffic Signal Installation	EACH	1		1	
158	*	89502375	Remove Existing Traffic Signal Equipment	EACH	3		3	
159	*	89502380	Remove Existing Handhole	EACH	12	12		
160	*	89502385	Remove Existing Concrete Foundation	EACH	2	2		
161		C2C05824	Shrub, Rhus Aromatica Gro-Low (Gro-Low Fragrant Sumac), 2' Width, Container	EACH	55	55		
162		C2C09918	Shrub, Spirea X Bumalda Goldflame (Gold Flame Bumald Spirea), 18" Height, Container	EACH	43	43		
163		K0013020	Perennial Plants, Prairie Type, Gallon Pot	UNIT	0.6	0.6		
164	*	K0036120	Mulch Placement 4"	SQ YD	50	50		
165	*	X0300015	Concrete Wingwall Removal	EACH	2	2		
166	*	X0322916	Proposed Storm Sewer Connection to Existing Storm Sewer	EACH	2	2		
167	*	X0322917	Proposed Storm Sewer Connection to Existing Manhole	EACH	3	3		
168	*	X0322936	Remove Existing Flared End Section	EACH	12	12		
169	*	X0327036	Bike Path Removal	SQ YD	1842	1842		
170	*	X1400012	Remove and Reinstall Fiber Optic Cable in Conduit	FOOT	994		994	
171	*	X4080052	Incidental Hot-Mix Asphalt Surfacing (Special)	TON	300	300		
172	*	X4400110	Temporary Pavement Removal	SQ YD	638	638		
173	*	X4400196	Hot-Mix Asphalt Surface Removal, Special	SQ YD	275	275		
174	*	X4402020	Concrete Median Surface Removal	SQ FT	2717	2717		
175	*	X6024210	Double Inlets, Special	EACH	2	2		
176	*	X6024240	Inlets, Special	EACH	1	1		
177	*	X6024242	Inlets, Special No. 1	EACH	1	1		
178	*	X6024244	Inlets, Special No. 2	EACH	1	1		
179	*	X6024246	Inlets, Special No. 3	EACH	5	5		
180	*	X6024250	Inlets, Special No. 5	EACH	11	11		

PAY ITEMS SHIFTED
DOWN FOR PAY ITEMS
ADDED TO ADDENDUM

*A specialty
Items*

LAYOUT	12/10/10
DRAWN	MWH
REVIEWED	DPA
DATE	02/12/13

FILE NAME =	USER NAME = #USER#	DESIGNED - DPA	REVISED -
#FILES#		DRAWN - MWH	REVISED -
		CHECKED - DPA	REVISED -
		DATE - #DATE#	REVISED -



SUMMARY OF QUANTITIES

F.A.U. RTE.	SECTION	COUNTY	TOTAL SHEETS	SHEET NO.
5149	04-00345-00-CH	WINNEBAGO	129	8
CONTRACT NO. 85616				
ILLINOIS FED. AID PROJECT				

SUMMARY OF QUANTITIES

Item Number	S.P.	Pay Item Number	Description	Unit	Total	Construction Type Code		
						0003	0021	0042
181	*	X6024252	Inlets, Special No. 6	EACH	2	2		
182	*	X6026050	Sanitary Manholes To Be Adjusted	EACH	2	2		
183	*	X6026051	Sanitary Manholes To Be Reconstructed	EACH	1	1		
184	*	X6061930	Concrete Median, Type SB-6.18 (Modified)	SQ FT	97	97		
185	*	X7010216	Traffic Control and Protection, Special	L SUM	1			
Δ 186	*	X8100105	Conduit Splice	EACH	2		2	
Δ 187	*	X8140115	Handhole To Be Adjusted	EACH	1	1		
Δ 188	*	X8211125	Luminaire, LED, Horizontal Mount, Special	EACH	66	66		
Δ 189	*	X8410102	Temporary Lighting System	L SUM	1	1		
Δ 190	*	X8410118	Maintenance of Temporary Lighting System	L SUM	1	1		
Δ 191	*	X8870300	Emergency Vehicle Priority System	EACH	3		3	
Δ 192	*	X8950105	Remove Existing Traffic Controller and Cabinet	EACH	1		1	
193	*	XX002182	Street Name Sign Mast Arm Mount	EACH	12	1	12	
Δ 194	*	XX002185	Relocate Existing Light Pole	EACH	2	2		
195	*	XX003653	Special Structure, SP-1	EACH	1	1		
196	*	XX006066	Sign To Be Relocated	EACH	1	1		
197	*	XX006821	Concrete Truck Washouts	L SUM	1			
Δ 198	*	XX007002	Lighting Unit, Aluminum, Complete, 40' and 16' M.H., Dual Luminaire Arms (Special)	EACH	10	1		
Δ 199	*	XX007003	Lighting Unit, Aluminum, Complete, 40' M.H., Single Luminaire Arm (Special)	EACH	39	39		
Δ 200	*	XX007797	Luminaire, Special	EACH	4	4		
201	*	XZ127900	Retaining Wall Removal	FOOT	31.1	31.1		
202	*	Z0013798	Construction Layout	L SUM	1			
Δ 203	*	Z0033072	Video Vehicle Detection System	EACH	3		3	
204	*	Z0043750	Precast Modular Block Wall	SQ FT	2555	2555		
Δ 205	*	Z0050600	Remove and Reset Ornamental Fence	FOOT	35.8	35.8		
206	*	Z0054400	Rock Fill	CU YD	2440	2440		
207	*	Z0062456	Temporary Pavement	SQ YD	638	638		
208	*	Z0076600	Trainees	HOUR				1000
209	*	Z0076604	Trainees Training Program Graduate	HOUR				1000

PAY ITEMS SHIFTED
DOWN FOR PAY ITEMS
ADDED TO ADDENDUM

Δ Specialty
Items

LAYOUT 12/10/10
DRAWN MWH 02/12/13
REVIEWED DPA 02/12/13

FILE NAME *	USER NAME * *USER*	DESIGNED - DPA	REVISED - -
FILES	DRAWN - MWH	CHECKED - DPA	REVISED - -
	PLOT SCALE * *SCALE*	DATE - *DATE1*	REVISED - -
	PLOT DATE * *DATE*		



SUMMARY OF QUANTITIES

F.A.U. RTE.	SECTION	COUNTY	TOTAL SHEETS	SHEET NO.
5149	04-00345-00-CH	WINNEBAGO	129	9
CONTRACT NO. 85616				
ILLINOIS FED. AID PROJECT				

SCHEDULE OF QUANTITIES

55100500 - Storm Sewer Removal, 12" (FOOT)	
Bell School Road (South)	277
Total	277
55100700 - Storm Sewer Removal, 15" (FOOT)	
Bell School Road (South)	86
Walton Street	82
Total	168
55100900 - Storm Sewer Removal, 18" (FOOT)	
Bell School Road (South)	404
Bell School Road (North)	34
Walton Street	25
US Bus. 20 (E. State St.)	25
Total	488
56400200 - Fire Hydrants to be Moved (Special) (EACH)	
Bell School Road (South)	1
Bell School Road (North)	1
US Bus. 20 (E. State St.)	3
Total	5
56400300 - Fire Hydrants to be Adjusted (EACH)	
US Bus. 20 (E. State St.)	1
Total	1
60107600 - Pipe Underdrains 4" (FOOT)	
Bell School Road (South)	139
US Bus. 20 (E. State St.)	12
Total	151
60221100 - Manholes, Type A, 5'-Diameter, Type 1 Frame, Closed Lid (EACH)	
Bell School Road (South)	1
Total	1
60252800 - Catch Basins to be Reconstructed (EACH)	
Bell School Road (South)	2
Total	2
60257900 - Manholes to be Reconstructed (EACH)	
Bell School Road (South)	1
Total	1
60260100 - Inlets to be Adjusted (EACH)	
Walton Street	1
Total	1
60263000 - Inlets to be Reconstructed with New Type 1 Frame, Closed Lid (EACH)	
Bell School Road (North)	2
Walton Street	1
US Bus. 20 (E. State St.)	2
Total	5
60265700 - Valve Vaults to be Adjusted (EACH)	
Bell School Road (South)	1
Bell School Road (North)	6
US Bus. 20 (E. State St.)	10
Total	17
60266600 - Valve Boxes to be Adjusted (EACH)	
Bell School Road (South)	2
US Bus. 20 (E. State St.)	1
Total	3
60500040 - Removing Manholes (EACH)	
Bell School Road (South)	2
Total	2
60500060 - Removing Inlets (EACH)	
Bell School Road (South)	3
Bell School Road (North)	1
Total	4
60603500 - Combination Concrete Curb and Gutter, Type B-6.06 (FOOT)	
Argus Drive	30
US Bus. 20 (E. State St.)	179
Total	209
60603800 - Combination Concrete Curb and Gutter, Type B-6.12 (FOOT)	
Argus Drive	47
Total	47

60604400 - Combination Concrete Curb and Gutter, Type B-6.18 (FOOT)	
Bell School Road (South)	2471
Bell School Road (North)	250
Burger King Drivethrough	268
Walton Street	167
Argus Drive	168
US Bus. 20 (E. State St.)	286
Total	3610
60605900 - Combination Concrete Curb and Gutter, Type B-6.24 (FOOT)	
Bell School Road (South)	821
Bell School Road (North)	617
Walton Street	460
Argus Drive	474
US Bus. 20 (E. State St.)	1209
Total	3581
60607400 - Combination Concrete Curb and Gutter, Type B-9.24 (FOOT)	
Bell School Road (South)	166
Total	166
60618300 - Concrete Median Surface, 4 Inch (SQ FT)	
Bell School Road (South)	1176
Potawotomi Trail	564
US Bus. 20 (E. State St.)	1303
Total	3043
60619600 - Concrete Median, Type SB-6.12 (SQ FT)	
Bell School Road (South)	1789
Bell School Road (North)	2604
Total	4393
60624600 - Corrugated Median (SQ FT)	
US Bus. 20 (E. State St.)	100
Total	100
66400105 - Chain Link Fence, 4' (FOOT)	
US Bus. 20 (E. State St.)	170
Total	170
70300100 - Short-Term Pavement Marking (FOOT)	
Bell School Road	3992
Walton Street and Argus Drive	1253
US Bus. 20 (E. State St.)	4154
Total	9399
70300210 - Temporary Pavement Marking - Letters and Symbols (FOOT)	
Bell School Road	872
Walton Street and Argus Drive	93
US Bus. 20 (E. State St.)	47
Total	1012
70300220 - Temporary Pavement Marking - Line 4" (FOOT)	
Bell School Road	38074
Walton Street and Argus Drive	7329
US Bus. 20 (E. State St.)	7462
Total	52865
70300280 - Temporary Pavement Marking - Line 24" (FOOT)	
Bell School Road	327
Walton Street and Argus Drive	127
US Bus. 20 (E. State St.)	81
Total	535
70301000 - Work Zone Pavement Marking Removal (SQ FT)	
Bell School Road	11490
Walton Street and Argus Drive	2279
US Bus. 20 (E. State St.)	2419
Total	16188
72400100 - Remove Sign Panel Assembly - Type A (EACH)	
Bell School Road (South)	6
Bell School Road (North)	1
Walton Street	3
Argus Drive	3
Total	13
72400500 - Relocate Sign Panel Assembly - Type A (EACH)	
Bell School Road (South)	5
Bell School Road (North)	1
Argus Drive	1
Potawotomi Trail	1
US Bus. 20 (E. State St.)	4
Total	12

78000100 - Thermoplastic Pavement Marking - Letters and Symbols (SQ FT)	
Bell School Road (South)	339
Walton Street	124
Argus Drive	93
Total	556
78000200 - Thermoplastic Pavement Marking - Line 4" (FOOT)	
Bell School Road (South)	3816
Walton Street	930
Argus Drive	773
Total	5519
78000400 - Thermoplastic Pavement Marking - Line 6" (FOOT)	
Bell School Road (South)	455
Walton Street	301
Argus Drive	110
US Bus. 20 (E. State St.)	94
Total	960
78000500 - Thermoplastic Pavement Marking - Line 8" (FOOT)	
Bell School Road (South)	2188
Walton Street	399
Argus Drive	136
US Bus. 20 (E. State St.)	110
Total	2833
78000600 - Thermoplastic Pavement Marking - Line 12" (FOOT)	
Bell School Road (South)	919
Walton Street	208
Argus Drive	155
US Bus. 20 (E. State St.)	205
Total	1487
78000650 - Thermoplastic Pavement Marking - Line 24" (FOOT)	
Bell School Road (South)	180
Walton Street	70
Argus Drive	56
US Bus. 20 (E. State St.)	36
Total	342
78005100 - Epoxy Pavement Marking - Letters and Symbols (SQ FT)	
Bell School Road (North)	201
US Bus. 20 (E. State St.)	247
Total	448
78005110 - Epoxy Pavement Marking - Line 4" (FOOT)	
Bell School Road (North)	280
US Bus. 20 (E. State St.)	6452
Total	6732
78005130 - Epoxy Pavement Marking - Line 6" (FOOT)	
Bell School Road (North)	396
US Bus. 20 (E. State St.)	549
Total	945
78005140 - Epoxy Pavement Marking - Line 8" (FOOT)	
Bell School Road (North)	1182
US Bus. 20 (E. State St.)	1835
Total	3017
78005150 - Epoxy Pavement Marking - Line 12" (FOOT)	
Bell School Road (North)	441
US Bus. 20 (E. State St.)	965
Total	1406
78005180 - Epoxy Pavement Marking - Line 24" (FOOT)	
Bell School Road (North)	122
US Bus. 20 (E. State St.)	137
Total	259
78100100 - Raised Reflective Pavement Marker (EACH)	
Bell School Road (North)	57
Bell School Road (South)	213
Walton Street	54
Argus Drive	6
Total	330
78300100 - Pavement Marking Removal (SQ FT)	
Bell School Road (North)	526
US Bus. 20 (E. State St.)	3290
Total	3816

80400100 - Electric Service Installation (EACH)	
Roadway Lighting	1
Total	1
80500100 - Service Installation, Type A (EACH)	
Walton Street	1
Argus Drive	1
US Bus. 20 (E. State St.)	1
Total	3
810288720 - Underground Conduit, Coillable Non-Metallic Conduit, 1" Dia. (FOOT)	
Roadway Lighting	6500
Total	6500
81028730 - Underground Conduit, Coillable Non-Metallic Conduit, 1 1/4" Dia. (FOOT)	
Walton Street	30
Argus Drive	5
US Bus. 20 (E. State St.)	43
Total	78
81028740 - Underground Conduit, Coillable Non-Metallic Conduit, 1 1/2" Dia. (FOOT)	
Walton Street	34
US Bus. 20 (E. State St.)	45
Total	79
81028750 - Underground Conduit, Coillable Non-Metallic Conduit, 2" Dia. (FOOT)	
Bell School Road Fiber	2630
Walton Street	289
Argus Drive	351
US Bus. 20 (E. State St.)	526
Total	3796
81028770 - Underground Conduit, Coillable Non-Metallic Conduit, 3" Dia. (FOOT)	
Bell School Road Fiber	207
Walton Street	62
Argus Drive	101
Total	370
81028780 - Underground Conduit, Coillable Non-Metallic Conduit, 3 1/2" Dia. (FOOT)	
Walton Street	188
US Bus. 20 (E. State St.)	62
Total	250
81028790 - Underground Conduit, Coillable Non-Metallic Conduit, 4" Dia. (FOOT)	
Argus Drive	75
US Bus. 20 (E. State St.)	321
Total	396
81028800 - Underground Conduit, Coillable Non-Metallic Conduit, 5" Dia. (FOOT)	
Walton Street	144
Argus Drive	122
US Bus. 20 (E. State St.)	241
Total	507
81400100 - Handhole (EACH)	
Walton Street	4
Argus Drive	3
US Bus. 20 (E. State St.)	7
Total	14
81400300 - Double Handhole (EACH)	
Walton Street	1
Argus Drive	1
US Bus. 20 (E. State St.)	1
Total	3
81400730 - Handhole, Composite Concrete (EACH)	
Bell School Road Fiber Ducts	8
Roadway Lighting	8
Total	16
81702110 - Electric Cable in Conduit, 600V (XLP-Type Use) 1/C No. 10 (FOOT)	
Roadway Lighting	29500
Total	29500

LAYOUT	12/10/10
DRAWN	MWH 02/12/13
REVIEWED	DPA 02/12/13

FILE NAME =	USER NAME = *USER*	DESIGNED - DPA	REVISED -
#FILES#		DRAWN - MWH	REVISED -
		CHECKED - DPA	REVISED -
		DATE - *DATE1*	REVISED -



SCHEDULE OF QUANTITIES

F.A.U. RTE.	SECTION	COUNTY	TOTAL SHEETS	SHEET NO.
5149	04-00345-00-CH	WINNEBAGO	129	11
CONTRACT NO. 85616			ILLINOIS FED. AID PROJECT	

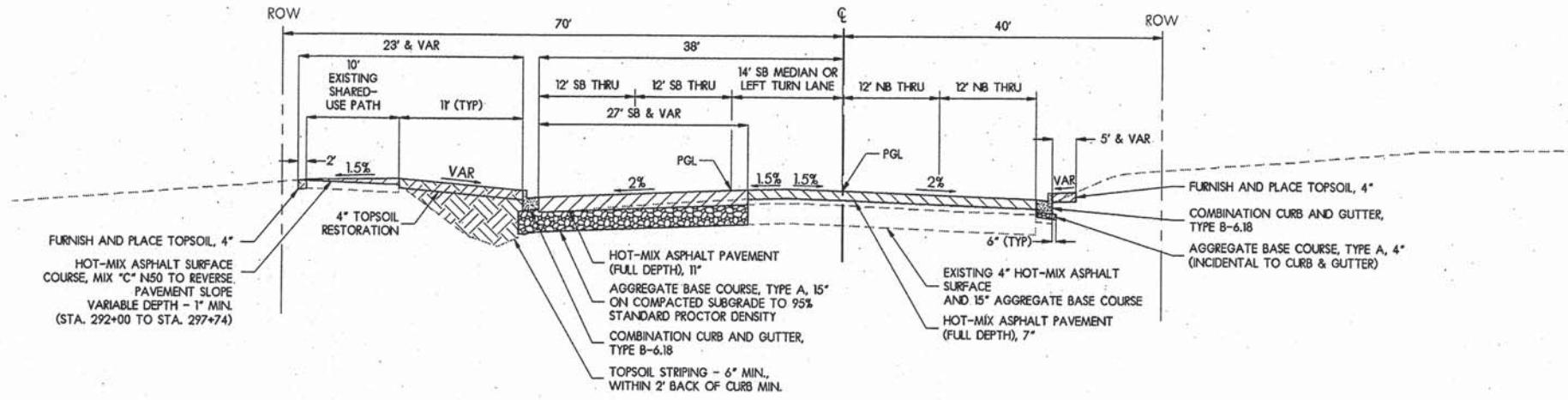

TYPICAL PAVEMENT SECTION - BELL SCHOOL ROAD
STA. 290+05.75 - STA. 298+45.09

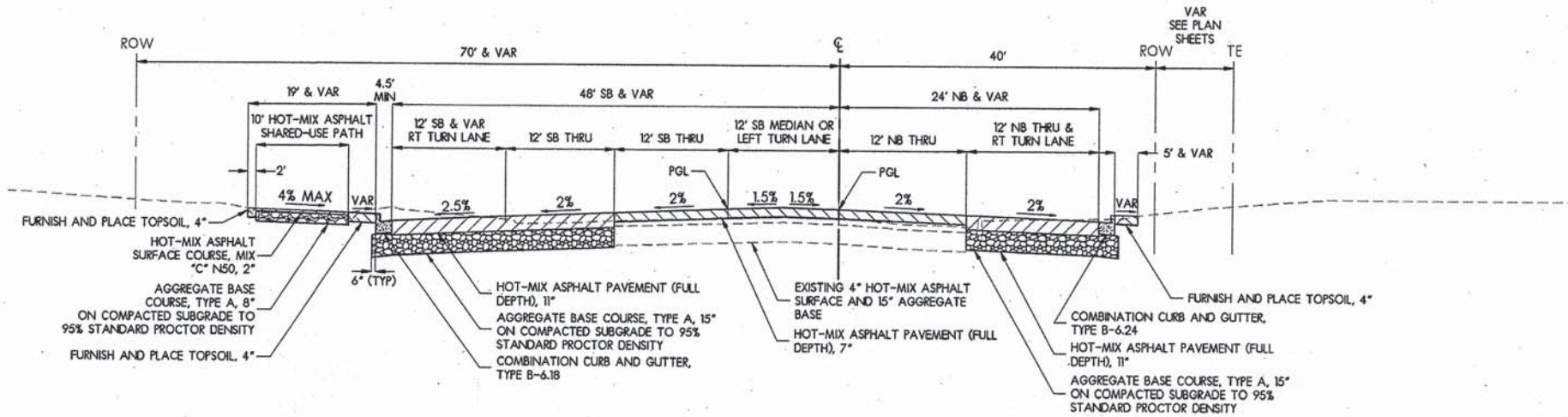

TYPICAL PAVEMENT SECTION - BELL SCHOOL ROAD
STA. 298+45.09 - STA. 301+01.99

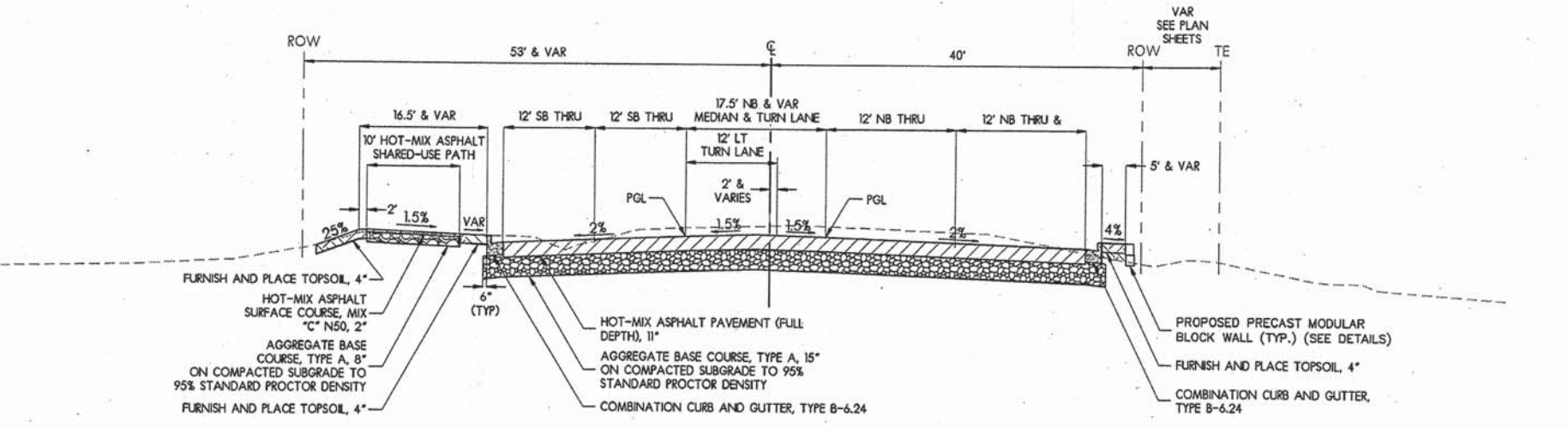

TYPICAL PAVEMENT SECTION - BELL SCHOOL ROAD
STA. 301+45.00 - STA. 303+71.83

HOT-MIX ASPHALT SHARED USE PATH

USAGE	SURFACE
AC	PG 64-22
Voids	4.0 @ N50
20 Yr ESAL	
Mix	9.5 FG
Friction Agg	
Mix Unit Weight	

HOT-MIX ASPHALT FULL DEPTH PAVEMENT

USAGE	SURFACE	TOP LIFT BINDER	ALL OTHER LIFTS
AC	SBS PG 64-28	SBS PG 64-28	PG 64-22
Voids	4.0 @ N70	4.0 @ N70	4.0 @ N70
20 Yr ESAL			
Mix	IL 9.5	IL 19.0	IL 19.0
Friction Agg	D	N/A	N/A
Mix Unit Weight	112 lbs/cy/in	112 lbs/cy/in	112 lbs/cy/in

LEGEND

- PGL = PROFILE GRADE LINE
- VAR = VARES
- SB = SOUTHBOUND
- NB = NORTHBOUND
- ROW = RIGHT OF WAY
- TE = TEMPORARY EASEMENT

PAVEMENT DESIGN

SOUTH LEG OF BELL SCHOOL ROAD
 DESIGN SPEED = 45 MPH
 DESIGN PERIOD = 10 YEARS
 STRUCTURAL DESIGN TRAFFIC = 18,500 ADT
 ROADS/STREET CLASSIFICATION: CLASS I
 PERCENT OF STRUCTURAL DESIGN TRAFFIC IN DESIGN LANE:
 PV = 16,280 (88%) SJ = 1295 (7%) MU = 925 (5%)
 FLEXIBLE TRAFFIC FACTOR = 5.58
 SUBGRADE RATING = POOR
 AC TYPE = AC 20
 DESIGN TEMP = 76.8
 EAC = 630 ksf
 AC MICROSTRAIN = 61
 PROPOSED PAVEMENT:
 HOT-MIX ASPHALT THICKNESS = 11"
 AGGREGATE SUBGRADE = 15"

NOTE:
HOT-MIX ASPHALT LIFTS SHALL NOT EXCEED 2.5"

LAYOUT: MWH 12/10/10
 DRAWN: MWH 02/12/13
 REVIEWED: DPA 02/12/13

FILE NAME =	USER NAME = #USER#	DESIGNED - DPA	REVISED -
#FILES#		DRAWN - MWH	REVISED -
	PLOT SCALE = #SCALE#	CHECKED - DPA	REVISED -
	PLOT DATE = #DATE#	DATE - #DATE1#	REVISED -



TYPICAL SECTIONS

F.A.U. RTE.	SECTION	COUNTY	TOTAL SHEETS	SHEET NO.
5149	04-00345-00-CH	WINNEBAGO	129	17
CONTRACT NO. 85616				
ILLINOIS FED. AID PROJECT				

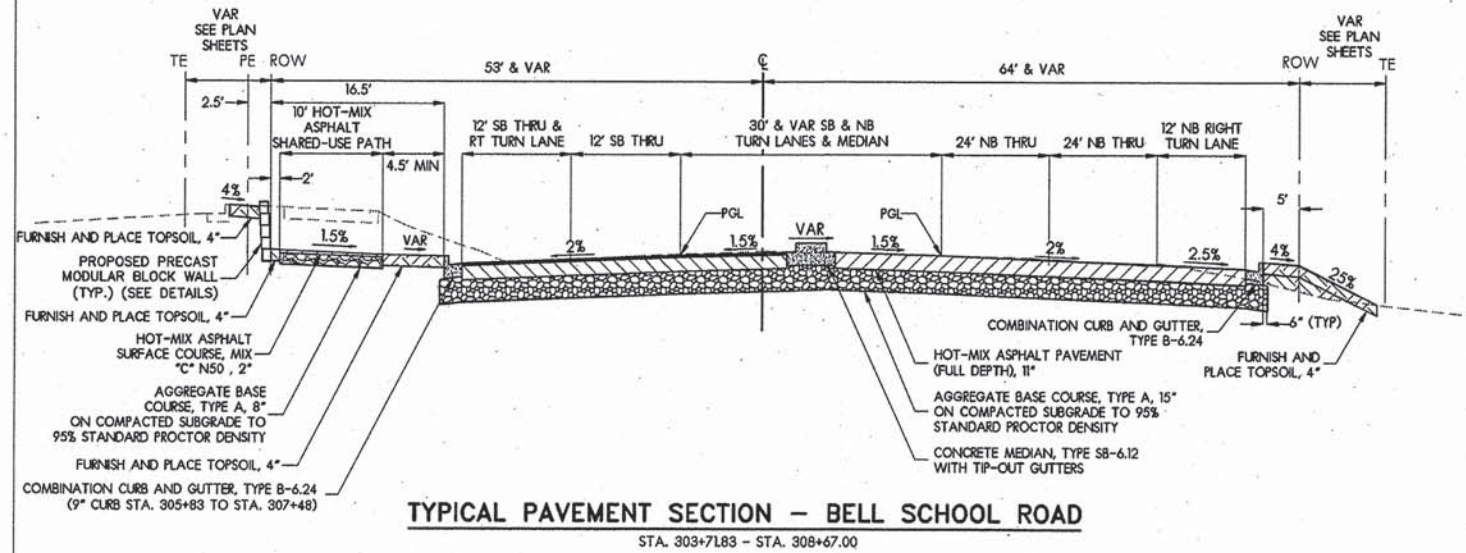

TYPICAL PAVEMENT SECTION - BELL SCHOOL ROAD

STA. 303+71.83 - STA. 308+67.00

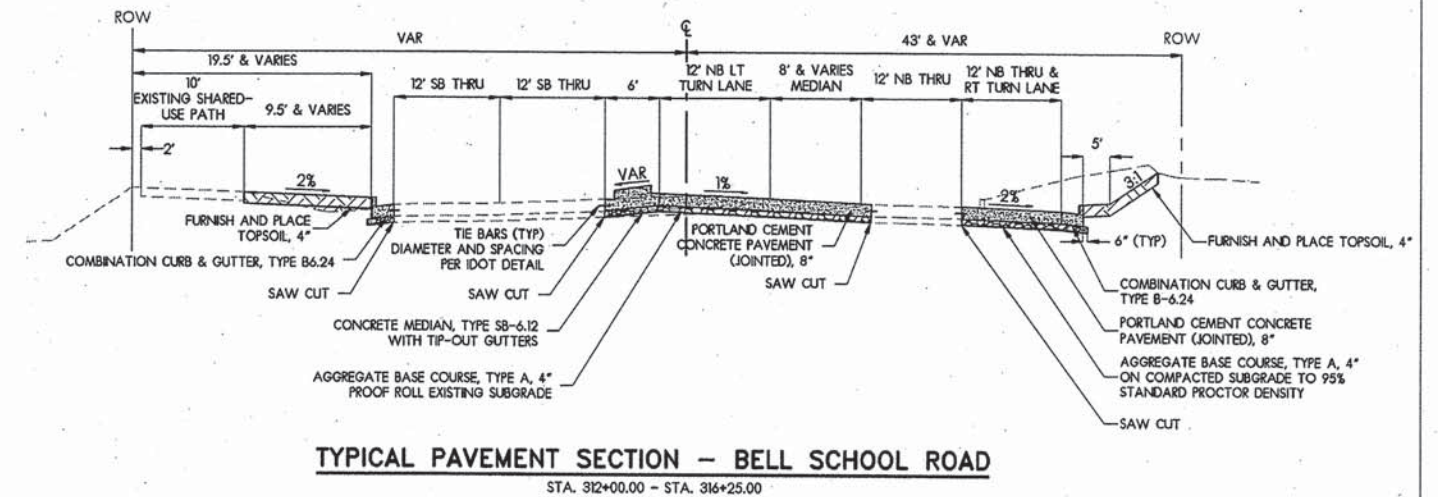

TYPICAL PAVEMENT SECTION - BELL SCHOOL ROAD

STA. 312+00.00 - STA. 316+25.00

LEGEND
 PGL = PROFILE GRADE LINE
 VAR = VARIES
 SB = SOUTHBOUND
 NB = NORTHBOUND
 ROW = RIGHT OF WAY
 TE = TEMPORARY EASEMENT

HOT-MIX ASPHALT SHARED USE PATH

USAGE	SURFACE
AC	PG 64-22
Voids	4.0 @ N50
20 Yr ESAL	
Mix	9.5 FG
Friction Agg	
Mix Unit Weight	

HOT-MIX ASPHALT FULL DEPTH PAVEMENT

USAGE	SURFACE	TOP LFT BINDER	ALL OTHER LFTS
AC	SBS PG 64-28	SBS PG 64-28	PG 64-22
Voids	4.0 @ N70	4.0 @ N70	4.0 @ N70
20 Yr ESAL			
Mix	IL 9.5	IL 19.0	IL 19.0
Friction Agg	D	N/A	N/A
Mix Unit Weight	112 lbs/sy/in	112 lbs/sy/in	112 lbs/sy/in

PAVEMENT DESIGN

SOUTH LEG OF BELL SCHOOL ROAD
 DESIGN SPEED = 45 MPH
 DESIGN PERIOD = 10 YEARS
 STRUCTURAL DESIGN TRAFFIC = 18,500 ADT
 ROAD/STREET CLASSIFICATION: CLASS I
 PERCENT OF STRUCTURAL DESIGN TRAFFIC IN DESIGN LANE:
 PV = 16,280 (88%) SU = 1295 (7%) MU = 925 (5%)
 FLEXIBLE TRAFFIC FACTOR = 5.58
 SUBGRADE RATING = POOR
 AC TYPE = AC 20
 DESIGN TEMP = 76.8
 EAC = 630 ksi
 AC MICROSTRAIN = 61

PROPOSED PAVEMENT:
 HOT-MIX ASPHALT THICKNESS = 11"
 AGGREGATE SUBGRADE = 15"

WALTON STREET
 DESIGN SPEED = 30 MPH
 DESIGN PERIOD = 20 YEARS
 STRUCTURAL DESIGN TRAFFIC = 5,150 ADT
 ROAD/STREET CLASSIFICATION: CLASS II
 PERCENT OF STRUCTURAL DESIGN TRAFFIC IN DESIGN LANE:
 PV = 4,532 (88%) SU = 361 (7%) MU = 257 (5%)
 FLEXIBLE TRAFFIC FACTOR = 1.13
 SUBGRADE RATING = POOR
 AC TYPE = AC 20
 DESIGN TEMP = 76.8
 EAC = 625 ksi
 AC MICROSTRAIN = 102

PROPOSED PAVEMENT:
 HOT-MIX ASPHALT THICKNESS = 9 1/2"
 AGGREGATE SUBGRADE = 12"

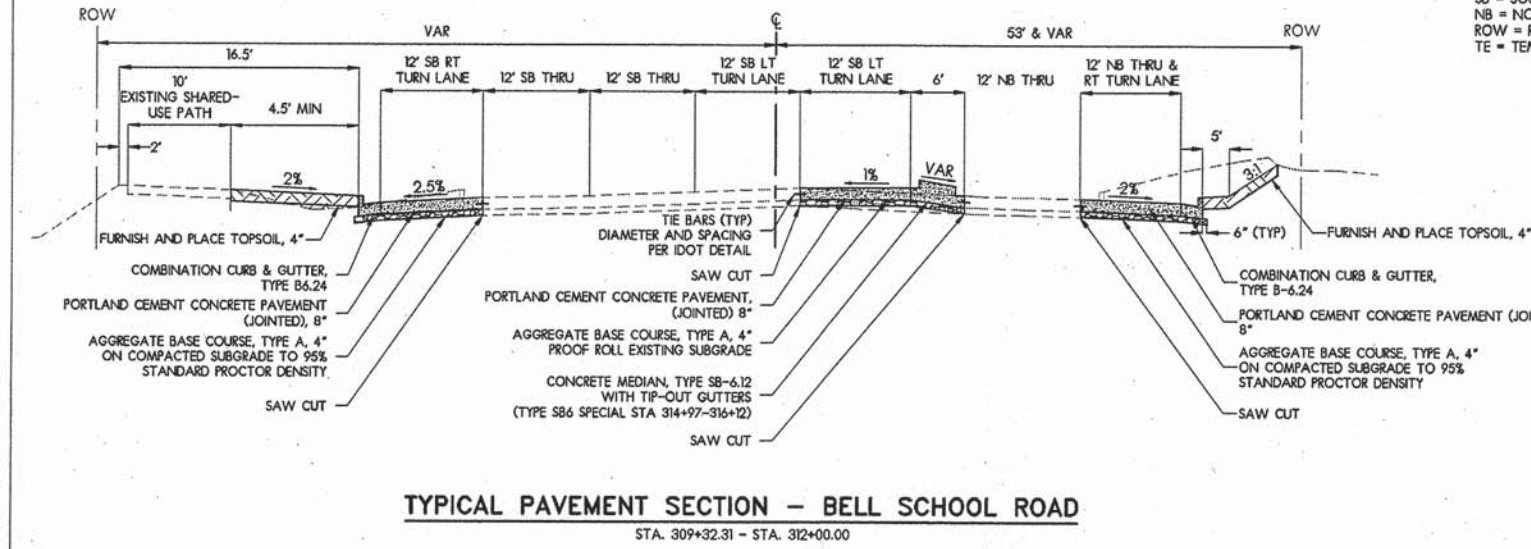

TYPICAL PAVEMENT SECTION - BELL SCHOOL ROAD

STA. 309+32.31 - STA. 312+00.00

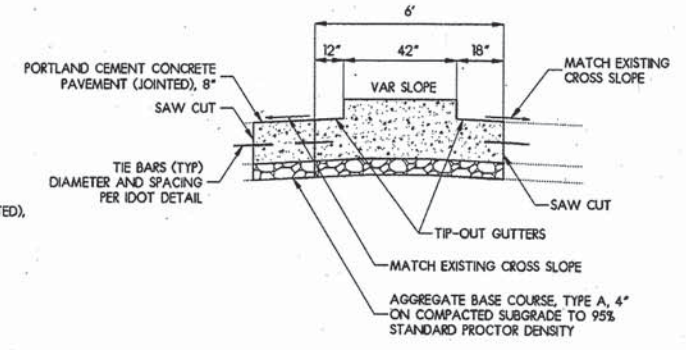

CONCRETE MEDIAN, TYPE SB-6.18 (MODIFIED)

STA. 314+81.00 - STA. 314+97.00

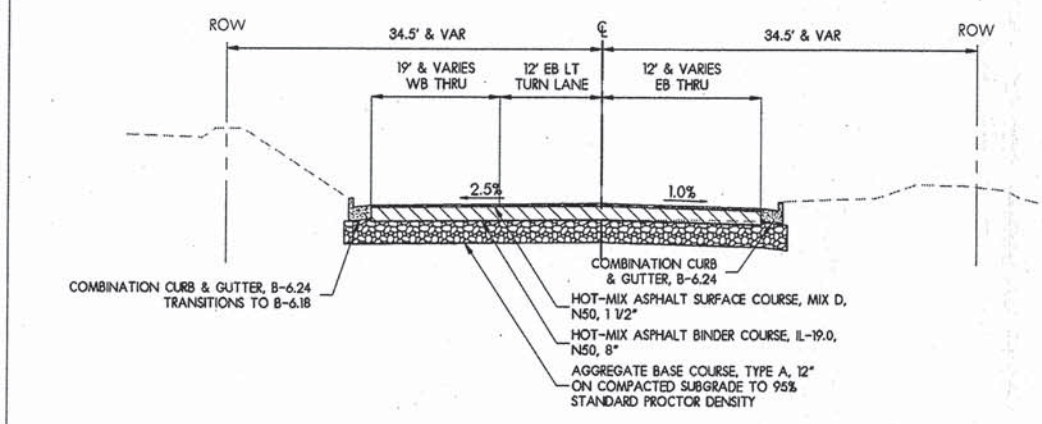

TYPICAL PAVEMENT SECTION - WALTON STREET WEST

STA. 9+00.00 - STA. 10+00.00

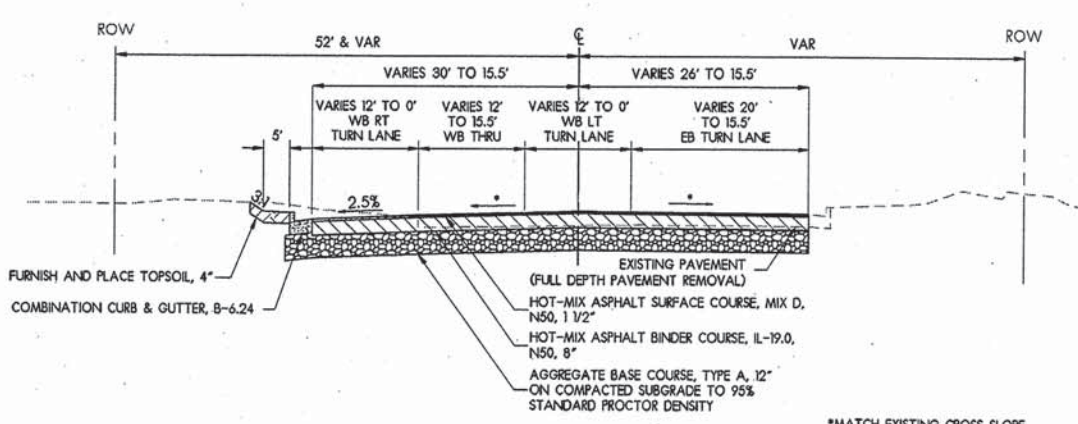

TYPICAL PAVEMENT SECTION - WALTON STREET EAST

STA. 10+00.00 - STA. 14+11.38

NOTE:
 HOT-MIX ASPHALT LIFTS SHALL NOT EXCEED 2.5"

12/10/10	MWH	02/12/13
02/12/13	MWH	02/12/13
02/12/13	DPA	02/12/13

FILE NAME =	USER NAME = #USER#	DESIGNED - DPA	REVISED -
#FILES#		DRAWN - MWH	REVISED -
		CHECKED - DPA	REVISED -
		DATE - #DATE#	REVISED -



TYPICAL SECTIONS

F.A.U. RTE.	SECTION	COUNTY	TOTAL SHEETS	SHEET NO.
5149	04-00345-00-CH	WINNEBAGO	129	18
CONTRACT NO. 85616				
ILLINOIS FED. AID PROJECT				

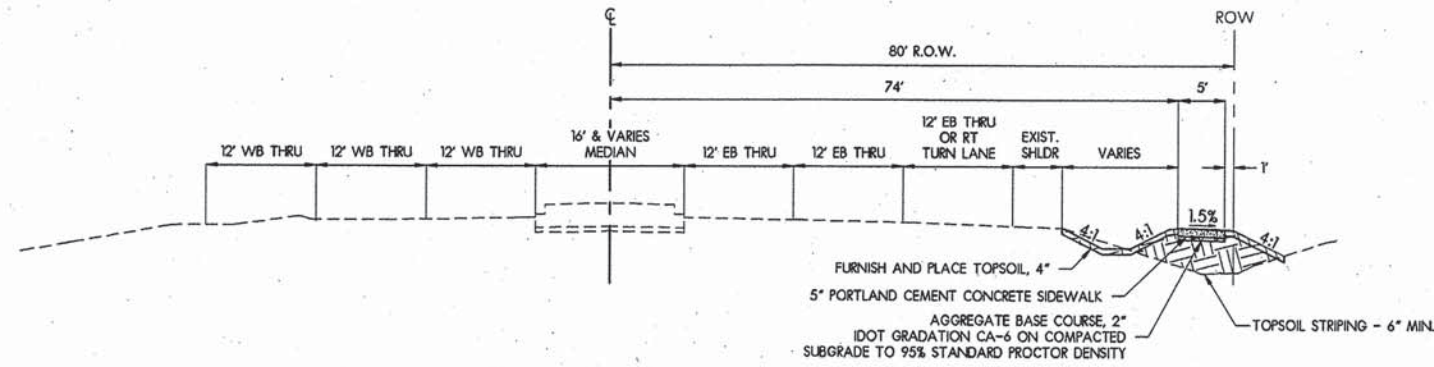

TYPICAL PAVEMENT SECTION - EAST STATE STREET - US BR 20

STA. 658+55.88 - STA. 661+51.77

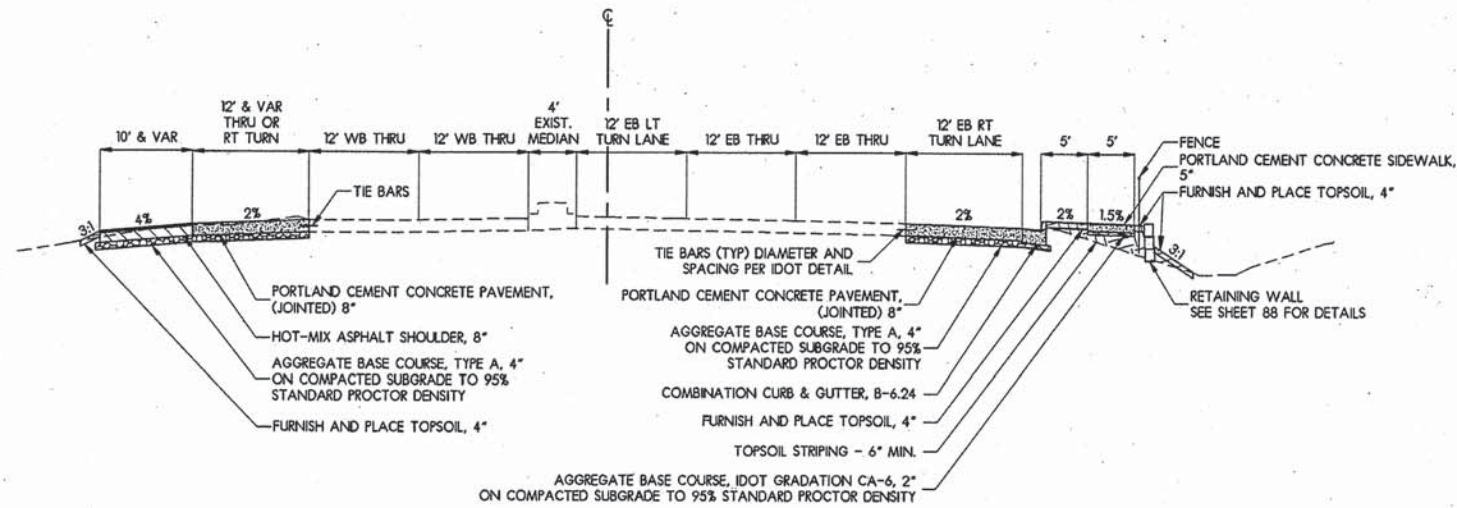

TYPICAL PAVEMENT SECTION - EAST STATE STREET - US BR 20

STA. 661+51.77 - STA. 669+33.86

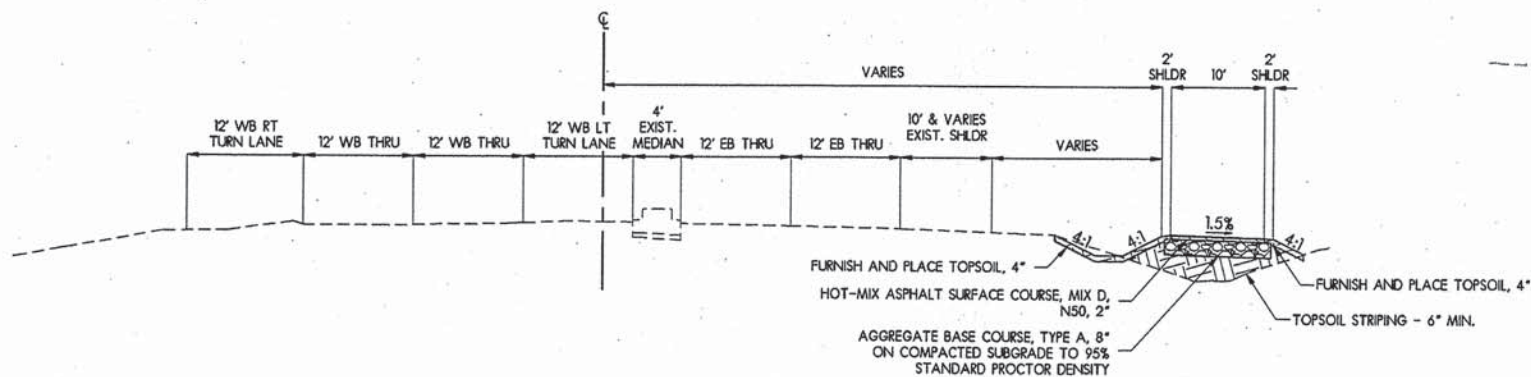

TYPICAL PAVEMENT SECTION - EAST STATE STREET - US BR 20

STA. 669+33.86 - STA. 680+51.84

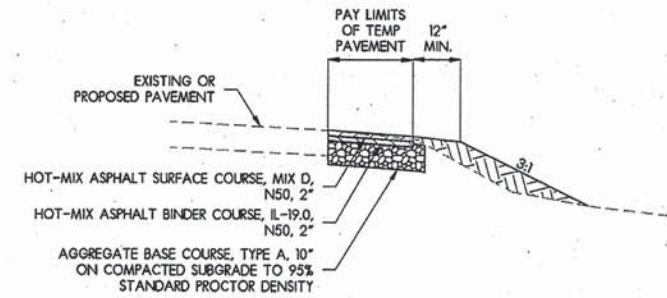

TYPICAL TEMPORARY PAVEMENT SECTION

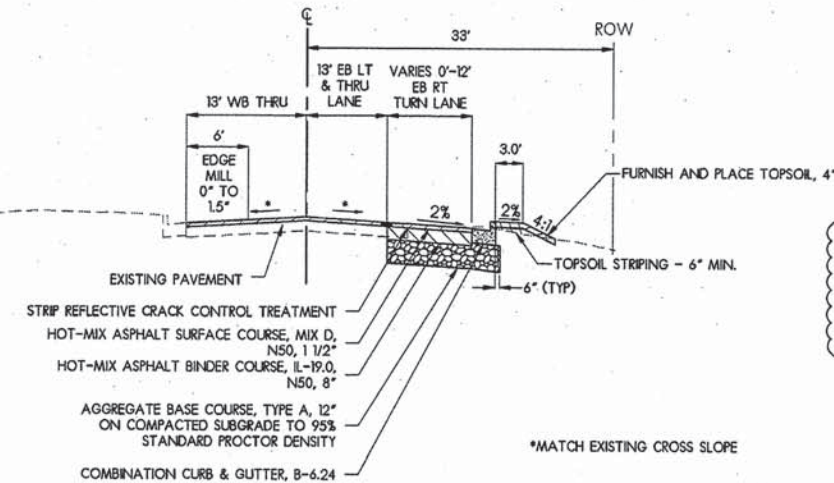

TYPICAL PAVEMENT SECTION - ARGUS DRIVE

STA. 66+92.04 - STA. 69+66.34

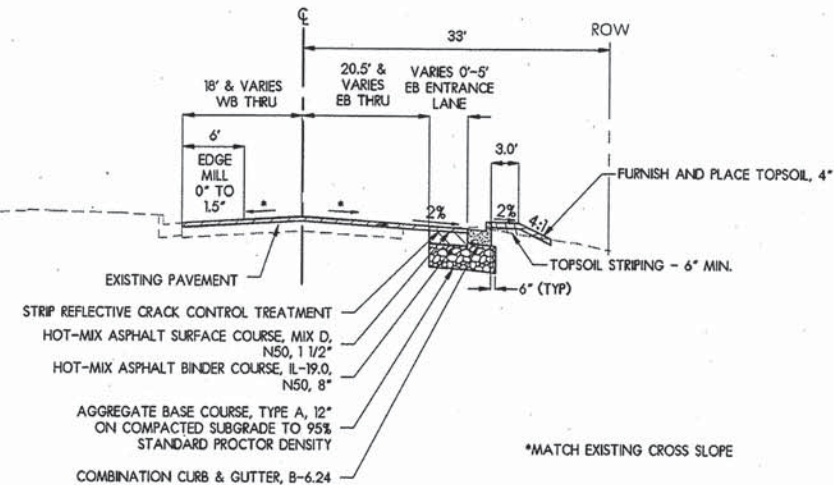

TYPICAL PAVEMENT SECTION - POTAWATOMI TRAIL

STA. 170+42.87 - STA. 171+97.40

NOTE:
HOT-MIX ASPHALT LIFTS SHALL NOT EXCEED 2.5"

- LEGEND**
- PGL = PROFILE GRADE LINE
 - HOT-MIX ASPHALT = HOT MIX ASPHALT
 - VAR = VARIES
 - SB = SOUTHBOUND
 - NB = NORTHBOUND
 - ROW = RIGHT OF WAY
 - TE = TEMPORARY EASEMENT

PAVEMENT DESIGN

ARGUS DRIVE
 DESIGN SPEED = 30 MPH
 DESIGN PERIOD = 20 YEARS
 STRUCTURAL DESIGN TRAFFIC = 3750 ADT
 ROADS/STREET CLASSIFICATION: CLASS II
 PERCENT OF STRUCTURAL DESIGN TRAFFIC IN DESIGN LANE:
 PV = 3300 (88%) SU = 263 (7%) MU = 187 (5%)

FLEXIBLE TRAFFIC FACTOR = 0.82
 SUBGRADE RATING = POOR
 AC TYPE = AC 20
 DESIGN TEMP = 76.8
 EAC = 625 ksi
 AC MICROSTRAIN = 112

PROPOSED PAVEMENT:
 HOT-MIX ASPHALT THICKNESS = 9 1/2"
 AGGREGATE SUBGRADE = 12"

MIX DESIGN TABLE

SHOULDER

USAGE	BOTTOM	TOP
AC	PG 64-22	PG 64-22
Voids	2% @ N50	3% @ N50
20 Yr ESAL	N/A	N/A
Mix	IL 19.0	IL 9.5
Friction Agg	N/A	C
Mix Unit Weight	112lb/cy/in	112lb/cy/in

LAYOUT	12/10/10
DRAWN	02/12/13
REVIEWED	02/12/13

FILE NAME =	USER NAME = #USER#	DESIGNED - DPA	REVISED -
#FILES#		DRAWN - MWH	REVISED -
		CHECKED - DPA	REVISED -
		DATE - #DATE1#	REVISED -



TYPICAL SECTIONS

F.A.I. RTE.	SECTION	COUNTY	TOTAL SHEETS	SHEET NO.
5149	04-00345-00-CH	WINNEBAGO	129	19
CONTRACT NO. 85616				
ILLINOIS FED. AID PROJECT				

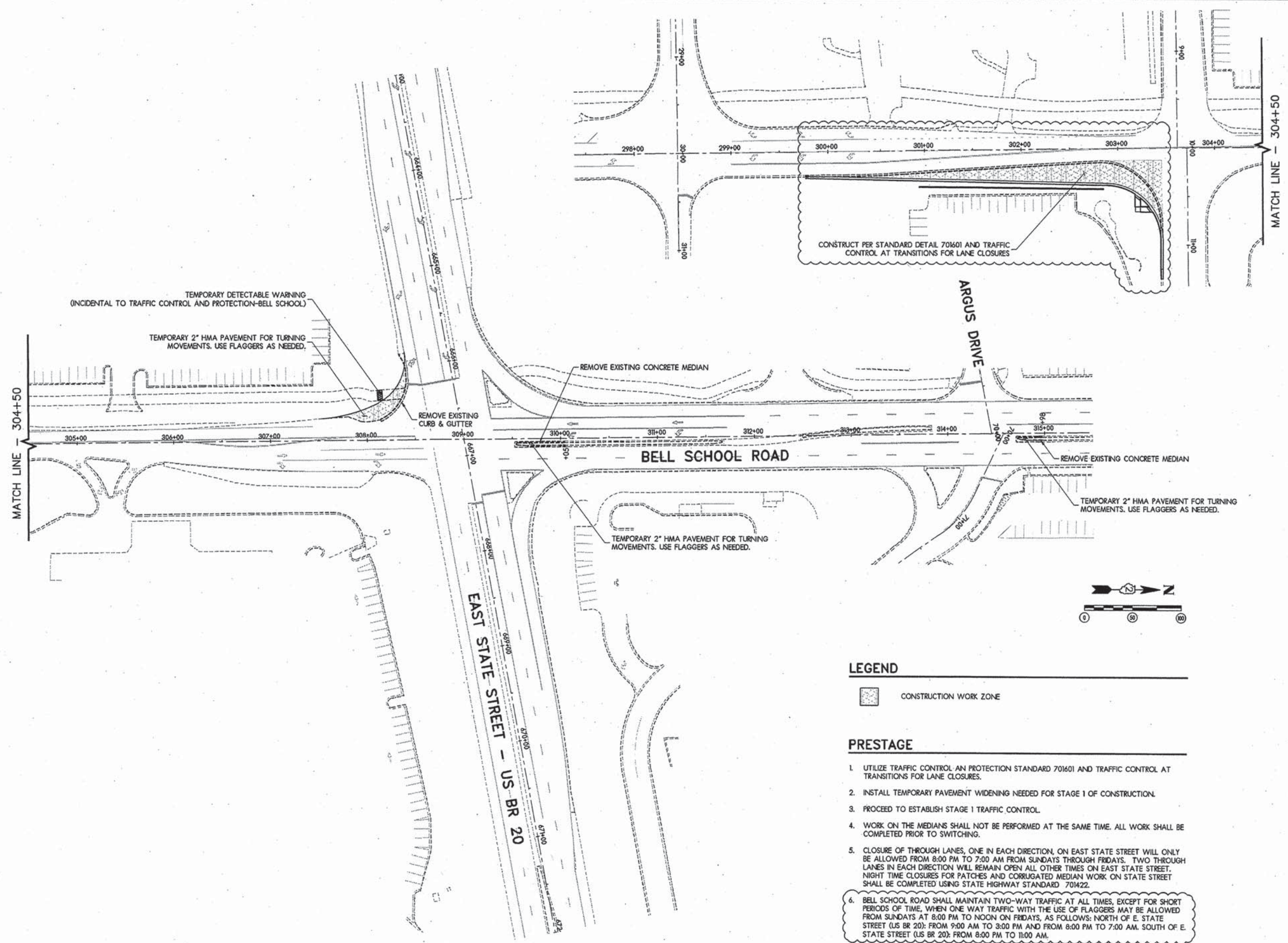

LAYOUT	12/10/10
DRAWN	MWH
REVIEWED	DPA
DATE	02/17/13

FILE NAME =	USER NAME = #USER#	DESIGNED - DPA	REVISED -
#FILES#		DRAWN - MWH	REVISED -
	PLOT SCALE = #SCALE#	CHECKED - DPA	REVISED -
	PLOT DATE = #DATE#	DATE - #DATE1#	REVISED -

ARC DESIGN
RESOURCES INC.

TRAFFIC CONTROL AND STAGING PLAN - PRESTAGE

F.A.I. RTE.	SECTION	COUNTY	TOTAL SHEETS	SHEET NO.
5149	04-00345-00-CH	WINNEBAGO	129	22
CONTRACT NO. 85616				
ILLINOIS FED. AID PROJECT				

STAGE I

1. INSTALL TRAFFIC CONTROL FOR STAGE I.
2. PAVEMENT PATCHING FOR STORM SEWER REMOVAL AND INSTALLATION SHALL BE COMPLETED UNDER TRAFFIC USING STATE HIGHWAY STANDARD 701501, RE: REMOVAL PLANS.
3. REMOVE THE EXISTING PAVEMENT MARKING WITHIN THE STAGE I CONSTRUCTION LIMITS AND INSTALL TEMPORARY PAINT PAVEMENT MARKINGS.
4. INSTALL DRUMS OR BARRICADES ALONG OUTSIDE OF TEMPORARY EDGE LINE PAVEMENT MARKINGS. A MINIMUM OF 2 FEET SHALL BE MAINTAINED FOR A BUFFER AREA BETWEEN THE TRAFFIC LANES AND CONSTRUCTION AREA.
5. BEGIN REMOVAL AND CONSTRUCTION OF THE STAGE I AREA. THE PROPOSED CONSTRUCTION SHALL CONSIST OF THE INSTALLATION OF INLETS, STORM SEWERS, CURB & GUTTER, GRADING, PAVEMENT, AND EROSION CONTROL. THE 15" AGGREGATE BASE COURSE SHALL BE INSTALLED ALONG WITH THE 4" HMA BINDER COURSE TO MATCH THE EXISTING PAVEMENT.
6. STAGE I WORK SHALL INCLUDE MULTI-USE PATH ALONG EAST STATE STREET EAST OF BELL SCHOOL ROAD.
7. TEMPORARY DRAINAGE SHALL BE MAINTAINED UTILIZING 4" PVC PIPE AS SHOWN ON TEMPORARY DRAINAGE DETAIL. THIS WORK SHALL BE INCLUDED IN THE COST OF INLET SPECIAL OF THE TYPE SPECIFIED.
8. QUANTITIES FOR TEMPORARY 2" HMA PAVEMENT HAVE BEEN ADDED TO THE PLANS FOR USE AS TEMPORARY ACCESS FOR ENTRANCES AND TURNING MOVEMENTS FOR TRUCKS ON WALTON STREET.
9. EROSION CONTROL AND SEEDING WORK SHALL BE MAINTAINED THROUGHOUT THE DURATION OF THE PROJECT.
10. CLOSURE OF THROUGH LANES, ONE IN EACH DIRECTION, ON EAST STATE STREET WILL ONLY BE ALLOWED FROM 8:00 PM TO 7:00 AM FROM SUNDAYS THROUGH FRIDAYS. TWO THROUGH LANES IN EACH DIRECTION WILL REMAIN OPEN ALL OTHER TIMES ON EAST STATE STREET. NIGHT TIME CLOSURES FOR PATCHES AND CORRUGATED MEDIAN WORK ON STATE STREET SHALL BE COMPLETED USING STATE HIGHWAY STANDARD 701422.
11. BELL SCHOOL ROAD SHALL MAINTAIN TWO-WAY TRAFFIC AT ALL TIMES, EXCEPT FOR SHORT PERIODS OF TIME, WHEN ONE WAY TRAFFIC WITH THE USE OF FLAGGERS MAY BE ALLOWED FROM SUNDAYS AT 8:00 PM TO NOON ON FRIDAYS, AS FOLLOWS: NORTH OF E. STATE STREET (US BR 20): FROM 9:00 AM TO 3:00 PM AND FROM 8:00 PM TO 7:00 AM. SOUTH OF E. STATE STREET (US BR 20): FROM 8:00 PM TO 11:00 AM.

LEGEND

- ← DIRECTION OF TRAFFIC FLOW
- ⊙ DRUMS OR TYPE II BARRICADES WITH FLASHING BEACON 50' CENTERS ON TANGENT, 20' CENTERS THRU TAPERS & RETURNS
- ⊕ TYPE III BARRICADE
- ↔ DIRECTION INDICATOR BARRICADE WITH STEADY BURN MONODIRECTIONAL LIGHT
- ▨ CONSTRUCTION WORK ZONE
- ▨ TEMPORARY 2" HMA PAVEMENT FOR TURNING MOVEMENTS TO BE REMOVED AND REPLACED WITH THE PROPOSED PAVEMENT WITHIN THREE CALENDAR DAYS OF THE COMPLETION OF STAGE I. USE FLAGGERS AS NEEDED.

ALL ENTRANCES AND SIDE ROADS SHALL REMAIN OPEN DURING CONSTRUCTION OPERATIONS UNLESS OTHERWISE SPECIFIED.

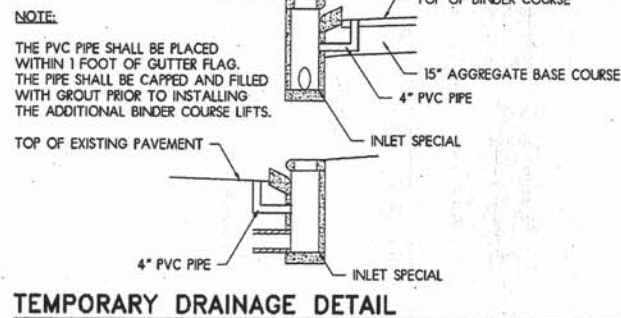
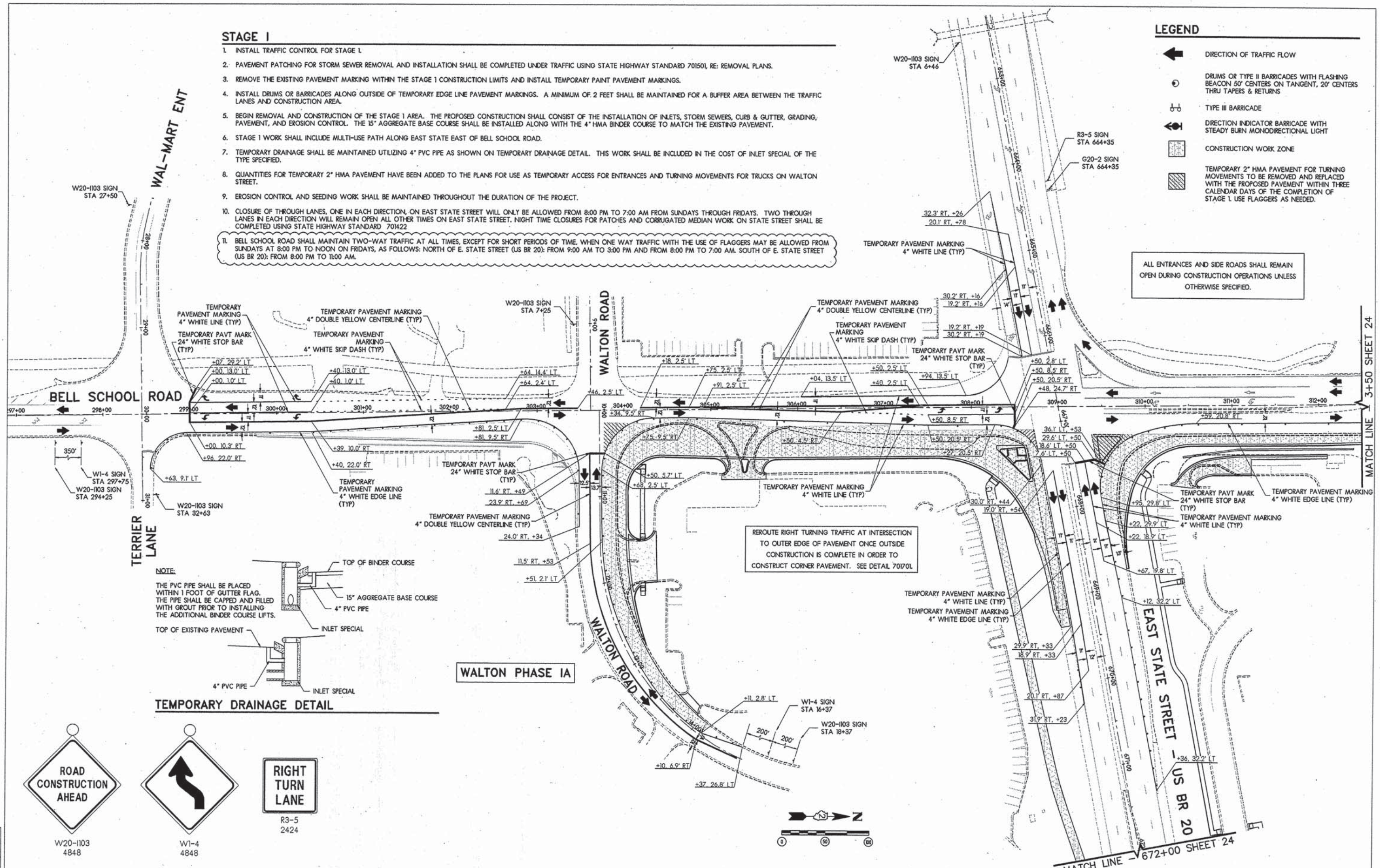

REROUTE RIGHT TURNING TRAFFIC AT INTERSECTION TO OUTER EDGE OF PAVEMENT ONCE OUTSIDE CONSTRUCTION IS COMPLETE IN ORDER TO CONSTRUCT CORNER PAVEMENT. SEE DETAIL 70170L

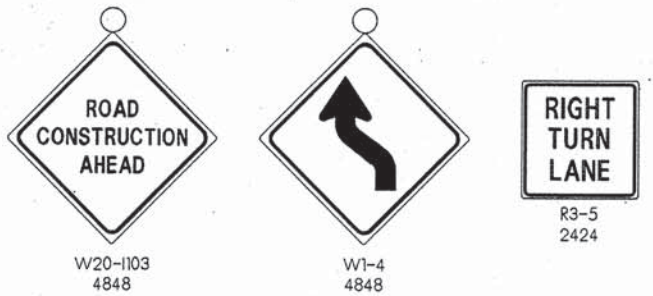

LAYOUT	MWH	12/10/10
DRAWN	MWH	02/12/13
REVIEWED	DPA	02/12/13

FILE NAME =	USER NAME = #USER#	DESIGNED - DPA	REVISED -
#FILES#		DRAWN - MWH	REVISED -
		CHECKED - DPA	REVISED -
		DATE - #DATE#	REVISED -

ARC DESIGN
RESOURCES INC.

TRAFFIC CONTROL AND STAGING PLAN - STAGE I

F.A.U. RTE.	SECTION	COUNTY	TOTAL SHEETS	SHEET NO.
5149	04-00345-00-CH	WINNEBAGO	129	23
CONTRACT NO. 85616				
ILLINOIS FED. AID PROJECT				

WINTER SHUTDOWN

1. WINTER SHUTDOWN SHALL OCCUR UPON COMPLETION OF STAGE I.
2. EROSION CONTROL AND SEEDING WORK SHALL BE MAINTAINED THROUGHOUT THE DURATION OF THE PROJECT.

LEGEND

- ← DIRECTION OF TRAFFIC FLOW
- ⊙ DRUMS OR TYPE II BARRICADES WITH FLASHING BEACON
50' CENTERS ON TANGENT, 20' CENTERS THRU TAPERS & RETURNS



W20-1103
4848



R3-5
2424

EAST STATE STREET - US BR 20

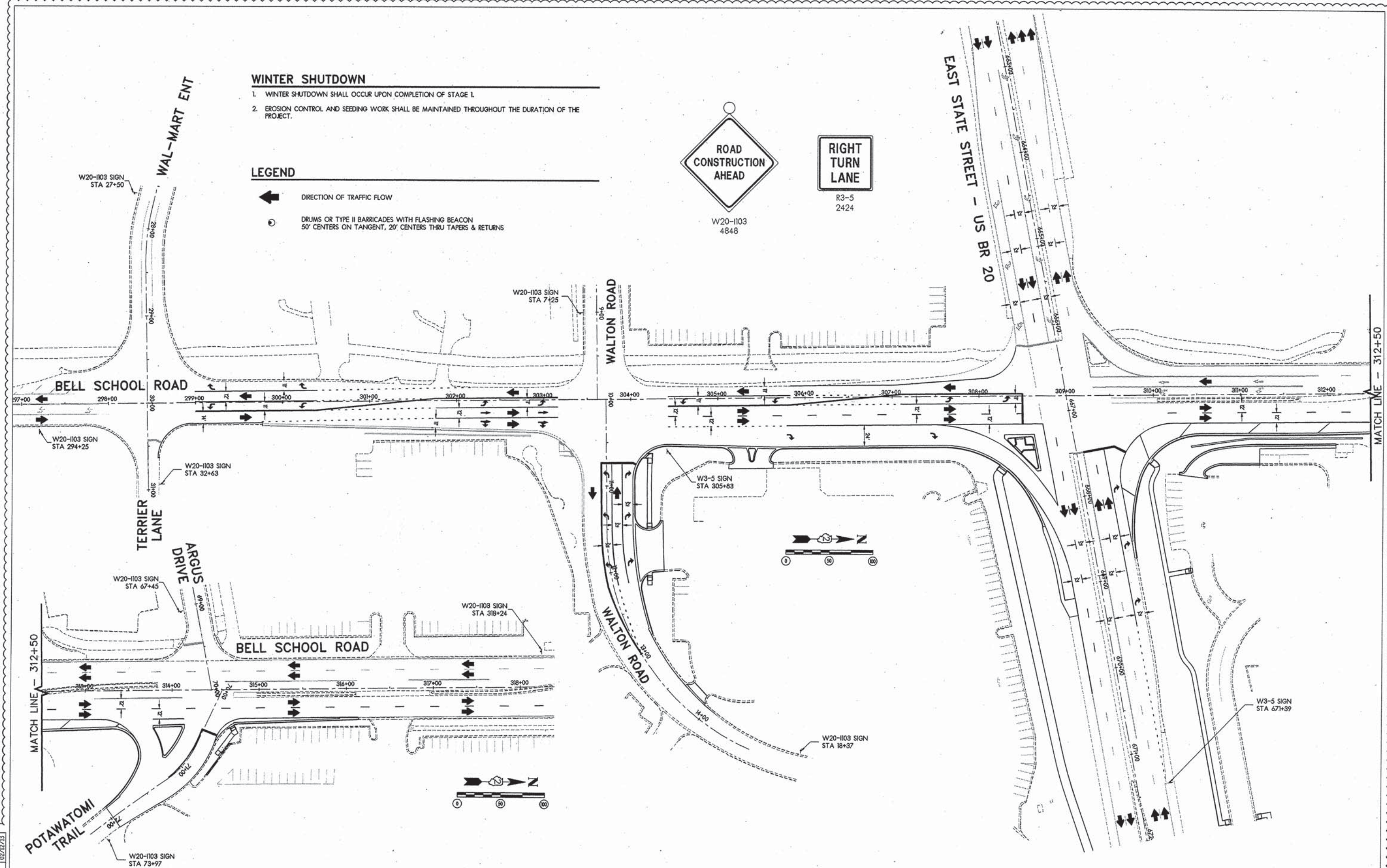

LAYOUT	MWH	12/10/10
DRAWN	MWH	02/12/13
REVIEWED	DPA	02/12/13

FILE NAME =	USER NAME = #USER#	DESIGNED - DPA	REVISED -
#FILES#		DRAWN - MWH	REVISED -
	PLOT SCALE = #SCALE#	CHECKED - DPA	REVISED -
	PLOT DATE = #DATE#	DATE - #DATE1#	REVISED -



TRAFFIC CONTROL AND STAGING PLAN - WINTER SHUTDOWN

F.A.U. RTE.	SECTION	COUNTY	TOTAL SHEETS	SHEET NO.
5149	04-00345-00-CH	WINNEBAGO	129	24A
CONTRACT NO. 85616				
ILLINOIS FED. AID PROJECT				

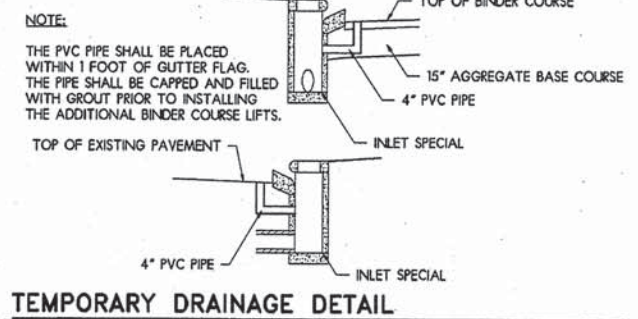
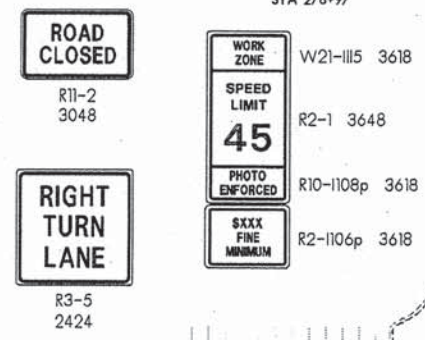
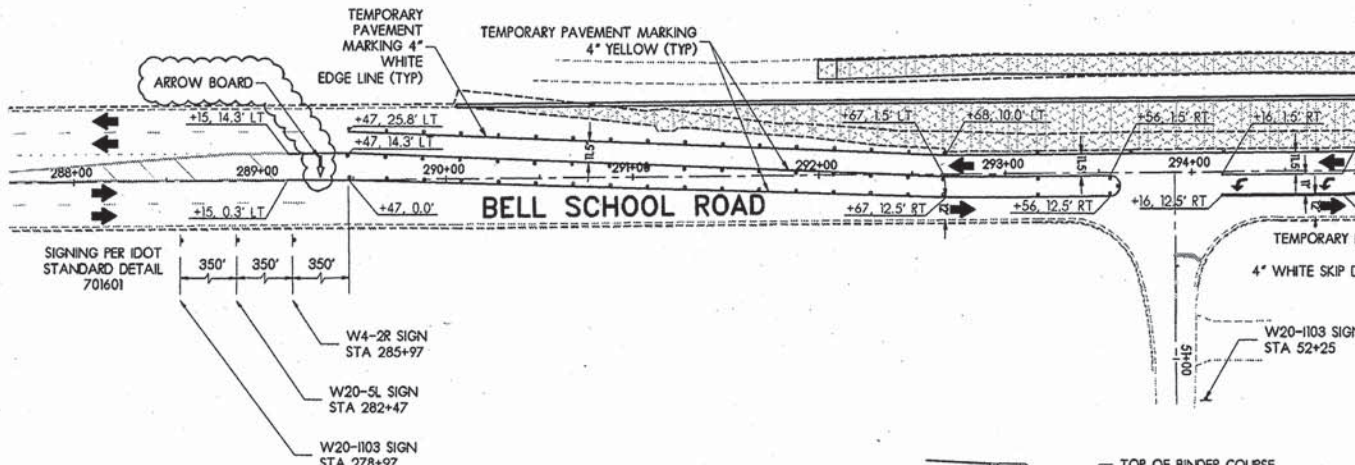
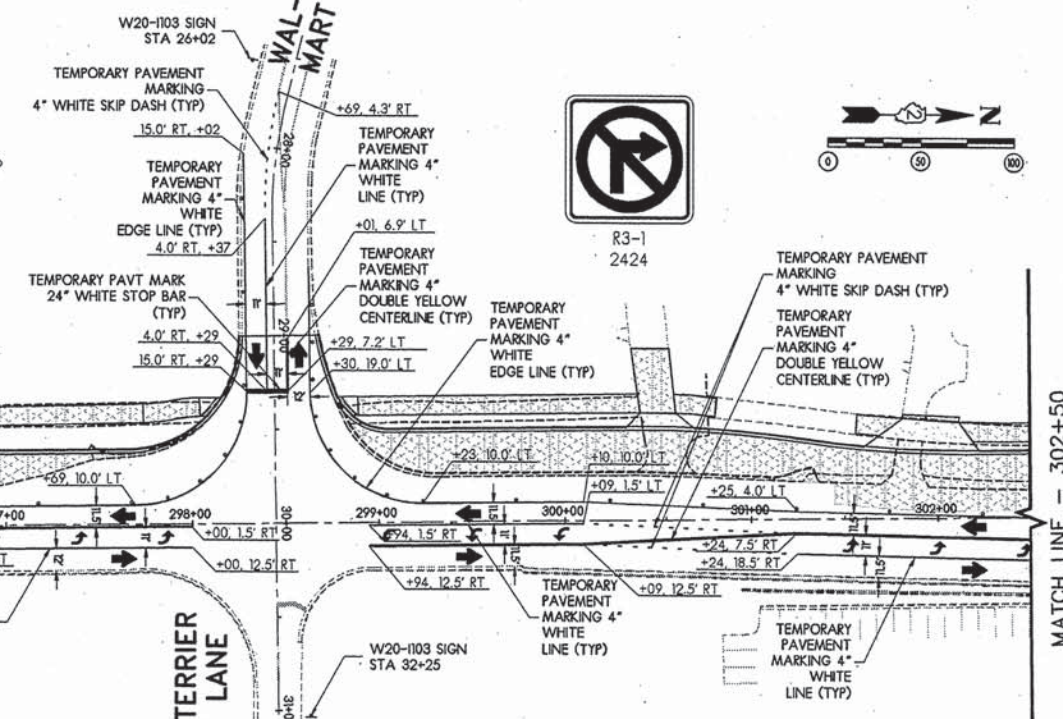
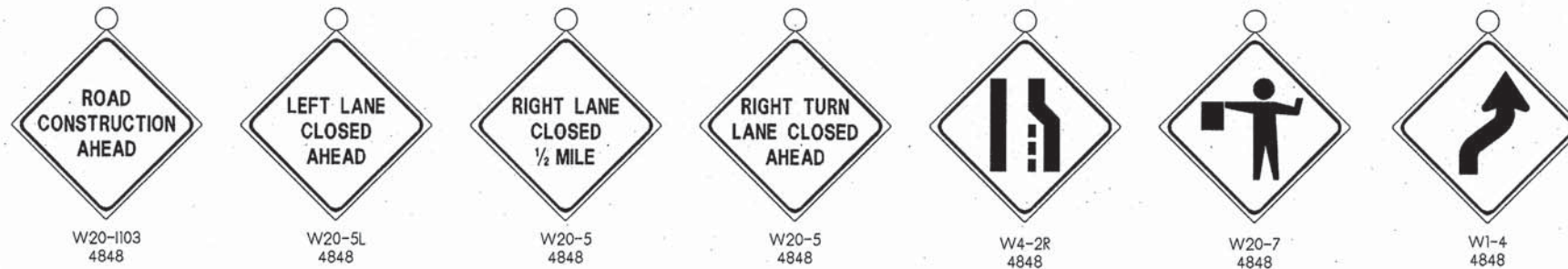

- STAGE II**
1. INSTALL TRAFFIC CONTROL FOR STAGE 2.
 2. PAVEMENT PATCHING FOR STORM SEWER REMOVAL AND INSTALLATION SHALL BE COMPLETED UNDER TRAFFIC USING STATE HIGHWAY STANDARD 701501, RE: REMOVAL PLANS.
 3. REMOVE THE EXISTING PAVEMENT MARKING WITHIN THE STAGE 2 CONSTRUCTION LIMITS AND INSTALL TEMPORARY PAINT PAVEMENT MARKINGS.
 4. INSTALL DRUMS OR BARRICADES ALONG OUTSIDE OF TEMPORARY EDGE LINE PAVEMENT MARKINGS. A MINIMUM OF 2 FEET SHALL BE MAINTAINED FOR A BUFFER AREA BETWEEN THE TRAFFIC LANES AND CONSTRUCTION AREA.
 5. BEGIN REMOVAL AND CONSTRUCTION OF THE STAGE 2 AREA. THE PROPOSED CONSTRUCTION SHALL CONSIST OF THE INSTALLATION OF INLETS, STORM SEWERS, CURB & GUTTER, GRADING, PAVEMENT, AND EROSION CONTROL. THE 15" AGGREGATE BASE COURSE SHALL BE INSTALLED ALONG WITH THE 4" HMA BINDER COURSE TO MATCH THE EXISTING PAVEMENT.
 6. STAGE 2 WORK SHALL INCLUDE SIDEWALK ALONG EAST STATE WEST OF BELL SCHOOL ROAD.
 7. TEMPORARY DRAINAGE SHALL BE MAINTAINED UTILIZING 4" PVC PIPE AS SHOWN ON TEMPORARY DRAINAGE DETAIL. THIS WORK SHALL BE INCLUDED IN THE COST OF INLET SPECIAL OF THE TYPE SPECIFIED.
 8. QUANTITIES FOR TEMPORARY 2" HMA PAVEMENT HAVE BEEN ADDED TO THE PLANS FOR USE AS TEMPORARY ACCESS FOR ENTRANCES AND TURNING MOVEMENTS FOR TRUCKS ON WALTON STREET.
 9. EROSION CONTROL AND SEEDING WORK SHALL BE MAINTAINED THROUGHOUT THE DURATION OF THE PROJECT.
 10. CLOSURE OF THROUGH LANES, ONE IN EACH DIRECTION, ON EAST STATE STREET WILL ONLY BE ALLOWED FROM 8:00 PM TO 7:00 AM FROM SUNDAYS THROUGH FRIDAYS. TWO THROUGH LANES IN EACH DIRECTION WILL REMAIN OPEN ALL OTHER TIMES ON EAST STATE STREET. NIGHT TIME CLOSURES FOR PATCHES AND CORRUGATED MEDIAN WORK ON STATE STREET SHALL BE COMPLETED USING STATE HIGHWAY STANDARD 701422.
 11. BELL SCHOOL ROAD SHALL MAINTAIN TWO-WAY TRAFFIC AT ALL TIMES, EXCEPT FOR SHORT PERIODS OF TIME, WHEN ONE WAY TRAFFIC WITH THE USE OF FLAGGERS MAY BE ALLOWED FROM SUNDAYS AT 8:00 PM TO NOON ON FRIDAYS, AS FOLLOWS: NORTH OF E. STATE STREET (US BR 20): FROM 9:00 AM TO 3:00 PM AND FROM 8:00 PM TO 7:00 AM. SOUTH OF E. STATE STREET (US BR 20): FROM 8:00 PM TO 11:00 AM.

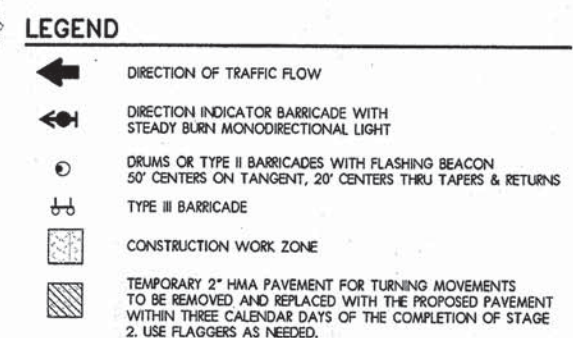
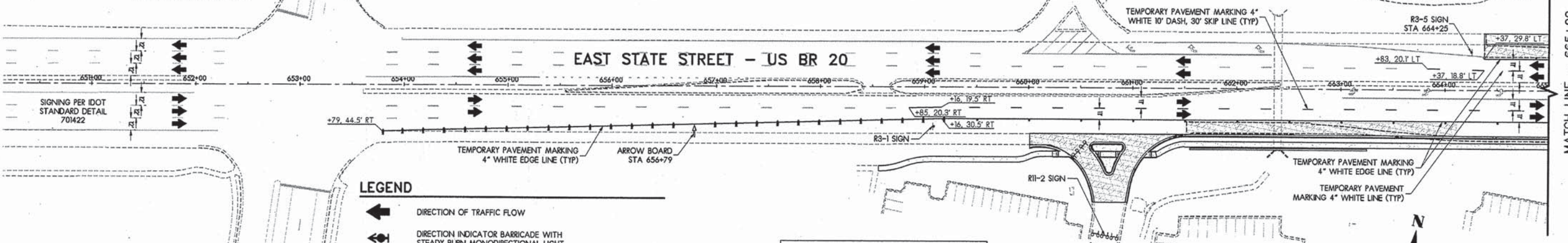

NOTE:
ALL ENTRANCES AND SIDE ROADS SHALL REMAIN OPEN DURING CONSTRUCTION OPERATIONS UNLESS OTHERWISE SPECIFIED.

LAYOUT	MWH	12/10/10
DRAWN	MWH	02/12/13
REVIEWED	DFA	02/12/13

FILE NAME =	USER NAME = #USER#	DESIGNED - DPA	REVISED -
#FILES#		DRAWN - MWH	REVISED -
	PLOT SCALE = #SCALE#	CHECKED - DPA	REVISED -
	PLOT DATE = #DATE#	DATE - #DATE#	REVISED -



TRAFFIC CONTROL AND STAGING PLAN - STAGE II

F.A.U. R.T.E.	SECTION	COUNTY	TOTAL SHEETS	SHEET NO.
5149	04-00345-00-CH	WINNEBAGO	129	25
CONTRACT NO. 85616				
ILLINOIS FED. AID PROJECT				

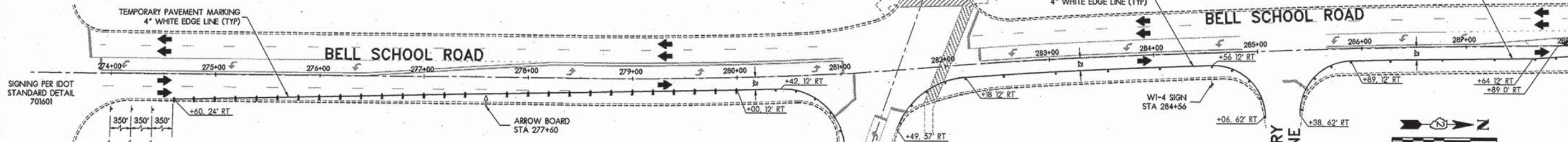
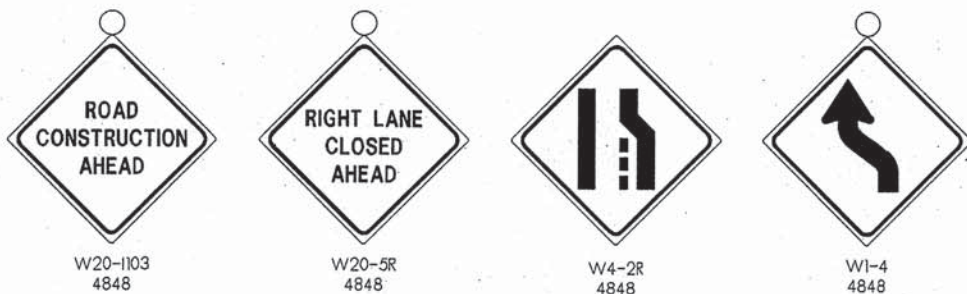

STAGE 3

1. INSTALL TRAFFIC CONTROL FOR STAGE 3.
2. PAVEMENT PATCHING FOR STORM SEWER REMOVAL AND INSTALLATION SHALL BE COMPLETED UNDER TRAFFIC USING STATE HIGHWAY STANDARD 70150I, RE: REMOVAL PLANS.
3. REMOVE THE EXISTING PAVEMENT MARKING WITHIN THE STAGE 3 CONSTRUCTION LIMITS AND INSTALL TEMPORARY PAINT PAVEMENT MARKINGS.
4. INSTALL DRUMS OR BARRICADES ALONG OUTSIDE OF TEMPORARY EDGE LINE PAVEMENT MARKINGS. A MINIMUM OF 2 FEET SHALL BE MAINTAINED FOR A BUFFER AREA BETWEEN THE TRAFFIC LANES AND CONSTRUCTION AREA.
5. BEGIN REMOVAL AND CONSTRUCTION OF THE STAGE 3 AREA. THE PROPOSED CONSTRUCTION SHALL CONSIST OF THE INSTALLATION OF INLETS, STORM SEWERS, CURB & GUTTER, GRADING, PAVEMENT, AND EROSION CONTROL. THE 15" AGGREGATE BASE COURSE SHALL BE INSTALLED ALONG WITH THE 4" HMA BINDER COURSE TO MATCH THE EXISTING PAVEMENT.
6. TEMPORARY DRAINAGE SHALL BE MAINTAINED UTILIZING 4" PVC PIPE AS SHOWN ON TEMPORARY DRAINAGE DETAIL. THIS WORK SHALL BE INCLUDED IN THE COST OF INLET SPECIAL OF THE TYPE SPECIFIED.
7. QUANTITIES FOR TEMPORARY 2" HMA PAVEMENT HAVE BEEN ADDED TO THE PLANS FOR USE AS TEMPORARY ACCESS FOR ENTRANCES AND TURNING MOVEMENTS FOR TRUCKS ON WALTON STREET.
8. EROSION CONTROL AND SEEDING WORK SHALL BE MAINTAINED THROUGHOUT THE DURATION OF THE PROJECT.
9. CLOSURE OF THROUGH LANES, ONE IN EACH DIRECTION, ON EAST STATE STREET WILL ONLY BE ALLOWED FROM 8:00 PM TO 7:00 AM FROM SUNDAYS THROUGH FRIDAYS. TWO THROUGH LANES IN EACH DIRECTION WILL REMAIN OPEN ALL OTHER TIMES ON EAST STATE STREET. NIGHT TIME CLOSURES FOR PATCHES AND CORRUGATED MEDIAN WORK ON STATE STREET SHALL BE COMPLETED USING STATE HIGHWAY STANDARD 701422.
10. BELL SCHOOL ROAD SHALL MAINTAIN TWO-WAY TRAFFIC AT ALL TIMES, EXCEPT FOR SHORT PERIODS OF TIME, WHEN ONE WAY TRAFFIC WITH THE USE OF FLAGGERS MAY BE ALLOWED FROM SUNDAYS AT 8:00 PM TO NOON ON FRIDAYS, AS FOLLOWS: NORTH OF E. STATE STREET (US BR 20): FROM 9:00 AM TO 3:00 PM AND FROM 8:00 PM TO 7:00 AM. SOUTH OF E. STATE STREET (US BR 20): FROM 8:00 PM TO 11:00 AM.

LEGEND

- DIRECTION OF TRAFFIC FLOW
- DIRECTION INDICATOR BARRICADE WITH STEADY BURN MONODIRECTIONAL LIGHT
- DRUMS OR TYPE II BARRICADES WITH FLASHING BEACON 50' CENTERS ON TANGENT, 20' CENTERS THRU TAPERS & RETURNS
- TYPE III BARRICADE
- CONSTRUCTION WORK ZONE
- TEMPORARY 2" HMA PAVEMENT FOR TURNING MOVEMENTS TO BE REMOVED AND REPLACED WITH THE PROPOSED PAVEMENT WITHIN THREE CALENDAR DAYS OF THE COMPLETION OF STAGE 3. USE FLAGGERS AS NEEDED.

NOTE:
ALL ENTRANCES AND SIDE ROADS SHALL REMAIN OPEN DURING CONSTRUCTION OPERATIONS UNLESS OTHERWISE SPECIFIED.

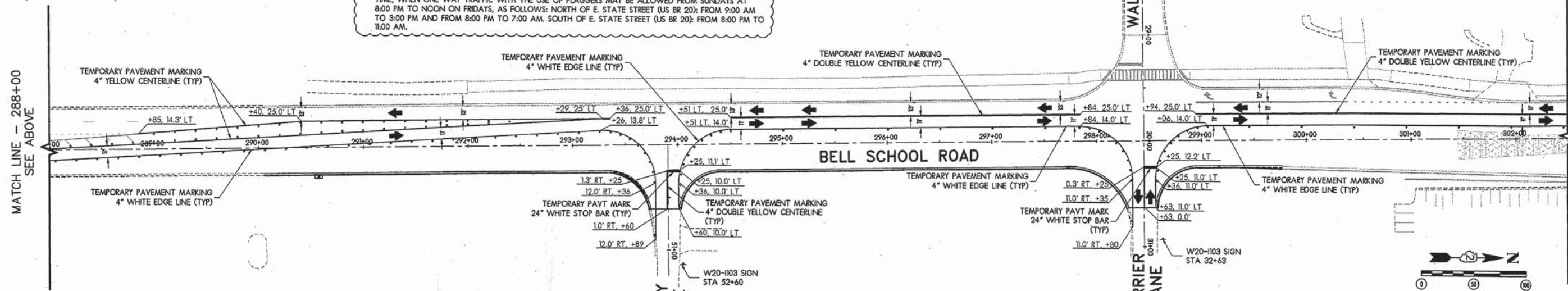
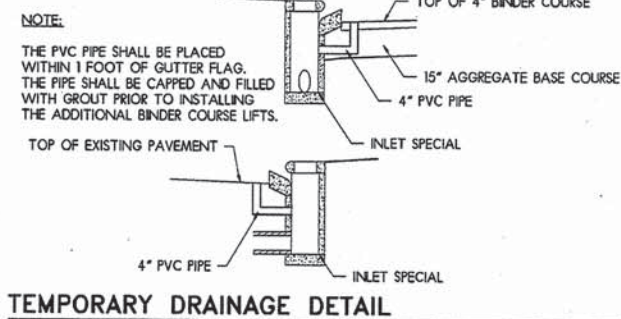

LAYOUT	MWH	12/10/10
DRAWN	MWH	02/12/13
REVIEWED	DPA	02/12/13

FILE NAME =	USER NAME = #USER#	DESIGNED - DPA	REVISED -
#FILES#		DRAWN - MWH	REVISED -
		CHECKED - DPA	REVISED -
		DATE - #DATE#	REVISED -



TRAFFIC CONTROL AND STAGING PLAN - STAGE III

F.A.U. RTE.	SECTION	COUNTY	TOTAL SHEETS	SHEET NO.
5149	04-00345-00-CH	WINNEBAGO	129	28
				CONTRACT NO. 85616
ILLINOIS FED. AID PROJECT				

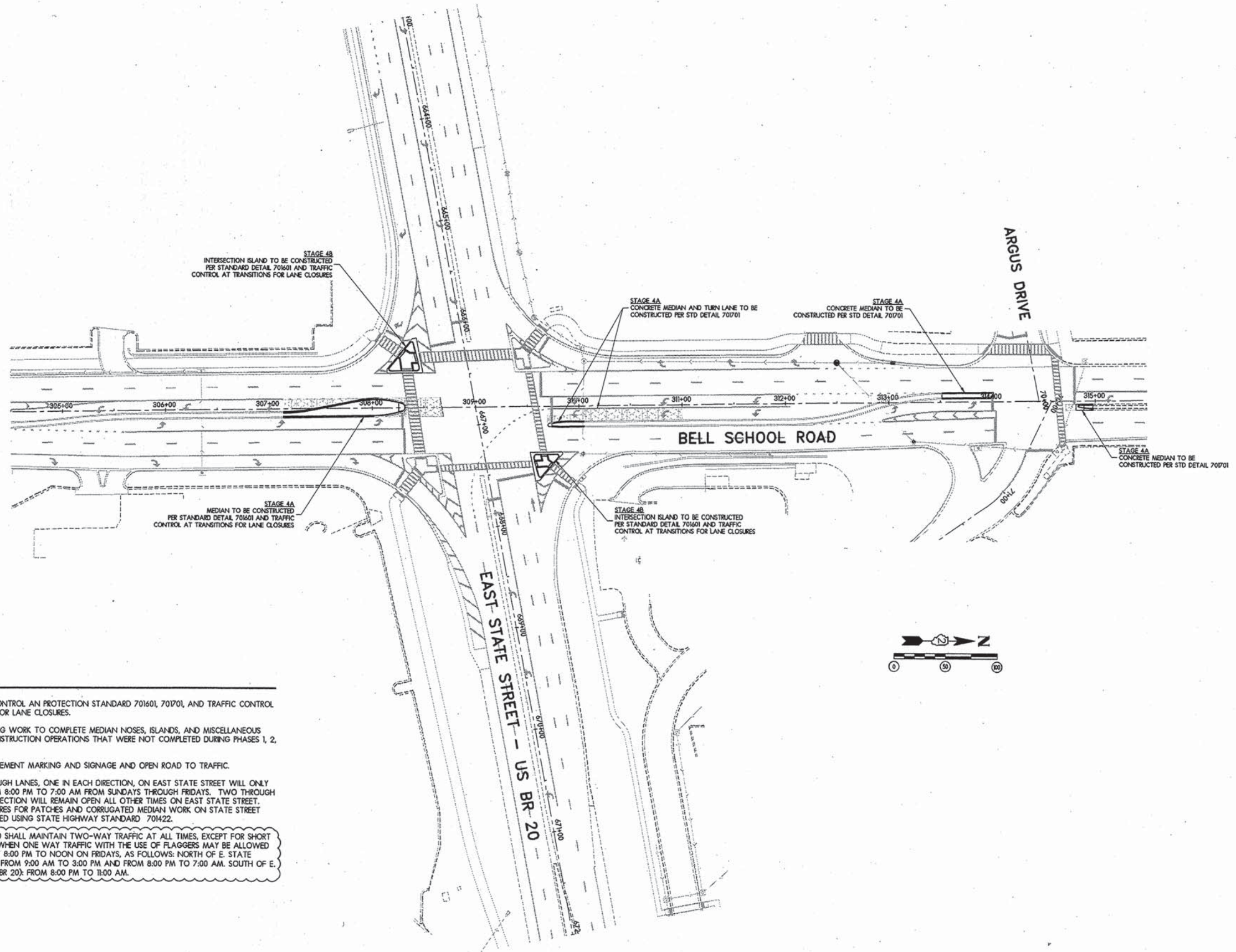

STAGE IV

1. UTILIZE TRAFFIC CONTROL AN PROTECTION STANDARD 701601, 701701, AND TRAFFIC CONTROL AT TRANSITIONS FOR LANE CLOSURES.
2. PERFORM REMAINING WORK TO COMPLETE MEDIAN NOSES, ISLANDS, AND MISCELLANEOUS OTHER MINOR CONSTRUCTION OPERATIONS THAT WERE NOT COMPLETED DURING PHASES 1, 2, AND 3.
3. INSTALL FINAL PAVEMENT MARKING AND SIGNAGE AND OPEN ROAD TO TRAFFIC.
4. CLOSURE OF THROUGH LANES, ONE IN EACH DIRECTION, ON EAST STATE STREET WILL ONLY BE ALLOWED FROM 8:00 PM TO 7:00 AM FROM SUNDAYS THROUGH FRIDAYS. TWO THROUGH LANES IN EACH DIRECTION WILL REMAIN OPEN ALL OTHER TIMES ON EAST STATE STREET. NIGHT TIME CLOSURES FOR PATCHES AND CORRUGATED MEDIAN WORK ON STATE STREET SHALL BE COMPLETED USING STATE HIGHWAY STANDARD 701422.
5. BELL SCHOOL ROAD SHALL MAINTAIN TWO-WAY TRAFFIC AT ALL TIMES, EXCEPT FOR SHORT PERIODS OF TIME, WHEN ONE WAY TRAFFIC WITH THE USE OF FLAGGERS MAY BE ALLOWED FROM SUNDAYS AT 8:00 PM TO NOON ON FRIDAYS, AS FOLLOWS: NORTH OF E. STATE STREET (US BR 20): FROM 9:00 AM TO 3:00 PM AND FROM 8:00 PM TO 7:00 AM. SOUTH OF E. STATE STREET (US BR 20): FROM 8:00 PM TO 11:00 AM.

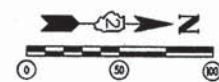

LAYOUT	12/10/10
DRAWN	MWH
REVIEWED	DPA
	02/12/13
	02/12/13

FILE NAME =	USER NAME = #USER#	DESIGNED - DPA	REVISED -
#FILES#		DRAWN - MWH	REVISED -
		CHECKED - DPA	REVISED -
		DATE - #DATE1#	REVISED -

ARC DESIGN
RESOURCES INC.

TRAFFIC CONTROL AND STAGING PLAN - STAGE IV

F.A.U. RTE.	SECTION	COUNTY	TOTAL SHEETS	SHEET NO.
5149	04-00345-00-CH	WINNEBAGO	129	31
CONTRACT NO. 85616				
ILLINOIS FED. AID PROJECT				