

INDEX OF SHEETS

VOLUME 1

SHEET NO.	DESCRIPTION
1	COVER SHEET
2	INDEX OF SHEETS/ HIGHWAY STANDARDS
3	GENERAL NOTES
4 - 18	SUMMARY OF QUANTITIES
19 - 25	TYPICAL SECTIONS
26 - 54	SCHEDULE OF QUANTITIES
55 - 60	ALIGNMENT, TIES, AND BENCHMARKS
61 - 77	ROADWAY PLANS
78 - 87	ROADWAY PROFILES
88 - 89	MAINTENANCE OF TRAFFIC SUGGESTED STAGING
90 - 91	SEIL ROAD & SB I-55 ON RAMP DETOURS
92 - 98	MAINTENANCE OF TRAFFIC TYPICAL SECTIONS AND SIGNS
99 - 112	MAINTENANCE OF TRAFFIC PLANS - PRE-STAGE
113 - 120	MAINTENANCE OF TRAFFIC PLANS - STAGE 1
121 - 131	MAINTENANCE OF TRAFFIC PLANS - STAGE 2
132 - 133	MAINTENANCE OF TRAFFIC PLANS - WINTER STAGE
134 - 143	MAINTENANCE OF TRAFFIC PLANS - STAGE 3
144 - 150	MAINTENANCE OF TRAFFIC PLANS - STAGE 4
151	EROSION CONTROL GENERAL NOTES
152 - 163	EROSION CONTROL PRESTAGE
164 - 171	EROSION CONTROL STAGE 1
172 - 179	EROSION CONTROL STAGE 2
180 - 185	EROSION CONTROL STAGE 3
186 - 188	EROSION CONTROL STAGE 4
189 - 190	EROSION CONTROL SCHEDULE
191 - 206	DRAINAGE AND UTILITY PLANS
207 - 215	DRAINAGE PROFILES
216 - 222	DRAINAGE SCHEDULE
223 - 237	UTILITY PLANS BY SUE (SUBSURFACE UTILITY EXPLORATION)
238 - 259	PLAT OF HIGHWAYS
260 - 261	INTERSECTION DESIGN
262 - 270	PAVEMENT MARKING AND LANDSCAPING PLANS
271 - 280	SIGNING PLANS
281 - 286	SIGN INVENTORY
287 - 295	SIGN PANELS
296 - 311	SIGN STRUCTURE PLANS

VOLUME 2

SHEET NO.	DESCRIPTION
312	COVER SHEET
313	INDEX OF SHEETS/HIGHWAY STANDARDS
314 - 319	TRAFFIC SIGNAL PLANS
320 - 330	IDOT LIGHTING PLANS
331 - 340	IDOT DISTRICT ONE LIGHTING STANDARD DETAILS
341 - 346	VILLAGE OF SHOREWOOD LIGHTING PLANS
347 - 370	STRUCTURE PLANS - IL ROUTE 59 OVER F.A.I. 55 (099-4642)
371	STRUCTURE PLANS - NB IL 59 EXIT RAMP STRUCTURE REMOVAL
372 - 373	STRUCTURE PLANS - IL ROUTE 59 OVER DUPAGE RIVER (099-0284)
374 - 376	STRUCTURE PLANS - IL ROUTE 59 RETAINING WALL (099-W008)
377 - 380	STRUCTURE PLANS - SEIL ROAD RETAINING WALL (099-W023)
381 - 383	STRUCTURE PLANS - IL ROUTE 59 SINGLE BOX CULVERT (099-C004)
384 - 388	STRUCTURE PLANS - IL ROUTE 59 TRIPLE BOX CULVERT (099-0352)
389 - 391	STRUCTURE PLANS - SEIL ROAD DOUBLE BOX CULVERT (099-C022)
392 - 394	STRUCTURE PLANS - IL ROUTE 59 DOUBLE BOX CULVERT (099-0351)
395 - 405	STRUCTURE PLANS - DRAINAGE STRUCTURES
406 - 409	STRUCTURE PLANS - BRIDGE APPROACH PAVEMENT
410 - 416	DRAINAGE AND UTILITY DETAILS
417 - 419	EROSION CONTROL DETAILS
420 - 426	ROADWAY DETAILS
426A - 426L	SOIL PROFILES
427 - 455	DISTRICT ONE STANDARD DETAILS
456	INDEX OF CROSS-SECTIONS
457 - 608	CROSS SECTIONS

HIGHWAY STANDARDS

STD. NO.	DESCRIPTION
000001-05	STANDARD SYMBOLS, ABBREVIATIONS AND PATTERNS
280001-04	TEMPORARY EROSION CONTROL SYSTEMS
406001-05	ENTRANCE RAMP TERMINAL (FLEXIBLE RAMP PAVEMENT ADJACENT TO FLEXIBLE MAINLINE PAVEMENT)
406101-04	EXIT RAMP TERMINAL (FLEXIBLE RAMP PAVEMENT ADJACENT TO FLEXIBLE MAINLINE PAVEMENT)
420001-07	PAVEMENT JOINTS
420111-02	PCC PAVEMENT ROUNDOUTS
420401-06	BRIDGE APPROACH PAVEMENT
424001-05	CURB RAMPS FOR SIDEWALKS
442201-03	CLASS C AND D PATCHES
482001-02	HMA SHOULDER ADJACENT TO FLEXIBLE PAVEMENT
482006-03	HMA SHOULDER ADJACENT TO RIGID PAVEMENT
515001-02	NAME PLATE FOR BRIDGES
542301-01	PRECAST REINFORCED CONCRETE FLARED END SECTION
542306-01	PRECAST REINFORCED CONCRETE ELLIPTICAL FLARED END SECTION
542601	REINFORCED CONCRETE PIPE ELBOW
601001-02	SUB-SURFACE DRAINS
601101	CONCRETE HEADWALL FOR PIPE DRAIN
602001	CATCH BASIN, TYPE A
602006-01	CATCH BASIN, TYPE B
602301-01	INLET, TYPE A
602306-01	INLET, TYPE B
602401-01	MANHOLE, TYPE A
602406-02	MANHOLE TYPE A 1.8 m (6') DIAMETER
602411	MANHOLE TYPE A 2.1 m (7') DIAMETER
602601-01	PRECAST REINFORCED CONCRETE FLAT SLAB TOP
602701-01	MANHOLE STEPS
604001-02	FRAME AND LIDS, TYPE 1
604006-03	FRAME AND GRATE, TYPE 3
604036-01	GRATE, TYPE 8
604091-01	FRAME AND GRATE, TYPE 24
606001-03	CONCRETE CURB TYPE B AND COMBINATION CONCRETE CURB AND GUTTER
606301-03	PC CONCRETE ISLANDS AND MEDIANS
606306-02	CORRUGATED PC CONCRETE MEDIANS
630001-07	STEEL PLATE BEAM GUARDRAIL
630201-05	PCC/HMA STABILIZATION AT STEEL PATE BEAM GUARDRAIL
630301-04	SHOULDER WIDENING FOR TYPE 1 (SPECIAL) GUARDRAIL TERMINALS
631011-04	TRAFFIC BARRIER TERMINAL, TYPE 2
631026-04	TRAFFIC BARRIER TERMINAL, TYPE 5
631031-06	TRAFFIC BARRIER TERMINAL, TYPE 6
635001	DELINEATORS
635006-02	REFLECTOR AND TERMINAL MARKER PLACEMENT
637006-01	CONCRETE BARRIER DOUBLE FACE, 1065 mm (42") HEIGHT
642001	SHOULDER RUMBLE STRIPS
664001-01	CHAIN LINK FENCE
701001-01	OFF-ROAD OPERATIONS, 2L, 2W, MORE THAN 4.5 M (15') AWAY
701006-02	OFF-ROAD OPERATIONS, 2L, 2W, 4.5 M (15') TO 600 MM (24") FROM PAVEMENT EDGE
701011-01	OFF-ROAD MOVING OPERATIONS, 2L, 2W, DAY ONLY
701101-01	OFF-ROAD OPERATIONS, MULTILANE, 4.5 M (15') TO 600 MM (24") FROM PAVEMENT EDGE
701201-02	LANE CLOSURE, 2L, 2W, DAY ONLY, FOR SPEEDS >= 45 MPH
701301-02	LANE CLOSURE, 2L, 2W, SHORT TIME OPERATIONS
701306-01	LANE CLOSURE, 2L, 2W, SLOW MOVING OPERATIONS DAY ONLY, FOR SPEEDS >= 45 MPH
701326-02	LANE CLOSURE, 2L, 2W, PAVEMENT WIDENING, FOR SPEEDS >= 45 MPH
701331-02	LANE CLOSURE, 2L, 2W, WITH RUN-AROUND, FOR SPEEDS >= 45 MPH
701400-02	APPROACH TO LANE CLOSURE, FREEWAY / EXPRESSWAY
701401-04	LANE CLOSURE, FREEWAY / EXPRESSWAY
701411-04	LANE CLOSURE, MULTILANE, AT ENTRANCE OR EXIT RAMP, FOR SPEEDS >= 45 MPH
701421-01	LANE CLOSURE, MULTILANE, DAY OPERATIONS ONLY, FOR SPEEDS >= 45 MPH TO 55 MPH
701422-01	LANE CLOSURE, MULTILANE, FOR SPEEDS >= 45 MPH TO 55 MPH
701426-02	LANE CLOSURE, MULTILANE, INTERMITTENT OR MOVING OPER., FOR SPEEDS >= 45 MPH
701446	TWO LANE CLOSURE FREEWAY / EXPRESSWAY
701501-04	URBAN LANE CLOSURE, 2L, 2W, UNDIVIDED
701606-05	URBAN LANE CLOSURE, MULTILANE, 2W WITH MOUNTABLE MEDIAN
701701-05	URBAN LANE CLOSURE, MULTILANE INTERSECTION
701801-03	LANE CLOSURE, MULTILANE 1W OR 2W CROSSWALK OR SIDEWALK CLOSURE
701901	TRAFFIC CONTROL DEVICES
704001-04	TEMPORARY CONCRETE BARRIER
720001	SIGN PANEL MOUNTING DETAILS
720006-01	SIGN PANEL ERECTION DETAILS
720011	METAL POSTS FOR SIGNS, MARKERS & DELINEATORS
720016-01	MAST ARM MOUNTED STREET NAME SIGNS
728001	TELESCOPING STEEL SIGN SUPPORT
731001	BASE FOR TELESCOPING STEEL SIGN SUPPORT
780001-01	TYPICAL PAVEMENT MARKINGS
814001-01	CONCRETE HANDHOLES
814006-01	DOUBLE HANDHOLES
857001	STANDARD PHASE DESIGNATION DIAGRAMS AND PHASE SEQUENCES
877001-03	STEEL MAST ARM ASSEMBLY AND POLE 16' THROUGH 55'
877011-03	STEEL COMB. MAST ARM ASSEMBLY AND POLE 16' THROUGH 55'
878001-06	CONCRETE FOUNDATION DETAILS
880001	SPAN WIRE MOUNTED SIGNALS AND FLASHING BEACON INSTALLATION
880006	TRAFFIC SIGNAL MOUNTING DETAILS
886001	DETECTOR LOOP INSTALLATIONS

DISTRICT ONE STANDARD DETAILS

BD01	DRIVEWAY DETAILS-DISTANCE BETWEEN R.O.W. AND CURB OR EDGE GREATER THAN 4.5 M (15 FT.)
BD02	DRIVEWAY DETAILS-DISTANCE BETWEEN R.O.W. AND CURB OR EDGE LESS THAN 4.5 M (15 FT.)
BD07	STORM SEWER CONNECTION TO EXISTING SEWER
BD08	DETAILS FOR FRAMES AND LIDS ADJUSTMENT WITH MILLING
BD12	MANHOLE WITH RESTRICTOR PLATE
BD22	PAVEMENT PATCHING FOR HMA SURFACED PAVEMENT
BD28	RUSTICATION FINISH AND GEOCOMPOSITE DRAIN FOR RETAINING WALLS
BD32	BUTT JOINT AND HMA TAPER DETAILS
BD34	DETAILS FOR STEEL PLATE BEAM GUARD RAIL ADJACENT TO CURB AND GUTTER STAB AT TYT TY 1 SPL
BD36	FIRE HYDRANT TO BE MOVED
BD49	DETAIL FOR CENTERLINE SAWCUT 16' (4.9 m) AND VARIABLE JOINTED PCC PAVEMENT FOR RAMPS
BD51	BENCHING DETAIL FOR EMBANKMENT WIDENING
BE205	LIGHTING CONTROLLER, RADIO CONTROL DUPLEX TYPE WITH SCADA
BE220	ELECTRIC SERVICE INSTALLATION AERIAL, REMOTE DISCONNECT
BE301	LIGHT POLE FOUNDATION 40' (12.192 m) TO 47 1/2' (14.478 m) M.H. 15" (381) BOLT CIRCLE
BE410	DAVIT LIGHT POLE 47' - 6" (14.478 m) MOUNTING HEIGHT
BE701	LUMINAIRE SAFETY CABLE ASSEMBLY
BE702	MISC. ELECTRICAL DETAILS SHEET A
BE900	SUSPENDED MOUNT UNDERPASS LUMINAIRE INSTALLATION DETAILS
TC08	FREEWAY ENTRANCE AND EXIT RAMP CLOSURE DETAILS
TC09	FREEWAY SINGLE AND MULTI LANE WEAVE
TC10	TRAFFIC CONTROL AND PROTECTION FOR SIDE ROADS, INTERSECTIONS AND DRIVEWAYS
TC11	RAISED REFLECTIVE PAVEMENT MARKERS
TC12	MULTI-LANE FREEWAY PAVEMENT MARKING DETAILS
TC13	DISTRICT ONE TYPICAL PAVEMENT MARKINGS
TC14	TRAFFIC CONTROL AND PROTECTION AT TURN BAYS (TO REMAIN OPEN TO TRAFFIC)
TC16	PAVEMENT MARKING LETTERS AND SYMBOLS FOR TRAFFIC STAGING
TC17	SHOULDER CLOSURES PARTIAL RAMP CLOSURES
TC18	SIGNING FOR FLAGGING OPERATIONS AT WORKING ZONE OPENINGS
TC22	ARTERIAL ROAD INFORMATION SIGN
TS02	DISTRICT 1 MAST ARM MOUNTED STREET NAME SIGNS
TS05	STANDARD TRAFFIC SIGNAL DESIGN DETAILS

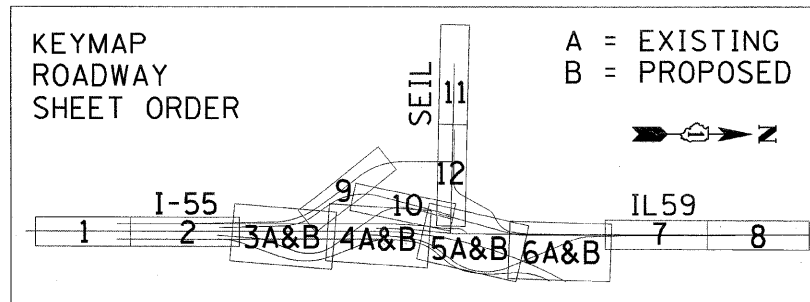

F.A.I. RTE.	SECTION	COUNTY	TOTAL SHEETS	SHEET NO.
55	*	WILL	608	2
STA.		TO STA.		
FED. ROAD DIST. NO. 1		ILLINOIS	FED. AID PROJECT	
* (26, 26HB-1&114) R-2		CONTRACT NO. 60363		

REVISIONS	
NAME	DATE
JB	07/11/08

ILLINOIS DEPARTMENT OF TRANSPORTATION
 FAI 55 AT FAP 338 ILLINOIS ROUTE 59
 SECTION: (26, 26HB-1&114) R-2

INDEX OF SHEETS & HIGHWAY STANDARDS

SCALE: N.T.S. DRAWN BY: JB
 DATE: 03/14/08 CHECKED BY: ACL

TENG
TENG & ASSOCIATES, INC.
 ENGINEERS ARCHITECTS PLANNERS
 305 N. MICHIGAN AVE. CHICAGO, IL 60601
 TEL: 312.587.9000

*ATTBOOKRNDJDN
 7-14-2008 8:42:03
 T:\DOCUMENT\932790\CIVIL\DRAWING\DOORS\HJDN
 12 13 14 15 16 17 18 19 20 21 22 23 24 25 26 27 28 29 30 31 32 33 34 35 36 37 38 39 40 41 42 43 44 45 46 47 48 49 50 51 52 53 54 55 56 57 58 59 60 61 62 63
 LEAC

F.A.I. RY.	SECTION	COUNTY	TOTAL SHEETS	SHEET NO.
55	*	WILL	608	6
STA.		TO STA.		
FED. ROAD DIST. NO. 1		ILLINOIS	FED. AID PROJECT	
* (26, 26HB-1&114) R-2		CONTRACT NO. 60363		

SUMMARY OF QUANTITIES

90% FED. / 10% STATE

CODE NO.	ITEM	UNIT	TOTAL QUANTITY	WILL COUNTY												TRAFFIC SIGNALS 90% FED 6.7% STATE 3.3% VOS	CITY OF JOLIET 100% JOLIET	RETAINING WALLS CULVERTS	VILLAGE OF SHOREWOOD 100% VOS
				URBAN	ROADWAY IL-59 90% FED 10% STATE	ROADWAY I-55 90% FED 10% STATE	ROADWAY NB RAMP 90% FED 10% STATE	ROADWAY SB RAMP 90% FED 10% STATE	ROADWAY SEIL RD 90% FED 10% STATE	ROADWAY FRONTG RD 90% FED 10% STATE	BRIDGE IL59 NB EXIT RAMP OVER I-55	BRIDGE IL59 OVER DUPAGE RIVER	SIGNING	EXPRESSWAY LIGHTING 100% STATE	VILLAGE LIGHTING 100% VOS				
					J000-2A	I000-2A	J000-2A	J000-2A	I000-2A	I000-2A	X271-2A	X081-2A	Y002-2A	Y030-1E	Y030-1E				
4400500	COMBINATION CURB AND GUTTER REMOVAL	FOOT	2,333		2,236					30	67								
4400600	SIDEWALK REMOVAL	SQ FT	2,626	2,626															
44003100	MEDIAN REMOVAL	SQ FT	334	334															
44003510	MEDIAN REMOVAL PARTIAL DEPTH	SQ FT	2,608	2,608															
44004000	PAVED DITCH REMOVAL	FOOT	75			75													
44004250	PAVED SHOULDER REMOVAL	SQ YD	12,059	221	9,165	2,673													
44201741	CLASS D PATCHES, TYPE II, 8 INCH	SQ YD	32	32															
44201745	CLASS D PATCHES, TYPE III, 8 INCH	SQ YD	39	39															
44201747	CLASS D PATCHES, TYPE IV, 8 INCH	SQ YD	1,083	831					252										
44201771	CLASS D PATCHES, TYPE IV, 10 INCH	SQ YD	71						71										
44201869	CLASS D PATCHES, TYPE IV, 18 INCH	SQ YD	352	352															
48101200	AGGREGATE SHOULDERS, TYPE B	TON	1,118		1,118														
48101500	AGGREGATE SHOULDERS, TYPE B 6"	SQ YD	3,968	1,360							2,608								
48101600	AGGREGATE SHOULDERS, TYPE B 8"	SQ YD	4,020			338	903	171	2,608										
48203029	HOT-MIX ASPHALT SHOULDERS, 8"	SQ YD	9,150	393	372	4,339	3,642	290	114										
48203049	HOT-MIX ASPHALT SHOULDERS, 13"	SQ YD	7,695		7,695														
50100200	REMOVAL OF EXISTING STRUCTURES	L SUM	1								1								
50102400	CONCRETE REMOVAL	CU YD	123									69					54		
50104400	CONCRETE HEADWALL REMOVAL	EACH	10	3		3		2	2										
50105220	PIPE CULVERT REMOVAL	FOOT	3090	1,626		245		1,104	115										
50200100	STRUCTURE EXCAVATION	CU YD	2,276								1,104						272	900	
50200400	ROCK EXCAVATION FOR STRUCTURES	CU YD	2,619	2,520														99	
50300225	CONCRETE STRUCTURES	CU YD	563.4								137.8						140.7	264.9	
50300255	CONCRETE SUPERSTRUCTURE	CU YD	347								341	6							
50300260	BRIDGE DECK GROOVING	SQ YD	1579								1,042	337							
50300300	PROTECTIVE COAT	SQ YD	2,153								1,453	590					54	56	
50300510	RUSTICATION FINISH	SQ FT	2,591														1,422	1,169	
50500105	FURNISHING AND ERECTING STRUCTURAL STEEL	L SUM	1								1								
50500405	FURNISHING AND ERECTING STRUCTURAL STEEL	POUND	1,640															1,640	
50500505	STUD SHEAR CONNECTORS	EACH	3,204								3,204								
50800105	REINFORCEMENT BARS	POUND	57,500								21,690							35,810	

• DENOTES SPECIALTY ITEMS

REVISIONS	
NAME	DATE

ILLINOIS DEPARTMENT OF TRANSPORTATION
FAI 55 AT FAP 338 ILLINOIS ROUTE 59
SECTION: (26, 26HB-1&114) R-2

SUMMARY OF QUANTITIES 3

SCALE: _____ DRAWN BY: JB
DATE: 03/14/08 CHECKED BY: ACL

TENG

TENG & ASSOCIATES, INC.
ENGINEERS, ARCHITECTS, PLANNERS
260 N. MICHIGAN AVE. CHICAGO, IL 60611
TEL: (312) 281-2000 FAX: (312) 281-2001

Rev. 7-17-08

Rev.

\S:\0000055.DGN... \S:\0000055.DGN... \T:\0000055.DGN...
 3-24-2008 10:37:49
 1 2 3 4 5 6 7 8 9 10 11 12 13 14 15 16 17 18 19 20 21 22 23 24 25 26 27 28 29 30 31 32 33 34 35 36 37 38 39 40 41 42 43 44 45 46 47 48 49 50 51 52 53 54 55 56 57 58 59 60 61 62 63

SUMMARY OF QUANTITIES

90% FED. / 10% STATE

CODE NO.	ITEM	UNIT	URBAN TOTAL QUANTITY	WILL COUNTY												TRAFFIC SIGNALS 90% FED 6.7% STATE 3.3% VOS	CITY OF JOLIET 100% JOLIET	90% FED. / 10% STATE RETAINING WALLS CULVERTS	VILLAGE OF SHOREWOOD 100% VOS
				ROADWAY IL-59 90% FED 10% STATE	ROADWAY I-55 90% FED 10% STATE	ROADWAY NB RAMP 90% FED 10% STATE	ROADWAY SB RAMP 90% FED 10% STATE	ROADWAY SEIL RD 90% FED 10% STATE	ROADWAY FRONTG RD 90% FED 10% STATE	BRIDGE IL59 NB EXIT RAMP OVER I-55	BRIDGE IL59 OVER DUPAGE RIVER	SIGNING	EXPRESSWAY LIGHTING 100% STATE	VILLAGE LIGHTING 100% VOS	CONSTRUCTION TYPE CODE				
				J000-2A	I000-2A	J000-2A	J000-2A	I000-2A	I000-2A	X271-2A	X081-2A	Y002-2A	Y030-1E	Y030-1E	Y031-1F				
70400100	TEMPORARY CONCRETE BARRIER	FOOT	7,375	240	7,135														
70400200	RELOCATE TEMPORARY CONCRETE BARRIER	FOOT	12,249	210	10,864	1,020		155											
* 72000100	SIGN PANEL - TYPE 1	SQ FT	573									562		11					
* 72000200	SIGN PANEL - TYPE 2	SQ FT	131									131							
* 72000300	SIGN PANEL - TYPE 3	SQ FT	1,221									1,221							
* 72400100	REMOVE SIGN PANEL ASSEMBLY - TYPE A	EACH	112									112							
* 72400200	REMOVE SIGN PANEL ASSEMBLY - TYPE B	EACH	9									9							
* 72400310	REMOVE SIGN PANEL - TYPE 1	SQ FT	570									570							
* 72400320	REMOVE SIGN PANEL - TYPE 2	SQ FT	145									145							
* 72400330	REMOVE SIGN PANEL - TYPE 3	SQ FT	640									640							
* 72400500	RELOCATE SIGN PANEL ASSEMBLY - TYPE A	EACH	19									19							
* 72400710	RELOCATE SIGN PANEL - TYPE 1	SQ FT	105									105							
* 72400720	RELOCATE SIGN PANEL - TYPE 2	SQ FT	20									20							
* 72800100	TELESCOPING STEEL SIGN SUPPORT	FOOT	1132									1132							
* 73100100	BASE FOR TELESCOPING STEEL SIGN SUPPORT	EACH	76									76							
* 73302170	OVERHEAD SIGN STRUCTURE - CANTILEVER, TYPE II-C-A (36" X 5'-6")	FOOT	90									90							
* 73304000	OVERHEAD SIGN STRUCTURE - BRIDGE MOUNTED	FOOT	20									20							
* 73400200	DRILLED SHAFT CONCRETE FOUNDATIONS	CU YD	24									24							
* 73700100	REMOVE GROUND-MOUNTED SIGN SUPPORT	EACH	4									4							
* 78000100	THERMOPLASTIC PAVEMENT MARKING - LETTERS AND SYMBOLS	SQ FT	291	73				218											
* 78000200	THERMOPLASTIC PAVEMENT MARKING - LINE 4"	FOOT	47,727	1,556	25,762			3,809	16,600										
* 78000400	THERMOPLASTIC PAVEMENT MARKING - LINE 6"	FOOT	872	322				550											
* 78000500	THERMOPLASTIC PAVEMENT MARKING - LINE 8"	FOOT	4,595		1,909	932	1,754												
* 78000600	THERMOPLASTIC PAVEMENT MARKING - LINE 12"	FOOT	1,141		1,141														
* 78000650	THERMOPLASTIC PAVEMENT MARKING - LINE 24"	FOOT	182	42				140											
* 78003120	PREFORMED PLASTIC PAVEMENT MARKING, TYPE B - LINE 5"	FOOT	8,227		8,227														
* 78005110	EPOXY PAVEMENT MARKING - LINE 4"	FOOT	13,914		13,914														
* 78005120	EPOXY PAVEMENT MARKING - LINE 5"	FOOT	4,187		4,187														
* 78005140	EPOXY PAVEMENT MARKING - LINE 8"	FOOT	3,476		3,476														
* 78008200	POLYUREA PAVEMENT MARKING TYPE I - LETTERS AND SYMBOLS	SQ FT	619	546		73													
* 78008210	POLYUREA PAVEMENT MARKING TYPE I - LINE 4"	FOOT	26,587	14,158		5,575	4,706			640	1,508								

* DENOTES SPECIALTY ITEMS

REVISIONS	
NAME	DATE

ILLINOIS DEPARTMENT OF TRANSPORTATION
FAI 55 AT FAP 338 ILLINOIS ROUTE 59
SECTION: (26, 26HB-1&114) R-2

SUMMARY OF QUANTITIES 9

SCALE: _____ DRAWN BY: JB
DATE: 03/14/08 CHECKED BY: ACL

TENG

TENG & ASSOCIATES INC.
ENGINEERS ARCHITECTS PLANNERS
205 N. MICHIGAN AVE. CHICAGO, IL 60601
TELEPHONE: 312.698.9900

Rev. 7-17-08

I:\S\0000055.DWG...S\0000055.DWG...T\T\0000055.DWG...
 P:\COURTNEY\1135279\1135279\1135279.DWG
 1 2 3 4 5 6 7 8 9 10 11 12 13 14 15 16 17 18 19 20 21 22 23 24 25 26 27 28 29 30 31 32 33 34 35 36 37 38 39 40 41 42 43 44 45 46 47 48 49 50 51 52 53 54 55 56 57 58 59 60 61 62 63

SUMMARY OF QUANTITIES

90% FED. / 10% STATE

CODE NO.	ITEM	UNIT	URBAN TOTAL QUANTITY	WILL COUNTY												TRAFFIC SIGNALS 90% FED 6.7% STATE 3.3% VOS	90% FED. / 10% STATE		
				ROADWAY IL-59 90% FED 10% STATE	ROADWAY I-55 90% FED 10% STATE	ROADWAY NB RAMP 90% FED 10% STATE	ROADWAY SB RAMP 90% FED 10% STATE	ROADWAY SEIL RD 90% FED 10% STATE	ROADWAY FRONTG RD 90% FED 10% STATE	BRIDGE IL59 NB EXIT RAMP OVER I-55	BRIDGE IL59 OVER DUPAGE RIVER	SIGNING	EXPRESSWAY LIGHTING 100% STATE	VILLAGE LIGHTING 100% VOS	CITY OF JOLIET 100% JOLIET		RETAINING WALLS CULVERTS	VILLAGE OF SHOREWOOD 100% VOS	
				J000-2A	I000-2A	J000-2A	J000-2A	I000-2A	I000-2A	X271-2A	X081-2A	Y002-2A	Y030-1E	Y030-1E	Y031-1F		J000-2A	Y007	J000-2A
Z0064600	SELECTIVE CLEARING	ACRE	2.4	1.2		1.2													
Z0065745	SLOTTED DRAIN 12" WITH 2 1/2" SLOT	FOOT	381					381.0											
Z0077700	WOOD FENCE TO BE REMOVED AND RE-ERECTED	FOOT	438	313					125										
* X0326020	UTILITY PROTECTION PAD	SQ YD	675					374		301									
* X0326015	LIGHT POLE, COMPLETE IN PLACE, VILLAGE OF SHOREWOOD	EACH	48												48				
* X0326021	UNIT DUCT, 600V, 4-1C NO.6, 1/C NO.6 (XLP-TYPE USE), 1 1/4" DIA. POLYETHYLENE	FOOT	9860												9860				
* X0326016	ELECTRIC CABLE IN CONDUIT, LIGHTING, 2/C NO.10	FOOT	415												415				
⊙ Z0076600	TRAINEES	HOUR	5000	5000															
⚠ X0326165	STORM SEWER (WATERMAIN REQUIREMENTS) 72 INCH	FOOT	25	13															12

⊙ Y080
• DENOTES SPECIALTY ITEMS

REVISIONS	
NAME	DATE

ILLINOIS DEPARTMENT OF TRANSPORTATION
FAI 55 AT FAP 338 ILLINOIS ROUTE 59
SECTION: (26, 26HB-1&114) R-2

SUMMARY OF QUANTITIES 15

SCALE: _____ DRAWN BY: JB
DATE: 03/14/08 CHECKED BY: ACL

TENG

TENG & ASSOCIATES, INC.
ENGINEERS/ARCHITECTS/PLANNERS
306 N. MICHIGAN AVE. CHICAGO, IL 60610
TELEPHONE: 312-615-0800

⚠ Rev. 7-10-08

Rev.

S:\000055.DGN ... \TBOORNDGN
 3-24-2008 10:37:46
 T:\DOCUMENT\193279\WIL\GDN\SJ000087.DGN
 1 2 3 4 5 6 7 8 9 10 11 12 13 14 15 16 17 18 19 20 21 22 23 24 25 26 27 28 29 30 31 32 33 34 35 36 37 38 39 40 41 42 43 44 45 46 47 48 49 50 51 52 53 54 55 56 57 58 59 60 61 62 63

HOT-MIX ASPHALT MIXTURE REQUIREMENTS				
	MIXTURE TYPE	THICKNESS	AC TYPE	AIR VOIDS
FULL DEPTH PAVEMENT				
HOT-MIX ASPHALT PAVEMENT (FULL-DEPTH), 9"				
	HOT-MIX ASPHALT SURFACE COURSE, MIX "C", N50 (IL 9.5 mm)	2"	PG 64-22	4% @ 50 GYR.
	HOT-MIX ASPHALT BINDER COURSE, IL-19.0, N50	7"	PG 64-22*	4% @ 50 GYR.
HOT-MIX ASPHALT PAVEMENT (FULL-DEPTH), 15 3/4"				
	POLYMERIZED HOT-MIX ASPHALT SURFACE COURSE, MIX "F", N90 (IL 9.5 mm)	2"	SBS/SBR PG 70-22	4% @ 90 GYR.
	POLYMERIZED HOT-MIX ASPHALT BINDER COURSE, IL-19.0, N90	13 3/4"	SBS/SBR PG 70-22	4% @ 90 GYR.
HOT-MIX ASPHALT PAVEMENT (FULL-DEPTH), 17"				
	POLYMERIZED HOT-MIX ASPHALT SURFACE COURSE, MIX "F", N90 (IL 9.5 mm)	2"	SBS/SBR PG 70-22	4% @ 90 GYR.
	POLYMERIZED HOT-MIX ASPHALT BINDER COURSE, IL-19.0, N90	15"	SBS/SBR PG 70-22	4% @ 90 GYR.
SHOULDER RECONSTRUCTION				
	HOT-MIX ASPHALT SHOULDERS, 8" (INCLUDING GUARDRAIL STABILIZ.)	8"	PG 64-22*	2% @ 30 GYR.
	HOT-MIX ASPHALT SHOULDERS, 13" (HMA BINDER IL-19 mm)	13"	PG 64-22*	4% @ 70 GYR.
TEMPORARY PAVEMENT 10"				
	TEMP PAVEMENT (HMA BINDER IL-19 mm)	8 1/2"	PG 64-22*	4% @ 50 GYR.
	HMA SURFACE COURSE, MIX "D" N50 (IL 9.5 mm)	1 1/2"	PG 64-22	4% @ 50 GYR.
PAVEMENT RESURFACING (IL59 SIDE STREETS)				
	HOT-MIX ASPHALT SURFACE COURSE, MIX "D", N50 (IL 9.5 mm)	1 1/4"	PG 64-22	4% @ 50 GYR.
	LEVELING BINDER (MACHINE METHOD), N50 (IL-9.5) **	3/4"	SBS/SBR PG 76-28/-22	4% @ 50 GYR.
DRIVEWAYS				
	HOT-MIX ASPHALT SURFACE COURSE, MIX "D", N50 (IL 9.5 mm)	2"	PG 64-22	4% @ 50 GYR.
	HOT-MIX ASPHALT BASE COURSE (HMA BINDER IL-19 mm)	PE - 6", CE - 8"	PG 64-22 *	4% @ 50 GYR.
PATCHING				
	CLASS D PATCHES (HMA BINDER IL-19 mm)	VARIES	PG 64-22*	4% @ 70 GYR.
STABILIZED SUBBASE				
	STABILIZED SUB-BASE-HOT-MIX ASPHALT	4"	PG 64-22	2% @ 30 GYR.
PAVEMENT WIDENING (IL59 SIDE STREETS)				
	HOT-MIX ASPHALT SURFACE COURSE, MIX "D", N50 (IL 9.5 mm)	1 1/2"	PG 64-22	
	LEVELING BINDER (MACHINE METHOD), N50 (IL-9.5) **	3/4"	SBS/SBR PG 76-28/-22	
	HMA BASE COURSE (HMA BINDER IL-19 mm); 7 1/4"	7"	PG 64-22*	
PAVEMENT RESURFACING (NORTH OF DUPAGE RIVER)				
	HOT-MIX ASPHALT SURFACE COURSE, MIX "D", N50	2"	PG 64-22	4% @ 50 GYR.

THE UNIT WEIGHT USED TO CALCULATE ALL HMA SURFACE MIXTURE QUANTITIES IS 112 LBS/SQ YD/IN.

* WHEN RAP EXCEEDS 20%, THE NEW ASPHALT BINDER IN THE MIX SHALL BE PG 58-22.

** THIS LEVELING BINDER SHALL SUPERSEDE THE LEVELING BINDER CALLED OUT IN THE PLANS WHICH REFERENCE AN "FG" BINDER.

REVISIONS	
NAME	DATE
JB	07/11/08

ILLINOIS DEPARTMENT OF TRANSPORTATION
 FAI 55 AT FAP 338 ILLINOIS ROUTE 59
 SECTION: (26, 26HB-1&114) R-2
**HOT-MIX ASPHALT MIXTURE
 REQUIREMENTS**

SCALE: DATE: 03/14/08 DRAWN BY: JB CHECKED BY: ACL

TENG
 TENG & ASSOCIATES, INC.
 ENGINEERS/ARCHITECTS/PLANNERS
 205 N. MICHIGAN AVE. CHICAGO, IL 60601
 TELEPHONE: 312.587.4000

\TTEBOOK\LDGN...TSC00RELJDN LEAC
 T:\DOCUMENT\9327901\DWL\LDGN\TSC00SO-DGN
 7-14-2008, 8:25:03
 1 2 3 4 5 6 7 8 9 10 11 12 13 14 15 16 17 18 19 20 21 22 23 24 25 26 27 28 29 30 31 32 33 34 35 36 37 38 39 40 41 42 43 44 45 46 47 48 49 50 51 52 53 54 55 56 57 58 59 60 61 62

F.A.I. RTE.	SECTION	COUNTY	TOTAL SHEETS	SHEET NO.
55	*	WILL	608	44
STA.		TO STA.		
FED. ROAD DIST. NO. 1		ILLINOIS	FED. AID PROJECT	
* (26, 26HB-1&114) R-2		CONTRACT NO. 60363		

48101600							TOTAL	4,021	SQ YD
AGGREGATE SHOULDERS, TYPE B 8"									
STA.	STA.	LENGTH FT	WIDTH FT	LOCATION LT/RT	AREA SQ FT	SUBTOTALS SQ YD			
E. FRONTAGE RD.									
6499+84.00	6504+45.32	461.3	8.00	LT & RT	3,691	410.1			
6504+45.32	6518+00.00	1,354.7	8.00	LT & RT	10,837	1,204.2			
6518+00.00	6529+18.39	1,118.4	8.00	LT & RT	8,947	994.1			
SEIL RD									
4004+00.00	4008+73.00	473.0	2.00	RT	946	105.1			
4004+00.00	4008+73.00	348.00	2.00	LT	596	66.2			
NB RAMP									
8000+86.22	8010+32.00	945.78	2.00	RT	1,883	209.2			
8004+55.03	8010+32.00	576.97	2.00	LT	1,161	129.0			
		0.00							
SB RAMP									
7005+05.36	7024+62.50	1,957.14	2.00	RT	3,926	436.2			
7005+05.36	7026+11.91	2,106.55	2.00	LT	4,199	466.6			

60600605							TOTAL	909	FOOT
CONCRETE CURB, TYPE B									
DESCRIPTION	OFFSET LT / RT	STATION	LEFT CURB LENGTH FT	RIGHT CURB LENGTH FT	MEDIAN	SUBTOTALS FOOT			
C.E. DRIVEWAY	LT	7484+00.00	48.39	48.70		97.09			
C.E. DRIVEWAY	LT	7486+65.44	47.27	47.29		94.56			
C.E. DRIVEWAY	RT	7498+58.68	58.15	51.59	0	109.74			
C.E. DRIVEWAY	RT	7502+18.03	44.54	43.39		87.93			
C.E. DRIVEWAY	RT	7504+20.68	42	77.64		119.64			
C.E. DRIVEWAY	RT	7504+68.54	39.66	79.59		119.25			
C.E. DRIVEWAY	RT	7506+25.20	39.01	39.01		78.02			
C.E. DRIVEWAY	RT	7509+14.83	39.27	39.27		78.54			
C.E. DRIVEWAY	RT	7512+33.40	39.27	39.27	45.78	124.32			

60605400				TOTAL	75	FOOT
COMBINATION CONCRETE CURB AND GUTTER, TYPE B-6.24 (SPECIAL)						
STA.	LENGTH			SUBTOTALS FOOT		
8031+60.77	8031+85.79		MEDIAN	25.02		
8033+35.77	8033+85.77		SHOULDER	50.00		

60618300					TOTAL	486	SQ FT
CONCRETE MEDIAN SURFACE, 4 INCH							
STA	ROAD	OFFSET	LOCATION		SUBTOTALS SQ FT		
748665	IL59	RT	MEDIAN		0		
750444	IL59	RT	MEDIAN		402.96		
751233	IL59	RT	MEDIAN		83.35		

60603800				TOTAL	32	FOOT
COMBINATION CONCRETE CURB AND GUTTER, TYPE B-6.12						
STA.	OFFSET	LENGTH FT		SUBTOTALS FOOT		
4003+20.50	27.46	LT	15.76	15.76		
4003+75.33	27.58	LT	15.86	15.86		

60624600					TOTAL	458	SQ FT
CORRUGATED MEDIAN							
STA.	STA.		AREA SQ FT	SUBTOTALS SQ FT			
SBRP	7000+52.19	7005+05.37	3,094	1,509			
IL59	6999+18.33	7483+64.70	8,816	1,509			
IL59	7484+30.85	7486+37.45	1,810	1,510			
		TOTAL	13,720	9,192	STATE PORTION		

48203029							TOTAL	9,190	SQ YD
HOT-MIX ASPHALT SHOULDERS, 8"									
STA.	STA.	LENGTH FT	WIDTH FT	LOCATION RT/LT	AREA SQ FT	SUBTOTALS SQ YD			
S.B. SHOULDER									
7000+75.64	7005+05.43	429.79	VAR	RT	5,400	600.0			
7005+05.43	7009+35.50	430.07	6.00	RT	2,581	286.8			
7009+35.50	7024+62.50	1,527.00	9.00	RT	9,171	1,019.0			
7024+62.50	7033+24.48	861.98	6.00	RT	7,228	803.1			
7005+05.43	7026+11.91	2,106.48	4.00	LT	8,402	933.6			
N.B. SHOULDER INCLUDES BIT STAB AT SPBGR AREAS									
8000+86.22	8004+55.03	368.81	6.00	RT	2,212	245.8			
8004+55.03	8010+27.50	572.47	6.00	RT	3,430	381.1			
8010+27.50	8019+28.40	900.90	9.00	RT	8,366	929.6			
8023+11.42	8033+35.77	1,024.35	9.00	RT	9,197	1,021.9			
8033+35.77	8036+79.66	343.89	3.00	RT	1,032	114.6			
8004+55.03	8010+27.50	572.47	4.00	LT	2,310	256.7			
8010+27.50	8019+02.84	875.34	7.00	LT	6,316	701.8			
8022+85.86	8031+60.77	874.91	7.00	LT	6,187	687.4			
IL59									
8033+35.77	7479+50.00	N/A	3.00	RT	2,437	270.8			
7476+72.09	7479+86.52			LT	1,100	122.2			
I-55									
CANTILEVER AT 63+00					809	89.9			
CANTILEVER AT 79+00					868	96.4			
CANTILEVER AT 88+00					818	90.9			
EX TRUSS AT 92+40					849	94.3			
SEIL									
4016+00.00	IL59			RT	910	101.1			
4015+36.30	SBRAMP			LT	1,112	123.6			
4012+50.00	4014+07.00			LT	585	65.0			
WEST F.R.									
5497+56.00	5500+87.50			RT	1,026	114.0			

60605000							TOTAL	13,993	FOOT
COMBINATION CONCRETE CURB AND GUTTER, TYPE B-6.24									
STA.	STA.	LENGTH FT	OFFSET RT / LT		MEDIAN	SUBTOTALS FOOT			
6999+18.00	6999+70.00	54.3	LT			54			
7000+37.20	7002+66.13	228.9	LT			229			
7002+66.13	7005+05.37	239.2	LT			239			
8031+85.79	8034+00.00	214.2	LT			214			
8034+00.00	8036+28.90	228.9	LT			229			
8031+60.77	MEDIAN	22.0	LT			22			
8036+95.00	8037+44.00	53.5	LT			54			
7476+72.09	7483+64.86	692.8	RT			693			
7476+68.47	7479+80.12	311.7	RT			312			
7479+80.12	7481+76.97	196.8	RT			197			
7481+76.97	7483+64.86	187.9	RT			188			
7484+34.00	7486+00.00	166.0	LT			166			
7484+36.37	7486+00.00	180.4	RT			180			
7486+00.00	7486+62.42	62.4	LT			62			
7486+00.00	7486+62.42	62.4	RT			62			
EOP									
8033+83.04	8034+00.00	17.0	RT			17			
8034+00.00	8037+44.39	344.4	RT			344			
7476+72.09	7486+00.00	927.9	LT			928			
7476+68.47	7486+00.00	931.5	LT			932			
7486+00.00	7492+23.37	623.4	LT			623			
7492+23.37	RADII	46.9	LT			47			
7493+16.19	RADII	47.4	LT			47			
7493+16.19	7499+00.00	583.8	LT			584			
7486+00.00	7499+00.00	1,300.0	RT			1,300			
7499+00.00	7500+68.41	168.4	LT			168			
7500+68.41	RADII	46.9	LT			47			
7501+54.08	RADII	47.4	LT			47			
7501+54.08	7503+94.04	240.0	LT			240			
7503+94.04	RADII	46.8	LT			47			
7504+79.10	RADII	47.4	LT			47			
7504+79.10	7513+14.22	835.1	LT			835			
7513+14.22	RADII	46.8	LT			47			
7514+00.00	RADII	74.8	LT			75			
7499+00.00	7507+48.27	848.3	RT			848			
7507+48.27	RADII	47.3	RT			47			
7508+31.94	RADII	47.0	RT			47			
7508+31.94	7514+00.00	568.1	RT			568			
7514+00.00	7515+41.42	141.4	LT			141			
7515+38.53	RADII	30.8	LT			31			
7516+20.30	RADII	30.5	LT			30			
7516+20.30	7517+72.38	152.1	LT			152			
7517+72.38	RADII	30.0	LT			30			
7518+48.30	RADII	29.1	LT			29			
7518+48.30	7520+73.09	224.8	LT			225			
7514+00.00	7514+84.20	84.2	RT			84			
7514+84.20	RADII	47.1	RT			47			
7515+68.79	RADII	46.9	RT			47			
7515+68.79	7519+81.87	413.1	RT			413			
7519+81.87	RADII	31.5	RT			32			
7520+85.47	RADII	63.1	RT			63			
7520+85.47	7521+86.27	100.8	RT			101			
7519+81.87	SIDE STREET	49.9	RT			50			
4008+73.25	4017+00.00	826.8	LT			827			
4017+00.00	4018+30.00	172.7	LT			173			
4008+73.25	4010+06.13	135.3	RT			135			
4011+02.34	4014+07.00	304.7	RT			305			
4015+35.00	4017+00.00	165.0	RT			165			
4017+00.00	4018+30.00	125.6	RT			126			

48203049				TOTAL	7,896	SQ YD
HOT-MIX ASPHALT SHOULDERS, 13"						
STA.	STA.	AREA SQ FT		SUBTOTALS SQ YD		
S.B. I-55						
82+50.00	97+53.23	17,301		1,922.3		
104+67.07	108+00.00	3,329		369.9		
111+46.80	130+00.00	18,384		2,042.7		
139+80.00	142+80.00	819		91.0		
N.B. I-55						
85+00.00	95+63.58	12,503		1,389.2		
99+33.13	103+42.95	3,815		423.9		
113+00.00	127+00.00	13,923		1,547.0		
137+50.00	140+50.00	988		109.8		

REVISIONS	
NAME	DATE
JB	07/11/08

F.A.I. RTE.	SECTION	COUNTY	TOTAL SHEETS	SHEET NO.
55	*	WILL	608	89
STA.		TO STA.		
FED. ROAD DIST. NO. 1		ILLINOIS	FED. AID PROJECT	
* (26, 26HB-1&114) R-2		CONTRACT NO. 60363		

GENERAL NOTES

1. THE CONTRACTOR SHALL ALWAYS MAINTAIN THREE LANES OF TRAFFIC PER DIRECTION ON FAI RTE 55 WITH THE EXCEPTION OF HOURS AS NOTED IN THE SPECIAL PROVISIONS.
2. THE CONTRACTOR SHALL ALWAYS MAINTAIN TWO WAY TRAFFIC ON ILLINOIS RTE 59, EXCEPT AS NOTED IN THE PLANS.
3. THE CONTRACTOR SHALL ALWAYS MAINTAIN ONE LANE OF TRAFFIC ON THE EXPRESSWAY RAMPS. EXISTING EXPRESSWAY RAMPS SHALL REMAIN OPEN UNTIL COMPLETION OF PROPOSED RAMPS.
4. THE CONTRACTOR SHALL PROVIDE ALL SIGNS, VERTICAL PANELS, TYPE III BARRICADES, DRUMS OR LATEST TYPE II PLASTIC BARRICADES, ALL TEMPORARY CONCRETE BARRIERS AND PROTECTION NECESSARY FOR THE MAINTENANCE OF TRAFFIC PER THE STANDARDS SPECIFIED, THE SPECIFIC APPLICATIONS NOTED IN THE PLANS, AND AS DIRECTED BY THE ENGINEER.
5. THE CONTRACTOR SHALL INSTALL AND MAINTAIN PROPOSED AND TEMPORARY DRAINAGE SYSTEMS AND EROSION CONTROL THROUGHOUT STAGED CONSTRUCTION DURING THE DURATION OF THE PROJECT.
6. THE CONTRACTOR SHALL PROVIDE AND MAINTAIN ACCESS TO ALL PUBLIC AND PRIVATE ENTRANCES.
7. THE CONTRACTOR SHALL COORDINATE THE WORK WITH THE CONTRACTORS ON THE ADJACENT CONTRACT NO. 62895 ALONG I-55 AND CONTRACT NO. 62416 ALONG IL ROUTE 59.
8. THE CONTRACTOR SHALL COORDINATE THE SEIL ROAD CLOSURE (WEST OF THE WEST FRONTAGE ROAD) TO THROUGH TRAFFIC (LOCAL ACCESS MAINTAINED) WITH THE LOCAL POLICE AND FIRE DEPARTMENTS AND THE VILLAGE OF SHOREWOOD.
9. THE CONTRACTOR SHALL NOT CLOSE FAI RTE 55 FOR MORE THAN 15 MINUTES IN ONE DIRECTION FOR ERECTION OF THE BEAMS FOR THE PROPOSED NORTHBOUND IL. RTE 59 EXIT RAMP OVER FAI RTE 55 OR REMOVAL OF THE EXISTING RAMP BRIDGE, ALL IN ACCORDANCE WITH THE RESTRICTIONS CONTAINED IN THE SPECIAL PROVISIONS.
10. THE CONTRACTOR SHALL USE WET REFLECTIVE TEMPORARY TAPE, TYPE III FOR STAGING TRAFFIC ON ALL PERMANENT SURFACES OR EXISTING SURFACES TO REMAIN. THE I-55 PAVEMENT MARKING LANES DURING WINTER STAGE WILL BE AN EXCEPTION, EPOXY PAVEMENT MARKINGS SHALL BE USED IN THIS CASE.
11. ALL TYPE II BARRICADES, DRUMS AND VERTICAL PANELS SHALL BE EQUIPPED WITH MONO-DIRECTIONAL STEADY BURNING LIGHTS.
12. ALL CONSTRUCTION WARNING SIGNS SHALL BE BLACK LEGEND ON ORANGE BACKGROUND.
13. ALL CONSTRUCTION WARNING SIGNS SHALL BE 48" x 48".
14. ALL "ROAD CONSTRUCTION AHEAD" WARNING SIGNS (W 20-1) SHALL BE EQUIPPED WITH HIGH INTENSIVITY FLASHING LIGHTS AND 18" x 18" ORANGE FLAGS
15. VERTICAL PANELS PLACED BEHIND GUARDRAIL SHALL BE BANDED TO THE GUARDRAIL POST. THIS WILL BE INCLUDED IN THE COST OF TRAFFIC CONTROL AND PROTECTION (EXPRESSWAYS).
16. THE RECONSTRUCTION OF IL ROUTE 59 NORTH OF U.S. ROUTE 52 IS TO BE DONE BY OTHERS (CONTRACT 62416). THE CONTRACTOR SHALL COORDINATE MAINTENANCE OF TRAFFIC ALONG IL ROUTE 59 WITH THE CONTRACTOR FOR CONTRACT 62416 TO ENSURE CONTINUITY AND SAFETY FOR TRAFFIC BETWEEN THE TWO CONTRACTS.
17. ALL TEMPORARY CONCRETE BARRIER SHALL BE CONTRACTOR FURNISHED.
18. TEMPORARY PAVEMENT MARKINGS PLACED ON PERMANENT PAVEMENT THAT REQUIRE REMOVAL SHALL NOT BE REMOVED BY GRINDING. A WATER BLASTER WITH VACUUM RECOVERY SHALL BE USED AS DIRECTED BY THE ENGINEER.
19. TREE REMOVALS SHOWN ON THE STAGING PLANS INDICATE REMOVAL IN PRE-STAGE A. THE ACTUAL STAGE OF REMOVAL SHALL BE COMPATIBLE WITH STAGING REQUIREMENTS AND MEET THE ENGINEERS APPROVAL.
20. THE WINTER STAGE PAVEMENT MARKINGS ON I-55 SHALL BE EPOXY AS NOTED. THE INSIDE SHOULDER LINE AND TWO LANE LINES SHALL BE INSTALLED PER THE PERMANENT PAVEMENT MARKING PLANS AS DIRECTED BY THE ENGINEER.
21. THE SPEED LIMIT ALONG IL ROUTE 59 SHALL BE REDUCED TO A CONTINUOUS 35 MPH FROM SEIL ROAD TO US ROUTE 52 DURING CONSTRUCTION STAGING OF IL ROUTE 59 (STAGES 2 THRU 3). ALL CONFLICTING SPEED LIMIT SIGNING SHALL BE COVERED DURING CONSTRUCTION STAGING.
22. THE SIDE STREETS ALONG IL ROUTE 59 SHALL BE RECONSTRUCTED PER THE SPECIAL PROVISION FOR WORK RESTRICTIONS. THE CONTRACTOR SHALL PROVIDE "CONSTRUCTION AHEAD" SIGNS AND DIRECTIONAL ARROWS ALONG SIDE STREETS AS APPLICABLE PER TC-10 WHEN IL ROUTE 59 IS UNDER STAGED CONSTRUCTION. THE CONTRACTOR SHALL PROVIDE AND PLACE STOP SIGNS AND UTILIZE TEMPORARY PAVEMENT MARKING TAPE FOR STOP BARS AND EXTENSION OF CENTERLINES AT SIDE STREETS AS REQUIRED TO MAINTAIN ACCESS DURING CONSTRUCTION.
23. THE CONTRACTOR SHALL UTILIZE WET REFLECTIVE TEMPORARY TAPE, TYPE III AT ALL LOCATIONS WHERE PAVEMENT MARKING TAPE, TYPE III IS SPECIFIED IN THESE CONTRACT PLANS.

SUGGESTED CONSTRUCTION STAGING AND MAINTENANCE OF TRAFFIC

SUGGESTED STAGING SEQUENCE:
 YEAR 1 - PRESTAGE A, PRESTAGE B AND STAGE 1
 YEAR 2 - STAGES 2A & 2B
 YEAR 3 - STAGES 3A, 3B, 4A & 4B

NOTE:
 (E) DENOTES EXISTING ALIGNMENT STATIONING
 (P) DENOTES PROPOSED ALIGNMENT STATIONING

YEAR 3

STAGE 3 (PRE-STAGE 3 WORK ITEMS WHICH MUST BE COMPLETE PRIOR TO START OF STAGE 3A)

IL ROUTE 59, NB AND SB RAMPS, AND SEIL ROAD

1. THE PAVING OF IL59 FROM THE PROPOSED INTERSECTION TO STATION 7481+25 SHALL BE COMPLETED AND OPERATIONAL PRIOR TO START OF STAGE 3A
2. THE PAVING OF THE NB RAMP SHALL BE COMPLETED AND OPERATIONAL PRIOR TO START OF STAGE 3A
3. THE PAVING OF THE SB RAMP SHALL BE COMPLETED AND OPERATIONAL PRIOR TO START OF STAGE 3A
4. THE PAVING OF SEIL ROAD FROM STA 4014+00 TO THE INTERSECTION SHALL BE COMPLETED AND OPERATIONAL PRIOR TO START OF STAGE 3A
5. IN ORDER TO MINIMIZE CLOSURE TIME FOR THE NICOR DRIVEWAY, THE TEMPORARY RUNAROUND PAVEMENT FROM STATION 1011+15.64 TO STATION 1015+67.35 SHALL BE COMPLETED AND OPERATIONAL NO EARLIER THAN 1 WEEK PRIOR TO THE START OF STAGE 3A.

STAGE 3A (15 WORKING DAYS MAXIMUM ALLOWED)

IL ROUTE 59

1. SHIFT IL59 TRAFFIC FROM MANHARD RUNAROUND TO IDOT RUNAROUND ALIGNMENT AT INTERSECTION WITH IL59. REMOVE TEMP SIGNALS.
2. CLOSE EXISTING SB I-55 RAMP.
3. DETOUR IL59 ACCESS TO SB I-55 RAMP TO THE NORTH TO US52, SEE DETOUR PLANS ON SHEET 91.
4. CONSTRUCT PROPOSED NB IL59 LANES "GAP" BETWEEN RAISED IL59 AND EX. IL59 STA. 7481+25 TO STA. 7487+00.

SEIL RD

1. OPEN SEIL ROAD EAST OF STATION 4014+00 FOR EB SEIL ROAD TRAFFIC TO ACCESS NEW SB I-55 RAMP.
2. THE CONTRACTOR SHALL STAGE HIS CONSTRUCTION TO PROVIDE ACCESS AT ALL TIMES TO LOCAL RESIDENTIAL AND COMMERCIAL PROPERTIES ON SEIL ROAD AND THE HEARTLAND DEVELOPMENT.
3. CLOSE NICOR PROPERTY SOUTH DRIVEWAY TEMPORARILY. NORTH DRIVEWAY MUST REMAIN OPEN.

STAGE 3B (15 WORKING DAYS MAXIMUM ALLOWED)

IL ROUTE 59 AND I-55 RAMPS

1. AS SOON AS IL59 "GAP" IS CONSTRUCTED IN STAGE 3A, SHIFT IL59 TRAFFIC ONTO THE NEWLY CONSTRUCTED GAP PAVEMENT, AND THROUGH THE NEWLY CONSTRUCTED PROPOSED SEIL/ IL59 INTERSECTION.
2. OPEN THE PROPOSED NB RAMP AND CLOSE THE EXISTING NB RAMP PER DISTRICT DETAIL TC-8. ALL PROPOSED SIGNAGE MUST BE INSTALLED PRIOR TO THE OPENING OF THE PROPOSED RAMP AND CLOSING OF THE EXISTING RAMP.
3. MAINTAIN 2 WAY TRAFFIC ON THE NB IL59 THRU LANES (STANDARD 701431) AND REMOVE THE EXISTING WEST HALF OF THE IL59 PAVEMENT AND RECONSTRUCT THE SOUTHBOUND IL59 PAVEMENT GAP BETWEEN STA. 7481+25 TO STA. 7487+00.
4. REMOVE TEMPORARY RUNAROUND BETWEEN IL59 AND SEIL ROAD.

SEIL RD

1. SHIFT ALL SEIL TRAFFIC TO NEWLY CONSTRUCTED SOUTH HALF OF SEIL ROAD.
2. CONSTRUCT NORTH HALF OF SEIL ROAD BETWEEN STATION 4009+00 TO 4014+00.
3. THE CONTRACTOR SHALL STAGE HIS CONSTRUCTION TO PROVIDE ACCESS AT ALL TIMES TO LOCAL RESIDENTIAL AND COMMERCIAL PROPERTIES ON SEIL ROAD AND THE HEARTLAND DEVELOPMENT.

STAGE 4A

IL ROUTE 59 & I-55 RAMPS

1. CONSTRUCT THE IL. RTE 59 MEDIANS.
2. REMOVE EXISTING NB AND SB RAMP PAVEMENTS.
3. REMOVE EXISTING NORTHBOUND RAMP BRIDGE AND SUBSTRUCTURE (PIER TO BE REMOVED IN STAGE 4B).
4. CONSTRUCT NB AND SB I-55 OUTSIDE SHOULDERS AS NOTED IN THE PLANS. STAGING - SHIFT 3 LANES OF TRAFFIC IN BOTH DIRECTIONS ON I-55 TOWARD MEDIAN USING DISTRICT ONE STANDAR FOR MULTI LANE WEAVE (TC-09).

EAST FRONTAGE ROAD

1. CONSTRUCT THE PROPOSED EAST FRONTAGE ROAD FULL DEPTH PAVEMENT FROM STATION 6499+84 TO STATION 6529+18 PER STANDARD 701201.
2. PLACE FINAL AGGREGATE SHOULDER.

STAGE 4B

IL ROUTE 59 & I-55 RAMPS

1. REMOVE EXISTING NB RAMP BRIDGE PIER. STAGING - SHIFT 3 LANES OF TRAFFIC IN BOTH DIRECTIONS ON I-55 TOWARD THE OUTSIDE SHOULDER USING DISTRICT ONE STANDARD FOR MULTI LANE WEAVE (TC-09).
2. CONSTRUCT THE RUMBLE STRIPS ON I-55 DURING NIGHT TIME STATIONARY CLOSURES (STANDARD 701401). WORK SHALL NOT BE DONE CONCURRENTLY ON BOTH SIDES OF I-55 IN A SINGLE DIRECTION (NB OR SB).
3. COMPLETE ANY REMAINING PAVEMENT MARKING AND LANDSCAPING ITEMS.



MOTO2 REVISIONS		
NAME	DATE	
JB	07/11/08	

ILLINOIS DEPARTMENT OF TRANSPORTATION
 FAI 55 AT FAP 338 ILLINOIS ROUTE 59
 SECTION: (26, 26HB-1&114) R-2
**MAINTENANCE OF TRAFFIC
 SUGGESTED CONSTR. STAGING
 (2 OF 2) & GENERAL NOTES**
 SCALE: 1" = 50'
 DATE: 03/14/08
 DRAWN BY: JB
 CHECKED BY: ACL
TENG
 TENG & ASSOCIATES, INC.
 ENGINEERS/ARCHITECTS/PLANNERS
 305 N. MICHIGAN AVE. CHICAGO, IL 60610
 TELEPHONE: 312.511.4000

LEAC
 7-14-2008, 9:45:57
 T:\DOCUMENTS\93279\9\9\CIVIL\DRAWING\MOTO2\050.DGN
 1 2 3 4 5 6 7 8 9 10 11 12 13 14 15 16 17 18 19 20 21 22 23 24 25 26 27 28 29 30 31 32 33 34 35 36 37 38 39 40 41 42 43 44 45 46 47 48 49 50 51 52 53 54 55 56 57 58 59 60 61 62

PIPE/CULVERT NO.	DESCRIPTION	DIA. (IN)	LENGTH (FT)	SLOPE (%)	TRENCH BACKFILL (CU YDS.)	SHEET NO.	FROM ST. 1	TO ST. 2
1001	STORM SEW CL A 1 54	54	208	0.40	246.6	201	50	45
1001a	STORM SEW WM REQ 54	54	25	0.40	29.6	201	PP	PP
1002	P CUL CL A 2 12	12	35	1.41	0.0	201	117	35
1003	STORM SEW CL A 2 12	12	77	0.80	12.6	201	33	31
1004	STORM SEW CL A 2 12	12	7	1.09	2.0	202	4	5
1005	STORM SEW CL A 2 72	72	82	0.07	141.0	202	6	5
1006	STORM SEW CL A 2 12	12	4	1.00	1.7	202	7	9
1007	STORM SEW CL A 2 12	12	27	1.10	5.6	202	8	30
1008	STORM SEW CL A 2 15	15	58	0.60	14.2	201	34	41
1009	STORM SEW CL A 2 72	72	126	0.07	247.3	202	9	6
1011	STORM SEW CL A 2 12	12	59	1.00	15.2	202	266	255
1012	STORM SEW CL A 2 12	12	61	0.80	14.3	202	15	7
1014	STORM SEW CL A 2 12	12	5	2.00	1.9	202	20	327
1017	STORM SEW WM REQ 12	12	78	1.00	10.4	202	18	65
1018	STORM SEW CL A 1 15	15	9	1.00	0.0	202	23	22
1019	STORM SEW CL A 2 12	12	71	1.00	21.1	202	65	22
1022	STORM SEW CL A 1 72	72	263	0.04	410.8	202	22	9
1024	STORM SEW CL A 2 15	15	14	0.73	0.0	202	24	324
1025	STORM SEW CL A 1 72	72	111	0.04	132.9	202	25	22
1026	STORM SEW CL A 2 12	12	72	1.00	8.2	201	48	118
1027	STORM SEW WM REQ 12	12	12	1.00	1.8	202	29	342
1028	STORM SEW CL A 2 12	12	58	1.00	13.7	202	27	2
1029	STORM SEW CL A 2 15	15	3	2.87	3.7	202	324	25
1030	STORM SEW CL A 1 90	90	85	0.13	95.2	202	5	30
1031	STORM SEW CL A 1 90	90	61	0.08	23.6	202	30	1
1032	STORM SEW CL A 1 72	72	271	0.07	326.4	201	37	25
1033	STORM SEW CL A 2 12	12	58	1.00	12.7	201	31	261
1034	STORM SEW CL A 2 12	12	92	2.00	16.1	198	113	109
1035	STORM SEW CL A 2 12	12	6	1.00	1.0	201	274	57
1036	STORM SEW CL A 1 60	60	320	0.50	473.8	201	47	37
1037	STORM SEW CL A 2 12	12	5	2.00	1.6	202	2	329
1038	STORM SEW CL A 2 15	15	17	1.00	0.0	201	321	339
1039	STORM SEW CL A 2 12	12	67	0.50	5.5	201	269	116
1040	STORM SEW CL A 2 15	15	5	1.00	1.4	201	55	42
1041	STORM SEW CL A 2 15	15	5	1.00	1.6	201	41	47
1042	STORM SEW CL A 2 12	12	4	2.27	3.4	202	255	3
1043	STORM SEW CL A 1 60	60	107	0.40	160.4	201	45	47
1044	SS RG CL A 1 48	48	131	0.40	104.9	201	42	50
1045	STORM SEW CL A 2 15	15	5	1.00	1.6	201	44	47
1046	STORM SEW CL A 2 12	12	5	1.00	1.9	201	46	45
1047	P CUL CL A 2 12	12	25	0.39	1.1	201	364	365
1050	STORM SEW CL A 2 18	18	5	1.00	1.8	201	272	50
1054	STORM SEW CL A 2 12	12	5	1.00	1.1	201	43	42
1055	STORM SEW CL A 2 15	15	31	1.00	10.9	198	109	106
1056	STORM SEW CL A 2 12	12	82	0.50	11.8	201	38	259
1057	STORM SEW CL A 2 15	15	58	0.60	10.0	201	279	55
1058	SS RG CL A 1 42	42	187	0.50	137.3	201	57	42
1059	STORM SEW CL A 2 12	12	59	0.50	4.7	201	60	274
1060	STORM SEW CL A 2 12	12	70	0.94	9.0	201	59	55
1061	SS RG CL A 2 30	30	93	0.60	43.9	201	63	57
1063	STORM SEW CL A 2 12	12	60	1.00	5.7	201	61	62
1064	STORM SEW CL A 2 15	15	6	1.00	1.3	201	62	63
1065	SS 1 RCEP S34 R22	34 x 22	5	1.00	0.0	200	351	88
1066	STORM SEW WM REQ 12	12	12	1.00	2.2	202	19	65
1067	STORM SEW CL A 2 12	12	69	0.43	5.5	201	66	279
1069	SS RG CL A 2 24	24	4	0.50	1.0	201	70	69
1070	STORM SEW CL A 2 15	15	6	1.07	1.4	201	71	70
1071	SS RG CL A 2 24	24	141	0.60	51.0	200	72	70
1072	SS RG CL A 2 24	24	140	0.60	0.0	200	77	72
1073	SS RG CL A 2 21	21	110	0.80	0.0	200	78	77
1074	SS RG CL A 2 18	18	288	0.60	0.0	200	84	78
1076	STORM SEW CL A 2 18	18	39	0.80	10.8	201	380	272
1077	SS RG CL A 2 27	27	193	0.40	0.0	198	93	104
1079	SS RG CL A 2 24	24	89	0.50	0.0	198	99	93
1080	SS RG CL A 2 21	21	235	1.50	0.0	198	101	99
1081	SS RG CL A 2 18	18	150	2.00	0.0	198	106	101
1082	STORM SEW CL A 2 15	15	59	0.80	10.5	200	74	288
1083	STORM SEW CL A 2 12	12	32	0.60	1.9	200	292	375

PIPE/CULVERT NO.	DESCRIPTION	DIA. (IN)	LENGTH (FT)	SLOPE (%)	TRENCH BACKFILL (CU YDS.)	SHEET NO.	FROM ST. 1	TO ST. 2
1085	STORM SEW CL A 2 15	15	58	0.50	4.5	200	296	75
1086	STORM SEW CL A 2 15	15	84	0.60	9.0	200	286	75
1087	STORM SEW CL A 2 18	18	6	0.80	1.2	200	75	78
1088	STORM SEW CL A 2 18	18	96	0.60	20.9	200	81	82
1089	STORM SEW CL A 2 12	12	80	0.60	11.9	201	259	262
1090	STORM SEW CL A 2 15	15	58	0.50	11.2	200	294	81
1091	STORM SEW CL A 2 12	12	65	0.50	6.9	200	108	294
1092	STORM SEW CL A 2 12	12	4	1.00	0.4	200	89	354
1093	SS RG CL A 2 30	30	6	1.00	2.4	200	283	86
1094	STORM SEW CL A 2 15	15	31	0.40	4.3	198	97	98
1095	STORM SEW CL A 2 15	15	68	0.50	15.0	200	291	92
1096	STORM SEW CL A 2 12	12	58	1.00	5.6	200	91	176
1097	STORM SEW CL A 2 15	15	21	0.50	3.2	198	301	403
1098	STORM SEW CL A 2 15	15	34	0.50	9.0	198	302	93
1099	STORM SEW CL A 2 18	18	58	0.50	13.9	201	262	36
1100	STORM SEW CL A 2 18	18	43	0.40	10.6	198	98	99
1101	STORM SEW CL A 2 15	15	35	1.00	6.7	198	103	102
1102	STORM SEW CL A 1 12	12	44	0.60	3.6	200	290	325
1104	STORM SEW CL A 1 12	12	65	0.60	4.6	200	297	74
1106	STORM SEW CL A 2 18	18	6	1.00	1.8	200	82	84
1107	SS RG CL A 2 18	18	186	2.00	0.0	198	326	106
1108	STORM SEW CL A 2 12	12	72	2.00	12.2	198	306	102
1109	SS RG CL A 2 30	30	14	0.30	0.0	200	86	87
1110	SS 1 RCEP S34 R22	34 x 22	109	0.60	0.0	200	92	174
1111	STORM SEW CL A 2 12	12	13	0.50	0.0	200	85	294
1112	STORM SEW CL A 2 12	12	72	2.00	19.2	198	314	103
1113	STORM SEW CL A 2 15	15	90	26.77	0.0	196	227	115
1115	P CUL CL A 2 15	15	28	1.14	1.0	201	126	361
1116	P CUL CL A 2 12	12	34	0.39	0.8	201	125	360
1117	P CUL CL A 2 12	12	29	0.38	1.5	201	359	124
1118	P CUL CL A 2 12	12	32	0.35	0.5	201	358	122
1119	P CUL CL A 2 12	12	21	0.70	0.8	201	123	357
1120	P CUL CL A 2 12	12	30	0.33	2.1	201	121	120
1121	STORM SEW CL A 2 12	12	12	8.25	1.0	201	356	31
1122	STORM SEW CL A 1 12	12	91	0.50	0.0	201	246	46
1123	STORM SEW CL A 2 12	12	12	1.00	2.1	201	28	2
1125	STORM SEW CL A 1 12	12	46	0.44	0.0	206	136	133
1126	STORM SEW CL A 2 12	12	2	2.00	0.5	202	257	172
1127	STORM SEW CL A 1 15	15	152	0.28	0.0	206	131	130
1128	STORM SEW CL A 1 15	15	105	0.28	0.0	206	130	156
1129	STORM SEW CL A 2 12	12	3	16.14	1.1	202	256	260
1130	STORM SEW CL A 1 15	15	5	0.30	0.2	206	133	131
1131	STORM SEW CL A 1 12	12	36	1.00	2.5	206	145	142
1133	STORM SEW CL A 1 12	12	36	0.70	2.2	206	146	143
1134	STORM SEW CL A 2 12	12	33	13.85	0.0	206	143	140
1135	STORM SEW CL A 2 18	18	5	0.60	1.8	201	51	50
1136	STORM SEW CL A 2 12	12	28	3.64	0.0	206	144	141
1139	STORM SEW CL A 1 12	12	93	3.00	8.1	206	142	315
1140	STORM SEW CL A 2 15	15	33	0.60	10.5	200	148	104
1141	STORM SEW CL A 2 12	12	49	0.80	4.5	200	149	291
1142	P CUL CL A 1 12	12	17	0.41	1.3	206	151	150
1143	P CUL CL A 1 EQRS 18	23 x 14	37	3.07	2.1	206	153	152
1144	P CUL CL A 1 12	12	28	0.39	2.2	206	155	154
1145	SS 1 RCEP S45 R29	45 x 29	269	0.15	0.0	206	156	152
1146	SS 1 RCEP S45 R29	45 x 29	55	0.40	3.7	206	157	156
1149	STORM SEW CL A 1 12	12	36	0.60	1.6	206	160	161
1150	P CUL CL A 1 15	15	53	0.32	3.8	206	163	162
1151	STORM SEW CL A 2 15	15	58	0.60	5.4	200	375	176
1154	STORM SEW CL A 2 15	15	12	0.80	3.4	201	107	170
1155	STORM SEW CL A 2 12	12	57	0.50	4.9	202	253	7
1156	STORM SEW CL A 2 12	12	11	12.36	0.0	200	173	375
1157	STORM SEW CL A 2 12	12	11	8.47	0.0	200	175	291
1158	P CUL CL A 1 12	12	57	0.32	0.0	200	178	177
1159	P CUL CL A 2 24	24	25	0.20	0.0	200	181	179
1160	P CUL CL A 2 24	24	26	0.19	0.0	200	179	180
1161	STORM SEW CL A 2 15	15	6	0.80	1.4	200	325	77
1162	STORM SEW CL A 1 12	12	3	0.60	0.1	206	400	130
1163	STORM SEW CL A 1 12	12	21	0.50	0.0	206	184	398

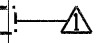

25' OF PIPE 1025 SHALL BE STORM SEWER (WATERMAIN REQUIREMENTS) 72"

LEGEND

PP - PROPOSED PIPE

NOTES:

- REFER TO EROSION CONTROL PLANS FOR REQUIRED INLET AND PIPE PROTECTION.
- FOR OFFSETS, RIM ELEVATION AND DRAINAGE STRUCTURE PLACEMENTS, SEE SHEET 413.
- ALL STORM SEWERS ARE RCP UNLESS OTHERWISE MENTIONED.
- PIPES 1065, 1110, 1261, 1262, 1266 AND 1267 ARE STORM SEWERS WITH RUBBER GASKETS OF SIZE SPECIFIED.

PROPOSED SIGN SCHEDULE

SIGN NO.	ROAD	STATION	OFFSET	SIGN DESCRIPTION	SIGN TYPE/I.D.	PANEL TYPE	PANEL SIZE (SF)	HEIGHT	WIDTH	TELESCOPING STEEL SIGN SUPPORT (FT)	BASE TEL STL SIN SUPP	SHEET NO.	REMARKS
S-248	IL 59 SB	7500+90	LT	OAKWOOD DR	D-3	1	3.00	1.00	3.00	0	0	277	
S-249	IL 59 SB	7504+16	LT	SHOREWOOD LN	D-3	1	3.00	1.00	3.00	0	0	277	
S-250	IL 59 NB	7508+09	RT	SARAH ST	D-3	1	2.50	1.00	2.50	0	0	277	
S-251	IL 59 SB	7513+38	LT	MYERS ST	D-3	1	2.50	1.00	2.50	0	0	277	
S-252	IL 59 NB	7515+46	RT	SCHOOL ST	D-3	1	3.00	1.00	3.00	0	0	277	
S-253	IL 59 SB	7515+63	LT	TROUT ST	D-3	1	2.50	1.00	2.50	0	0	277	
S-254	IL 59 SB	7517+96	LT	BASS ST	D-3	1	2.50	1.00	2.50	0	0	277	
S-255	IL 59 NB	7520+04	RT	CHANNAHON ST	D-3	1	3.00	1.00	3.00	0	0	277	
S-269	NOT USED												
S-270	IL 59 EXIT RAMP	8026+00	RT	CHEVRON	W1-8R	1	7.50	3.00	2.50	0	0	279	
S-271	IL 59 EXIT RAMP	8027+20	RT	CHEVRON	W1-8R	1	7.50	3.00	2.50	0	0	279	
S-272	IL 59 EXIT RAMP	8028+40	LT	CHEVRON	W1-8R	1	7.50	3.00	2.50	0	0	279	
S-273	IL 59 EXIT RAMP	8029+60	LT	CHEVRON	W1-8R	1	7.50	3.00	2.50	0	0	279	
S-274	IL 59 EXIT RAMP	8030+80	LT	CHEVRON	W1-8R	1	7.50	3.00	2.50	0	0	279	
S-275	NICOR NORTH DRIVE	7485+60	LT	LEFT TURN PROHIBITION	R3-2	1	4.00	2.00	2.00	14.00	1	276	
S-276	IL 59 NB	7486+10	RT	LEFT TURN PROHIBITION	R3-2	1	4.00	2.00	2.00	0.00	0	276	

1

I:\SC000270.DGN ... \TTB00RINDGN... \SC000270.DGN
 7-14-2008 8:20:51 I:\DOCUMENT\91327900\CIVIL\DRN\SGN007.K.DGN
 L 2 3 4 5 6 7 8 9 10 11 12 13 14 15 16 17 18 19 20 21 22 23 24 25 26 27 28 29 30 31 32 33 34 35 36 37 38 39 40 41 42 43 44 45 46 47 48 49 50 51 52 53 54 55 56 57 58 59 60 61 62 63
 LEEAC

REVISIONS	
NAME	DATE
JB	07/11/08

ILLINOIS DEPARTMENT OF TRANSPORTATION
 FAI 55 AT FAP 338 ILLINOIS ROUTE 59
 SECTION: (26, 26HB-1&114) R-2

SIGN INVENTORY 6

SCALE: _____ DRAWN BY: JB
 DATE: 03/14/08 CHECKED BY: ACL

TENG
TENG & ASSOCIATES, INC.
 ENGINEERS/ARCHITECTS/PLANNERS
 300 N. MICHIGAN AVE. CHICAGO, IL 60610
 TELEPHONE: 312.557.0000

F.A.I. RTE.	SECTION	COUNTY	TOTAL SHEETS	SHEET NO.
55		WILL	608	415
STA.		TO STA.		
FED. ROAD DIST. NO. 1		ILLINOIS FED. AID PROJECT		
* (26, 26HB-1&114) R-2		CONTRACT NO. 60363		

CONSTRUCTION SEQUENCE

- CUT THE EXISTING END OF THE PIPE SO AS TO PRESENT A FLUSH BUTT JOINT. BRUSH AND CLEAN ALL PIPES.
- BUTT THE PIPES TOGETHER LEAVING A MINIMUM OF 12" X 6" DEEP EXCAVATION UNDER AND AROUND EACH PIPE END.
- APPLY THE MASTIC JOINT SEALANT TO THE FIRST 6" OF EACH PIPE.
- CUT A PIECE OF SHEET METAL GAGE NO. 19 (.0418") X 18" WIDE BY THE OUTSIDE CIRCUMFERENCE OF THE PIPE PLUS MINIMUM 3" LONG.
- WRAP THE SHEET METAL AROUND THE PIPES, 9" ON EACH SIDE OF THE JOINT, STARTING AT THE TOP OF THE PIPE.
- LAP THE SHEET METAL AT LEAST 3" AT THE TOP OF THE PIPE AND PLACE THE MASTIC JOINT SEALANT BETWEEN THE LAP.
- PLACE TWO OR MORE METAL BANDS AROUND THE SHEET METAL AND TIGHTEN TO CAUSE THE SHEET METAL TO CONFORM, AS CLOSELY AS POSSIBLE, TO THE OUTSIDE CIRCUMFERENCE OF THE PIPE.
- WIPE OFF ANY EXCESS MASTIC JOINT SEALANT THAT OOOZES OUT FROM BETWEEN THE SHEET METAL AND THE PIPES.
- PLACE SI CONCRETE AROUND THE JOINT INCLUDING COMPLETELY FILLING THE EXCAVATION UNDER EACH PIPE END.

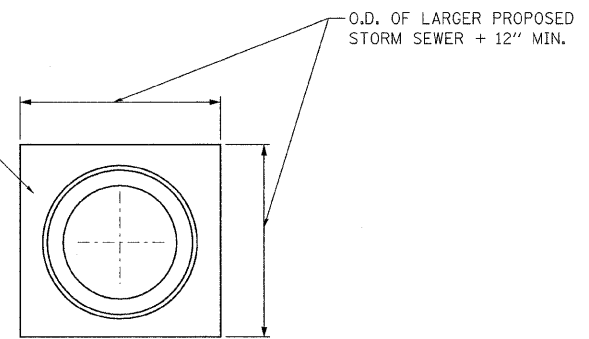
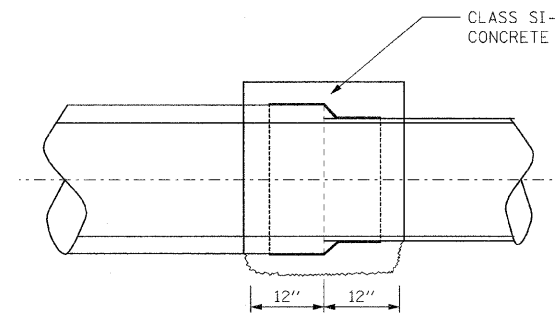
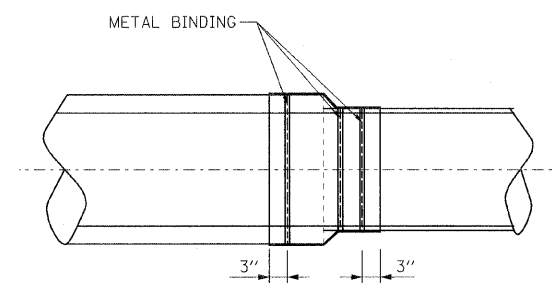
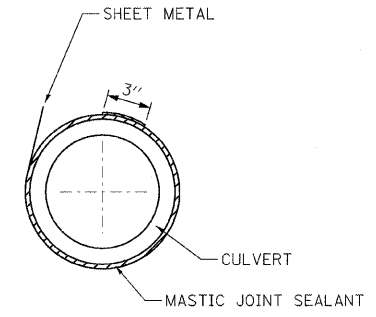
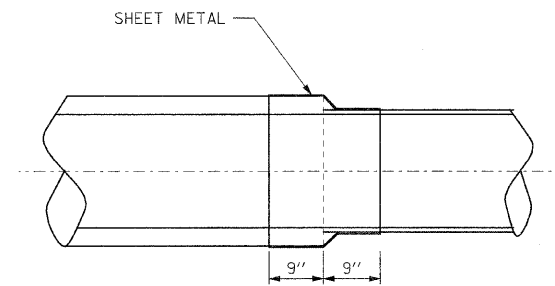
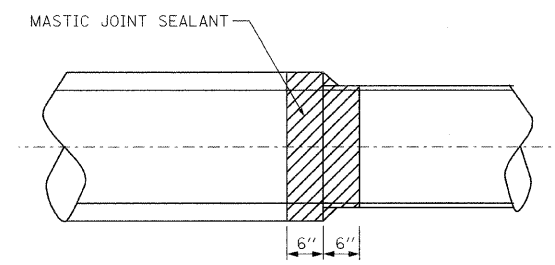
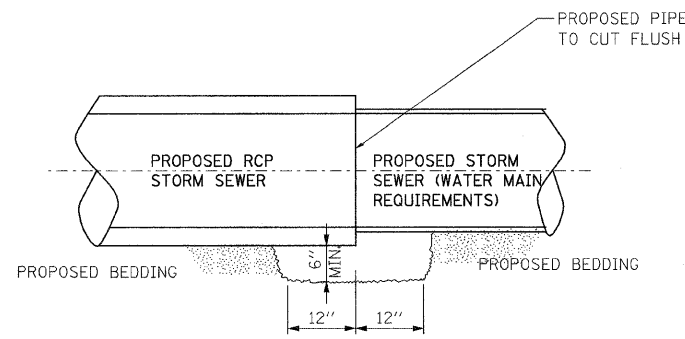

CLASS SI CONCRETE COLLAR

GENERAL NOTES

- CARE MUST BE TAKEN TO PREVENT DEBRIS FROM ENTERING THE SEWER. ALL DEBRIS WHICH ENTERS THE SEWER MUST BE REMOVED. THE SEWER MUST BE LEFT CLEAN AND UNOBSTRUCTED UPON COMPLETION OF THE CONTRACT.
- CONCRETE COLLAR FOR CONNECTING A PROPOSED STORM SEWER TO PROPOSED STORM SEWER (WATER MAIN REQUIREMENTS) WILL NOT BE PAID FOR SEPARATELY BUT SHALL BE INCLUDED IN THE COST OF THE PROPOSED STORM SEWER (WATER MAIN REQUIREMENTS).

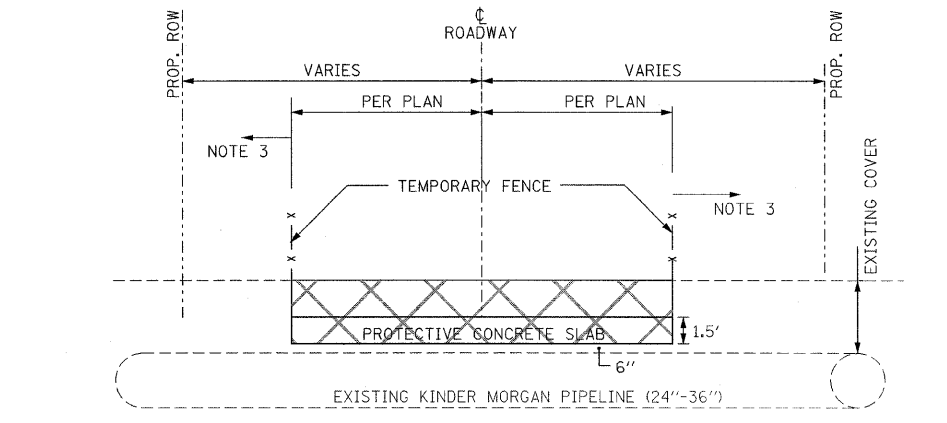

PROPOSED ROADWAY CORRIDOR KINDER MORGAN PROTECTIVE CONCRETE SLAB PLACEMENT TYPICAL

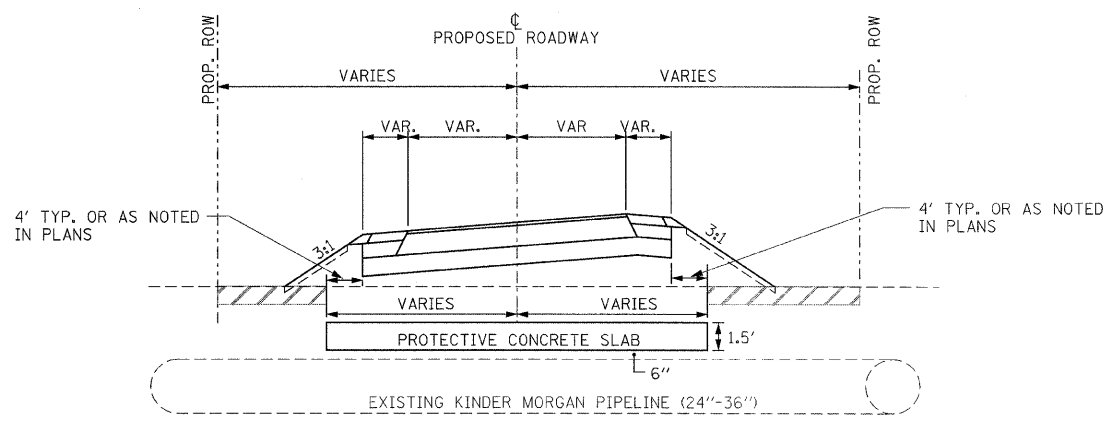
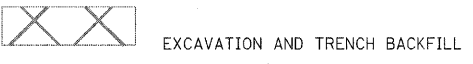

PROPOSED ROADWAY CORRIDOR FINAL CONDITION TYPICAL

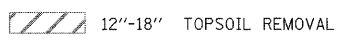

NOTES:

- PROTECTIVE SLAB FOR THE 6 EXISTING KINDER MORGAN PIPELINE SHALL BE CONSTRUCTED AT THE LOCATIONS AS NOTED IN THE PLANS AND PER KINDER MORGAN STANDARD DETAIL STD-32-D3. CONSTRUCTION SHALL ADHERE TO THE NGPL GUIDELINES DOCUMENT. NOTE THAT THE OPTIONAL BACKFILL WITH CEMENT STABILIZED SAND IS NOT REQUIRED FOR THIS APPLICATION. TRENCH BACKFILL SHALL BE USED TO BACKFILL OVER THE PROPOSED PROTECTIVE SLAB UP TO THE EXISTING GROUND ELEVATION. AN ALTERNATE DETAIL 32-D2 CAN BE UTILIZED WITH THE APPROVAL OF KINDER MORGAN.
- HEAVY EQUIPMENT WILL NOT BE ALLOWED TO OPERATE DIRECTLY OVER KM PIPELINES EXCEPT AT AREAS WITH PROTECTIVE CONCRETE SLABS IN PLACE, OR AT THE DISCRETION OF THE KM REPRESENTATIVE.
- THE AREAS WITHIN THE EXISTING ROW WITHOUT PROTECTIVE CONCRETE SLAB SHALL BE STAKED AND FENCED OFF DURING CONSTRUCTION SO NO CONSTRUCTION VEHICLES OR MACHINERY CAN DRIVE OR OPERATE IN THESE AREAS WITHOUT THE PERMISSION AND/OR SUPERVISION OF A KM REPRESENTATIVE. SOIL COMPACTION OVER UNPROTECTED KM PIPELINES IS ACCEPTABLE, HOWEVER, THE EQUIPMENT UTILIZED FOR THIS WORK MUST BE SUITABLE FOR WORK OVER UNPROTECTED PIPELINES. SUCH COMPACTION EQUIPMENT WILL BE SUBJECT TO KINDER MORGAN APPROVAL. SHEEPSFOOT OR OTHER UNAPPROVED VIBRATORY DEVICES WILL NOT BE ALLOWED OVER UNPROTECTED KM PIPELINES. A KM REPRESENTATIVE WILL BE ON SITE FOR COORDINATION.
- IF TOPSOIL IS DISTURBED ABOVE EXISTING KM PIPELINES BEFORE CONCRETE SLABS ARE CONSTRUCTED, APPROPRIATE CRANE MATS MUST BE IN PLACE AT THE SATISFACTION OF THE KM REPRESENTATIVE BEFORE CONSTRUCTION VEHICLES MAY DRIVE OVER THOSE AREAS.
- POWER EQUIPMENT UTILIZED FOR EXCAVATION WILL NOT BE ALLOWED WITHIN 18" OF EXISTING PIPELINES.
- THE CONTRACTOR SHALL FOLLOW THE "GUIDELINES FOR DESIGN AND CONSTRUCTION NEAR KINDER MORGAN OPERATED FACILITIES" AND "PROTECTIVE SLAB FOR EXISTING PIPELINES" STD-32-D3 IN THE SPECIAL PROVISIONS.

REVISIONS	
NAME	DATE
JB - ENTIRE SHEET	07/11/08

ILLINOIS DEPARTMENT OF TRANSPORTATION
 FAI 55 AT FAP 338 ILLINOIS ROUTE 59
 SECTION: (26, 26HB-1&114) R-2

**DRAINAGE DETAILS VI
 KINDER MORGAN DETAILS
 AND CONCRETE COLLAR**

SCALE: N.T.S. DRAWN BY: JB
 DATE: 03/14/08 CHECKED BY: ACL

TENG
 TENG & ASSOCIATES, INC.
 PROFESSIONAL ENGINEERS
 305 N. MICHIGAN AVE. CHICAGO, IL 60610
 TELEPHONE: 312.666.6000

ATT:BOORADON, ... \TSC002\JDDG
 7-14-2008, 8:20:46
 I 2 3 4 5 6 7 8 9 10 11 12 13 14 15 16 17 18 19 20 21 22 23 24 25 26 27 28 29 30 31 32 33 34 35 36 37 38 39 40 41 42 43 44 45 46 47 48 49 50 51 52 53 54 55 56 57 58 59 60 61 62
 LEAC
 T:\DOCUMENTS\1832790\CIVIL\DKM\DRD008\7P.DGN