

F.A.P. RTE.	SECTION	COUNTY	TOTAL SHEETS	SHEET NO.
346	*	LAKE	469	47
STA.	TO STA.		FED. ROAD DIST. NO. D-91-404-99	ILLINOIS
			FED. AID PROJEC	CONTRACT * 608
			* 125X-HB-(1&2) R-1	

PLAN	DATE
BY	
REVISIONS	
NO.	

PROFILE	DATE
BY	
REVISIONS	
NO.	

MATCHLINE IL RTE 132 STA. 11+50

MATCHLINE IL RTE 132 STA. 23+50

MATCHLINE IL RTE 132 STA. 23+50

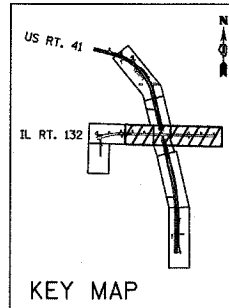
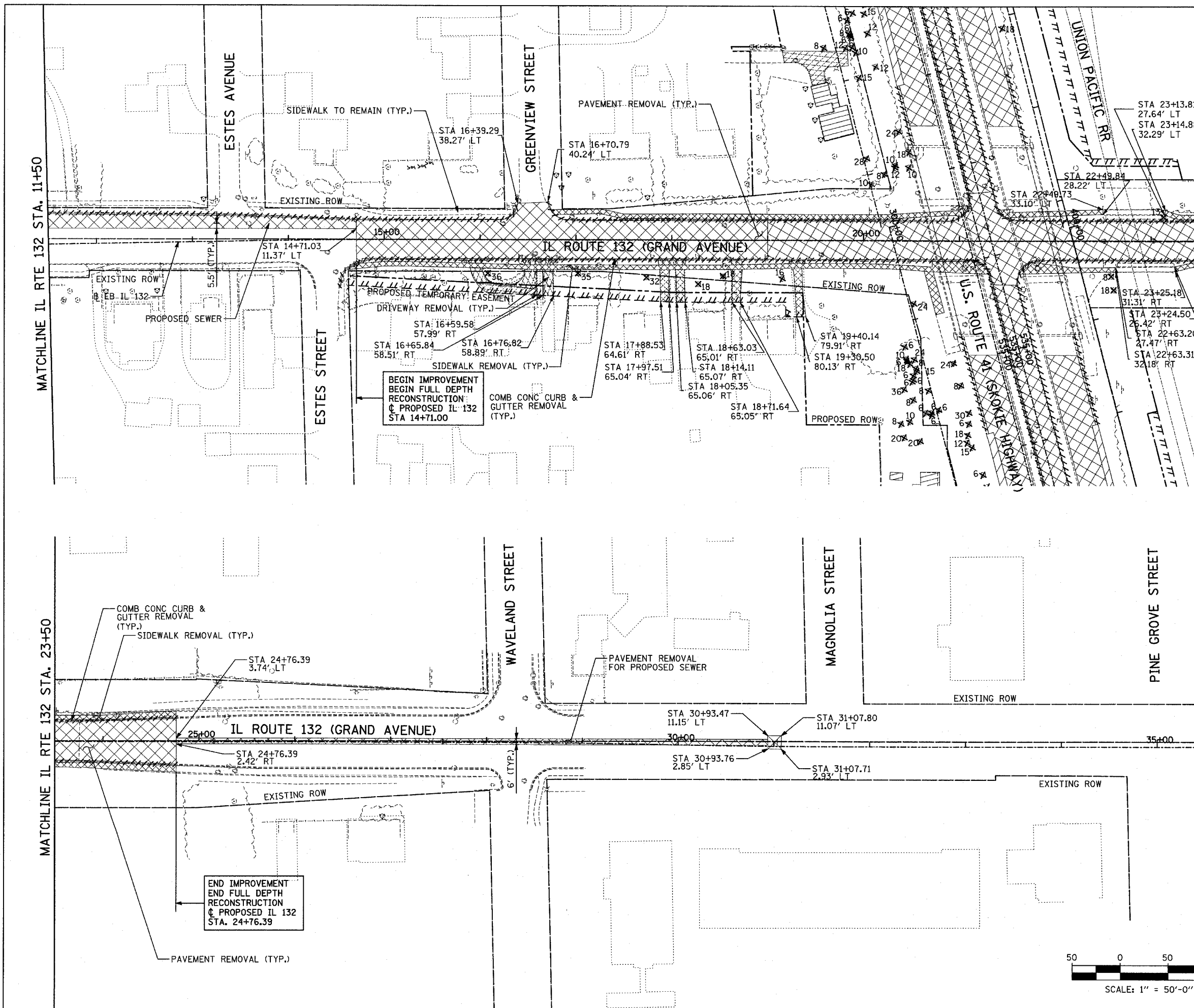

- LEGEND:**
- PAVEMENT REMOVAL
 - PAVED SHOULDER REMOVAL
 - SIDEWALK REMOVAL
 - HOT-MIX ASPHALT SURFACE REMOVAL
 - DRIVEWAY REMOVAL
 - COMB CONC CURB & GUTTER REMOVAL
 - CHAIN LINK FENCE REMOVAL
 - CONCRETE BARRIER/GUARDRAIL REMOVAL
 - TREE REMOVAL (UNITS)
 - BUILDING REMOVAL
 - CONCRETE ACCENT PAVER, REMOVE AND STORE

END IMPROVEMENT
END FULL DEPTH
RECONSTRUCTION
@ PROPOSED IL 132
STA. 24+76.39

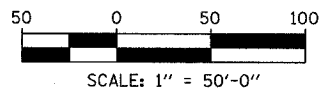

REVISIONS	
NAME	DATE

ILLINOIS DEPARTMENT OF TRANSPORTATION
U.S. 41 (SKOKIE HIGHWAY)
AT IL ROUTE 132
EXISTING AND REMOVAL PLAN
SHEET 4 OF 4
IL 132 - STA. 11+50 TO STA. 24+76.39
SCALE: 1"=50'
DRAWN BY:
DATE: MAY 12, 2008
CHECKED BY: