

| | | | | |
|---------------------------------|---------|--------|---------------------|------------|
| F.A.P. RTE. | SECTION | COUNTY | TOTAL SHEETS | SHEET NO. |
| 346 | . | LAKE | 469 | 94 |
| STA. | TO STA. | | FED. AID PROJ. | CONTRACT # |
| | | | ILLINOIS | 60 |
| FED. ROAD DIST. NO. D-91-404-99 | | | • 125X-HB-(1&2) R-1 | |

LEGEND

- PERIMETER EROSION BARRIER
- ROADWAY DITCH FLOW ARROW
- TEMPORARY DITCH CHECKS
- EROSION CONTROL BLANKET
- TEMPORARY EROSION CONTROL SEEDING
- INLET AND PIPE PROTECTION
- INLET FILTERS
- RIP RAP
- AGGREGATE FOR TEMPORARY ACCESS
- EXISTING WETLAND
- IMPACTED WETLAND

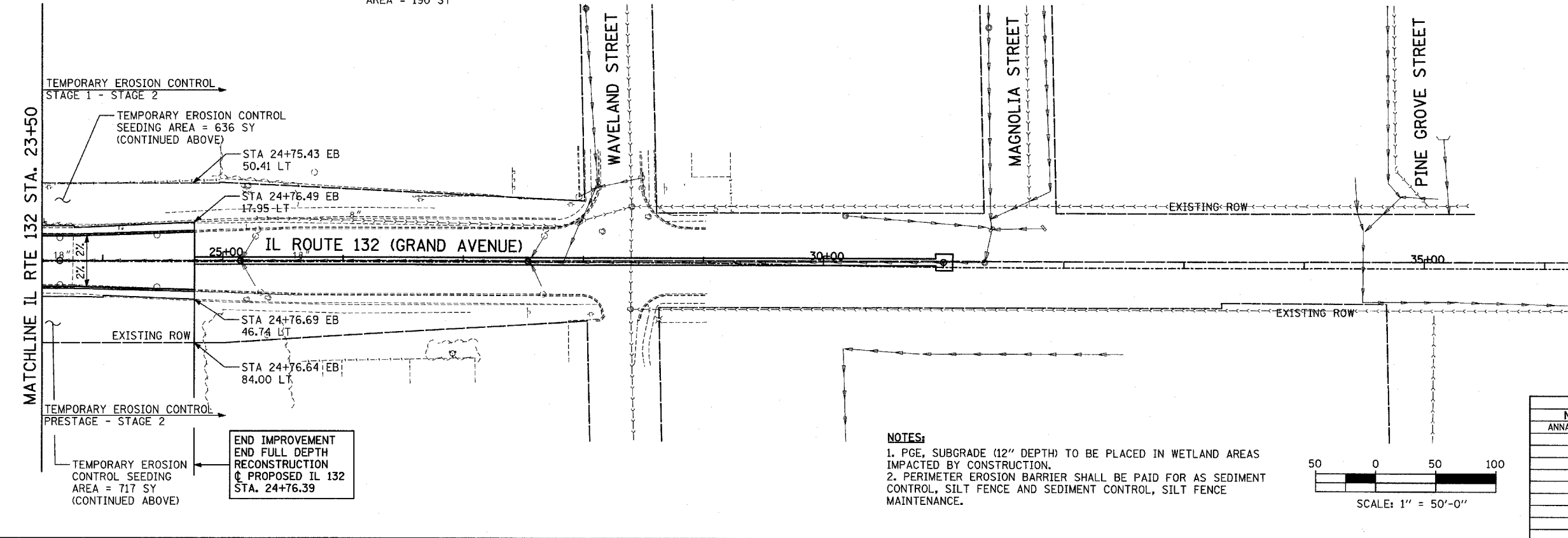
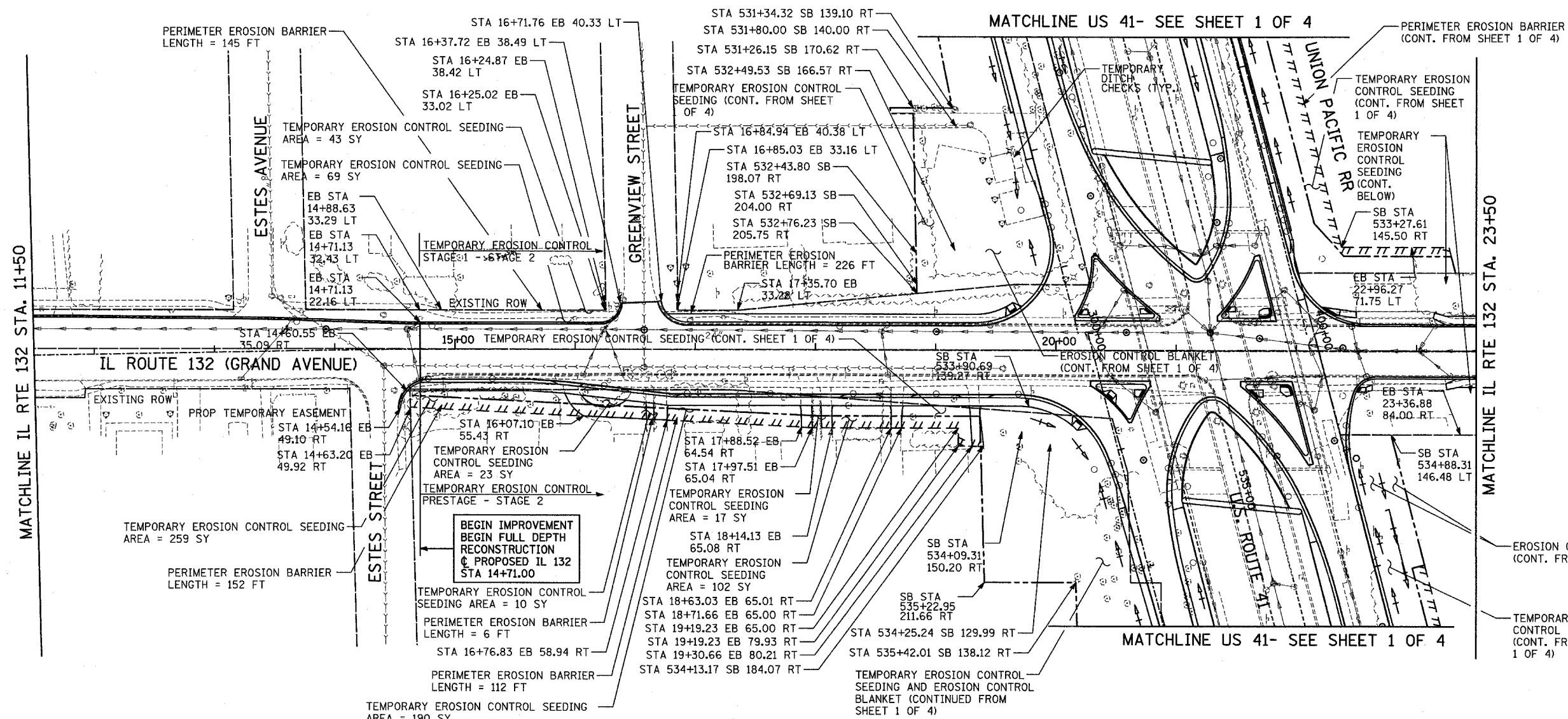
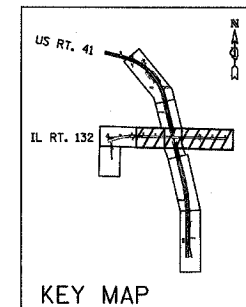

PLAN

| | |
|-------------------|--|
| DATE | |
| BY | |
| REVIEWED | |
| PLOTTED | |
| ALIGNMENT CHECKED | |
| NOTE BOOK | |
| NO. | |
| FILE NAME | |

PROFILE

| | |
|---------------------|--|
| DATE | |
| BY | |
| REVIEWED | |
| PLOTTED | |
| GRADES CHECKED | |
| NOTE BOOK | |
| NO. | |
| STRUCTURE NOTATIONS | |

NOTES:
 1. PGE, SUBGRADE (12" DEPTH) TO BE PLACED IN WETLAND AREAS IMPACTED BY CONSTRUCTION.
 2. PERIMETER EROSION BARRIER SHALL BE PAID FOR AS SEDIMENT CONTROL, SILT FENCE AND SEDIMENT CONTROL, SILT FENCE MAINTENANCE.

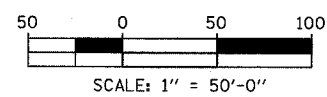

REVISIONS

| NAME | DATE |
|-------------|---------|
| ANNA ZYSMAN | 6-17-08 |
| | |
| | |
| | |
| | |

ILLINOIS DEPARTMENT OF TRANSPORTATION
 U.S. 41 (SKOKIE HIGHWAY)
 AT IL ROUTE 132

EROSION CONTROL PLAN
 SHEET 4 OF 4
 IL 132 - STA. 11+50 TO STA. 24+76.39
 SCALE: 1"=50'
 DATE: MAY 12, 2008
 DRAWN BY:
 CHECKED BY: