

| F.A.P. RTE. | SECTION | COUNTY | TOTAL SHEETS | SHEET NO. |
|--------------|---------|----------|----------------|---------------------|
| 346 | | LAKE | 469 | 120 |
| STA. TO STA. | | ILLINOIS | | FED. AID PROJ. NO. |
| | | | | * 125X-HB-(1&2) R-1 |
| | | | CONTRACT # 608 | |

| | |
|------|----|
| DATE | BY |
| | |
| DATE | BY |
| | |
| DATE | BY |
| | |
| DATE | BY |
| | |

| | |
|------|----|
| DATE | BY |
| | |
| DATE | BY |
| | |
| DATE | BY |
| | |
| DATE | BY |
| | |

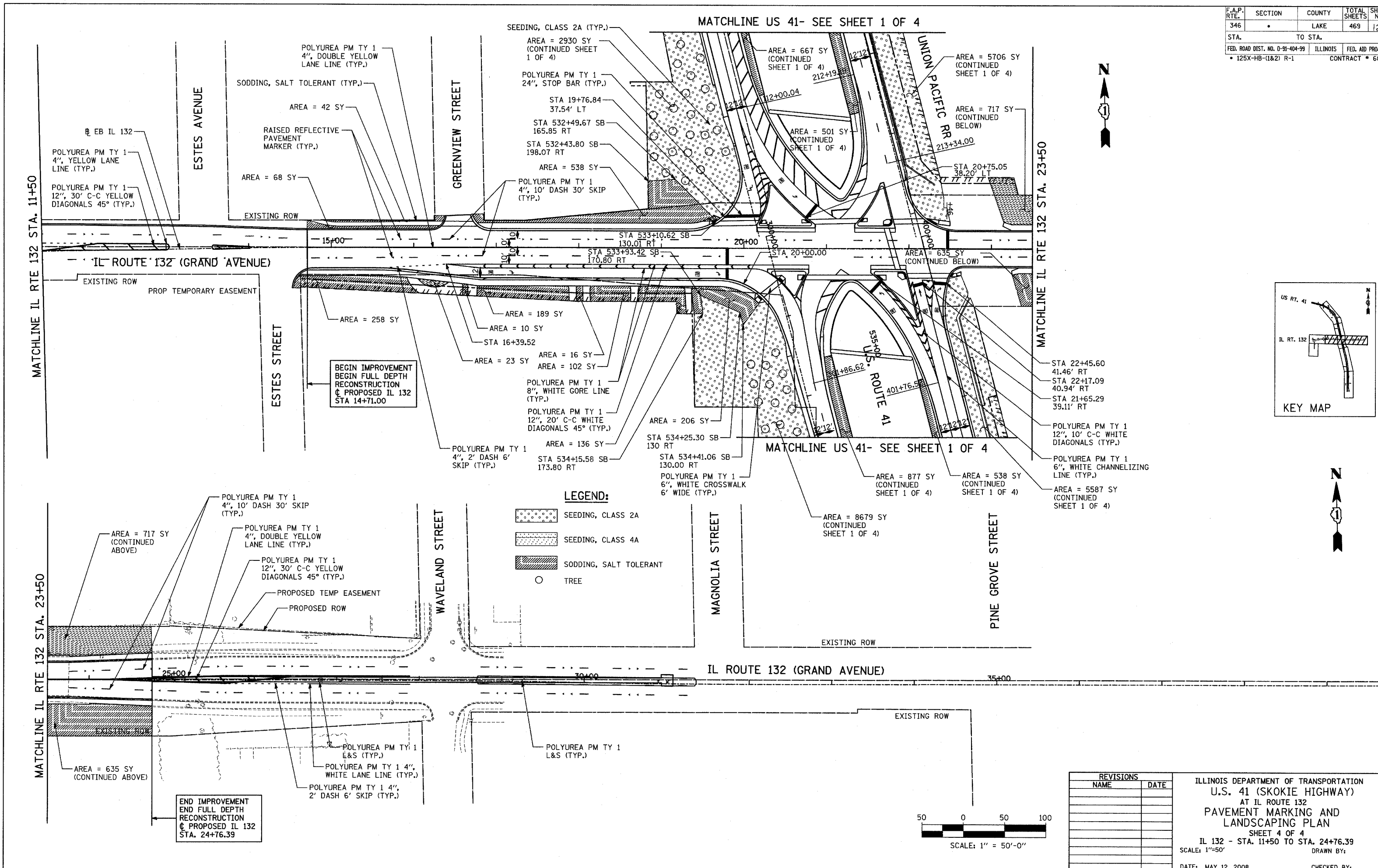

BEGIN IMPROVEMENT
BEGIN FULL DEPTH
RECONSTRUCTION
@ PROPOSED IL 132
STA 14+71.00

END IMPROVEMENT
END FULL DEPTH
RECONSTRUCTION
@ PROPOSED IL 132
STA. 24+76.39

LEGEND:

- SEEDING, CLASS 2A
- SEEDING, CLASS 4A
- SODDING, SALT TOLERANT
- TREE

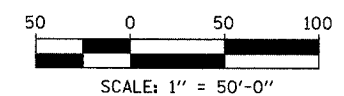

| REVISIONS | |
|-----------|------|
| NAME | DATE |
| | |
| | |
| | |
| | |
| | |
| | |

ILLINOIS DEPARTMENT OF TRANSPORTATION
U.S. 41 (SKOKIE HIGHWAY)
AT IL ROUTE 132
PAVEMENT MARKING AND
LANDSCAPING PLAN
SHEET 4 OF 4
IL 132 - STA. 11+50 TO STA. 24+76.39
SCALE: 1"=50'
DATE: MAY 12, 2008
DRAWN BY:
CHECKED BY:

