

F.A.P. RTE.	SECTION	COUNTY	TOTAL SHEETS	SHEET NO.
346	.	LAKE	469	126
STA. 23+50		TO STA. 39+00		
FED. ROAD DIST. NO. D-91-404-99		ILLINOIS	FED. AID PROJ. NO.	
• 125X-HB-(1&2) R-1		CONTRACT # 608		

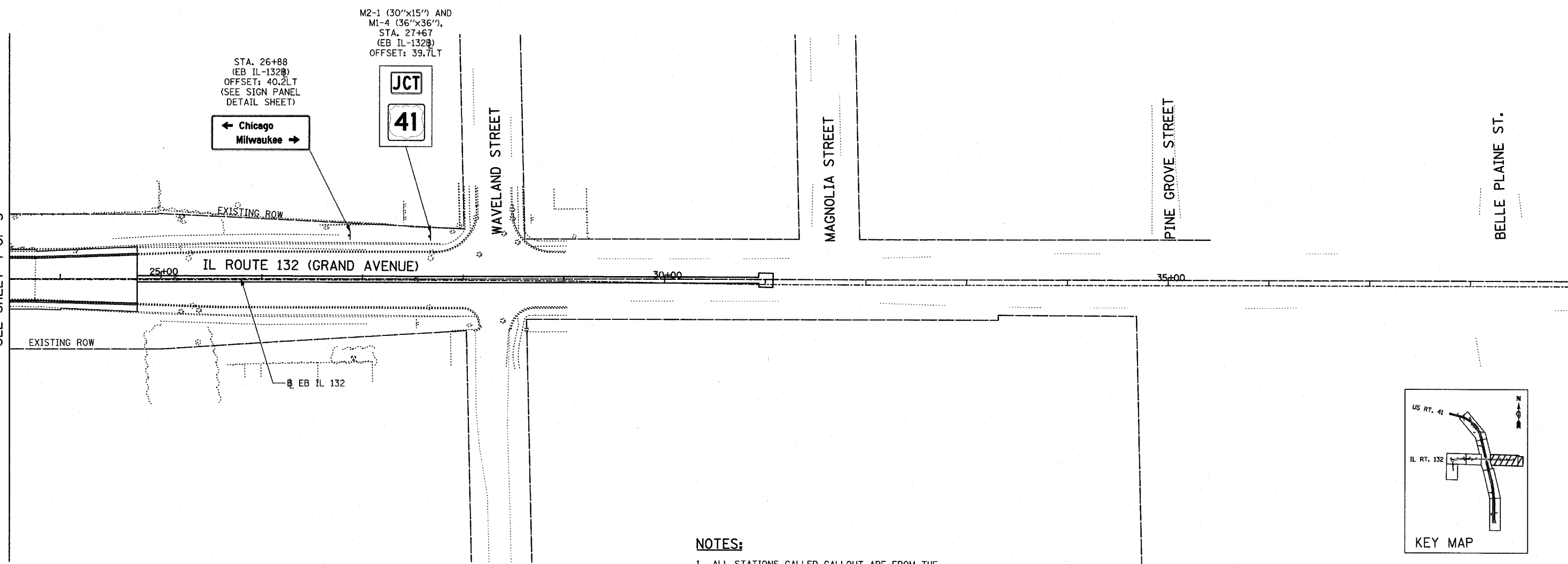

MATCHLINE IL RTE 132 - STA. 23+50
SEE SHEET 4 OF 5



NOTES:

1. ALL STATIONS CALLED CALLOUT ARE FROM THE U.S. 41 CENTERLINE UNLESS OTHERWISE NOTED.
2. ALL OFFSETS ARE TO THE SIGN PANEL EDGE UNLESS OTHERWISE NOTED.
3. ALL SIGNS SHALL BE GROUND MOUNTED UNLESS OTHERWISE NOTED.
4. FOR ALL STANDARD SIGNS, SEE THE SIGNING LEGEND FOR SIGN DIMENSIONS.
5. FOR ALL GUIDE SIGNS, SEE SIGN PANEL DETAILS FOR SIGN DIMENSIONS.
6. FOR OVERHEAD SIGNS, SEE CANTILEVER SIGN STRUCTURE SHEETS FOR STRUCTURE DIMENSIONS.
7. BOXES DENOTE THAT THE SIGN PANELS DEPICTED WILL BE ATTACHED TO THE SAME POST STRUCTURE.

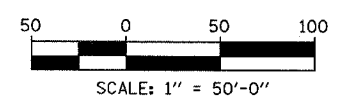
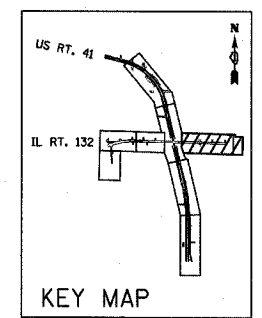

PLAN	SURVEYED	DATE
	PLOTTED	
	BY	
	NOTE BOOK	
	NO.	
	RT. OF WAY CHECKED	
	CADD FILE NAME	

PROFILE	SURVEYED	DATE
	PLOTTED	
	BY	
	NOTE BOOK	
	NO.	
	STRUCTURE NOTATIONS	
	CHKD	

REVISIONS	
NAME	DATE

ILLINOIS DEPARTMENT OF TRANSPORTATION
 U.S. 41 (SKOKIE HIGHWAY)
 AT IL ROUTE 132
PROPOSED SIGNING PLAN
 SHEET 5 OF 5
 IL 132 - STA. 23+50 TO STA. 39+00
 SCALE: 1"=50' DRAWN BY: JDF
 DATE: MAY 12, 2008 CHECKED BY: AB