

F.A.P. RTE.	SECTION	COUNTY	TOTAL SHEETS	SHEET NO.
120		LAKE	469	160A
STA.	TO STA.			
FED. ROAD DIST. NO. D-91-404-99		ILLINOIS	FED. AID PROJECT	
• 125X-HB-(1&2) R-1				

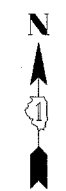
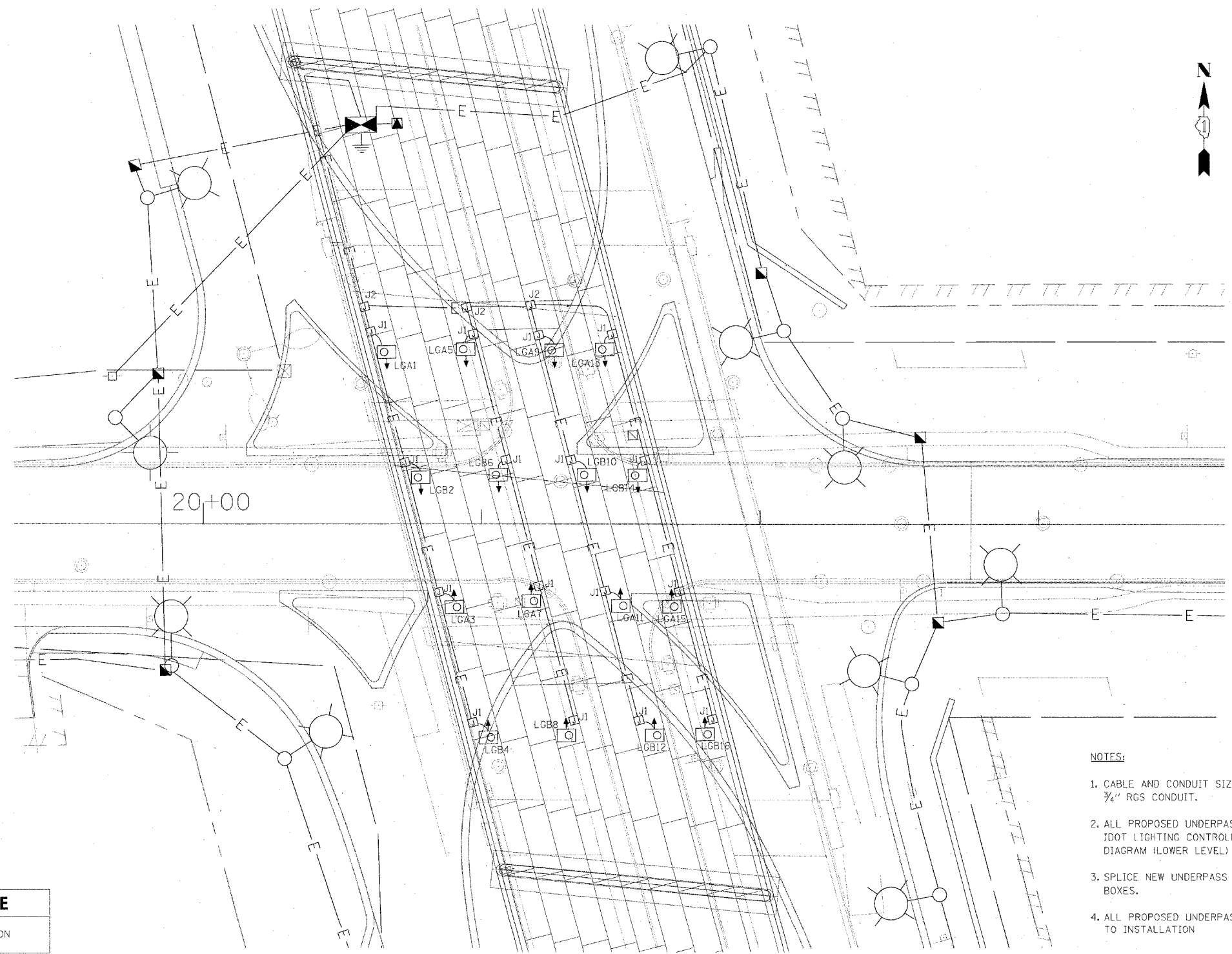

NOTES:

1. CABLE AND CONDUIT SIZES SHALL BE SPECIFIED AS 3 1-1/2" #10, 1-1/2" #10 GND IN 3/4" RGS CONDUIT.
2. ALL PROPOSED UNDERPASS LUMINAIRES SHOWN ON THE DRAWING SHALL BE FED FROM IDOT LIGHTING CONTROLLER "LC". SEE SHEET LIGHTING CONTROLLER "LC" WIRING DIAGRAM (LOWER LEVEL) FOR SINGLE-LINE DIAGRAM.
3. SPLICE NEW UNDERPASS LIGHTING CIRCUITS TO THE CABLES LOCATED IN JUNCTION BOXES.
4. ALL PROPOSED UNDERPASS LUMINAIRE LOCATIONS SHALL BE APPROVED BY DOT PRIOR TO INSTALLATION.

JUNCTION BOX SCHEDULE		
LABEL	SIZE	DESCRIPTION
J1	6"x6"x4"	STAINLESS STEEL, ATTACHED TO STRUCTURE, FEEDS INDIVIDUAL UNDERPASS LUMINAIRES
J2	10"x8"x6"	STAINLESS STEEL, ATTACHED TO STRUCTURE, FEEDS JUNCTION BOXES



REVISIONS	
NAME	DATE

ILLINOIS DEPARTMENT OF TRANSPORTATION
 U.S. 41 (SKOKIE HIGHWAY)
 AT IL ROUTE 132

PROPOSED UNDERPASS
 LIGHTING PLAN

SCALE: 1"=20'-0"
 DATE: 05/07/08

DRAWN BY: JRH
 CHECKED BY: DEM

PLAN	DATE
BY	
CHECKED	
DATE	
NO. OF W.A. CHECKED	
DATE	
BY	
DATE	

PROFILE	DATE
BY	
CHECKED	
DATE	
NO. OF W.A. CHECKED	
DATE	
BY	
DATE	

PLOT DATE = 5/14/2008
 FILE NAME = BNTY_LIN\34295 - US 41 at IL 132\CADD\wp4\undrpass.ltg.plt