

F.A.P. RTE.	SECTION	COUNTY	TOTAL SHEETS	SHEET NO.
120	*	LAKE	469	108
STA.		TO STA.		
FED. ROAD DIST. NO. D-91-404-99		ILLINOIS	FED. AID PROJECT	
• 125X-HB-(1&2) R-1				



PLAN	BY	DATE
REVISIONS		
ALIGNMENT CHECKED		
NOTE BOOK		
NO.		

PROFILE	BY	DATE
GRADES CHECKED		
NOTE BOOK		
NO.		

PLOT DATE = 5/14/2008
 FILE NAME = J:\17\LA\4296 - US 41 at IL 132\CADD\temp\TEMPLOT.dwg

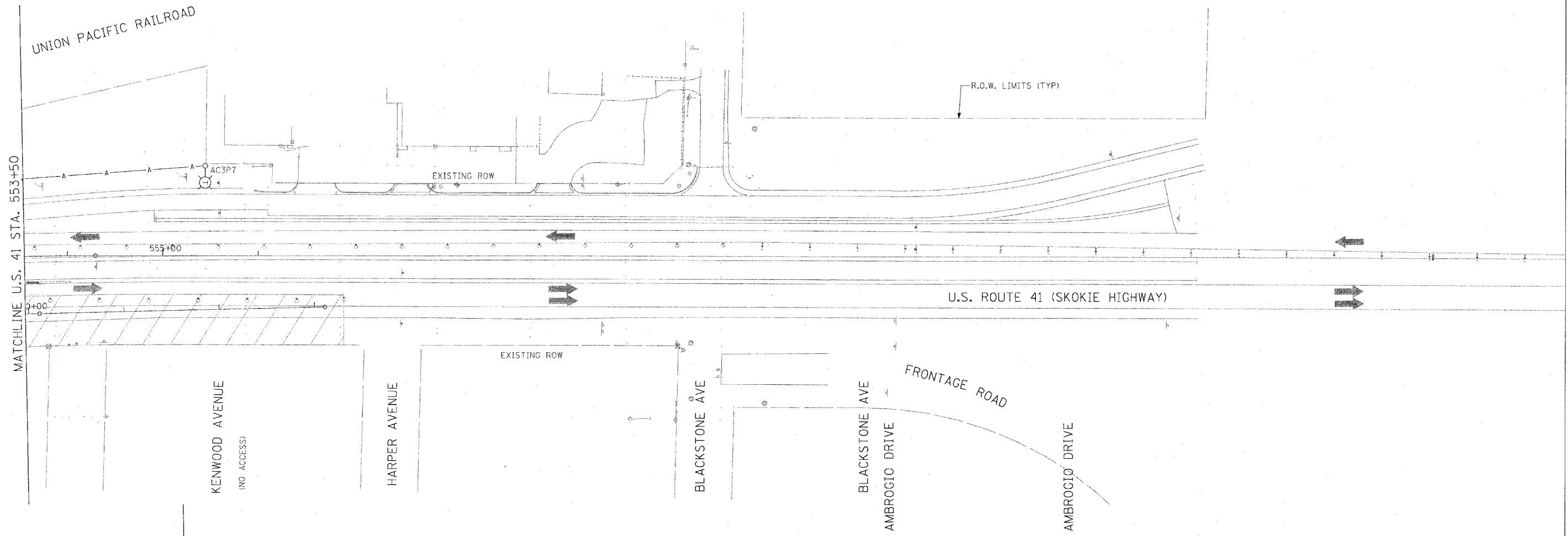

REVISIONS	
NAME	DATE

ILLINOIS DEPARTMENT OF TRANSPORTATION
 U.S. 41 (SKOKIE HIGHWAY)
 AT IL ROUTE 132
 TEMPORARY ROADWAY LIGHTING PLAN
 SHEET 4 OF 4
 US 41 - STA. 553+50 TO EOP
 SCALE: 1"=50'-0"
 DATE: 05/07/08
 DRAWN BY: FO
 CHECKED BY: DEM