

STATE OF ILLINOIS
DEPARTMENT OF TRANSPORTATION

ROUTE NO.	SECTION	COUNTY	TOTAL SHEETS	SHEET NO.	SHEET NO. - S-47 S-66 SHEETS
346	*	LAKE	469	210	
FED. ROAD DIST. NO.	ILLINOIS	FED. AID PROJECT-	CONTRACT # 60826		
* 125X-HB-(1&2) R-1					

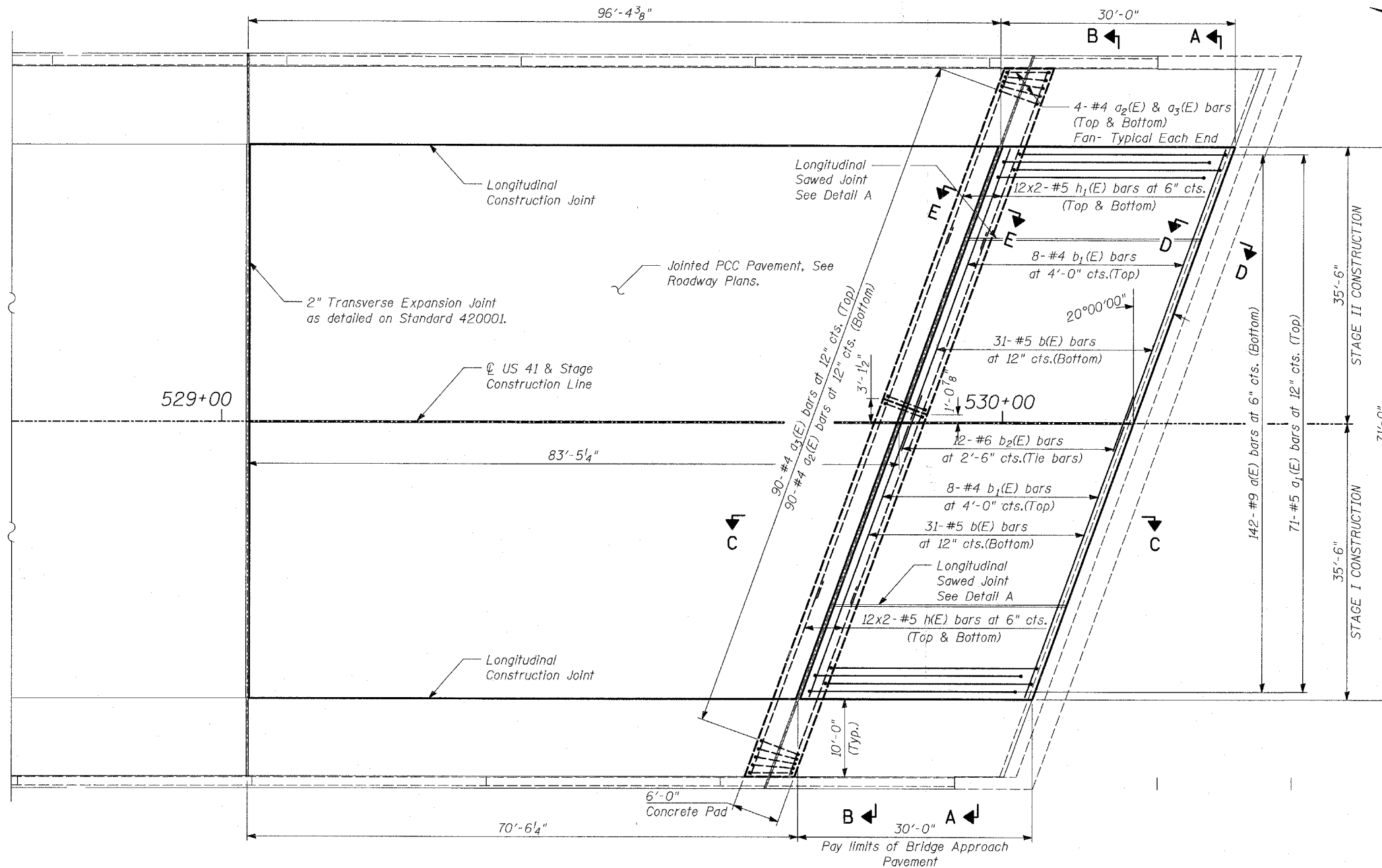

PLAN

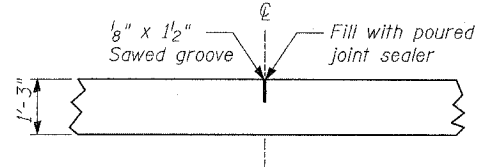

DETAIL A

(Reinforcement Not Shown)

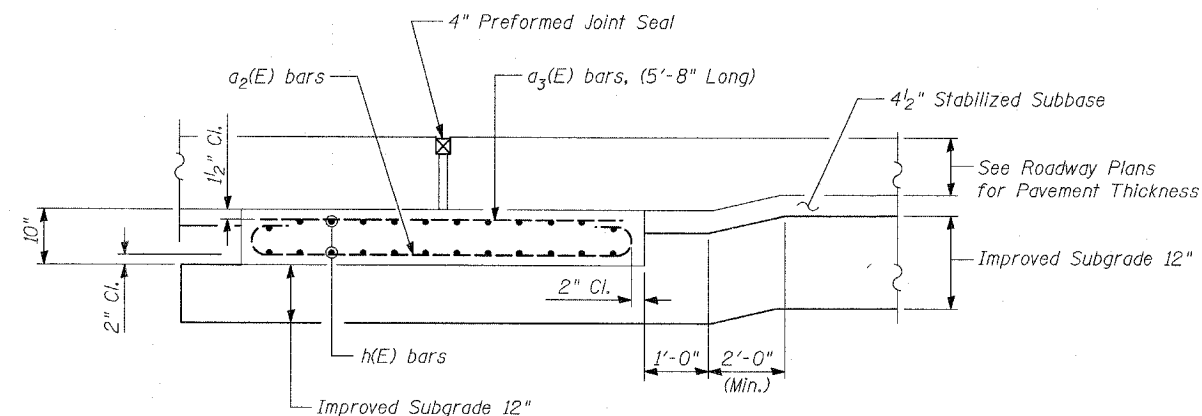

SECTION E-E - RIGID PAVEMENT

(Showing reinforcement)

BILL OF MATERIAL

Bar	No.	Size	Length	Shape
a(E)	142	#9	29'-6"	
a1(E)	71	#5	29'-6"	
a2(E)	98	#4	6'-8"	
a3(E)	98	#4	5'-8"	
b(E)	62	#5	35'-2"	
b1(E)	16	#4	35'-2"	
b2(E)	12	#6	2'-6"	
h(E)	48	#5	26'-9"	
h1(E)	48	#5	24'-7"	
Reinforcement Bars, Epoxy Coated		POUND	22,500	
Bridge Approach Pavement, Special		SQ YD	237	
Protective Coat		SQ YD	252	

Quantity of "Reinforcement bars, Epoxy Coated" is shown for information only.

NOTES:

- See Standard 421001 for reinforcement details not shown.
- See Standard 420001 for joint details not shown.
- The cost of tie bars, expansion joint, preformed joint seal, polyethylene bond breaker, reinforcement bars, concrete, concrete pad (including reinforcement), 4" granular subbase and excavation shall be included in the cost of "Bridge Approach Pavement, (Special)".

TYLIN INTERNATIONAL

DESIGNED	- MAF
CHECKED	- AD
DRAWN	- MAF
CHECKED	- AD

**NORTH BRIDGE APPROACH PAVEMENT
(1 OF 2)**

FAP 346 (U.S. ROUTE 41 - SKOKIE
HIGHWAY) OVER ILLINOIS ROUTE 132
SECTION 125X-HB-(1&2)R-1
LAKE COUNTY
S.N. 049-0209