

Benchmark: BM #6 - Square cut in base of L.P. at N.E. corner of IL Route 132 and Magnolia (Speedway) 45.14' LT, Sta. 32+13.24 (IL 132 E.B. @), Elev. 696.47.
 Existing Structure: None.

STATE OF ILLINOIS
 DEPARTMENT OF TRANSPORTATION

ROUTE NO.	SECTION	COUNTY	TOTAL SHEETS	SHEET NO.
346		LAKE	469	299
FED. ROAD DIST. NO.		ILLINOIS	FED. AID PROJECT	
125X-HB-(1&2) R-1		CONTRACT # 60826		

DESIGN SPECIFICATIONS
 2002 AASHTO Standard Specifications For Highway Bridges

DESIGN STRESSES

FIELD UNITS
 $f'_c = 3,500$ psi
 $f_y = 60,000$ psi (reinforcement)

GENERAL NOTES:

1. Wall stations and offsets are given to the front face of the Precast concrete wall panels, and are measured from Ramp C Baseline.
2. Reinforcement bars shall conform to the requirements of ASTM A706, Grade 60 (IL Modified). See Special Provisions.
3. Reinforcement bars designated (E) shall be epoxy coated.
4. All exposed concrete edges shall be chamfered $\frac{3}{4}$ " except as noted.
5. Slipforming of the parapet is not allowed.
6. The limits and quantities of removal and replacement shown are based on the boring data and may be modified by the District Geotechnical and Field Engineers for variable subsurface conditions encountered in the field.

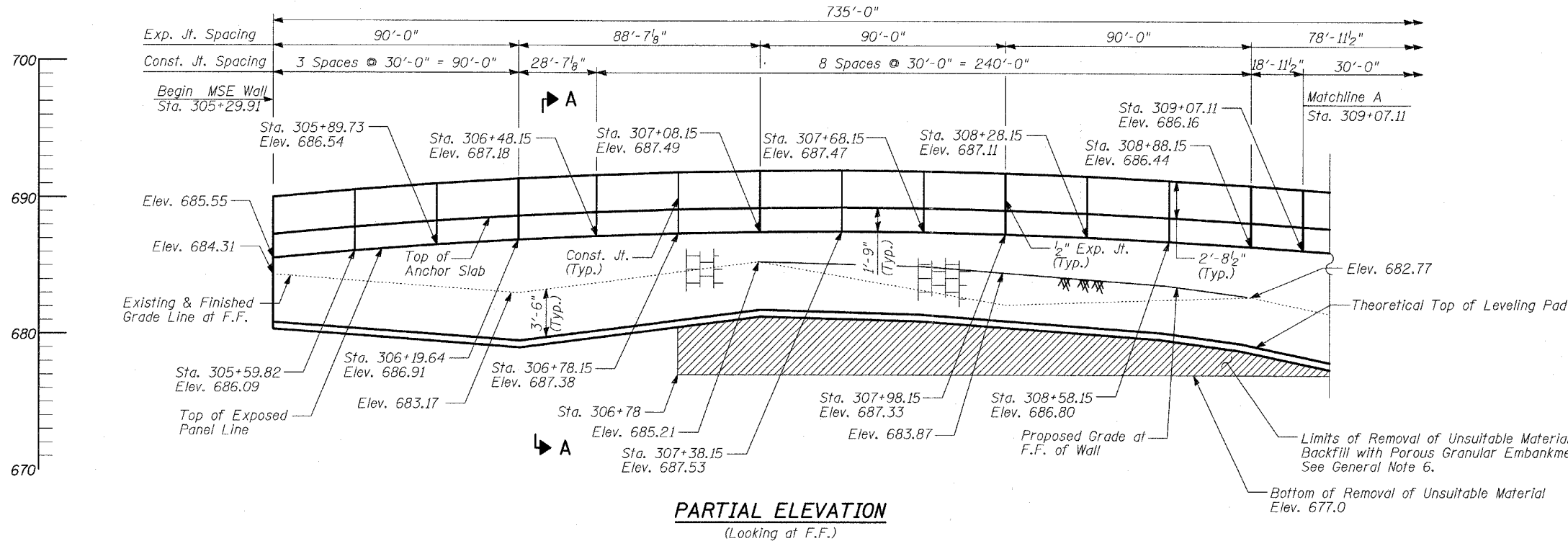

LEGEND

- ⊙ - Manhole
- - Catch Basin
- ⊕ - Soil Boring
- - Prop. Storm Sewer
- - Exist. Drain Pipe
- +— - Proposed Drainage Swale
- ▨ - Removal of Unsuitable Material

INDEX OF SHEETS:

1. WALL N GENERAL PLAN AND ELEVATION, STA 305+29.91 TO STA 309+07.11
2. WALL N GENERAL PLAN AND ELEVATION, STA 309+07.11 TO STA 312+64.94
3. ANCHORAGE SLAB AND PARAPET (1 OF 5)
4. ANCHORAGE SLAB AND PARAPET (2 OF 5)
5. ANCHORAGE SLAB AND PARAPET (3 OF 5)
6. ANCHORAGE SLAB AND PARAPET (4 OF 5)
7. ANCHORAGE SLAB AND PARAPET (5 OF 5)
8. ANCHORAGE SLAB AND PARAPET SECTIONS AND BAR LIST
9. ANCHORAGE SLAB AND PARAPET DETAILS
10. BORING LOGS N-2 & N-3
11. BORING LOGS N-4 & N-5
12. BORING LOGS N-6 & N-7
13. BORING LOGS N-8 & N-9
14. BORING LOGS N-10 & N-11
15. BORING LOG N-12

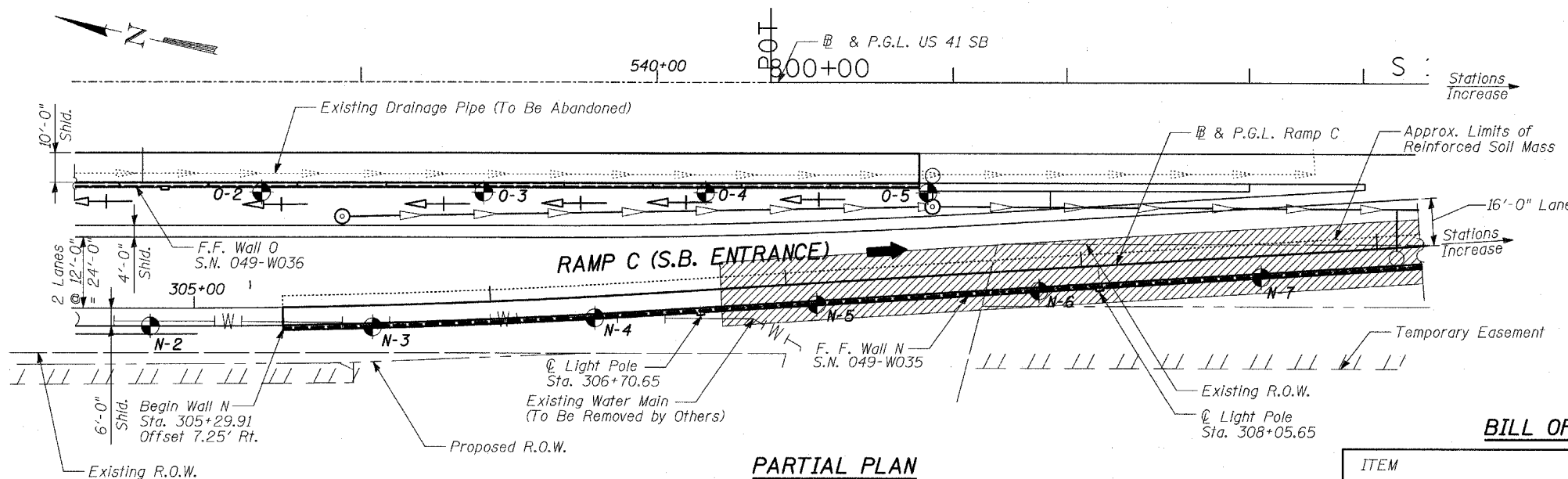
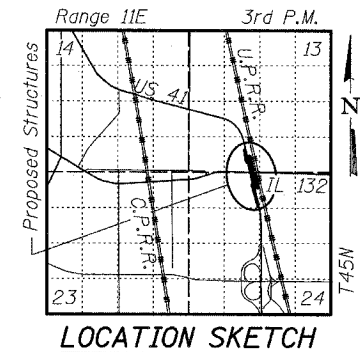

BILL OF MATERIAL

ITEM	UNIT	TOTAL
Removal and Disposal of Unsuitable Material	CU YD	373
Porous Granular Embankment	CU YD	373
Structure Excavation	CU YD	1,001
Concrete Superstructure	CU YD	353
Protective Coat	SQ YD	798
Reinforcement Bars, Epoxy Coated	POUND	50,260
Mechanically Stabilized Earth Retaining Wall	SQ FT	4,418
Anti-Graffiti Coating	SQ FT	5,362

**WALL N
 GENERAL PLAN
 STA 305+29.91 TO STA 309+07.11**

FAP 346 (U.S. ROUTE 41 - SKOKIE HIGHWAY) OVER ILLINOIS ROUTE 132
 SECTION 125X-HB-(1&2)R-1
 LAKE COUNTY
 S.N. 049-W035

TYLIN INTERNATIONAL

DESIGNED	- MB
CHECKED	- CM/AD
DRAWN	- DE
CHECKED	- CM/AD

APPROVED
 FOR STRUCTURAL ADEQUACY ONLY

Ralph E. Anderson
 ENGINEER OF BRIDGES AND STRUCTURES



Signed: *[Signature]*
 Spiros Pantazis, S.E. II, Lic. No. 081-006448
 Expires 11-30-2008.
 Date: 5/14/08

For drawings 1 thru 15 of 15