

STATE OF ILLINOIS
DEPARTMENT OF TRANSPORTATION

ROUTE NO.	SECTION	COUNTY	TOTAL SHEETS	SHEET NO.	SHEET NO. - 12
346		LAKE	469	325	21 SHEETS
FED. ROAD DIST. NO.	ILLINOIS	FED. AID PROJECT-			

125X-HB-(1&2) R-1 CONTRACT # 60826

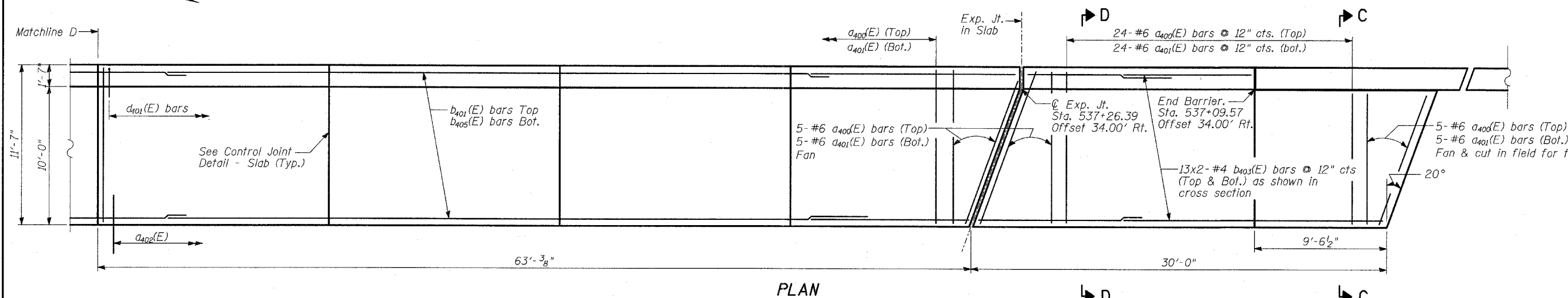
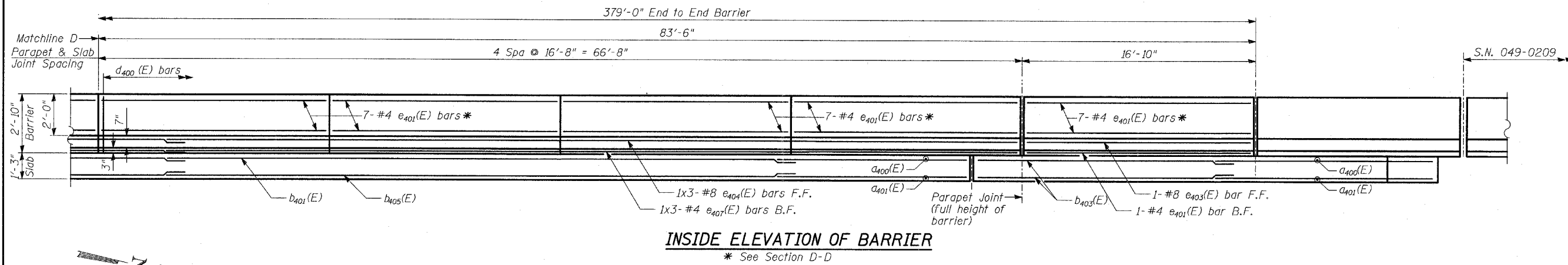

BILL OF MATERIAL

Bar	No.	Size	Length	Shape
a400(E)	396	#6	12'-8"	U
a401(E)	396	#6	11'-3"	U
a402(E)	389	#6	2'-6"	U
b400(E)	78	#4	31'-0"	U
b401(E)	39	#4	34'-4"	U
b402(E)	39	#4	28'-5"	U
b403(E)	52	#4	15'-9"	U
b404(E)	104	#4	23'-9"	U
b405(E)	52	#4	26'-2"	U
b406(E)	52	#4	21'-9"	U
e400(E)	414	#5	5'-7"	U
e401(E)	414	#5	7'-5"	U
e402(E)	3	#6	4'-5"	U
e403(E)	5	#6	8'-11"	U
e404(E)	96	#4	14'-8"	U
e405(E)	36	#4	16'-4"	U
e406(E)	6	#4	16'-6"	U
e407(E)	6	#8	36'-3"	U
e408(E)	2	#8	16'-6"	U
e409(E)	12	#8	32'-11"	U
e410(E)	12	#5	31'-4"	U
e411(E)	6	#5	34'-8"	U
e412(E)	6	#5	16'-6"	U
e413(E)	6	#4	21'-10"	U
e414(E)	6	#8	30'-4"	U
e415(E)	6	#5	28'-9"	U
Concrete Superstructure		CU YD	259	
Reinforcement Bars, Epoxy Coated		Pound	31,610	
Protective Coat		SQ YD	580	

PLAN

SECTION C-C

SECTION D-D

BAR d400(E)

BAR d401(E)

BAR a400(E)

**WALL 0
ANCHORAGE SLAB AND PARAPET
(3 OF 3)**

FAP 346 (U.S. ROUTE 41 - SKOKIE
HIGHWAY) OVER ILLINOIS ROUTE 132
SECTION 125X-HB-(1&2)R-1
LAKE COUNTY
S.N. 049-W036

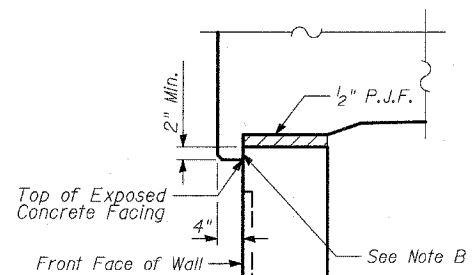

DETAIL A

Note B:
Bond breaker membrane on top of fascia wall.

TYLIN INTERNATIONAL

DESIGNED	- MB
CHECKED	- AD
DRAWN	- DE
CHECKED	- AD

Note A:
Sta. 540+88.57 to 537+58.57 - 1/2" /'
Sta. 537+58.57 to 537+03.57 - Varies 1/4" /' to 1/2" /'

LAP SPLICES

Bar	Lap
#4	1'-8"
#5	2'-2"
#6	2'-7"
#8	4'-6"

NOTES:

- Offsets are measured from B & P.G.L. SB US 41.
- Work this sheet with Sheets 10, 11 and 13 of 21.
- Bars indicated thus 20x3-#5 etc. Indicates 20 lines of bars with 3 lengths per line.