

STATE OF ILLINOIS  
DEPARTMENT OF TRANSPORTATION

ROUTE NO.	SECTION	COUNTY	TOTAL SHEETS	SHEET	SHEET NO. - 1
346	•	LAKE	469	365A	2 SHEETS
FED. ROAD DIST. NO.	ILLINOIS	FED. AID PROJECT-	CONTRACT # 60826		
* 125X-HB-(1&2) R-1					

**LOADING HS20-44**

Allow 50 psf for future wearing surface

**DESIGN SPECIFICATIONS**

2002 AASHTO Standard Specifications For Highway Bridges

**DESIGN STRESSES**

**FIELD UNITS**

$f'_c = 3,500$  psi  
 $f_y = 60,000$  psi (reinforcement)

**SEISMIC DATA**

Seismic Performance Category (SPC) = A  
Bedrock Acceleration Coefficient (A) = 0.035g  
Site Coefficient (S) = 1.0

**TOTAL BILL OF MATERIAL**

ITEM	UNIT	TOTAL
Porous Granular Embankment	CU YD	17
Concrete Removal	CU YD	1
Structure Excavation	CU YD	8
Concrete Box Culverts	CU YD	1
Reinforcement Bars	POUND	130
Expansion Bolts $\frac{3}{4}$ "	EACH	12

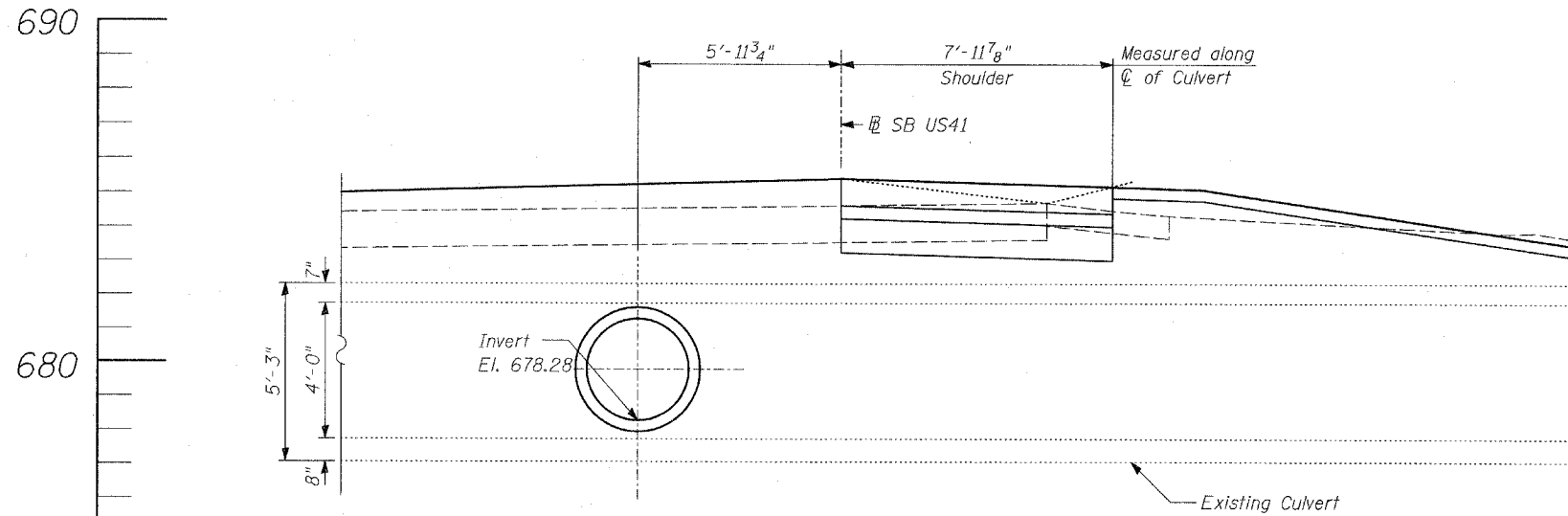

**ELEVATION**

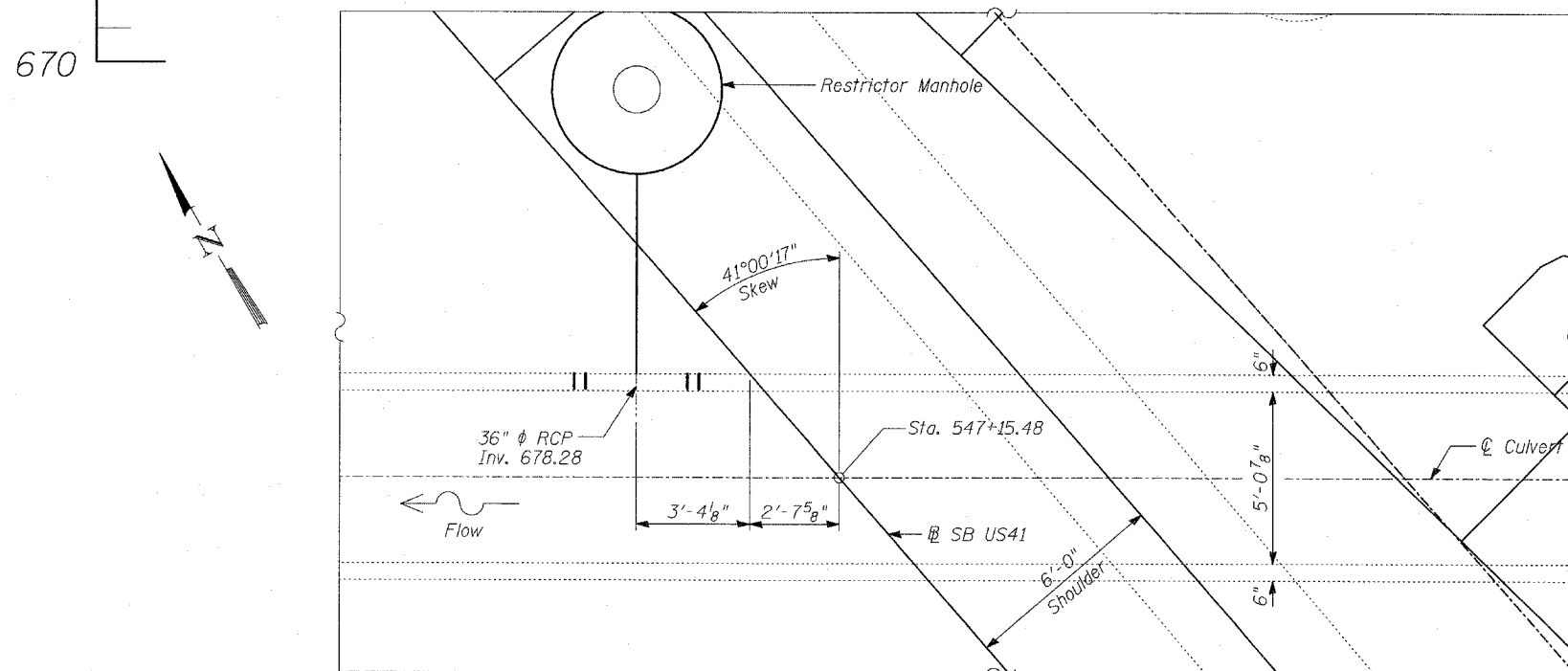

**PLAN**

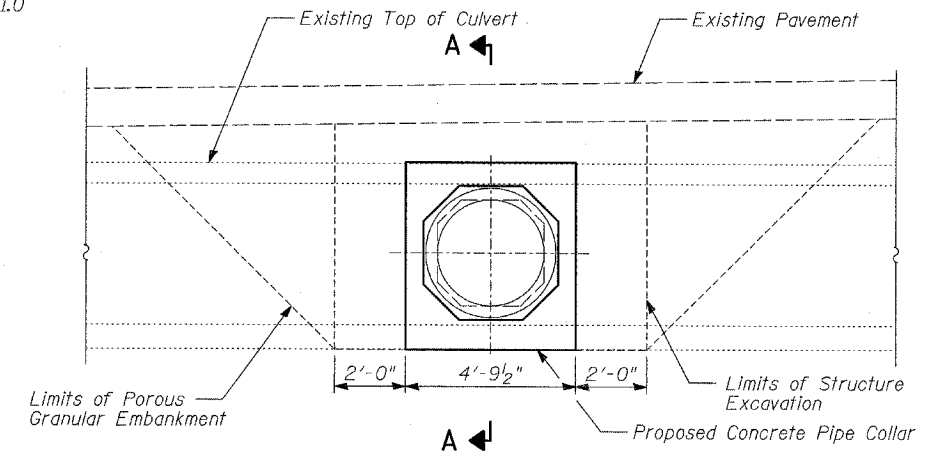

**LIMITS OF POROUS GRANULAR EMBANKMENT & STRUCTURE EXCAVATION**

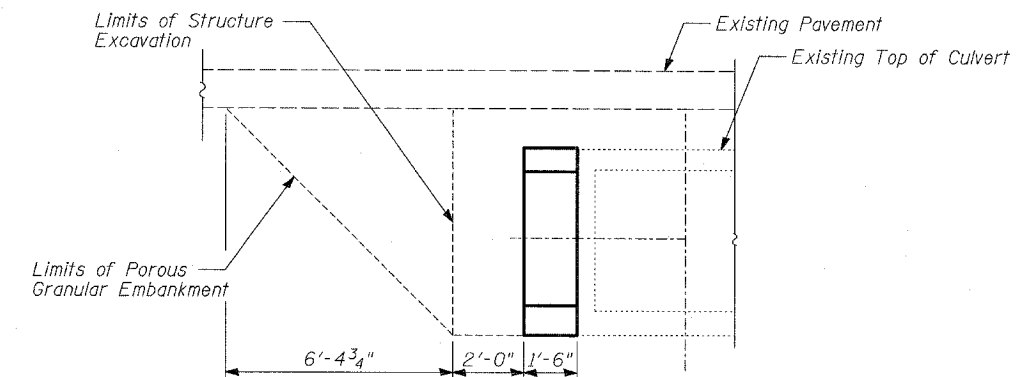

**SECTION A-A**

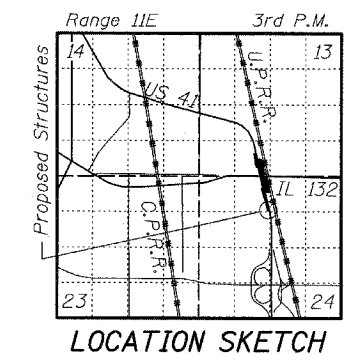

**LOCATION SKETCH**

**PIPE COLLAR AT EXISTING CULVERT  
STA. 547+15.48**

FAP 346 (U.S. ROUTE 41 - SKOKIE  
HIGHWAY) OVER ILLINOIS ROUTE 132  
SECTION 125X-HB-(1&2)R-1  
LAKE COUNTY

TYLIN INTERNATIONAL

DESIGNED	-
CHECKED	-
DRAWN	-
CHECKED	-

**NOTES:**

1. Reinforcement bars shall conform to the requirements of ASTM A 706 Gr. 60 (IL Modified). See Special Provisions.
2. All exposed concrete edges shall be chamfered  $\frac{3}{4}$ " except as noted.
3. All construction joints shall be bonded.



Signed *[Signature]*  
Spiros Pantazis, S.E., Il. Lic. No. 081-006448  
Expires 11-30-2008. For drawings 1 and 2 of 2  
Date 5/14/08