

F.A.I. RTE.	SECTION	COUNTY	TOTAL SHEETS	SHEET NO.
90/94	2005-066 LS	COOK	77	31
STA. 2040+00		TO STA. 2204+00		
FED. ROAD DIST. NO. 1 ILLINOIS FED. AID PROJECT				
60A72				

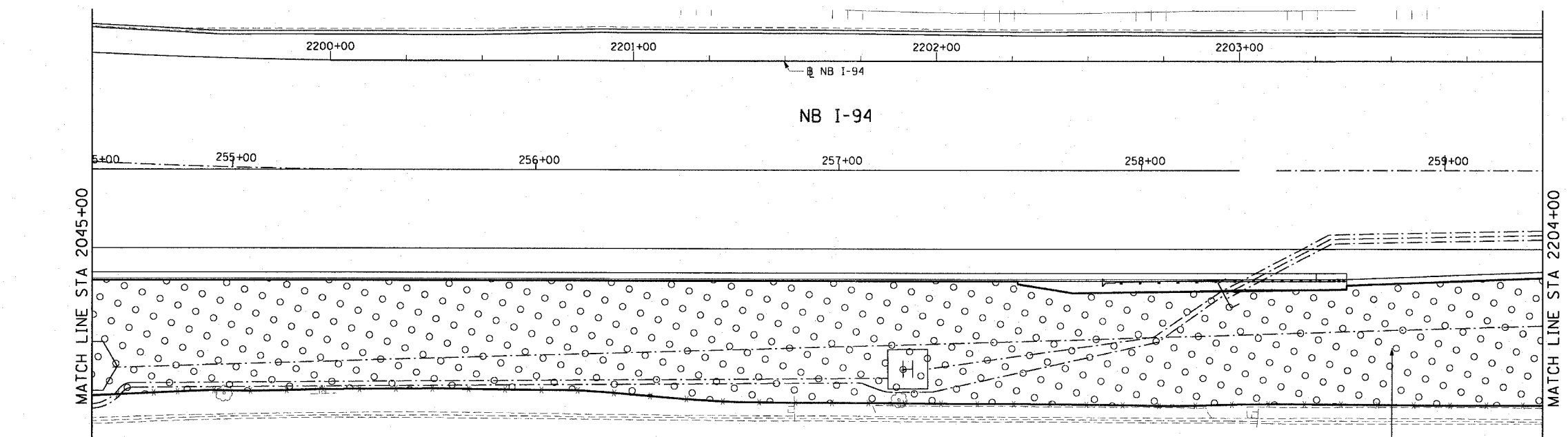

(9) SWAMP BUR OAK
(MULCH RINGS)

FUTURE GATEWAY
(BY OTHERS)

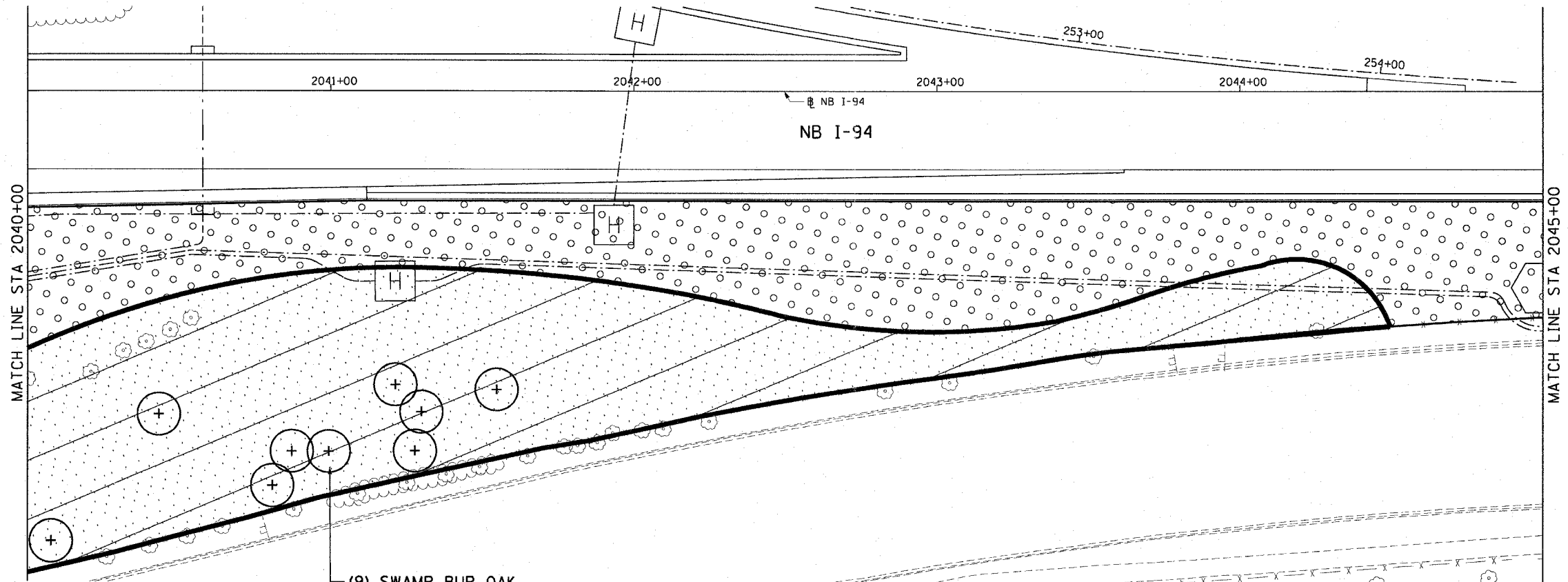
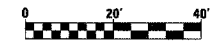

SHT-22 of 67

REVISIONS	NAME	DATE

ILLINOIS DEPARTMENT OF TRANSPORTATION
F.A.I. 90/94 (DAN RYAN EXPRESSWAY)
NB ROADSIDE EMBANKMENT LANDSCAPE

PROPOSED IMPROVEMENT
I-57 INTERCHANGE TO 31ST STREET

SCALE: 1"=20'
DATE: JUNE 2008
DRAWN BY: LAM
CHECKED BY: JWM

CTE | AECOM

IP:\0468\0468\CIVIL\30-roadside-embankment\stn22a_nb\rs22a022_2a.dwg 6/19/2008 6:35:55 PM