

CONTRACT NO. 60C12

| | | | | |
|---------------------|----------|------------------|--------------|-----------|
| FAP ROUTE NO. | SECTION | COUNTY | TOTAL SHEETS | SHEET NO. |
| 334 | SY-1-T-1 | LAKE | 19 | 1 |
| FED. ROAD DIST. NO. | ILLINOIS | FED. AID PROJECT | | |

D-91-122-07

STATE OF ILLINOIS
DEPARTMENT OF TRANSPORTATION
DIVISION OF HIGHWAYS
**PLANS FOR PROPOSED
HIGHWAY**
FAP 334 (US 12 /RAND ROAD)
SECTION: SY-1-T-1
AT ELA ROAD
STORM SEWER REPAIR
LAKE COUNTY
C-91-122-07

FOR INDEX OF SHEETS, SEE SHEET NO. 2

TRAFFIC DATA

EXISTING ADT
US 12 /RAND ROAD - 42,700 (2006)
ELA ROAD - 14,300 (2006)

SPEED LIMIT 45 MPH - US 12 /RAND ROAD
SPEED LIMIT 30 MPH - ELA ROAD

IMPROVEMENT LOCATED
IN THE VILLAGE OF
LAKE ZURICH

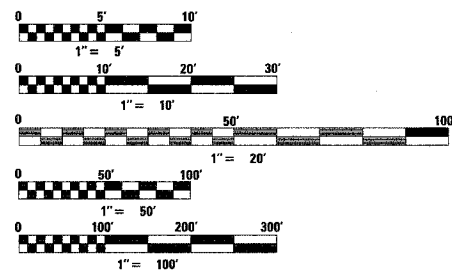

FULL SIZE PLANS HAVE BEEN PREPARED USING STANDARD
ENGINEERING SCALES, REDUCED SIZED PLANS WILL NOT
CONFORM TO STANDARD SCALES, IN MAKING MEASUREMENTS
ON REDUCED PLANS, THE ABOVE SCALES MAY BE USED.

J.U.L.I.E. JOINT UTILITY LOCATION INFORMATION
FOR EXCAVATION 1-800-892-0123

CONTRACT NO. 60C12

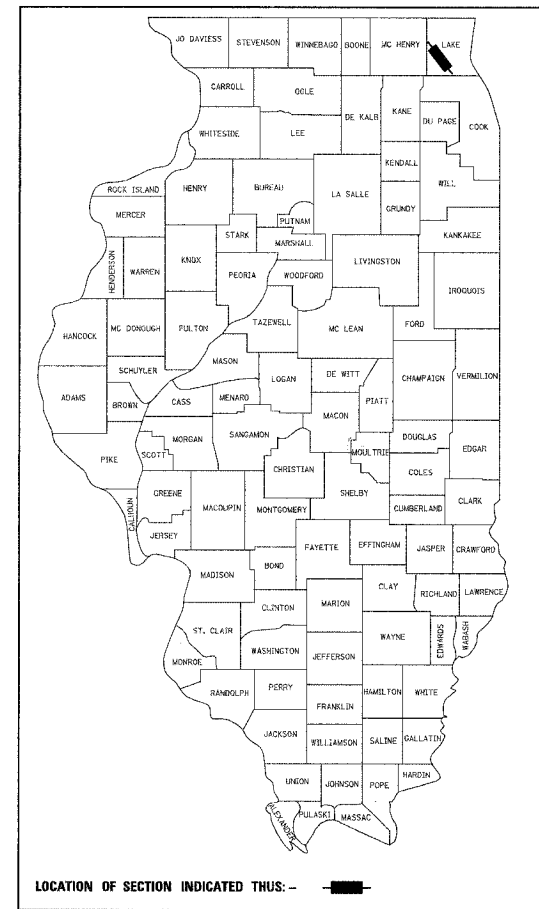

LOCATION OF SECTION INDICATED THUS: -

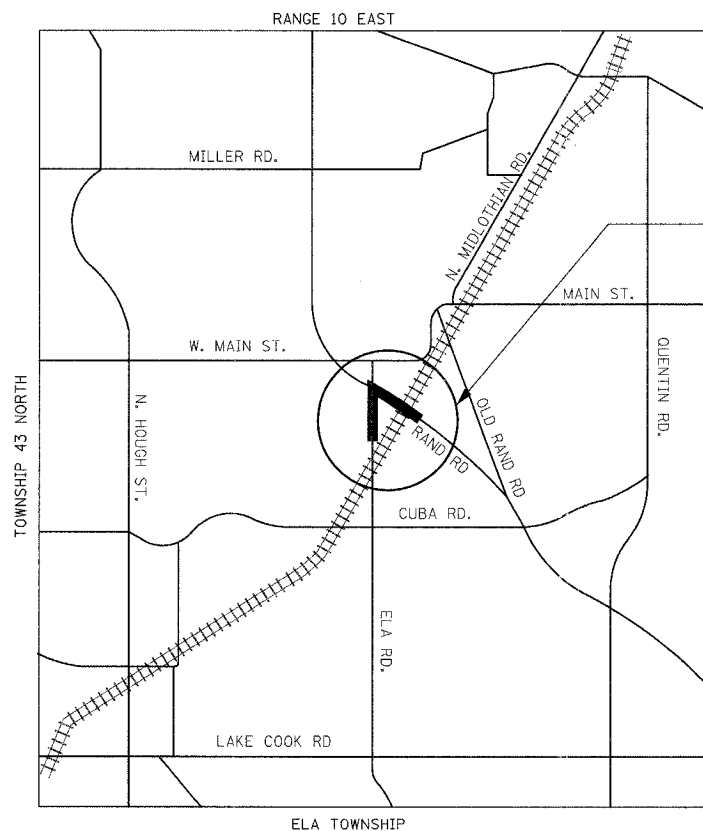

PROJECT LOCATION

Don M. Johnson
3-20-08
Professional Engineer of Illinois
Exp. 11-30-09

STATE OF ILLINOIS
DEPARTMENT OF TRANSPORTATION
DIVISION OF HIGHWAYS

SUBMITTED *March 24* 20 08

Don M. Johnson
DEPUTY DIRECTOR OF HIGHWAYS, REGION 1 ENGINEER

May 9, 20 08
Eric E. Haral
ENGINEER OF DESIGN AND ENVIRONMENT

May 9, 20 08
Christine M. Reed
DIRECTOR, DIVISION OF HIGHWAYS

PRINTED BY THE AUTHORITY OF
THE STATE OF ILLINOIS

GRAEF, ANHALT, SCHLOEMER & ASSOCIATES, INC.
ENGINEERS & SCIENTISTS
8501 W. Higgins Road, Suite 280
Chicago, Illinois 60631
(773) 399-0112

DISTRICT ONE PLAN PREPARATION ENGINEER: KEN ENG (847) 705-4247