

F.A.P. RTE.	SECTION	COUNTY	TOTAL SHEETS	SHEET NO.
353	12R-4	WILL	199	74
STA.	TO STA.			
FED. ROAD DIST. NO.	ILLINOIS	FED. AID PROJECT		

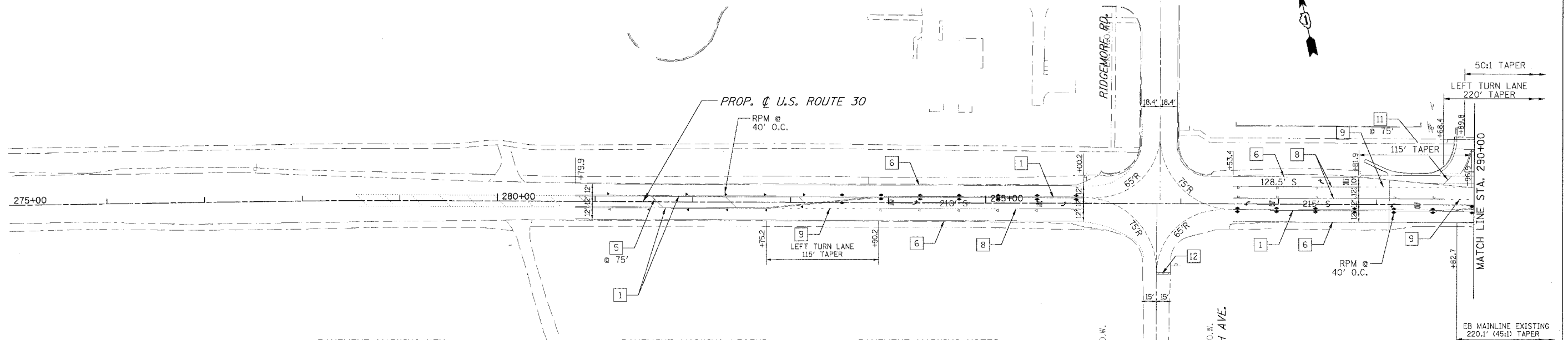

PAVEMENT MARKING KEY

YELLOW	1	4" DOUBLE (WIDE)	WHITE	6	4" SOLID
	2	4" DOUBLE (NARROW)		7	4"- 30' SKIP/10' DASH
	3	4" SOLID		8	6" SOLID
	4	4"- 30' SKIP/10' DASH		9	6"- 6' SKIP/2' DASH
	5	12" DIAGONALS @ 45°		10	8" SOLID
			11	12" SOLID @ 45°	
			12	24" STOP BAR	

PAVEMENT MARKING LEGEND

- ☐ LETTERS AND SYMBOLS
- ▶ RAISED PAVEMENT MARKER (RPM), ONE-WAY CRYSTAL
- ▶ RAISED PAVEMENT MARKER (RPM), ONE-WAY AMBER
- ◆ RAISED PAVEMENT MARKER (RPM), TWO-WAY AMBER
- 240' T LENGTH OF TAPER

PAVEMENT MARKING NOTES

1. THERMOPLASTIC PAVEMENT MARKINGS SHALL BE APPLIED ON BITUMINOUS PAVEMENT.
2. POLYUREA PAVEMENT MARKINGS SHALL BE APPLIED ON P.C. CONCRETE PAVEMENT.
3. PAVEMENT MARKINGS AND RAISED PAVEMENT MARKERS SHALL BE PER DISTRICT ONE PAVEMENT MARKING AND RAISED PAVEMENT MARKERS DETAIL.
4. TWO WEEKS PRIOR TO PLACING PERMANENT PAVEMENT MARKINGS CONTACT CORA MATHIS, IDOT'S AREA TRAFFIC FIELD ENGINEER AT (815)485-6475.

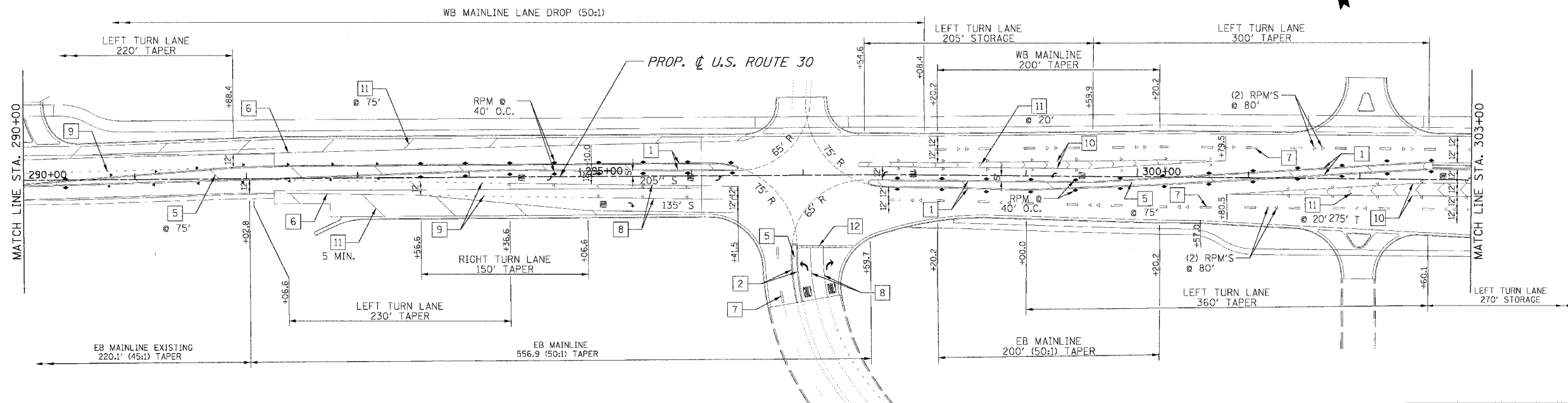

REVISIONS		ILLINOIS DEPARTMENT OF TRANSPORTATION
NAME	DATE	
		PAVEMENT MARKING PLANS U.S. RTE. 30 (LINCOLN HIGHWAY) STA. 260+00 TO STA. 290+00 SCALE : 1" = 50' DRAWN BY : BAE DATE : 03/21/2008 CHECKED BY : GB