

- PAVEMENT MARKING NOTES:**
1. ALL PAVEMENT MARKINGS ON BRIDGE DECK SHALL BE POLYUREA, TYPE I.
 2. ALL PAVEMENT MARKINGS ON CONCRETE PAVEMENT SHALL BE POLYUREA, TYPE I.
 3. ALL PAVEMENT MARKINGS ON HOT-MIX ASPHALT SHALL BE THERMOPLASTIC.

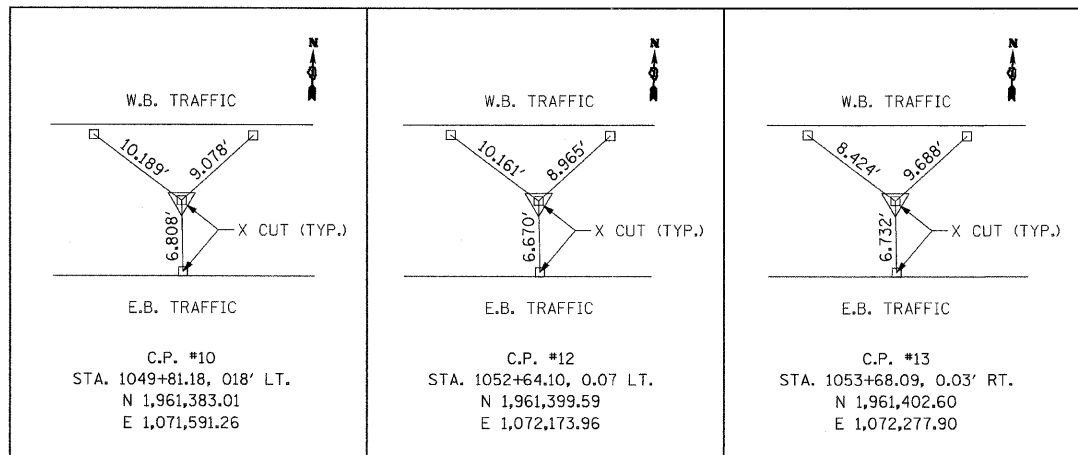

CENTERLINE ALIGNMENT			
	NORTHING	EASTING	STATION
P. I.	1,961,379.37	1,071,471.25	1045+61.10
P. I.	1,961,392.06	1,071,911.92	1050+01.96
P. I.	1,961,398.14	1,072,127.88	1052+18.00
P. I.	1,961,404.12	1,072,327.79	1054+18.00
P. I.	1,961,419.29	1,072,856.87	1059+47.30