

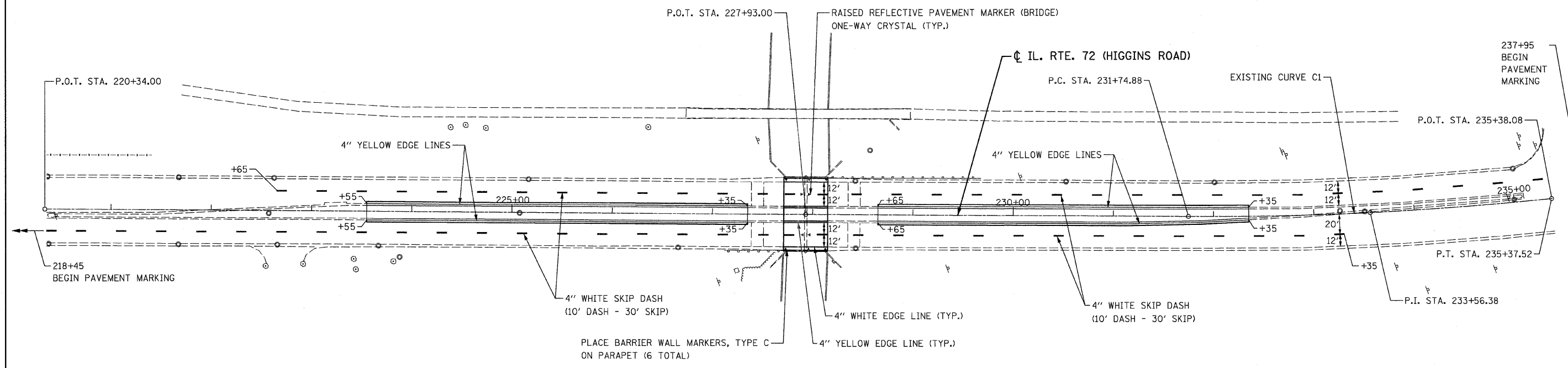

EXIST. CURVE C1  
 PI STA. = 233+56.38  
 $\Delta = 6^\circ 17' 46''$  (LT)  
 $D = 1^\circ 44' 10''$   
 $R = 3,300.00'$   
 $T = 181.50'$   
 $L = 362.64'$   
 $E = 4.99'$   
 $e = \text{-----}$   
 $T.R. = \text{-----}$   
 $S.E. \text{ RUN} = \text{-----}$   
 P.C. STA. = 231+74.88  
 P.T. STA. = 235+37.52



PLACE BARRIER WALL MARKERS, TYPE C ON PARAPET (6 TOTAL)

**PAVEMENT MARKING NOTES:**

1. ALL PAVEMENT MARKINGS ON BRIDGE DECK SHALL BE POLYUREA.
2. ALL PAVEMENT MARKINGS ON HOT-MIX ASPHALT SHALL BE THERMOPLASTIC.
3. SEE SHEET NO. 24 & 25 FOR DETAILS AND SPACING.

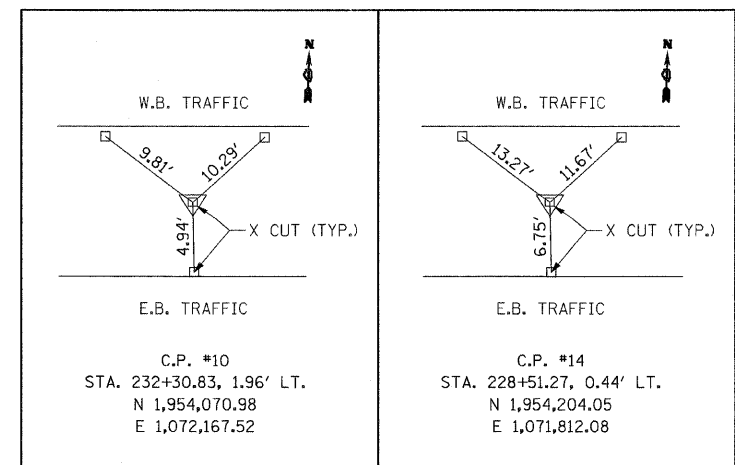

C.P. #10  
 STA. 232+30.83, 1.96' LT.  
 N 1,954,070.98  
 E 1,072,167.52

C.P. #14  
 STA. 228+51.27, 0.44' LT.  
 N 1,954,204.05  
 E 1,071,812.08

CENTERLINE ALIGNMENT			
	STATION	N	E
P.O.T.	220+34.00	1,954,494.22	1,071,048.06
P.O.T.	227+93.00	1,954,224.36	1,071,757.46
P.C.	231+74.88	1,954,088.58	1,072,114.39
P.I.	233+56.38	1,954,024.05	1,072,284.03
P.T.	235+37.52	1,953,978.51	1,072,459.72

**PAVEMENT MARKING REMOVAL:**  
 4" YELLOW, LT. & RT.  
 STA. 223+55 TO STA. 227+35  
 STA. 228+65 TO STA. 232+35

FILE NAME = 60055 align pm 72.dgn  
 PLOT DATE = 4/30/2008



DESIGNED - S.J.P.	REVISED -
DRAWN - A.C.S.	REVISED -
CHECKED - E.J.M.	REVISED -
DATE - APRIL 21, 2008	REVISED -

**STATE OF ILLINOIS  
 DEPARTMENT OF TRANSPORTATION**

**ALIGNMENT, TIES AND PAVEMENT MARKINGS  
 IL. RTE. 72**

SCALE: 1" = 50' SHEET NO. 2 OF 2 SHEETS STA. 221+00 TO STA. 235+00

F.A.P. RTE. 559341	SECTION 2008-007 B	COUNTY COOK	TOTAL SHEETS 39	SHEET NO. 6
FED. ROAD DIST. NO. 1 ILLINOIS FED. AID PROJECT				
CONTRACT NO. 60D55				