

INDEX OF SHEETS

SHEET NO.	DESCRIPTION
1.	TITLE SHEET
2.	INDEX OF SHEETS, STATE STANDARDS, GENERAL NOTES
3.	SUMMARY OF QUANTITIES
4.	EXISTING TYPICAL SECTIONS
5.	PROPOSED TYPICAL SECTIONS
6-8.	ROADWAY AND PAVEMENT MARKING PLAN
9.	LOOP DETECTOR PLANS
10.	DETAILS FOR FRAMES AND LIDS ADJUSTMENT WITH MILLING
11.	PAVEMENT PATCHING FOR HMA SURFACED PAVEMENT
12.	CURB OR CURB AND GUTTER REMOVAL AND REPLACEMENT
13.	BUTT JOINT AND HMA TAPER DETAILS
14.	TRAFFIC CONTROL AND PROTECTION FOR SIDE ROADS, INTERSECTIONS, AND DRIVEWAYS
15.	TYPICAL APPLICATIONS RAISED REFLECTIVE PAVEMENT MARKERS (SNOW-PLOW RESISTANT)
16.	DISTRICT ONE TYPICAL PAVEMENT MARKINGS
17.	TRAFFIC CONTROL AND PROTECTION AT TURN BAYS (TO REMAIN OPEN TO TRAFFIC)
18.	PAVEMENT MARKING LETTERS AND SYMBOLS FOR TRAFFIC STAGING
19.	ARTERIAL ROAD INFORMATION SIGN
20.	DRIVEWAY ENTRANCE SIGNING
21.	DISTRICT 1 DETECTOR LOOP INSTALLATION DETAILS FOR ROADWAY RESURFACING

STATE STANDARDS

STANDARD NO.	DESCRIPTION
000001-05	STANDARD SYMBOLS, ABBREVIATIONS AND PATTERNS
442201-03	CLASS C AND D PATCHES
604006-03	FRAME AND GRATE, TYPE 3
604051-02	FRAME AND GRATE, TYPE 11
606001-03	CONCRETE CURB TYPE B AND COMBINATION CONCRETE CURB AND GUTTER
701606-05	URBAN LANE CLOSURE, 2W WITH MOUNTABLE MEDIAN
701701-05	URBAN LANE CLOSURE, MULTILANE INTERSECTION
701901	TRAFFIC CONTROL DEVICES

GENERAL NOTES

- BEFORE STARTING ANY EXCAVATION, THE CONTRACTOR SHALL CALL *J.U.L.I.E.* AT (800)892-0123 FOR FIELD LOCATIONS OF BURIED ELECTRIC, TELEPHONE AND GAS UTILITIES. (48 HOUR NOTIFICATION IS REQUIRED.)
- ALL PAVEMENT MARKING SHALL BE PLACED THROUGHOUT THE PROJECT ACCORDING TO DISTRICT 1 TYPICAL PAVEMENT MARKING.
- ALL HMA PAVEMENT PATCHING SHALL BE CLASS D.
- THE CONTRACTOR WILL NOT BE ALLOWED TO SET UP A YARD OR FIELD OFFICE ON STATE PROPERTY WITHOUT WRITTEN PERMISSION FROM THE DEPARTMENT.
- ANY PAVEMENT MARKINGS AND RAISED REFLECTIVE PAVEMENT MARKERS OBLITERATED BY MILLING AND RESURFACING OPERATIONS ON SIDE STREETS AND ENTRANCES SHALL BE REPLACED AND PAID FOR IN KIND.
- BEFORE BEGINNING ANY WORK, THE CONTRACTOR SHALL RETAIN AND RECORD (FOR FUTURE REFERENCES), ALL EXISTING PAVEMENT MARKING LINES IN ORDER THAT THESE LOCATIONS CAN BE RE-ESTABLISHED FOR STRIPING. EXACT LOCATIONS OF ALL STRIPING SHALL BE AS DIRECTED BY THE ENGINEER.
- ALL PAVEMENT PATCHING AND CURB & GUTTER REMOVAL AND REPLACEMENT LOCATIONS WILL BE DETERMINED IN THE FIELD BY THE ENGINEER.
- DRAINAGE STRUCTURE ADJUSTMENT OR RECONSTRUCTION LOCATIONS WILL BE DETERMINED IN THE FIELD BY THE ENGINEER.
- LOCATIONS FOR TYPE 3 GRATES TO REPLACE EXISTING NON-BICYCLE-SAFE GRATES AND REPLACEMENT OF BROKEN TYPE 11 FRAMES AND GRATES WILL BE DETERMINED IN THE FIELD BY THE ENGINEER.
- FRAMES AND GRATES ADJUSTMENT OF PRIVATE UTILITIES WITHIN THE LIMITS OF THE IMPROVEMENTS SHALL BE DONE BY THEIR RESPECTIVE OWNERS AND ARE NOT PART OF THIS CONTRACT.
- THE RESIDENT ENGINEER SHALL CONTACT THE DISTRICT ONE TRAFFIC CONTROL SUPERVISOR AT (847) 705-4470 A MINIMUM OF 72 HOURS PRIOR TO THE PLACEMENT OF ANY TEMPORARY TRAFFIC CONTROL DEVICES.
- THE ENGINEER SHALL CONTACT MS. DEBBIE HANLON, THE TRAFFIC FIELD ENGINEER, @ 847-438-2300 TWO (2) WEEKS PRIOR TO THE START OF THIS PROJECT SO THAT EXACT STATIONING OF NO PASSING ZONES AND OTHER PERMANENT PAVEMENT MARKINGS MAY BE ESTABLISHED.
- THE CONTRACTOR SHALL BE REQUIRED TO PROVIDE ACCESS TO ABUTTING PROPERTY AT ALL TIMES DURING THE CONSTRUCTION OF THIS PROJECT.
- EXISTING BROKEN FRAMES AND LIDS, OR NON-BICYCLE-SAFE GRATES SHALL BE REMOVED AND DISPOSED OF BY THE CONTRACTOR AND SHALL BE REPLACED AS DIRECTED BY THE ENGINEER. REPLACEMENT FRAMES AND GRATES OR LIDS WILL BE PAID FOR IN ACCORDANCE WITH ARTICLE 109.04 OF THE STANDARD SPECIFICATIONS, UNLESS A SEPARATE PAY ITEM HAS BEEN PROVIDED.
- DO NOT SCALE PLANS FOR CONSTRUCTION DIMENSIONS.
- DOUBLE LANE MARKERS ARE TO BE USED AS SHOWN ON THE DISTRICT ONE DETAIL FOR TYPICAL APPLICATION OF RAISED REFLECTIVE PAVEMENT MARKERS (SNOW-PLOW RESISTANT) SHOWN IN THE PLANS.
- WHEN ARTIFICIAL LIGHTING IS USED IN NIGHT OPERATIONS THE CONTRACTOR SHALL EXERCISE THE UTMOST PRECAUTIONS IN PREVENTING ADVERSE VISIBILITY TO THE MOTORING PUBLIC AND ADJOINING RESIDENTIAL AREAS.
- WHEN MILLED PAVEMENT IS OPEN TO TRAFFIC THE MAXIMUM GRADE DIFFERENTIAL BETWEEN PASSES OF THE MILLING MACHINE SHALL NOT EXCEED 1/2 INCHES (40 MM) WHERE THE SPEED LIMIT IS 45 MPH (80 KM/H) OR LESS AND 1 INCH (25 MM) WHERE THE SPEED LIMIT IS GREATER THAN 45 MPH (80 KM/H). WITH WRITTEN APPROVAL FROM THE ENGINEER, A MAXIMUM GRADE DIFFERENTIAL OF 3 INCHES (75 MM) MAY BE ALLOWED IF THE EDGE OF THE MILLING IS SLOPED A MINIMUM 1:3 (V:H)
- BUTT JOINTS WILL BE INSTALLED AT THE ENDS OF ALL RESURFACING (WHERE RESURFACING MEETS EXISTING PAVEMENT), IN ACCORDANCE WITH THE "BUTT JOINT AND HOT-MIX ASPHALT TAPER DETAILS" SHEET INCLUDED IN THE PLANS, UNLESS OTHERWISE SPECIFIED.
- IT SHALL BE THE CONTRACTOR'S RESPONSIBILITY TO VERIFY ALL DIMENSIONS AND CONDITIONS EXISTING IN THE FIELD PRIOR TO CONSTRUCTION AND ORDERING OF MATERIALS.
- THE CONTRACTOR SHALL COORDINATE CONSTRUCTION ACTIVITIES WITH UTILITY COMPANIES, AND WITH THE CITY OF WAUKEGAN.
- REMOVAL AND REPLACEMENT OF UNSUITABLE SUB-BASE MATERIAL AT PAVEMENT PATCHING LOCATIONS SHALL BE PAID FOR AS FOLLOWS:
REMOVAL AND REPLACEMENT 4" OR LESS SHALL BE INCLUDED IN THE COST OF PATCHES OF THE CLASS & TYPE BEING PLACED.
REMOVAL AND REPLACEMENT IN THE EXCESS OF 4" WILL BE PAID FOR IN ACCORDANCE WITH ARTICLE 109.04 OF THE STANDARD SPECIFICATIONS.

PLOT DATE = 7/14/2008
FILE NAME = K:\11225608\Civil\Sheet\11225608 NOTES.dgn
PLOT SCALE = 1:1
USER NAME = mhysko
MODEL = Defaul1

rjngroup
Excellence through Ownership

200 West Front Street
Wheaton, IL 60187

DESIGNED -	WJV	REVISED -	
DRAWN -	WJV	REVISED -	
CHECKED -	BLB	REVISED -	
DATE -	5/23/08	REVISED -	

STATE OF ILLINOIS
DEPARTMENT OF TRANSPORTATION

IL ROUTE 137 (GREENWOOD AVE. - BLANCHARD RD.)
INDEX OF SHEETS, STATE STANDARDS, AND GENERAL NOTES

SCALE: SHEET NO. OF SHEETS STA. TO STA.

F.A.P. RTE.	SECTION	COUNTY	TOTAL SHEETS	SHEET NO.
352	(E, M, D) RS-6	LAKE	21	2
CONTRACT NO. 60E56				
FED. ROAD DIST. NO. 1 [ILLINOIS] FED. AID PROJECT				

Rev. 7-16-08

801.FED.
20/STATE

SUMMARY OF QUANTITIES

CODE NO.	ITEM DESCRIPTION	UNIT	URBAN TOTAL QUANTITY	CONSTRUCTION TYPE CODE
40600200	BITUMINOUS MATERIALS (PRIME COAT)	TON	23.1	23.1
40600300	AGGREGATE (PRIME COAT)	TON	115	115
40600400	MIXTURE FOR CRACKS, JOINTS, AND FLANGWAYS	TON	177.2	177.2
40600895	CONSTRUCTING TEST STRIP	EACH	2	2
40600982	HOT-MIX ASPHALT SURFACE REMOVAL - BUTT JOINT	SQ YD	194	194
40601005	HOT-MIX ASPHALT REPLACEMENT OVER PATCHES	TON	411	411
40603595	POLYMERIZED HOT-MIX ASPHALT SURFACE COURSE, MIX "F", N90	TON	3,765	3,765
42300200	PORTLAND CEMENT CONCRETE DRIVEWAY PAVEMENT, 6 INCH	SQ YD	7	7
44000159	HOT-MIX ASPHALT SURFACE REMOVAL, 2 1/2"	SQ YD	38,415	38,415
42300400	PORTLAND CEMENT CONCRETE DRIVEWAY PAVEMENT, 8 INCH	SQ YD	9	9
44001700	COMBINATION CONCRETE CURB AND GUTTER REMOVAL AND REPLACEMENT	FOOT	1,070	1,070
42400200	PORTLAND CEMENT CONCRETE SIDEWALK 5 INCH	SQ FT	113	113
44002216	HOT-MIX ASPHALT REMOVAL OVER PATCHES, 4"	SQ YD	1,836	1,836
42400800	DETECTABLE WARNINGS	SQ FT	12	12
44201789	CLASS D PATCHES, TYPE II, 12 INCH	SQ YD	400	400
44000200	DRIVEWAY PAVEMENT REMOVAL	SQ YD	32	32
44201794	CLASS D PATCHES, TYPE III, 12 INCH	SQ YD	190	190
44000600	SIDEWALK REMOVAL	SQ FT	113	113
44201796	CLASS D PATCHES, TYPE IV, 12 INCH	SQ YD	1,597	1,597
44003100	MEDIAN REMOVAL	SQ FT	190	190
60300105	FRAMES AND GRATES TO BE ADJUSTED	EACH	1	1
55039700	STORM SEWERS TO BE CLEANED	FOOT	500	500
60300310	FRAMES AND LIDS TO BE ADJUSTED (SPECIAL)	EACH	62	62
60401810	GRATES, TYPE 3	EACH	23	23
60404800	FRAMES AND GRATES, TYPE II	EACH	1	1
60618800	CONCRETE MEDIAN SURFACE, 4 INCH	SQ FT	190	190
67000400	ENGINEER'S FIELD OFFICE, TYPE A	CAL MO	4	4
67100100	MOBILIZATION	L SUM	1	1
70102625	TRAFFIC CONTROL AND PROTECTION, STANDARD 701606	L SUM	1	1
70102635	TRAFFIC CONTROL AND PROTECTION, STANDARD 701701	L SUM	1	1
70300100	SHORT-TERM PAVEMENT MARKING	FOOT	8000	8000
70300210	TEMPORARY PAVEMENT MARKING - LETTERS AND SYMBOLS	SQ FT	436	436
70300220	TEMPORARY PAVEMENT MARKING - LINE 4"	FOOT	23,042	23,042
70300240	TEMPORARY PAVEMENT MARKING - LINE 6"	FOOT	1,628	1,628
70300260	TEMPORARY PAVEMENT MARKING - LINE 12"	FOOT	480	480
70300280	TEMPORARY PAVEMENT MARKING - LINE 24"	FOOT	259	259
70301000	WORK ZONE PAVEMENT MARKING REMOVAL	SQ FT	2640	2640
* 78000100	THERMOPLASTIC PAVEMENT MARKING - LETTERS AND SYMBOLS	SQ FT	437	437
* 78000200	THERMOPLASTIC PAVEMENT MARKING - LINE 4"	FOOT	23,042	23,042
* 78000400	THERMOPLASTIC PAVEMENT MARKING - LINE 6"	FOOT	1654	1654
* 78000600	THERMOPLASTIC PAVEMENT MARKING - LINE 12"	FOOT	480	480
* 78000650	THERMOPLASTIC PAVEMENT MARKING - LINE 24"	FOOT	259	259
* 78100100	RAISED REFLECTIVE PAVEMENT MARKER	EACH	501	501
78300200	RAISED REFLECTIVE PAVEMENT MARKER REMOVAL	EACH	501	501
* 88600600	DETECTOR LOOP REPLACEMENT	FOOT	664	664
X0322256	TEMPORARY INFORMATION SIGNING	SQ FT	77.1	77.1
X4067107	POLYMERIZED LEVELING BINDER (MACHINE METHOD), IL 4.75, N50	TON	1615	1615
NP 70018500	DRAINAGE STRUCTURES TO BE CLEANED	EACH	48	48
70004500	BITUMINOUS DRIVEWAY PAVEMENT 8"	SQ YD	7	7
70076600	TRAINERS	HOUR	9	9
70004900	BITUMINOUS DRIVEWAY PAVEMENT 10"	SQ YD	9	9

* SPECIALTY ITEM
NP = Non-participating

Rev. 7-16-08

PLOT DATE = 5/22/2008
 FILE NAME = K:\1225588\Civil\Sheets\1225588_SCD.dgn
 USER NAME = jmm
 MODEL = Default



200 West Front Street
Wheaton, IL 60187

DESIGNED - WJV
DRAWN - WJV
CHECKED - BLB
DATE - 5/23/08

REVISED -
REVISED -
REVISED -
REVISED -

STATE OF ILLINOIS
DEPARTMENT OF TRANSPORTATION

IL ROUTE 137 (GREENWOOD AVE. - BLANCHARD RD.)
SUMMARY OF QUANTITIES

F.A.P. RTE.	SECTION	COUNTY	TOTAL SHEETS	SHEET NO.
352	(E, M, D) RS-6	LAKE	21	3
FED. ROAD DIST. NO. 1 ILLINOIS FED. AID PROJECT			CONTRACT NO. 60E56	

SCALE: SHEET NO. OF SHEETS STA. TO STA.

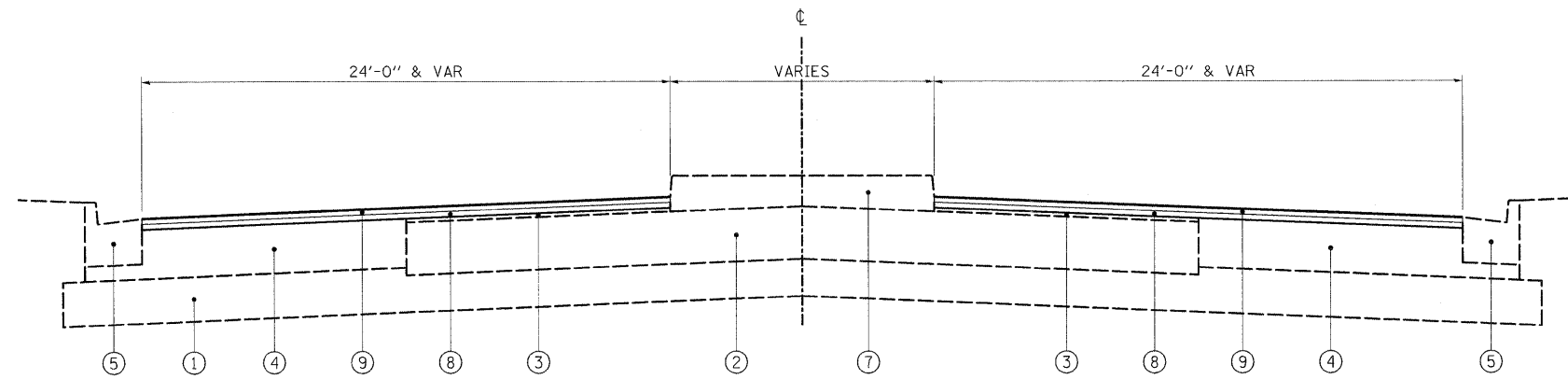

PROPOSED TYPICAL SECTION SHERIDAN ROAD

STA 14+46 TO STA 22+25

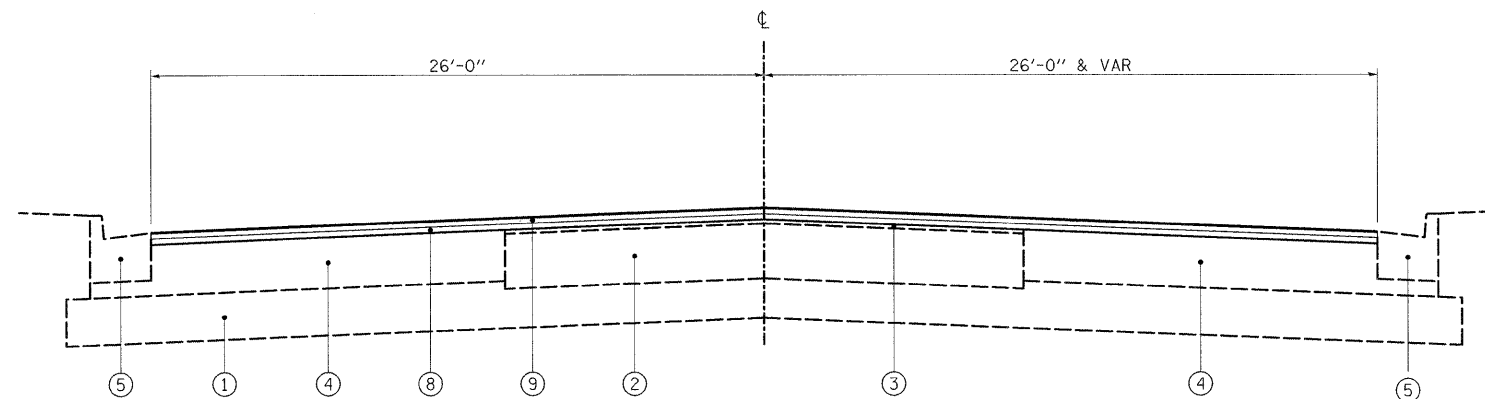

PROPOSED TYPICAL SECTION SHERIDAN ROAD

STA 22+25 TO STA 71+27

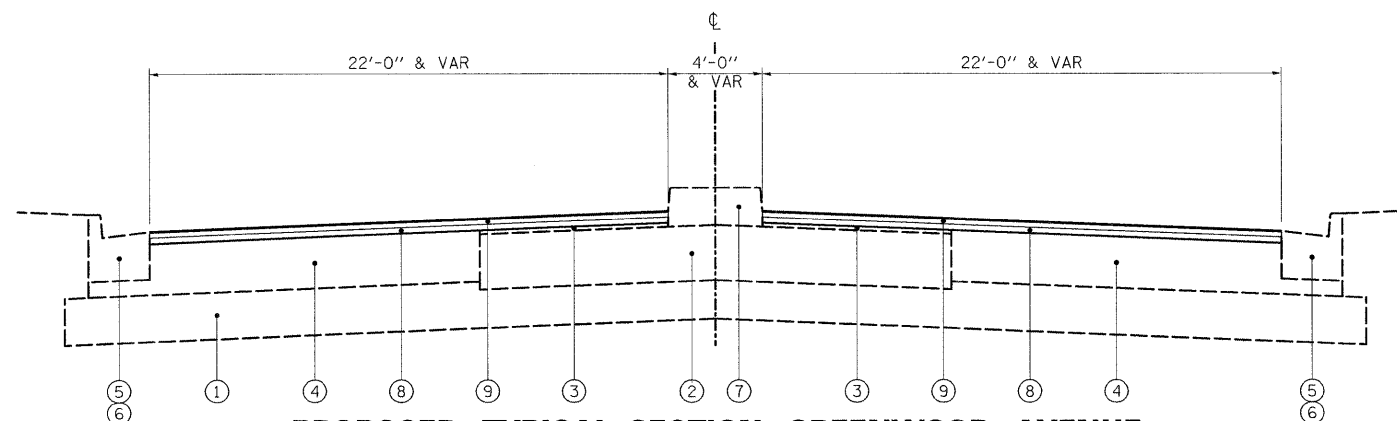

PROPOSED TYPICAL SECTION GREENWOOD AVENUE

STA 16+08 TO STA 22+04

HOT-MIX ASPHALT MIXTURE

MIXTURE	AC TYPE	AIR VOIDS (%)
POLYMERIZED HOT-MIX ASPHALT SURFACE COURSE, MIX "F", N90 (IL 9.5 mm)	SBS/SBR PG 70-22	4% @ 90 GYR.
POLYMERIZED LEVELING BINDER (MACHINE METHOD), IL-4.75, N50	SBS/SBR PG 76-28/-22	4% @ 50 GYR.
HMA REPLACEMENT OVER PATCHES (HMA BINDER, IL-19 mm)	PG 64-22*	4% @ 70 GYR.
CLASS D PATCH (HMA BINDER, IL-19 mm)	PG 64-22*	4% @ 70 GYR.
TEMPORARY RAMPS (HMA BINDER, IL-19 mm)	PG 64-22*	4% @ 50 GYR.

THE UNIT WEIGHT USED TO CALCULATE ALL HOT-MIX ASPHALT SURFACE MIXTURES IS 112 LBS/SQ YD/IN

*WHEN RAP EXCEEDS 20%, THE NEW ASPHALT BINDER IN THE MIX SHALL BE PG 58-22.

LEGEND

- ① EXISTING AGGREGATE BASE COURSE
- ② EXISTING PCC PAVEMENT, 14"
- ③ EXISTING HOT-MIX ASPHALT PAVEMENT, 4" (BEFORE SURFACE REMOVAL)
- ④ EXISTING HOT-MIX ASPHALT PAVEMENT, 16" (BEFORE SURFACE REMOVAL)
- ⑤ EXISTING COMBINATION CURB AND GUTTER, TYPE B-6.24
- ⑥ EXISTING COMBINATION CURB AND GUTTER, TYPE B-6.12
- ⑦ EXISTING MEDIAN
- ⑧ PROPOSED POLYMERIZED LEVELING BINDER (MACHINE METHOD), IL-4.75, N50, 3/4"
- ⑨ PROPOSED POLYMERIZED HOT-MIX ASPHALT SURFACE COURSE, "MIX F", N90, 1 3/4"

PLOT DATE = 7/14/2008
 FILE NAME = K:\11225006\Civil\Sheets\11225006.TYPICAL.dgn
 USER NAME = mhaka
 MODEL = Default



200 West Front Street
Wheaton, IL 60187

DESIGNED - LCM
 DRAWN - LCM
 CHECKED - BLB
 DATE - 5/23/08

REVISED -
 REVISED -
 REVISED -
 REVISED -

**STATE OF ILLINOIS
 DEPARTMENT OF TRANSPORTATION**

**IL ROUTE 137 (GREENWOOD AVE. - BLANCHARD RD.)
 PROPOSED TYPICAL SECTIONS**

SCALE: SHEET NO. OF SHEETS STA. TO STA.

Rev. 7-16-08

F.A.P. RTE.	SECTION	COUNTY	TOTAL SHEETS	SHEET NO.
352	(E, M, D) RS-6	LAKE	21	5
FED. ROAD DIST. NO. 1 ILLINOIS FED. AID PROJECT			CONTRACT NO. 60E56	

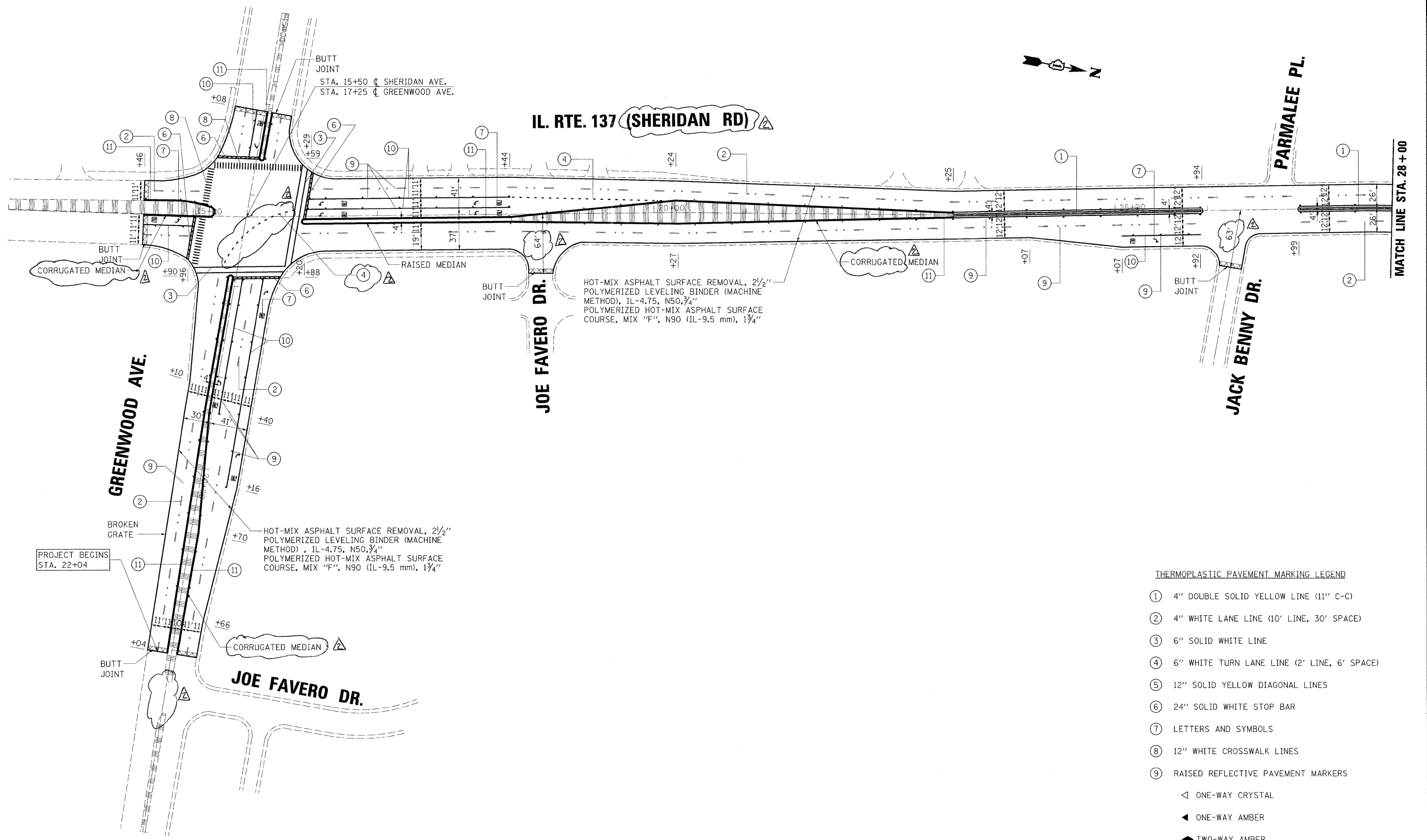

IL RTE. 137 (SHERIDAN RD)

GREENWOOD AVE.

JOE FAVERO DR.

JACK BENNY DR.

PARMALEE PL.

MATCH LINE STA. 28+00

BUTT JOINT
STA. 15+50 @ SHERIDAN AVE.
STA. 17+25 @ GREENWOOD AVE.

HOT-MIX ASPHALT SURFACE REMOVAL, 2 1/2"
POLYMERIZED LEVELING BINDER (MACHINE METHOD), IL-4.75, N50, 3/4"
POLYMERIZED HOT-MIX ASPHALT SURFACE COURSE, MIX "F", N90 (IL-9.5 mm), 1 3/4"

HOT-MIX ASPHALT SURFACE REMOVAL, 2 1/2"
POLYMERIZED LEVELING BINDER (MACHINE METHOD), IL-4.75, N50, 3/4"
POLYMERIZED HOT-MIX ASPHALT SURFACE COURSE, MIX "F", N90 (IL-9.5 mm), 1 3/4"

PROJECT BEGINS
STA. 22+04

THERMOPLASTIC PAVEMENT MARKING LEGEND

- ① 4" DOUBLE SOLID YELLOW LINE (11" C-C)
- ② 4" WHITE LANE LINE (10' LINE, 30' SPACE)
- ③ 6" SOLID WHITE LINE
- ④ 6" WHITE TURN LANE LINE (2' LINE, 6' SPACE)
- ⑤ 12" SOLID YELLOW DIAGONAL LINES
- ⑥ 24" SOLID WHITE STOP BAR
- ⑦ LETTERS AND SYMBOLS
- ⑧ 12" WHITE CROSSWALK LINES
- ⑨ RAISED REFLECTIVE PAVEMENT MARKERS
 - ◁ ONE-WAY CRYSTAL
 - ◀ ONE-WAY AMBER
 - ◆ TWO-WAY AMBER
- ⑩ 6" SOLID WHITE TURN LANE LINE
- ⑪ 4" SINGLE SOLID YELLOW LINE

Rev. 7-16-08

PLOT DATE = 7/14/2008
 FILE NAME = K:\11225508\Civil\Sheets\11225508-PLAN01.dgn
 USER NAME = jphs
 MODEL = Default



200 West Front Street
Wheaton, IL 60187

DESIGNED - LCM	REVISED -
DRAWN - JMT	REVISED -
CHECKED - BLB	REVISED -
DATE - 5/23/08	REVISED -

**STATE OF ILLINOIS
DEPARTMENT OF TRANSPORTATION**

**IL ROUTE 137 (GREENWOOD AVE. - BLANCHARD RD.)
EXISTING & PROPOSED ROADWAY PLAN**

SCALE: 1"=50' SHEET NO. 1 OF 3 SHEETS STA. 13+00 TO STA. 28+00

F.A.P. RTE. 352	SECTION (E, M, D) RS-6	COUNTY LAKE	TOTAL SHEETS 21	SHEET NO. 6
FED. ROAD DIST. NO. 1 ILLINOIS FED. AID PROJECT			CONTRACT NO. 60E56	

LONGVIEW RD.

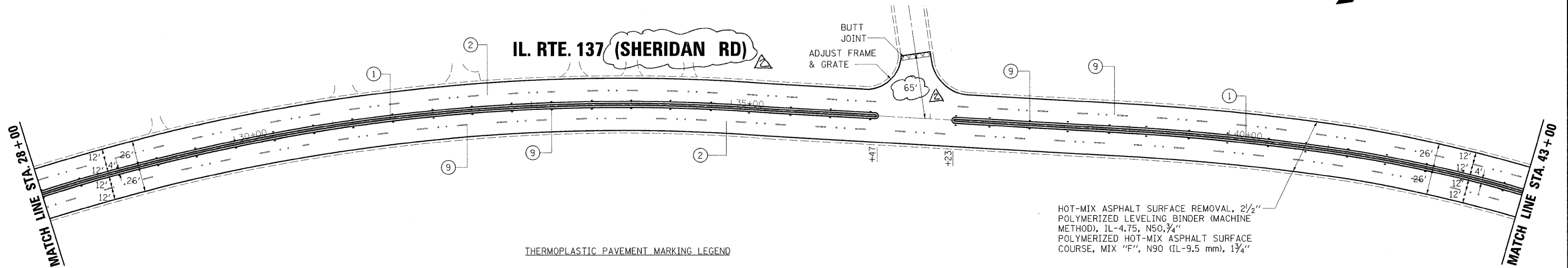

HOT-MIX ASPHALT SURFACE REMOVAL, 2 1/2"
 POLYMERIZED LEVELING BINDER (MACHINE METHOD), IL-4.75, N50, 3/4"
 POLYMERIZED HOT-MIX ASPHALT SURFACE COURSE, MIX "F", N90 (IL-9.5 mm), 1 3/4"

THERMOPLASTIC PAVEMENT MARKING LEGEND

- | | |
|---|--------------------------------------|
| ① 4" DOUBLE SOLID YELLOW LINE (11" C-C) | ⑧ 12" WHITE CROSSWALK LINES |
| ② 4" WHITE LANE LINE (10' LINE, 30' SPACE) | ⑨ RAISED REFLECTIVE PAVEMENT MARKERS |
| ③ 6" SOLID WHITE LINE | ◁ ONE-WAY CRYSTAL |
| ④ 6" WHITE TURN LANE LINE (2' LINE, 6' SPACE) | ◀ ONE-WAY AMBER |
| ⑤ 12" SOLID YELLOW DIAGONAL LINES | ◆ TWO-WAY AMBER |
| ⑥ 24" SOLID WHITE STOP BAR | ⑩ 6" SOLID WHITE TURN LANE LINE |
| ⑦ LETTERS AND SYMBOLS | ⑪ 4" SINGLE SOLID YELLOW LINE |

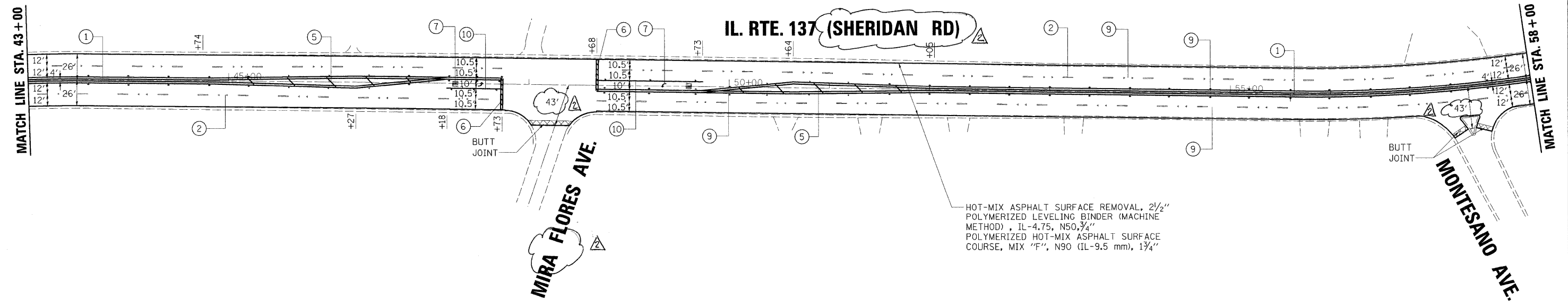
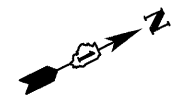

HOT-MIX ASPHALT SURFACE REMOVAL, 2 1/2"
 POLYMERIZED LEVELING BINDER (MACHINE METHOD), IL-4.75, N50, 3/4"
 POLYMERIZED HOT-MIX ASPHALT SURFACE COURSE, MIX "F", N90 (IL-9.5 mm), 1 3/4"

Rev. 7-16-08

PLOT DATE = 7/14/2008
 FILE NAME = K:\1122508\Civil\Sheets\1122508_Plan02.dgn
 USER NAME = mchako
 MODEL = Default

rjngroup
 Excellence through Ownership

200 West Front Street
 Wheaton, IL 60187

DESIGNED - LCM	REVISED -
DRAWN - JMT	REVISED -
CHECKED - BLB	REVISED -
DATE - 5/23/08	REVISED -

**STATE OF ILLINOIS
 DEPARTMENT OF TRANSPORTATION**

**IL ROUTE 137 (GREENWOOD AVE. - BLANCHARD RD.)
 EXISTING & PROPOSED ROADWAY PLAN**

SCALE: 1"=50' SHEET NO. 2 OF 3 SHEETS STA. 28+00 TO STA. 58+00

F.A.P. RTE. 352	SECTION (E, M, D) RS-6	COUNTY LAKE	TOTAL SHEETS 21	SHEET NO. 7
CONTRACT NO. 60E56				
FED. ROAD DIST. NO. 1 ILLINOIS FED. AID PROJECT				

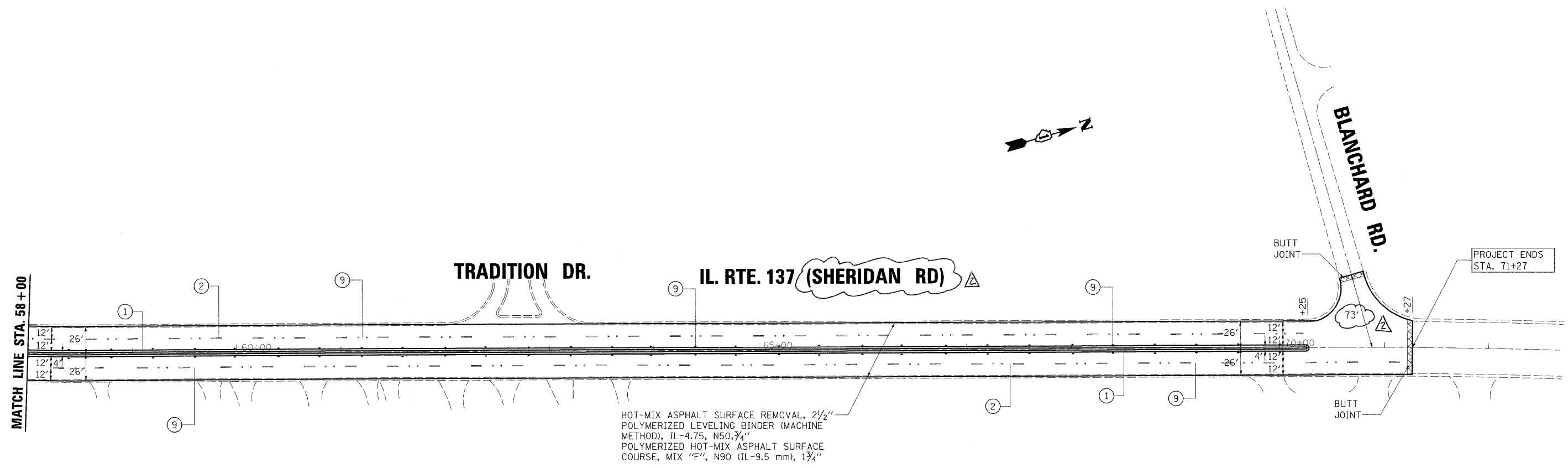

- THERMOPLASTIC PAVEMENT MARKING LEGEND**
- ① 4" DOUBLE SOLID YELLOW LINE (11" C-C)
 - ② 4" WHITE LANE LINE (10' LINE, 30' SPACE)
 - ③ 6" SOLID WHITE LINE
 - ④ 6" WHITE TURN LANE LINE (2' LINE, 6' SPACE)
 - ⑤ 12" SOLID YELLOW DIAGONAL LINES
 - ⑥ 24" SOLID WHITE STOP BAR
 - ⑦ LETTERS AND SYMBOLS
 - ⑧ 12" WHITE CROSSWALK LINES
 - ⑨ RAISED REFLECTIVE PAVEMENT MARKERS
 - ◁ ONE-WAY CRYSTAL
 - ◀ ONE-WAY AMBER
 - ◆ TWO-WAY AMBER
 - ⑩ 6" SOLID WHITE TURN LANE LINE
 - ⑪ 4" SINGLE SOLID YELLOW LINE

Rev. 7-16-08

PLOT DATE = 7/14/2008
 FILE NAME = K:\1225500\Civil\Sheets\1225500-PL-R03.dgn
 USER NAME = mhaka
 MODEL = Default



200 West Front Street
Wheaton, IL 60187

DESIGNED -	REVISED -
DRAWN -	REVISED -
CHECKED -	REVISED -
DATE - 5/23/08	REVISED -

**STATE OF ILLINOIS
DEPARTMENT OF TRANSPORTATION**

**IL ROUTE 137 (GREENWOOD AVE. - BLANCHARD RD.)
EXISTING & PROPOSED ROADWAY PLAN**

SCALE: 1"=50' SHEET NO. 3 OF 3 SHEETS STA. 58+00 TO STA. 73+00

F.A.P. RTE. 352	SECTION (E, M, D) RS-6	COUNTY LAKE	TOTAL SHEETS 21	SHEET NO. 8
FED. ROAD DIST. NO. 1 ILLINOIS FED. AID PROJECT			CONTRACT NO. 60E56	