

ROUTE	SECTION	COUNTY	TOTAL SHEETS	SHEET NUMBER
VARIOUS	2008-047 RS	LAKE	41	1

**STATE OF ILLINOIS**  
**DEPARTMENT OF TRANSPORTATION**  
**DIVISION OF HIGHWAYS**  
**DISTRICT ONE**  
**PROPOSED HIGHWAY PLANS**

**CONTRACT NO. 60E96**

D-91-550-08

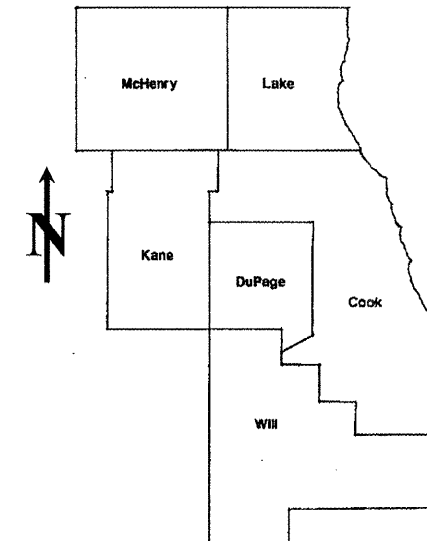

LOCATION OF IMPROVEMENT INDICATED THUS:

VARIOUS ROUTES  
 SECTION: 2008-047 RS  
 VARIOUS LOCATIONS IN WEST LAKE COUNTY  
 INTERMITTANT PAVEMENT RESURFACING  
 LAKE COUNTY  
 C-91-550-08

FOR INDEX OF SHEETS SEE SHEET 2

STATE OF ILLINOIS DEPARTMENT OF TRANSPORTATION DIVISION OF HIGHWAYS	
SUBMITTED:	<u>JUNE 18,</u> 20 <u>08</u>
	<u>Diana M. O'Keefe</u> <i>gr</i>
	DEPUTY DIRECTOR OF HIGHWAYS, REGION ENGINEER
	<u>June 27,</u> 20 <u>08</u>
	<u>Eric E. Harrel</u> <i>@</i>
<i>Interim</i>	ENGINEER OF DESIGN AND ENVIRONMENT
	<u>June 27,</u> 20 <u>08</u>
	<u>Christine M. Reed</u> <i>@</i>
	DIRECTOR, DIVISION OF HIGHWAYS

**PRINTED BY THE AUTHORITY**  
**OF THE STATE OF ILLINOIS**

**J.U.L.I.E.: JOINT UTILITY LOCATION**  
**INFORMATION FOR EXCAVATION**  
**(312) 744-7000**

**CONTRACT NO. 60E96**

DISTRICT ONE - DESIGN - PLAN PREPARATION ENGINEER:  
 KEN ENG / (847) 705-4247

INDEX OF SHEETS

<u>SHEET NO.</u>	<u>DESCRIPTION</u>
1	TITLE SHEET
2	INDEX OF SHEETS, STATE STANDARDS AND GENERAL NOTES
3	SUMMARY OF QUANTITIES
4	GENERAL LOCATION MAP
5	SUMMARY OF PATCHING SCHEDULE
6-35	PATCHING SCHEDULE
36	BUTT JOINT AND HMA TAPER DETAILS
37	TRAFFIC CONTROL AND PROTECTION FOR SIDE ROADS, INTERSECTIONS AND DRIVEWAYS
38	TYPICAL APPLICATIONS; RAISED REFLECTIVE PAVEMENT MARKERS (SNOW-PLOW RESISTANT)
39	DISTRICT ONE TYPICAL PAVEMENT MARKINGS
40	TRAFFIC CONTROL AND PROTECTION OF TURN BAYS (TO REMAIN OPEN TO TRAFFIC)
41	ARTERIAL ROAD INFORMATION SIGN

STATE STANDARDS

<u>STANDARD NO.</u>	<u>DESCRIPTION</u>
000001-05	TYPICAL SYMBOLS, ABBREVIATIONS AND PATTERNS
701201-02	LANE CLOSURE, 2L, 2W, DAY ONLY
701301-02	LANE CLOSURE, 2L, 2W, SHORT TIME OPERATIONS
701306-01	LANE CLOSURE, 2L, 2W, SLOW MOVING OPERATIONS - DAY ONLY
701336-04	LANE CLOSURE, 2L, 2W, WORK AREAS IN SERIES
701501-04	URBAN LANE CLOSURE, 2L, 2W, UNDIVIDED
701601-05	URBAN LANE CLOSURE, MULTILANE, 1W OR 2W WITH NONTRAVERSABLE MEDIAN
701606-05	URBAN LANE CLOSURE, MULTILANE, 2W WITH MOUNTABLE MEDIAN
701701-05	URBAN LANE CLOSURE, MULTILANE INTERSECTION
701901	TRAFFIC CONTROL DEVICES

GENERAL NOTES

BEFORE STARTING ANY EXCAVATION, THE CONTRACTOR SHALL CALL "JULIE" AT (800) 892-0123 OR 811 FOR FIELD LOCATIONS OF BURIED ELECTRIC, TELEPHONE AND GAS FACILITIES. (48 HOUR NOTIFICATION REQUIRED)

THE CONTRACTOR WILL NOT BE ALLOWED TO SET UP A YARD OR FIELD OFFICE ON STATE (OR TOLLWAY) PROPERTY WITHOUT WRITTEN PERMISSION FROM THE DEPARTMENT (OR ISTHA)

WHEN ARTIFICIAL LIGHTING IS UTILIZED IN NIGHT OPERATIONS, THE CONTRACTOR SHALL EXERCISE THE UTMOST PRECAUTIONS IN PREVENTING ADVERSE VISABILITY TO THE MOTORING PUBLIC AND ADJOINING RESIDENTIAL AREAS.

ANY PAVEMENT MARKINGS AND RAISED REFLECTIVE PAVEMENT MARKERS OBLITERATED BY MILLING AND RESURFACING OPERATIONS ON SIDE STREETS AND ENTRANCES SHALL BE REPLACED AND PAID FOR IN KIND.

BEFORE BEGINNING ANY WORK, THE CONTRACTOR SHALL RETAIN AND RECORD FOR FUTURE REFERENCE, ALL EXISTING PAVEMENT MARKING LINES (AND RAISED REFLECTIVE PAVEMENT MARKERS) IN ORDER THAT THESE LOCATIONS CAN BE RE-ESTABLISHED FOR STRIPING. EXACT LOCATIONS OF ALL PAVEMENT MARKINGS SHALL BE AS DIRECTED BY THE ENGINEER.

ALL PAVEMENT PATCHING LOCATIONS WILL BE DETERMINED IN THE FIELD BY THE ENGINEER.

THE CONTRACTOR SHALL CONTACT THE DISTRICT ONE TRAFFIC CONTROL SUPERVISOR AT (847) 705-4470 A MINIMUM OF 72 HOURS IN ADVANCE OF BEGINNING WORK.

THE ENGINEER SHALL CONTACT MS. DEBBIE HANLON, AREA TRAFFIC FIELD ENGINEER AT (815) 438-2300 MINIMUM OF TWO (2) WEEKS PRIOR TO PLACEMENT OF PERMANENT PAVEMENT MARKINGS.

DOUBLE LANE MARKERS ARE TO BE USED AS SHOWN ON THE DISTRICT ONE DETAIL "TYPICAL APPLICATIONS - RAISED REFLECTIVE PAVEMENT MARKERS (SNOW-PLOW RESISTANT)" SNOWN IN THE PLANS.

THE EXISTING ROADWAY TYPICAL SECTION IS ASSUMED TO HAVE A 3 INCH HOT-MIX ASPHALT OVERLAY ON TOP OF A TEN INCH CONCRETE BASE.

THE COST OF TRAFFIC CONTROL AND PROTECTION FOR THE PROJECT SHALL BE INCLUDED IN THE COST OF THE ASSOCIATED ROAD WORK.

THE COST OF ANY PARTIAL OR FULL DEPTH PATCHING REQUIRED AFTER THE REMOVAL OF THE EXISTING 2 INCH HOT-MIX ASPHALT SURFACE SHALL BE PAID FOR IN ACCORDANCE WITH ARTICLE 109.04 OF THE STANDARD SPECIFICATIONS.

HOT-MIX ASPHALT MIXTURE REQUIREMENTS

MIXTURE TYPE	AC TYPE	AIR VOIDS (%)
HOT-MIX ASPHALT SURFACE COURSE, MIX "D", N70 (IL 9.5MM), 2"	PG 64-22	4% @ 70 GYR

THE UNIT WEIGHT USED TO CALCULATE ALL HOT-MIX ASPHALT SURFACE MIXTURE QUANTITIES IS 112 LBS/SY/IN.

F.A. RTE.	SECTION	COUNTY	TOTAL SHEETS	SHEET NO.
VAR.	2008-047 RS	LAKE	41	3
FED. ROAD DIST. NO. 1		ILLINOIS	HIGHWAY PROJECT	
CONTRACT NO. 60E96				

SUMMARY OF QUANTITIES			URBAN 100% STATE	CONSTRUCTION TYPE CODE				
CODE NO	ITEM	UNIT	TOTAL QUANTITIES					
				I000-2A				
40600200	BITUMINOUS MATERIALS (PRIME COAT)	TON	17	17				
40600300	AGGREGATE (PRIME COAT)	TON	85	85				
40600400	MIXTURE FOR CRACKS, JOINTS, AND FLANGEWAYS	TON	127	127				
40600982	HOT-MIX ASPHALT SURFACE REMOVAL - BUTT JOINT	SO YD	1950	1950				
40603340	HOT-MIX ASPHALT SURFACE COURSE, MIX "D", N70	TON	4722	4722				
44000157	HOT-MIX ASPHALT SURFACE REMOVAL, 2"	SO YD	42159	42159				
67000400	ENGINEER'S FIELD OFFICE, TYPE A	CAL MO	3	3				
67100100	MOBILIZATION	L SUM	1	1				
70300100	SHORT-TERM PAVEMENT MARKING	FOOT	19582	19582				
70301000	WORK ZONE PAVEMENT MARKING REMOVAL	SO FT	6528	6528				
*78000200	THERMOPLASTIC PAVEMENT MARKING - LINE 4"	FOOT	293736	293736				
*78100100	RAISED REFLECTIVE PAVEMENT MARKER	EACH	1224	1224				
78300200	RAISED REFLECTIVE PAVEMENT MARKER REMOVAL	EACH	1224	1224				
X0322256	TEMPORARY INFORMATION SIGNING	SO FT	1131	1131				

SUMMARY OF QUANTITIES				CONSTRUCTION TYPE CODE				
CODE NO	ITEM	UNIT	TOTAL QUANTITIES					

\* SPECIALTY ITEM

REVISIONS	
NAME	DATE

ILLINOIS DEPARTMENT OF TRANSPORTATION  
SUMMARY OF QUANTITIES

PLOT DATE: 6/26/2008

6/26/2008  
C:\projects\136008\design\aa.dgn

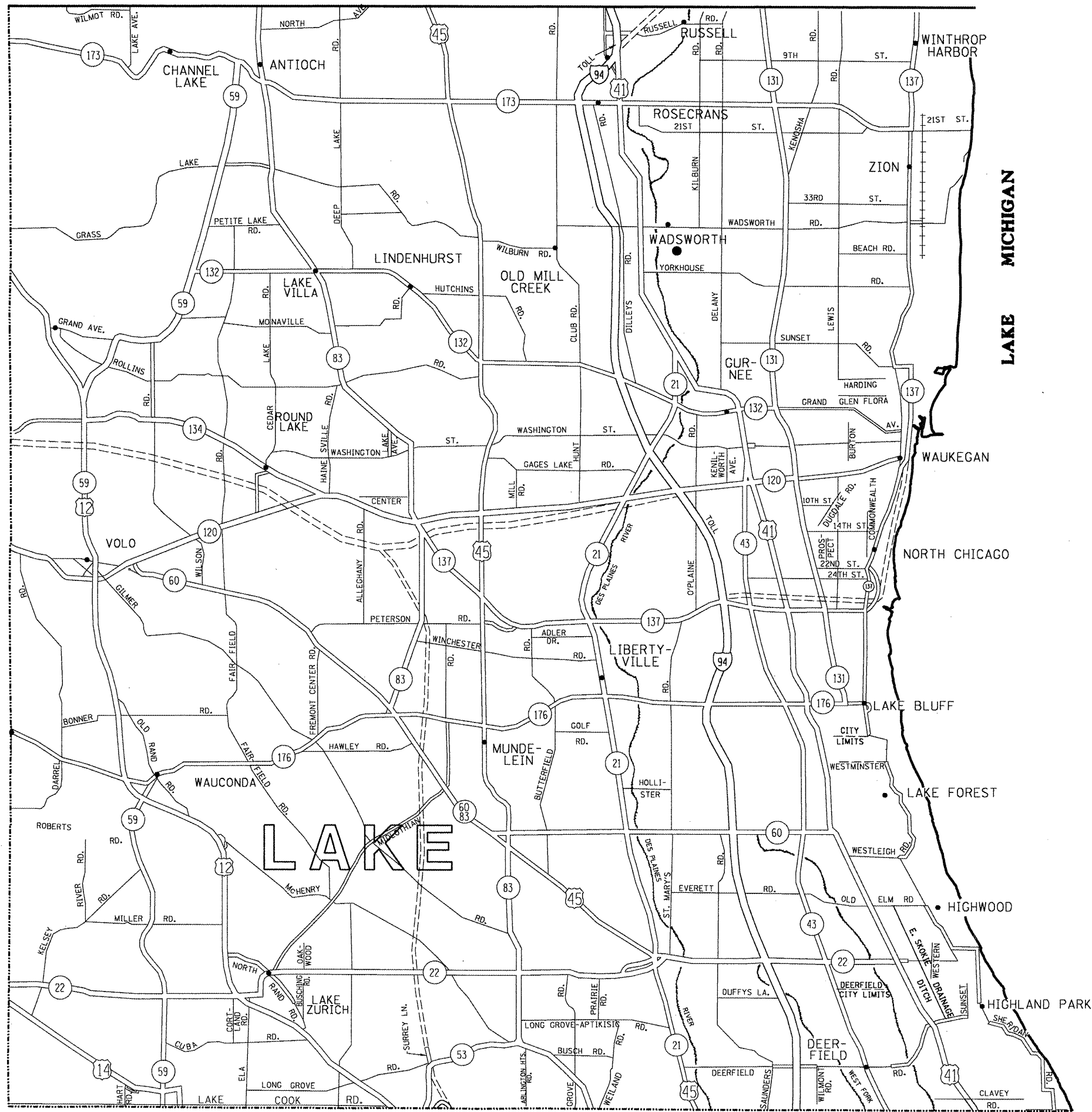

FILE NAME =  
 c:\projects\136008\design\_aa.dgn

USER NAME = wilgreendp  
 DRAWN -  
 CHECKED -  
 DATE -

DESIGNED -  
 REVISED -  
 REVISED -  
 REVISED -  
 REVISED -

**STATE OF ILLINOIS  
 DEPARTMENT OF TRANSPORTATION**

**GENERAL LOCATION MAP - LAKE COUNTY**  
 SCALE: SHEET NO. OF SHEETS STA. TO STA.

F.A. RTE. VAR.	SECTION	COUNTY	TOTAL SHEETS	SHEET NO.
	2008-047 RS	LAKE	41	4
CONTRACT NO. 60E96				
FED. ROAD DIST. NO. 1 ILLINOIS FED. AID PROJECT				



WEST LAKE COUNTY ROUTE SEGMENT	MILL & RESURFACE (SY)
IL 53 (Hicks Rd.)	547
IL RTE 59 (EXIT RAMP- NORTH OF IL 134) FROM US 12 TO IL 173	1422
IL 59	1759
IL 60 ( Peterson Road to IL 83 and IL 83 to IL 21)	801
IL RTE 60 (PETERSON ROAD TO IL RTE 120)	1715
IL 60/83	838
IL Rte 83	2588
IL 83 ( Peterson Road to IL 60 and IL 60 to Lake Cook Road)	2619
IL RTE 120 (MILL ROAD TO US 12 / IL RTE 59)	2401
IL RTE 132 (GRAND AVENUE) - FROM U.S. ROUTE 45 TO IL ROUTE 59	1545
IL RTE 134 (IL RTE 120 TO US 12 / IL 59)	160
IL RTE 173 (Old Mill Creek Road to IL RTE 83)	2354
IL RTE 173, (IL RTE 83 to FOX RIVER BRIDGE)	260
IL 176 (IL 21 to Roberts Road (McHenry County Line))	2088
IL Rte 176 (Old Rockland Rd to EJ & E Railroad)	1903
Midlothian Road ( IL 176 to IL 22)	1087
Lake Cook Road	1418
US 12 (NORTHBOUND)	5161
US 12 (SOUTHBOUND)	4192
US 14	2035
US 45 (STATE LINE ROAD TO PETERSON ROAD)	4132
US 45 ( Peterson Road to IL 83 and IL 83 to IL 21)	1134
<b>SUMMARY TOTALS:</b>	<b>42159</b>
	<b>SY</b>

FILE NAME =  
 c:\projects\dl136008\design.ee.dgn

USER NAME = wilgreendp	DESIGNED -	REVISED -
	DRAWN -	REVISED -
PLOT SCALE = 100.0000' / IN.	CHECKED -	REVISED -
PLOT DATE = 6/26/2008	DATE -	REVISED -

**STATE OF ILLINOIS  
 DEPARTMENT OF TRANSPORTATION**

**SUMMARY OF PATCHING SCHEDULE  
 LAKE COUNTY**

SCALE: SHEET NO. OF SHEETS STA. TO STA.

F.A. RTE.	SECTION	COUNTY	TOTAL SHEETS	SHEET NO.
VAR.	2008-047 RS	LAKE	41	5
CONTRACT NO. 60E96				
FED. ROAD DIST. NO. 1 (ILLINOIS) FED. AID PROJECT				



ROUTE: IL RTE 59 (EXIT RAMP- NORTH OF IL 134) FROM US 12 TO IL 173

CROSS STREETS		DIRECTION (EB/WB) (NB/SB)	LANE NO. (1, 2, 3)	PAVEMENT PATCH WIDTH	PAVEMENT PATCH LENGTH	REPAIR AREA (SQ FT)	REPAIR AREA (SQ YD)
FROM	TO						
U.S. 12		NB	1	12	4	48	5
		NB	1	12	6	72	8
		NB	1	12	6	72	8
		NB	1	12	6	72	8
		NB	1	12	6	72	8
		NB	1	12	6	72	8
		NB	1	12	8	96	11
		NB	2	12	8	96	11
		NB	1	12	10	120	13
		NB	1	6	20	120	13
		NB	1	6	20	120	13
		SB	1	12	6	72	8
		SB	1	12	6	72	8
		CL	1	3	50	150	17
		CL	1	3	50	150	17
		CL	1	3	100	300	33
		CL	1	3	100	300	33
		CL	1	3	200	600	67
		CL	1	3	200	600	67
	DEVLIN ROAD	CL	1	3	300	900	100
DEVLIN ROAD		SB	1	12	6	72	8
		SB	1	12	6	72	8
		CL	CL	3	50	150	17
		CL	CL	3	50	150	17
		CL	CL	3	50	150	17
		CL	CL	3	50	150	17
		CL	CL	3	50	150	17
		CL	CL	3	50	150	17
		CL	CL	3	50	150	17
		CL	CL	3	50	150	17
		CL	CL	3	100	300	33
		CL	CL	3	100	300	33
		CL	CL	3	100	300	33
	WILSON ROAD	CL	CL	3	200	600	67
WILSON ROAD		NB	1	12	8	96	11
		NB	1	20	6	120	13
		SB	1	12	6	72	8
		SB	1	12	6	72	8
		SB	1	12	6	72	8
		SB	2	12	10	120	13
		SB	2	12	10	120	13
		CL	CL	3	50	150	17
		CL	CL	3	50	150	17
		SB	1	3	50	150	17
		SB	1	3	50	150	17
		SB	1	3	50	150	17
		SB	1	3	50	150	17
		SB	1	3	50	150	17
		SB	1	3	50	150	17
		SB	1	3	50	150	17
		NB	1	3	50	150	17
CON'T WILSON ROAD		NB	1	3	50	150	17

TOTALS: 2526 997 SY

CONTINUED ON THE NEXT SHEET

...projects\136008\design\_aa.dgn 6/26/2008 1:12:58 PM User=wilgreendp

ROUTE: **IL RTE 59 (EXIT RAMP- NORTH OF IL 134) FROM US 12 TO IL 173**

CROSS STREETS		DIRECTION (EB/WB) (NB/SB)	LANE NO. (1, 2, 3)	PAVEMENT PATCH WIDTH	PAVEMENT PATCH LENGTH	REPAIR AREA (SQ FT)	REPAIR AREA (SQ YD)
FROM	TO						
CON'T WILSON ROAD		NB	1	3	50	150	17
		NB	1	3	50	150	17
		NB	1	3	50	150	17
		NB	1	3	100	300	33
		SB	1	3	100	300	33
		SB	1	3	100	300	33
		SB	1	3	100	300	33
	MONAVILLE ROAD	NB	1	3	200	600	67
MONAVILLE ROAD		NB	1	12	4	48	5
		NB	1	12	6	72	8
		SB	1	12	4	48	5
		SB	1	12	4	48	5
		SB	1	12	4	48	5
		SB	1	12	4	48	5
		SB	1	12	6	72	8
	IL. RTE 132	NB	1	3	100	300	33
IL. RTE 132		NB	1	12	4	48	5
		NB	1	12	4	48	5
		NB	1	12	4	48	5
		NB	1	12	6	72	8
		NB	1	12	6	72	8
		NB	1	12	6	72	8
		NB	1	12	10	120	13
		SB	1	12	4	48	5
	GRASS LAKE ROAD	SB	1	12	6	72	8
GRASS LAKE ROAD		NB	1	12	6	72	8
		SB	1	12	6	72	8
		SB	1	12	6	72	8
	IL. RTE 173	CL	CL	3	50	150	17

TOTALS: 994 425 SY

ROUTE: IL 59

CROSS STREETS		DIRECTION (EB/WB) (NB/SB)	LANE NO. (1, 2, 3)	PAVEMENT PATCH WIDTH	PAVEMENT PATCH LENGTH	REPAIR AREA (SQ FT)	REPAIR AREA (SQ YD)
FROM	TO						
US 12	Roberts Rd	SB	1	12	4	48	5
		SB	1	12	4	48	5
		SB	1	6	20	120	13
		SB	1	12	4	48	5
		SB	1	3	200	600	67
		SB	1	12	6	72	8
		SB	1	12	6	72	8
		SB	1	12	4	48	5
		SB	1	12	4	48	5
		SB	RT EP	2	100	150	17
Kelsey	Miller	SB	1	12	4	48	5
		SB	1	12	4	48	5
		SB	1	12	4	48	5
Miller	IL 22	SB	1	12	50	600	67
		SB	1	4	100	400	44
		SB	1	4	50	200	22
		SB	1	4	20	80	9
		SB	1	4	10	40	4
		SB	RT EP	3	200	600	67
		SB	1	4	50	200	22
		SB	RT EP	3	75	225	25
		SB	1	12	4	48	5
		SB	1	12	4	48	5
		SB	1	12	4	48	5
		SB	1	4	150	600	67
		SB	1	12	10	120	13
		SB	1	12	4	48	5
		SB	1	12	4	48	5
IL 22	Cuba	SB	1	4	100	400	44
		SB	1	12	4	48	5
		SB	1	12	4	48	5
		SB	1	12	4	48	5
		SB	1	4	50	200	22
		SB	RT EP	3	200	600	67
		SB	1	12	6	72	8
		SB	RT EP	3	200	600	67
		SB	1	12	4	48	5
		SB	1	12	4	48	5
		SB	1	12	4	48	5
		SB	RT EP	2	200	300	33
		SB	1	12	4	48	5
		SB	1	12	4	48	5
		SB	1	12	4	48	5
		SB		6	50	300	33
		SB	LT EP	3	300	900	100
		SB	LT TN	6	20	120	13
		SB	LT TN	12	6	72	8
Cuba	US 14	SB	LT EP	3	100	300	33
		SB	1	12	6	72	8
		SB	1	12	6	72	8
		SB	1	12	4	48	5
		SB	1	12	12	144	16
		SB	1	12	12	144	16
		SB	1	4	50	200	22

ROUTE: IL 59

CROSS STREETS		DIRECTION (EB/WB) (NB/SB)	LANE NO. (1, 2, 3)	PAVEMENT PATCH WIDTH	PAVEMENT PATCH LENGTH	REPAIR AREA (SQ FT)	REPAIR AREA (SQ YD)
FROM	TO						
US 14	Lake Cook Rd	SB	1	12	6	72	8
		SB	1	12	6	72	8
		SB	1	4	12	48	5
		SB	1	12	4	48	5
		SB	1	12	4	48	5
		SB	1	12	4	48	5
		SB	1	12	4	48	5
Lake Cook Rd	US 14	NB	1	4	12	48	5
		NB	1	4	12	48	5
		NB	1	4	12	48	5
US 14	Cuba	NB	1	4	20	80	9
		NB	1	4	12	48	5
		NB	1	4	12	48	5
		NB	1	4	100	400	44
		NB	RT EP	2	300	450	50
		NB	1	12	4	48	5
		NB	1	12	4	48	5
		NB	1	4	20	80	9
		NB	1	12	4	48	5
Cuba	IL 22	NB	1	12	4	48	5
		NB	1	12	4	48	5
		NB	1	4	20	80	9
		NB	1	6	15	90	10
		NB	1	12	4	48	5
		NB	1	12	4	48	5
		NB	1	12	4	48	5
		NB	1	12	4	48	5
		NB	1	12	4	48	5
		NB	1	12	4	48	5
		NB	1	12	4	48	5
		NB	1	4	50	200	22
		NB	1	12	4	48	5
		NB	1	12	4	48	5
IL 22	Miller	NB	1	4	50	200	22
		NB	1	12	4	48	5
		NB	1	12	4	48	5
		NB	1	4	20	80	9
		NB	1	12	4	48	5
		NB	1	12	4	48	5
		NB	1	4	30	120	13
Miller	Kelsey	NB	1	12	4	48	5
		NB	1	12	4	48	5
		NB	1	12	4	48	5
		NB	1	12	4	48	5
Roberts	US 12	NB	1	6	50	300	33
		NB	1	6	20	120	13
		NB	1	4	12	48	5
		NB	1	12	6	72	8
		NB	CL	2	200	300	33
		NB	1	8	12	96	11
		NB	1	12	4	48	5
		NB	1	12	4	48	5
		NB	1	4	20	80	9
		NB	1	12	4	48	5
		NB	1	12	4	48	5
		NB	1	12	4	48	5
		NB	1	12	10	120	13
		NB	1	12	6	72	8

TOTALS: 3738 1759 SY

FILE NAME = c:\projects\136008\design\_aa.dgn  
 USER NAME = wilgreendp  
 PLOT SCALE = 100.0000 "/>

DESIGNED -  
 DRAWN -  
 CHECKED -  
 DATE -  
 REVISED -  
 REVISED -  
 REVISED -  
 REVISED -

STATE OF ILLINOIS  
 DEPARTMENT OF TRANSPORTATION

PATCHING SCHEDULE  
 IL 59

SCALE: SHEET NO. OF SHEETS STA. TO STA.

F.A. RTE. SECTION COUNTY TOTAL SHEETS SHEET NO.  
 VAR. 2008-047 RS LAKE 41 9  
 CONTRACT NO. 60E96  
 FED. ROAD DIST. NO. 1 ILLINOIS FED. AID PROJECT

ROUTE: IL 60 ( Peterson Road to IL 83 and IL 83 to IL 21)

CROSS STREETS		DIRECTION (EB/WB) (NB/SB)	LANE NO. (1, 2, 3)	PAVEMENT PATCH WIDTH	PAVEMENT PATCH LENGTH	REPAIR AREA (SQ FT)	REPAIR AREA (SQ YD)
FROM	TO						
Peterson Road	Freemont Center Road	EB		12	4	48	5
		EB		12	4	48	5
		EB		12	4	48	5
		EB	RT E/P	3	100	300	33
Freemont Center Road	IL 83	EB		12	4	48	5
		EB		12	4	48	5
		EB		12	4	48	5
		EB		12	10	120	13
		EB		12	4	48	5
		EB		12	4	48	5
		EB		12	4	48	5
		EB		12	4	48	5
		EB		12	4	48	5
		EB		12	4	48	5
		EB	RT E/P	3	150	450	50
Note: The area will IL 60 and IL 83 run concurrently will be compiled on a separate spreadsheet.							
IL 83	US 45	EB					
US 45	Butterfield Road	EB					
Butterfield Road	IL 21	EB					
IL 21	Butterfield Road	WB					
Butterfield Road	US 45	WB	1	12	12	144	16
		WB	1	3	4	12	1
US 45	IL 83	WB					
Note: The area will IL 60 and IL 83 run concurrently will be compiled on a separate spreadsheet.							
IL 83	Freemont Center Road	WB	CL	3	300	900	100
		WB		3	500	1500	167
		WB		3	200	600	67
		WB		12	30	360	40
		WB		12	20	240	27
		WB		12	20	240	27
		WB		12	12	144	16
		WB		12	12	144	16
		WB		12	20	240	27
		WB		12	10	120	13
		WB		12	20	240	27
		WB		12	10	120	13
		WB		12	12	144	16
		WB		12	10	120	13
		WB		12	20	240	27
		WB		12	6	72	8
Freemont Center Road	Peterson Road	WB		12	15	180	20

TOTALS: 1541 801 SY

FILE NAME = c:\projects\136008\design_aa.dgn	USER NAME = wjlgreendp	DESIGNED -	REVISED -	<b>STATE OF ILLINOIS DEPARTMENT OF TRANSPORTATION</b>	<b>PATCHING SCHEDULE IL 60</b>			F.A. RTE.	SECTION	COUNTY	TOTAL SHEETS	SHEET NO.
		DRAWN -	REVISED -					VAR.	2008-047 RS	LAKE	41	10
		CHECKED -	REVISED -		SCALE:	SHEET NO. OF	SHEETS	STA.	TO STA.	CONTRACT NO. 60E96		
		DATE -	REVISED -		FED. ROAD DIST. NO. 1   ILLINOIS   FED. AID PROJECT							





ROUTE: IL 60/ 83

CROSS STREETS		DIRECTION (EB/WB) (NB/SB)	LANE NO. (1, 2, 3)	PAVEMENT PATCH WIDTH	PAVEMENT PATCH LENGTH	REPAIR AREA (SQ FT)	REPAIR AREA (SQ YD)
FROM	TO						
N/O IL 176	IL 176	SB	1	12	12	144	16
		SB	1	12	4	48	5
		SB	1	12	4	48	5
		SB	1	12	4	48	5
IL 176	Hawley	SB	1	12	6	72	8
		SB	1	12	4	48	5
		SB	1	12	4	48	5
		SB	1	12	6	72	8
Hawley	Midlothian	SB	1	12	12	144	16
		SB	CL	3	300	900	100
		SB	1	4	30	120	13
		SB	1	4	20	80	9
		SB	CL	3	200	600	67
		SB	1	4	10	40	4
Midlothian	Diamond Lake Rd	SB	1	3	200	600	67
		SB	1	12	4	48	5
		SB	1	12	4	48	5
		SB	1	12	4	48	5
		SB	1	12	6	72	8
		SB	1	12	6	72	8
		SB	1	12	4	48	5
		SB	1	12	4	48	5
		SB	1	12	4	48	5
		SB	1	4	20	80	9
		SB	1	4	10	40	4
		SB	1	12	4	48	5
		SB	1	12	4	48	5
		SB	1	12	4	48	5
		SB	1	4	30	120	13
		SB	1	12	6	72	8
		SB	1	12	6	72	8
		SB	1	12	4	48	5
IL 60	Diamond Lake Rd	NB	2	12	4	48	5
		NB	2	12	4	48	5
Diamond Lake Rd	Midlothian	NB	1	12	4	48	5
		NB	1	12	4	48	5
		NB	1	12	4	48	5
		NB	1	12	4	48	5
		NB	1	12	4	48	5
		NB	1	12	6	72	8
Midlothian	Hawley	NB	1	3	700	2100	233
		NB	1	12	6	72	8
		NB	1	4	12	48	5
		NB	1	4	50	200	22
Hawley	N/O IL 176	NB	1	12	4	48	5
		NB	1	12	4	48	5
		NB	1	4	50	200	22
		NB	1	12	4	48	5
		NB	1	12	4	48	5
		NB	1	3	100	300	33

TOTALS: 1908 838 SY

FILE NAME = c:\projects\136008\design\_aa.dgn  
 USER NAME = w1lgreendp  
 PLOT SCALE = 100.0000' / IN.  
 PLOT DATE = 6/26/2008

DESIGNED -  
 DRAWN -  
 CHECKED -  
 DATE -  
 REVISED -  
 REVISED -  
 REVISED -  
 REVISED -

STATE OF ILLINOIS  
 DEPARTMENT OF TRANSPORTATION

PATCHING SCHEDULE  
 IL 60/83

SCALE: SHEET NO. OF SHEETS STA. TO STA.

F.A. RTE.	SECTION	COUNTY	TOTAL SHEETS	SHEET NO.
VAR.	2008-047 RS	LAKE	41	12
FED. ROAD DIST. NO. 1 ILLINOIS FED. AID PROJECT			CONTRACT NO. 60E96	



ROUTE: IL Rte 83

CROSS STREETS		DIRECTION (EB/WB) (NB/SB)	LANE NO. (1, 2, 3)	PAVEMENT PATCH WIDTH	PAVEMENT PATCH LENGTH	REPAIR AREA (SQ FT)	REPAIR AREA (SQ YD)
FROM	TO						
IL Rte 173		N/B	1	12	100	1200	133
	Total 8 Each	N/B	1	6	12	72	64
	Total 3 Each	S/B	1	6	12	72	24
		N/B	1	4	20	80	9
	Total 5 Ea	N/B & S/B	1	12	6	72	40
		N/B	1	6	20	120	13
		N/B	1	6	12	72	8
		S/B	1	6	30	180	20
		N/B	1	6	100	600	67
		S/B	1	12	6	72	8
		N/B	1	4	20	80	9
		N/B	1	6	20	120	13
	Total 4 Ea	N/B & S/B	1	8	12	96	43
		S/B	1	6	100	600	67
	Total 2 Ea	N/B & S/B	1	6	12	72	16
	Total 6 E	S/B	1	6	12	72	48
	WISCONSIN ST LINE	S/B	1	3	50	150	17
IL Rte 173		S/B	1	6	20	120	13
	Total 2 Each	S/B	1	6	12	72	16
	Total 4 Each	N/B	1	12	6	72	32
		S/B	1	4	10	40	4
		S/B	1	4	100	400	44
		S/B	1	4	50	200	22
		S/B	C/L	4	100	400	44
		N/B	1	4	300	1200	133
		S/B	1	4	50	200	22
	Total 2	N/B & S/B	1	12	6	72	16
		S/B	1	12	8	96	11
		C.L.	1	3	150	450	50
	Total 2	S/B	1	4	25	100	22
		N/B	1	12	6	72	8
	Total 2	N/B & S/B	1	12	6	72	16
		C.L.	C.L.	3	50	150	17
	Grass Lake Rd. (Tot 2)	N/B & S/B	1	6	12	72	16
Grass Lake Road		N/B	1	4	250	1000	111
		N/B	1	6	12	72	8
		S/B	1	4	100	400	44
		S/B	1	4	100	400	44
	Total 2 Each	N/B & S/B	1	12	6	72	16
		C.L.	C.L.	3	100	300	33
		S/B	1	4	150	600	67
	Total 2 Each	S/B	1	12	6	72	16
	Total 2 Each	N/B & S/B	1	12	6	72	16

ROUTE: IL Rte 83

CROSS STREETS		DIRECTION (EB/WB) (NB/SB)	LANE NO. (1, 2, 3)	PAVEMENT PATCH WIDTH	PAVEMENT PATCH LENGTH	REPAIR AREA (SQ FT)	REPAIR AREA (SQ YD)
FROM	TO						
	Petite Lake (Tot 3 Ea)	N/B, Med, S/B	1	12	6	72	24
IL 132		S/B	1	6	25	150	17
	Total 2 Each	N/B & S/B	1	6	12	72	16
	Total 2 Each	N/B & S/B	1	6	12	72	16
	Total 2 Each	N/B & S/B	1	6	12	72	16
		C.L.	1	2	100	150	17
	Total 2 Each	N/B & S/B	1	12	6	72	16
		S/B	1	12	6	72	8
		S/B	1	4	10	40	4
		C.L.	C.L.	2	2000	3000	333
		S/B	1	2	100	150	17
		S/B	1	4	100	400	44
	Rollins Rd (Total 3 Ea)	N/B & S/B	1	12	6	72	24
Rollins Road		S/B	1	2	200	300	33
		N/B	1	2	200	300	33
		N/B	1	12	6	72	8
	Total 2 Each	N/B & S/B	1	12	6	72	16
	Lake Street (Tot 2 Ea)	N/B & S/B	1	2	150	225	50
		S/B	1	6	6	36	4
		C/L	C/L	2	200	300	33
		N/B	1	12	6	72	8
		N/B	1	12	6	72	8
	2 EA, TOT 4	N/B & S/B	1	12	6	72	32
		N/B	1	4	100	400	44
	Total 2 Ea	N/B & S/B	1	12	6	72	16
		S/B	1	2	50	75	8
	3EA, TOTAL 6	N/B & S/B	1	6	12	72	48
	IL Rte 137	N/B & S/B	1	6	12	72	16
IL Rte 137		S/B	1	6	10	60	7
		S/B	1	6	20	120	13
		N/B	1	4	50	200	22
	2 Each	N/B & S/B	1	12	8	96	21
		S/B	1	6	100	600	67
		N/B	1	4	50	200	22
		S/B	1	6	20	120	13
	3 Each	N/B	1	12	6	72	24
		N/B	1	4	50	200	22
	Petersen Rd	S/B	1	4	50	200	22
TOTALS						5910	2588 SY

ROUTE: IL 83 ( Peterson Road to IL 60 and IL 60 to Lake Cook Road)

CROSS STREETS		DIRECTION (EB/WB) (NB/SB)	LANE NO. (1, 2, 3)	PAVEMENT PATCH WIDTH	PAVEMENT PATCH LENGTH	REPAIR AREA (SQ FT)	REPAIR AREA (SQ YD)
FROM	TO						
Peterson Road	IL 60	SB		3	100	300	33
		SB		12	6	72	8
		SB		12	10	120	13
		SB		12	10	120	13
		SB		12	8	96	11
IL 60	US 45	SB	1	12	4	48	5
		SB	1	12	4	48	5
		SB	1	12	20	240	27
		SB	1	12	4	48	5
		SB	2	12	6	72	8
		SB	Lane Line	3	300	900	100
US 45	Gilmer Road	SB	2	12	12	144	16
		SB	Lane Line	3	200	600	67
		SB	1	12	4	48	5
		SB	1	12	4	48	5
		SB	1	12	4	48	5
		SB	1	12	4	48	5
		SB	1	12	4	48	5
		SB	1	12	4	48	5
		SB	1	12	12	144	16
		SB	1	12	4	48	5
		SB	1	12	4	48	5
		SB	2	12	4	48	5
		SB	1	12	4	48	5
		SB	1	12	12	144	16
		SB	1	12	4	48	5
		SB	2	12	4	48	5
Gilmer Road	IL 22	SB	1	12	12	144	16
		SB	2	12	12	144	16
		SB	1	12	4	48	5
		SB	2	12	12	144	16
		SB	1	12	4	48	5
		SB	1	12	4	48	5
IL 22	IL 53	SB	1	12	12	144	16
		SB	2	12	12	144	16
		SB	2	12	4	48	5
		SB	2	12	4	48	5
IL 53	Arlington Heights Road	SB	2	12	12	144	16
		SB	1	12	12	144	16
		SB	2	12	12	144	16
		SB	2	12	12	144	16
Arlington Heights Road	Buffalo Grove Road	SB	LT Turn	12	12	144	16
		SB	2	12	4	48	5
		SB	1	12	4	48	5
		SB	2	12	4	48	5
		SB	2	12	12	144	16
		SB	2	12	4	48	5

ROUTE: IL 83 ( Peterson Road to IL 60 and IL 60 to Lake Cook Road)

CROSS STREETS		DIRECTION (EB/WB) (NB/SB)	LANE NO. (1, 2, 3)	PAVEMENT PATCH WIDTH	PAVEMENT PATCH LENGTH	REPAIR AREA (SQ FT)	REPAIR AREA (SQ YD)
FROM	TO						
Buffalo Grove Road	Lake Cook Road	SB	2	3	200	600	67
		SB	2	3	200	600	67
		SB	2	3	100	300	33
		SB	1	3	1000	3000	333
		SB	1	12	4	48	5
Lake Cook Road	Buffalo Grove Road	NB	1	3	2000	6000	667
		NB	2	12	4	48	5
		NB	2	12	4	48	5
		NB	Lane Line	3	1000	3000	333
		NB	2	3	100	300	33
Buffalo Grove Road	Arlington Heights Road	NB	1	12	4	48	5
		NB	2	12	4	48	5
		NB	1	12	4	48	5
		NB	2	12	4	48	5
		NB	1	12	4	48	5
		NB	1	12	4	48	5
		NB	2	12	4	48	5
		NB	1	12	4	48	5
Arlington Heights Road	IL 53	NB	1	12	4	48	5
		NB	2	12	12	144	16
IL 53	IL 22	NB	1	12	4	48	5
IL 22	Gilmer Road	NB	2	12	4	48	5
		NB	1	12	4	48	5
		NB	1	12	4	48	5
		NB	2	12	4	48	5
		NB	1	12	4	48	5
Gilmer Road	US 45	NB	CL	2	100	150	17
		NB	1	12	4	48	5
		NB	1	12	4	48	5
US 45	IL 60	NB	2	12	10	120	13
		NB	1	3	300	900	100
IL 60	Winchester Road	NB		12	100	1200	133
		NB		12	4	48	5
		NB		12	4	48	5
		NB		12	4	48	5
		NB		3	100	300	33
		NB		12	12	144	16
Winchester Road	Peterson Road	NB		12	6	72	8
		NB		12	4	48	5
		NB		12	4	48	5

TOTALS: 6252 2619 SY

ROUTE: IL RTE 120 (MILL ROAD TO US 12 / IL RTE 59)

ROUTE: IL RTE 120 (MILL ROAD TO US 12 / IL RTE 59)

CROSS STREETS		DIRECTION (EB/WB) (NB/SB)	LANE NO. (1, 2, 3)	PAVEMENT PATCH WIDTH	PAVEMENT PATCH LENGTH	REPAIR AREA (SQ FT)	REPAIR AREA (SQ YD)
FROM	TO						
MILL ROAD		EB	1	12	4	48	5
		EB	1	12	4	48	5
		EB	1	12	4	48	5
		EB	1	12	4	48	5
		EB	1	12	6	72	8
		EB	1	12	6	72	8
		EB	1	12	6	72	8
		EB	1	12	10	120	13
		EB	1	12	10	120	13
		WB	1	12	6	72	8
		WB	1	12	6	72	8
		CL	CL	3	100	300	33
		CL	CL	3	100	300	33
		EB	1	3	100	300	33
		EB	1	3	100	300	33
US RTE 45	US RTE 45	EB	1	3	100	300	33
		EB	1	12	6	72	8
		EB	1	12	6	72	8
		EB	1	12	6	72	8
		EB	1	12	6	72	8
		EB	1	12	6	72	8
		EB	1	12	6	72	8
		EB	1	12	10	120	13
		EB	1	12	10	120	13
		EB	1	12	10	120	13
		EB	1	12	200	2400	267
		EB	1	12	30	360	40
		WB	1	12	6	72	8
		WB	1	12	6	72	8
		WB	1	12	6	72	8
		WB	1	12	6	72	8
		WB	1	3	200	600	67
		WB	1	3	50	150	17
	CL	1	3	100	300	33	
	CL	1	3	100	300	33	
	CL	1	3	100	300	33	
	EB	1	3	100	300	33	
	EB	1	3	100	300	33	
	EB	1	3	100	300	33	
	EB	1	3	200	600	67	
	EB	1	3	200	600	67	
	EB	1	3	200	600	67	
	EB	1	3	200	600	67	
	EB	1	3	200	600	67	
IL RTE 83	IL RTE 83	EB	1	3	200	600	67
		EB	1	12	10	120	13
		WB	1	12	4	48	5
		WB	1	12	4	48	5
		WB	1	12	6	72	8
	WB	1	3	100	300	33	
CON'T ALLEGHANY RD	ALLEGHANY ROAD	WB	1	3	100	300	33
		EB	1	12	6	72	8
		EB	1	12	6	72	8
		EB	1	12	6	72	8
		EB	1	12	6	72	8
		EB	1	12	6	72	8
		EB	1	12	8	96	11

CROSS STREETS		DIRECTION (EB/WB) (NB/SB)	LANE NO. (1, 2, 3)	PAVEMENT PATCH WIDTH	PAVEMENT PATCH LENGTH	REPAIR AREA (SQ FT)	REPAIR AREA (SQ YD)
FROM	TO						
CON'T ALLEGHANY RD		EB	1	6	50	300	33
		EB	1	12	10	120	13
		EB	1	3	100	300	33
		EB	1	3	100	300	33
		EB	1	3	100	300	33
		EB	1	3	100	300	33
		EB	1	3	100	300	33
		EB	1	3	100	300	33
		EB	1	3	100	300	33
		EB	1	3	100	300	33
		EB	1	3	100	300	33
		EB	1	3	200	600	67
		WB	1	12	4	48	5
		WB	1	12	6	72	8
		WB	1	12	6	72	8
HAINSEVILLE ROAD	HAINSEVILLE ROAD	WB	1	12	10	120	13
		EB	1	12	6	72	8
		EB	1	12	6	72	8
		EB	1	12	10	120	13
		EB	1	12	10	120	13
		WB	1	12	4	48	5
		WB	1	12	4	48	5
		WB	1	12	4	48	5
		WB	1	12	4	48	5
		WB	1	12	4	48	5
	WB	1	12	6	72	8	
	WB	1	12	6	72	8	
	WB	2	12	4	48	5	
	WB	2	12	4	48	5	
	CL	CL	3	50	150	17	
	CL	CL	3	100	300	33	
FAIRFIELD ROAD	FAIRFIELD ROAD	CL	CL	3	200	600	67
		EB	1	12	4	48	5
		EB	1	12	6	72	8
		EB	1	12	6	72	8
		EB	2	12	6	72	8
		EB	2	12	6	72	8
		WB	1	12	4	48	5
		WB	1	12	4	48	5
		WB	1	12	4	48	5
		WB	1	12	4	48	5
	WB	1	12	6	72	8	
	WB	1	12	6	72	8	
	EB	1	6	30	180	20	
	EB	1	3	50	150	17	
	CL	CL	3	100	300	33	
	CL	CL	3	100	300	33	
	EB	1	3	100	300	33	
	EB	1	3	100	300	33	
	US RTE 12	EB	1	3	100	300	33

NOTE: OTHER LOCATION  
600' W/O CHAPEL HILL RD. E/O CITY OF MCHENRY EB 1 12 30 360 40

TOTALS: 5178 2401 SY

CROSS STREETS		DIRECTION (EB/WB) (NB/SB)	LANE NO. (1, 2, 3)	PAVEMENT PATCH WIDTH	PAVEMENT PATCH LENGTH	REPAIR AREA (SQ FT)	REPAIR AREA (SQ YD)
FROM	TO						
U.S 45		WB	2	12	6	72	8
		WB	2	4	10	40	4
		WB	2	4	10	40	4
		C/L	C/L	2	150	225	25
		WB	2	6	10	60	7
		EB	2	12	6	72	8
		EB	2	12	6	72	8
		EB	1	6	12	72	8
		EB	2	12	10	120	13
		EB	1	4	12	48	5
		EB	2	4	6	24	3
	SAND LAKE ROAD	EB	2	4	6	24	3
SAND LAKE ROAD		WB	1	12	15	180	20
		CL	1	3	10	30	3
		WB	2	4	15	60	7
		WB	1	12	8	96	11
		WB	1	12	8	96	11
		WB	1	12	6	72	8
		WB	1	12	6	72	8
		EB	2	6	10	60	7
		EB	1	4	25	100	11
		CL	CL	2	50	75	8
		EB	2	6	12	72	8
		EB	1	6	12	72	8
		EB	2	6	12	72	8
		EB	1	6	12	72	8
		EB	1	6	12	72	8
		EB	2	6	12	72	8
		EB	1	6	12	72	8
	DEEP LAKE ROAD	EB	2	6	12	72	8
DEEP LAKE ROAD		CL	CL	2	24	36	4
		WB	1	12	40	480	53
		WB	2	12	40	480	53
		WB	1	12	60	720	80
		CL	CL	3	30	90	10
		WB	2	12	100	1200	133
		WB	1	12	6	72	8
		WB	2	12	6	72	8
		WB	1	12	6	72	8
		WB	2	12	6	72	8
		WB	1	12	6	72	8
		WB	2	12	6	72	8
		WB	1	12	6	72	8
		WB	2	12	6	72	8
		WB	2	12	6	72	8
		WB	2	12	6	72	8
		WB	2	12	6	72	8
		WB	2	12	6	72	8
		WB	2	12	6	72	8
		WB	2	12	6	72	8
		WB	2	12	6	72	8
		WB	2	12	6	72	8
		WB	2	12	6	72	8
	IL RTE 83	WB	2	12	6	72	8
		CL	CL	3	100	300	33

CROSS STREETS		DIRECTION (EB/WB) (NB/SB)	LANE NO. (1, 2, 3)	PAVEMENT PATCH WIDTH	PAVEMENT PATCH LENGTH	REPAIR AREA (SQ FT)	REPAIR AREA (SQ YD)
FROM	TO						
DEEP LAKE ROAD		CL	CL	3	300	900	100
		CL	CL	3	200	600	67
		CL	CL	3	200	600	67
		EB	1	6	12	72	8
		EB	2	6	12	72	8
		EB	2	6	12	72	8
		CL	CL	3	200	600	67
		EB	1	12	20	240	27
		EB	1	6	12	72	8
		EB	1	6	12	72	8
		EB	1	6	12	72	8
		EB	1	6	12	72	8
		EB	1	6	12	72	8
		EB	1	6	12	72	8
		EB	1	6	12	72	8
		EB	1	6	12	72	8
	IL RTE 83	WB	1	12	6	72	8
		WB	1	12	6	72	8
		WB	1	12	6	72	8
		WB	1	12	6	72	8
		WB	1	6	10	60	7
		WB	1	6	10	60	7
		WB	1	6	12	72	8
		WB	1	6	12	72	8
		WB	1	6	12	72	8
		WB	1	6	12	72	8
		WB	1	6	20	120	13
		WB	1	6	20	120	13
		WB	1	6	20	120	13
		WB	1	6	20	120	13
		WB	1	6	20	120	13
		WB	1	6	20	120	13
		WB	1	6	20	120	13
		WB	1	6	20	120	13
		WB	1	6	20	120	13
		WB	1	6	20	120	13
		WB	1	6	20	120	13
		WB	1	6	20	120	13
		WB	1	6	20	120	13
		EB	2	10	12	120	13
		EB	1	6	12	72	8
		EB	1	6	12	72	8
		EB	1	6	12	72	8
		EB	1	6	12	72	8
		EB	1	6	30	180	20
		EB	1	4	20	80	9
		EB	1	4	20	80	9
		EB	1	12	15	180	20
		EB	1	6	12	72	8
		EB	1	6	12	72	8
		EB	1	6	12	72	8
		EB	1	6	12	72	8
		EB	1	6	12	72	8
		EB	1	6	12	72	8
		EB	1	6	12	72	8
	FAIRFIELD ROAD	EB	1	6	12	72	8
FAIRFIELD ROAD		WB	1	12	10	120	13
		WB	1	12	6	72	8
		WB	1	12	6	72	8
		WB	1	12	6	72	8
		WB	1	12	6	72	8
		WB	1	4	10	40	4
		EB	1	12	12	144	16
		EB	1	6	12	72	8
		EB	1	6	12	72	8
		EB	1	6	12	72	8
	IL RTE 59	EB	1	6	12	72	8

TOTALS: 2509 1545 SY

02:\projects\136008\design\_aa.dgn 6/26/2008 4:54:45 PM User:wilgreendp

ROUTE: IL RTE 134 (IL RTE 120 TO US 12 / IL 59)

CROSS STREETS		DIRECTION (EB/WB) (NB/SB)	LANE NO. (1, 2, 3)	PAVEMENT PATCH WIDTH	PAVEMENT PATCH LENGTH	REPAIR AREA (SQ FT)	REPAIR AREA (SQ YD)
FROM	TO						
IL RTE 120		EB	1	12	4	48	5
		EB	1	12	4	48	5
	FAIRFIELD ROAD	WB	1	12	4	48	5
FAIRFIELD ROAD		EB	1	12	4	48	5
		EB	1	12	4	48	5
		EB	1	12	4	48	5
		EB	1	12	4	48	5
		EB	1	12	6	72	8
		EB	1	12	6	72	8
		EB	1	12	6	72	8
		WB	1	12	4	48	5
		WB	1	12	4	48	5
		EB	1	3	50	150	17
	WILSON ROAD	CL	CL	3	100	300	33
WILSON ROAD		WB	1	12	6	72	8
		WB	1	12	6	72	8
	US 12 / IL 59	WB	1	3	50	150	17

TOTALS:

270

160  
SY



ROUTE: IL RTE 173 (Old Mill Creek Road to IL RTE 83)

CROSS STREETS		DIRECTION (EB/WB) (NB/SB)	LANE NO. (1, 2, 3)	PAVEMENT PATCH WIDTH	PAVEMENT PATCH LENGTH	REPAIR AREA (SQ FT)	REPAIR AREA (SQ YD)
FROM	TO						
Old Mill Creek Road	Total 20	WB	1,2	12	6	1440	160
		W/B	1	6	14	84	9
		WB	1	3	250	750	83
		W/B	1	3	100	300	33
		W/B	1	12	150	1800	200
	TOTAL 14 EA	WB	1,2	6	12	72	112
		EB	2	3	150	450	50
		EB	RAMP	8	8	64	7
		EB	1	3	100	300	33
		EB	2	3	75	225	25
		EB	1	6	18	108	12
	HUNT CLUB ROAD	EB	2	8	100	800	89
HUNT CLUB ROAD		WB	1	6	12	72	8
		WB	1	12	15	180	20
		CL	1	3	30	90	10
	TOTAL 2 EA	WB	1	12	6	72	16
		WB	1	3	50	150	17
		WB	1	3	200	600	67
		WB	1	3	100	300	33
		WB	1	12	6	72	8
		EB	C.L.	3	100	300	33
		EB	1	12	25	300	33
		WB	1	3	100	300	33
		WB	1	12	25	300	33
		WB	1	3	60	180	20
		WB	1	6	60	360	40
		WB	C.L.	3	200	600	67
		WB	1	3	50	150	17
		WB	1	12	6	72	8
		WB	1	6	20	120	13
		WB	1	3	100	300	33
		EB	1	12	30	360	40
		EB	1	3	100	300	33
		EB	1	6	15	90	10
		EB	1	8	50	400	44
		C.L.	C.L.	3	50	150	17
		EB	1	12	20	240	27
	US RTE 45	WB	1	3	100	300	33
US RTE 45	TOTAL 10 EA	WB/EB	1	12	6	72	80
	TOTAL 2 EA	WB/EB	1	12	8	96	21
		EB	1	6	20	120	13
	TOTAL 2 EA	C.L. & WB		3	100	300	67
		WB	1	8	12	96	11
		WB	1	4	12	48	5
		EB	1	6	10	60	7
	SAVAGE RD.TOT 4 EA	WB	SHLD	4	100	400	178
SAVAGE RD	TOTAL 8 EA	WB/EB	1	12	6	72	64
	TOTAL 2 EA	C.L. & WB		3	100	300	67
	TOTAL 2 EA	WB	1	4	6	24	5
	DEEP LAKE ROAD	W/B	SHLDR	4	200	800	89
DEEP LAKE ROAD	TOTAL 12 EA	WB/EB	1	12	6	72	96
	TOTAL 2 EA	WB/EB	SHLDR	4	100	400	89
	IL RTE 83	C.L.	C.L.	3	100	300	33

TOTALS: 3299 2354 SY

ROUTE: IL RTE 173, (IL RTE 83 to FOX RIVER BRIDGE)

CROSS STREETS		DIRECTION (EB/WB) (NB/SB)	LANE NO. (1, 2, 3)	PAVEMENT PATCH WIDTH	PAVEMENT PATCH LENGTH	REPAIR AREA (SQ FT)	REPAIR AREA (SQ YD)
FROM	TO						
IL RTE 83		WB	1	3	200	600	67
	TOTAL 4 EA	WB/EB	1	12	6	72	32
		WB	1	12	25	300	33
	IL RTE 59	EB	1	20	20	400	44
IL RTE 59		CL	CL	3	200	600	67
	FOX RIVER BRIDGE	WB	1	6	25	150	17

TOTALS: 476 260 SY

FILE NAME =  
c:\projects\135008\design\_aa.dgn  
PLOT SCALE = 1/8" = 100.0000' / IN.  
PLOT DATE = 6/26/2008

USER NAME = wilgreendp	DESIGNED -	REVISED -
DRAWN -	REVISED -	REVISED -
CHECKED -	REVISED -	REVISED -
DATE -	REVISED -	REVISED -

STATE OF ILLINOIS  
DEPARTMENT OF TRANSPORTATION

PATCHING SCHEDULE  
IL 173

SCALE: SHEET NO. OF SHEETS STA. TO STA.

F.A. RTE.	SECTION	COUNTY	TOTAL SHEETS	SHEET NO.
VAR.	2008-047 RS	LAKE	41	18
FED. ROAD DIST. NO. 1 [ILLINOIS] FED. AID PROJECT			CONTRACT NO. 60E96	

ROUTE: IL 176 (IL 21 to Roberts Road (McHenry County Line))

CROSS STREETS		DIRECTION (EB/WB) (NB/SB)	LANE NO. (1, 2, 3)	PAVEMENT PATCH WIDTH	PAVEMENT PATCH LENGTH	REPAIR AREA (SQ FT)	REPAIR AREA (SQ YD)
FROM	TO						
IL 21	Garfield	WB		0	0	0	0
Garfield	Butterfield Road	WB		12	4	48	5
		WB		12	4	48	5
		WB		12	4	48	5
		WB	LT E/P	3	100	300	33
Butterfield Raod	Hawley Street	WB		12	4	48	5
		WB		12	4	48	5
		WB		4	100	400	44
		WB		12	6	72	8
		WB		12	4	48	5
		WB	LT E/P	3	200	600	67
Hawley Street	US 45	WB		12	10	120	13
		WB		12	30	360	40
US 45	Midlothian	WB		12	20	240	27
		WB		12	4	48	5
		WB		12	4	48	5
		WB		12	4	48	5
		WB	CL	3	100	300	33
		WB	CL	3	500	1500	167
Midlothian	IL 60/83	WB		12	12	144	16
		WB		12	10	120	13
IL 60/83	Gilmer Road	WB		12	6	72	8
		WB		12	20	240	27
Gilmer Road	Fairfield Road	WB		12	6	72	8
		WB		12	4	48	5
		WB		12	4	48	5
		WB		12	4	48	5
		WB		12	4	48	5
Fairfield Road	Main Street (Wauconda)	WB		12	4	48	5
		WB	CL	3	200	600	67
Main Street (Wauconda)	US 12	WB		12	4	48	5
		WB		12	6	72	8
		WB		12	4	48	5
		WB		12	6	72	8
US 12	Darrel Road	WB	RT E/P	3	200	600	67
		WB		12	6	72	8
		WB		12	10	120	13
		WB	CL	3	150	450	50
Darrel Road	Roberts Road	WB		12	4	48	5
		WB		12	6	72	8
		WB		12	6	72	8
						0	0
Roberts Road	Darrel Road	EB		3	100	300	33
		EB		12	4	48	5
		EB		12	4	48	5
		EB		12	4	48	5
		EB		12	4	48	5
Darrel Road	US 12	EB		12	4	48	5
		EB		12	4	48	5
		EB		12	40	480	53
		EB		12	4	48	5
		EB		12	4	48	5
		EB		12	4	48	5
		EB		12	4	48	5
		EB		24	50	1200	133
US 12	Main Street (Wauconda)	EB		12	4	48	5
		EB		12	4	48	5
		EB		12	4	48	5
		EB		12	4	48	5
		EB		12	6	72	8
		EB		12	4	48	5
		EB		12	4	48	5

ROUTE: IL 176 (IL 21 to Roberts Road (McHenry County Line))

CROSS STREETS		DIRECTION (EB/WB) (NB/SB)	LANE NO. (1, 2, 3)	PAVEMENT PATCH WIDTH	PAVEMENT PATCH LENGTH	REPAIR AREA (SQ FT)	REPAIR AREA (SQ YD)
FROM	TO						
		EB		12	4	48	5
		EB		12	4	48	5
		EB		12	4	48	5
Main Street (Wauconda)	Fairfield Road	EB				0	0
Fairfield Road	Gilmer Road	EB		12	10	120	13
		EB		12	4	48	5
		EB		12	4	48	5
		EB		12	4	48	5
		EB		12	4	48	5
		EB		12	10	120	13
		EB		12	4	48	5
Gilmer Road	IL 60/83	EB		12	4	48	5
		EB		12	20	240	27
		EB		12	20	240	27
		EB		12	20	240	27
		EB		12	6	72	8
		EB		12	25	300	33
		EB		12	25	300	33
		EB		12	6	72	8
		EB		12	6	72	8
		EB		12	4	48	5
IL 60/83	Midlothian	EB		12	6	72	8
		EB		12	10	120	13
		EB		12	4	48	5
		EB		12	4	48	5
		EB		12	10	120	13
Midlothian	US 45	EB		12	4	48	5
		EB		12	4	48	5
		EB		12	12	144	16
		EB		12	12	144	16
US 45	Hawley Street	EB		12	12	144	16
		EB		6	75	450	50
		EB		12	4	48	5
		EB		3	50	150	17
		EB		3	100	300	33
Hawley Street	Butterfield Road	EB		12	4	48	5
		EB		12	4	48	5
		EB	CL	3	200	600	67
		EB		12	4	48	5
		EB	CL	3	500	1500	167
		EB		3	150	450	50
Butterfield Road	Garfield Ave.	EB		12	4	48	5
		EB		12	4	48	5
		EB		12	4	48	5
		EB		12	4	48	5
		EB		12	4	48	5
		EB		12	4	48	5
		EB		12	4	48	5
		EB		12	4	48	5
		EB		12	12	144	16
		EB		6	20	120	13
		EB		12	6	72	8
		EB		12	6	72	8
		EB		12	4	48	5
		EB		12	4	48	5
		EB		12	4	48	5
		EB		12	4	48	5
Garfield Ave.	IL 21	EB		3	200	600	67
		EB		12	4	48	5
		EB		12	4	48	5
		EB		12	4	48	5

TOTALS: 3699 2088

FILE NAME = c:\projects\136008\design\_aa.dgn  
 USER NAME = wilgreendp  
 PLOT SCALE = 1/8" = 1' IN.  
 PLOT DATE = 6/26/2008

DESIGNED -	REVISOR -
DRAWN -	REVISOR -
CHECKED -	REVISOR -
DATE -	REVISOR -

STATE OF ILLINOIS  
 DEPARTMENT OF TRANSPORTATION

SCALE:	SHEET NO. OF SHEETS	STA. TO STA.
--------	---------------------	--------------

PATCHING SCHEDULE  
 IL 176

F.A. RTE. VAR.	SECTION 2008-047 RS	COUNTY LAKE	TOTAL SHEETS 41	SHEET NO. 19
CONTRACT NO. 60E96				

ROUTE: IL Rte 176 (Old Rockland Rd to EJ & E Railroad)

CROSS STREETS		DIRECTION (EB/WB) (NB/SB)	LANE NO. (1, 2, 3)	PAVEMENT PATCH WIDTH	PAVEMENT PATCH LENGTH	REPAIR AREA (SQ FT)	REPAIR AREA (SQ YD)
FROM	TO						
Old Rockland Rd	Entrance Ramp for I94	EB	2	12	4	48	5
Old Rockland Rd	Entrance Ramp for I94	EB	1	12	4	48	5
Old Rockland Rd	Entrance Ramp for I94	EB	1	12	4	48	5
Old Rockland Rd	Entrance Ramp for I94	EB	2	12	4	48	5
Old Rockland Rd	Entrance Ramp for I94	EB	2	12	4	48	5
Old Rockland Rd	Entrance Ramp for I94	EB	1	12	4	48	5
Old Rockland Rd	Entrance Ramp for I94	EB	2	12	4	48	5
Old Rockland Rd	Entrance Ramp for I94	EB	1	12	4	48	5
Old Rockland Rd	Entrance Ramp for I94	EB	2	12	4	48	5
Old Rockland Rd	Entrance Ramp for I94	EB	1	12	4	48	5
Old Rockland Rd	Entrance Ramp for I94	EB	1	12	4	48	5
Old Rockland Rd	Entrance Ramp for I94	EB	1	3	250	750	83
Old Rockland Rd	Entrance Ramp for I94	EB	1	12	4	48	5
Old Rockland Rd	Entrance Ramp for I94	EB	2	12	4	48	5
Old Rockland Rd	Entrance Ramp for I94	EB	1	12	4	48	5
Old Rockland Rd	Entrance Ramp for I94	EB	1	12	4	48	5
Old Rockland Rd	Entrance Ramp for I94	EB	LT TL	3	200	600	67
Old Rockland Rd	Entrance Ramp for I94	EB	1	12	4	48	5
Old Rockland Rd	Entrance Ramp for I94	EB	LT TL	12	4	48	5
Old Rockland Rd	Entrance Ramp for I94	EB	2	12	4	48	5
Old Rockland Rd	Entrance Ramp for I94	EB	LT TL	12	4	48	5
Old Rockland Rd	Entrance Ramp for I94	EB	1	12	4	48	5
Old Rockland Rd	Entrance Ramp for I94	EB	1	12	4	48	5
Old Rockland Rd	Entrance Ramp for I94	EB	2	12	4	48	5
Old Rockland Rd	Entrance Ramp for I94	EB	1	12	4	48	5
Old Rockland Rd	Entrance Ramp for I94	EB	2	12	4	48	5
Old Rockland Rd	Entrance Ramp for I94	EB	2	12	4	48	5
Old Rockland Rd	Entrance Ramp for I94	EB	2	12	4	48	5
Old Rockland Rd	Entrance Ramp for I94	EB	2	12	4	48	5
Old Rockland Rd	Entrance Ramp for I94	EB	2	12	4	48	5
Old Rockland Rd	Entrance Ramp for I94	EB	2	12	4	48	5
Old Rockland Rd	Entrance Ramp for I94	EB	2	12	4	48	5
Old Rockland Rd	Entrance Ramp for I94	EB	2	12	4	48	5
Old Rockland Rd	Entrance Ramp for I94	EB	2	12	4	48	5
Old Rockland Rd	Entrance Ramp for I94	EB	LT TL	8	36	288	32
Old Rockland Rd	Entrance Ramp for I94	EB	1	12	4	48	5
Entrance Ramp for I94	Exit Ramp for I94	EB	2	12	4	48	5
Entrance Ramp for I94	Exit Ramp for I94	EB	2	12	4	48	5
Entrance Ramp for I94	Exit Ramp for I94	EB	1	12	4	48	5
Entrance Ramp for I94	Exit Ramp for I94	EB	2	12	4	48	5
Entrance Ramp for I94	Exit Ramp for I94	EB	2	12	4	48	5
Entrance Ramp for I94	Exit Ramp for I94	EB	2	12	4	48	5
Entrance Ramp for I94	Exit Ramp for I94	EB	2	12	4	48	5
Entrance Ramp for I94	Exit Ramp for I94	EB	2	12	4	48	5
Entrance Ramp for I94	Exit Ramp for I94	EB	2	12	4	48	5
Entrance Ramp for I94	Exit Ramp for I94	EB	2	12	4	48	5
Entrance Ramp for I94	Exit Ramp for I94	EB	2	12	4	48	5
Entrance Ramp for I94	Exit Ramp for I94	EB	2	12	4	48	5
Entrance Ramp for I94	Exit Ramp for I94	EB	2	12	4	48	5
Entrance Ramp for I94	Exit Ramp for I94	EB	2	12	4	48	5
Entrance Ramp for I94	Exit Ramp for I94	EB	2	12	4	48	5
Entrance Ramp for I94	Exit Ramp for I94	EB	2	12	4	48	5
Entrance Ramp for I94	Exit Ramp for I94	EB	2	12	4	48	5
Entrance Ramp for I94	Exit Ramp for I94	EB	2	12	4	48	5
Entrance Ramp for I94	Exit Ramp for I94	EB	2	12	4	48	5
Entrance Ramp for I94	Exit Ramp for I94	EB	2	12	4	48	5
Entrance Ramp for I94	Exit Ramp for I94	EB	1	3	700	2100	233
Entrance Ramp for I94	Exit Ramp for I94	EB	1	6	18	108	12
Entrance Ramp for I94	Exit Ramp for I94	EB	2	12	4	48	5
Entrance Ramp for I94	Exit Ramp for I94	EB	2	12	4	48	5
Entrance Ramp for I94	Exit Ramp for I94	EB	2	12	4	48	5
Entrance Ramp for I94	Exit Ramp for I94	EB	2	12	4	48	5
Entrance Ramp for I94	Exit Ramp for I94	EB	2	12	4	48	5
Entrance Ramp for I94	Exit Ramp for I94	EB	2	12	4	48	5
Entrance Ramp for I94	Exit Ramp for I94	EB	2	12	4	48	5
Entrance Ramp for I94	Exit Ramp for I94	EB	2	12	4	48	5
Entrance Ramp for I94	Exit Ramp for I94	EB	2	12	4	48	5
Entrance Ramp for I94	Exit Ramp for I94	EB	2	12	4	48	5
Entrance Ramp for I94	Exit Ramp for I94	EB	2	12	4	48	5
Entrance Ramp for I94	Exit Ramp for I94	EB	2	12	4	48	5
Exit Ramp for I94	Bradley Rd	EB	1	12	4	48	5
Exit Ramp for I94	Bradley Rd	EB	1	12	4	48	5
Exit Ramp for I94	Bradley Rd	EB	1	12	4	48	5

TOTALS: 4282 1903 SY

ROUTE: IL Rte 176 (Old Rockland Rd to EJ & E Railroad)

CROSS STREETS		DIRECTION (EB/WB) (NB/SB)	LANE NO. (1, 2, 3)	PAVEMENT PATCH WIDTH	PAVEMENT PATCH LENGTH	REPAIR AREA (SQ FT)	REPAIR AREA (SQ YD)
FROM	TO						
Exit Ramp for I94	Bradley Rd	EB	1	12	4	48	5
Exit Ramp for I94	Bradley Rd	EB	1	12	4	48	5
Exit Ramp for I94	Bradley Rd	EB	2	12	4	48	5
Exit Ramp for I94	Bradley Rd	EB	2	12	4	48	5
Exit Ramp for I94	Bradley Rd	EB	2	12	4	48	5
Exit Ramp for I94	Bradley Rd	EB	2	6	30	180	20
Bradley Rd	Railroad X-ing	EB	2	6	12	72	8
Bradley Rd	Railroad X-ing	EB	2	12	4	48	5
Bradley Rd	Railroad X-ing	EB	1	12	4	48	5
Bradley Rd	Railroad X-ing	EB	1	12	4	48	5
Bradley Rd	Railroad X-ing	EB	1	12	4	48	5
Bradley Rd	Railroad X-ing	EB	1	12	4	48	5
Bradley Rd	Railroad X-ing	EB	1	12	4	48	5
Bradley Rd	Railroad X-ing	EB	1	12	4	48	5
Bradley Rd	Railroad X-ing	EB	1	12	4	48	5
Railroad X-ing	Bradley Rd	WB	1	12	4	48	5
Railroad X-ing	Bradley Rd	WB	1	12	4	48	5
Railroad X-ing	Bradley Rd	WB	1	12	4	48	5
Railroad X-ing	Bradley Rd	WB	1	12	4	48	5
Railroad X-ing	Bradley Rd	WB	1	12	4	48	5
Bradley Rd	Exit Ramp for I94	WB	1	12	4	48	5
Bradley Rd	Exit Ramp for I94	WB	1	3	50	150	17
Bradley Rd	Exit Ramp for I94	WB	1	3	50	150	17
Bradley Rd	Exit Ramp for I94	WB	1	12	4	48	5
Bradley Rd	Exit Ramp for I94	WB	LT TL	3	50	150	17
Exit Ramp for I94	Entrance Ramp for I94	WB	1	3	25	75	8
Exit Ramp for I94	Entrance Ramp for I94	WB	1	3	800	2400	267
Exit Ramp for I94	Entrance Ramp for I94	WB	2	12	4	48	5
Exit Ramp for I94	Entrance Ramp for I94	WB	2	12	4	48	5
Exit Ramp for I94	Entrance Ramp for I94	WB	2	12	4	48	5
Exit Ramp for I94	Entrance Ramp for I94	WB	2	12	4	48	5
Exit Ramp for I94	Entrance Ramp for I94	WB	2	12	4	48	5
Exit Ramp for I94	Entrance Ramp for I94	WB	2	12	4	48	5
Exit Ramp for I94	Entrance Ramp for I94	WB	2	12	4	48	5
Exit Ramp for I94	Entrance Ramp for I94	WB	2	12	4	48	5
Exit Ramp for I94	Entrance Ramp for I94	WB	RT TL	12	4	48	5
Exit Ramp for I94	Entrance Ramp for I94	WB	RT TL	12	4	48	5
Exit Ramp for I94	Entrance Ramp for I94	WB	RT TL	12	4	48	5
Exit Ramp for I94	Entrance Ramp for I94	WB	RT TL	3	250	750	83
Exit Ramp for I94	Entrance Ramp for I94	WB	1	12	4	48	5
Exit Ramp for I94	Entrance Ramp for I94	WB	2	12	4	48	5
Exit Ramp for I94	Entrance Ramp for I94	WB	2	12	4	48	5
Entrance Ramp for I94	Old Rockland Rd	WB	1	3	800	2400	267
Entrance Ramp for I94	Old Rockland Rd	WB	1	12	4	48	5
Entrance Ramp for I94	Old Rockland Rd	WB	2	12	4	48	5
Entrance Ramp for I94	Old Rockland Rd	WB	2	12	4	48	5
Entrance Ramp for I94	Old Rockland Rd	WB	2	12	4	48	5
Entrance Ramp for I94	Old Rockland Rd	WB	2	12	4	48	5
Entrance Ramp for I94	Old Rockland Rd	WB	1	12	4	48	5
Entrance Ramp for I94	Old Rockland Rd	WB	2	12	4	48	5
Entrance Ramp for I94	Old Rockland Rd	WB	2	12	4	48	5
Entrance Ramp for I94	Old Rockland Rd	WB	2	12	4	48	5
Entrance Ramp for I94	Old Rockland Rd	WB	2	12	4	48	5
Entrance Ramp for I94	Old Rockland Rd	WB	2	12	4	48	5
Entrance Ramp for I94	Old Rockland Rd	WB	2	12	4	48	5
Entrance Ramp for I94	Old Rockland Rd	WB	2	12	4	48	5
Entrance Ramp for I94	Old Rockland Rd	WB	2	12	4	48	5
Entrance Ramp for I94	Old Rockland Rd	WB	2	12	4	48	5
Entrance Ramp for I94	Old Rockland Rd	WB	2	12	4	48	5
Entrance Ramp for I94	Old Rockland Rd	WB	2	12	4	48	5
Entrance Ramp for I94	Old Rockland Rd	WB	2	3	25	75	8

FILE NAME =	USER NAME = wlgreendp	DESIGNED -	REVISED -	<p align="center"><b>STATE OF ILLINOIS</b> <b>DEPARTMENT OF TRANSPORTATION</b></p>	<p align="center"><b>PATCHING SCHEDULE</b> <b>IL 176</b></p>	F.A. RTE.	SECTION	COUNTY	TOTAL SHEETS	SHEET NO.	
ca\projects\136000\design\aa.dgn	PLLOT SCALE = 100.0000' / IN.	DRAWN -	REVISED -			VAR.	2008-047 RS	LAKE	41	20	
	PLLOT DATE = 6/26/2008	CHECKED -	REVISED -			CONTRACT NO. 60E96					
...projects\136000\design_aa.dgn 6/26/2008 1:17:51 PM User=wlgreendp		DATE -	REVISED -			SCALE:	SHEET NO.	OF	SHEETS	STA.	TO STA.



ROUTE: Midlothian Road ( IL 176 to IL 22)

CROSS STREETS		DIRECTION (EB/WB) (NB/SB)	LANE NO. (1, 2, 3)	PAVEMENT PATCH WIDTH	PAVEMENT PATCH LENGTH	REPAIR AREA (SQ FT)	REPAIR AREA (SQ YD)
FROM	TO						
IL 176	Hawley Street	SB		12	4	48	5
Hawley Street	IL 60/83	SB		12	12	144	16
		SB		12	4	48	5
		SB		12	4	48	5
		SB	CL	3	200	600	67
		SB		12	6	72	8
		SB		12	4	48	5
IL 60/83	Gilmer Road	SB		12	6	72	8
		SB		12	4	48	5
		SB	LT E/P	2	200	300	33
		SB		12	4	48	5
		SB		12	10	120	13
		SB		12	20	240	27
		SB	RT E/P	2	200	300	33
		SB	CL	3	200	600	67
		SB		12	10	120	13
		SB	RT E/P	2	200	300	33
Gilmer Road	Old McHenry Road	SB		12	4	48	5
		SB		12	4	48	5
		SB		12	4	48	5
		SB		12	4	48	5
		SB		12	30	360	40
		SB	Rt Turn	12	6	72	8
		SB		12	4	48	5
		SB		12	25	300	33
Old McHenry Road	Oakwood	SB		12	4	48	5
		SB		12	4	48	5
		SB		12	4	48	5
		SB		12	4	48	5
Oakwood	IL 22	SB		12	4	48	5
		SB		12	4	48	5
				12			
IL 22	Oakwood	NB		12	6	72	8
		NB		12	25	300	33
		NB		12	4	48	5
Oakwood	Old McHenry Road	NB		12	12	144	16
		NB		12	4	48	5
		NB		12	100	1200	133
		NB		12	4	48	5
		NB		12	50	600	67
Old McHenry Road	Gilmer Road	NB		12	4	48	5
		NB		12	4	48	5

ROUTE: Midlothian Road ( IL 176 to IL 22)

CROSS STREETS		DIRECTION (EB/WB) (NB/SB)	LANE NO. (1, 2, 3)	PAVEMENT PATCH WIDTH	PAVEMENT PATCH LENGTH	REPAIR AREA (SQ FT)	REPAIR AREA (SQ YD)
FROM	TO						
Roberts Road	Darrel Road	NB		12	6	72	8
		NB		12	6	72	8
		NB		12	4	48	5
		NB		12	4	48	5
		NB		12	12	144	16
		NB		12	4	48	5
		NB		12	150	450	50
Gilmer Road	IL 60/83	NB		12	4	48	5
		NB		12	4	48	5
		NB		12	4	48	5
		NB		12	10	120	13
		NB		12	6	72	8
		NB		12	6	72	8
		NB		12	4	48	5
		NB		12	4	48	5
		NB		12	4	48	5
		NB		12	4	48	5
		NB		12	4	48	5
		NB	CL	3	150	450	50
IL 60/83	Hawley Street	NB		12	4	48	5
		NB		12	4	48	5
		NB		12	4	48	5
		NB	RT E/P	3	150	450	50
Hawley Street	IL 176	NB		12	4	48	5
		NB		12	10	120	13
		NB		12	10	120	13

TOTALS: 1978 1087 SY





ROUTE: US Rte. 12 (NORTHBOUND)

CROSS STREETS		DIRECTION (EB/WB) (NB/SB)	LANE NO. (1, 2, 3)	PAVEMENT PATCH WIDTH	PAVEMENT PATCH LENGTH	REPAIR AREA (SQ FT)	REPAIR AREA (SQ YD)
FROM	TO						
<b>Old McHenry</b>	<b>IL 59</b>	NB	1	4	12	48	5
		NB	1	4	12	48	5
		NB	1	4	12	48	5
		NB	1	4	12	48	5
		NB	1	4	12	48	5
		NB	1	4	4	16	2
		NB	1	12	4	48	5
		NB	1	12	12	144	16
		NB	1	12	12	144	16
		NB	2	4	12	48	5
		NB	2	4	12	48	5
		NB	2	4	12	48	5
		NB	2	4	12	48	5
		NB	2	4	12	48	5
		NB	2	4	6	24	3
		NB	2	4	4	16	2
		NB	2	12	12	144	16
		NB	2	12	12	144	16
		NB	CL	2	1500	2250	250
		NB	LT EP	2	1500	2250	250
<b>IL 59</b>	<b>Bonner</b>	NB	2	4	12	48	5
		NB	2	12	6	72	8
		NB	2	12	6	72	8
<b>Case</b>	<b>IL 120</b>	NB	2	12	4	48	5
		NB	2	12	4	48	5
		NB	2	4	12	48	5
<b>Vojo Village Rd.</b>	<b>Fox Lake Rd.</b>	NB	CL	3	250	750	83
HMA Sect 1		NB	2	4	4	16	2
		NB	2	4	4	16	2
		NB	1	5	4	20	2
		NB	2	10	4	40	4
		NB	CL	3	150	450	50
		NB	2	12	4	48	5
		NB	2	12	4	48	5
		NB	1	12	4	48	5
		NB	2	12	4	48	5
		NB	CL	3	200	600	67
		NB	1	12	4	48	5
		NB	1	4	50	200	22
		NB	2	12	4	48	5
HMA Sect 2		NB	1	12	4	48	5
		NB	2	12	4	48	5
		NB	1	4	10	40	4
		NB	1	12	4	48	5
		NB	CL	2	200	300	33
		NB	1	12	4	48	5
Dry land bridge		NB	2	12	4	48	5
		NB	2	12	4	48	5
		NB	2	12	4	48	5
		NB	2	12	4	48	5
HMA sect 3		NB	CL	2	200	300	33
		NB	1	12	4	48	5
		NB	1	12	4	48	5
		NB	2	12	4	48	5

ROUTE: US Rte. 12 (NORTHBOUND)

CROSS STREETS		DIRECTION (EB/WB) (NB/SB)	LANE NO. (1, 2, 3)	PAVEMENT PATCH WIDTH	PAVEMENT PATCH LENGTH	REPAIR AREA (SQ FT)	REPAIR AREA (SQ YD)
FROM	TO						
<b>Fox Lake Rd</b>	<b>Molidor</b>	NB	1	4	30	120	13
		NB	1	12	4	48	5
		NB	CL	2	200	300	33
		NB	1	12	4	48	5
		NB	1	12	4	48	5
		NB	2	6	15	90	10
		NB	2	12	4	48	5
		NB	CL	2	100	150	17
		NB	1	12	4	48	5
		NB	1	12	4	48	5
		NB	2	12	4	48	5
		NB	2	12	4	48	5
		NB	1	12	4	48	5
		NB	2	12	4	48	5
		NB	1	12	4	48	5
		NB	2	12	4	48	5
		NB	2	12	4	48	5
		NB	1	12	4	48	5
		NB	2	12	4	48	5
		NB	1	12	4	48	5
		NB	2	12	4	48	5
		NB	1	12	4	48	5
		NB	2	12	4	48	5
		NB	1	12	4	48	5
		NB	2	12	4	48	5
		NB	2	12	10	120	13
		NB	2	12	4	48	5
		NB	1	12	4	48	5
		NB	1	12	4	48	5
		NB	2	6	15	90	10
		NB	1	12	4	48	5
		NB	2	12	4	48	5
		NB	1	12	4	48	5
		NB	2	12	4	48	5
		NB	1	12	4	48	5
		NB	2	6	50	300	33
		NB	1	12	4	48	5
		NB	2	12	4	48	5
		NB	2	6	15	90	10
		NB	2	6	25	150	17
		NB	1	12	4	48	5
		NB	1	12	4	48	5
		NB	CL	2	150	225	25
		NB	1	12	4	48	5
		NB	1	12	4	48	5
		NB	2	12	4	48	5
		NB	1	12	4	48	5
<b>Molidor</b>	<b>IL 134</b>	NB	1	12	6	72	8
		NB	1	12	6	72	8
		NB	2	6	6	36	4
		NB	1	12	4	48	5
		NB	1	12	4	48	5
		NB	1	12	4	48	5
		NB	1	12	4	48	5
		NB	2	12	4	48	5
		NB	2	12	4	48	5
		NB	CL	2	100	150	17
		NB	1	6	15	90	10
		NB	1	12	4	48	5
		NB	1	12	4	48	5
		NB	2	12	4	48	5
		NB	1	12	4	48	5
		NB	2	12	4	48	5
		NB	1	12	4	48	5
		NB	1	12	6	72	8
		NB	2	12	4	48	5
		NB	1	12	4	48	5
		NB	1	12	6	72	8

CONTINUED ON THE NEXT SHEET









ROUTE: US Rte. 12 (SOUTHBOUND)

CROSS STREETS		DIRECTION (EB/WB) (NB/SB)	LANE NO. (1, 2, 3)	PAVEMENT PATCH WIDTH	PAVEMENT PATCH LENGTH	REPAIR AREA (SQ FT)	REPAIR AREA (SQ YD)
FROM	TO						
<b>Miller</b>	<b>Old Rand</b>	SB	1	4	12	48	5
		SB	1	4	12	48	5
		SB	1	4	12	48	5
		SB	1	4	12	48	5
		SB	1	4	12	48	5
		SB	1	4	12	48	5
		SB	1	4	12	48	5
		SB	1	4	12	48	5
		SB	1	12	6	72	8
		SB	1	12	6	72	8
		SB	1	12	6	72	8
		SB	1	12	6	72	8
		SB	1	12	4	48	5
		SB	1	12	4	48	5
		SB	1	12	4	48	5
		SB	1	12	4	48	5
		SB	1	6	20	120	13
		SB	1	6	20	120	13
		SB	1	6	12	72	8
		SB	1	6	12	72	8
		SB	2	4	12	48	5
		SB	2	4	12	48	5
		SB	2	4	12	48	5
		SB	2	4	12	48	5
		SB	2	4	12	48	5
		SB	2	4	12	48	5
		SB	2	12	6	72	8
		SB	2	12	6	72	8
		SB	2	12	4	48	5
		SB	2	12	4	48	5
		SB	2	12	4	48	5
		SB	2	12	4	48	5
		SB	2	4	20	80	9
		SB	2	6	20	120	13
		SB	2	6	12	72	8
		SB	2	6	12	72	8
<b>Old Rand</b>	<b>IL 22</b>	SB	1	4	12	48	5
		SB	1	4	12	48	5
		SB	1	12	6	72	8
		SB	1	12	6	72	8
		SB	1	12	6	72	8
		SB	1	12	4	48	5
		SB	1	12	4	48	5
		SB	1	12	4	48	5
		SB	1	12	4	48	5
		SB	1	4	20	80	9
		SB	1	4	20	80	9
		SB	1	6	20	120	13
		SB	1	6	20	120	13
		SB	1	6	20	120	13
		SB	1	6	20	120	13
		SB	1	6	12	72	8
		SB	1	6	12	72	8

ROUTE: US Rte. 12 (SOUTHBOUND)

CROSS STREETS		DIRECTION (EB/WB) (NB/SB)	LANE NO. (1, 2, 3)	PAVEMENT PATCH WIDTH	PAVEMENT PATCH LENGTH	REPAIR AREA (SQ FT)	REPAIR AREA (SQ YD)
FROM	TO						
<b>Old Rand</b>	<b>IL 22</b>	SB	1	6	12	72	8
		SB	1	6	12	72	8
		SB	1	6	50	300	33
		SB	1	6	50	300	33
		SB	RT EP	2	1500	2250	250
		SB	CL	2	1500	2250	250
<b>S. Old Rand</b>		SB	HT SC	6	100	600	67
<b>Old Rand</b>	<b>Quentin</b>	SB	2	12	4	48	5
		SB	2	12	4	48	5
<b>Quentin</b>	<b>Deer Park</b>	SB	2	12	4	48	5
<b>Deer Park</b>	<b>Plum Grove</b>	SB	1	12	4	48	5
		SB	2	12	4	48	5

TOTALS: 15322 4192 SY

FILE NAME = c:\projects\136008\design\_aa.dgn  
 USER NAME = wilgreendp  
 PLOT SCALE = 100.0000' / IN.  
 PLOT DATE = 6/26/2008

DESIGNED -	REVISED -
DRAWN -	REVISED -
CHECKED -	REVISED -
DATE -	REVISED -

**STATE OF ILLINOIS  
DEPARTMENT OF TRANSPORTATION**

**PATCHING SCHEDULE  
US 12 (SOUTHBOUND)**

SCALE: SHEET NO. OF SHEETS STA. TO STA.

F.A. RTE.	SECTION	COUNTY	TOTAL SHEETS	SHEET NO.
VAR.	2008-047 RS	LAKE	41	28
FED. ROAD DIST. NO. 1 ILLINOIS FED. AID PROJECT			CONTRACT NO. 60E96	















ROUTE: US 45 (STATE LINE ROAD TO PETERSON ROAD)

CROSS STREETS		DIRECTION (EB/WB) (NB/SB)	LANE NO. (1, 2, 3)	PAVEMENT PATCH WIDTH	PAVEMENT PATCH LENGTH	REPAIR AREA (SQ FT)	REPAIR AREA (SQ YD)
FROM	TO						
CASEY ROAD		NB	2	12	6	72	8
		NB	2	12	6	72	8
		NB	2	12	6	72	8
		SB	1	12	6	72	8
		SB	1	12	6	72	8
		SB	1	12	6	72	8
		SB	1	12	6	72	8
		SB	1	12	6	72	8
		SB	1	12	6	72	8
		SB	1	12	6	72	8
		SB	1	12	6	72	8
		SB	1	12	6	72	8
		SB	1	12	6	72	8
		SB	1	12	6	72	8
		SB	1	12	6	72	8
		SB	1	12	6	72	8
		SB	1	12	6	72	8
		SB	2	12	6	72	8
		SB	2	12	6	72	8
		SB	2	12	6	72	8
		SB	2	12	6	72	8
		SB	2	12	6	72	8
		SB	2	12	6	72	8
		SB	2	12	6	72	8
		SB	2	12	6	72	8
		SB	2	12	6	72	8
		SB	2	12	6	72	8
		SB	2	12	6	72	8
		SB	2	12	6	72	8
		SB	2	12	6	72	8
		CL	CL	3	50	150	17
		CL	CL	3	50	150	17
		CL	CL	3	100	300	33
	PETERSON ROAD	CL	CL	3	200	600	67

TOTALS: 8564 4132  
SY

...projects\136000\design\_sa.dgn 6/26/2008 1:22:22 PM User=wilgreendp

ROUTE: US 45 ( Peterson Road to IL 83 and IL 83 to IL 21)

CROSS STREETS		DIRECTION (EB/WB) (NB/SB)	LANE NO. (1, 2, 3)	PAVEMENT PATCH WIDTH	PAVEMENT PATCH LENGTH	REPAIR AREA (SQ FT)	REPAIR AREA (SQ YD)
FROM	TO						
Peterson Road	IL 176	SB					
IL 176	Hawley Street	SB	2	4	12	48	5
Hawley Street	Diamond Lake Road	SB	2	4	10	40	4
		SB	1	12	4	48	5
		SB	2	12	4	48	5
		SB	2	2	100	150	17
		SB	2	12	4	48	5
		SB	2	12	4	48	5
Diamond Lake Road	IL 60	SB	CL	3	150	450	50
		SB	1	8	12	96	11
		SB	2	8	12	96	11
		SB	Lane Line	3	300	900	100
		SB	1	4	12	48	5
		SB	2	4	12	48	5
		SB	2	12	4	48	5
		SB	1	6	12	72	8
		SB	2	6	12	72	8
		SB	2	4	12	48	5
		SB	Lane Line	3	100	300	33
		SB	1	6	12	72	8
		SB	2	6	12	72	8
		SB	CL	3	300	900	100
		SB	1	4	12	48	5
		SB	2	12	6	72	8
		SB	2	12	4	48	5
		SB	2	12	4	48	5
		SB	1	12	4	48	5
		SB	1	12	4	48	5
		SB	1	12	4	48	5
		SB	2	12	4	48	5
		SB	1	4	20	80	9
		SB	1	4	20	80	9
IL 60	IL 83	SB	1	4	12	48	5
		SB	1	4	12	48	5
IL 83	Butterfield Road	SB		12	4	48	5
(2 Lane Section)		SB		12	4	48	5
		SB		12	4	48	5
		SB		12	4	48	5
		SB		4	12	48	5
Butterfield Road	Buffalo Grove Road	SB		12	4	48	5
		SB		6	10	60	7
		SB		12	4	48	5
		SB		12	4	48	5
		SB		3	100	300	33

ROUTE: US 45 ( Peterson Road to IL 83 and IL 83 to IL 21)

CROSS STREETS		DIRECTION (EB/WB) (NB/SB)	LANE NO. (1, 2, 3)	PAVEMENT PATCH WIDTH	PAVEMENT PATCH LENGTH	REPAIR AREA (SQ FT)	REPAIR AREA (SQ YD)
FROM	TO						
		SB		12	6	72	8
		SB		12	4	48	5
		SB		12	6	72	8
Buffalo Grove Road	IL 21	SB		12	20	240	27
		SB		12	20	240	27
		SB		12	4	48	5
		SB		12	6	72	8
IL 21	Buffalo Grove Road	NB		12	4	48	5
		NB		12	4	48	5
		NB		12	4	48	5
		NB		12	4	48	5
		NB		12	10	120	13
		NB		3	200	600	67
		NB	RT E/P	3	50	150	17
Buffalo Grove Road	IL 83	NB		4	20	80	9
		NB		12	4	48	5
		NB		4	20	80	9
IL 83	IL 60	NB	Lane Line	3	200	600	67
		NB	1	12	4	48	5
		NB	1	12	4	48	5
		NB	1	12	4	48	5
		NB	1	3	200	600	67
IL 60	Diamond Lake Road	NB	2	12	6	72	8
		NB	2	12	6	72	8
		NB	2	12	6	72	8
		NB	2	6	20	120	13
		NB	2	8	12	96	11
		NB	2	12	4	48	5
		NB	1	12	4	48	5
		NB	2	6	20	120	13
		NB	2	12	6	72	8
		NB	2	12	4	48	5
		NB	2	12	12	144	16
		NB	2	12	4	48	5
		NB	1	6	12	72	8
		NB	2	6	12	72	8
Diamond Lake Road	IL 176	NB	2	4	30	120	13
		NB	2	12	4	48	5
		NB	2	12	4	48	5
		NB	1	12	4	48	5
		NB	2	12	4	48	5
		NB	2	12	4	48	5
		NB	2	12	4	48	5
		NB	2	12	4	48	5
		NB	2	12	4	48	5
		NB	2	12	4	48	5
		NB	2	4	20	80	9

TOTALS: 2368 1134 SY

FILE NAME = es:\projects\136008\design\_aa.dgn  
 USER NAME = wilgreendp  
 PLOT SCALE = 100.0000' / IN.  
 PLOT DATE = 6/26/2008

DESIGNED -  
 DRAWN -  
 CHECKED -  
 DATE -  
 REVISED -  
 REVISED -  
 REVISED -  
 REVISED -

STATE OF ILLINOIS  
 DEPARTMENT OF TRANSPORTATION

PATCHING SCHEDULE  
 US 45

SCALE: SHEET NO. OF SHEETS STA. TO STA.

F.A. SECTION COUNTY TOTAL SHEETS SHEET NO.  
 RTE. 2008-047 RS LAKE 41 35  
 VAR. CONTRACT NO. 60E96  
 FED. ROAD DIST. NO. 1 ILLINOIS FED. AID PROJECT

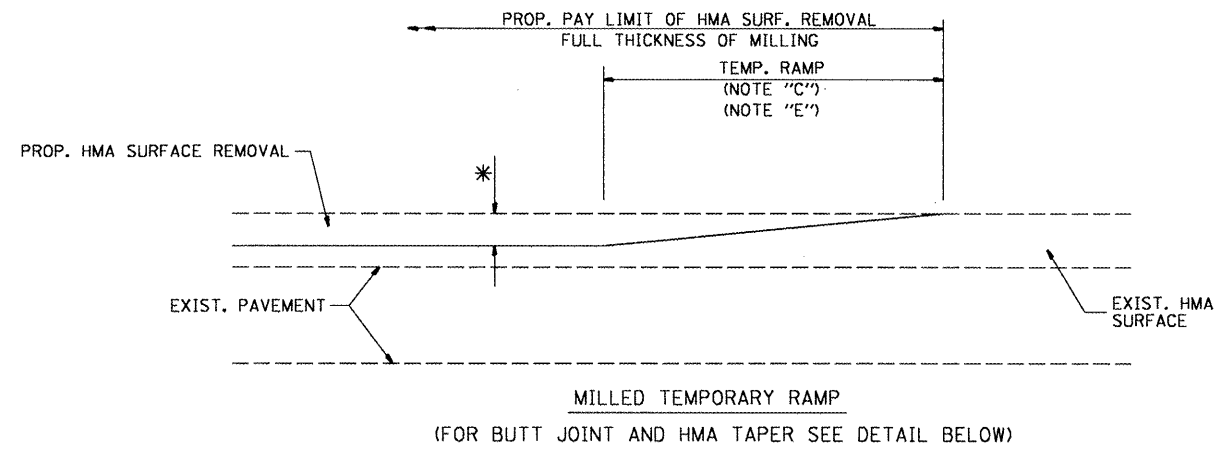

**OPTION 1**

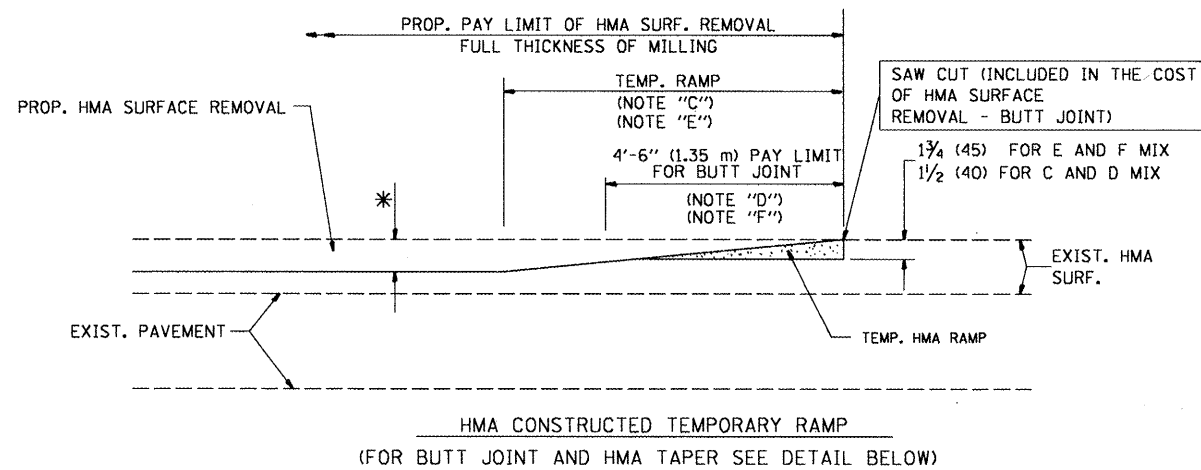

**OPTION 2**

**TYPICAL TEMPORARY RAMP**

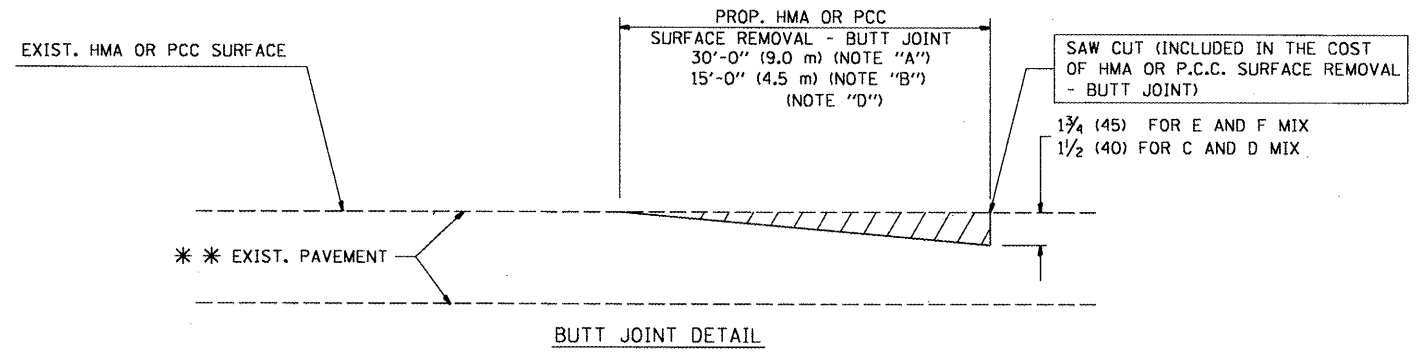

**BUTT JOINT DETAIL**

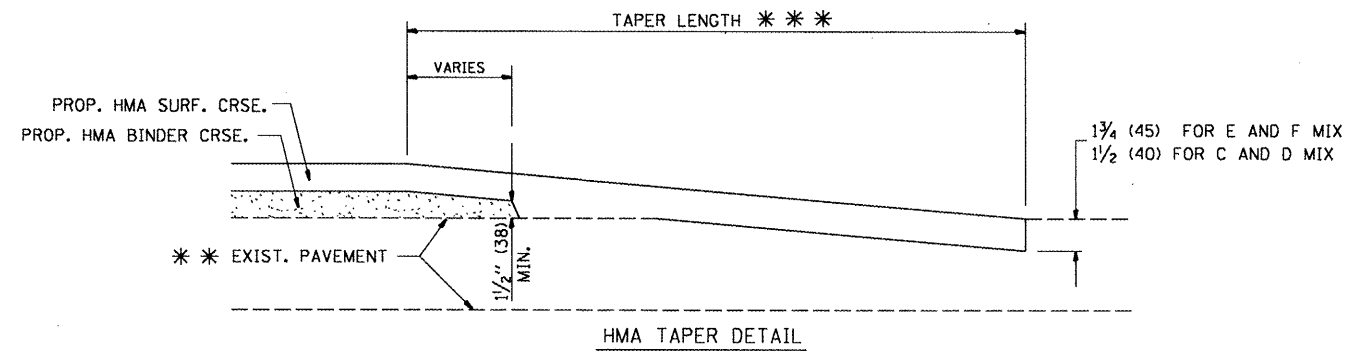

**HMA TAPER DETAIL**

**TYPICAL BUTT JOINT AND HMA TAPER FOR RESURFACING ONLY**

\*\*\* PC CONCRETE, HMA OR HMA RESURFACED PAVEMENT.

**NOTES**

- A: MAINLINE ROADWAYS AND MAJOR SIDE ROADS.
  - B: MINOR SIDE ROADS.
  - C: THE TEMP. RAMP SHALL BE CONSTRUCTED IMMEDIATELY UPON REMOVAL OF THE EXISTING HMA SURFACE.
  - D: THE BUTT JOINT SHALL BE CONSTRUCTED IMMEDIATELY PRIOR TO PLACING THE PROPOSED HMA COURSES.
  - E: TAPER THE TEMP. RAMP AT A RATE OF 3'-0" (900 mm) PER 1 INCH (25 mm) OF MILLING THICKNESS.
  - F: INSTALLATION AND REMOVAL OF THE 4'-6" (1.35 m) TEMP. RAMP IS INCLUDED IN COST OF HMA SURFACE REMOVAL - BUTT JOINT
  - G: SEE ARTICLE 406.08 AND 406.14 OF THE STANDARD SPECIFICATIONS FOR "HMA AND/OR PCC SURFACE REMOVAL, BUTT JOINT".
- \* SEE TYPICAL SECTIONS FOR MILLING THICKNESS.
- \*\*\* 20'-0" (6.1 m) PER 1 (25) RESURFACING (NOTE "A")  
 10'-0" (3.0 m) PER 1 (25) RESURFACING (NOTE "B")

**BASIS OF PAYMENT:**

THE BUTT JOINT WILL BE PAID FOR AT THE CONTRACT UNIT PRICE PER SQUARE YARD (SQUARE METER) FOR "HOT-MIX ASPHALT SURFACE REMOVAL - BUTT JOINT" OR FOR "PORTLAND CEMENT CONCRETE SURFACE REMOVAL - BUTT JOINT".

ALL DIMENSIONS ARE IN INCHES (MILLIMETERS) UNLESS OTHERWISE SHOWN.

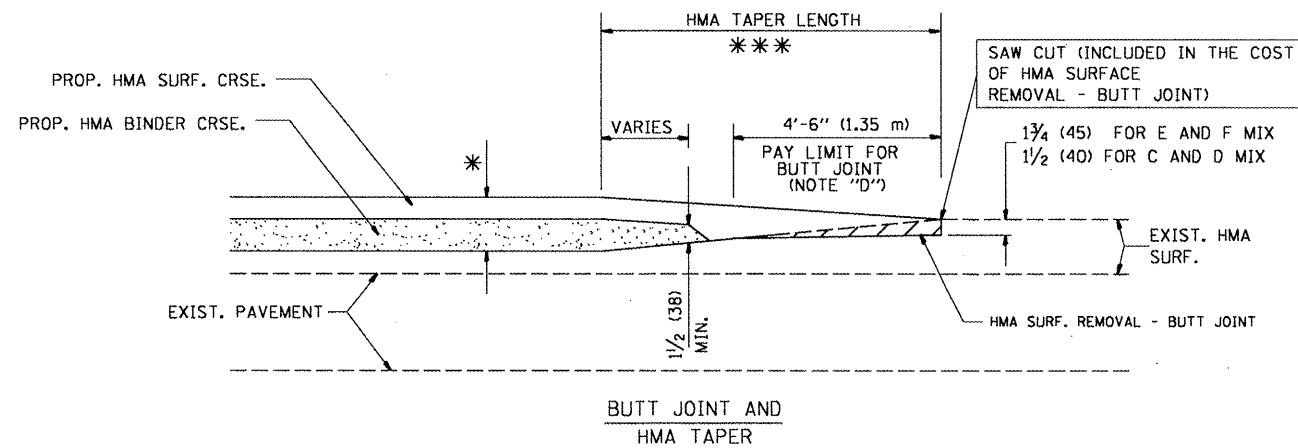

**BUTT JOINT AND HMA TAPER**

**TYPICAL BUTT JOINT AND HMA TAPER FOR MILLING AND RESURFACING**

**STATE OF ILLINOIS  
DEPARTMENT OF TRANSPORTATION**

**BUTT JOINT AND  
HMA TAPER DETAILS**

FILE NAME =	USER NAME = smthk1	DESIGNED - M. DE YONG	REVISED - R. SHAH 10-25-94
DETAILS\bd32.dgn		DRAWN -	REVISED - A. ABBAS 03-21-97
PLOT SCALE = 99.9998 "/td> <td></td> <td>CHECKED -</td> <td>REVISED - M. GOMEZ 04-06-01</td>		CHECKED -	REVISED - M. GOMEZ 04-06-01
PLOT DATE = 6/26/2008		DATE - 06-13-90	REVISED - R. BORO 01-01-07

SCALE: NONE SHEET NO. 1 OF 1 SHEETS STA. TO STA.

F.A. RTE.	SECTION	COUNTY	TOTAL SHEETS	SHEET NO.
VAR.	2008-047 RS	LAKE	41	36
BD400-05 BD32			CONTRACT NO. 60E96	
FED. ROAD DIST. NO. 1 ILLINOIS FED. AID PROJECT				



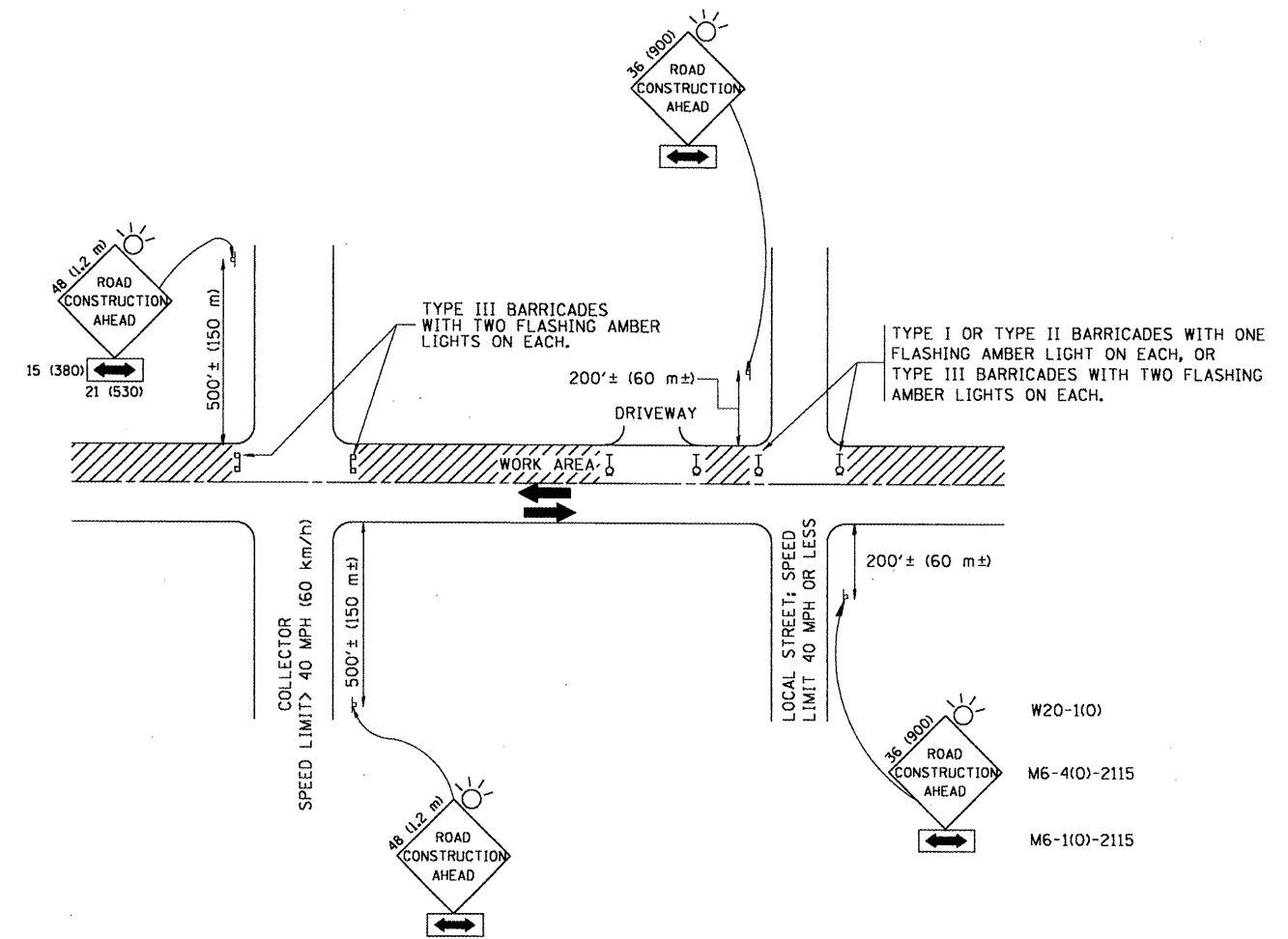

**TRAFFIC CONTROL AND PROTECTION FOR SIDE ROADS, INTERSECTIONS, AND DRIVEWAYS**

**NOTES:**

- A. FOR NO LANE RESTRICTION ON THE SIDE ROAD OR DRIVEWAYS
  1. SIDE ROAD WITH A SPEED LIMIT OF 40 MPH (60 km/h) OR LESS AS SHOWN ON THE DRAWING AND AS DIRECTED BY THE ENGINEER:
    - a) ONE ROAD CONSTRUCTION AHEAD SIGN 36 x 36 (900x900) WITH A FLASHER AND FLAG MOUNTED ON IT APPROXIMATELY 200' (60 m) IN ADVANCE OF THE MAIN ROUTE.
    - b) THE CLOSED PORTION OF THE MAIN ROUTE SHALL BE PROTECTED BY BLOCKING WITH TYPE I, TYPE II OR TYPE III BARRICADES, 1/3 OF THE CROSS SECTION OF THE CLOSED PORTION.
  2. SIDE ROAD WITH A SPEED LIMIT GREATER THAN 40 MPH (60 km/h) AS SHOWN ON THE DRAWING AND AS DIRECTED BY THE ENGINEER:
    - a) ONE ROAD CONSTRUCTION AHEAD SIGN 48 x 48 (1.2 m x 1.2 m) WITH A FLASHER MOUNTED ON IT APPROXIMATELY 500' (150 m) IN ADVANCE OF THE MAIN ROUTE.
    - b) THE CLOSED PORTION OF THE MAIN ROUTE SHALL BE PROTECTED BY BLOCKING WITH TYPE III BARRICADES, 1/2 OF THE CROSS SECTION OF THE CLOSED PORTION.
  3. WHEN THE SIDE ROAD LIES BETWEEN THE BEGINNING OF THE MAINLINE SIGNING AND THE WORK ZONE, A SINGLE HEADED ARROW (M6-1) SHALL BE USED IN LIEU OF THE DOUBLE HEADED ARROW (M6-4).
- B. FOR A LANE CLOSURE ON A SIDE ROAD OR DRIVEWAY:
 

USE APPLICABLE PORTIONS OF THE TYPICAL APPLICATION OF TRAFFIC CONTROL DEVICES (STD. 701501, STD. 701606 OR THE APPROPRIATE STANDARD). THE SPACING OF SIGNS AND BARRICADES SHALL BE ADJUSTED FOR FIELD CONDITIONS AS DIRECTED BY THE ENGINEER. THE DIRECTIONAL ARROW SHALL BE COVERED OR REMOVED WHEN NO LONGER CONSISTENT WITH THE SIDE ROAD LANE CLOSURE.
- C. ADVANCE WARNING SIGNS ARE TO BE OMITTED ON DRIVEWAY UNLESS OTHERWISE NOTED.
- D. THE TRAFFIC CONTROL AND PROTECTION FOR SIDE ROADS, INTERSECTIONS, AND DRIVEWAYS SHALL BE INCIDENTAL TO THE COST OF SPECIFIED TRAFFIC CONTROL STANDARDS OR ITEMS.

All dimensions are in millimeters (inches) unless otherwise shown.

FILE NAME =	USER NAME = sm1thk1	DESIGNED - LHA	REVISED - J. OBERLE 10-18-95
\\dist1\fa2\users\sm1thk1\Desktop\CADD	DETAILS\c10.dgn	DRAWN -	REVISED - A. HOUSEH 03-06-96
	PLDT SCALE = 100.000 / IN.	CHECKED -	REVISED - A. HOUSEH 10-15-96
	PLDT DATE = 6/26/2008	DATE - 06-89	REVISED - T. RAMMACHER 01-06-00

**STATE OF ILLINOIS  
DEPARTMENT OF TRANSPORTATION**

**TRAFFIC CONTROL AND PROTECTION FOR  
SIDE ROADS, INTERSECTIONS, AND DRIVEWAYS**

SCALE: NONE SHEET NO. 1 OF 1 SHEETS STA. TO STA.

F.A. RTE.	SECTION	COUNTY	TOTAL SHEETS	SHEET NO.
VAR.	2008-047 RS	LAKE	41	37
TC-10			CONTRACT NO. 60E96	
FED. ROAD DIST. NO. 1 [ILLINOIS] FED. AID PROJECT				

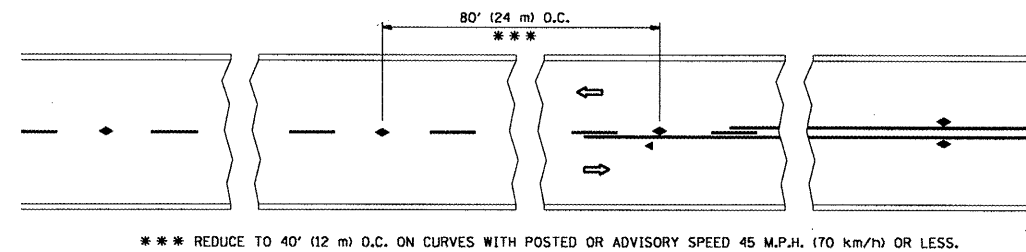

\*\*\* REDUCE TO 40' (12 m) O.C. ON CURVES WITH POSTED OR ADVISORY SPEED 45 M.P.H. (70 km/h) OR LESS.

TWO-LANE/TWO-WAY

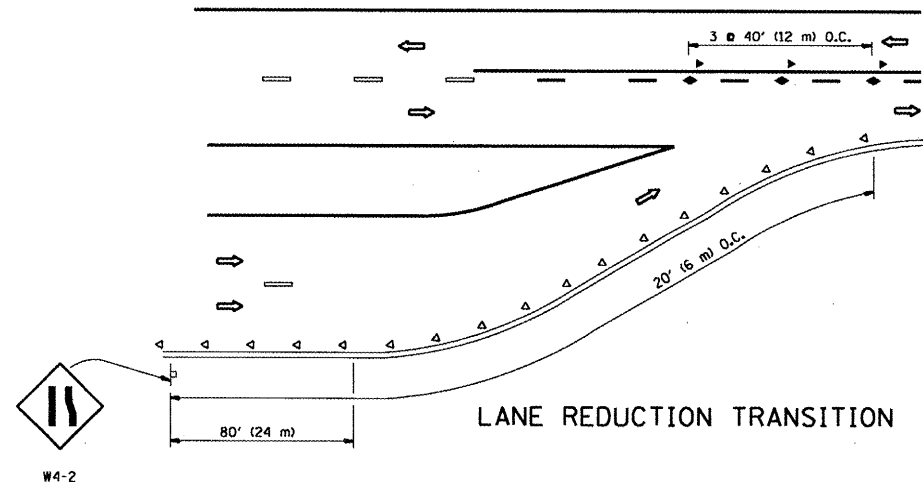

LANE REDUCTION TRANSITION

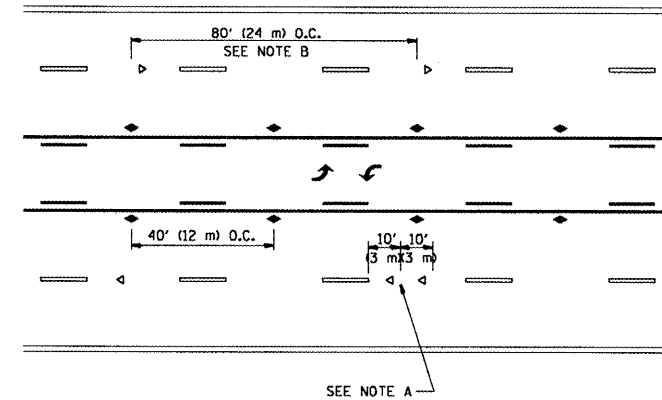

TWO-WAY LEFT TURN

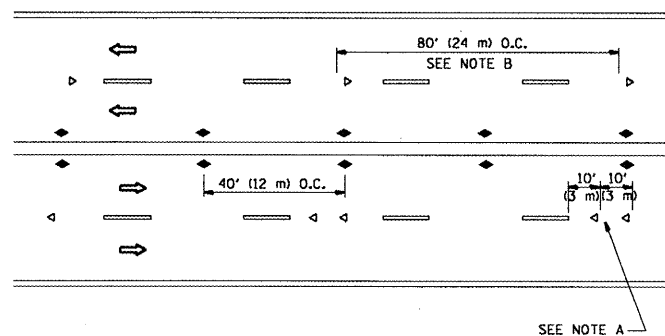

MULTI-LANE/UNDIVIDED

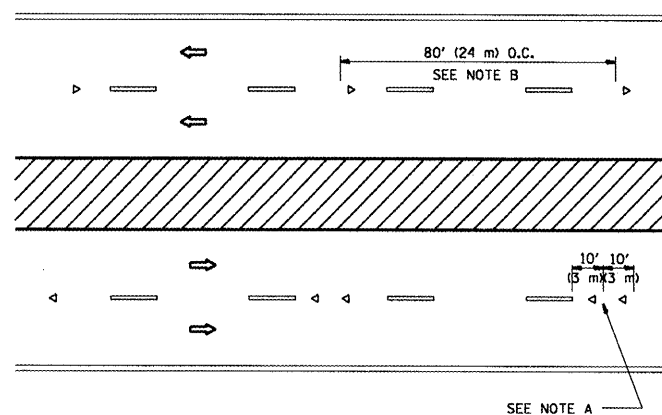

MULTI-LANE/DIVIDED

GENERAL NOTES

1. MARKERS USED WITH DASHED LINES SHALL BE CENTERED IN THE GAP BETWEEN SEGMENTS.
2. MARKERS USED ADJACENT TO SOLID LINES SHALL BE OFFSET 2 TO 3 (50 TO 75) TOWARD TRAFFIC AS SHOWN.
3. MARKERS THROUGH TANGENTS LESS THAN 500' (150 m) IN LENGTH BETWEEN CURVES SHALL BE INSTALLED AT THE LESSER OF THE TWO CURVE SPACINGS.

SYMBOLS

- YELLOW STRIPE
- WHITE STRIPE
- ◀ ONE-WAY AMBER MARKER
- ◁ ONE-WAY CRYSTAL MARKER (W/O)
- ◆ TWO-WAY AMBER MARKER

LANE MARKER NOTES

- A. USE DOUBLE LANE LINE MARKERS SPACED AS SHOWN.
- B. REDUCE TO 40' (12 m) O.C. ON CURVES WHERE ADVISORY SPEEDS ARE 10 M.P.H (20 km/h) LOWER THAN POSTED SPEEDS.

DESIGN NOTES

1. DOUBLE LANE LINE MARKERS SHALL BE USED UNLESS SPECIFIED OTHERWISE.
2. EXCEPT AS SHOWN ON THE LANE REDUCTION TRANSITION AND FREEWAY EXIT RAMP DETAIL, MARKERS ARE NOT TO BE SPECIFIED ON RIGHT EDGE LINES.
3. THE EXACT MARKER LIMITS, SPACING, AND COLOR SHOULD BE INCLUDED IN THE PLANS.
4. MARKERS SHOULD NOT BE USED ALONGSIDE CURBS EXCEPT FOR EXTREMELY SHORT SECTIONS OF CURBS WHERE NOT MORE THAN TWO MARKERS WOULD BE INVOLVED.

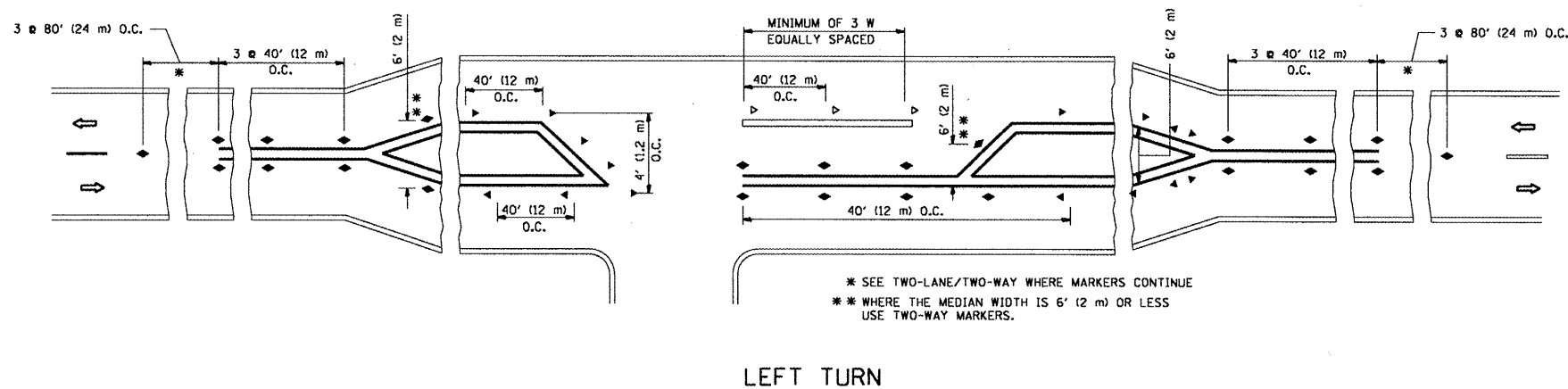

LEFT TURN

\* SEE TWO-LANE/TWO-WAY WHERE MARKERS CONTINUE  
 \*\* WHERE THE MEDIAN WIDTH IS 6' (2 m) OR LESS USE TWO-WAY MARKERS.

All dimensions are in inches (millimeters) unless otherwise shown.

FILE NAME =	USER NAME = sm:thkl	DESIGNED -	REVISED - T. RAMMACHER 09-19-94
\desktop\fa2\users\sm:thkl\Desktop\CADD	DETAILS\to11.dgn	DRAWN -	REVISED - T. RAMMACHER 03-12-99
	PLOT SCALE = 100.000 / IN.	CHECKED -	REVISED - T. RAMMACHER 01-06-00
	PLOT DATE = 6/26/2008	DATE -	REVISED -

STATE OF ILLINOIS  
DEPARTMENT OF TRANSPORTATION

TYPICAL APPLICATIONS  
RAISED REFLECTIVE PAVEMENT MARKERS (SNOW-PLOW RESISTANT)

SCALE: NONE SHEET NO. 1 OF 1 SHEETS STA. TO STA.

F.A. RTE.	SECTION	COUNTY	TOTAL SHEETS	SHEET NO.
VAR.	2008-047 RS	LAKE	41	38
TC-11			CONTRACT NO. 60E96	
FED. ROAD DIST. NO. 1 ILLINOIS FED. AID PROJECT				

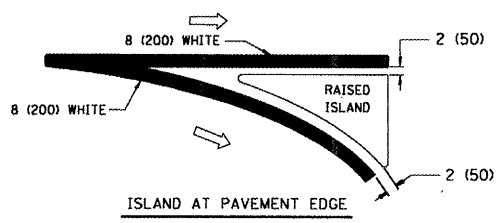
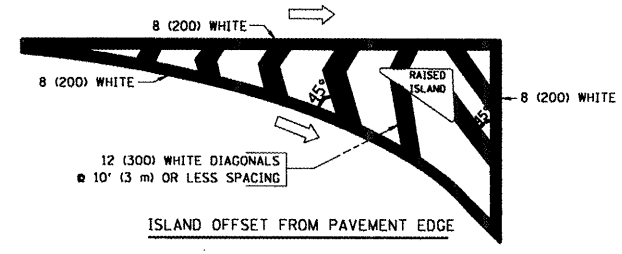
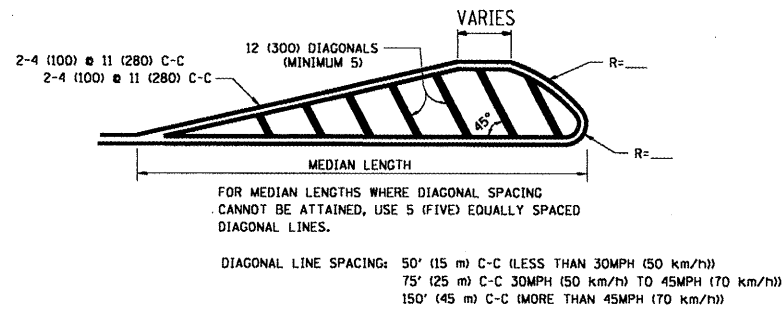
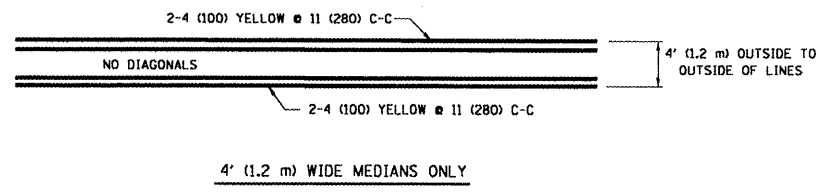
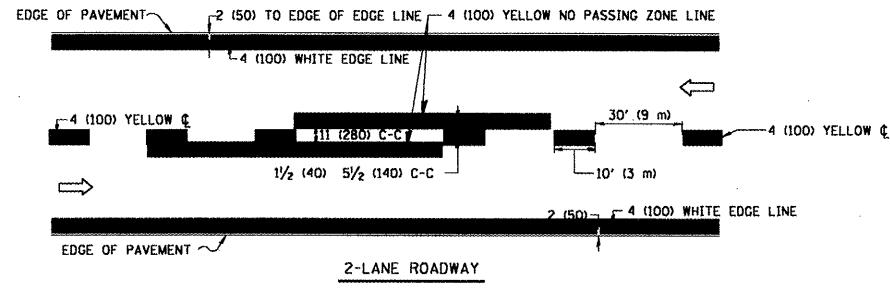

TYPICAL ISLAND MARKING

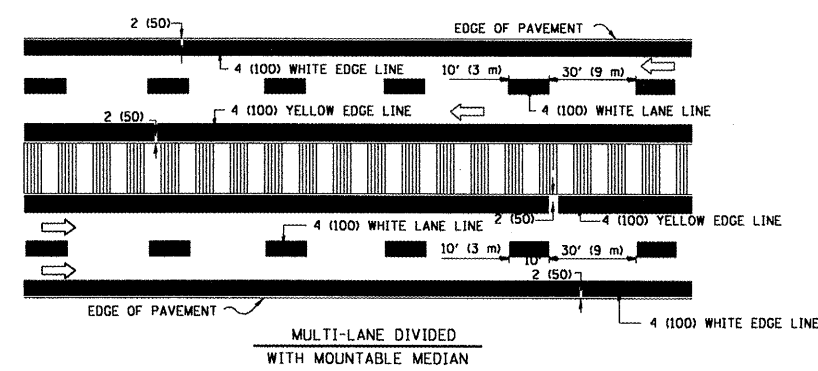
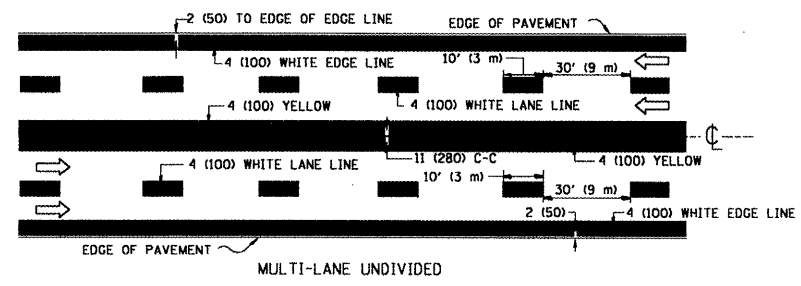

NOTE: MEDIANS WITH BARRIER CURB DO NOT REQUIRE AN EDGE LINE

TYPICAL LANE AND EDGE LINE MARKING

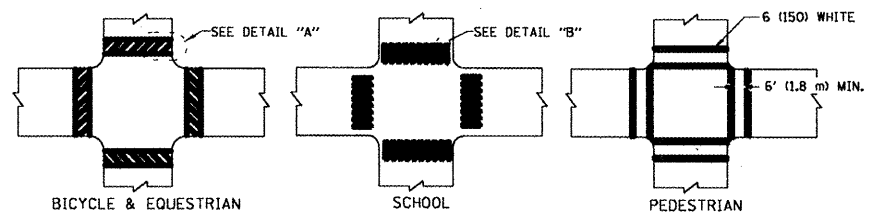

TYPICAL CROSSWALK MARKING

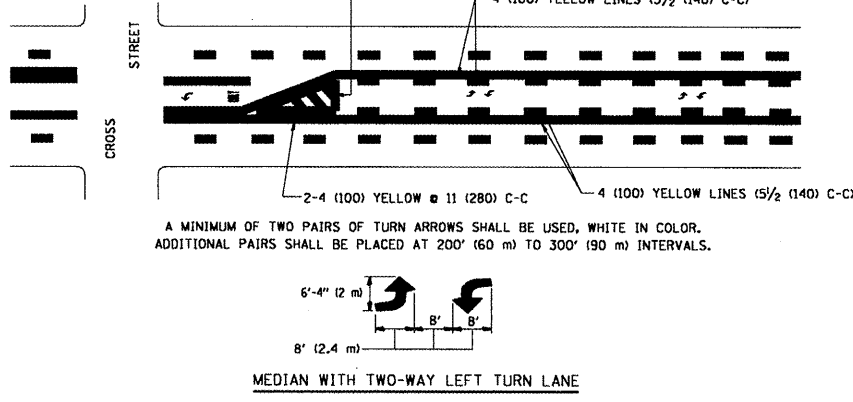

TYPICAL PAINTED MEDIAN MARKING

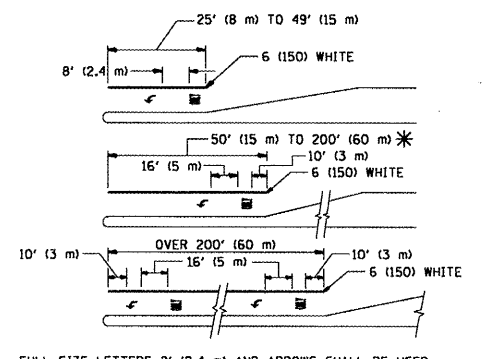

TYPICAL LEFT (OR RIGHT) TURN LANE

TYPICAL TURN LANE MARKING

TYPE OF MARKING	WIDTH OF LINE	PATTERN	COLOR	SPACING / REMARKS
CENTERLINE ON 2 LANE PAVEMENT	4 (100)	SKIP-DASH	YELLOW	10' (3 m) LINE WITH 30' (9 m) SPACE
CENTERLINE ON MULTI-LANE UNDIVIDED PAVEMENT	2 @ 4 (100)	SOLID	YELLOW	11 (280) C-C
NO PASSING ZONE LINES FOR ONE DIRECTION FOR BOTH DIRECTIONS	4 (100) 2 @ 4 (100)	SOLID SOLID	YELLOW YELLOW	5/2 (140) C-C FROM SKIP-DASH CENTERLINE 11 (280) C-C OMIT SKIP-DASH CENTERLINE BETWEEN
LANE LINES	4 (100) 5 (125) ON FREEWAYS	SKIP-DASH SKIP-DASH	WHITE WHITE	10' (3 m) LINE WITH 30' (9 m) SPACE
DOTTED LINES (EXTENSIONS OF CENTER, LANE OR TURN LANE MARKINGS)	SAME AS LINE BEING EXTENDED	SKIP-DASH	SAME AS LINE BEING EXTENDED	2' (600) LINE WITH 6' (1.8 m) SPACE
EDGE LINES	4 (100)	SOLID	YELLOW-LEFT WHITE-RIGHT	OUTLINE MOUNTABLE MEDIANS IN YELLOW; EDGE LINES ARE NOT USED NEXT TO BARRIER CURB
TURN LANE MARKINGS	6 (150) LINE; FULL SIZE LETTERS & SYMBOLS (8' (2.4m))	SOLID	WHITE	SEE TYPICAL TURN LANE MARKING DETAIL
TWO WAY LEFT TURN MARKING	2 @ 4 (100) EACH DIRECTION 8' (2.4m) LEFT ARROW	SKIP-DASH AND SOLID IN PAIRS	YELLOW WHITE	10' (3 m) LINE WITH 30' (9 m) SPACE FOR SKIP-DASH; 5/2 (140) C-C BETWEEN SOLID LINE AND SKIP-DASH LINE SEE TYPICAL TWO-WAY LEFT TURN MARKING DETAIL
CROSSWALK LINES (PEDESTRIAN) A. DIAGONALS (BIKE & EQUESTRIAN) B. LONGITUDINAL BARS (SCHOOL)	2 @ 6 (150) 12 (300) @ 45° 12 (300) @ 90°	SOLID SOLID SOLID	WHITE WHITE WHITE	NOT LESS THAN 6' (1.8 m) APART 2' (600) APART 2' (600) APART SEE TYPICAL CROSSWALK MARKING DETAILS.
STOP LINES	24 (600)	SOLID	WHITE	PLACE 4' (1.2 m) IN ADVANCE OF AND PARALLEL TO CROSSWALK, IF PRESENT. OTHERWISE, PLACE AT DESIRED STOPPING POINT, PARALLEL TO CROSSROAD CENTERLINE, WHERE POSSIBLE
PAINTED MEDIANS	2 @ 4 (100) WITH 12 (300) DIAGONALS @ 45° NO DIAGONALS USED FOR 4' (1.2 m) WIDE MEDIANS	SOLID	YELLOW: TWO WAY TRAFFIC WHITE: ONE WAY TRAFFIC	11 (280) C-C FOR THE DOUBLE LINE SEE TYPICAL PAINTED MEDIAN MARKING.
GORE MARKING AND CHANNELIZING LINES	8 (200) WITH 12 (300) DIAGONALS @ 45°	SOLID	WHITE	DIAGONALS: 15' (4.5 m) C-C (LESS THAN 30MPH (50 km/h)) 20' (6 m) C-C 30MPH (50 km/h) TO 45MPH (70 km/h) 30' (9 m) C-C (OVER 45MPH (70 km/h))
RAILROAD CROSSING	24 (600) TRANSVERSE LINES; "RR" IS 6' (1.8 m) LETTERS; 16 (400) LINE FOR "X"	SOLID	WHITE	SEE STATE STANDARD 780001 AREA OF: "R"-3.6 SQ. FT. (0.33 m <sup>2</sup> ) EACH "X"-54.0 SQ. FT. (5.0 m <sup>2</sup> )
SHOULDER DIAGONALS	12 (300) @ 45°	SOLID	WHITE - RIGHT YELLOW - LEFT	50' (15 m) C-C (LESS THAN 30MPH (50 km/h)) 75' (25 m) C-C (30 MPH (50 km/h) TO 45MPH (70 km/h)) 150' (45 m) C-C (OVER 45MPH (70 km/h))

FOR FURTHER DETAILS ON PAVEMENT MARKING REFER TO STANDARD SPECIFICATIONS FOR ROAD AND BRIDGE CONSTRUCTION AND STATE STANDARD 780001.

All dimensions are in inches (millimeters) unless otherwise shown.

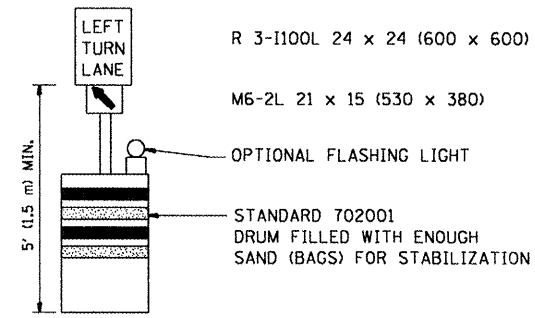
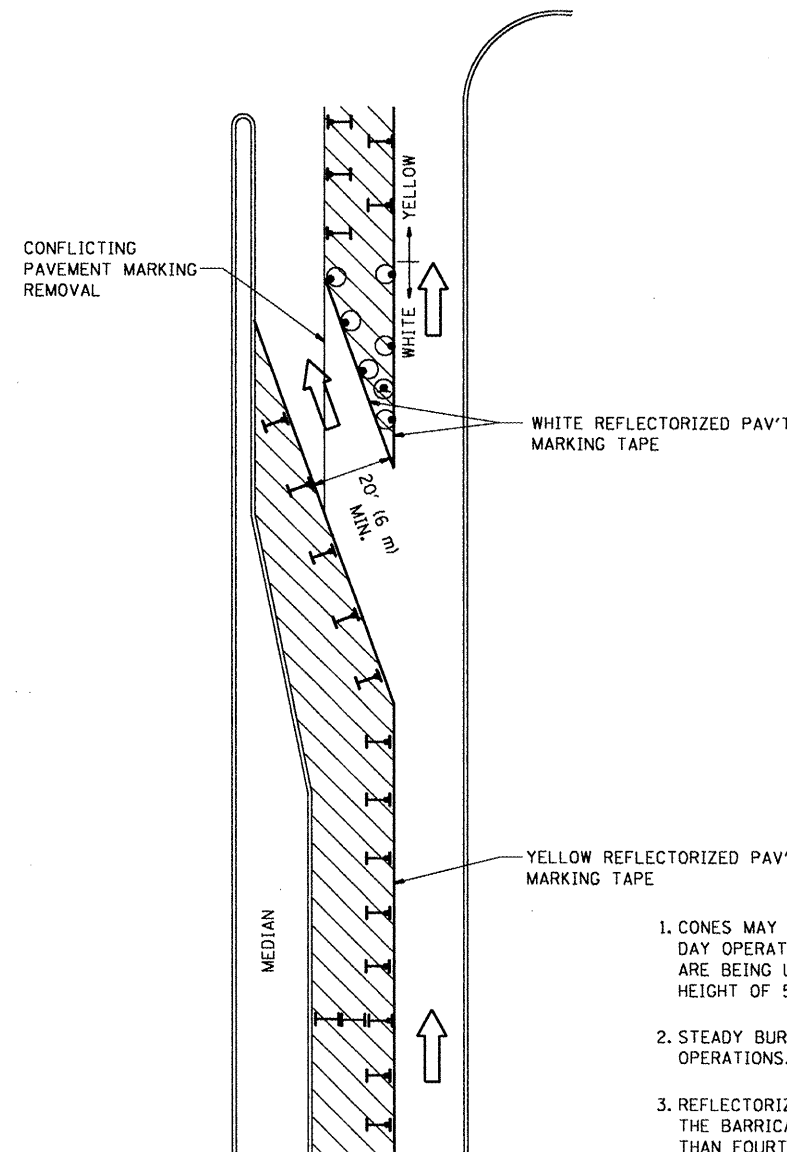

**GENERAL NOTES**

1. CONES MAY BE SUBSTITUTED FOR BARRICADES OR DRUMS AT HALF THE SPACING DURING DAY OPERATIONS. CONES SHALL BE A MINIMUM OF 28 (710) IN HEIGHT. WHEN CONES ARE BEING USED, THE "LEFT TURN LANE" SIGN MAY BE SKID MOUNTED AT A MINIMUM HEIGHT OF 5' (1.5 m).
2. STEADY BURNING LIGHTS WILL NOT BE REQUIRED ON BARRICADES OR DRUMS FOR DAY OPERATIONS. ALL LIGHTS SHALL BE MONODIRECTIONAL.
3. REFLECTORIZED TEMPORARY PAVEMENT MARKING TAPE SHALL BE PLACED THROUGHOUT THE BARRICADED AREA OF EACH TURN BAY WHERE THE CLOSURE TIME IS GREATER THAN FOURTEEN DAYS.
4. THIS APPLICATION ALSO APPLIES WHEN WORK IS BEING PERFORMED IN THE RIGHT LANE(S) AND THE RIGHT TURN BAY IS TO REMAIN OPEN. UNDER THIS CONDITION, "RIGHT TURN LANE" R3-100 24 x 24 (600 x 600) AND M6-2R 21 x 15 (530 x 380) SHALL BE USED.
5. THESE CONTROLS SHALL SUPPLEMENT MAINLINE TRAFFIC CONTROL FOR LANE CLOSURES.
6. LONGITUDINAL DIMENSIONS MAY BE ADJUSTED TO FIT FIELD CONDITIONS.
7. FORM BT 725 IS REQUIRED.
8. TRAFFIC CONTROL AND PROTECTION AT TURN BAYS (TO REMAIN OPEN TO TRAFFIC) SHALL BE INCLUDED IN THE COST SPECIFIED TRAFFIC CONTROL STANDARDS OR ITEMS.

All dimensions are in inches (millimeters) unless otherwise shown.

**LEGEND**

- WORK AREA
- LANE OPEN TO TRAFFIC
- TYPE I OR II BARRICADE WITH STEADY BURN LIGHT
- DRUM WITH STEADY BURN LIGHT
- DRUM WITH SIGN (WITH OPTIONAL FLASHING LIGHT) SEE DETAIL
- TYPE I OR II CHECK BARRICADE WITH FLASHING LIGHT

FILE NAME =	USER NAME = smithk1	DESIGNED -	REVISED -T. RAMMACHER 09-08-94
\\dstlntfs2\users\smithk1\Desktop\CA00	DETAILS\tc14.dgn	DRAWN -	REVISED - A. HOUSEH 11-07-95
	PLOT SCALE = 99.9998 1 / IN.	CHECKED -	REVISED - A. HOUSEH 10-12-96
	PLOT DATE = 6/26/2008	DATE -	REVISED -T. RAMMACHER 01-06-00

**STATE OF ILLINOIS  
DEPARTMENT OF TRANSPORTATION**

**TRAFFIC CONTROL AND PROTECTION AT TURN BAYS  
(TO REMAIN OPEN TO TRAFFIC)**

SCALE: NONE SHEET NO. 1 OF 1 SHEETS STA. TO STA.

F.A. RTE.	SECTION	COUNTY	TOTAL SHEETS	SHEET NO.
VAR.	2008-047 RS	LAKE	41	40
TC-14		CONTRACT NO. 60E96		
FED. ROAD DIST. NO. 1 ILLINOIS FED. AID PROJECT				

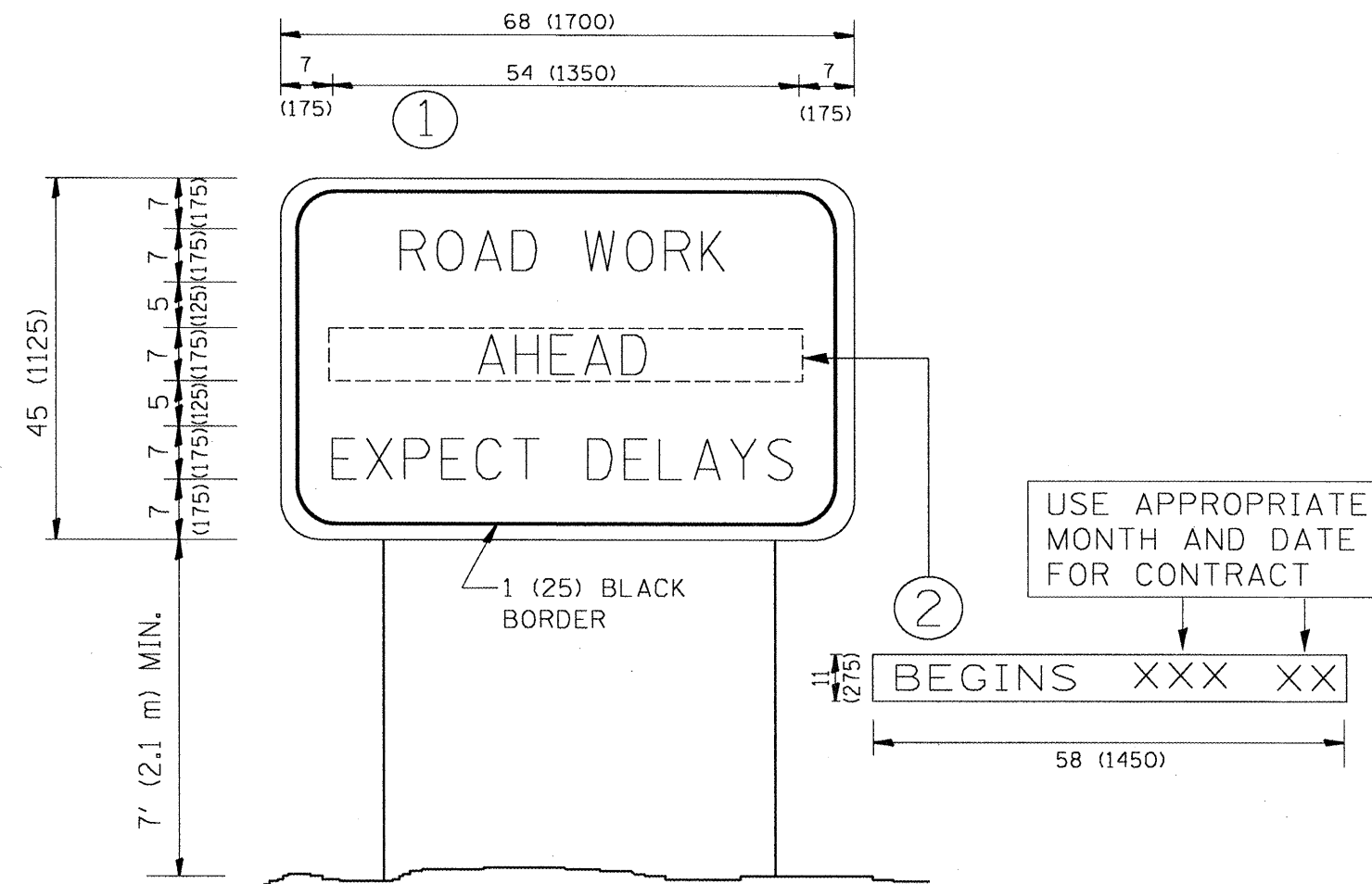

**NOTES:**

1. USE BLACK LETTERING ON ORANGE BACKGROUND.
2. ERECT SIGNS IN ADVANCE OF THE LOCATION FOR THE "ROAD CONSTRUCTION AHEAD" SIGN AT LOCATIONS AS DIRECTED BY THE ENGINEER.
3. ERECT SIGN ① WITH INSTALLED PANEL ② ONE WEEK PRIOR TO THE START OF CONSTRUCTION.
4. REMOVE PANEL ② SOON AFTER THE START OF CONSTRUCTION.
5. SEE SPECIAL PROVISION FOR "TEMPORARY INFORMATION SIGNING" FOR ADDITIONAL INFORMATION.
6. ONE SIGN ASSEMBLY EQUALS 25.70 SQ. FT. (2.3 SQ. M.)
7. SHALL BE PAID FOR AS TEMPORARY INFORMATION SIGNING.

ALL DIMENSIONS ARE IN INCHES (MILLIMETERS) UNLESS OTHERWISE SHOWN.

FILE NAME =	USER NAME = smthk1	DESIGNED -	REVISED - R. MIRS 09-15-97
\\dist1\ntfs2\users\smthk1\Desktop\CADD	DETAILS\to22.dgn	DRAWN -	REVISED - R. MIRS 12-11-97
PLOT SCALE = 100.000' / IN.	CHECKED -	REVISED - T. RAMMACHER 02-02-99	
PLOT DATE = 6/26/2008	DATE -	REVISED - C. JUCIUS 01-31-07	

**STATE OF ILLINOIS  
DEPARTMENT OF TRANSPORTATION**

**ARTERIAL ROAD  
INFORMATION SIGN**

SCALE: NONE SHEET NO. 1 OF 1 SHEETS STA. TO STA.

F.A. RTE.	SECTION	COUNTY	TOTAL SHEETS	SHEET NO.
VAR.	2008-047 RS	LAKE	41	41
TC-22			CONTRACT NO. 60E96	
FED. ROAD DIST. NO. 1   ILLINOIS   FED. AID PROJECT				