

F.A. RTE.	SECTION	COUNTY	TOTAL SHEETS	SHEET NO.
338	114R-1	WILL	355	1

D-91-123-02

355+2-2-355
+1
356

1051 PERIMETER DRIVE, SUITE 1025
SCHAMBURG, IL 60173
(847) 605-9600 FAX (847) 605-9610
TranSystems
IDOT - REGION ONE BUREAU OF DESIGN/CONSULTANT PROJECT MANAGER: MS. KIM HARVEY, P.E. (847) 705-4555

FOR INDEX OF SHEETS, SEE SHEET NO. 2

STATE OF ILLINOIS
DEPARTMENT OF TRANSPORTATION
DIVISION OF HIGHWAYS

**PROPOSED
HIGHWAY PLANS**

FAP ROUTE 338 (ILLINOIS ROUTE 59)

SECTION: 114R-1

PROJECT NO: ACNHF-ACBHF-0338(035)

U.S. ROUTE 52 (WEST JEFFERSON STREET) TO CATON FARM ROAD
ROADWAY RECONSTRUCTION, ADDITIONAL LANES, RETAINING WALLS
CULVERT REPLACEMENT, AND TRAFFIC SIGNAL MODERNIZATION

WILL COUNTY

C-91-123-02

DESCRIPTION OF IMPROVEMENT:

THIS IMPROVEMENT CONSISTS OF EARTH EXCAVATION, CONSTRUCTION OF STORM SEWERS AND DRAINAGE STRUCTURES, P.C.C. PAVEMENT RECONSTRUCTION, MODERNIZATION OF TRAFFIC SIGNALS, CONSTRUCTION OF TWO BOX CULVERTS, RETAINING WALLS AND ALL INCIDENTAL AND COLLATERAL WORK AS NECESSARY TO COMPLETE THE IMPROVEMENT SHOWN HEREIN AND AS DESCRIBED IN THE SPECIFICATIONS.

DESIGN DESIGNATION 1080 (20) MAJOR ARTERIAL 7.93 (PCC-20)

TRAFFIC DATA:

ILLINOIS ROUTE 59
POSTED SPEED 40 MPH (SOUTH OF MEADOW DRIVE)
DESIGN SPEED 45 MPH
POSTED SPEED 45 MPH (NORTH OF MEADOW DRIVE)
DESIGN SPEED 50 MPH
ADT 22,100 (2006) 33,000 (2030)

RETAINING WALL:

STRUCTURE NO. 099-W016
STRUCTURE NO. 099-W017

IMPROVEMENT LOCATED IN:
VILLAGE OF SHOREWOOD,
CITY OF JOLIET, AND
UNINCORPORATED WILL COUNTY

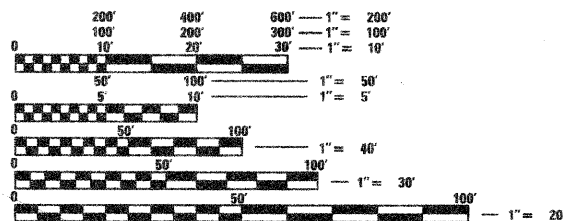

FULL SIZE PLANS HAVE BEEN PREPARED USING STANDARD ENGINEERING SCALES. REDUCED SIZED PLANS WILL NOT CONFORM TO STANDARD SCALES. IN MAKING MEASUREMENTS ON REDUCED PLANS, THE ABOVE SCALES MAY BE USED.

J.U.L.I.E.
JOINT UTILITY LOCATION INFORMATION FOR EXCAVATION
1-800-892-0123 OR 811

CONTRACT NO. 62416

IMPROVEMENT ENDS
STATION 3193+25.00
ILLINOIS ROUTE 59

IMPROVEMENT LIMIT
STATION 103+00.00
THEODORE ST.

IMPROVEMENT LIMIT
STATION 97+45.00
THEODORE ST.

PROPOSED CULVERT
LOCATION
STATION 3051+32.33

PROPOSED CULVERT
LOCATION
STATION 3041+91.63
STRUCTURE NO.
099-4660

IMPROVEMENT BEGINS
STATION 3032+25.77
ILLINOIS ROUTE 59

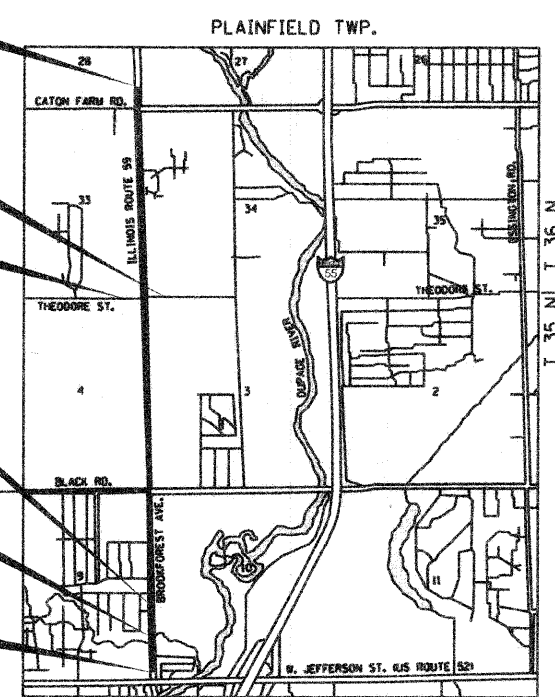

LOCATION MAP

IL ROUTE 59 NET/GROSS LENGTH = 16,099.23 FEET (3.049 MILES)
IMPROVEMENT NET/GROSS LENGTH = 16,654.23 FEET (3.154 MILES)

LOCATION MAP SCALE

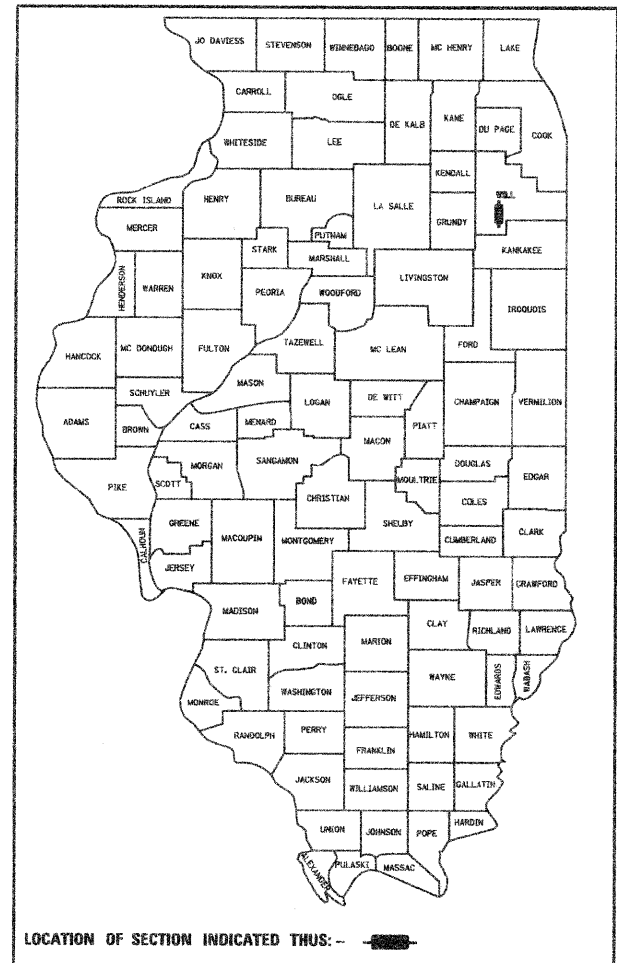
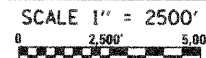

STATE OF ILLINOIS
DEPARTMENT OF TRANSPORTATION
DIVISION OF HIGHWAYS

SUBMITTED MARCH 18, 2008

Diana M. O'Keefe DEPUTY DIRECTOR OF HIGHWAYS, REGION ENGINEER
May 9, 2008

Eric E. Harris ENGINEER OF DESIGN AND ENVIRONMENT
May 9, 2008

Christina M. Reed DIRECTOR OF HIGHWAYS, CHIEF ENGINEER

PRINTED BY THE AUTHORITY OF THE STATE OF ILLINOIS

ROBERT L. PETERS, P.E., S.E.
NO. 081-04697
EXP. DATE 11/30/08
SHEETS 259 TO 288

R. CHRISTOPHER BONUS, P.E.
NO. 062-050801
EXP. DATE 11/30/09
SHEETS 1 TO 28, 63 TO 78
118 TO 172, 185 TO 190 &
201 TO 258, 308 TO 354

BRUCE TALBOT, P.E.
NO. 062-046494
EXP. DATE 11/30/09
SHEETS 235, 236
SHEETS 242, 243

SYED M. KAZI, P.E.
NO. 062-033486
EXP. DATE 11/30/09
SHEETS 191 TO 200