

Benchmark:
 Square cut in center of 13' Headwall, 21' West of IL Route 59
 North of Sunrise Drive, Elevation 598.12

Existing Structure:
 None.

STATE OF ILLINOIS
 DEPARTMENT OF TRANSPORTATION

ROUTE NO.	SECTION	COUNTY	SHEET NO.	SHEET NO.
F.A.P. 338	114R-1	WILL	355	282
FED. ROAD DIST. NO. 7	ILLINOIS	FED. AID PROJECT		7 SHEETS

Contract # 62416

TOTAL BILL OF MATERIAL

Item	Unit	Total
Porous Granular Embankment, Special	Cu. Yd.	252
Stone Riprap, Class A4	Sq. Yd.	20
Filter Fabric	Sq. Yd.	25
Structure Excavation	Cu. Yd.	783
Concrete Structures	Cu. Yd.	203.2
Reinforcement Bars, Epoxy Coated	Pound	29,180
Pedestrian Railing	Foot	186
Geocomposite Wall Drain	Sq. Yd.	172
Pipe Underdrains for Structures 4"	Foot	192

GENERAL NOTES

- Reinforcement bars shall conform to the requirements of ASTM A 706 Grade 60 (IL Modified). See Special Provisions.
- Reinforcement bars designated (F) shall be epoxy coated.
- All construction joints shall be bonded.
- Exposed concrete edges shall have a standard $\frac{3}{4}$ " chamfer unless otherwise noted. Chamfer on vertical edges shall be continued a minimum of 1 foot below the finished ground line.
- Station and offsets are measured from the Proposed Centerline of IL Route 59 to the back face at the top of the retaining wall.
- Layout of the slope protection system may be varied to suit ground conditions in the field as directed by the Engineer.
- Minimum Bar Laps shall be:

Bar	Min. Lap
#5	2'-2"
#6	2'-7"

INDEX OF SHEETS

- S4-1 GENERAL PLAN
- S4-2 PLAN AND ELEVATION
- S4-3 RETAINING WALL DETAILS
- S4-4 PEDESTRIAN RAILING
- S4-5 BORING LOGS I
- S4-6 BORING LOGS II
- S4-7 BORING LOGS III

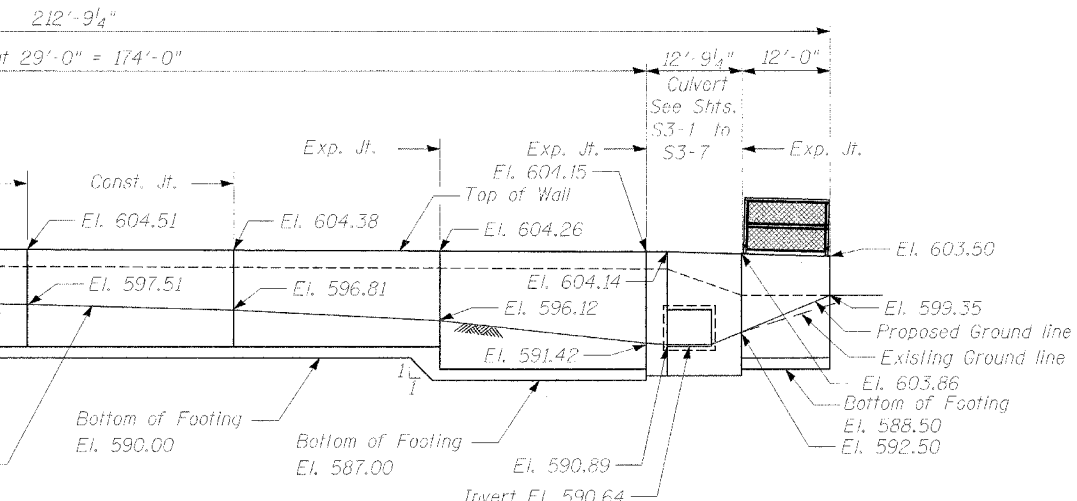

ELEVATION
 (Looking East)

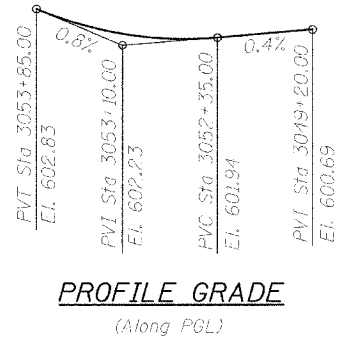
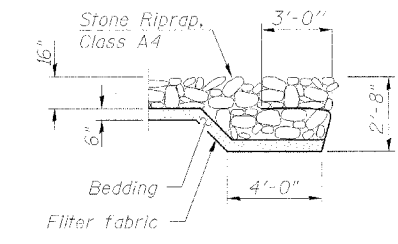
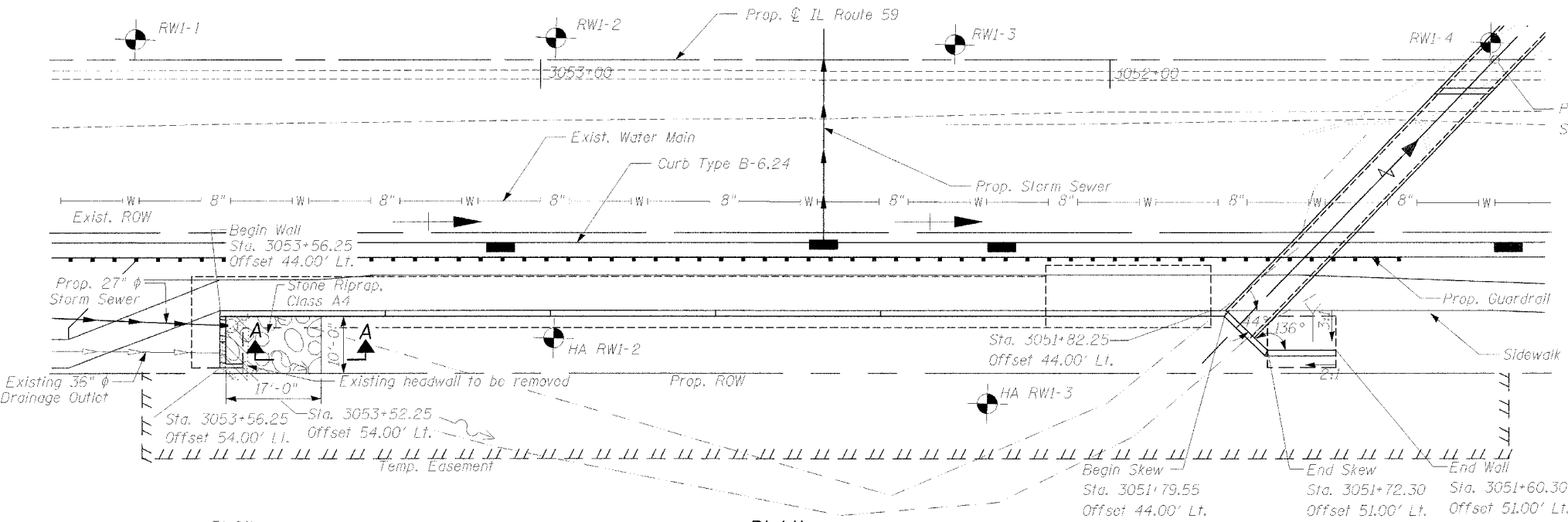

LEGEND:

- Soil Boring Location
- Riprap

APPROVED
 FOR STRUCTURAL ADEQUACY ONLY

Robert E. Peters
 ENGINEER OF BRIDGES AND STRUCTURES

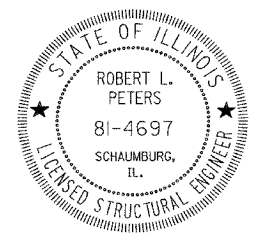

DESIGN SPECIFICATIONS
 AASHTO 2002 "Standard Specifications for Highway Bridges"

DESIGN STRESSES
 $f'_c = 3,500$ psi
 $f_y = 60,000$ psi (Reinforcement)

Robert L. Peters 02/16/08
 ROBERT L. PETERS, P.E., S.E.
 NO. 081-04697
 EXP. DATE 11/30/08

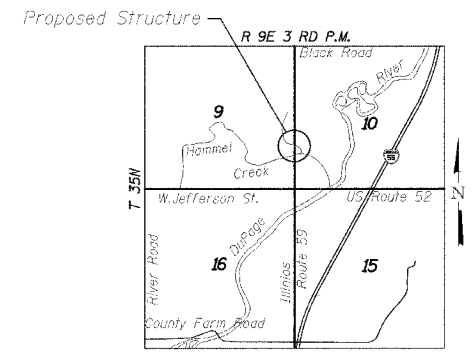

GENERAL PLAN
 RETAINING WALL ALONG IL ROUTE 59
 F.A.P. ROUTE 338 SECTION 114R-1
 WILL COUNTY
 STATION 3051+60.30 TO STATION 3053+56.25
 STRUCTURE NO. 099-W017