

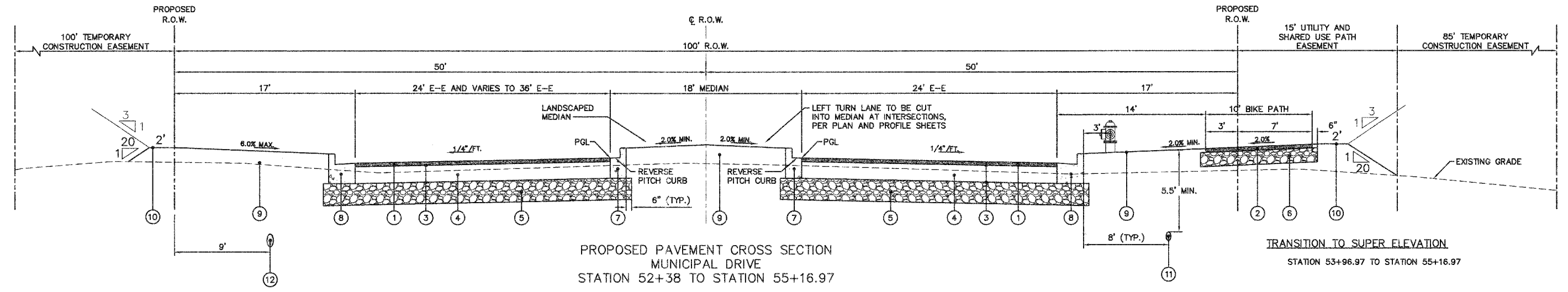

F.A. RTE.	SECTION	COUNTY	TOTAL SHEETS	SHEET NO.
N/A	06-00017-00-PV	KANE	232	12
STA.		TO STA.		
FED. ROAD DIST. NO.		ILLINOIS FED. AID PROJECT		

PLAN	SURVEYED	DATE
	ALIGNED	
	NOTED	
	BY	
	NO.	

PROFILE	SURVEYED	DATE
	GRADES	
	NOTED	
	BY	
	NO.	



**LEGEND**

- |  |  |
|--|--|
| ① POLYMERIZED HOT-MIX ASPHALT SURFACE COURSE, MIX "F", N90, 2" | ⑧ COMBINATION CONCRETE CURB AND GUTTER, B-6.24     |
| ② HOT-MIX ASPHALT SURFACE COURSE, MIX "C", N50, 2"             | ⑨ 4" TOPSOIL, SEEDING CLASS 1A, AND MULCH METHOD 3 |
| ③ BITUMINOUS MATERIAL (PRIME COAT)                             | ⑩ 4" TOPSOIL, SEEDING CLASS 2, AND MULCH METHOD 3  |
| ④ HOT-MIX ASPHALT BINDER COURSE, IL-19.0, N90, 9"              | ⑪ WATER MAIN                                       |
| ⑤ AGGREGATE SUBGRADE, 12"                                      | ⑫ STORM SEWER                                      |
| ⑥ SUB-BASE GRANULAR MATERIAL, TYPE B, 8"                       | ⑬ CONCRETE MEDIAN, TYPE SB-6.12                    |
| ⑦ COMBINATION CONCRETE CURB AND GUTTER, B-6.12                 |  |

△ ~~REVISED~~ 7/11/08

REVISIONS		ILLINOIS DEPARTMENT OF TRANSPORTATION
NAME	DATE	
		<p><b>TYPICAL CROSS SECTIONS</b></p> <p>SCALE: NTS DATE: 02/07/08</p> <p>DRAWN BY: CHECKED BY: WBR</p>