

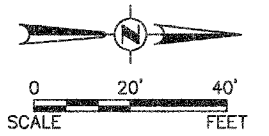

F.A. RTE.	SECTION	COUNTY	TOTAL SHEETS	SHEET NO.
N/A	06-00017-00-PV	KANE	232	122
STA.	TO STA.			
FED. ROAD DIST. NO.	ILLINOIS	FED. AID PROJECT		



PLAN	BY	DATE
SURVEYED		
NOTE BOOK		
NO.		
ALIGNED		
CHECKED		
BY		
DATE		
NO. OF WAY CHECKED		
BY		
DATE		
NO. OF FILE NAME		

PROFILE	BY	DATE
SURVEYED		
NOTE BOOK		
NO.		
GRADES		
CHECKED		
BY		
DATE		
STRUCTURE		
NOTATIONS		
BY		
DATE		

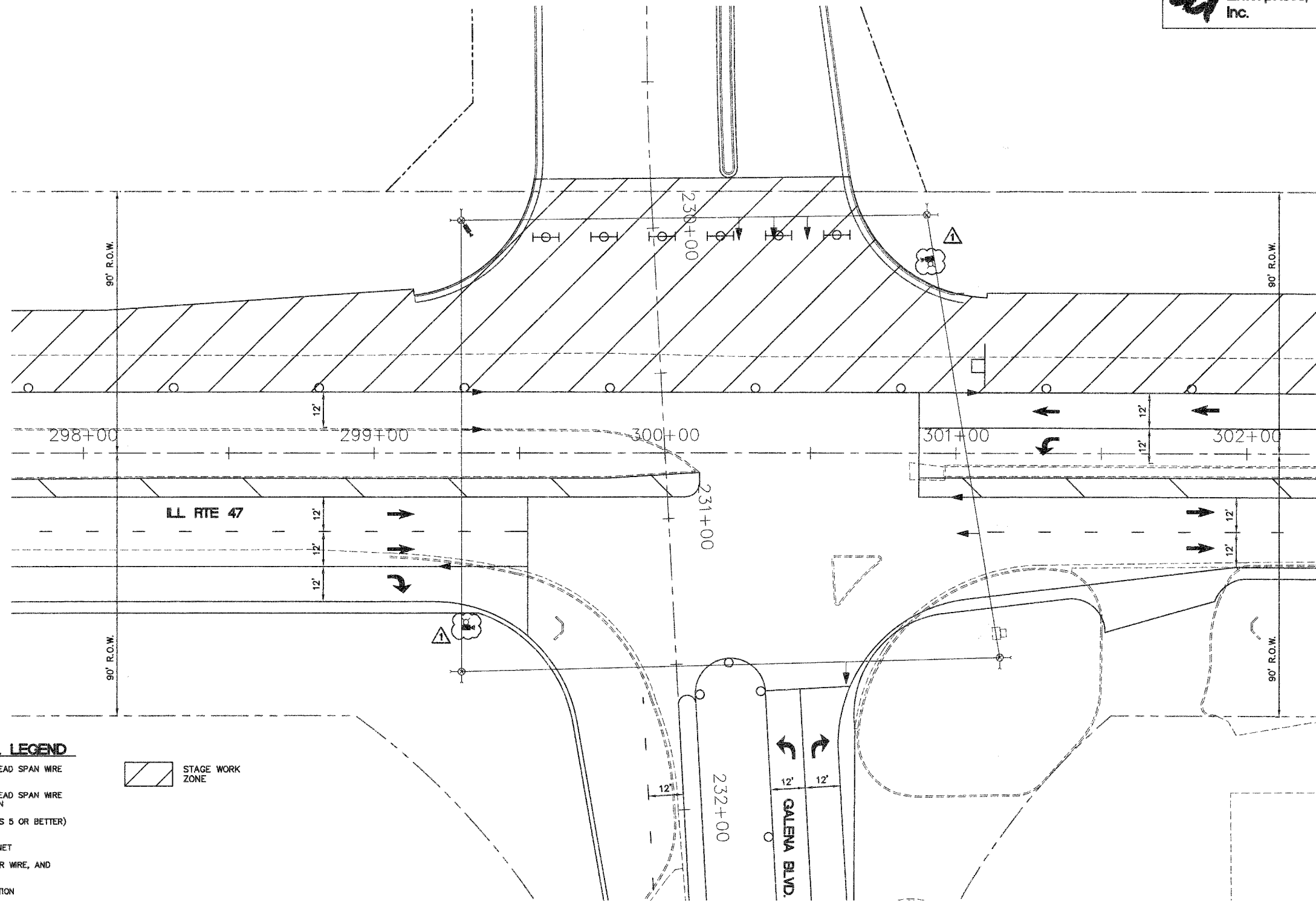

TEMPORARY TRAFFIC SIGNAL LEGEND

- ← TEMPORARY TRAFFIC SIGNAL HEAD SPAN WIRE MOUNTED ORIGINAL LOCATION
- ↖ TEMPORARY TRAFFIC SIGNAL HEAD SPAN WIRE MOUNTED SECONDARY LOCATION
- ⊗ TEMPORARY WOOD POLE (CLASS 5 OR BETTER) 45 FOOT (13.7m) MINIMUM
- ⊠ TEMPORARY CONTROLLER CABINET
- TEMPORARY SPAN WIRE, TETHER WIRE, AND CABLE
- ⊕ TEMPORARY SERVICE INSTALLATION
- ⊞ TEMPORARY PEDESTRIAN SIGNAL HEAD, BRACKET MOUNTED
- ⊙ TEMPORARY PEDESTRIAN PUSHBUTTON DETECTOR
- ⊞ VIDEO VEHICLE SENSOR
- ⊞ EMERGENCY VEHICLE LIGHT DETECTOR
- ⊞ CONFIRMATION BEACON
- VEHICLE DETECTOR, INDUCTION LOOP
- UD UNIT DUCT
- G.S. CONDUIT IN TRENCH (T) OR PUSHED (P)
- ⊞ HANDHOLE
- ⊞ HEAVY DUTY HANDHOLE
- CT COMMON TRENCH
- ⊞ DOWN GUY
- ▨ STAGE WORK ZONE

REVISIONS	
NAME	DATE

ILLINOIS DEPARTMENT OF TRANSPORTATION

ILL RTE 47 AND GALENA BOULEVARD TEMPORARY TRAFFIC SIGNAL (STAGE 2)

SCALE: 1" = 20'
DATE: 02/07/08

DRAWN BY:
CHECKED BY: TWV

REVISION 7/17/08