

**Engineering Enterprises, Inc.**

F.A. RTE.	SECTION	COUNTY	TOTAL SHEETS	SHEET NO.
N/A	06-00017-00-PV	KANE	232	132
STA.		TO STA.		
FED. ROAD DIST. NO.		ILLINOIS	FED. AID PROJECT	

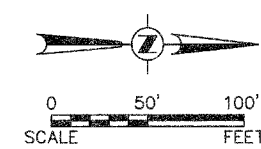

PLAN	SURVEYED	DATE
	PLOTTED	BY
	GRADES CHECKED	
	STRUCTURE NOTATIONS CHECKED	
	NOTE BOOK NO.	
	CADD FILE NAME	

MATCHLINE B-B

MATCHLINE C-C

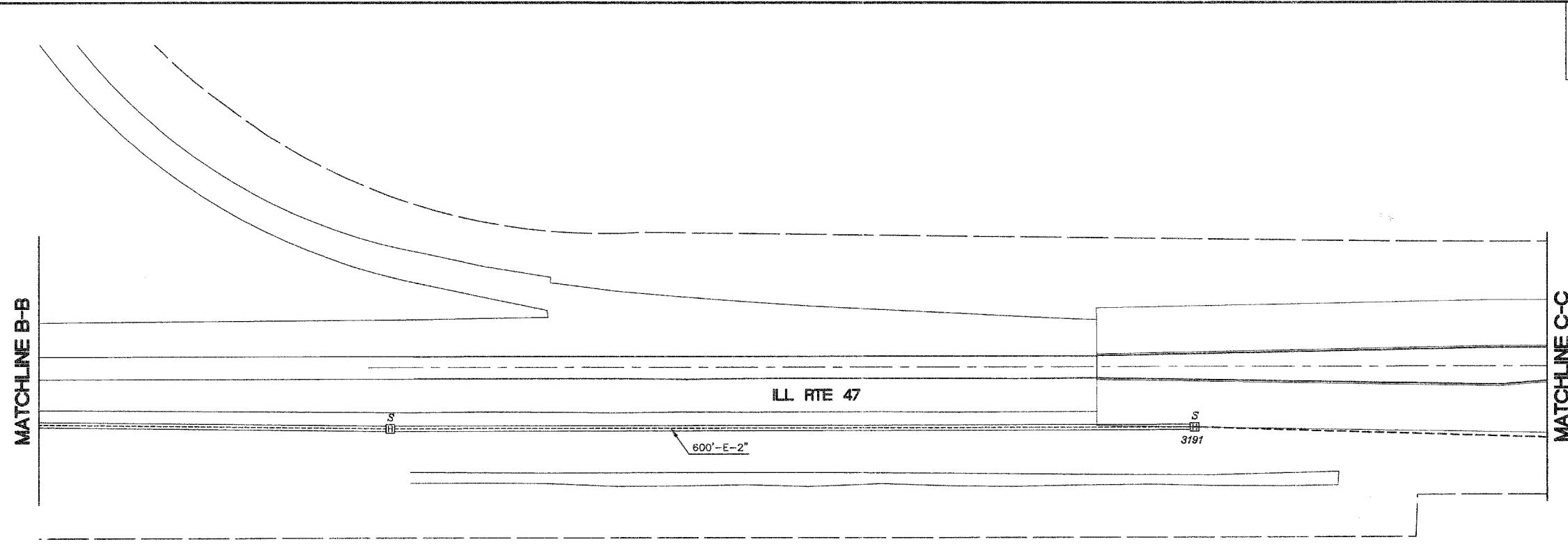

**INTERCONNECT PLAN LEGEND**

- | EXISTING | PROPOSED |   |
|----------|----------|---|
|          |          | CONTROLLER  |
|          |          | HANDHOLE  |
|          |          | DOUBLE HANDHOLE   |
|          |          | HEAVY-DUTY HANDHOLE   |
|          |          | G.S. CONDUIT IN TRENCH OR PUSHED                                |
|          |          | DETECTOR LOOP   |
|          |          | COMMON TRENCH   |
|          |          | UNIT DUCT   |
|          |          | SYSTEM  |
|          |          | INTERSECTION  |
|          |          | TELEPHONE   |
|          |          | TEMPORARY WOOD POLE (CLASS 5 OR BETTER)<br>45 FOOT (13.7m MIN.) |

PROFILE	SURVEYED	DATE
	PLOTTED	BY
	GRADES CHECKED	
	STRUCTURE NOTATIONS CHECKED	
	NOTE BOOK NO.	
	CADD FILE NAME	

MATCHLINE C-C

MATCHLINE D-D

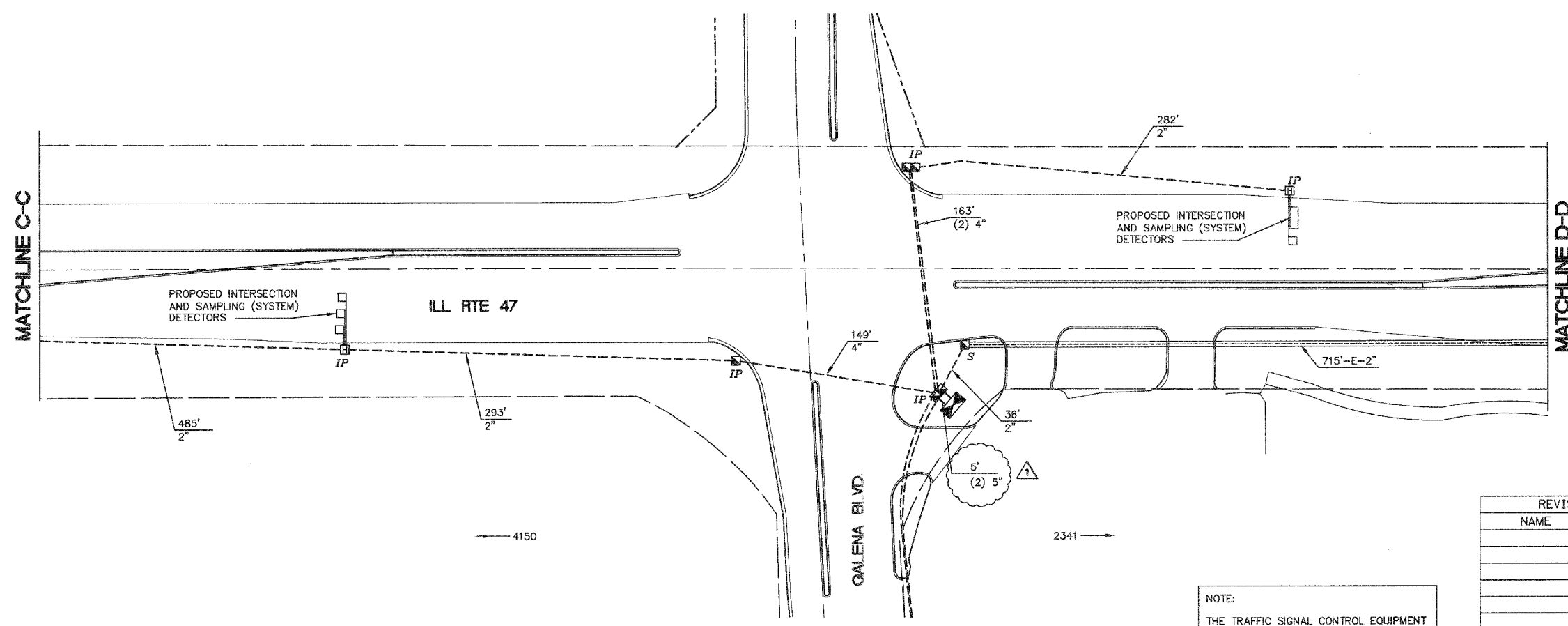

NOTE:  
THE TRAFFIC SIGNAL CONTROL EQUIPMENT FOR THIS PROJECT SHALL BE "EAGLE" TO MATCH THE EXISTING ADJACENT SYSTEM.

REVISD 7/17/08

REVISIONS	
NAME	DATE

ILLINOIS DEPARTMENT OF TRANSPORTATION

**INTERCONNECT PLAN**  
**ILL RTE 47 FROM**  
**△ CROSS STREET TO**  
**BLISS RD./WHEELER RD.**  
**(2 OF 3)**

SCALE: 1" = 50'  
 DATE: 05/16/08

DRAWN BY: KKP  
 CHECKED BY: TWV