

F.A. RTE.	SECTION	COUNTY	TOTAL SHEETS	SHEET NO.
N/A	06-00017-00-PV	KANE	232	1

STATE OF ILLINOIS
DEPARTMENT OF TRANSPORTATION
DIVISION OF HIGHWAYS

PLANS FOR PROPOSED
FEDERAL AID HIGHWAY

MUNICIPAL DRIVE, FROM BASTIAN DRIVE TO GALENA BOULEVARD
FAU 1521 (GALENA BOULEVARD), FROM WEST OF IL. ROUTE 47 TO MUNICIPAL DRIVE

SECTION 06-00017-00-PV

PROJECT NUMBER: HPP 2879 (001)

JOB NUMBER: C91 193 06

PAVEMENT CONSTRUCTION, UTILITY,
AND INTERSECTION IMPROVEMENTS
KANE COUNTY



LOCATION OF SECTION INDICATED THUS: - [shaded box] -

ENGINEER'S CERTIFICATION

I HEREBY CERTIFY THAT THESE PLANS WERE PREPARED UNDER MY DIRECT SUPERVISION.

DATED AT SUGAR GROVE, ILLINOIS

THIS 29 DAY OF MAY 2008

Ronald G. Naylor
RONALD G. NAYLOR, P.E.
ILLINOIS LICENSED PROFESSIONAL ENGINEER NO. 028491
EXPIRATION DATE: 11/30/09

AGENCY RESPONSIBLE FOR LETTING

APPROVED *Anthony Spencel*
LOCAL AGENCY, PUBLIC WORKS DIRECTOR

PASSED *May 30, 2008*
Chas Holt
DISTRICT ENGINEER OF LOCAL ROADS & STREETS
STATE OF ILLINOIS

RELEASING FOR BID BASED ON LIMITED REVIEW
DEPARTMENT OF TRANSPORTATION
DIVISION OF HIGHWAYS
May 30, 2008
DEPUTY DIRECTOR OF HIGHWAYS, REGIONAL ENGINEER

PRINTED BY THE AUTHORITY
OF THE STATE OF ILLINOIS

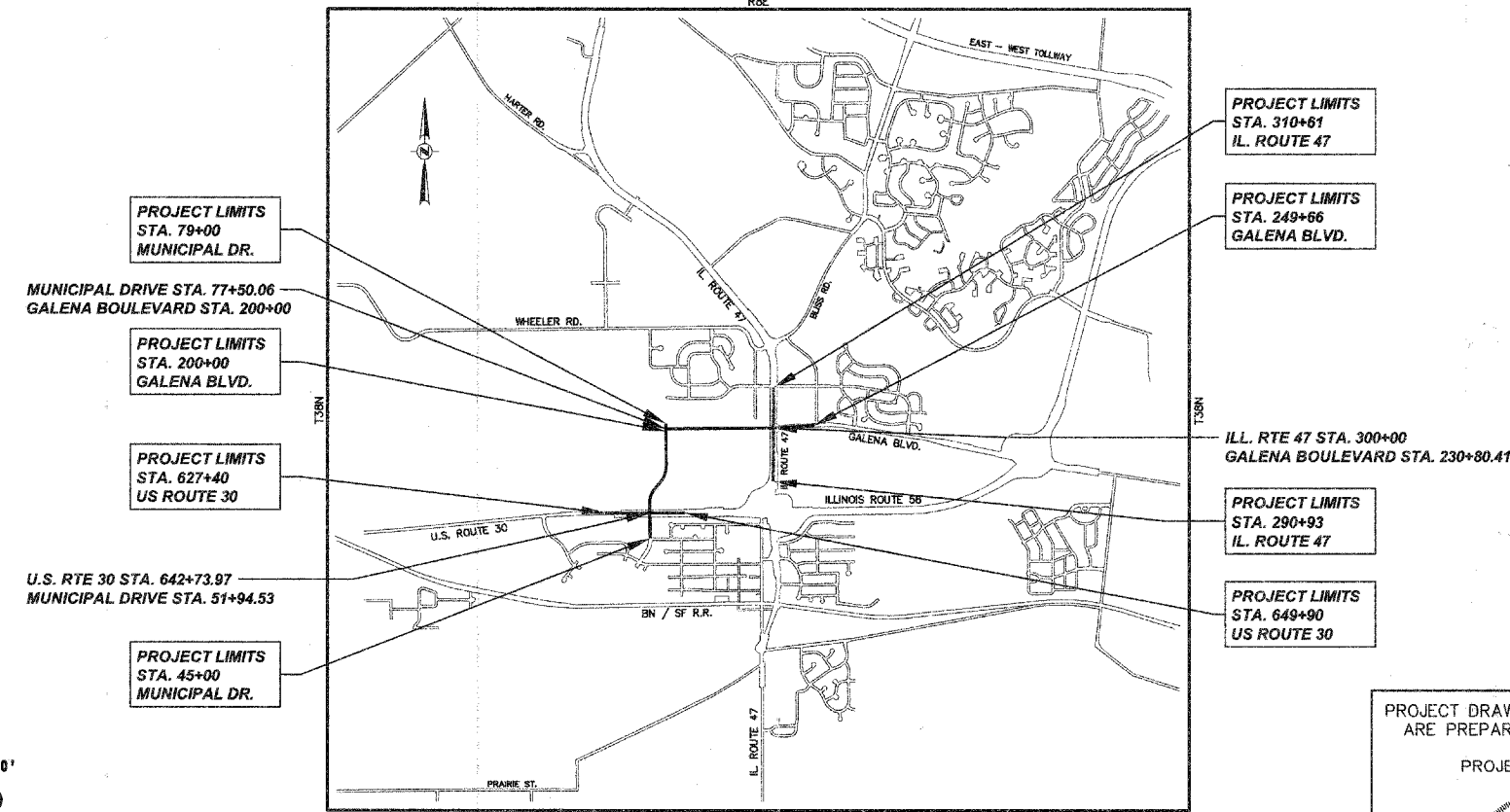

LOCATION MAP

TOTAL LENGTH OF PROJECT = 12,544 FEET (2.37 MILES)
MUNICIPAL DRIVE = 3,400 FEET (0.64 MILES)
GALENA BOULEVARD = 4,966 FEET (0.94 MILES)
US ROUTE 30 = 2,210 FEET (0.42 MILES)
IL. ROUTE 47 = 1,968 FEET (0.37 MILES)

FOR INDEX OF SHEETS AND
PAVEMENT DESIGN INFORMATION,
STRUCTURAL PAVEMENT DESIGN
INFORMATION, SPEED LIMITS
AND ADT SEE SHEET NO. 2

PROJECT LOCATED IN
VILLAGE OF SUGAR GROVE

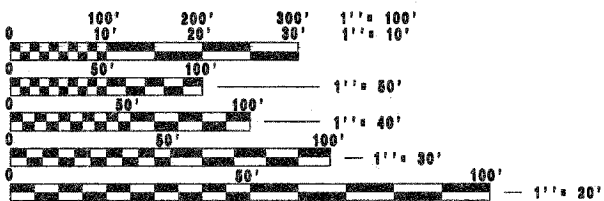

FULL SIZE PLANS HAVE BEEN PREPARED USING STANDARD
ENGINEERING SCALES. REDUCED SIZED PLANS WILL NOT
CONFORM TO STANDARD SCALES. IN MAKING MEASUREMENTS
ON REDUCED PLANS, THE ABOVE SCALES MAY BE USED.

J.U.L.I.E.
JOINT UTILITY LOCATION INFORMATION FOR EXCAVATION
1-800-892-0123

CONTRACT NO. 63023



PROJECT DRAWINGS #E-1 TO #E-15
ARE PREPARED BY SUNJOY INC.

PROJECT ENGINEER



EEI Engineering Enterprises, Inc.
CONSULTING ENGINEERS
52 Wheeler Road
Sugar Grove, Illinois 60554
Phone: (630) 466-9350

FEDERAL AID DESIGN ENGINEER CONTACT: MARLIN SOLOMON 847-705-4407
CONSULTING ENGINEER: ENGINEERING ENTERPRISES, INC. CONTACT: RON NAYLOR 630-466-9350

Plotted: May 29, 2008 @ 11:14 AM By: Kris Purig - Tab: 01 EVR (22x34)

Path: \\S05RPRO\560546\DWG\63023\0603\0603\FINAL ENR\CONTRACT B\B-630546-COVER