

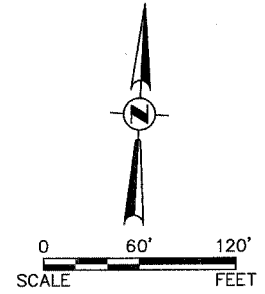

F.A. RTE.	SECTION	COUNTY	TOTAL SHEETS	SHEET NO.
N/A	06-00017-00-PV	KANE	232	72
STA.		TO STA.		
FED. ROAD DIST. NO.		ILLINOIS FED. AID PROJECT		



PLAN	DATE
SURVEYED	
DESIGNED	
CHECKED	
RT. OF WAY CHECKED	
CADD FILE NAME	
NO.	

PROFILE	DATE
SURVEYED	
DESIGNED	
CHECKED	
B.M. NOTED	
STRUCTURE NOTATIONS CHECKED	
NO.	

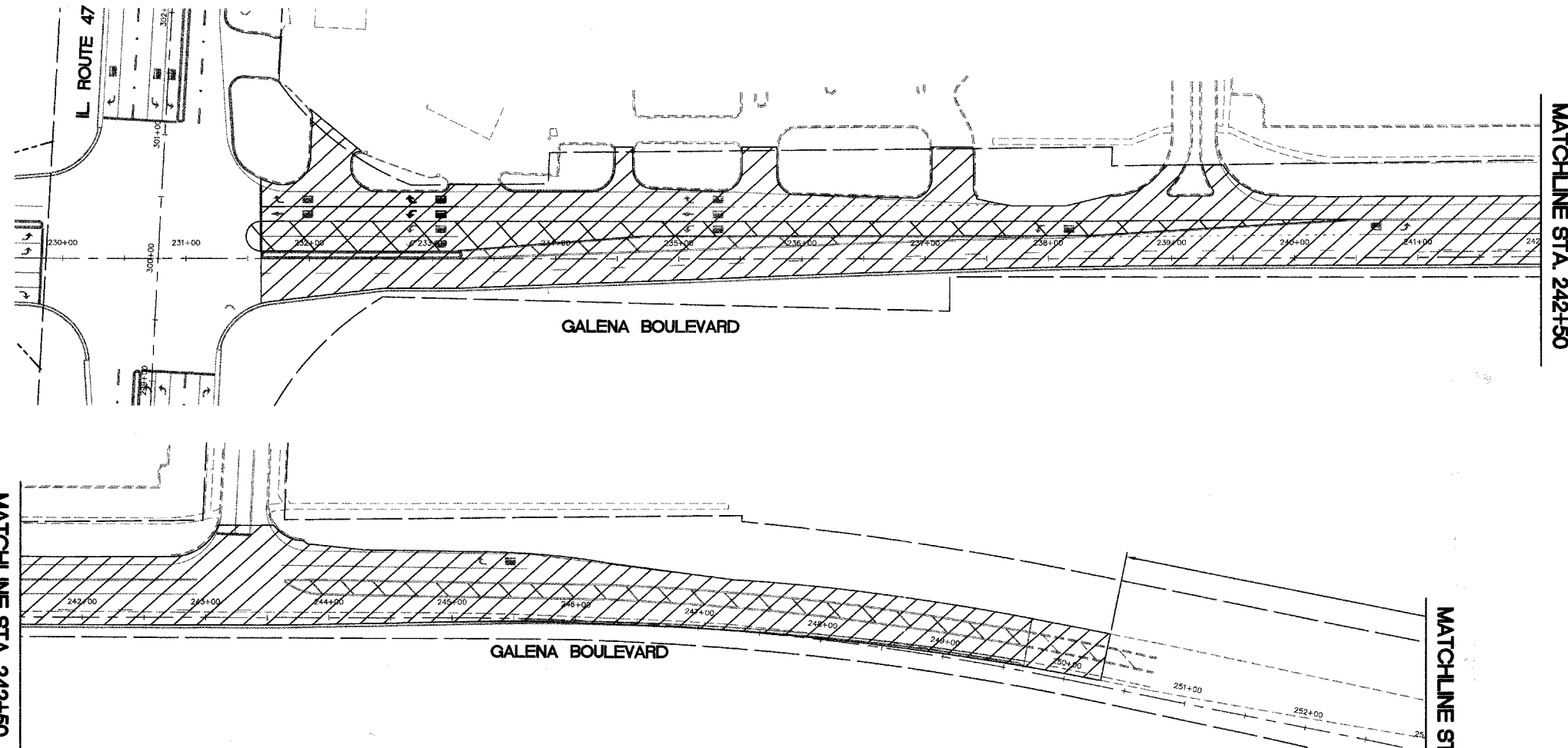

- | | | |
|--|---|--|
| | WORK AREA | WORK ITEMS |
| | TRAFFIC CONTROL DRUM W/ STEADY BURN AMBER LIGHT | - REMOVE CONFLICTING TEMPORARY PAVEMENT MARKINGS |
| | SIGN | - MILL AND OVERLAY GALENA BOULEVARD. |
| | TYPE 3 BARRICADE | - PERMANENT PAVEMENT MARKINGS. |
| | DIRECTIONAL INDICATOR BARRICADE | |
| | ARROW BOARD | |

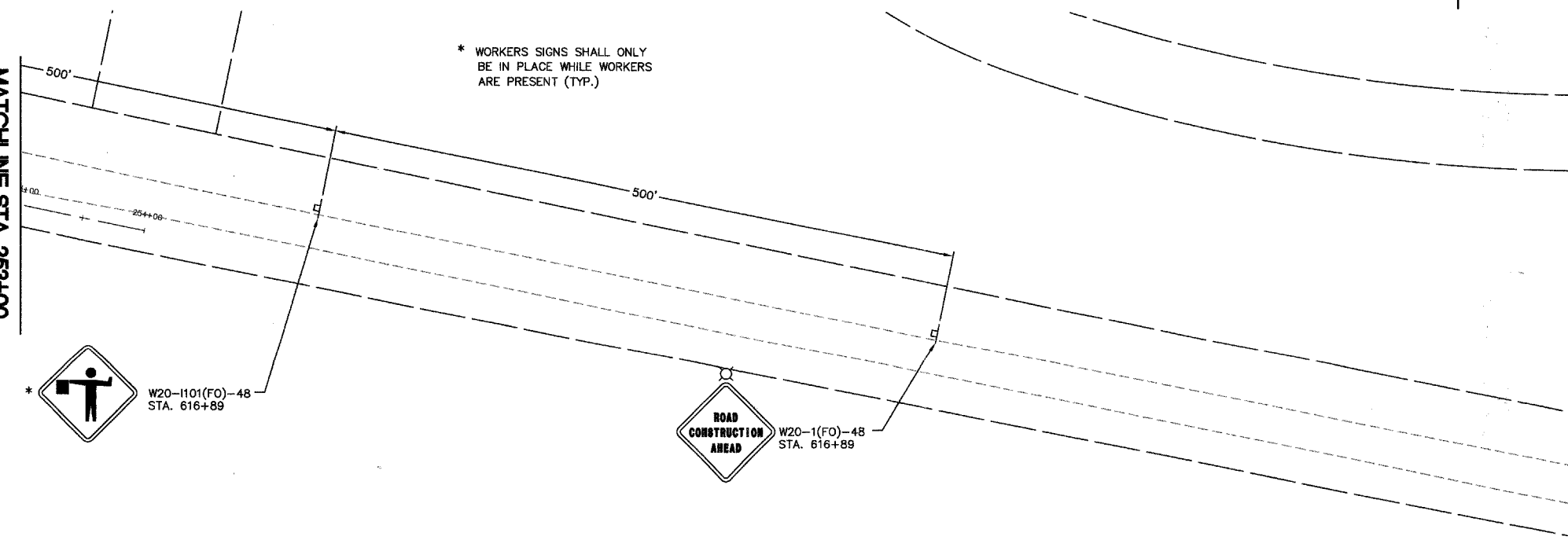

* WORKERS SIGNS SHALL ONLY BE IN PLACE WHILE WORKERS ARE PRESENT (TYP.)

* W20-1101(FO)-48 STA. 616+89

W20-1(FO)-48 STA. 616+89

STAGE 4B: IL. ROUTE 47 AND GALENA BOULEVARD

- NOTES:
- SEE IDOT STANDARD 701606-05 FOR DETAILS ON DAYTIME LANE CLOSURES.
 - WESTBOUND GALENA BOULEVARD PAVEMENT MARKINGS TO MATCH THOSE SHOWN ON STAGE 2 IL. ROUTE 47 UNTIL WESTBOUND THROUGH MOVEMENTS ARE ALLOWED AT THIS INTERSECTION.
 - PAVEMENT JOINTS ARE TO BE CONSISTENT WITH FUTURE LANE LINES PER ARTICLE 406.06(g) OF THE STANDARD SPECIFICATIONS.
 - BUTT JOINTS SHALL NOT REMAIN EXPOSED TO TRAFFIC OVER NIGHT. MILLED OR UNFINISHED SURFACES WILL REQUIRE A 40(H) : 1(V) TEMPORARY RAMP PER ARTICLE 406.08 OF THE STANDARD SPECIFICATIONS.
 - TO BE COMPLETED WITH STAGE 4 IL. ROUTE 47.
 - GALENA BOULEVARD STAGE 4 TRAFFIC CONTROL AND PROTECTION IS FOR FINAL RESURFACING AND PAVEMENT MARKINGS TO BE COMPLETED WITH ILLINOIS ROUTE 47 STAGE 4 TRAFFIC CONTROL AND PROTECTION.

REVISIONS	
NAME	DATE

ILLINOIS DEPARTMENT OF TRANSPORTATION

ILLINOIS ROUTE 47 AND GALENA BOULEVARD TRAFFIC CONTROL AND STAGING PLAN

SCALE: 1" = 60'
DATE: 02/07/08

DRAWN BY:
CHECKED BY: WBR