

Engineering Enterprises, Inc.

F.A. RTE.	SECTION	COUNTY	TOTAL SHEETS	SHEET NO.
N/A	D6-00017-00-PV	KANE	232	114
STA. 299+50 TO STA. 312+00			FED. AID PROJECT	
ILLINOIS		FED. ROAD DIST. NO.		

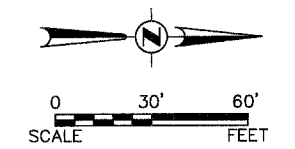

DATE	BY
NO.	

PLAN
 SUBMITTED
 PLOTTED
 ALIGNMENT CHECKED
 GRADES CHECKED
 STRUCTURE NOTATION CHECKED
 NO. _____
 DATE _____

DATE	BY
NO.	

PROFILE
 SUBMITTED
 PLOTTED
 GRADES CHECKED
 STRUCTURE NOTATION CHECKED
 NO. _____
 DATE _____

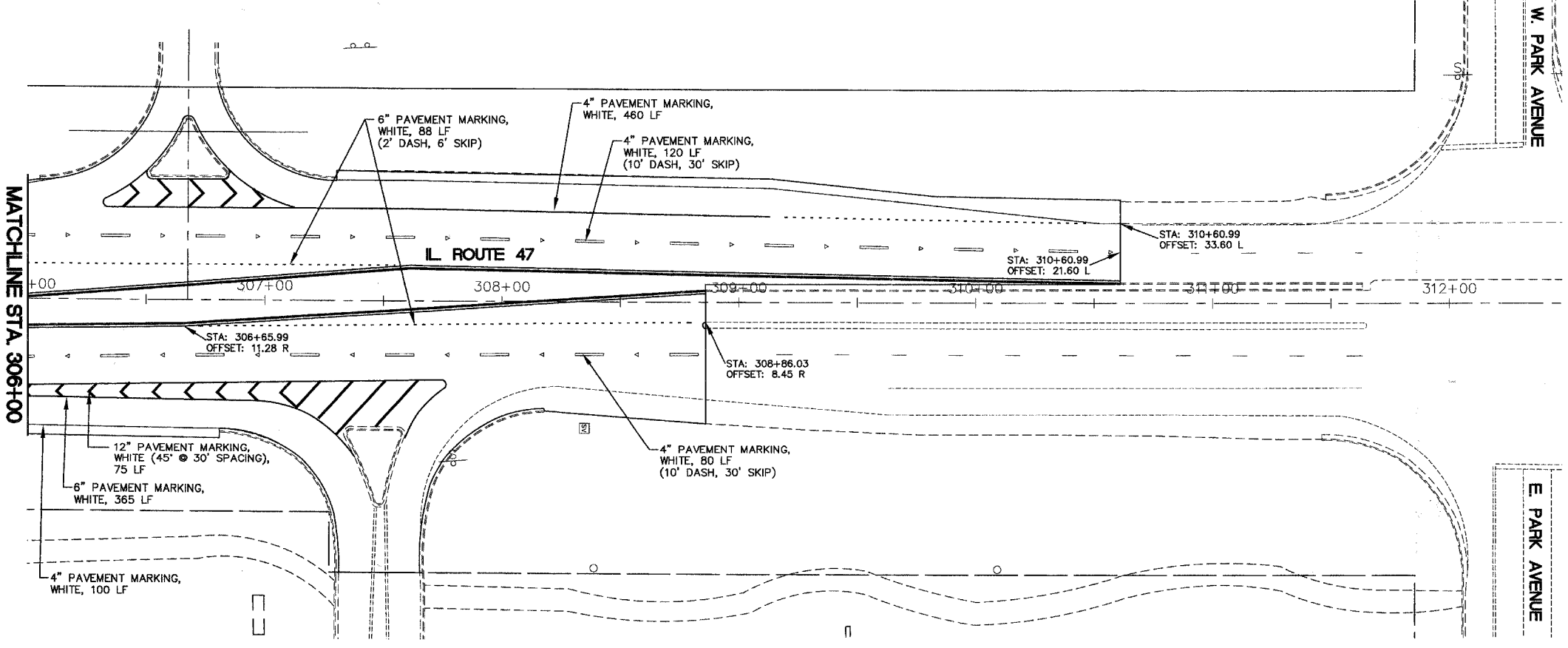
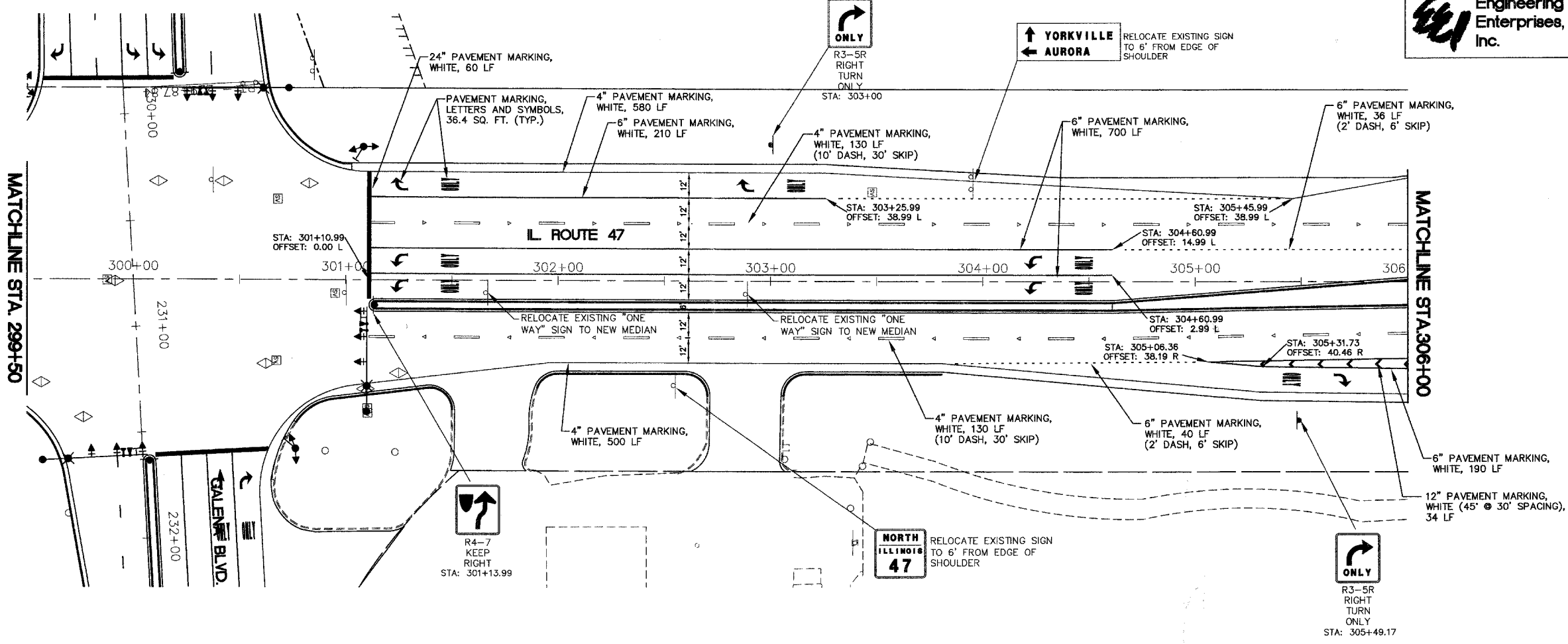

REVISIONS	
NAME	DATE

ILLINOIS DEPARTMENT OF TRANSPORTATION

STRIPING AND SIGNAGE PLAN ILLINOIS ROUTE 47

SCALE: 1" = 30'
 DATE: 02/07/08
 DRAWN BY: KKP
 CHECKED BY: WBR

Plotted: May 27, 2008 @ 4:59 PM By: Jim Gales - Tab: 114 STRIP (22x34)

Path: \\S05KPR001\SS0546\Drawings\63023\2D\DWG-FINAL-ENG\CONTRACT 63023-SS0546-STRIP