

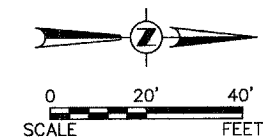

F.A. RTE.	SECTION	COUNTY	TOTAL SHEETS	SHEET NO.
N/A	06-00017-00-PV	KANE	232	120
STA. 292+00		TO STA. 298+65		
FED. ROAD DIST. NO. _		ILLINOIS FED. AID PROJECT		



TEMPORARY TRAFFIC SIGNAL LEGEND

- ◀ TEMPORARY TRAFFIC SIGNAL HEAD SPAN WIRE MOUNTED ORIGINAL LOCATION
- ◀ TEMPORARY TRAFFIC SIGNAL HEAD SPAN WIRE MOUNTED SECONDARY LOCATION
- ⊗ TEMPORARY WOOD POLE (CLASS 5 OR BETTER) 45 FOOT (13.7m) MINIMUM
- ⊠ TEMPORARY CONTROLLER CABINET
- TEMPORARY SPAN WIRE, TETHER WIRE, AND CABLE
- ⊕ TEMPORARY SERVICE INSTALLATION
- TEMPORARY PEDESTRIAN SIGNAL HEAD, BRACKET MOUNTED
- ⊙ TEMPORARY PEDESTRIAN PUSHBUTTON DETECTOR
- ▶ VIDEO VEHICLE SENSOR
- ▶ EMERGENCY VEHICLE LIGHT DETECTOR
- ▶ CONFIRMATION BEACON
- VEHICLE DETECTOR, INDUCTION LOOP
- UD UNIT DUCT
- G.S. CONDUIT IN TRENCH (T) OR PUSHED (P)
- HANDHOLE
- HEAVY DUTY HANDHOLE
- CT COMMON TRENCH
- DOWN GUY

EXISTING EQUIPMENT TO BE REMOVED LEGEND

- ◀ EXISTING SIGNAL HEAD TO BE REMOVED
- EXISTING SERVICE INSTALLATION TO BE REMOVED
- EXISTING SIGNAL POST AND FOUNDATION TO BE REMOVED
- ▶ EXISTING ALUMINUM MAST ARM POLE AND FOUNDATION TO BE REMOVED
- ⊠ EXISTING CONTROLLER AND FOUNDATION TO BE REMOVED
- EXISTING HANDHOLE TO BE REMOVED
- EXISTING PEDESTRIAN SIGNAL HEAD TO BE REMOVED
- ⊙ EXISTING PEDESTRIAN PUSHBUTTON TO BE REMOVED
- ▶ EXISTING EMERGENCY VEHICLE LIGHT DETECTOR TO BE REMOVED
- ▶ EXISTING CONFIRMATION BEACON TO BE REMOVED
- EXISTING HEAVY-DUTY HANDHOLE TO BE REMOVED
- ▶ EXISTING STEEL MAST ARM POLE AND FOUNDATION TO BE REMOVED

REVISIONS	
NAME	DATE

ILLINOIS DEPARTMENT OF TRANSPORTATION

**ILL RTE 47
AND
GALENA BOULEVARD
TEMPORARY TRAFFIC SIGNAL
AND REMOVAL PLAN
(STAGE 1)**

SCALE: 1" = 20'
DATE: 05/16/08

DRAWN BY: KKP
CHECKED BY: TVW

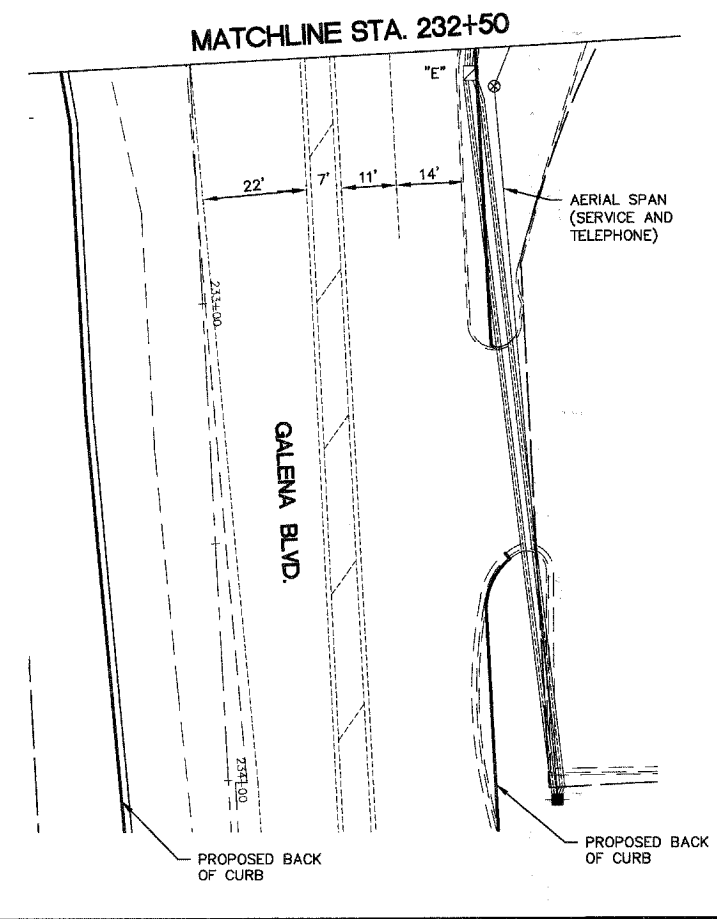
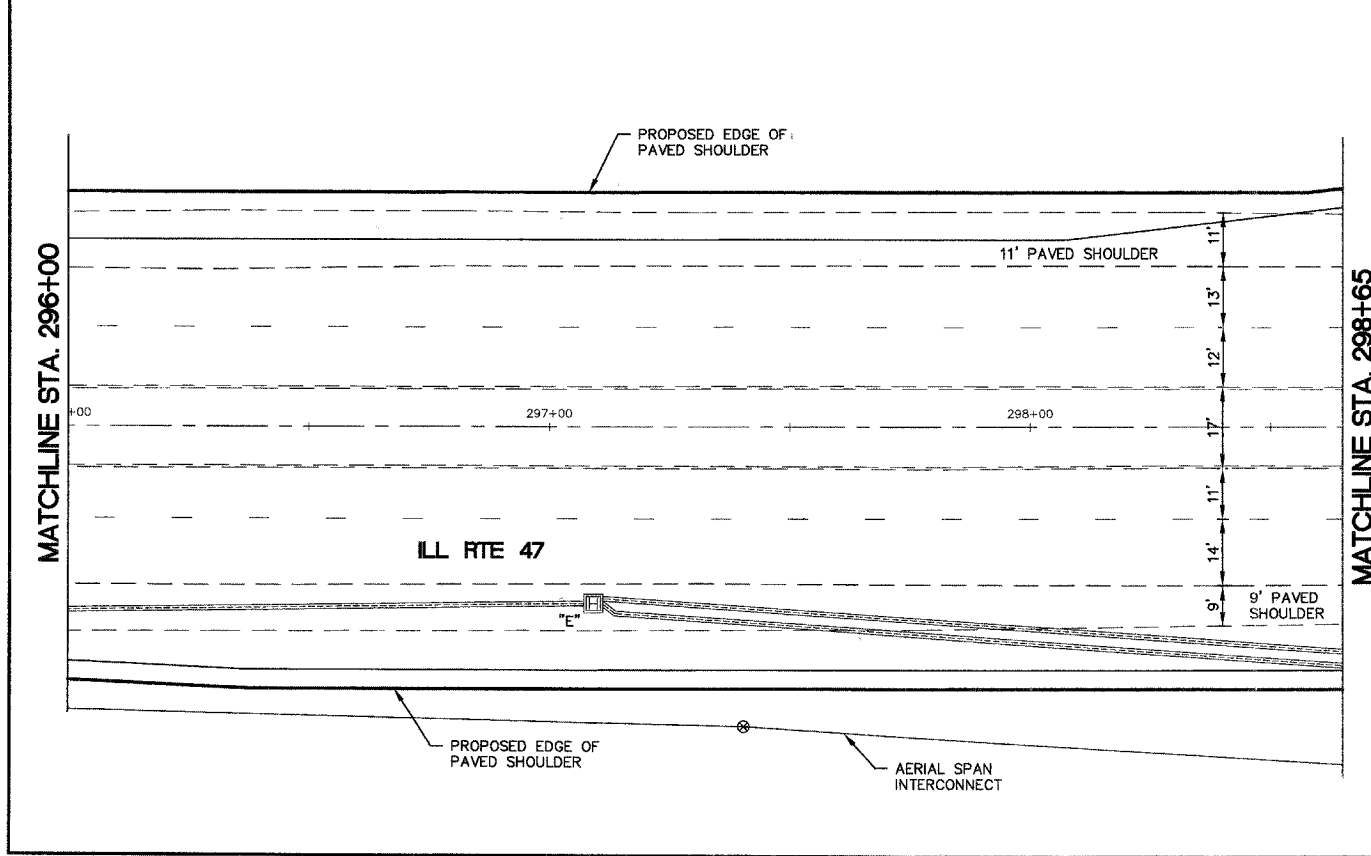
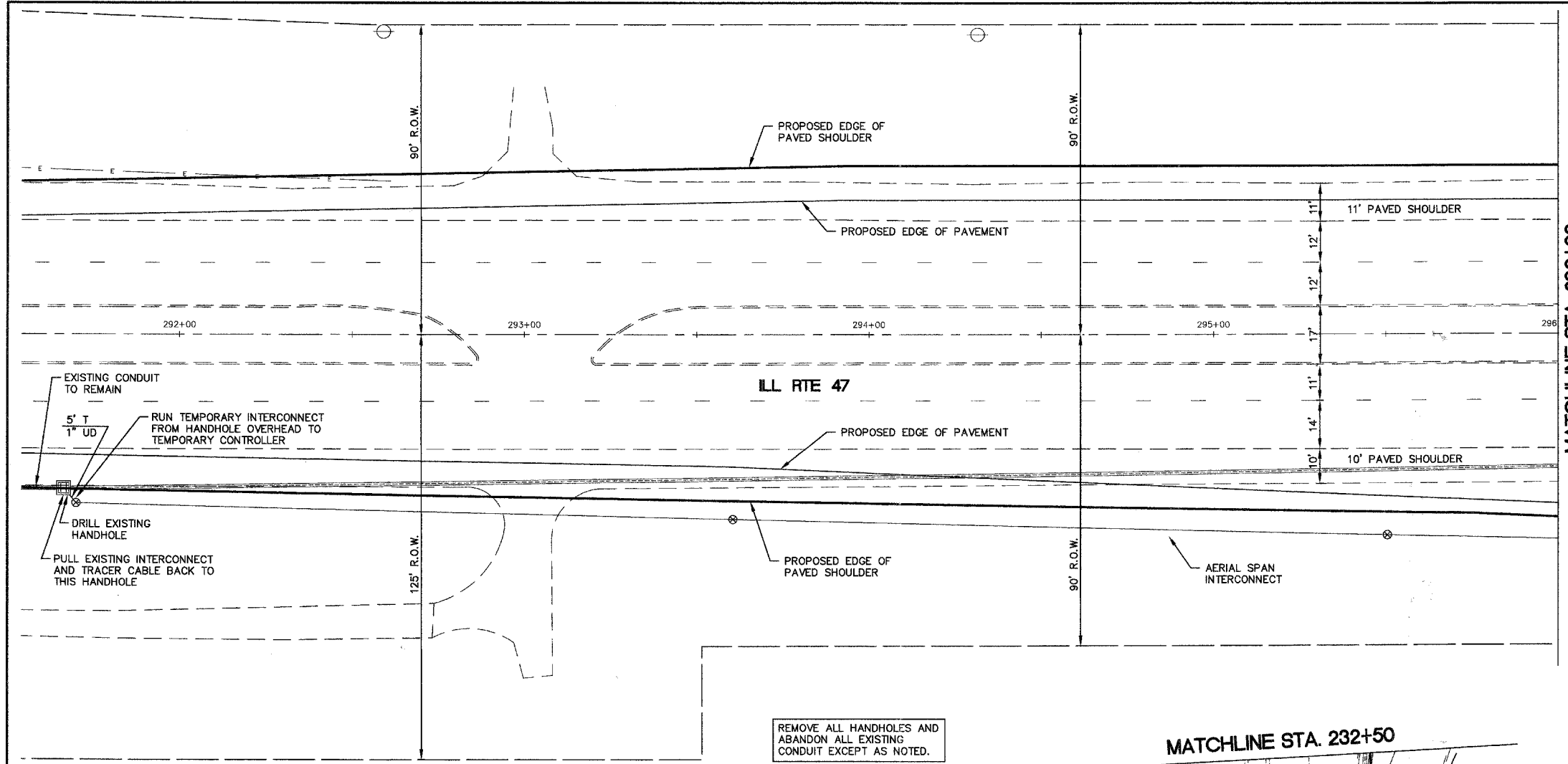

DATE	BY

PLAN

REVISIONS
CHECKED
PLOTTED
ALIGNMENT CHECKED
NOTES CHECKED
NO. CAD FILE NAME

DATE	BY

PROFILE

REVISIONS
CHECKED
PLOTTED
GRADES CHECKED
STRUCTURE NOTATIONS CHECKED
NO.

Plotted: May 28, 2008 @ 6:15 AM By: Kris Pung - Tab: 120 TEMP SIGNAL (22x34)

Path: H:\SIS\PROJ\63023\DWG\63023.DWG FINAL ENG\CONTRACT BY: 63023-120.TEMP.SIG