

STATE OF ILLINOIS
 DEPARTMENT OF TRANSPORTATION
 DIVISION OF HIGHWAYS

PLANS FOR PROPOSED
 FEDERAL AID HIGHWAY

F. A. I. NO.	SECTION	COUNTY	TOTAL SHEETS	SHEET NO.
2947	08-00148-00-RS	COOK	011	001
STA.	TO STA.			
FED. ROAD DIST. NO.	ILLINOIS	FED. AID PROJECT		

CONTRACT #63044

INDEX OF SHEETS
 SEE SHEET NO. 2

STATE STANDARDS
 SEE SHEET NO. 2

SCALES
 PLAN - 1"=50'
 PROFILE HORIZ. - 1"=50'
 PROFILE VERT. - 1"=5'
 CROSS SECTIONS - 1"=10'

FAU 2947 (STATELINE ROAD)
 FROM 155TH STREET TO RIVER OAKS DRIVE
 ROADWAY RESURFACING
 SECTION: 08-00148-00-RS
 PROJECT: M-8003(959)
 C-91-221-08
 CITY of CALUMET CITY
 COOK COUNTY

DESIGN DESIGNATION - STATELINE ROAD COLLECTOR
 ADT: 6200 (2007)
 100% OF DESIGN TRAFFIC IN DESIGN LANE

POSTED SPEED LIMIT - 35MPH

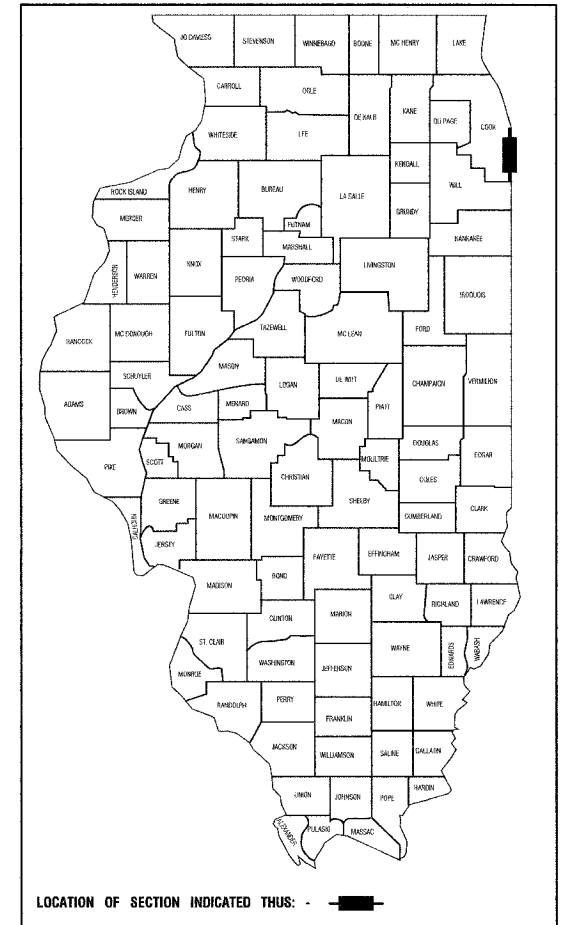

LOCATION OF SECTION INDICATED THUS: [Symbol]

LOCATION MAP
 NO SCALE

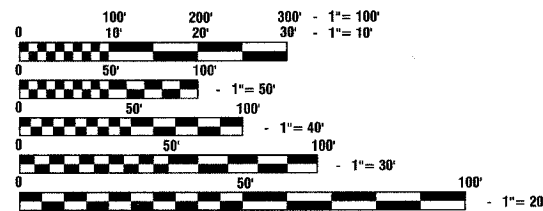

FULL SIZE PLANS HAVE BEEN PREPARED USING STANDARD ENGINEERING SCALES, REDUCED SIZED PLANS WILL NOT CONFORM TO STANDARD SCALES, IN MAKING MEASUREMENTS ON REDUCED PLANS, THE ABOVE SCALES MAY BE USED.

J.U.L.I.E.
 JOINT UTILITY LOCATION INFORMATION FOR EXCAVATION
 1-800-892-0123

CONTRACT NO. 63044

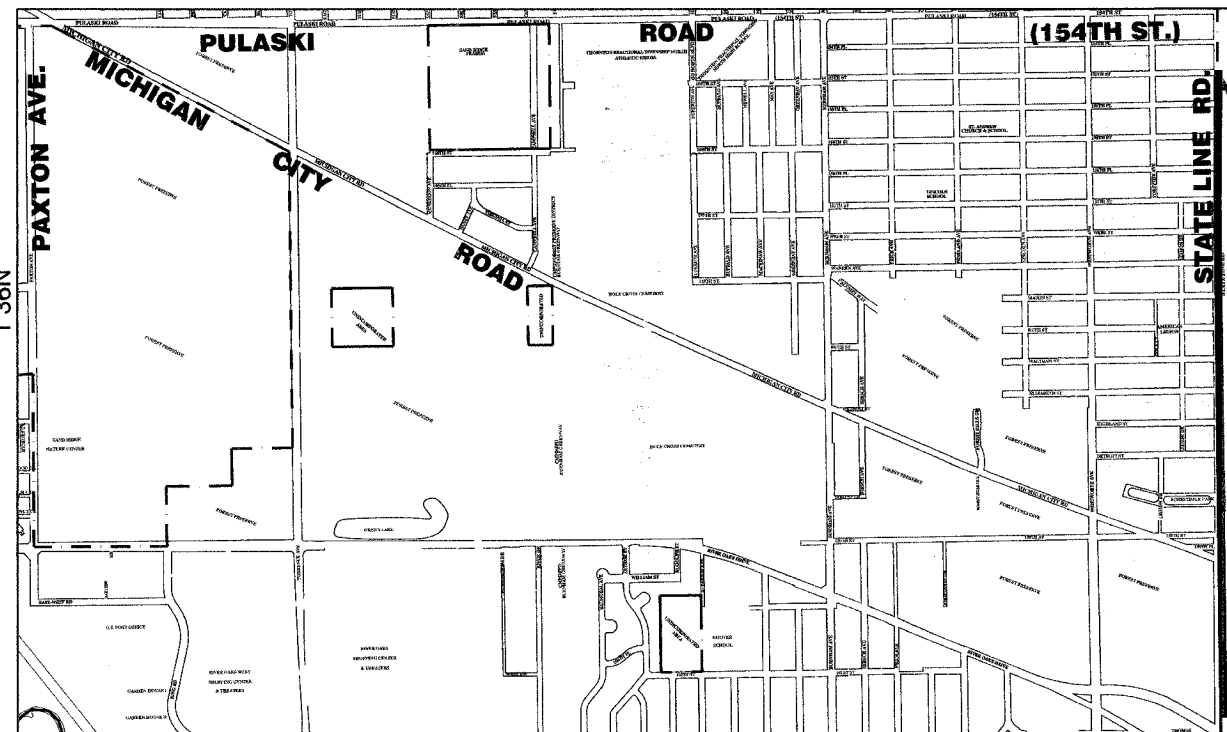

PROJECT ENDS
 STA 70+08

PROJECT BEGINS
 STA 5+20

THORNTON TOWNSHIP
 GROSS AND NET LENGTH=6488 FEET=1.23 MILES

STATE OF ILLINOIS
 DEPARTMENT OF TRANSPORTATION

APPROVED May 7 2008
Michelle M. Kavanagh LOCAL AGENCY OFFICER

PASSED MAY 22 2008
Christopher Holt DISTRICT ENGINEER OF LOCAL ROADS & STREETS

RELEASING FOR BID REVIEW May 22 2008
 BASED ON LIMITED REVIEW *Diana M. O'Keefe* DEPUTY DIRECTOR OF HIGHWAYS, REGION ONE ENGINEER

PRINTED BY AUTHORITY OF THE STATE OF ILLINOIS

PREPARED BY OR UNDER THE
 DIRECT SUPERVISION OF:

[Signature]
 5/7/08

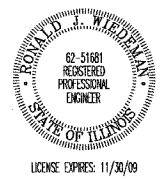

FIELD ENGINEER-MELCHOR MANGOBA (847) 705-4408
 CONSULTANTS: ROBINSON ENGINEERING, LTD. 708-331-8700
 CONTACT ENGINEER: RON WEDEMAN

F. A. U. FILE NO.	SECTION	COUNTY	TOTAL SHEETS	SHEET NO.
2947	08-00148-00-RS	COOK	011	002
STA.		TO STA.		
FED. ROAD DIST. NO.	BLMGS	FED. RD PROJECT		

CONTRACT #63044

INDEX OF SHEETS

1. COVER SHEET
2. INDEX OF SHEETS, STATE STANDARDS, AND GENERAL NOTES
3. SUMMARY OF QUANTITIES
4. TYPICAL SECTIONS
5. SCHEDULES
- 6.-8. PAVEMENT MARKING PLAN
9. CONSTRUCTION DETAILS
- 10.-11. DISTRICT ONE STANDARD DETAILS

STATE STANDARDS

- | | |
|-----------|---|
| 420001-07 | PAVEMENT JOINTS |
| 424001-05 | CURB RAMPS FOR SIDEWALKS |
| 442201-03 | CLASS C AND D PATCHES |
| 602011 | CATCH BASIN TYPE C |
| 604001-02 | FRAME AND LIDS TYPE I |
| 606001-03 | CONCRETE CURB TYPE B AND COMBINATION CONCRETE CURB AND GUTTER |
| 701311-02 | LANE CLOSURE 2L, 2W MOVING OPERATIONS-DAY ONLY |
| 701501-04 | URBAN LANE CLOSURE, 2L, 2W, UNDIVIDED |
| 701701-05 | URBAN LANE CLOSURE, MULTILANE INTERSECTION |
| 701801-03 | LANE CLOSURE MULTILANE 1W OR 2W CROSSWALK OR SIDEWALK CLOSURE |
| 701901 | TRAFFIC CONTROL DEVICES |

GENERAL NOTES

1. BEFORE ANY EXCAVATION, THE CONTRACTOR SHALL CALL "JULIE" AT 1-800-892-0123 FOR FIELD LOCATIONS OF BURIED ELECTRIC, TELEPHONE, AND GAS FACILITIES. (48 HOUR NOTIFICATION IS REQUIRED)
2. 10 FOOT TRANSITIONS SHALL BE USED TO MATCH THE PROPOSED CURB AND GUTTER AND MEDIAN ITEMS OF WORK TO EXISTING CURBS AND GUTTERS AND MEDIANS IN THE FIELD, UNLESS OTHERWISE SHOWN. THE TRANSITIONS SHALL BE PAID FOR AT THE CONTRACT UNIT PRICE FOR THE PROPOSED ITEMS OF WORK SPECIFIED.
3. THE CONTRACTOR SHALL COORDINATE CONSTRUCTION ACTIVITIES WITH UTILITY COMPANIES AND THE CITY OF CALUMET CITY
4. THE CONTRACTOR WILL NOT BE ALLOWED TO SET UP A YARD OR FIELD OFFICE ON CITY PROPERTY WITHOUT WRITTEN PERMISSION FROM THE CITY.
5. BUTT JOINTS WILL BE INSTALLED AT THE ENDS OF ALL RESURFACING (WHERE RESURFACING MEETS EXISTING PAVEMENT), IN ACCORDANCE WITH THE "BUTT JOINT AND HMA TAPER DETAILS" SHEET INCLUDED IN THE PLANS UNLESS OTHERWISE SPECIFIED.
6. THE RESIDENT ENGINEER WILL LAY OUT THE LOCATIONS OF SIDEWALK, DRIVEWAY, CURB AND GUTTER AND PATCHING REMOVAL AND REPLACEMENT LOCATIONS.

REVISIONS	
NAME	DATE

ILLINOIS DEPARTMENT OF TRANSPORTATION

**STATELINE ROAD
ROADWAY RESURFACING
INDEX OF SHEETS, STATE STANDARDS,
AND GENERAL NOTES**

SCALE: VERT. NA
HORIZ. NA
DATE 04/23/08

DRAWN BY PS
CHECKED BY RW

ROBINSON ENGINEERING, LTD.
1700 SOUTH PERRY AVENUE, SOUTH HOLLAND, ILLINOIS 60473
(708) 831-8700 FAX (708) 331-9800
ILLINOIS DESIGN FIRM REGISTRATION NO. 150-011205

08003_60-INDEX-01

F. A. U. NO.	SECTION	COUNTY	TOTAL SHEETS	SHEET NO.
2947	08-00148-00-RS	COOK	011	003
STA.		TO STA.		
FED. ROAD DIST. NO.	BLKNO.	FED. AID PROJECT		

CONTRACT #63044

SUMMARY OF QUANTITIES				1000 70% FED/ 30% LOCAL
S.I.	CODE NO.	PAY ITEM	UNIT	TOTAL QUANTITY
	20100210	TREE REMOVAL (OVER 15 UNIT DIAMETER)	UNIT	16
	40600200	BITUMINOUS MATERIALS (PRIME COAT)	TON	20
	40600300	AGGREGATE (PRIME COAT)	TON	97
	40600625	LEVELING BINDER (MACHINE METHOD), N50	TON	1361
	40603335	HOT-MIX ASPHALT SURFACE COURSE, MIX "D", N50	TON	2041
	40600895	CONSTRUCTING TEST STRIP	EACH	1
	40600982	HOT-MIX ASPHALT SURFACE REMOVAL-BUTT JOINT	SQ YD	427
	44000159	HOT-MIX ASPHALT SURFACE REMOVAL, 2 1/2"	SQ YD	24300
	44000200	DRIVEWAY PAVEMENT REMOVAL	SQ YD	80
	44000600	SIDEWALK REMOVAL	SQ FT	10165
	44001700	COMBINATION CONCRETE CURB AND GUTTER REMOVAL AND REPLACEMENT	FOOT	642
	42300200	PORTLAND CEMENT CONCRETE DRIVEWAY PAVEMENT 6 INCH	SQ YD	47
	42400200	PORTLAND CEMENT CONCRETE SIDEWALK 5 INCH	SQ FT	11005
	42400800	DETECTABLE WARNING	SQ FT	272
	56500600	DOMESTIC WATER SERVICE BOX TO BE ADJUSTED	EACH	4
	60500050	REMOVING CATCH BASINS	EACH	4
	60206905	CATCH BASIN, TYPE C WITH TYPE 1 FRAME, OPEN LID	EACH	4
	60265700	VALVE VAULT TO BE ADJUSTED	EACH	5
	67100100	MOBILIZATION	L. SUM	1
	70102620	TRAFFIC CONTROL AND PROTECTION STANDARD 701501	L. SUM	1
	70102635	TRAFFIC CONTROL AND PROTECTION STANDARD 701701	L. SUM	1
	70102640	TRAFFIC CONTROL AND PROTECTION STANDARD 701801	L. SUM	1
*	78001110	PAINT PAVEMENT MARKING-LINE 4"	FOOT	2312
*	78001130	PAINT PAVEMENT MARKING-LINE 6"	FOOT	140
*	78001180	PAINT PAVEMENT MARKING-LINE 24"	FOOT	71
	X4400220	CURB REMOVAL AND REPLACEMENT	FOOT	1737
	X0325769	HOT-MIX ASPHALT REMOVAL, SPECIAL	SQ YD	94
	XX006209	CLASS D PATCH, (SPECIAL), 10 INCH	SQ YD	161
	XX007489	HOT-MIX ASPHALT ALLEY REMOVAL AND REPLACEMENT	SQ YD	8
	XX007490	HOT-MIX ASPHALT DRIVEWAY PAVEMENT, 8 INCH	SQ YD	34
	XX007491	DRAINAGE STRUCTURE TO BE ADJUSTED WITH TYPE 1 FRAME, OPEN LID	EACH	8
	XX007492	DRAINAGE STRUCTURE TO BE ADJUSTED WITH TYPE 1 FRAME, CLOSED LID	EACH	9

* - INDICATES SPECIALTY ITEMS

REVISIONS	
NAME	DATE

ILLINOIS DEPARTMENT OF TRANSPORTATION

STATELINE ROAD
ROADWAY RESURFACING
SUMMARY OF QUANTITIES

SCALE: VERT. NA
HORIZ. NA
DATE 04/23/08

DRAWN BY PS
CHECKED BY RW

F. A. U. SHEET	SECTION	COUNTY	TOTAL SHEETS	SHEET NO.
2947	08-00148-00-RS	COOK	011	004
STA. TO STA.		FED. ROAD DIST. NO.		
		FED. RD PROJECT		

CONTRACT #63044

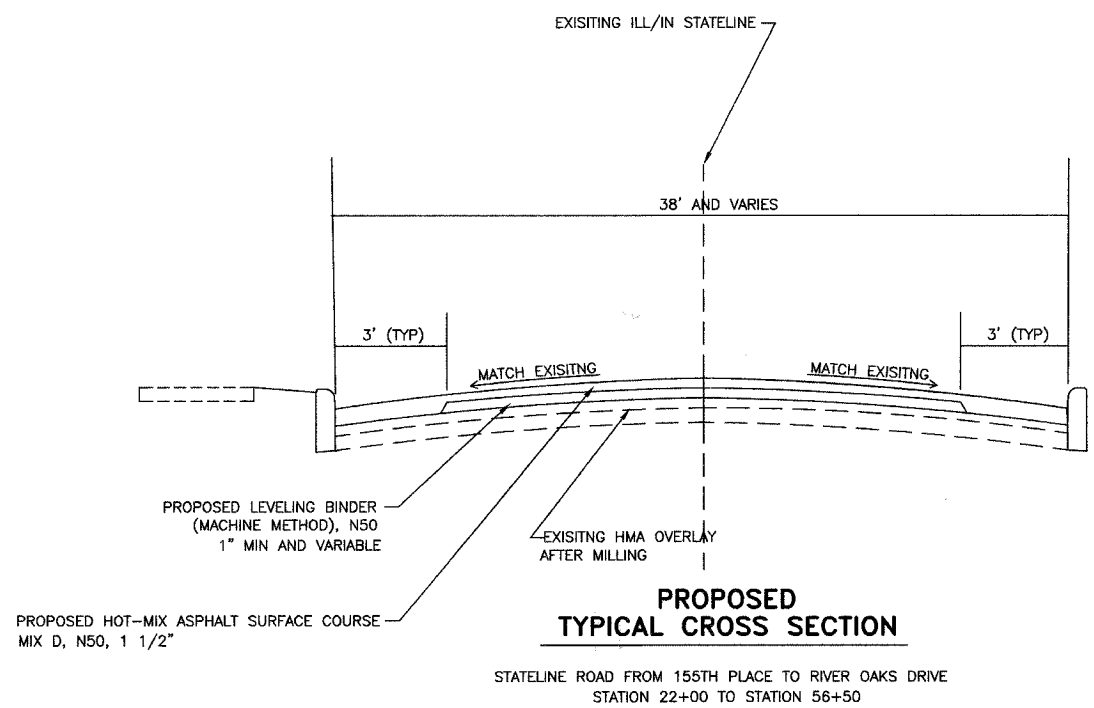
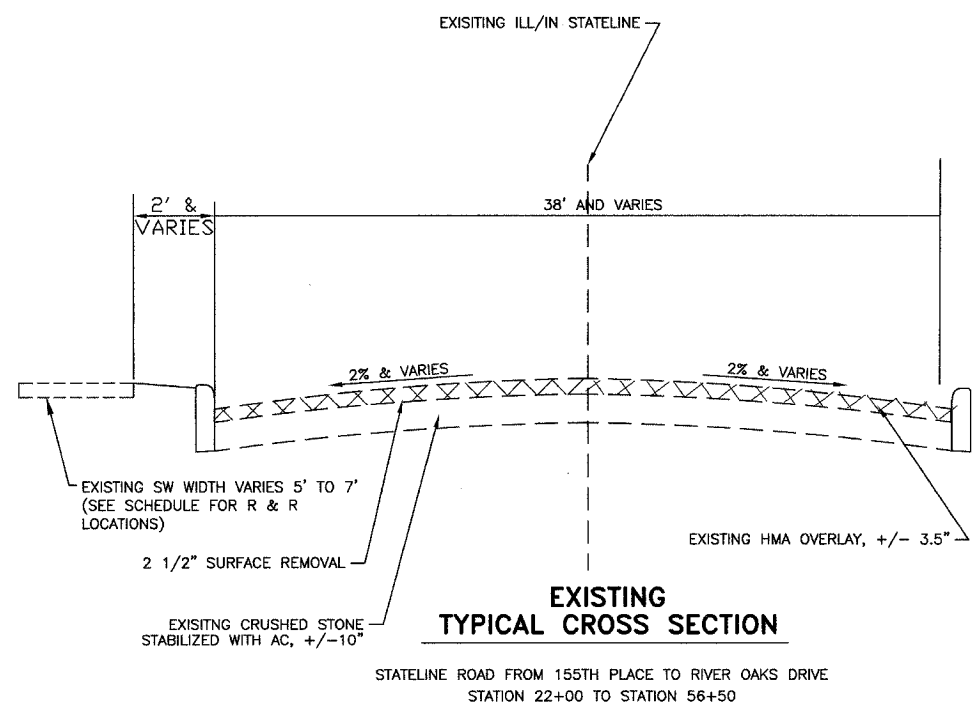

HOT-MIX ASPHALT MIXTURE REQUIREMENTS

MIXTURE TYPE	AC TYPE	AIR VOIDS	RAP %
LEVELING BINDER (MACHINE METHOD), N50 (IL 9.5 mm)	*PG 64-22/58-22	4% @ 50 Gyr.	25
HOT-MIX ASPHALT SURFACE COURSE, MIX "C", N50 (IL 9.5 mm) **	PG 64-22	4% @ 50 Gyr.	15
HOT-MIX ASPHALT BASE COURSE (HMA Binder IL-19 mm) **	*PG 64-22/58-22	2% @ 50 Gyr.	25
CLASS "D" PATCHING HMA Binder IL-19 mm)	*PG 64-22/58-22	4% @ 70 Gyr.	15/25

THE UNIT WEIGHT USED TO CALCULATE ALL HOT-MIX ASPHALT SURFACE MIXTURE QUANTITIES IS 112 lbs/sq yd/in.
 * WHEN RAP EXCEEDS 20%, THE NEW ASPHALT BINDER IN THE MIX SHALL BE PG 58-22
 ** HMA BASE COURSE AND HMA SURFACE COURSE REQUIREMENTS FOR HOT-MIX ASPHALT DRIVEWAY PAVEMENT AND HOT-MIX ASPHALT ALLEY REMOVAL AND REPLACEMENT.

NOTE:
 THE THICKNESS OF THE SURFACE IN THE 3' AREA WILL VARY IN THICKNESS FROM 1 1/2" TO 2 1/4" AT THE EDGE OF PAVEMENT.

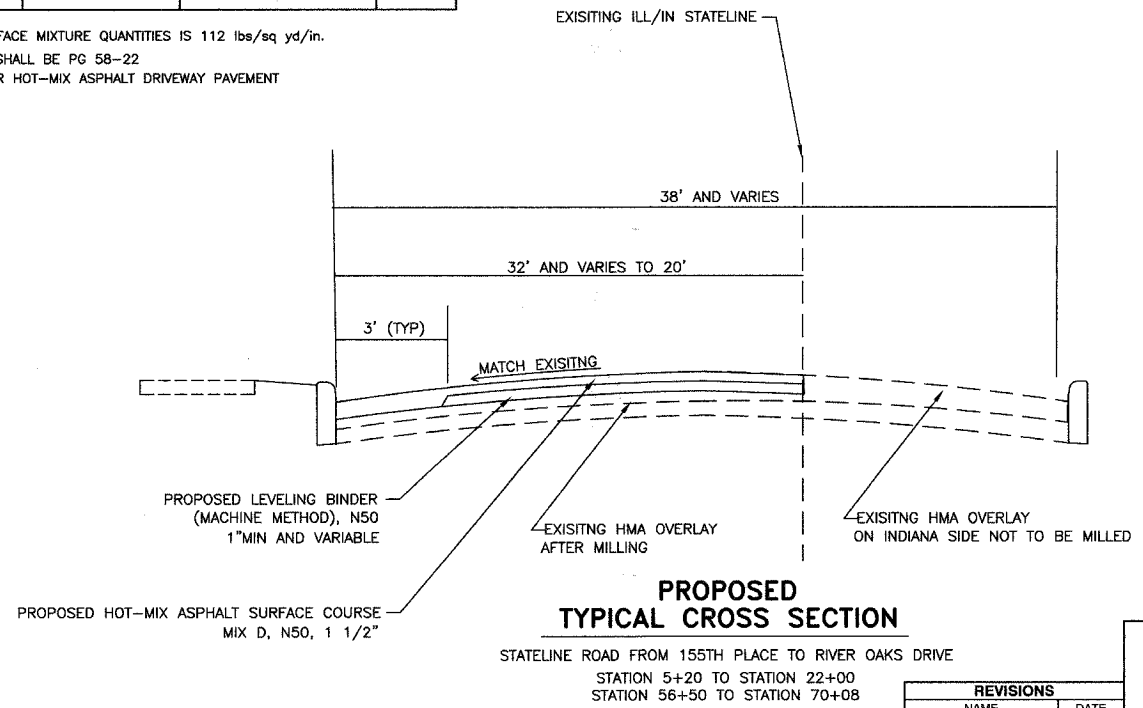
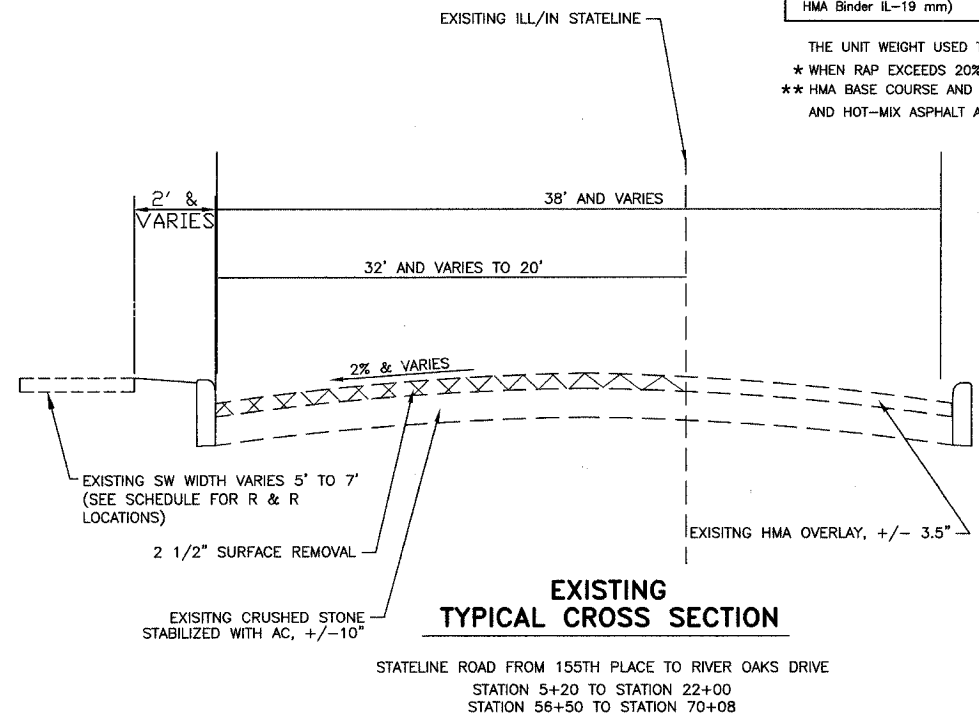

REVISIONS	
NAME	DATE

ILLINOIS DEPARTMENT OF TRANSPORTATION

STATELINE ROAD ROADWAY RESURFACING TYPICAL SECTIONS

SCALE: VERT. NA
 HORIZ. NA
 DATE: 04/23/08

DRAWN BY: PS
 CHECKED BY: RW

ROBINSON ENGINEERING, LTD.
 1700 SOUTH PARK AVENUE, SOUTH HOLLAND, ILLINOIS 60473
 (708) 331-8700 FAX (708) 331-3826
 ILLINOIS DESIGN FIRM REGISTRATION NO. 146001208 08003_00-TYPK-01

F. A. U. NO.	SECTION	COUNTY	TOTAL SHEETS	SHEET NO.
2947	08-00148-00-RS	COOK	011	005
STA.		TO STA.		
FED. ROAD DIST. NO.	LINE	FED. RD PROJECT		

CONTRACT #63044

LOCATION OF SIDEWALK OR DRIVEWAY REMOVAL AND REPLACEMENT						
Stataline Road from Michigan City Road to 155th St						
Approx. Location	West	East	Driveway R & R Area (Sq Yds)	Sidewalk R & R Area (Sq Ft)	Delectable Warning (Sq Ft)	Reason
Bit. Drive at Sta. 25+10 Stataline.	X		8			Curb Removal and Replacement
Bit. Drive at Sta. 25+45 Stataline.	X		5			Curb Removal and Replacement
Bit. Drive at Sta. 25+65 Stataline.	X		7.6			Curb Removal and Replacement
STA. 26+70 TO STA. 27+35	X			325		Curb Removal and Replacement
STA. 28+27	X			40		Curb Removal and Replacement
STA. 28+48	X			8		Curb Removal and Replacement
STA. 29+18 TO STA. 29+52	X			34		Curb Removal and Replacement
SW corner of Bit. alley at Sta. 30+08	X			36	8	Handicap Ramp Installation
NW corner of Bit. alley at sta. 30+08	X			36	8	Handicap Ramp Installation
STA. 30+62	X			39		Curb Removal and Replacement
Conc. Drive at Sta. 31+00 Stataline.	X		12			Curb & Gutter Removal and Replacement
Bit. Drive at Sta. 31+12 Stataline.	X		7.3			Curb & Gutter Removal and Replacement
STA. 31+85	X			32.5		Curb Removal and Replacement
SW corner of stone alley at sta. 33+62	X			24	8	Handicap Ramp Installation
NW corner of stone alley at Sta. 33+82 TO Sta. 35+50	X			858	16	Handicap Ramp Installation & Curb Removal and Replacement
Conc. Drive at Sta. 34+22 Stataline.	X		8			Curb & Gutter Removal and Replacement
NW corner of Highland (Sta. 35+50)	X			36	8	Handicap Ramp Installation & Curb Removal and Replacement
Sta. 36+41 TO Sta. 36+87.5	X			270	8	Handicap Ramp Installation & Curb Removal and Replacement
Sta. 37+15 TO Sta. 37+75	X			360		Curb Removal and Replacement
SW corner of Elizabeth	X			162	8	Handicap Ramp Installation & Curb Removal and Replacement
NW corner of Elizabeth	X			35	8	Handicap Ramp Installation
SW corner of alley (Sta. 40+08)	X			36	8	Handicap Ramp Installation
NW corner of alley (Sta. 40+08)	X			24	8	Handicap Ramp Installation
STA. 40+50	X			60		Curb Removal and Replacement
Conc. Drive at Sta. 40+50 Stataline.	X		6.7			Curb & Gutter Removal and Replacement
STA. 42+08 TO STA. 43+01	X			558		Curb Removal and Replacement
SW corner of alley (Sta. 43+35)	X			30	8	Handicap Ramp Installation & Curb Removal and Replacement
Alley @ Sta. 43+35 to Ruth (Sta. 45+00)	X			936	16	Handicap Ramp Installation & Curb Removal and Replacement
NW corner of Ruth	X			36	8	Handicap Ramp Installation
SW corner of alley (Sta. 46+40)	X			36	8	Handicap Ramp Installation & Curb Removal and Replacement
Conc. Drive at Sta. 46+85 Stataline.	X		14.7			Curb & Gutter Removal and Replacement
NW corner of alley (Sta. 46+55) TO Sta. 47+38	X			300	8	Handicap Ramp Installation & Curb Removal and Replacement
STA. 47+95 TO STA. 48+00	X			30		Curb Removal and Replacement
SW corner of Mason	X			9	8	Handicap Ramp Installation
NW corner of Mason to alley at Sta. 49+70	X			750	16	Handicap Ramp Installation & Curb Removal and Replacement
Conc. Drive at Sta. 49+50 Stataline.	X		5.3			Curb & Gutter Removal and Replacement
Alley @ Sta. 49+70 to Warren	X			792	16	Handicap Ramp Installation & Curb Removal and Replacement
NW corner of Warren to Sta. 52+80	X			798	8	Handicap Ramp Installation & Curb Removal and Replacement
SW corner of driveway at Sta. 52+95	X			36	8	Handicap Ramp Installation
NW corner of Driveway at Sta. 52+95	X			36	8	Handicap Ramp Installation
SW corner of Webb	X			16	8	Handicap Ramp Installation
NW corner of Webb	X			20	8	Handicap Ramp Installation
SW corner of driveway at Sta. 56+15	X			30	8	Handicap Ramp Installation
NW corner of driveway at Sta. 56+15	X			25	8	Handicap Ramp Installation
SW corner of 157th	X			16	8	Handicap Ramp Installation
NW corner of 157th	X			16	8	Handicap Ramp Installation
STA. 58+00 TO STA. 58+15	X			75		Curb & Gutter Removal and Replacement
STA. 58+95 TO STA. 59+88	X			415		Curb & Gutter Removal and Replacement
Bit. Drive at Sta. 59+33 Stataline.	X		5.6			Curb & Gutter Removal and Replacement
SW corner of 156th PL	X			50	8	Handicap Ramp Installation
NW corner of 156th PL	X			16	8	Handicap Ramp Installation
Sta. 61+14 to Sta. 61+24	X			48		Curb & Gutter Removal and Replacement
NW corner of 156th ST	X			25	8	Handicap Ramp Installation
Sta. 64+62 to Sta. 67+00	X			644		Curb & Gutter Removal and Replacement
Sta. 67+57 to Sta. 69+90	X			2006		Curb & Gutter Removal and Replacement
Total			80.2	10164.5	272	

LOCATION OF CURB REMOVAL AND REPLACEMENT					
Stataline Road from Michigan City Road to 155th Street					
Approx. Location	West	East	Curb R & R Length (Ft)	Curb & Gutter R & R Length (Ft)	
STA. 24+16 TO STA. 26+80	X		164		
STA. 26+00 TO STA. 27+35	X		135		
STA. 28+05 TO STA. 28+35	X		30		
STA. 29+18 TO STA. 30+00	X		94		
STA. 30+20 TO STA. 31+57	X		150		
STA. 32+85	X		8		
STA. 33+88 TO STA. 35+20	X		144		
STA. 35+50	X		36		
STA. 38+41 TO STA. 38+78	X		51		
STA. 37+15 TO STA. 37+75	X		60		
SW CORNER OF ELIZABETH	X		32		
NW CORNER OF ELIZABETH	X		8		
SW CORNER OF ALLEY (STA. 40+08)	X		10		
NW CORNER OF ALLEY (STA. 40+08)	X		10		
STA. 40+45 TO STA. 40+55	X		10		
STA. 42+08 TO STA. 43+01	X		93		
SW CORNER OF ALLEY (STA. 43+35)	X		9		
ALLEY @ STA. 43+35 TO RUTH (STA. 45+00)	X		146		
NW CORNER OF RUTH	X		10		
SW CORNER OF ALLEY (STA. 46+40)	X		8		
NW CORNER OF ALLEY (STA. 46+55) TO STA. 47+38	X		78		
STA. 47+95 TO STA. 48+00	X		5		
SW CORNER OF MASON	X		7		
NW CORNER OF MASON TO ALLEY AT STA. 49+70	X		146		
ALLEY @ STA. 49+70 TO WARREN	X		148		
NW CORNER OF WARREN TO STA. 52+80	X		135		
SW CORNER OF DRIVEWAY AT STA. 52+95	X		10		
SW CORNER OF WEBB	X		10		
NW CORNER OF WEBB	X		10		
STA. 58+00 TO STA. 58+15	X		15		
STA. 59+95 TO STA. 59+88	X		83		
SW CORNER OF 156TH PL	X		10		
NW CORNER OF 156TH PL	X		10		
STA. 61+10	X		10		
NW CORNER OF 156TH ST	X		10		
STA. 64+62 TO STA. 67+00	X		238		
STA. 67+57 TO STA. 69+90	X		236		
Total			1737	642	

REMOVAL WORK AT EXISTING INTERSECTIONS					
Stataline Road from Michigan City Road to 155th Street					
Location	West	East	Work at Intersection		
Stataline Road			North of River Oaks Drive Butt Joint Required		
Michigan City Road	x		Grind along existing EOP line (No Butt Joint)		
Wildwood		x	Grind along existing EOP line (No Butt Joint)		
Detroit		x	Grind along existing EOP line (No Butt Joint)		
Highland	x		Butt Joint Required		
Highland		x	Grind along existing EOP line (No Butt Joint)		
Elizabeth	x		Butt Joint Required		
Elizabeth		x	Grind along existing EOP line (No Butt Joint)		
Waltham		x	Grind along existing EOP line (No Butt Joint)		
Ruth	x		Butt Joint Required		
Ruth		x	Grind along existing EOP line (No Butt Joint)		
Mason	x		Butt Joint Required		
Mason		x	Grind along existing EOP line (No Butt Joint)		
Warren	x		Butt Joint Required		
Warren		x	Grind along existing EOP line (No Butt Joint)		
Webb	x		Butt Joint Required		
Webb		x	Grind along existing EOP line (No Butt Joint)		
157th Street	x		Butt Joint Required		
156th Place		x	Butt Joint Required		
156th Street	x		Butt Joint Required		

LOCATION OF HOT-MIX ASPHALT PARKWAY REMOVAL AND SIDEWALK REPLACEMENT					
Stataline Road from Michigan City Road to 155th St					
Approx. Location	West	East	Bit Parkway Rem Area (Sq Yds)	Sidewalk Replacement, 5" Area (Sq Ft)	Reason
Sta. 64+95 to Sta. 66+70	X		25	225	Curb Removal and Replacement
Sta. 66+00 to Sta. 66+40	X		13.3	120	Curb Removal and Replacement
Sta. 67+57 to Sta. 68+72	X		38.3	345	Curb Removal and Replacement
Sta. 68+85 to Sta. 69+35	X		16.7	150	Curb Removal and Replacement
Total			93.3	640	

LOCATION OF DRAINAGE STRUCTURE ADJUSTMENTS						
Stataline Road from Michigan City Road to 155th Street						
Approx. Location	Catch Basin Remove & Replace	Adjustment Open Lid	Adjustment Closed Lid	Reconstruction Open Lid	Domestic Water Service Box Adjusted	Water Valve Adjustment
STA. 25+75, LT						
STA. 27+45, LT			1			1
STA. 27+45, LT						1
STA. 30+23, LT			1			
STA. 40+50, LT			1			
STA. 44+80, LT			1			
STA. 45+10, LT			1			
STA. 46+70, LT			1			
STA. 49+80, LT	1					
STA. 49+85, LT			1			
STA. 50+05, LT						1
STA. 51+35, RT				1		
STA. 58+05, LT	1					
STA. 60+88, LT						1
STA. 61+05, LT					1	
STA. 61+14, LT			1			
STA. 61+14, LT			1			
STA. 61+35, LT			1			
STA. 63+83, LT						1
STA. 63+92, LT			1			
STA. 64+07, LT					1	
STA. 64+07, LT			1			
STA. 64+25, LT			1			
STA. 64+26, LT	1					
STA. 67+09, LT			1			
STA. 67+17, LT						1
STA. 67+48, LT			1			
STA. 67+59, LT	1					
STA. 67+59, LT			1			
STA. 68+40, LT					1	
Total	4	8	9	0	4	5

STATELINE ROAD PAVEMENT MARKING SCHEDULE				
FROM MICHIGAN CITY ROAD TO 155TH STREET AVENUE				
LOCATION	24" STOP BAR (WHITE)	4" DOUBLE YELLOW	4" SKIP DASH (YELLOW)	6" CROSSWALK (WHITE)
Station 5+20 LT				
Station 5+20 to Station 6+00, 10 FT LT				
Station 6+00 to Station 22+00, CL		80	1720	
Station 22+00 to Station 33+60, CL			290	
Station 33+60 to Station 35+07, CL		294		
Station 35+07 LT		17		
Station 35+60 LT		18		
Station 35+60 to Station 36+25, CL			130	
Station 36+25 to Station 55+75, CL			488	
Station 55+75 to Station 57+44, CL			336	
Station 57+44 RT		17		
Station 57+83 LT		19		
Station 57+83 to Station 59+50, CL			734	
Station 59+50 to Station 70+08, CL			265	
Station 64+28.5				140
Total	71	1576	690.8	140

ILLINOIS DEPARTMENT OF TRANSPORTATION

STATELINE ROAD ROADWAY RESURFACING SCHEDULES

REVISIONS	
NAME	DATE

SCALE: VERT. NA
HORIZ. NA
DATE 04/23/08

DRAWN BY RG
CHECKED BY RW

SECTION 20, TOWNSHIP 36, RANGE 15
SECTION 17, TOWNSHIP 36, RANGE 15

F. A. U. NO.	SECTION	COUNTY	TOTAL SHEETS	SHEET NO.
2947	08-00148-00-RS	COOK	011	006
STA. 4+00	TO STA. 28+00			
FED. ROAD DIST. NO.	CLASS	FED. AID PROJECT		

CONTRACT #63044

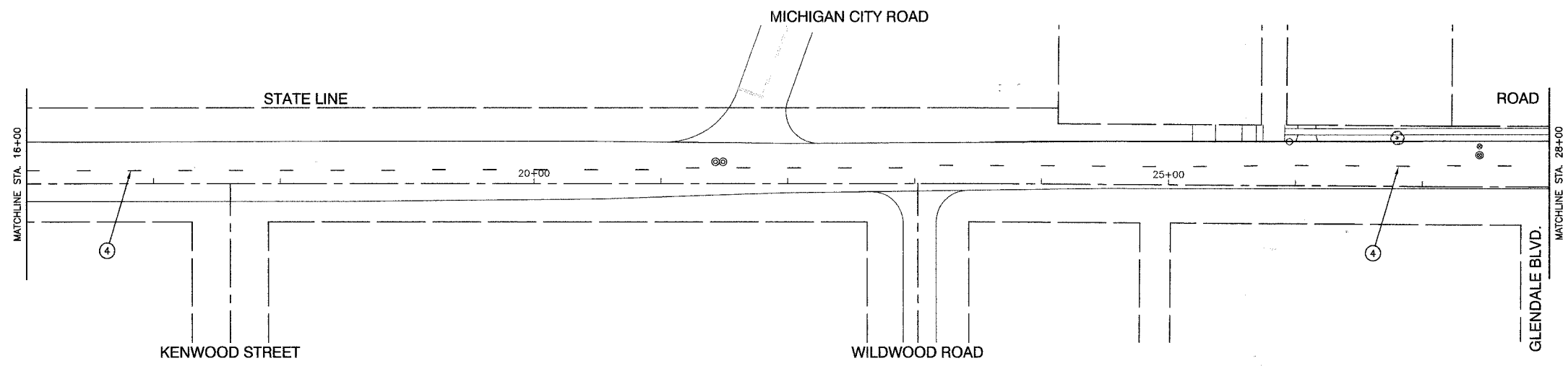
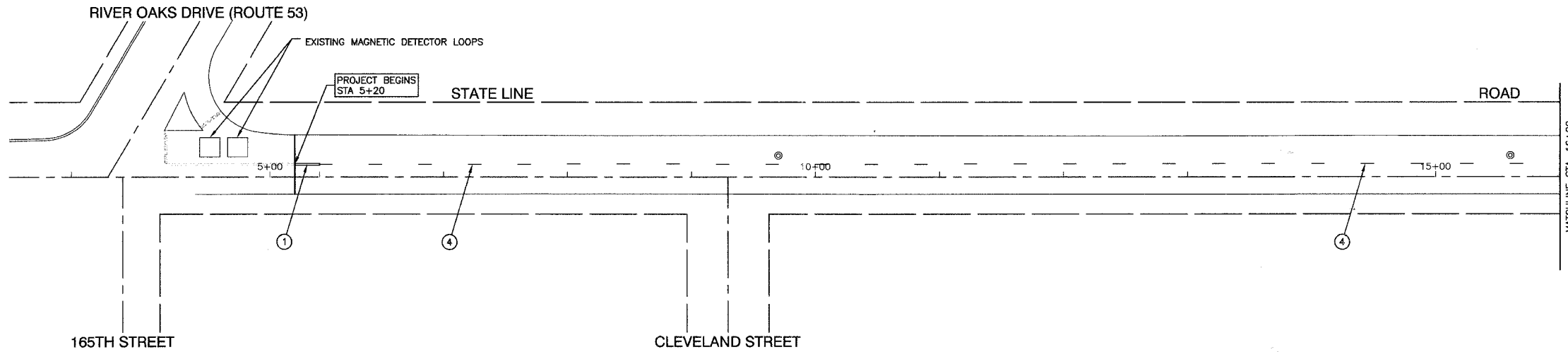
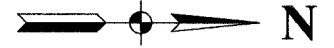

NOTE:
ALL LEGEND ITEMS ARE PAINTED
PAVEMENT MARKING OF THE WIDTH AND TYPE SPECIFIED

PAVEMENT MARKING LEGEND

- ① PAINT PAVEMENT MARKING—LINE 4" (YELLOW)
- ② PAINT PAVEMENT MARKING—LINE 24" (WHITE)
- ③ PAINT PAVEMENT—LINE 6" (WHITE)
- ④ 4" YELLOW SKIP - DASH LINE (10' LINE - 30' SPACE)

REVISIONS	
NAME	DATE

ILLINOIS DEPARTMENT OF TRANSPORTATION

**STATELINE ROAD
ROADWAY RESURFACING
PAVEMENT MARKING PLAN**

SCALE: VERT. NA
HORIZ. 1"=50'
DATE 04/23/08
DRAWN BY PS
CHECKED BY RW

F. A. S. NO.	SECTION	COUNTY	TOTAL SHEETS	SHEET NO.
2947	08-00148-00-RS	COOK	011	007
STA. 28+00		TO STA. 52+00		
FED. ROAD DIST. NO.	LENGTH	FED. RD PROJECT		

CONTRACT #63044

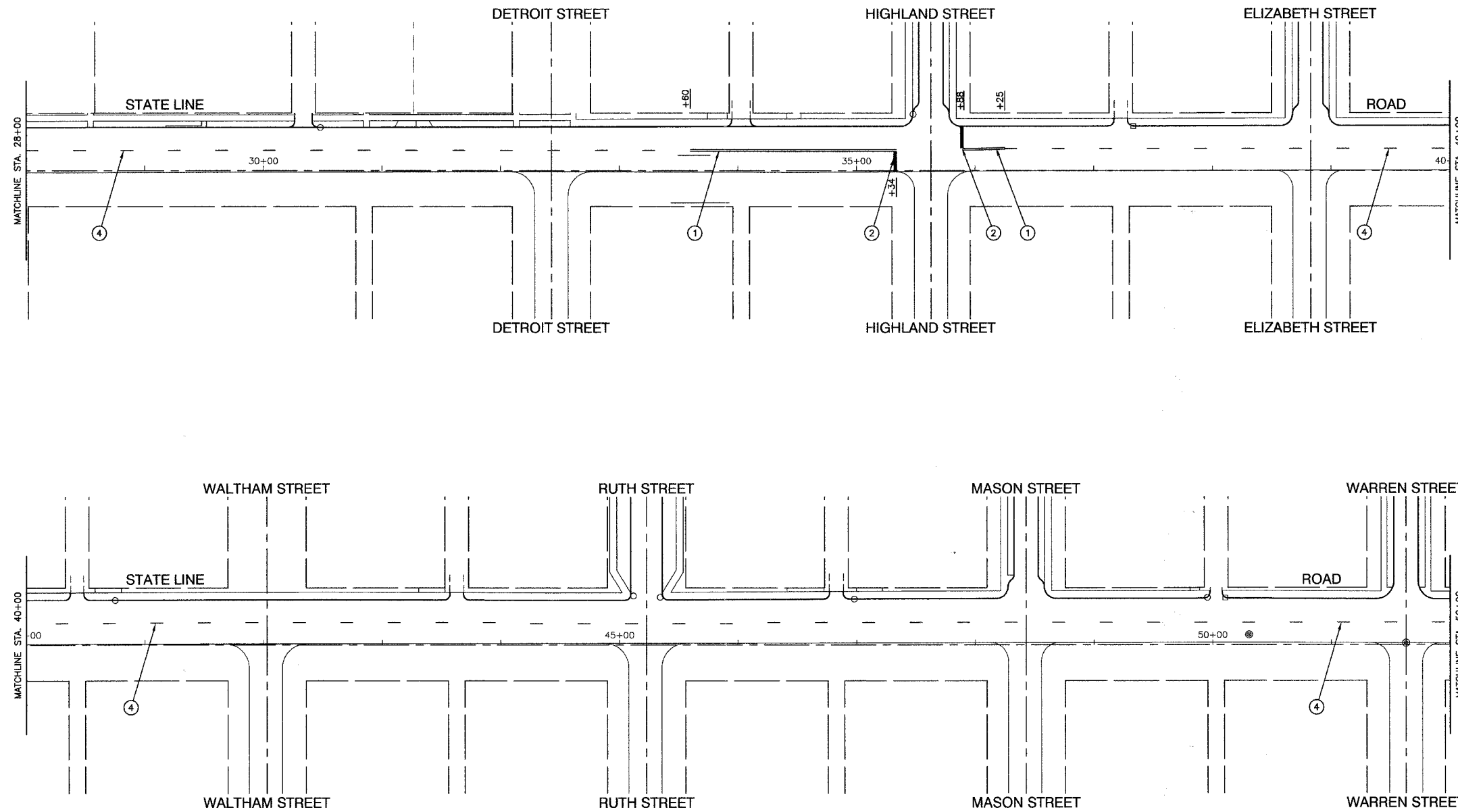

NOTE:
ALL LEGEND ITEMS ARE PAINTED
PAVEMENT MARKING OF THE WIDTH AND TYPE SPECIFIED

PAVEMENT MARKING LEGEND

- ① PAINT PAVEMENT MARKING—LINE 4" (YELLOW)
- ② PAINT PAVEMENT MARKING—LINE 24" (WHITE)
- ③ PAINT PAVEMENT—LINE 6" (WHITE)
- ④ 4" YELLOW SKIP - DASH LINE (10' LINE - 30' SPACE)

REVISIONS	
NAME	DATE

ILLINOIS DEPARTMENT OF TRANSPORTATION

**STATELINE ROAD
ROADWAY RESURFACING
PAVEMENT MARKING PLAN**

SCALE: VERT. NA
HORIZ. 1"=50'
DATE 04/23/08

DRAWN BY PS
CHECKED BY RW

F. A. U. NO.	SECTION	COUNTY	TOTAL SHEETS	SHEET NO.
2947	08-00148-00-RS	COOK	011	008
STA. 52+00	TO STA. 70+00			
FED. ROAD DIST. NO.	KLINGS	FED. AID PROJECT		

CONTRACT #63044

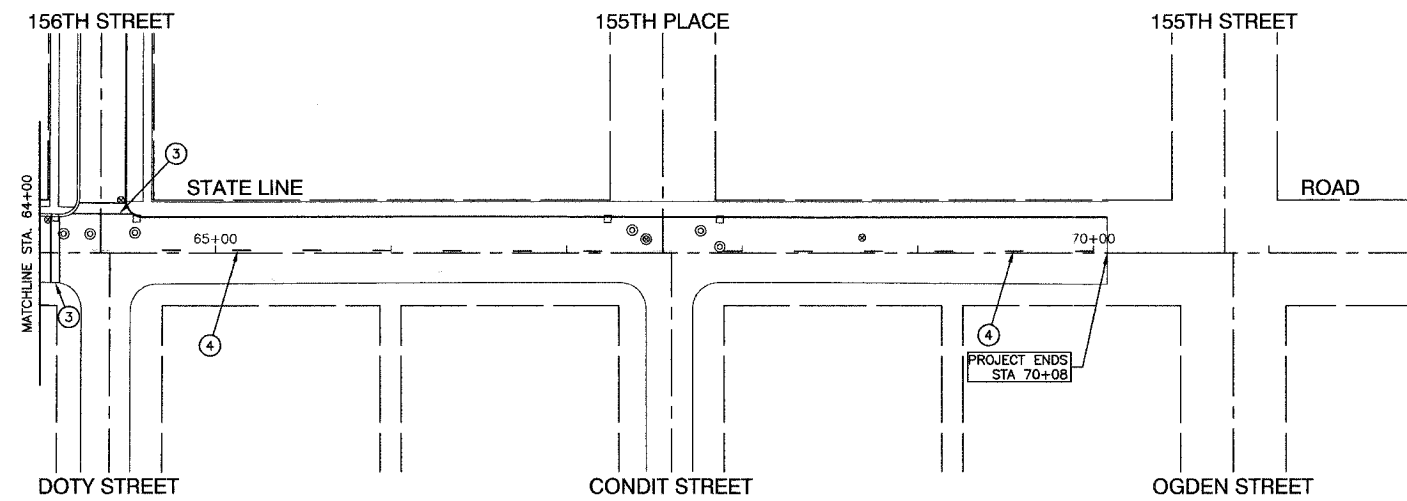
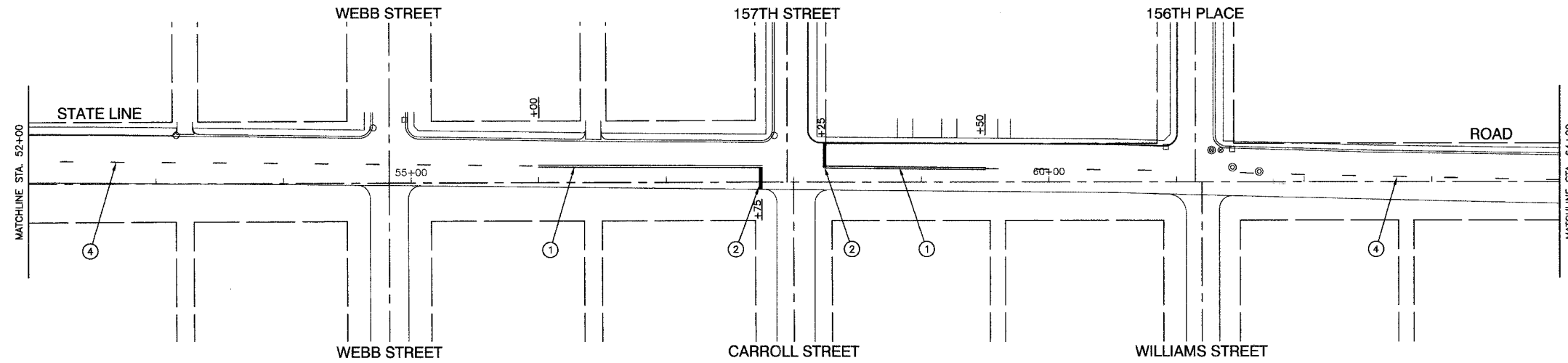

NOTE:
ALL LEGEND ITEMS ARE PAINTED
PAVEMENT MARKING OF THE WIDTH AND TYPE SPECIFIED

PAVEMENT MARKING LEGEND

- ① PAINT PAVEMENT MARKING—LINE 4" (YELLOW)
- ② PAINT PAVEMENT MARKING—LINE 24" (WHITE)
- ③ PAINT PAVEMENT—LINE 6" (WHITE)
- ④ 4" YELLOW SKIP - DASH LINE (10' LINE - 30' SPACE)

REVISIONS	
NAME	DATE

ILLINOIS DEPARTMENT OF TRANSPORTATION

**STATELINE ROAD
ROADWAY RESURFACING
PAVEMENT MARKING PLAN**

SCALE: VERT. NA
HORIZ. 1"=50'
DATE 04/23/08

DRAWN BY PS
CHECKED BY RW

F. A. S. NO.	SECTION	COUNTY	TOTAL SHEETS	SHEET NO.
2947	08-00148-00-RS	COOK	011	009
STA.		TO STA.		
FED. ROAD DIST. NO.	ALMOST	FED. AID PROJECT		

CONTRACT #63044

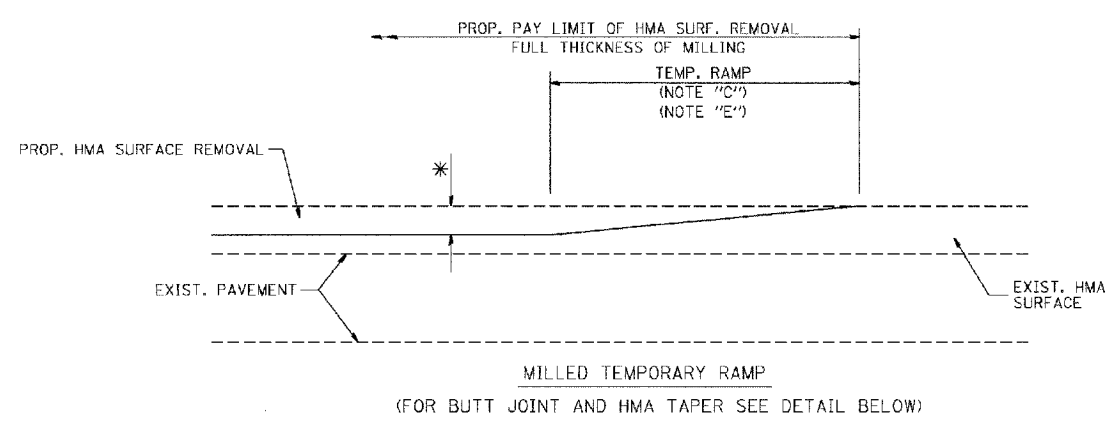

MILLED TEMPORARY RAMP
(FOR BUTT JOINT AND HMA TAPER SEE DETAIL BELOW)

OPTION 1

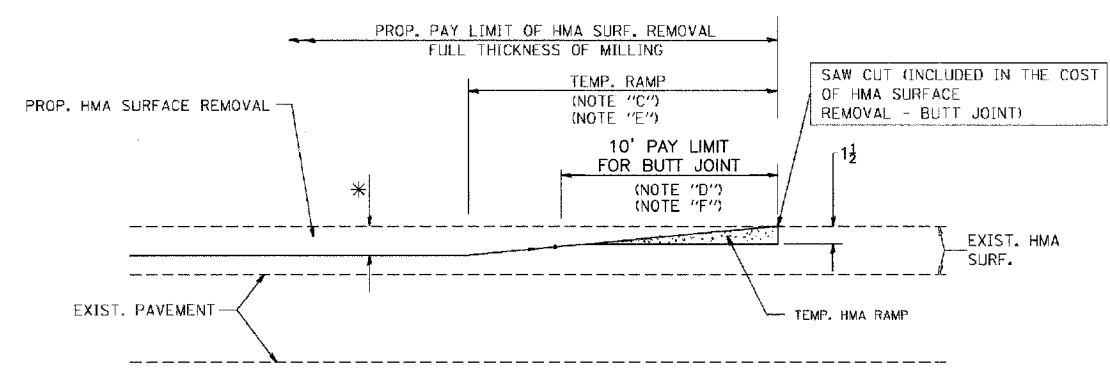

HMA CONSTRUCTED TEMPORARY RAMP
(FOR BUTT JOINT AND HMA TAPER SEE DETAIL BELOW)

OPTION 2
TYPICAL TEMPORARY RAMP

NOTES

- A: MAINLINE ROADWAYS AND MAJOR SIDE ROADS
 - B: MINOR SIDE ROADS
 - C: THE TEMP RAMP SHALL BE CONSTRUCTED IMMEDIATELY UPON REMOVAL OF THE EXISTING HMA SURFACE.
 - D: THE BUTT JOINT SHALL BE CONSTRUCTED IMMEDIATELY PRIOR TO PLACING THE PROPOSED HMA COURSES.
 - E: TAPER THE TEMP RAMP AT A RATE OF 3'-0" (900 mm) PER 1 INCH (25 mm) OF MILLING THICKNESS
 - F: INSTALLATION AND REMOVAL OF THE 10' TEMP RAMP IS INCLUDED IN THE COST OF HMA SURFACE REMOVAL - BUTT JOINT
- * SEE TYPICAL SECTIONS FOR MILLING THICKNESS
- *** 20'-0" PER 1 RESURFACING (NOTE "A")
10'-0" PER 1 RESURFACING (NOTE "B")

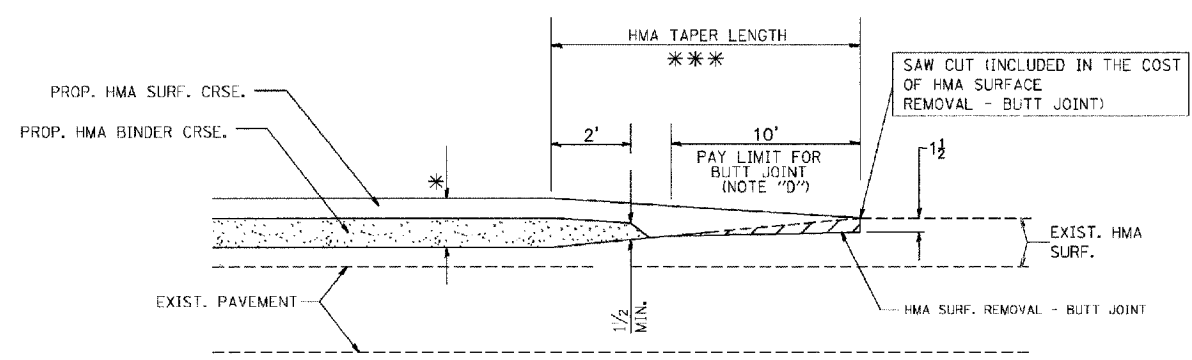

BUTT JOINT AND HMA TAPER
TYPICAL BUTT JOINT AND HMA TAPER
FOR MILLING AND RESURFACING

REVISIONS	
NAME	DATE

ILLINOIS DEPARTMENT OF TRANSPORTATION

STATELINE ROAD
ROADWAY RESURFACING
CONSTRUCTION DETAILS

SCALE: VERT. NA
HORIZ. NA
DATE 04/23/08

DRAWN BY RG
CHECKED BY RW

F. A. U. NO.	SECTION	COUNTY	TOTAL SHEETS	SHEET NO.
2847	08-00148-00-RS	COOK	011	010
STA.	TO STA.			
FED. ROAD DIST. NO.	BLK/ROW	FED. AID PROJECT		

CONTRACT #63044

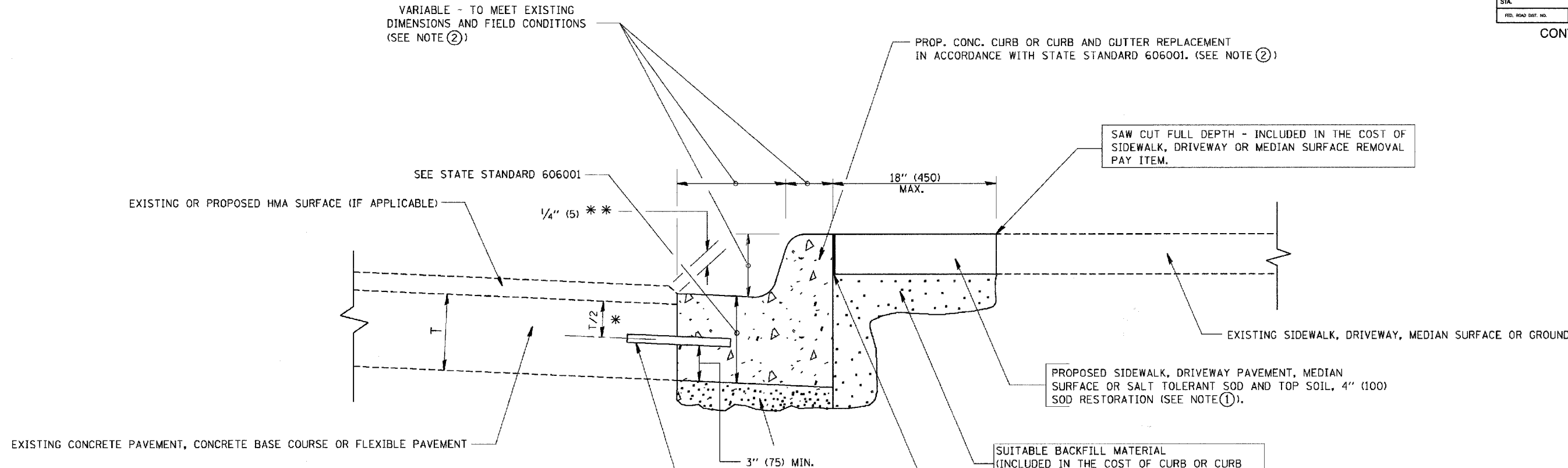

- * 3" (75) MINIMUM FROM TOP AND BOTTOM OF THE CONCRETE PAVEMENT OR BASE COURSE.
- ** IF THE FINAL SURFACE OF THE PAVEMENT IS CONCRETE, THE GUTTER IS TO BE FLUSH WITH THE PAVEMENT.

- NOTE: ① SIDEWALK, DRIVEWAY PAVEMENT OR MEDIAN SURFACE SHALL BE SIMILAR TO THE MATERIAL BEING REMOVED AND WILL BE PAID FOR SEPARATELY.
- SALT TOLERANT SOD AND TOP SOIL, 4" (100) RESTORATION WILL NOT BE PAID FOR SEPARATELY, BUT SHALL BE INCLUDED IN THE COST OF CURB OR CURB AND GUTTER REMOVAL AND REPLACEMENT.
- ② CURB OR CURB AND GUTTER REPLACEMENT SHALL MATCH THE SHAPE OF THE EXISTING CURB OR CURB AND GUTTER UNLESS OTHERWISE SPECIFIED.
- ③ FOR CURB OR CURB AND GUTTER REMOVAL AND REPLACEMENT ADJACENT TO FLEXIBLE PAVEMENT DELETE EPOXY COATED TIE BARS.
- ④ LONGITUDINAL BARS, IF ENCOUNTERED IN THE EXISTING CURB OR CURB AND GUTTER, ARE NOT TO BE REPLACED. CUTTING AND REMOVING LONGITUDINAL BARS SHALL BE INCLUDED IN THE COST OF CURB OR CURB AND GUTTER REMOVAL AND REPLACEMENT.
- ⑤ THE COST OF HMA SURFACE REMOVAL IN THE EXISTING GUTTER FLAG SHALL BE INCLUDED IN THE COST OF THE CURB AND GUTTER REMOVAL AND REPLACEMENT.
- ⑥ THE REMOVAL AND REPLACEMENT OF THE EXISTING CURB OR CURB AND GUTTER SHALL BE DONE IN ACCORDANCE WITH THE APPLICABLE PORTIONS OF SECTION 440 AND 606 OF THE STANDARD SPECIFICATIONS.
- ⑦ THE LOCATIONS OF REMOVAL AND REPLACEMENT OF EXISTING CURB OR CURB AND GUTTER SHALL BE DETERMINED BY THE RESIDENT ENGINEER AT THE TIME OF CONSTRUCTION.

BASIS OF PAYMENT:
 THIS WORK WILL BE PAID FOR AT THE CONTRACT UNIT PRICE PER FOOT (METER) FOR "CURB REMOVAL AND REPLACEMENT" OR "COMBINATION CONCRETE CURB AND GUTTER REMOVAL AND REPLACEMENT".

ALL DIMENSIONS ARE IN INCHES (MILLIMETERS) UNLESS OTHERWISE SHOWN.

CURB OR CURB AND GUTTER REMOVAL AND REPLACEMENT

REVISIONS	
NAME	DATE
A. HOUSEH	03/11/94
R. SHAH	02/24/95
R. SHAH	03/02/95
R. SHAH	08/19/95
R. SHAH	09/12/95
R. SHAH	09/19/95
R. SHAH	10/03/95
A. ABBAS	03/21/97
M. GOMEZ	01/22/01
R. BORO	01/01/07

ILLINOIS DEPARTMENT OF TRANSPORTATION

CURB OR CURB AND GUTTER REMOVAL AND REPLACEMENT

SCALE: VERT. NONE
 HORIZ. _____

DRAWN BY _____
 CHECKED BY _____

F. A. U. NO.	SECTION	COUNTY	TOTAL SHEETS	SHEET NO.
2947	08-00148-00-RS	COOK	011	011
STA.	TO STA.			
FED. ROAD DIST. NO.	LANES	FED. RD PROJECT		

CONTRACT #63044

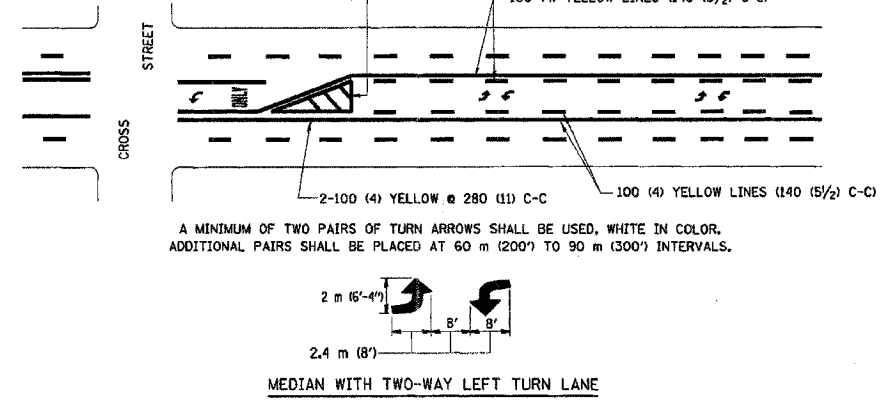
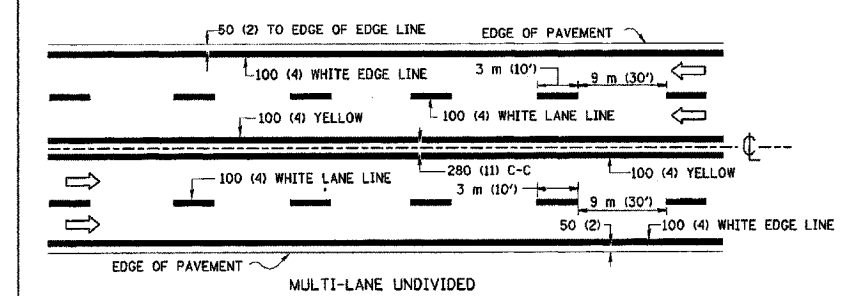
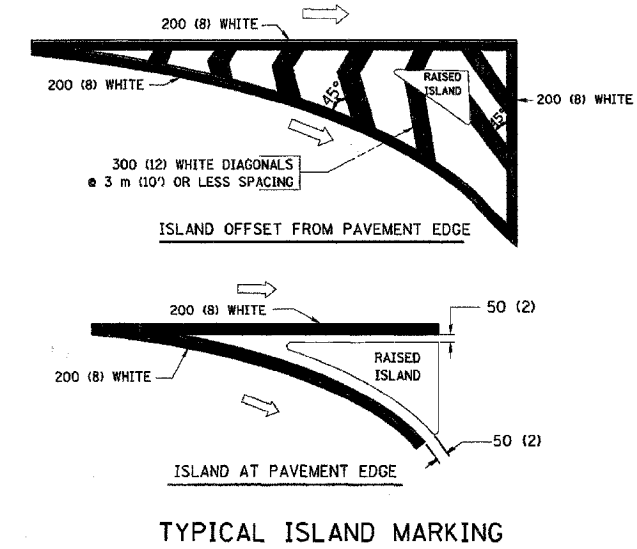
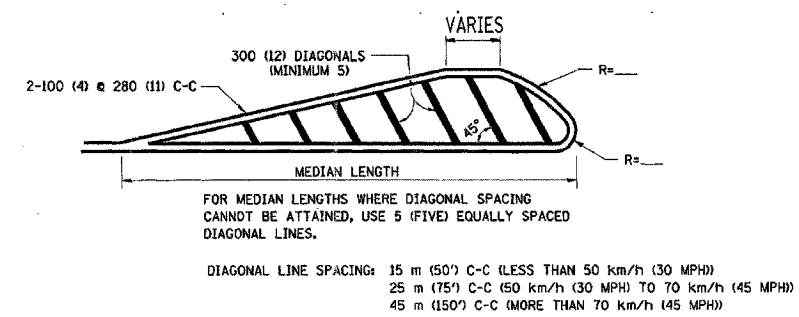
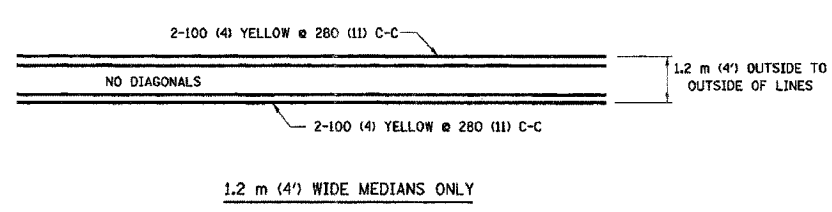
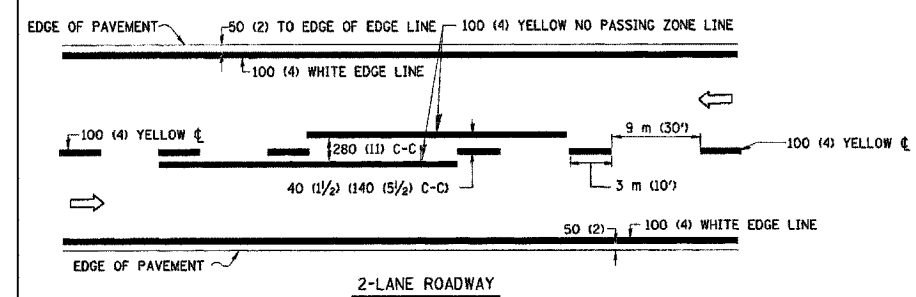

TYPE OF MARKING	WIDTH OF LINE	PATTERN	COLOR	SPACING / REMARKS
CENTERLINE ON 2 LANE PAVEMENT	100 (4)	SKIP-DASH	YELLOW	3 m (10') LINE WITH 9 m (30') SPACE
CENTERLINE ON MULTI-LANE UNDIVIDED PAVEMENT	2 @ 100 (4)	SOLID	YELLOW	280 (11) C-C
NO PASSING ZONE LINES: FOR ONE DIRECTION FOR BOTH DIRECTIONS	100 (4) 2 @ 100 (4)	SOLID SOLID	YELLOW YELLOW	140 (5 1/2) C-C FROM SKIP-DASH CENTERLINE 280 (11) C-C OMIT SKIP-DASH CENTERLINE BETWEEN
LANE LINES	100 (4) 125 (5) ON FREEWAYS	SKIP-DASH SKIP-DASH	WHITE WHITE	3 m (10') LINE WITH 9 m (30') SPACE
DOTTED LINES (EXTENSIONS OF CENTER, LANE OR TURN LANE MARKINGS)	SAME AS LINE BEING EXTENDED	SKIP-DASH	SAME AS LINE BEING EXTENDED	600 (2') LINE WITH 1.8 m (6') SPACE
EDGE LINES	100 (4)	SOLID	YELLOW-LEFT WHITE-RIGHT	OUTLINE MOUNTABLE MEDIANS IN YELLOW; EDGE LINES ARE NOT USED NEXT TO BARRIER CURB
TURN LANE MARKINGS	150 (6) LINE; FULL SIZE LETTERS & SYMBOLS (2.4 m (8'))	SOLID	WHITE	SEE TYPICAL TURN LANE MARKING DETAIL
TWO WAY LEFT TURN MARKING	2 @ 100 (4) EACH DIRECTION 2.4 m (8') LEFT ARROW	SKIP-DASH AND SOLID IN PAIRS	YELLOW WHITE	3 m (10') LINE WITH 9 m (30') SPACE FOR SKIP-DASH; 140 (5 1/2) C-C BETWEEN SOLID LINE AND SKIP-DASH LINE SEE TYPICAL TWO-WAY LEFT TURN MARKING DETAIL
CROSSWALK LINES (PEDESTRIAN) A. DIAGONALS (BIKE & EQUESTRIAN) B. LONGITUDINAL BARS (SCHOOL)	2 @ 150 (6) 300 (12) @ 45° 300 (12) @ 90°	SOLID SOLID SOLID	WHITE WHITE WHITE	NOT LESS THAN 1.8 m (6') APART 600 (2') APART SEE TYPICAL CROSSWALK MARKING DETAILS.
STOP LINES	600 (24)	SOLID	WHITE	PLACE 1.2 m (4') IN ADVANCE OF AND PARALLEL TO CROSSWALK, IF PRESENT. OTHERWISE, PLACE AT DESIRED STOPPING POINT. PARALLEL TO CROSSROAD CENTERLINE, WHERE POSSIBLE
PAINTED MEDIANS	2 @ 100 (4) WITH 300 (12) DIAGONALS @ 45° NO DIAGONALS USED FOR 1.2 m (4') WIDE MEDIANS	SOLID	YELLOW; TWO WAY TRAFFIC WHITE; ONE WAY TRAFFIC	280 (11) C-C FOR THE DOUBLE LINE SEE TYPICAL PAINTED MEDIAN MARKING.
GORE MARKING AND CHANNELIZING LINES	200 (8) WITH 300 (12) DIAGONALS @ 45°	SOLID	WHITE	DIAGONALS: 4.5 m (15') C-C (LESS THAN 50 km/h (30 MPH)) 6 m (20') C-C (50 km/h (30 MPH) TO 70 km/h (45 MPH)) 9 m (30') C-C (OVER 70 km/h (45 MPH))
RAILROAD CROSSING	600 (24) TRANSVERSE LINES; "RR" IS 1.8 m (6') LETTERS; 400 (16) LINE FOR "X"	SOLID	WHITE	SEE STATE STANDARD 780001 AREA OF: "R"=0.33m ² (3.6 SQ. FT.) EACH "X"=5.0 m ² (54.0 SQ. FT.)
SHOULDER DIAGONALS	15 m (50') C-C (LESS THAN 50 km/h (30 MPH)) 25 m (75') C-C (50 km/h (30 MPH) TO 70 km/h (45 MPH)) 45 m (150') C-C (OVER 70 km/h (45 MPH))	SOLID	WHITE - RIGHT YELLOW - LEFT	

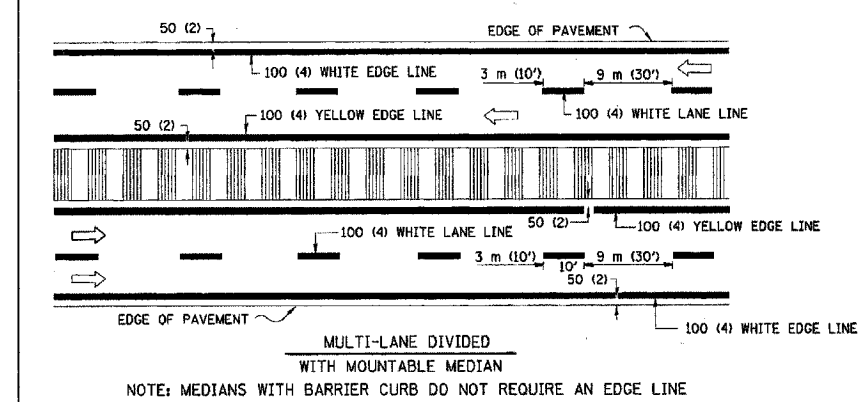

TYPICAL PAINTED MEDIAN MARKING

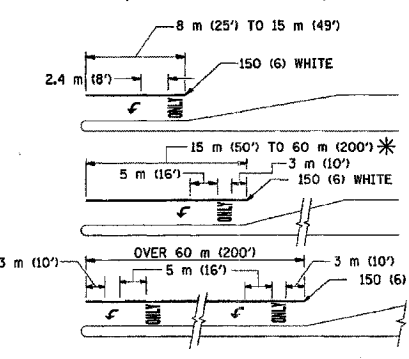

FULL SIZE LETTERS 2.4 m (8') AND ARROWS SHALL BE USED.
AREA = 1.5 m² (15.6 SQ. FT.) ONLY AREA = 1.9 m² (20.8 SQ. FT.)

* TURN LANES IN EXCESS OF 120 m (400') IN LENGTH MAY HAVE AN ADDITIONAL SET OF ARROW - "ONLY" INSTALLED MIDWAY BETWEEN THE OTHER TWO SETS OF ARROW - "ONLY".

TYPICAL LEFT (OR RIGHT) TURN LANE MARKING

TYPICAL LANE AND EDGE LINE MARKING

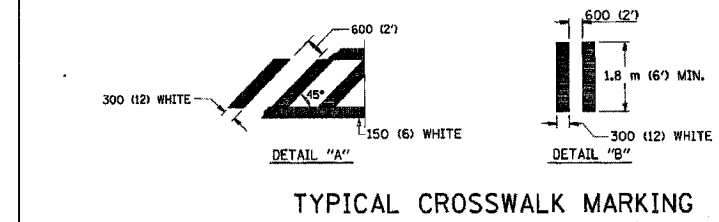
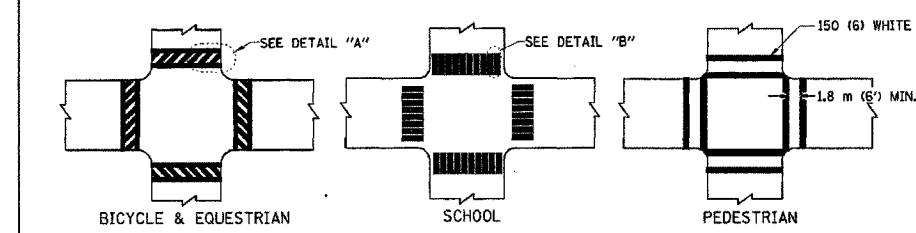

FOR FURTHER DETAILS ON PAVEMENT MARKING REFER TO STANDARD SPECIFICATIONS FOR ROAD AND BRIDGE CONSTRUCTION AND STATE STANDARD 780001.

All dimensions are in millimeters (inches) unless otherwise shown.

ILLINOIS DEPARTMENT OF TRANSPORTATION
DISTRICT ONE
TYPICAL PAVEMENT MARKINGS

REVISIONS	
NAME	DATE
EVERS	03-19-90
T. RAMMACHER	10-27-94
ALEX HOUSEH	10-09-96
ALEX HOUSEH	10-17-96
T. RAMMACHER	01-06-00

SCALE: NONE
DATE: 03/26/2003
DRAWN BY: CADD
CHECKED BY: TC-13