

F.A.U. RTE.	SECTION	COUNTY	TOTAL SHEETS	SHEET NO.
2689	06-00087-00-PK	COOK	18	5
STA.		TO STA.		
ILLINOIS FED. AID PROJECT				
CONTRACT NO. 83057				

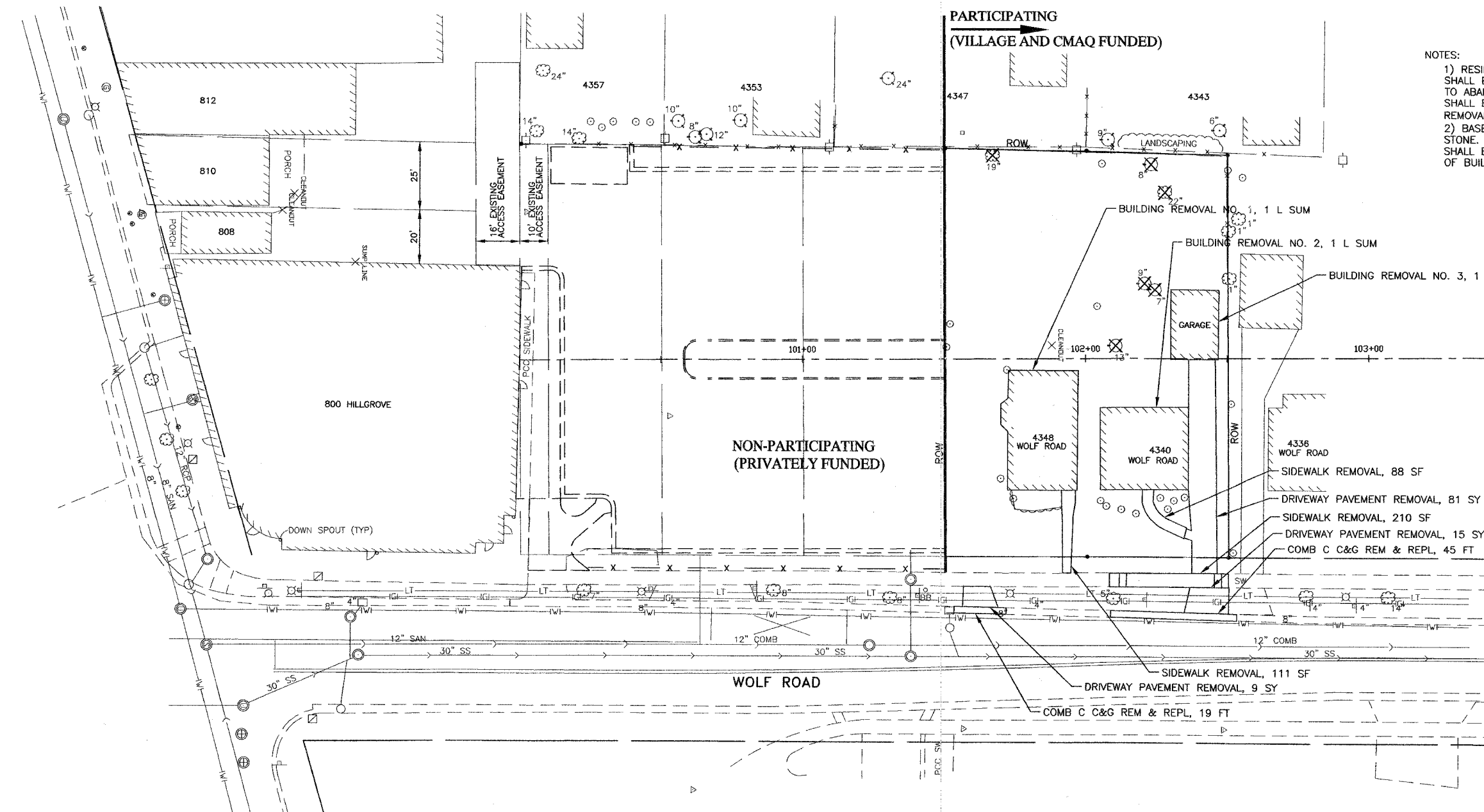

- NOTES:
- 1) RESIDENTIAL SANITARY AND WATER SERVICES SHALL BE CUT AND CAPPED AT R.O.W. THE WORK TO ABANDON SANITARY AND WATER SERVICES SHALL BE INCLUDED IN THE COST OF BUILDING REMOVAL (L SUM).
 - 2) BASEMENTS SHALL BE BACKFILLED WITH CA-7 STONE. BACKFILLING OF BUILDING BASEMENTS SHALL BE CONSIDERED AS INCLUDED IN THE COST OF BUILDING REMOVAL.

JJB
JAMES J. BENES & ASSOCIATES, INC.
 950 Warrenville Road, Suite 101, Lisle, Illinois 60532
 Tel. (630) 719-7570 · Fax (630) 719-7589

REVISIONS	
NAME	DATE

ILLINOIS DEPARTMENT OF TRANSPORTATION
 F.A.U. ROUTE 2689
 WOLF ROAD COMMUTER PARKING FACILITY EXPANSION

REMOVAL PLAN

SCALE: 1"=20'
 DATE: _____

DRAWN BY: BCD
 CHECKED BY: JDS