

MATCH LINE STA. 201+00

MATCH LINE STA. 207+00

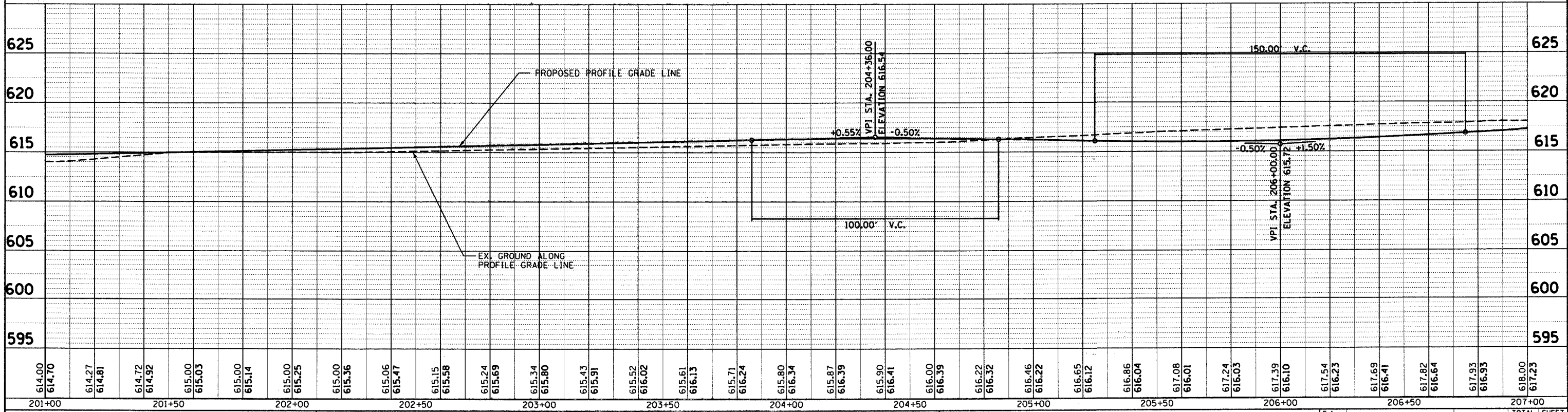
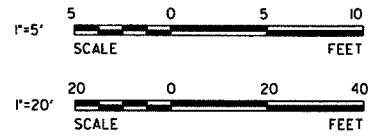
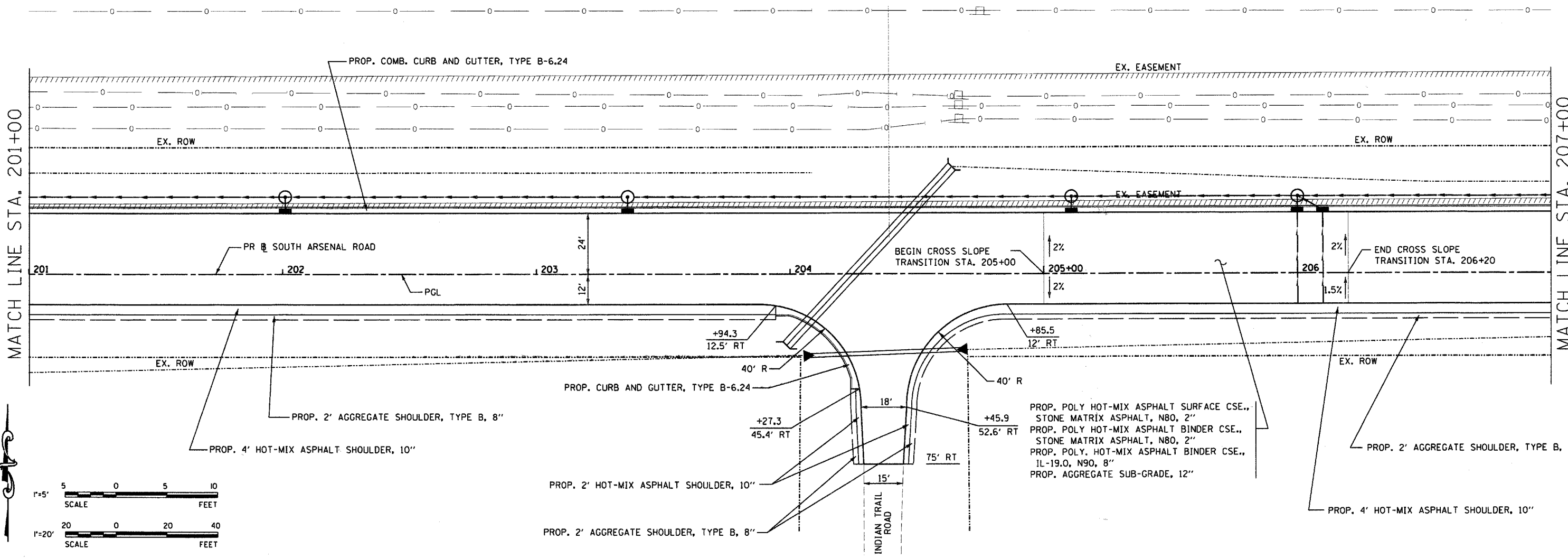

614.00	614.70	614.27	614.81	614.72	614.92	615.00	615.03	615.00	615.14	615.00	615.25	615.00	615.36	615.06	615.47	615.15	615.58	615.24	615.69	615.34	615.80	615.43	615.91	615.52	616.02	615.61	616.13	615.71	616.24	615.80	616.34	615.87	616.39	615.90	616.41	616.00	616.39	616.22	616.32	616.46	616.22	616.65	616.12	616.86	616.04	617.08	616.01	617.24	616.03	617.39	616.10	617.54	616.23	617.69	616.41	617.82	616.64	617.93	616.93	618.00	617.23
201+00	201+50	202+00	202+50	203+00	203+50	204+00	204+50	205+00	205+50	206+00	206+50	207+00																																																	

**ESI CONSULTANTS, LTD**  
 1570 N. MILL STREET, SUITE 100  
 NAPERVILLE, IL 60563  
 (630) 428-1700  
 WWW.ESICONSULTANTS.LTD.COM  
 ILLINOIS DEPARTMENT OF PROFESSIONAL REGULATION REGISTRATION #184-093885

DESIGNED - JRS  
 DRAWN - DJN  
 CHECKED - MAR  
 DATE - 6/16/2008

REVISED -  
 REVISED -  
 REVISED -  
 REVISED -

STATE OF ILLINOIS  
 DEPARTMENT OF TRANSPORTATION

PLAN AND PROFILE

F.A. RTE. SECTION 08-00039-00-FP COUNTY WILL TOTAL SHEETS 89 SHEET NO. 15 CONTRACT NO. 63066  
 FED. ROAD DIST. NO. ILLINOIS FED. AID PROJECT

6/16/2008 K:\Project\Quiet Arsenal Development Authority\South Arsenal Road\East\CAD\Sheet\15 PP3.dwg