

MATCH LINE STA. 207+00

MATCH LINE STA. 213+00

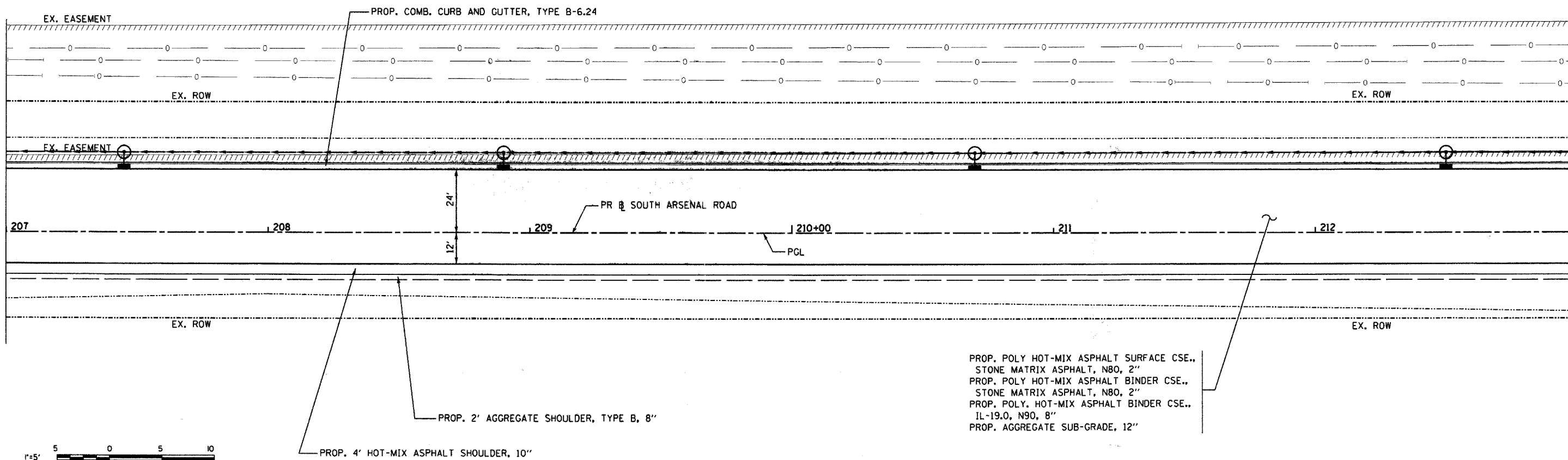

PROP. POLY HOT-MIX ASPHALT SURFACE CSE.,
 STONE MATRIX ASPHALT, N80, 2"
 PROP. POLY HOT-MIX ASPHALT BINDER CSE.,
 STONE MATRIX ASPHALT, N80, 2"
 PROP. POLY. HOT-MIX ASPHALT BINDER CSE.,
 IL-19.0, N90, 8"
 PROP. AGGREGATE SUB-GRADE, 12"

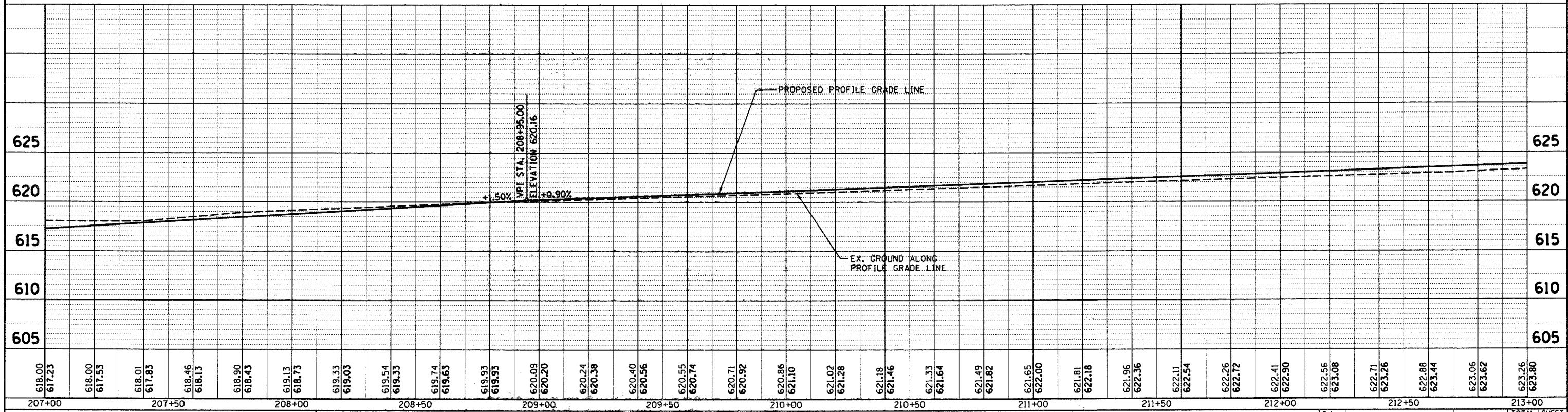
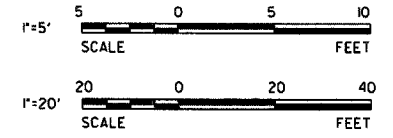

618.00 617.23	618.00 617.53	618.01 617.83	618.46 618.13	618.90 618.43	619.13 618.73	619.33 619.03	619.54 619.33	619.74 619.63	619.93 619.93	620.09 620.20	620.24 620.38	620.40 620.56	620.55 620.74	620.71 620.92	620.86 621.10	621.02 621.28	621.18 621.46	621.33 621.64	621.49 621.82	621.65 622.00	621.81 622.18	621.96 622.36	622.11 622.54	622.26 622.72	622.41 622.90	622.56 623.08	622.71 623.26	622.88 623.44	623.06 623.62	623.26 623.80
207+00	207+50	208+00	208+50	209+00	209+50	210+00	210+50	211+00	211+50	212+00	212+50	213+00																		

ESI CONSULTANTS, LTD
 1377 N. MILL STREET, SUITE 100
 NAPERVILLE, IL 60563
 (830) 420-1700
 WWW.ESICONSULTANTS.LTD.COM
 ILLINOIS DEPARTMENT OF PROFESSIONAL REGULATION REGISTRATION #184-003893

DESIGNED - JRS	REVISED -
DRAWN - DJN	REVISED -
CHECKED - MAR	REVISED -
DATE - 6/16/2008	REVISED -

STATE OF ILLINOIS
 DEPARTMENT OF TRANSPORTATION

PLAN AND PROFILE

SCALE: 1"=20' SHEET NO. OF SHEETS STA. 207+00 TO STA. 213+00

F.A. RTE.	SECTION	COUNTY	TOTAL SHEETS	SHEET NO.
	08-00039-00-FP	WILL	89	16
FED. ROAD DIST. NO.		ILLINOIS FED. AID PROJECT		
CONTRACT NO. 63066				

6/16/2008 K:\Projects\Joliet Arsenal Development Authority\South Arsenal Road\Est\CAD\Sheet\16 PP4.sht