

MATCH LINE STA. 219+00

MATCH LINE STA. 225+00

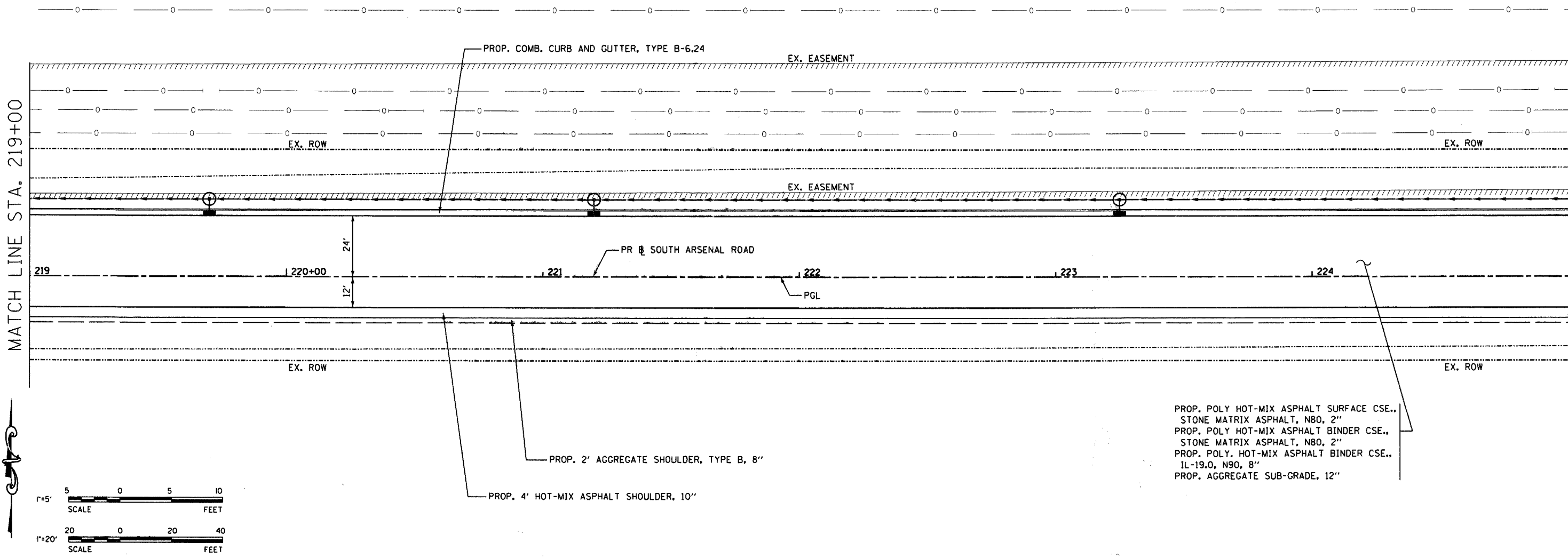

PROP. POLY HOT-MIX ASPHALT SURFACE CSE.,
 STONE MATRIX ASPHALT, N80, 2"
 PROP. POLY HOT-MIX ASPHALT BINDER CSE.,
 STONE MATRIX ASPHALT, N80, 2"
 PROP. POLY. HOT-MIX ASPHALT BINDER CSE.,
 IL-19.0, N90, 8"
 PROP. AGGREGATE SUB-GRADE, 12"

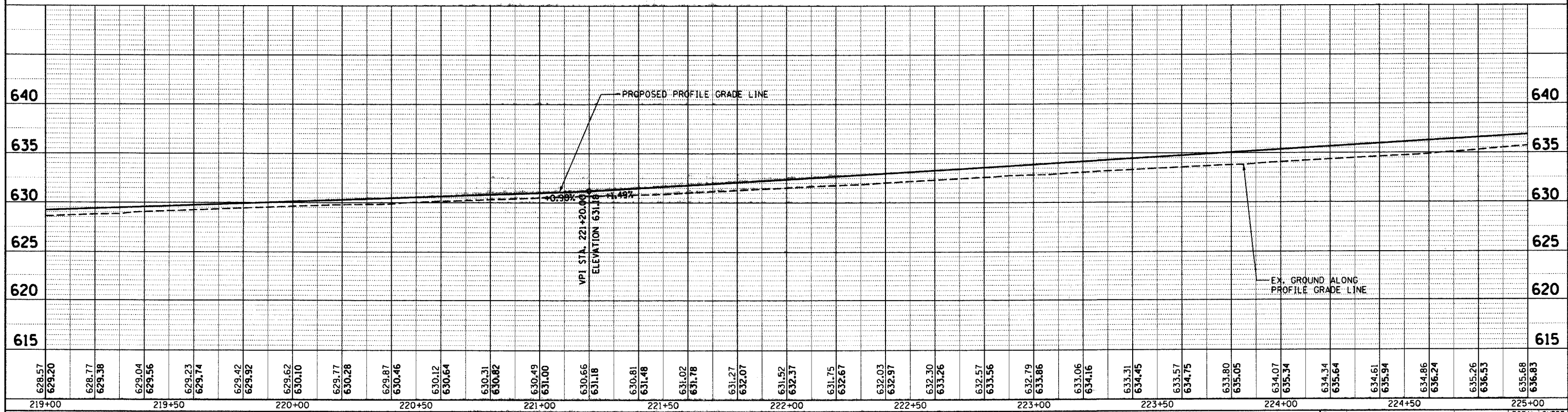
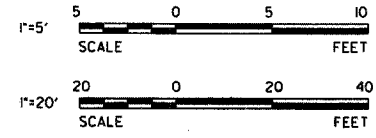

628.57	629.20	628.77	629.38	629.04	629.56	629.23	629.74	629.42	629.92	629.62	630.10	629.77	630.28	629.87	630.46	630.12	630.64	630.31	630.82	630.49	631.00	630.66	631.18	630.81	631.48	631.02	631.78	631.27	632.07	631.52	632.37	631.75	632.67	632.03	632.97	632.30	633.26	632.57	633.56	632.79	633.86	633.06	634.16	633.31	634.45	633.57	634.75	633.80	635.05	634.07	635.34	634.34	635.64	634.61	635.94	634.86	636.24	635.26	636.53	635.68	636.83
219+00	219+50	220+00	220+50	221+00	221+50	222+00	222+50	223+00	223+50	224+00	224+50	225+00																																																	

ESI CONSULTANTS, LTD
 1979 N. MILL STREET, SUITE 100
 NAPERVILLE, IL 60563
 (630) 420-1700
 WWW.ESICONSULTANTS.LTD.COM
 ILLINOIS DEPARTMENT OF PROFESSIONAL REGULATION REGISTRATION #164-003685

DESIGNED - JRS	REVISED -
DRAWN - DJN	REVISED -
CHECKED - MAR	REVISED -
DATE - 6/16/2008	REVISED -

STATE OF ILLINOIS
 DEPARTMENT OF TRANSPORTATION

PLAN AND PROFILE

SCALE: 1"=20' SHEET NO. OF SHEETS STA. 219+00 TO STA. 225+00

F.A. RTE.	SECTION	COUNTY	TOTAL SHEETS	SHEET NO.
	08-00039-00-FP	WILL	89	18
FED. ROAD DIST. NO.		ILLINOIS FED. AID PROJECT		
CONTRACT NO. 63066				

6/16/2008 K:\projects\Batter Arsenal Development Authority\South Arsenal Road.East\CADD\81818 PPG.sht