

PROJECT LIMIT
STA 191+59

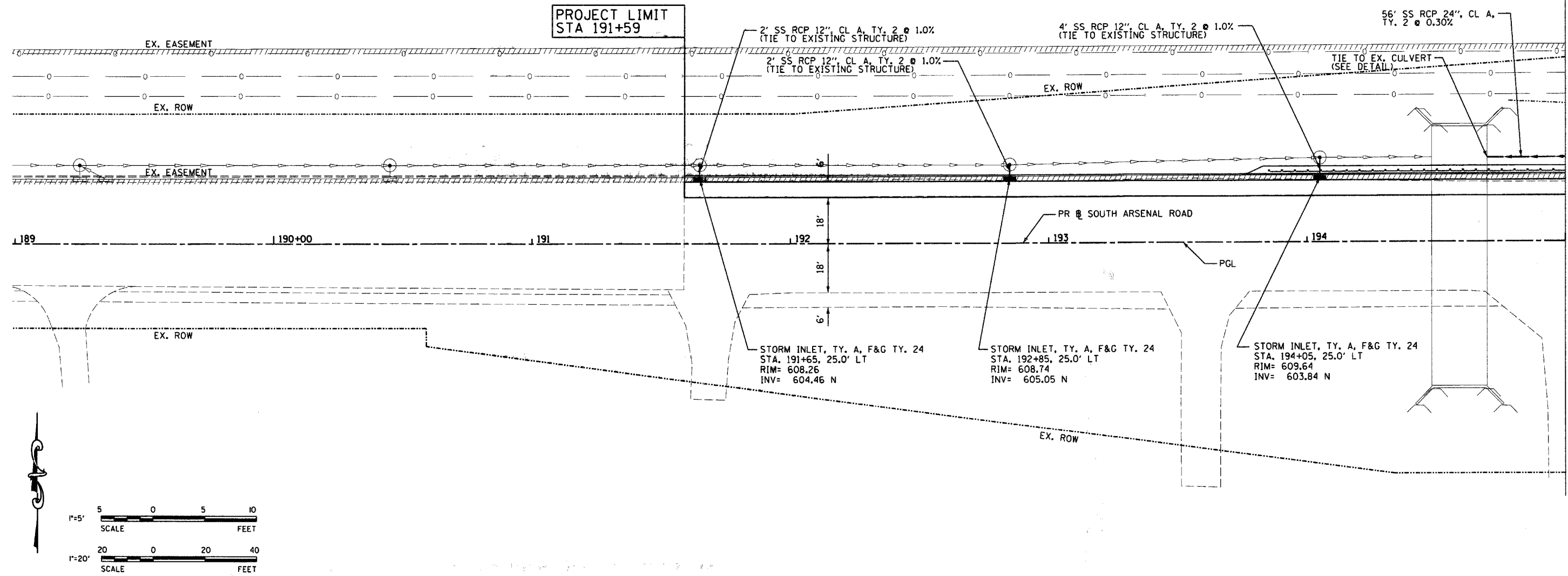

MATCH LINE STA. 195+00

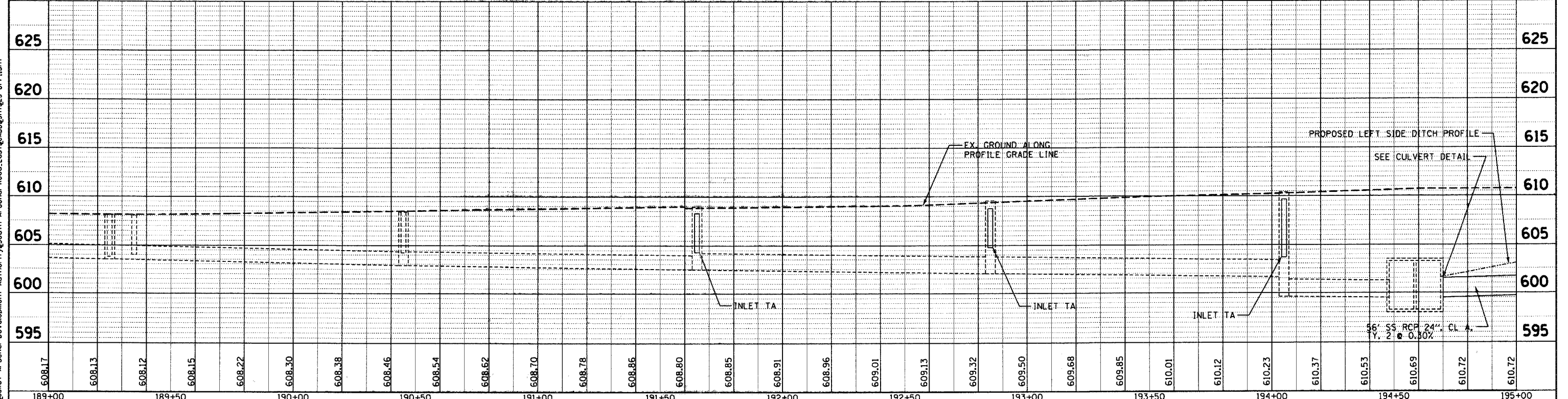
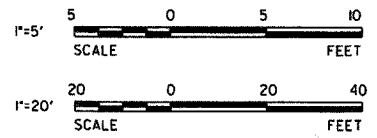

6/16/2008 K:\Projects\01\Arsenal Development Authority\South Arsenal Road\East\CD08\Shig25 DP\1.sht

608.17	608.13	608.12	608.15	608.22	608.30	608.38	608.46	608.54	608.62	608.70	608.78	608.86	608.80	608.85	608.91	608.96	609.01	609.13	609.32	609.50	609.68	609.85	610.01	610.12	610.23	610.37	610.53	610.69	610.72	610.72	
189+00	189+50	190+00	190+50	191+00	191+50	192+00	192+50	193+00	193+50	194+00	194+50	195+00																			

ESI CONSULTANTS, LTD
 1575 N. MILL STREET, SUITE 100
 MAPERVILLE, IL 60863
 (833) 420-1700
 WWW.ESICONSULTANTS.LTD.COM
 ILLINOIS DEPARTMENT OF PROFESSIONAL REGULATION REGISTRATION #184-003866

DESIGNED - JRS	REVISED -
DRAWN - DJN	REVISED -
CHECKED - MAR	REVISED -
DATE - 6/16/2008	REVISED -

STATE OF ILLINOIS
 DEPARTMENT OF TRANSPORTATION

DRAINAGE PLAN AND PROFILE
 SCALE: 1"=20' SHEET NO. OF SHEETS STA. 189+00 TO STA. 195+00

F.A. RTE.	SECTION	COUNTY	TOTAL SHEETS	SHEET NO.
	08-00039-00-FP	WILL	89	25
FED. ROAD DIST. NO.		ILLINOIS FED. AID PROJECT		
		CONTRACT NO. 63066		